

# NEC

## QUICK START GUIDE

---

### **1. WHAT IS IN THE BOX**

Femtocell with optional wall fixings (where included)



Data cable to connect the Femtocell to your broadband router or cable modem



Mains power supply adaptor and plug



External GPS Antenna (Optional)

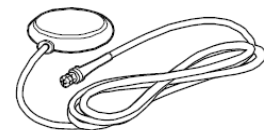

### **2. CHOOSING THE BEST LOCATION**

Before installing, think about where you want to put your new Femtocell. The ideal location is somewhere central, away from windows – this will allow the Femtocell to give the best coverage possible.



418-0001XXR R01

### **3. HOW TO INSTALL YOUR FEMTOCELL**

#### **STEP 1 – Insert the SIM Card**

Insert the SIM card provided by your Network Operator with the Femtocell. The SIM card will not lock in place if it is inserted incorrectly – please take care not to force the SIM card in to the slot.

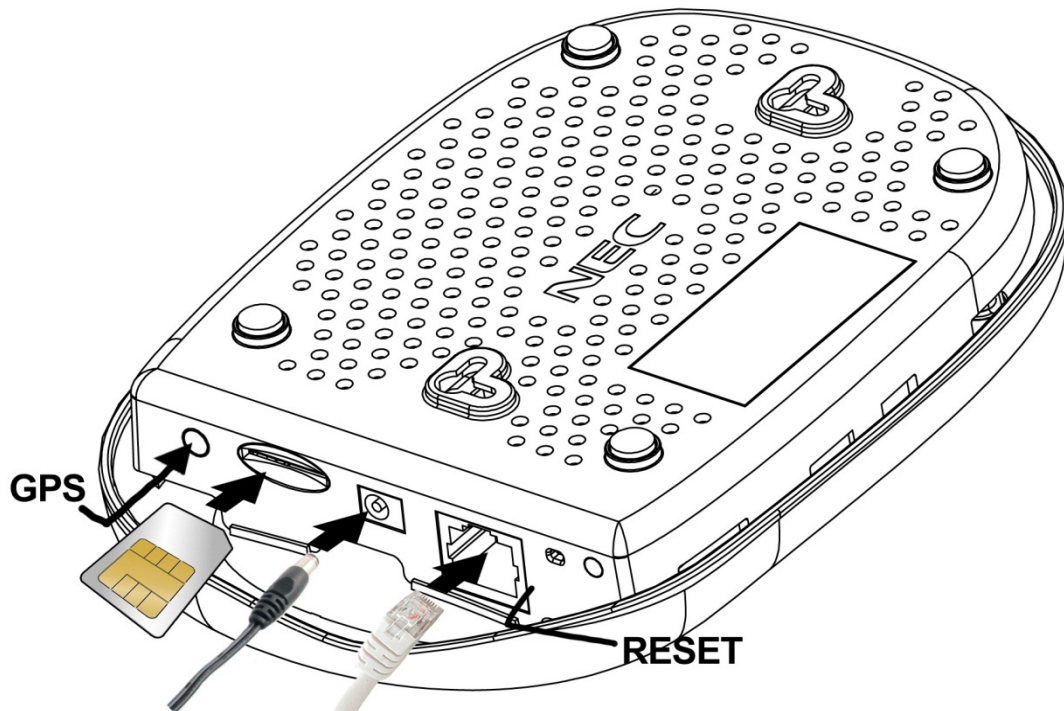

#### **STEP 2 – Connect the network cable**

Connect one end to the Femtocell and the other end to your broadband router or cable modem.

#### **STEP 3 – Connect the power adaptor and then switch on at the mains**

#### **STEP 4 – Wait 10 minutes for the Femtocell to be ready to use**

The green light will stop flashing and become solid green when the Femtocell is ready to use

## **4. IN THE EVENT OF A PROBLEM**

If the Red light is on then that means there is a problem with the device. If the Red light is not flashing then please contact customer care who will help you with the problem.

If the red light is flashing this means there is a problem which you can resolve yourself. The number of flashes indicates the type of problem as shown below:

<b>Number of flashes</b>	<b>Problem</b>	<b>Recommended action</b>
1	No connection to local broadband router	Check the connection between the broadband router and the Femtocell.
2	No internet connection	Check that the broadband router is connected to the Internet and is providing service.
3	Interference problem	There is interface with other systems. Try placing the Femtocell in a different place. If this persists please contact customer services.
4	Overheating	Check the Femtocell is located where there is good airflow.
5	SIM card problem	Check to see that the SIM card is the one provided with the Femtocell and that it has been inserted correctly. If it is please contact customer services.

## **5. PRODUCT CARE & USAGE**

All instructions, warning and caution statements that accompany this equipment must be strictly followed at all times to ensure its safe use. Observe all warning and caution symbols that are fixed to this equipment.

***Do not cover the device or block the airflow to the device with any other objects***

To be in compliance with regulations, the user must use the cables supplied with the unit and install them properly. This includes the power adapter that is provided.

Operate this product only with the type of power source indicated on the marking label. If you are not sure of the type of power supplied to your home, consult your dealer or local electricity company.

Do not use this product near water, for example a swimming pool or a bathroom. Keep the device away from excessive heat and humidity and keep the device free from vibration and dust.

## **Federal Communication Commission Interference Statement**

This device has been tested and found to comply with the limits for a Class B digital device, pursuant to part 15 of the FCC Rules. These limits are designed to provide reasonable protection against such interference in a residential installation. This equipment generates, uses, and can radiate radio frequency energy. If not installed and used in accordance with the instructions, it may cause harmful interference to radio communications. However, there is no guarantee that interference will not occur in a particular installation. If this equipment does cause harmful interference to radio or television reception, which can be determined by turning the equipment OFF and ON, the user is encouraged to try to correct the interference by one or more of the following measures:

- Reorient or relocate the receiving antenna, if applicable.
- Increase the separation between the equipment and receiver.
- Connect the equipment into an outlet on a circuit different from that to which the receiver is connected.
- Consult the service provider or an experienced radio/television technician for help.

FCC Caution: Any changes or modifications not expressly approved by the party responsible for compliance could void the user's authority to operate this equipment.

This transmitter must not be co-located or operating in conjunction with any other antenna or transmitter.

The information shown in the FCC Declaration of Conformity paragraph below is a requirement of the FCC and is intended to supply you with information regarding the FCC approval of this device.

### **FCC Declaration of Conformity**

Description:	3G Small Cell
M/N :	FP8132T
Product code:	FP8132T-01US
FCC ID:	D6XFP8132T
IC ID:	3187A-FP8132T

This device complies with Part 15 of FCC Rules. Operation is subject to the following two conditions:

The device may not cause harmful interference.

The device must accept any interference received, including interference that may cause undesired operation.

### **Canada EMI Regulation**

This Class B digital apparatus complies with Canadian ICES-003.

Cet appareil numérique de la class B est conforme à la norme NMB-003 du Canada.

This device complies with RSS-132 and RSS-133 of the Industry Canada Rules.

Operation is subject to the following two conditions:

- This device may not cause harmful interference.
- This device must accept any interference received, including interference that may cause undesired operation.

### **Radiation Exposure Statement**

This device complies with FCC's RF radiation exposure limits set forth for an uncontrolled environment under the following conditions:

This device should be installed and operated such that a minimum separation distance of 8 inches (20 cm) is maintained between the radiator (antenna) and the user's or nearby person's body at all times.

This transmitter must not be co-located or operated in conjunction with any other antenna or transmitter.

For more information, visit the FCC website at <http://www.fcc.gov>

### **Disclaimer**

NEC assumes no responsibility for errors or omissions that may appear in this guide. We reserve the right to change this guide at any time without notice.

### **Industry Canada statement:**

This device complies with RSS-210 of the Industry Canada Rules. Operation is subject to the following two conditions: (1) This device may not cause harmful interference, and (2) this device must accept any interference received, including interference that may cause undesired operation. Ce dispositif est conforme à la norme CNR-210 d'Industrie Canada applicable aux appareils radio exempts de licence. Son fonctionnement est sujet aux deux conditions suivantes: (1) le dispositif ne doit pas produire de brouillage préjudiciable, et (2) ce dispositif doit accepter tout brouillage reçu, y compris un brouillage susceptible de provoquer un fonctionnement indésirable.

### **Radiation Exposure Statement:**

This equipment complies with IC radiation exposure limits set forth for an uncontrolled environment. This equipment should be installed and operated with minimum distance 20cm between the radiator & your body.

### **Déclaration d'exposition aux radiations:**

Cet équipement est conforme aux limites d'exposition aux rayonnements IC établies pour un environnement non contrôlé. Cet équipement doit être installé et utilisé avec un minimum de 20 cm de distance entre la source de rayonnement et votre corps.