

# MOCET

## IP3093-L Communicator mini Quick User Guide



Made for



iPod



iPhone



iPad



Copyright © 2013, All Rights Reserved.

Ver: R02 D/C: 102-1111

## **Federal Communication Commission Interference Statement**

This equipment has been tested and found to comply with the limits for a Class B digital device, pursuant to Part 15 of the FCC Rules. These limits are designed to provide reasonable protection against harmful interference in a residential installation. This equipment generates, uses and can radiate radio frequency energy and, if not installed and used in accordance with the instructions, may cause harmful interference to radio communications. However, there is no guarantee that interference will not occur in a particular installation. If this equipment does cause harmful interference to radio or television reception, which can be determined by turning the equipment off and on, the user is encouraged to try to correct the interference by one or more of the following measures:

- Reorient or relocate the receiving antenna.
- Increase the separation between the equipment and receiver.
- Connect the equipment into an outlet on a circuit different from that to which the receiver is connected.
- Consult the dealer or an experienced radio/TV technician for help.

FCC Caution: Any changes or modifications not expressly approved by the party responsible for compliance could void the user's authority to operate this equipment.

This device complies with Part 15 of the FCC Rules. Operation is subject to the following two conditions: (1) This device may not cause harmful interference, and (2) this device must accept any interference received, including interference that may cause undesired operation.

## **CE Declaration of Conformity**

This equipment complies with the requirements relating to electromagnetic compatibility, EN55022 class B for ITE and EN 50082-1. This meets the essential protection requirements of the European Council Directive 89/336/EEC on the approximation of the laws of the Member States relating to electromagnetic compatibility.

## **Environment**

The device you have purchased, as well as any used batteries must not be disposed of with household waste. You should return these to your distributor if they are to be replaced or disposed of them in an approved recycling center.

## **Trademarks**

iPad™, iPad mini™, iPhone™, iDevice™, iPod™, iTunes™, iOS™, Safari™ and Facetime™ are registered trademarks of Apple Inc., USA. Android is a trademark of Google Inc., USA. Skype™ and Lync2013™ are registered trademarks of Microsoft. Viber, Line and others as well as Unified Communications (UC) apps, like CounterPath™ Bria™, Cisco™ Jabber™, Avaya™ Flare™, Radvision™ Scopia™, Polycom™ RealPresence™ or others are registered trademarks of their respective owners.

## **WARNING!**



1. Read these installation instructions carefully before connecting the device to its power.
2. To reduce the risk of electric shock, do not remove the cover from the device or attempt to dismantle it. Opening or removing covers may expose you to dangerous voltage levels. Equally, incorrect reassembly could cause electric shock on re-use of the appliance.
3. Do not expose the device to Fire, direct sunlight or excessive heat.
4. Do not expose the device to rain or moisture and do not allow it to come into contact with water.
5. Do not install the device in an environment likely to present a THREAT OF IMPACT.

6. You may clean the device using a fine damp cloth. Never use solvents (such as trichloroethylene or acetone), which may damage the device's plastic surface. Never spray the device with any cleaning product whatsoever.
7. The device is designed to work in temperatures from 5°C to 40°C.
8. The device must be installed at least 1 meter from radio frequency equipment, such as TVs, radios, hi-fi or video equipment (which radiate electromagnetic fields).
9. Do not attempt to upgrade device in an unstable power environment. This could cause unexpected issues.
10. Do not work on the system or connect or disconnect cables during lightning storms.
11. Children don't recognize the risks of electrical appliances. Therefore use or keep the phone only under supervision of adults or out of the reach from children.
12. No repair can be performed by the end user, if you experience trouble with this equipment, for repair or warranty information, please contact your supplier.

# Introduction

The MOCET™ Communicator mini™ is an innovative audio accessory that enables you to use your Apple™ iPad mini, or iPhone 5, 5s or 5c as a desktop phone with popular Social Networking apps like FaceTime, Skype, Viber, Line and others as well as Unified Communications (UC) apps, like CounterPath Bria iPad Edition, Cisco Jabber for iOS, Avaya Flare, Radvision Scopia, Polycom RealPresence, Microsoft Lync2013, and others, available from the Apple™ App Store™

The high definition audio-enabled handset and speakerphone on the Communicator mini dramatically enhances your communications and ensures privacy and comfort. For a large office or small to medium sized conference room, there is even an optional desktop microphone set available to ensure all participants in the room can be heard clearly on the call. For a more enjoyable multimedia experience, there is an available external speaker to play high quality stereo audio when listening to music or watching movies or YouTube videos.

The Communicator mini stand is adjustable between 0° and 125°, allowing you to find the most convenient viewing angle for watching movies or participating in video conferencing calls at your desk. The Communicator mini has a built-in fast charger so you can play and work all day, and when you leave, your iPad mini or iPhone will be fully charged and ready to go. Using the built-in USB host port, you can even charge a second phone or mobile device.

And because it pairs using Bluetooth, Android, Windows Mobile and other Bluetooth-enabled devices can also benefit from the Communicator mini's HD handset and speakerphone for better call quality and comfort as well.

## What's In the Package?

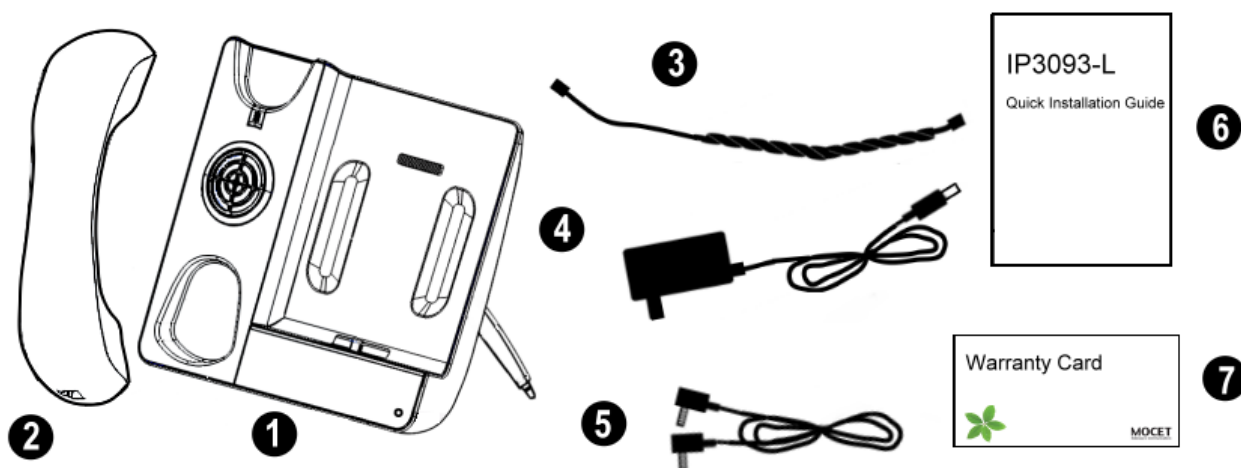

- |                                |                          |
|--------------------------------|--------------------------|
| 1. Main unit x 1               | 5. AUX-in cable x 1      |
| 2. Handset x 1                 | 6. Quick start guide x 1 |
| 3. Handset cord x 1            | 7. Warranty card x 1     |
| 4. Power adapter with cord x 1 |                          |

## Setting up the Communicator mini™

### 1. Adjust the stand

After unpacking the product package box, place the Communicator mini on the table and slightly pull the stand apart from the bottom shell to a comfortable viewing position.

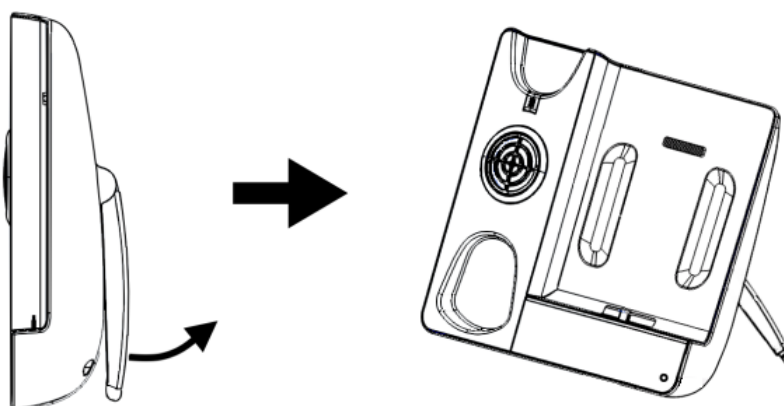

### 2. Attach the handset

Attach the long end of the handset cord to the **HAND** port in the back of the Communicator mini. Then, attach the short end to the handset. Run the cord through the cable guide so that the Communicator mini™ does not wobble on the desk.

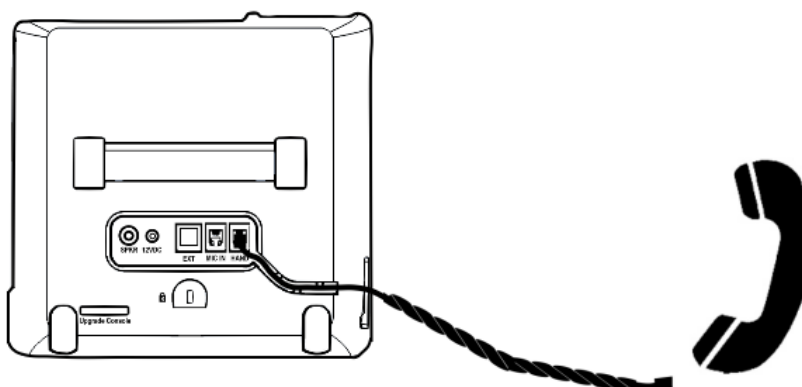

### 3. Plug-in the Power

Attach the cord of the power adaptor to the **12VDC** port on back panel of the Communicator mini. Plug the power cord into an outlet. When it is powered, the LEDs on the front panel of

main unit will light up and an alert sound will indicate that the Communicator mini is ready to go.

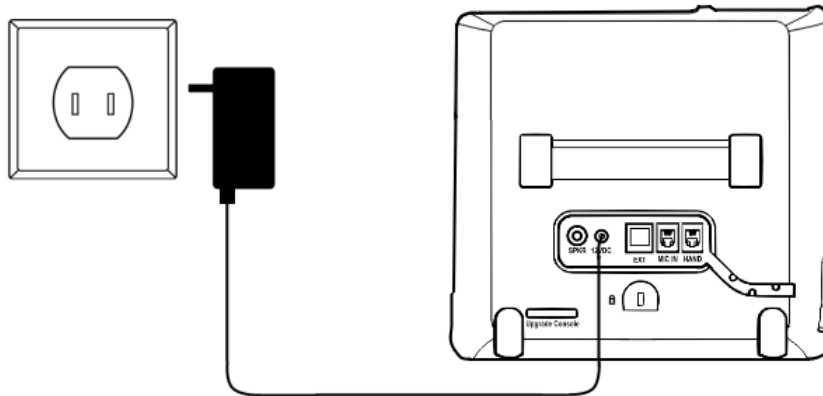

#### 4. Connect the external speaker IP-SPKR (optional)

You can connect an external speaker to the **SPKR** jack in the back of the Communicator mini.

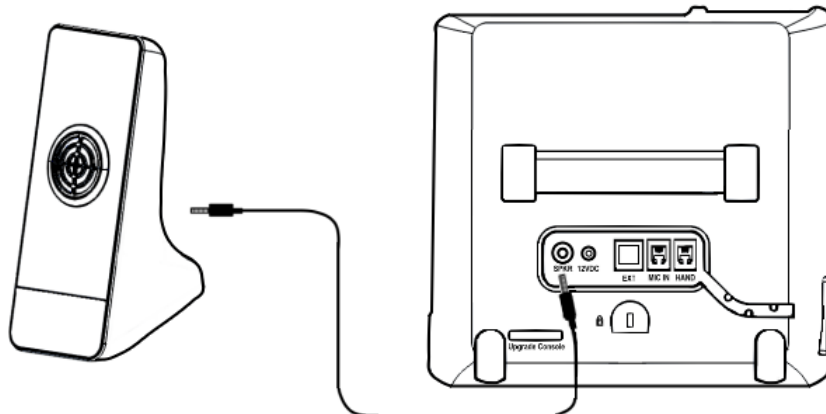

#### 5. Connect the external microphone IP-MIC (optional)

You can connect an external microphone to the **MIC IN** jack in the back of the Communicator mini to improve the ability of others on a conference call to hear everyone in the room.

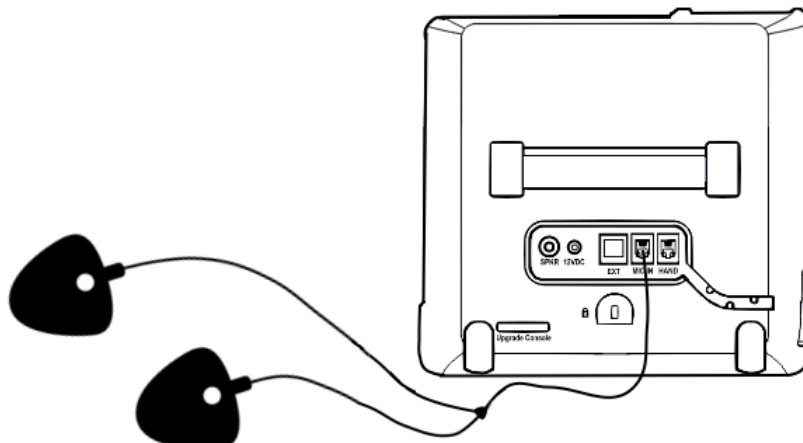



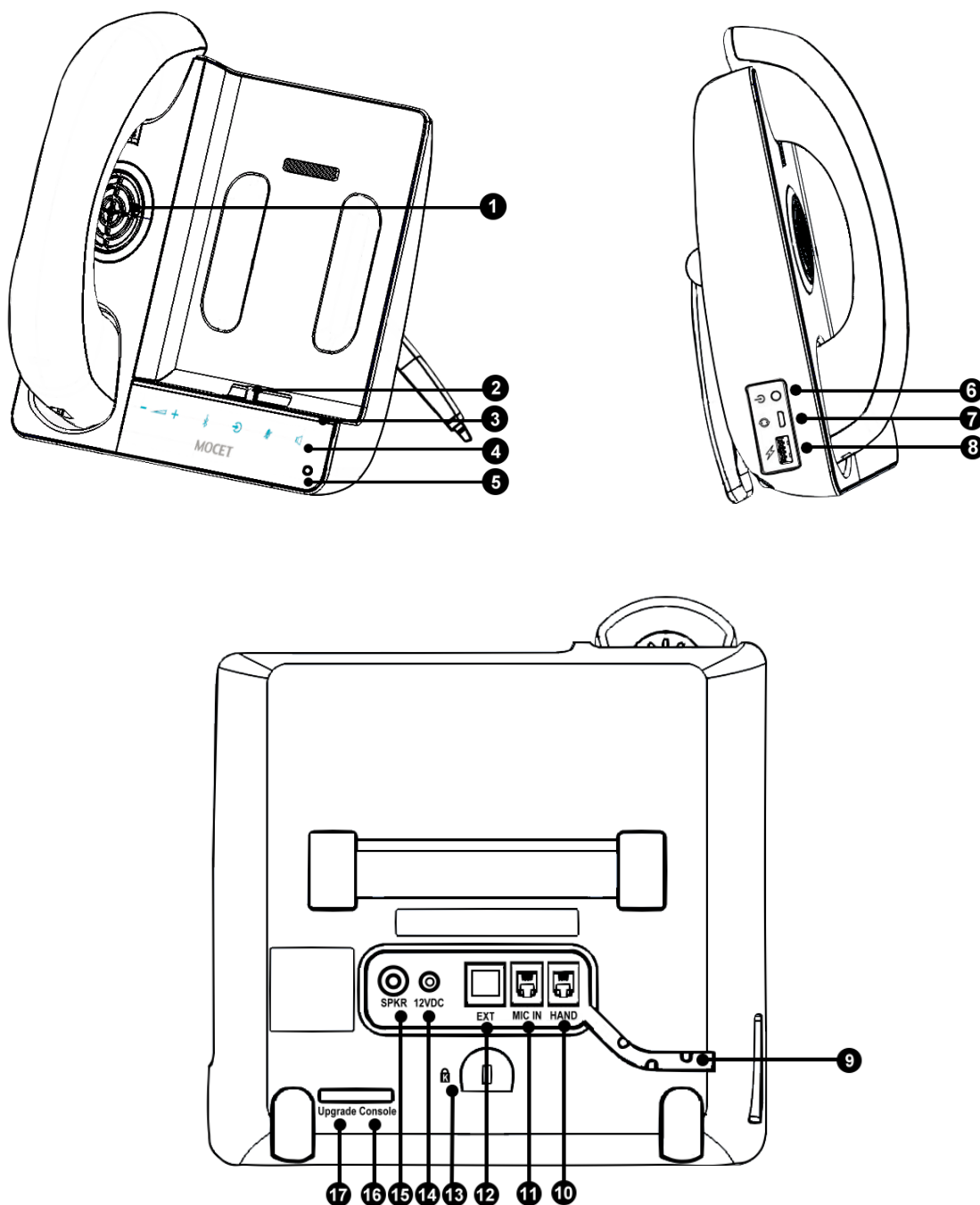

# Appearance and Buttons

The figures below show the appearance of both sides of the Communicator mini along with the user interface buttons and handset.

The front panel is capacitive touch design to allow the user to control the volume of the speaker, handset and headset of the Communicator mini. To make, answer, transfer, join, hold or end a call, please use the controls on the iPad mini or iPhone app or built-in phone app of the iPhone.



## Function Description for Interface of Communicator mini™:

1	<b>Speaker</b>	For audio playing, ring and hands-free talking.
2	<b>Lightning connector</b>	For Mobile device charging when it is seated on the Lightning connector. Also, data synchronization supported between your Mobile device and a connected computer at micro-USB port. <b>[Note]:</b> If you need a connector for another type of device, please contact MOCET directly.
3	<b>Volume indicator light bar</b>	For current volume indication. Press volume up button twice will turn on one more light. Press volume down button twice will turn off one more light.
4	 <b>Volume control</b>	Volume up (+) : Touch to raise the volume. Volume down (–) : Touch to lower the volume.
	 <b>Bluetooth</b>	Touch and hold for 3 seconds to enter the pairing mode. <b>Slow blinking:</b> Bluetooth is on pairing mode. <b>Steady on:</b> Once the Bluetooth communication is connected, the LED will be steadily lit and a hint sound will be played.
	 <b>AUX-in</b>	Toggle this to switch audio path of the Mobile device either AUX-in or Bluetooth. <b>Steady on:</b> Audio from Mobile device is through the included AUX-in cable instead of Bluetooth.
	 <b>Mute</b>	Single touch to control Mute/Unmute of microphone(s). Or, twice touches to Mute/Unmute both Mic(s) and speaker(s). <b>Steady on:</b> Both microphone and speaker are all muted. <b>Slow blinking:</b> Microphone is muted only. <b>[Note]:</b> When mute is on, the external IP-MIC pair will be muted too. You can mute the audio in the iPad mini or iPhone app or the built-in phone app of the iPhone.
	 <b>Speaker</b>	Touch to enable Communicator mini's hands-free mode. <b>Steady on:</b> Hands-free mode is enabled. (Default)
5	<b>Microphone</b>	For hands-free talking.
6	<b>AUX-in port</b>	Connect to the headset port of your mobile device through an AUX-in cable. This is useful in the event that an iPad mini or iPhone app does not support Bluetooth audio.
7	<b>PC synchronization port</b>	Micro USB port to connect to a computer through a micro USB cable for data synchronization with your device.



8	<b>Charging port</b>	USB port for charging your second mobile device.
9	<b>Cable tray (slot)</b>	Put handset cord in the tray to prevent accident pull force on the handset.
10	<b>Hand</b>	Handset connector for connecting the handset cord.
11	<b>MIC IN</b>	Microphone connector for connecting the external microphone (IP-MIC). It is an optional accessory. Please order the IP-MIC separately from MOCET.
12	<b>EXT</b>	Extension box connector. Not used.
13	<b>Kingston lock mount</b>	Anti-theft device lock. Requires separate lock system.
14	<b>12VDC</b>	Power jack for connecting the included 12V/2A power adapter.
15	<b>SPKR</b>	Speaker connector for connecting the external speaker (IP-SPKR). It is an optional accessory. Please order the IP-SPKR separately from MOCET.
16	<b>Console</b>	It is reserved for engineering usage only.
17	<b>Upgrade</b>	It is reserved for engineering usage only.

## Docking and Charging Your iPad mini or iPhone

If your iPad mini or iPhone is in a case, please remove it from the case first, and then connect it to the Communicator mini as shown in the figures below. While your Mobile device is docked on the Communicator mini, it will start charging automatically.

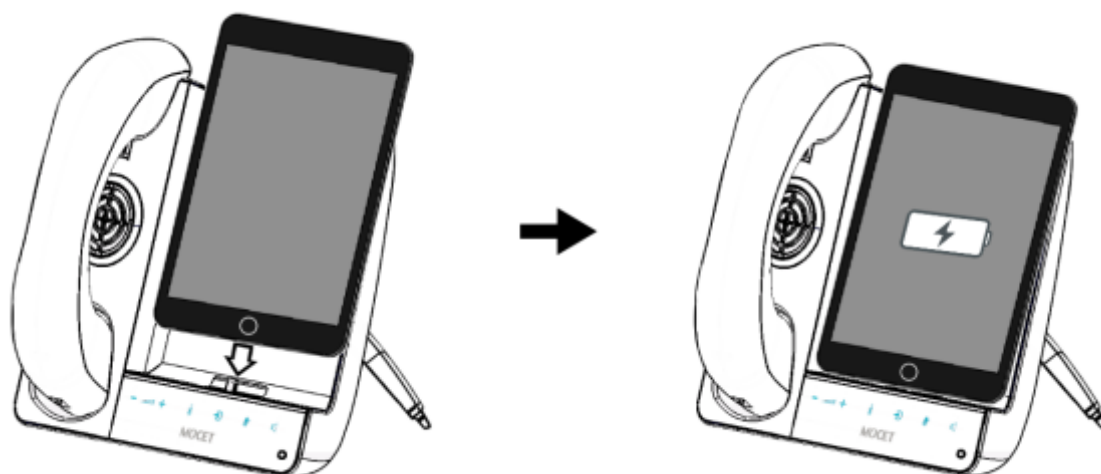

# Pairing Your iPad mini or iPhone with Bluetooth

## 1. Prepare your iPad mini or iPhone

On your device, go to Settings > Bluetooth. Turn Bluetooth on.



## 2. Prepare your Communicator mini

Touch and hold the Bluetooth button on the Communicator mini for three (3) seconds, until the Bluetooth button blinks. The Communicator mini is now in pairing mode. If you want to stop pairing mode, touch and hold the Bluetooth button again for three (3) seconds.

## 3. Pair your iPad mini or iPhone with the Communicator mini

Once your Communicator mini is listed as a device (appearing in the Bluetooth Devices list with an ID like IP3093-XXXXXX), tap it to pair and connect to your iPad mini or iPhone.



Successfully, the status will change from **Not Paired** to **Connected** once the pairing process has been completed.

When connected to the Communicator mini, if you want to disconnect Bluetooth communication with your iPad mini, iPhone, touch and hold the Bluetooth button again for three (3) seconds. The Bluetooth connection will disconnect.

# Basic Operations

To use the Communicator mini, your iPad mini and iPhone not have to be docked; it will either be connected by Bluetooth when in range of the Communicator mini, or connected by the included AUX-in cable\*. Here, we use Skype™ as an example.

## 1. Making and answering calls

When you make a call, the Communicator mini speaker automatically comes on unless you pick up the handset. When a call comes in, the Communicator mini rings. To answer the call, tap the Answer button  .

## 2. Switching between devices during a call

- Switching a call to your Communicator mini

Tap the Bluetooth button  on the Skype™ app, the call will be switched to the Communicator mini.

- Switching a call back to the iPad mini, or iPhone.

Tap the Speaker button  on the Skype™ app, the call will be switched to the Mobile device.

## 3. Adjusting the volume

You can either press the Volume buttons on the Communicator mini or on your iPad mini, or iPhone volume switch to adjust the sound level.

## 4. Synchronizing data

You can synchronize data such as music, photos and media files between your Mobile device and the computer, through the Communicator mini.

1. Install the Apple iTunes software on the computer.
2. Use a micro-USB to USB standard cable (not provided) to connect the computer and the Communicator mini (Micro-USB port).
3. Connect your iPad mini, or iPhone to the Communicator mini. The computer will recognize the device and mount it on the desktop or connect it to iTunes.
4. To synchronize data between your Mobile device and the computer, please follow the instructions provided with the application software.

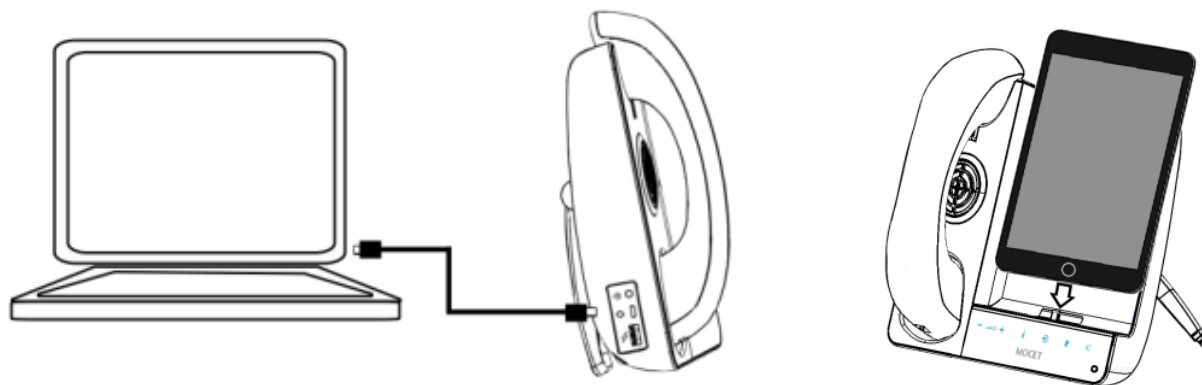

### 5. Charging a second device using the USB host port on the Communicator mini

You can use the USB port on the left side of the Communicator mini to charge a second device. Using the charging cable included with the second device, connect it to the Communicator mini USB port.

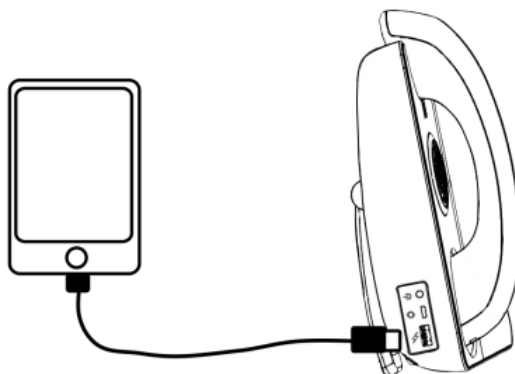

### 6. Using the AUX-in cable instead of Bluetooth pairing

There are still quite a few apps for the iPad mini or iPhone that do not support Bluetooth. Using the included AUX-in cable to connect with your device's headset port to the Communicator mini AUX-IN port will allow you to use these apps. When the AUX-in cable is connected, audio will route automatically through the included AUX-in cable to the Communicator mini. The AUX-in indicator light  will also turn steady blue.

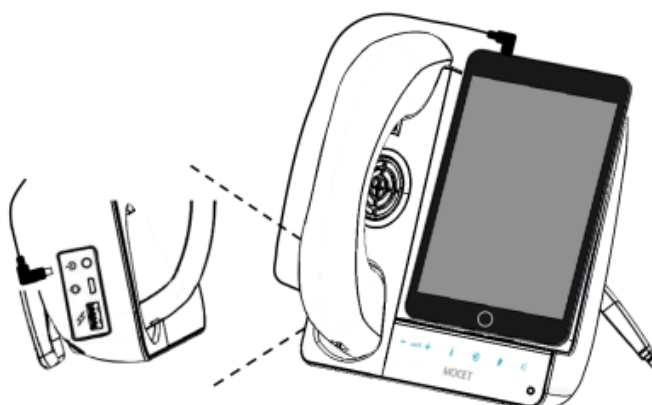

## Warranty Information

Thank you for your choice of product. Remember to record your Communicator mini information below for further support service, if needed.

This device has Model number, Bluetooth ID and Serial Number which are located on the back of the base unit. Please record them for service and support personnel.

**Model Number:** IP3093-L **BT ID:** \_\_\_\_\_ **Serial Number:** \_\_\_\_\_