

MOCET

Quick Installation Guide for the IP-SPKR Accessory *External speaker for IP3093 Communicator mini™ series*

What's In the Package?

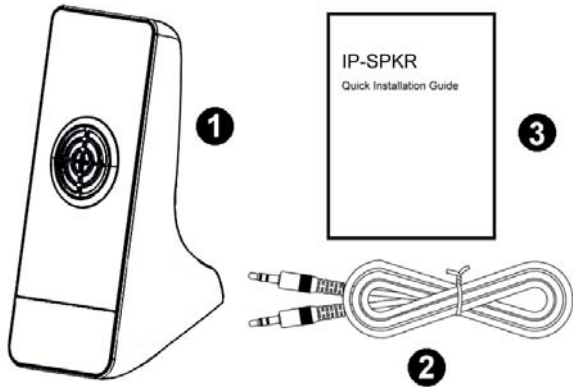

1. IP-SPKR unit x 1
2. Speaker cable x 1
3. Quick installation guide x 1

Hardware Installation

Step1: After unpacking the product package box, place the IP-SPKR at the right side of the Communicator mini™.

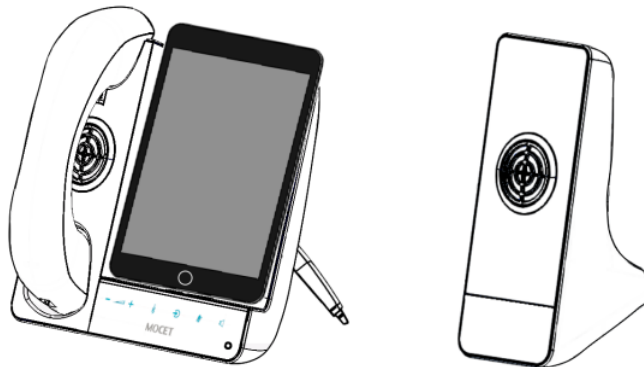

Step2: Attach the one end of the speaker cable to the SPKR port in the back of the Communicator mini™. Then, attach the other end to the IP-SPKR.

