

INSTRUCTIONS

DOCKr
by  inNuevo

inNuevo takes no responsibility for any damage or malfunction in any implied or expressed warranty or guarantee for your separately purchased Apple iPad. For warranty information, visit our website. If you need assistance, call us at 202-537-1107.

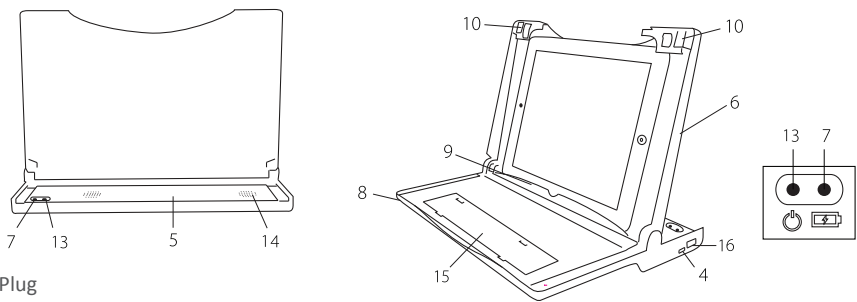

1. Plug
2. USB cable end
3. Micro USB cable end
4. Micro USB port
5. LED lights
6. Top of DOCKr
7. Battery button
8. Bottom of DOCKr
9. DOCKr holding tray
10. DOCKr Locks
11. Back Position
12. Forward Position
13. Speakers button
14. Speakers
15. Storage compartment
16. USB port
17. USB power cable

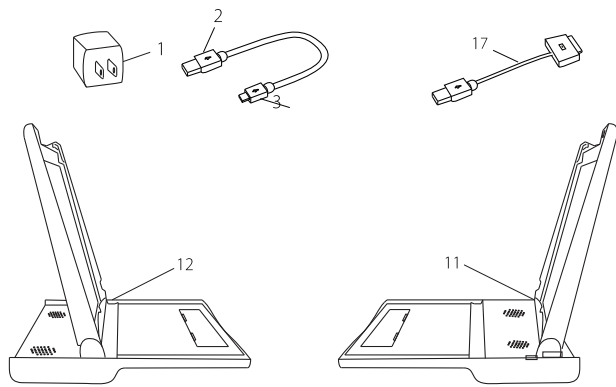

TO CHARGE YOUR DOCKR :

1. Connect the plug¹ to the USB cable end²
2. Plug the Micro USB cable end³ into the Micro USB port⁴ on the right side of the DOCKr
3. Connect the plug to an outlet

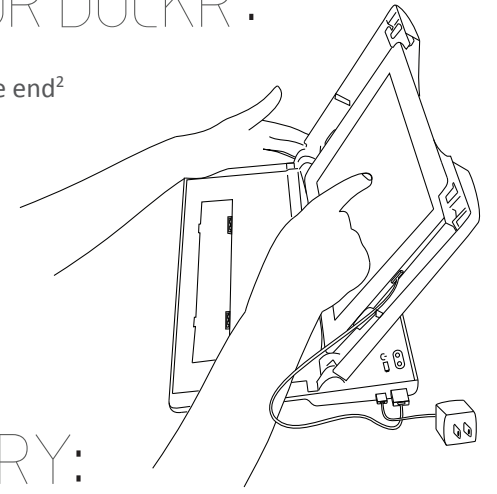

TO CHECK THE DOCKR'S BATTERY:

1. Slide the top⁶ of your DOCKr forward and locate the battery button⁷
2. Hold the battery button, the number of LED lights⁵ will show the battery life (5 lights reflect a fully charged battery)

TO OPEN AND CLOSE THE DOCKR :

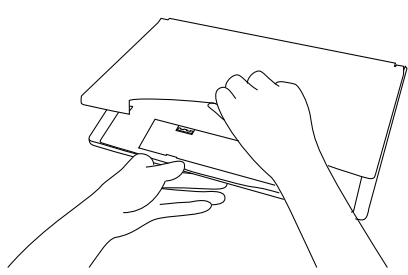

1. Put your thumb under the top lip of the DOCKr, and hold the bottom⁸ of the DOCKr while opening

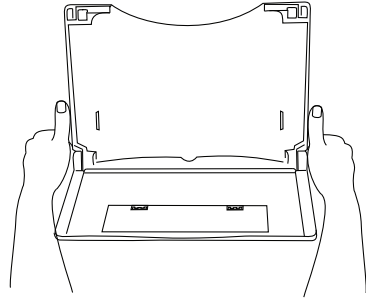

2. Using two hands, slide the top of the DOCKr towards you¹²

3. Place your iPad in the DOCKr holding tray⁹ and slide the locks¹⁰ in the top corners to secure your iPad (applies to portrait and landscape modes)

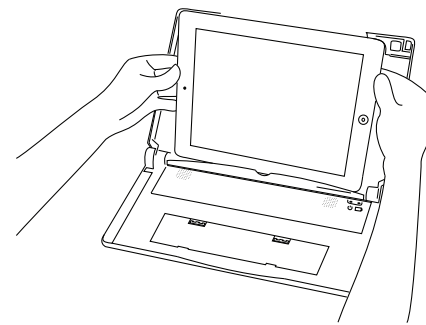

4. To close the DOCKr into a carrying case, use two hands to slide the top of the DOCKr to the back position¹¹, lock the iPad in **landscape mode** and close. Make sure your iPad is secured with DOCKr locks¹⁰ before closing

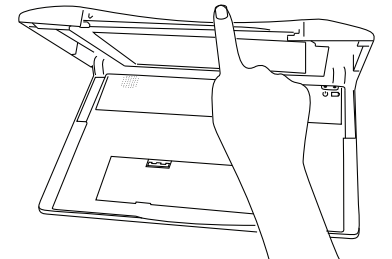

TO USE THE DOCKR SPEAKERS :

Note: DOCKr battery must be charged to play the DOCKr speakers

1. Slide the top of the DOCKr towards you with two hands

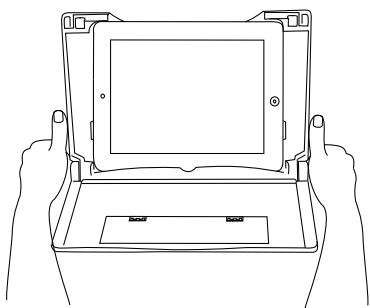

2. Locate the buttons in the back right corner of DOCKr, press the battery button⁷ until you see LED lights flash ON

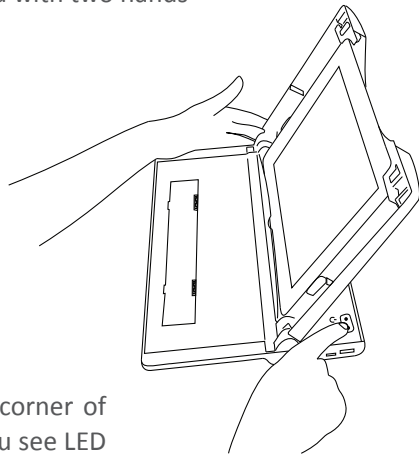

3. Press and hold the speaker button¹³ for four seconds, speakers are on when you hear the beep sounds, the LED lights will remain on

4. Go to "Settings" on your electronic device and turn on "Bluetooth"

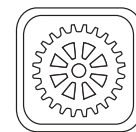

Bluetooth

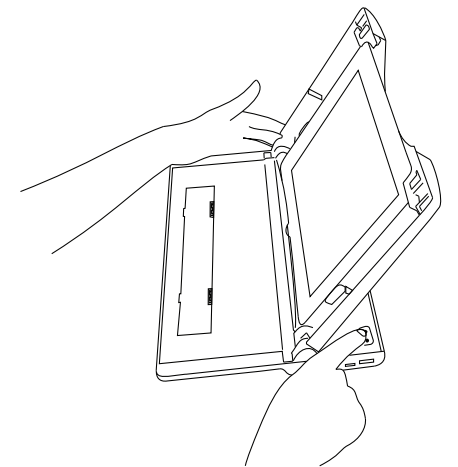

5. Touch the "DOCKr Wireless Speakers" device under Bluetooth settings to connect

6. To turn off, press speaker button (LED lights will turn off)

TO USE THE INNUEVO OR APPLE WIRELESS KEYBOARD :

1. **inNuevo Keyboard:** Locate the buttons in the upper right corner and turn "on," then push the "connect" button

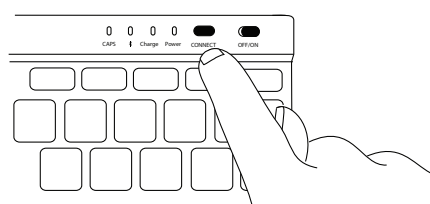

- Apple Keyboard: Lift up the keyboard and push the power button on the right side

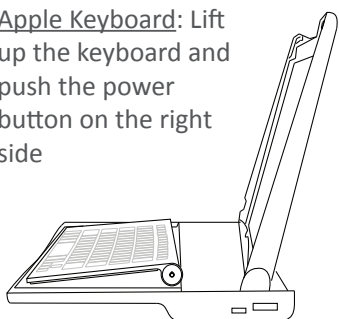

2. Go to "Settings" on your iPad or electronic device and turn on "Bluetooth"

3. Touch the "Wireless Keyboard" device under Bluetooth settings to connect and follow any additional instructions

Note: This process only has to be done once

TO CHARGE YOUR ELECTRONIC DEVICE :

1. Slide the top of the DOCKr towards you with two hands
2. Press the battery button

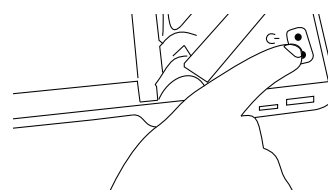

3. Locate the USB power cable¹⁷ from the storage compartment¹⁵ under the keyboard (or use your own USB-compatible cable)

4. Plug the USB cable into the DOCKr's USB outlet¹⁶ on the right side
5. Attach the other end of the cable to your electronic device

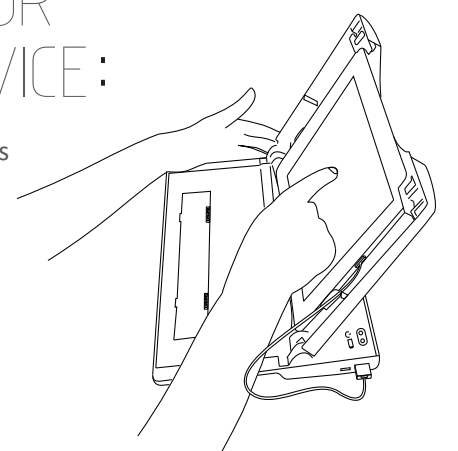

WHAT IF I HAVE MORE QUESTIONS?

Visit our inNuevo website FAQ at <http://www.innuevo.com/faq.html>

FCC Caution.

§ 15.19 Labelling requirements.

This device complies with part 15 of the FCC Rules. Operation is subject to the following two conditions: (1) This device may not cause harmful interference, and (2) this device must accept any interference received, including interference that may cause undesired operation.

§ 15.21 Changes or modification warning

Any Changes or modifications not expressly approved by the party responsible for compliance could void the user's authority to operate the equipment.

§ 15.105 Information to the user.

Note: This equipment has been tested and found to comply with the limits for a Class B digital device, pursuant to part 15 of the FCC Rules. These limits are designed to provide reasonable protection against harmful interference in a residential installation. This equipment generates uses and can radiate radio frequency energy and, if not installed and used in accordance with the instructions, may cause harmful interference to radio communications. However, there is no guarantee that interference will not occur in a particular installation. If this equipment does cause harmful interference to radio or television reception, which can be determined by turning the equipment off and on, the user is encouraged to try to correct the interference by one or more of the following measures:

- Reorient or relocate the receiving antenna.
- Increase the separation between the equipment and receiver.
- Connect the equipment into an outlet on a circuit different from that to which the receiver is connected.
- Consult the dealer or an experienced radio/TV technician for help.

*** RF warning for Portable device:**

The device has been evaluated to meet general RF exposure requirement. The device can be used in portable exposure condition without restriction.