

True Choice™ Premium Digital Monitor (P300 AND P400)

Note:

P300 comes with one Child Unit, one Parent Unit, one rechargeable battery pack and two AC adaptors.

P400 comes with one Child Unit, two Parent Units, two rechargeable battery packs and three AC adaptors.

Except for setting up (and using) the second Parent Unit, instructions for both models are the same.

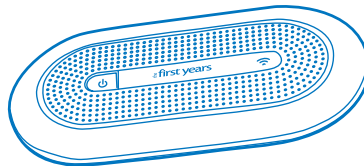

P300_P400 Child Unit

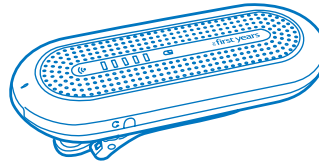

P300 Parent Unit

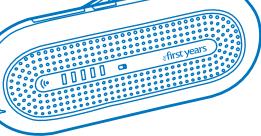
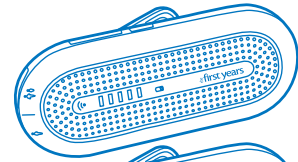

P400 Parent Unit

QUICK START INSTRUCTIONS

You'll find detailed instructions inside. Please read the safety instructions on page 2.

Set up the Parent Unit(s)

- For portable use: Install the battery pack. Battery compartment is located on the back of the unit. Loosen screw to release it, and lift cover off. (for easier access, press on top of belt clip to hold it out of the way.) Insert plug on battery pack into connector inside compartment, then fit battery into place with battery info side facing up.

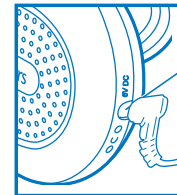

AC adaptor jack

IMPORTANT: Charge battery for 8 hours before first use

- For plug-in use: Connect one of the AC adaptors provided

Set up the Child Unit

- Place the Child Unit near your child (within 6 feet, but well beyond child's reach).
- Connect the remaining AC adaptor to the unit and plug into wall outlet

To Use:

- 1 Press and release power button to turn the Child Unit on and wait for connection indicator to blink.
- 2 Press and release the power button on the side of the Parent Unit to turn it on.
- 3 Connection indicators on all units should glow blue indicating connection.
- 4 Press [+] or [-] to adjust volume of Parent Unit(s).
- 5 Keep the Parent Unit within hearing distance.

Before returning this product to the store for any reason, please contact our Parent Service Center at 1-800-704-8697 or www.learningcurve.com
Often, we can provide helpful tips and instructions to resolve your problem quickly over the phone or by e-mail.

⚡ ⚠ WARNING:

- To prevent electric shock or strangling by the cord, do not place the monitor in, or attach it to, a crib or playpen.
- Never place these units within a child's reach.
- The product is designed to assist in the monitoring of children, not as prevention for injury to or loss of a child.
- This product is not a substitute for proper adult supervision. All children should be supervised at all times by responsible adults.

Model:Y7445C Y7446C

Model:Y7445P,Y7446P

Questions? Comments?
Contact Consumer Care
www.learningcurve.com
800-704-8697

Safety Instructions



This symbol is intended to warn the user of potential safety hazards.



This symbol is intended to alert the user to a potential risk of electric shock and other electrical safety issues.



WARNING:

To reduce the risk of fire or electrical shock, do not open this product or expose this product to:

Water And Moisture: This product should not be used near water, for example, near a bathtub or sink, in a wet basement or near a swimming pool.

Heat: This product should be situated away from heat sources such as radiators, heat registers, stoves, or other appliances that produce heat.

IMPORTANT:

- The user should not attempt to service this product. Read all safety and operating instructions before operating this product.
- Retain these instructions for future reference.
- Observe all warnings.
- Follow all operating instructions.
- Do not tamper with the plug under any circumstances.
- Power Source - This product should be connected only to the power supply provided.
- Cleaning - Before cleaning, be sure to unplug. Clean only as recommended in these instructions.
- Object And Liquid Entry - Care should be taken so that objects do not fall and liquids are not spilled into the enclosure through the openings.
- Damage Requiring Service - This product should be serviced by qualified service personnel when:
 - a. The power supply cord or plug has been damaged
 - b. Objects have fallen or liquid has been spilled into it
 - c. The product has been exposed to rain
 - d. The product does not appear to operate normally or exhibits a marked change in its performance
 - e. The product has been dropped or the enclosure damaged.

**Refer All Servicing To A Qualified First Years® Technician
(Call 1-800-704-8697 if you believe your unit needs service).**

Wall Mounting - The Child Unit should be mounted to a wall only as recommended in these instructions.



WARNING:

Do not mount the Child Unit in a location where the unit and the adaptor cord is within the child's reach.

WARNING: Changes or modifications to this unit not expressly approved by the party responsible for compliance could void the user's authority to operate equipment.

NOTE: This equipment has been tested and found to comply with the limits for a Class B digital device, pursuant to Part 15 of the FCC Rules. These limits are designed to provide reasonable protection against harmful interference in a residential installation. This equipment generates, uses and can radiate radio frequency energy and, if not installed and used in accordance with the instructions, may cause harmful interference to radio communications.

However, there is no guarantee that interference will not occur in a particular installation. If this equipment does cause harmful interference to radio or television reception, which can be determined by turning the equipment off and on, the user is encouraged to try to correct the interference by one or more of the following measures:

- Reorient or relocate the receiving antenna.
- Increase the separation between the equipment and receiver.
- Connect the equipment into an outlet on a circuit different from that to which the receiver is connected.
- Consult the dealer or an experienced radio/TV technician for help.

This device complies with part 15 of the FCC Rules. Operation is subject to the following two conditions: (1) this device may not cause harmful interference, and (2) this device must accept any interference received, including interference that may cause undesired operation.

These devices comply with FCC and Industry Canada RF radiation exposure limits set forth for general population. They must not be operated when co-located with any other antenna or transmitter.

Caution: To maintain the compliance with the FCC's RF exposure guideline, place the baby unit at least 20 cm from nearby persons.

For body worn operation, Parent Unit has been tested and meets the FCC RF exposure guidelines when used with the TOMY International, Inc. or Telefield Limited accessories supplied or designated for this product. Use of other accessories may not ensure compliance with FCC RF exposure guidelines.

Contents and Features

Child Unit, Parent Unit(s) and AC Adapter

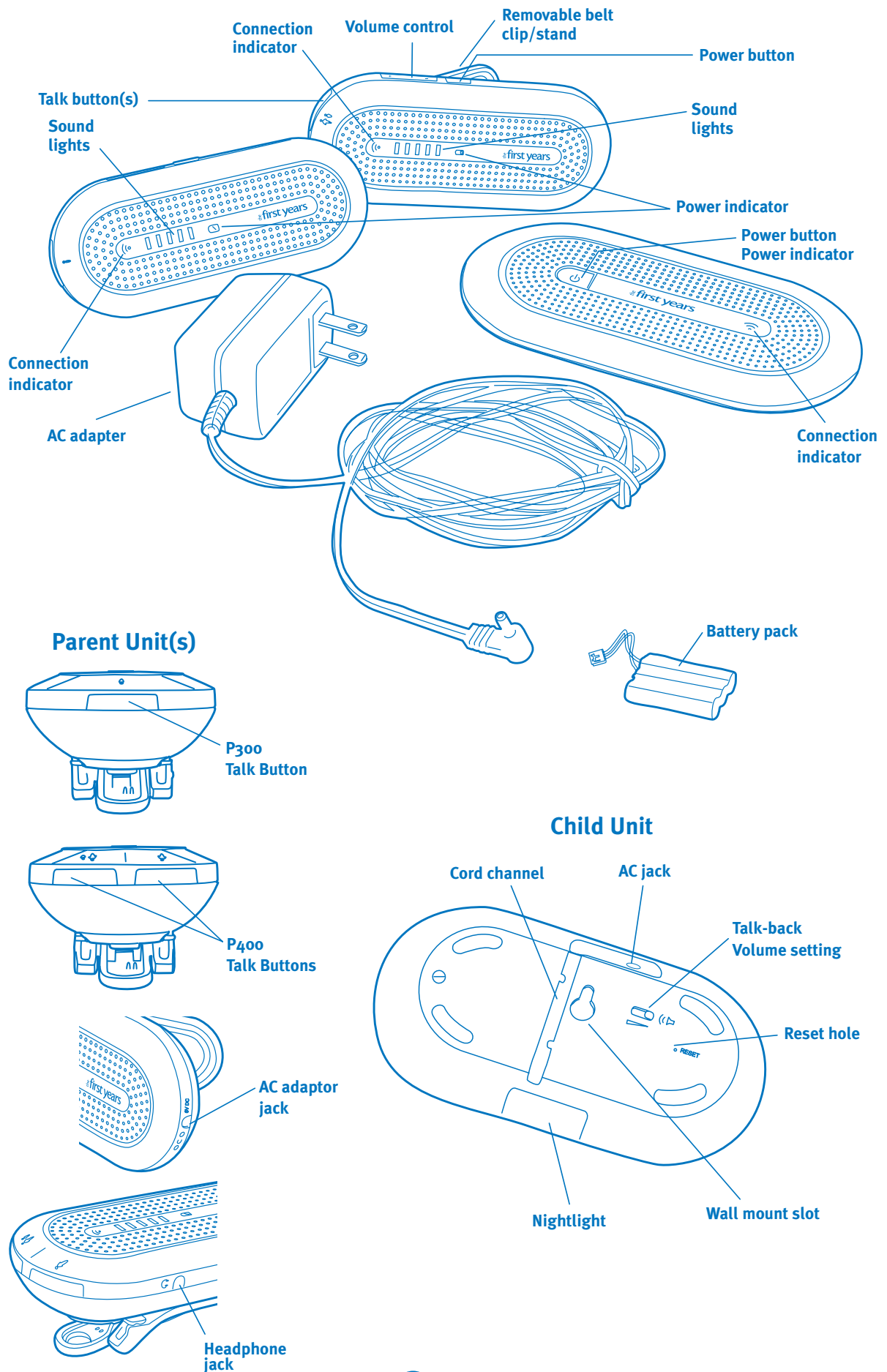

To Set Up - Child Unit

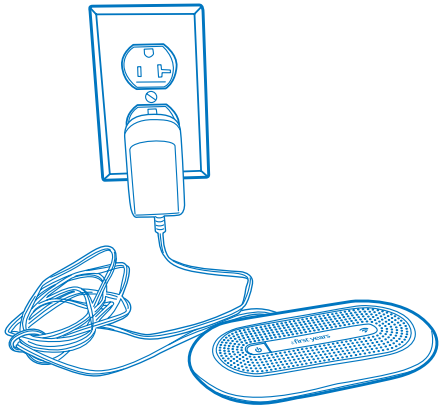

1. Position the Child Unit within 4 to 6 feet of your child. NEVER position the unit within a child's reach.
2. Insert the connector on the AC adapter into the jack on the back of the unit, then plug the adapter into an electrical outlet.

For wall mounting (optional)

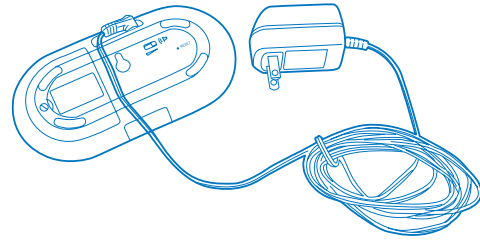

1. Press the adapter cord into the grooved channel on the back of the unit, making certain to slide it under the two holding clips.
2. Securely fasten a #8 "pan" head screw to the wall, leaving the screw head protruding by at least 1/4 inch. For best results use a 3/4-inch long screw; mount in a solid wood panel, or use a screw anchor.
3. Fit the round opening on the wall mount slot over the screw head, then slide the unit down until it is seated firmly.
4. To test that unit is securely mounted: press on its top and side edges.

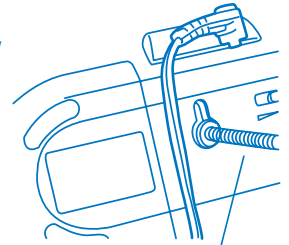

#8 "pan" head screw

For temporary/battery-powered operation

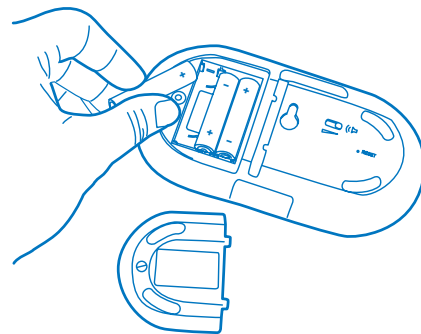

Loosen the screw to release the battery compartment cover, then lift it off. Insert three AAA batteries, positioning them so the + and - on the batteries are aligned with the corresponding marks in the battery compartment. Replace the cover and secure it by tightening the screw.

IMPORTANT: Use of batteries to power the Child's unit is intended only for temporary use during a power outage or when a plug-in electrical outlet is unavailable. Check low battery indicator often, and replace batteries as necessary.

WARNING:

Do not place Child Unit in crib or attach to crib or playpen.

WARNING:

Do not mount the Child Unit in a location where the unit or the adaptor cord is within the child's reach.

To Set Up - Parent Unit(s)

To install batteries

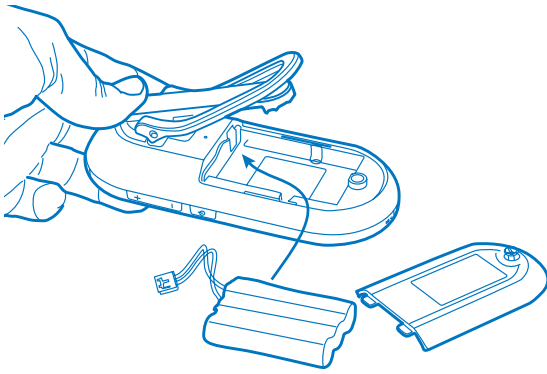

1. Loosen the screw to release the battery compartment cover. Then, lift the cover off. (For easier access, press on the top of the belt clip/stand to hold it out of the way.)
2. Insert the plug on the battery pack into the connector inside the battery compartment.
Note: Align raised rib on plug with slot in connector.
3. Fit the battery pack into the compartment; be certain that the side with the battery information faces up. Press battery pack firmly into place.
4. Place the cover back onto the battery compartment and secure it by tightening the screw.
5. **Charge the battery:** Insert the connector on the AC adaptor into the jack on the bottom of the unit, and plug into an electrical outlet. The battery needs to be charged for 8 hours before the first portable use.

IMPORTANT: While the battery is charging, the power indicator will glow purple. Once the battery is fully charged it will glow blue steadily. You may use the monitor while charging; however, it will take longer to charge when in use.

For plug-in use/recharging

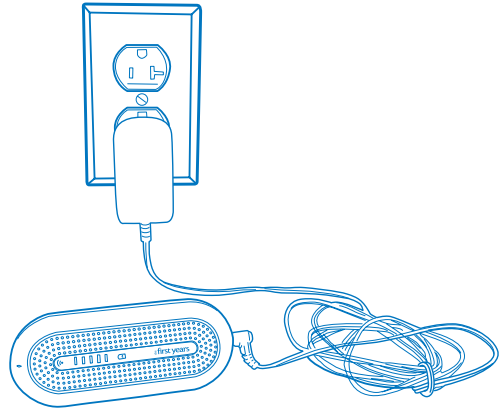

Reconnect the Parent Unit to the AC adaptor as for initial battery charging and plug the adaptor into an electrical outlet. If desired, open stand to support unit in an upright position.

IMPORTANT: Use only the AC adaptors supplied with this product. Use of any other adaptor(s) could damage Monitor and would void warranty.

- Product is not intended for use by children under 3 years old;
- Product must only be used with the supplied AC adaptor;
- AC adaptor is not a toy;
- AC adaptor should be regularly examined for damage to the cord, plug, enclosure or other parts, and in the event of such damage, it must not be used until the AC adaptor has been replaced.

To obtain replacement AC adaptor: please call our Parent Service Center at 800-704-8697.



WARNING:

Batteries may explode or leak if not used correctly. Follow all instructions for proper installation, use and storage.

To Use

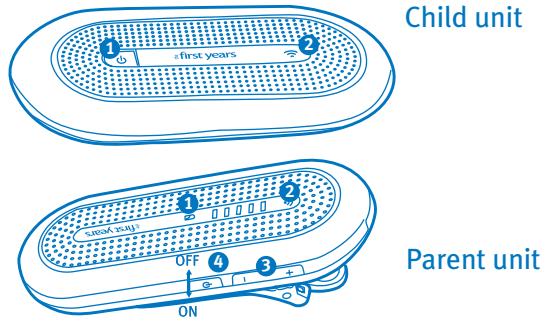

1. Press and release the power button ❶ on the Child unit to turn it on and wait for the connection indicator ❷ to blink.
2. Press and release the power button ❹ on the Parent Unit to turn it on.
3. Be certain that Power ❶ and Connection ❷ Indicators on both units are glowing blue.
4. For P400, perform steps 2 and 3 to turn on the second Parent Unit.
5. On the Parent Unit, press ❸ + and/or - to adjust volume to the desired level.
6. Keep the Parent Unit within hearing distance.

TIP: A loud screeching sound will occur if Parent Unit at a high volume level is brought close to the Child Unit. This is feedback that is common with audio devices. To avoid this it is best to either lower the volume or shut off the Parent Unit when entering the Child's room .

To turn Parent Unit off: Press and release ❹ power button.

To turn Child Unit off: Press and release ❶ power button.

Note: Turning units off conserves battery power.

Important: Power indicator will turn red when battery power is low. Batteries in Parent Unit should be recharged as soon as possible. Follow instructions under "To Set Up." [Page 5]

Range:

The distance you can separate the units and still maintain a connection will vary based on the layout and construction of your home. To test the Monitor's workable range, walk through your house and yard listening for the volume and clarity of the sounds being transmitted.

Out of range warning: If the Parent Unit is taken to a location where the connection with the Child Unit is lost, the Connection Indicator will **flash** and the unit will **beep** after 5 seconds. This warning will stop when unit is brought back into range.

Belt Clip/Stand

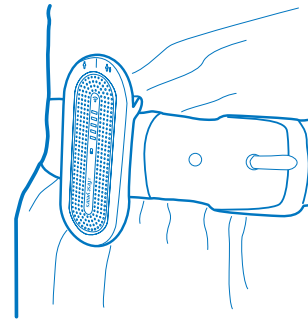

Press on the top of the belt clip to open; slide it onto waistband or belt and release.

Or, lift the tip of the stand away from the unit, and set the unit on any flat surface.

TIP: Belt clip/stand can be removed from the Parent Unit to give you a smaller unit that is easy to slip in your pocket.

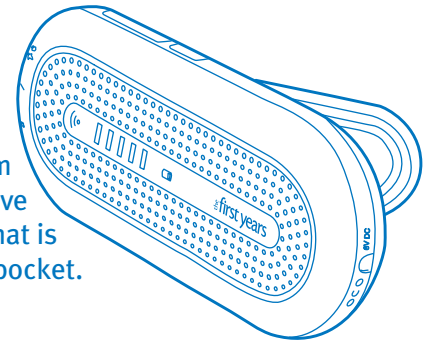

Headphone Use

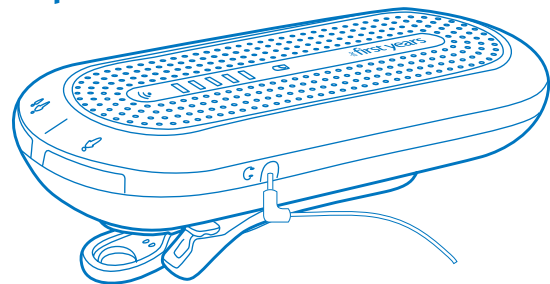

You may connect a headphone (not supplied) to the Parent Unit, if desired. When headphone is used, sound will not come out of the speaker.

Finder Feature

If you should misplace the Parent Unit, turn off the Child Unit. Wait 5 seconds, and the Parent Unit will begin to beep and will continue beeping until it is found and turned off (or batteries are exhausted). Turn Child Unit on before turning the Parent Unit back on.

Note: This feature will not work if Parent Unit is turned off or has lost power.

To Use (continued)

Lights

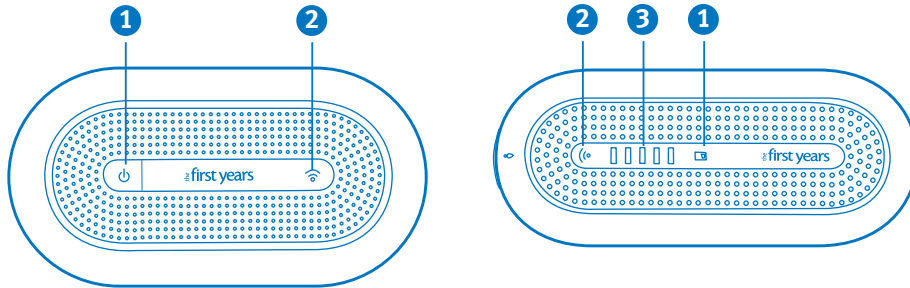

Here's how to interpret the lights on the Parent Unit(s) and the Child Unit:

1 Power Indicator

Blue Light

Unit is on.

Red Light

Batteries are weak and need to be replaced or recharged. Remove dead batteries from child unit immediately. (See "For Temporary/Battery Powered Operation" p. 4) Recharge batteries in parent unit (See "To use," p. 8).

Purple Light

(Parent unit only)

Parent unit is recharging batteries

No Light

Unit is off or no power. See "Troubleshooting."

2 Connection Indicator on Parent Unit(s)

Blue light

Unit is securely linked to the Child Unit.

Flashing blue

(Unit is also beeping.) Units are not linked, therefore Parent Unit is not able to receive sounds from the Child Unit. See "Troubleshooting."

No Light

Unit is off or batteries are dead and AC adaptor is not connected. See "Troubleshooting."

3 Sound Lights – Parent Unit(s) only

The more lights, the louder the sounds coming from baby's location.

No lights

No sound (baby is quiet).

One, two, or three Green lights

Soft sounds (baby may be fussing or vocalizing softly).

One or two Red lights

Louder sounds (baby may be crying or vocalizing loudly).

Nightlight

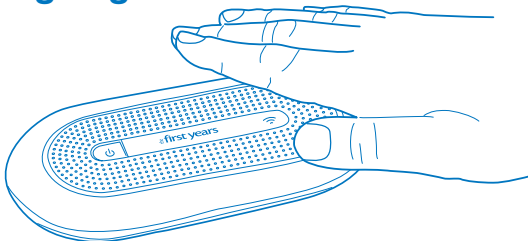

To turn the nightlight on or off touch or closely pass your hand over the child unit (as shown above). Once you turn the nightlight on, it will stay on until you turn it off.

Note: If unit is unplugged (being used in battery mode) the nightlight will automatically turn off after 30 seconds.

To Use (continued)

Two-Way Communications



Parent Unit(s)

If You Have P300:

- Press and hold the **Talk button**  to speak and soothe your child. Release button when you are done talking.



If You Have P400:

- Press and hold the **Talk-to-Child & Parent button**  to speak and soothe your child. Release button when you are done talking. Your voice will be transmitted to the other Parent Unit, as well.
- Press and hold the **Talk Parent-to-Parent button**  to speak to the person using the other Parent Unit. Release button when you are done talking. Child will not hear what you are saying.

Note: While Talk button is depressed, you will not hear any sounds being transmitted by the Child Unit.

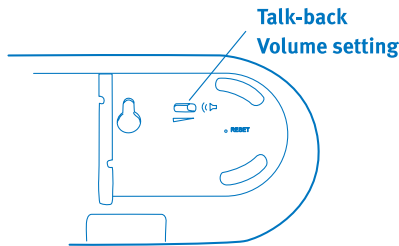

Child Unit Talk-Back Volume Setting

The volume of the talk-back on the Child Unit can be adjusted.

- There are three settings: low, medium and high
- Slide switch to the left to increase volume and to the right to decrease volume.

WARNING:

Keep batteries away from children. Parents are urged to exercise care in the storage, use and disposal of all batteries. Do not dispose of batteries in a fire. They may explode.

To avoid battery leakage:

- Be sure to insert batteries correctly following instructions. Do not put batteries in backwards; positive (+) and negative (-) ends must face the proper direction.
- Do not mix old and new batteries.
- Do not mix alkaline, standard(carbon-zinc), or rechargeable(nickel-cadmium) batteries.
- Always remove exhausted batteries from the product.
- Never use a screwdriver or any other tool to pry batteries from the compartment, as the supply terminals may be short-circuited.
- Do not leave batteries in the monitor for long periods of non-use.

Failure to follow these instructions may cause batteries to make “popping” sounds and leak battery acid, which could result in personal injury and damage to the monitor. If battery leakage occurs, avoid all contact with battery acid, being especially careful to keep it away from eyes and mouth. Should contact occur, wash any affected skin and clothing thoroughly.

Recharging/Replacing Batteries

Parent Unit(s):

If Power indicator on the Parent Unit(s) glows red instead of blue when unit is turned on, batteries are low.

If indicator does not light at all, batteries are dead. Recharge batteries following instructions under “To Set Up.”

Important: Each rechargeable battery pack is designed to be used through multiple recharge cycles. However, like all batteries, it will wear out over time. If you notice that the battery is retaining its power for only a short time and requires charging frequently, the battery pack must be replaced.

To obtain a replacement battery pack: Please call our Parent Service Center at 800-704-8697.

ONLY use the battery pack(s) supplied.

Child Unit:

Important: Remember that batteries can only power the Child Unit temporarily. If you are using the Child Unit in temporary/battery-powered mode, check the power light frequently, and replace batteries as necessary. (See “To Set Up.”)

TIP: We recommend that you use Alkaline batteries for longer life.

Troubleshooting

PROBLEM	POSSIBLE CAUSE	SOLUTION
No power (No lights on unit)	Parent Units: Unit is not turned on.	Press and release power button.
	Batteries are dead.	Recharge batteries (See “To Set Up-Parent Units(s)”), or plug in adapter.
	AC adaptor is not plugged into correct jack	Plug must be plugged into AC adaptor jack (see “For plug-in-use” p. 5)
	Child Unit: Unit is not turned on.	Press and release power button.
	Adapter not plugged in.	Plug in adapter.
	Adapter plugged into outlet that’s turned off.	If outlet is controlled by a wall switch, be sure switch is turned on.
No connection (Connection indicator flashing)	Parent Unit is too far from Child Unit, (out of range).	Move Parent Unit closer to Child Unit.
	Child Unit is turned off.	Turn on the Child Unit. Connection indicator on all units should stop blinking and glow blue. If this does not happen, pairing may need to be reset. (see detailed instructions on p. 10).
	AC adapter is not plugged into Child Unit.	Plug in the AC adapter.
	Parent Unit has temporary lost connection to Child Unit.	Reset system by turning off all units and restart them (See “To Use” p.6)
	Units are no longer digitally paired.	Reset pairing codes. (See detailed instructions on p. 10)
Noisy feedback (high-pitched “screech”)	Units too close together.	Be sure Parent Unit is at least 3 feet from Child Unit.
	Volume too high.	Lower volume setting on Parent Unit.
Parent unit has poor reception, static	Transmission channel has interference from another device	Turn off all units. Turn on Child unit then Parent units. This will allow Child unit to find a new clearer channel to broadcast on.
No sound or very weak reception	Unit is getting little or no power.	Parent Unit: Check power indicator light. If light is red, recharge batteries or plug in adapter. Child Unit: Make sure adapter is plugged in and outlet is receiving power.
	Out of range and connection indicator is flashing & beeping.	Move Parent Unit closer to Child Unit (and be sure Child Unit is turned on).
	Volume is set too low.	Raise volume setting on Parent Unit.
Battery in Parent Unit does not charge	AC adaptor is not plugged into correct jack	Plug must be plugged into AC adaptor jack (see “For plug-in-use” p. 5)
	Rechargeable battery pack has worn out from many uses	Contact our Parent Service Center 1-800-704-8697 to purchase a new battery pack
Nightlight on Child Unit does not turn on or off	Unit is not turned on.	Press and release power button.
	Unit is getting no power.	Make sure adapter is plugged in and outlet is receiving power. If running on battery power, the batteries are dead. Replace the batteries.
	Hand has not passed close enough to top of unit.	Try touching the top surface of unit near connection indicator.
Nightlight on Child Unit does not stay on	Unit is running on battery power.	While under battery power the nightlight will shut off after 30 seconds.

About Pairing Codes

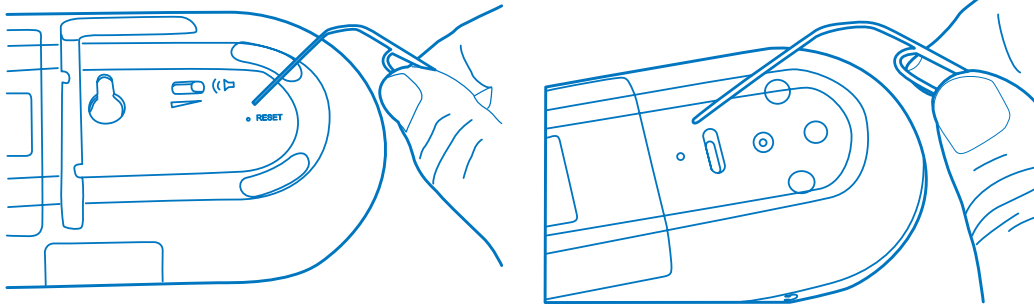

The Parent Unit(s) and Child Unit are digitally “paired” at the factory. This means they are digitally encrypted with the same electronic code so that they can securely communicate with each other and not be confused by the signals sent out by other electronic devices, such as cell phones or other monitors.

It is unlikely, but possible, that strong electronic interference, such as a power surge, could erase this coding. Should this occur, you can reset the pairing codes by following these steps.

To reset pairing codes:

1. Turn off the Parent Unit(s), and remove the belt clip/stand (use a small screwdriver to loosen the holding screw).
2. Turn off the Child Unit.
3. Position the two units close together (within 3 inches).
4. Insert the end of a paper clip into the reset hole on the Child Unit.
5. Turn on the Child Unit and immediately firmly push the paper clip down and hold. Release once both power and connection indicators start blinking. It is critical that both indicators are blinking. If this does not happen, repeat steps 2 - 5 again.
6. Turn on the Parent Unit.
7. Insert paper clip into the reset hole on the Parent Unit, firmly push the paper clip down and release.
8. Both Units will go into regular operation mode once pairing is complete.
If this does not happen repeat steps 1 - 7.
9. If you have P400, repeat steps 1-8 for second Parent Unit.

NOTE: This pairing operation could take up to 60 seconds.

If this operation does not restore monitor functionality, please contact Customer Service at 1-800-704-8697.

Care

To Clean:

Do not immerse the parent unit(s) or the child unit in water. Do not use cleaning spray or liquid cleaners.

1. Unplug the child and parent unit(s) if they are connected to a power source.
2. Clean the child and parent unit(s) with a damp cloth. Make sure they are dry before re-connecting them to a power source.
3. Unplug the adaptors and clean them with a dry cloth.
4. Dispose of used batteries in an environmentally friendly manner.
5. If the baby unit is connected to a power supply, check its batteries for leakage every six months.

Storage

When you are not going to use your True Choice™ monitor for some time, remove the alkaline batteries from the child unit and remove the rechargeable batteries from the parent unit(s). Store in a clean, dry place.

Proper Disposal

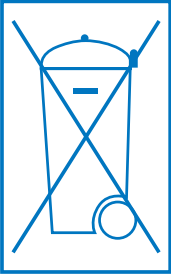

This symbol on the product or on its packaging indicates that this product shall not be treated as household waste. Instead it shall be handed over to the applicable collection point for the recycling of electrical and electronic equipment. By ensuring this product is disposed of correctly, you will help prevent potential negative consequences for the environment and human health, which could otherwise be caused by inappropriate waste handling of this product. The recycling of materials will help to conserve natural resources. For more detailed information about recycling of this product, please contact your local city officer, your household waste disposal service or the store where you purchased the product.

Limited Warranty

Our Limited Warranty and Warranty Period When we use the terms "we," "us" and "our," we are referring to Learning Curve Brands, Inc., and when we use the terms "you" and "your" we mean the original end-user customer. Our products are guaranteed to be free from defects in material and workmanship under normal and intended use for a period of 90 days from the date of your purchase.

Repair/Replacement If our product fails to meet our limited warranty during the warranty period, we will, at our option, repair or replace the product free of charge.

What Our Limited Warranty Does Not Cover We offer this limited warranty only when the product is used by the original end-user customer. We offer no other warranty. Additionally, while our warranty is excellent, there are other limits to it. We offer NO WARRANTY in cases of damage in transit, inadequate care, abuse, abnormal use, misuse, accidents, normal wear and tear, damage due to environmental or natural elements, failure to follow product instructions, immersion in water (except for products specifically identified by us in writing as intended for water use), battery leakage or improper storage or maintenance of the products.

Disclaimer of Other Warranties: THE EXPRESS WARRANTIES IN THE PRECEDING SECTION ARE EXCLUSIVE AND IN LIEU OF ALL OTHER WARRANTIES. However, to the extent applicable law does not permit disclaimers of certain implied warranties, such warranties are limited to the warranty period identified above. Some states and countries do not allow limitations on how long an implied warranty lasts, so the above limitations may not apply to you.

Limitation on Damages: IN NO EVENT SHALL WE BE LIABLE FOR INCIDENTAL, COMPENSATORY, PUNITIVE, CONSEQUENTIAL, INDIRECT, SPECIAL OR OTHER DAMAGES. OUR AGGREGATE LIABILITY WITH RESPECT TO DEFECTIVE PRODUCTS IS LIMITED TO THE MONIES PAID TO US FOR THE DEFECTIVE GOOD. Some states and countries do not allow the exclusion or limitation of incidental, consequential or other damages, so the above limitation or exclusion may not apply to you.

State Variations: This warranty gives you specific legal rights, and you may also have other rights which vary based on state, province or country.

Contact Us: If you have a warranty claim or request, any customer care questions, please contact via our website www.learningcurve.com or call us at 1-800-704-8697.

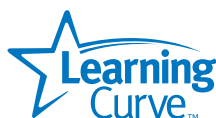

© 2010 Learning Curve Brands, Inc.
Oak Brook, IL 60523 U.S.A.
All Rights Reserved. Patent pending.
Made in China.
Y7445,Y7446. 03.18.10