

True Choice™ Digital Monitor

(A100 AND A200)

Note:

A100 comes with one Child Unit, one Parent Unit and two AC adaptors.

A200 comes with one Child Unit, two Parent Units and three AC adaptors.

Except for setting up (and using) the second Parent Unit, instructions for both models are the same.

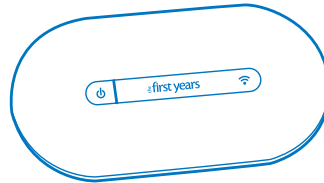

A100_A200 Child Unit

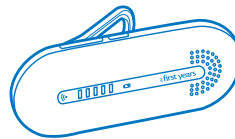

A100 Parent Unit

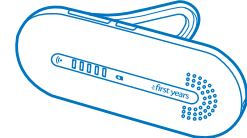
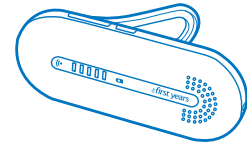

A200 Parent Units

QUICK START INSTRUCTIONS

You'll find detailed instructions inside.

Please read the safety instructions on page 2.

Set up the Parent Unit(s)

- For portable use: Install the 3 AAA batteries (not included). Battery compartment is located on the back of the unit. Loosen screw to release it, and lift cover off (for easier access, press on top of belt clip to hold it out of the way). Insert 3 AAA batteries aligning + and - symbols to match markings in battery box.

Tip: Use Alkaline batteries for longer use.

- For plug-in use: Connect one of the AC adapters provided

Set up the Child's Unit

- Place the Child Unit near your child (within 6 feet, but well beyond child's reach).
- Connect the remaining AC adaptor to the unit and plug into wall outlet

To Use:

- 1 Press and release power button ϕ to turn the Child Unit on and wait for connection indicator Ⓢ to blink.
- 2 Press and release the power button ϕ on the side of the Parent Unit to turn it on.
- 3 Connection indicators on all units should glow blue indicating connection.
- 4 Press [+] or [-] to adjust volume of Parent Unit(s).
- 5 Keep the Parent Unit within hearing distance.

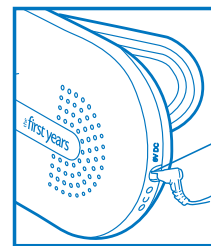

AC jack adaptor

Before returning this product to the store for any reason, please contact our Parent Service Center at 1-800-704-8697 or www.learningcurve.com. Often, we can provide helpful tips and instructions to resolve your problem quickly over the phone or by e-mail.

⚡ ⚠ WARNING:

- To prevent electric shock or strangling by the cord, do not place the monitor in, or attach it to, a crib or playpen.
- Never place these units within a child's reach.
- The product is designed to assist in the monitoring of children, not as prevention for injury to or loss of a child.
- This product is not a substitute for proper adult supervision. All children should be supervised at all times by responsible adults.

Model: Y7443C, Y7444C
Model: Y7443P, Y7444P

Questions? Comments?
Contact Consumer Care
www.learningcurve.com
800-704-8697

Safety Instructions



This symbol is intended to warn the user of potential safety hazards.



This symbol is intended to alert the user to a potential risk of electric shock and other electrical safety issues.



WARNING:

To reduce the risk of fire or electrical shock, do not open this product or expose this product to:

Water And Moisture: This product should not be used near water, for example, near a bathtub or sink, in a wet basement or near a swimming pool.

Heat: This product should be situated away from heat sources such as radiators, heat registers, stoves, or other appliances that produce heat.

IMPORTANT:

- The user should not attempt to service this product. Read all safety and operating instructions before operating this product.
- Retain these instructions for future reference.
- Observe all warnings.
- Follow all operating instructions.
- Do not tamper with the plug under any circumstances.
- Power Source - This product should be connected only to the power supply provided.
- Cleaning - Before cleaning, be sure to unplug. Clean only as recommended in these instructions.
- Object And Liquid Entry - Care should be taken so that objects do not fall and liquids are not spilled into the enclosure through the openings.
- Damage Requiring Service - This product should be serviced by qualified service personnel when:
 - a. The power supply cord or plug has been damaged
 - b. Objects have fallen or liquid has been spilled into it
 - c. The product has been exposed to rain
 - d. The product does not appear to operate normally or exhibits a marked change in its performance
 - e. The product has been dropped or the enclosure damaged.

**Refer All Servicing To A Qualified First Years® Technician
(Call 1-800-704-8697 if you believe your unit needs service).**

Wall Mounting - The Child Unit should be mounted to a wall only as recommended in these instructions.



WARNING:

Do not mount the Child Unit in a location where the unit and the adaptor cord is within the child's reach.

WARNING: Changes or modifications to this unit not expressly approved by the party responsible for compliance could void the user's authority to operate equipment.

NOTE: This equipment has been tested and found to comply with the limits for a Class B digital device, pursuant to Part 15 of the FCC Rules. These limits are designed to provide reasonable protection against harmful interference in a residential installation. This equipment generates, uses and can radiate radio frequency energy and, if not installed and used in accordance with the instructions, may cause harmful interference to radio communications.

However, there is no guarantee that interference will not occur in a particular installation. If this equipment does cause harmful interference to radio or television reception, which can be determined by turning the equipment off and on, the user is encouraged to try to correct the interference by one or more of the following measures:

- Reorient or relocate the receiving antenna.
- Increase the separation between the equipment and receiver.
- Connect the equipment into an outlet on a circuit different from that to which the receiver is connected.
- Consult the dealer or an experienced radio/TV technician for help.

This device complies with part 15 of the FCC Rules. Operation is subject to the following two conditions: (1) this device may not cause harmful interference, and (2) this device must accept any interference received, including interference that may cause undesired operation.

These devices comply with FCC and Industry Canada RF radiation exposure limits set forth for general population. They must not be operated when co-located with any other antenna or transmitter.

Caution: To maintain the compliance with the FCC's RF exposure guideline, place the baby unit at least 20 cm from nearby persons.

For body worn operation, Parent Unit has been tested and meets the FCC RF exposure guidelines when used with the TOMY International, Inc. or Telefield Limited accessories supplied or designated for this product. Use of other accessories may not ensure compliance with FCC RF exposure guidelines.

Contents and Features

Child Unit, Parent Unit(s) and AC Adapter

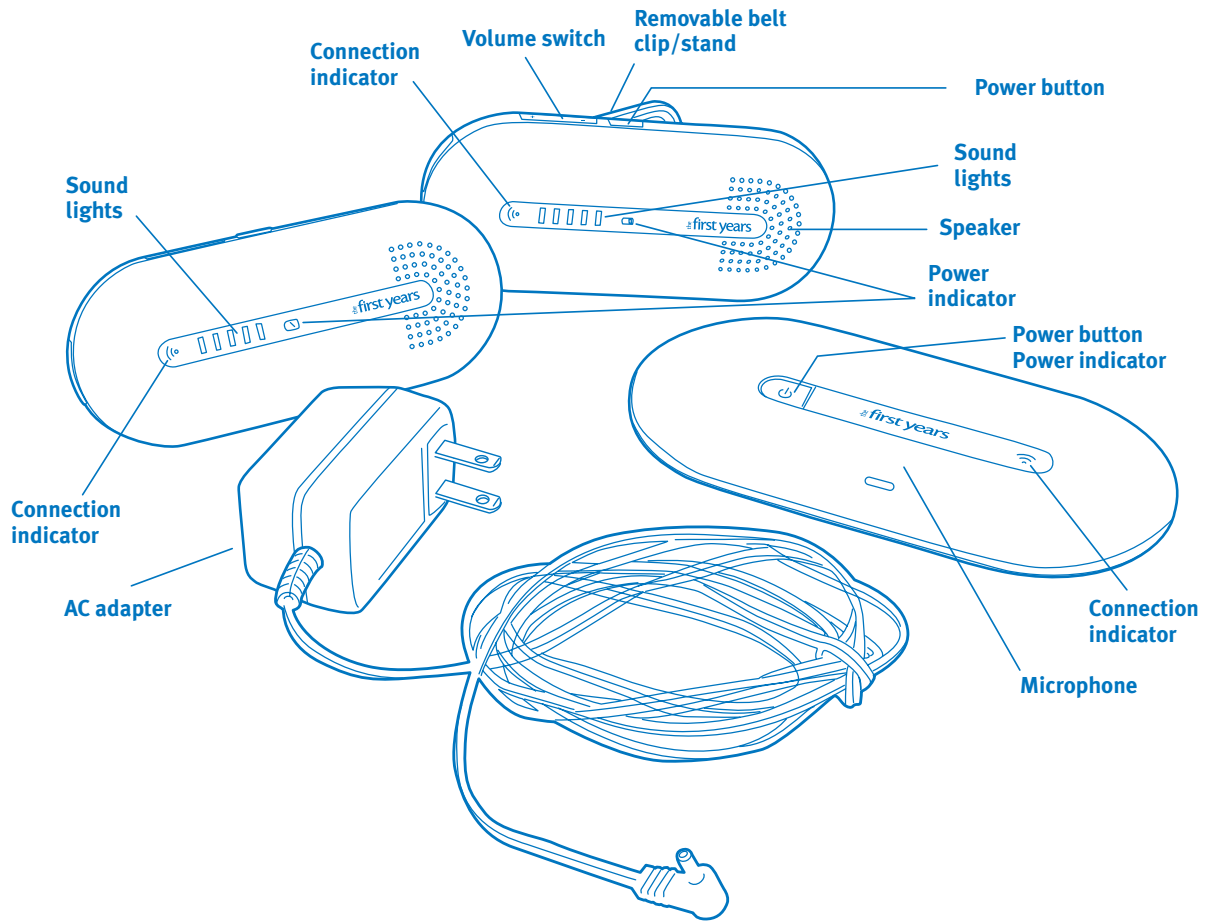

Parent Units

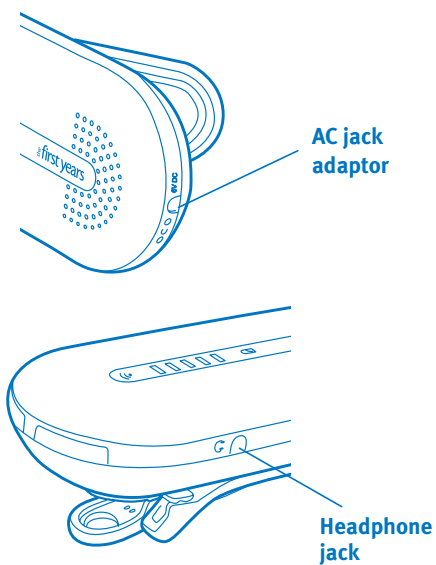

Child Unit

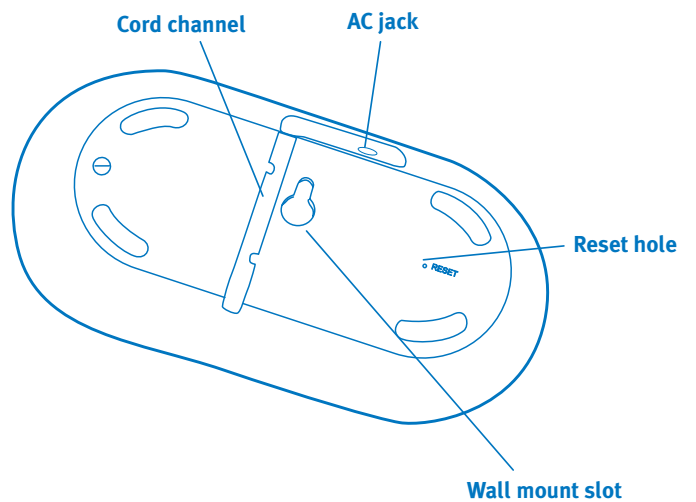

To Set Up - Child Unit

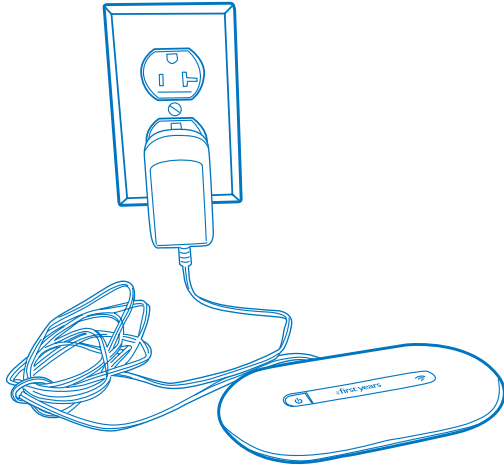

1. Position the Child Unit within 4 to 6 feet of your child. NEVER position the unit within a child's reach.
2. Insert the connector on the AC adapter into the jack on the back of the unit, then plug the adapter into an electrical outlet.

For wall mounting (optional)

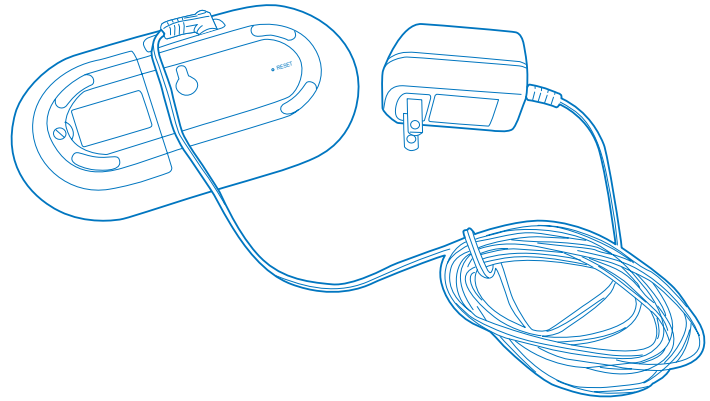

1. Press the adapter cord into the grooved channel on the back of the unit, making certain to slide it under the two holding clips.
2. Securely fasten a #8 "pan" head screw to the wall, leaving the screw head protruding by at least 1/4 inch. For best results use a 3/4-inch long screw; mount in a solid wood panel, or use a screw anchor.
3. Fit the round opening on the wall mount slot over the screw head, then slide the unit down until it is seated firmly.
4. To test that unit is securely mounted: press on its top and side edges.

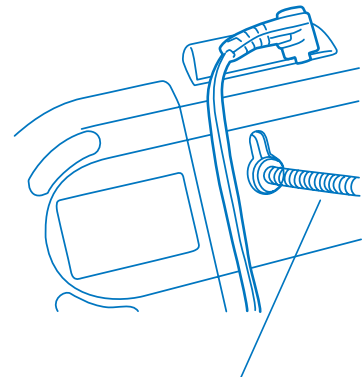

#8 "pan" head screw

WARNING:

Do not place Child Unit in crib or attach to crib or playpen.

WARNING:

Do not mount the Child Unit in a location where the unit or the adaptor cord is within the child's reach.

To Set Up - Parent Unit(s)

To install batteries

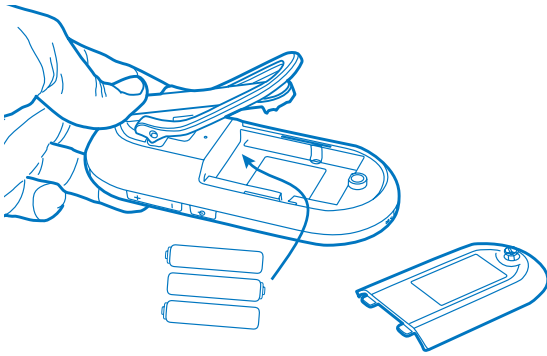

1. Loosen the screw to release the battery compartment cover. Then, lift the cover off. (For easier access, press on the top of the belt clip/stand to hold it out of the way.)

2. Insert 3-AAA batteries into battery compartment. Position the batteries so that + and – symbol match markings in the battery compartment.

Tip: It is easier to install + end of battery first, then push – end into place.

3. Place the cover back onto the battery compartment and secure it by tightening the screw.

Tip: We recommend alkaline batteries for longer life.

For plug-in use

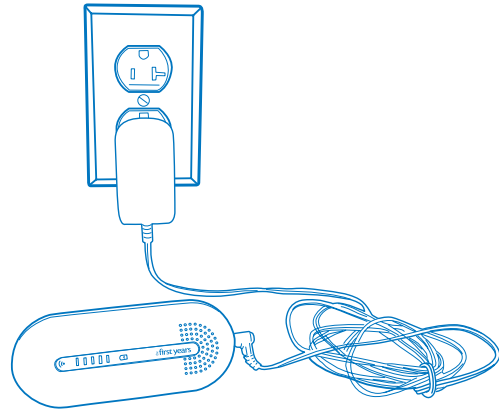

Connect the Parent Unit to the AC adapter and plug the adapter into an electrical outlet. If desired, open stand to support unit in an upright position.

IMPORTANT: Use only the AC adapters supplied with this product. Use of any other adapter(s) could damage Monitor and would void warranty.

- Product is not intended for use by children under 3 years old;
- Product must only be used with the supplied AC adaptor;
- AC adaptor is not a toy;
- AC adaptor should be regularly examined for damage to the cord, plug, enclosure or other parts, and in the event of such damage, it must not be used until the AC adaptor has been replaced.

To obtain replacement AC adaptor: please call our Parent Service Center at 800-704-8697.



WARNING:

Batteries may explode or leak if not used correctly. Follow all instructions for proper installation, use and storage.

To Use

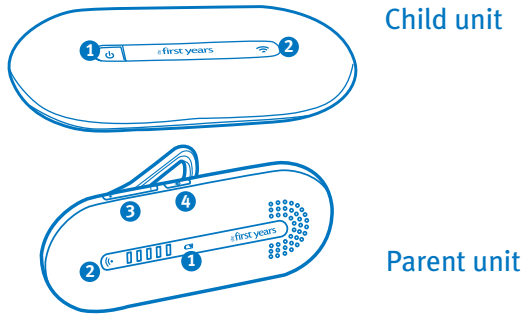

1. Press and release the power button ❶ on the Child unit to turn it on and wait for the connection indicator ❷ to blink.
2. Press and release the power button ❹ on the Parent Unit to turn it on.
3. Be certain that Power ❶ and Connection ❷ Indicators on both units are glowing blue.
4. For A200, perform steps 2 and 3 to turn on the second Parent Unit.
5. On the Parent Unit, press ❸ + and/or - to adjust volume to the desired level.
6. Keep the Parent Unit within hearing distance.

TIP: A loud screeching sound will occur if Parent Unit at a high volume level is brought close to the Child Unit. This is feedback that is common with audio devices. To avoid this it is best to either lower the volume or shut off the Parent Unit when entering the Child's room .

To turn Parent Unit off: Press and release ❹ power button.

To turn Child Unit off: Press and release ❶ power button.

Note: Turning units off conserves battery power.

Important: Power indicator on the Parent Unit will turn red when battery power is low. Batteries should be replaced as soon as possible. Follow instructions under "To Set Up." [Page 5]

Range

The distance you can separate the units and still maintain a connection will vary based on the layout and construction of your home. To test the Monitor's workable range, walk through your house and yard listening for the volume and clarity of the sounds being transmitted.

Out of range warning: If the Parent Unit is taken to a location where the connection with the Child Unit is lost, the Connection Indicator will **flash** and the unit will **beep** after 5 seconds. This warning will stop when unit is brought back into range.

Belt Clip/Stand

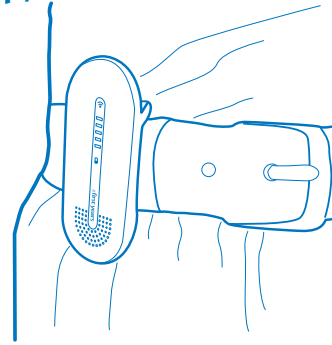

Press on the top of the belt clip to open; slide it onto waistband or belt and release.

Or, lift the tip of the stand away from the unit, and set the unit on any flat surface.

TIP: Belt clip/stand can be removed from the Parent Unit to give you a smaller unit that is easy to slip in your pocket.

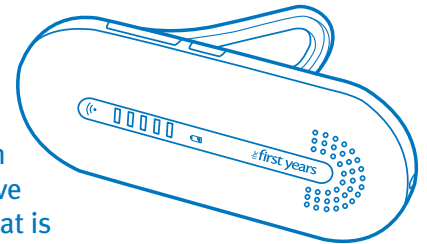

Headphone Use

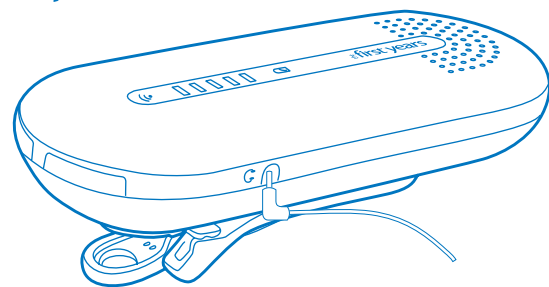

You may connect a headphone (not supplied) to the Parent Unit, if desired. When headphone is used, sound will not come out of the speaker.

Finder Feature

If you should misplace the Parent Unit, turn off the Child Unit. Wait 5 seconds, and the Parent Unit will begin to beep and will continue beeping until it is found and turned off (or batteries are exhausted). Turn Child Unit on before turning the Parent Unit back on.

Note: This feature will not work if Parent Unit is turned off or has lost power.

To Use (continued)

Lights

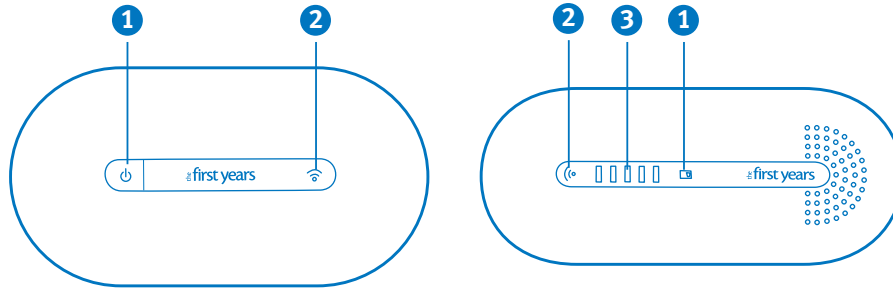

Here's how to interpret the lights on the Parent Unit(s) and the Child Unit:

1 Power Indicator

Blue Light

Unit is on.

Red Light

(Parent Unit(s) only)

Batteries are weak and need to be replaced.

Remove dead batteries from parent unit(s) immediately.
(See "To install batteries," p. 5)

No Light

Unit is off or no power. See "Troubleshooting."

2 Connection Indicator on Parent Unit(s)

Blue light

Unit is securely linked to the Child Unit.

Flashing blue

(Unit is also beeping.) Units are not linked, therefore Parent Unit is not able to receive sounds from the Child Unit. See "Troubleshooting."

No Light

Unit is off or batteries are dead and AC adapter is not connected.
See "Troubleshooting."

3 Sound Lights – Parent Unit(s) only

The more lights, the louder the sounds coming from baby's location.

No lights

No sound (baby is quiet).

One, two, or

three Green lights

Soft sounds (baby may be fussing or vocalizing softly).

One or two Red lights

Louder sounds (baby may be crying or vocalizing loudly).

To Use (continued)

Replacing Batteries

Parent Unit(s):

If Power indicator on the Parent Unit(s) glows red instead of blue when unit is turned on, batteries are low.

If indicator does not light at all, batteries are dead. Replace batteries following instructions under “To Set Up-Parent Unit(s) p.5”.

Care

To Clean:

Do not immerse the parent unit(s) or the child unit in water. Do not use cleaning spray or liquid cleaners.

1. Unplug the child and parent unit(s) if they are connected to a power source.
2. Clean the child and parent unit(s) with a damp cloth. Make sure they are dry before re-connecting them to a power source.
3. Unplug the adaptors and clean them with a dry cloth.
4. Dispose of used batteries in an environmentally friendly manner.

Storage

When you are not going to use your True Choice™ monitor for some time, remove the alkaline batteries from the parent unit(s). Store in a clean, dry place.



WARNING:

Keep batteries away from children. Parents are urged to exercise care in the storage, use and disposal of all batteries. Do not dispose of batteries in a fire. They may explode.

To avoid battery leakage:

- Be sure to insert batteries correctly following instructions. Do not put batteries in backwards; positive (+) and negative (-) ends must face the proper direction.
- Do not mix old and new batteries.
- Do not mix alkaline, standard(carbon-zinc), or rechargeable(nickel-cadmium) batteries.
- Always remove exhausted batteries from the product.
- Never use a screwdriver or any other tool to pry batteries from the compartment, as the supply terminals may be short-circuited.
- Do not leave batteries in the monitor for long periods of non-use.

Failure to follow these instructions may cause batteries to make “popping” sounds and leak battery acid, which could result in personal injury and damage to the monitor. If battery leakage occurs, avoid all contact with battery acid, being especially careful to keep it away from eyes and mouth. Should contact occur, wash any affected skin and clothing thoroughly.

Troubleshooting

PROBLEM	POSSIBLE CAUSE	SOLUTION
No power (No lights on unit)	Parent Unit: Unit is not turned on.	Press and release power button.
	Batteries are dead.	Replace batteries (See “To Set Up- Parent Unit(s) p.5”), or plug in adapter.
	AC adaptor is not plugged into correct jack	Plug must be plugged into AC adaptor jack (see “For plug-in use” p. 5)
	Child Unit: Unit is not turned on.	Press and release power button.
	Adapter not plugged in.	Plug in adapter.
	Adapter plugged into outlet that’s turned off.	If outlet is controlled by a wall switch, be sure switch is turned on.
No connection (Connection indicator flashing)	Parent Unit is too far from Child Unit, (out of range).	Move Parent Unit closer to Child Unit.
	Child Unit is turned off.	Turn on the Child Unit. Connection indicator on all units should stop blinking and glow blue. If this does not happen, pairing may need to be reset. (see detailed instructions on p. 10).
	AC adapter is not plugged into Child Unit.	Plug in the AC adapter.
	Parent Unit has temporary lost connection to Child Unit.	Reset system by turning off all units and restart them (See “To Use” p.6)
	Units are no longer digitally paired.	Reset pairing codes. (See detailed instructions on p. 10)
Noisy feedback (high-pitched “screech”)	Units too close together.	Be sure Parent Unit is at least 3 feet from Child Unit.
	Volume too high.	Lower volume setting on Parent Unit.
Parent unit has poor reception, static	Transmission channel has interference from another device	Turn off all units. Turn on Child unit then Parent units. This will allow Child unit to find a new clearer channel to broadcast on.
No sound or very weak reception	Unit is getting little or no power.	Parent Unit: Check power indicator light. If light is red, replace batteries or plug in adapter. Child Unit: Make sure adapter is plugged in and outlet is receiving power.
	Out of range. - Connection indicator is flashing & beeping.	Move Parent Unit closer to Child Unit (and be sure Child Unit is turned on).
	Volume is set too low.	Raise volume setting on Parent Unit.

About Pairing Codes

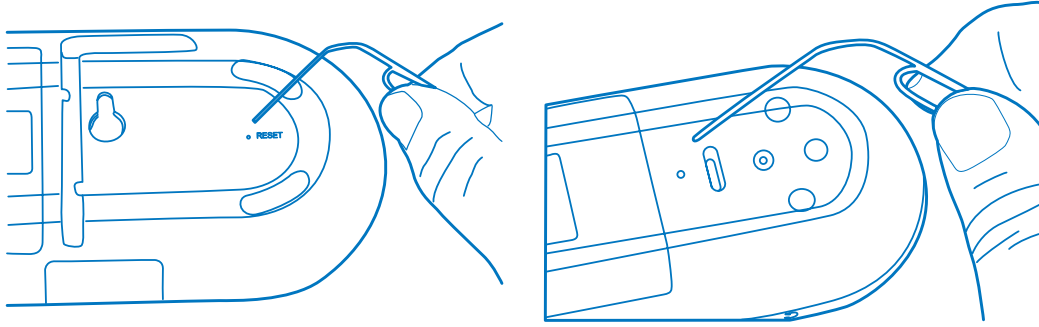

The Parent Unit(s) and Child Unit are digitally “paired” at the factory. This means they are digitally encrypted with the same electronic code so that they can securely communicate with each other and not be confused by the signals sent out by other electronic devices, such as cell phones or other monitors. It is unlikely, but possible, that strong electronic interference, such as a power surge, could erase this coding. Should this occur, you can reset the pairing codes by following these steps:

To reset pairing codes:

1. Turn off the Parent Unit, and remove the belt clip/stand (use a small screwdriver to loosen the holding screw).
2. Turn off the Child Unit.
3. Position the two units close together (within 3 inches).
4. Insert the end of a paper clip into the reset hole on the Child Unit.
5. Turn on the Child Unit and immediately firmly push the paper clip down and hold. Release once both power and connection indicators start blinking. It is critical that both indicators are blinking. If this does not happen, repeat steps 2 - 5 again.
6. Turn on the Parent Unit.
7. Insert paper clip into the reset hole on the Parent Unit, firmly push the paper clip down and release.
8. Both Units will go into regular operation mode once pairing is complete.
If this does not happen repeat steps 1 - 7.
9. If you have A200, repeat steps 1-8 for second Parent Unit.

NOTE: This pairing operation could take up to 60 seconds.

If this operation does not restore monitor functionality, please contact Customer Service at 1-800-704-8697.

Proper Disposal

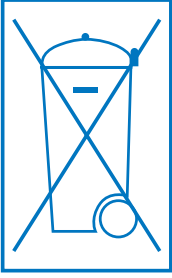

This symbol on the product or on its packaging indicates that this product shall not be treated as household waste. Instead it shall be handed over to the applicable collection point for the recycling of electrical and electronic equipment. By ensuring this product is disposed of correctly, you will help prevent potential negative consequences for the environment and human health, which could otherwise be caused by inappropriate waste handling of this product. The recycling of materials will help to conserve natural resources. For more detailed information about recycling of this product, please contact your local city officer, your household waste disposal service or the store where you purchased the product.

Limited Warranty

Our Limited Warranty and Warranty Period When we use the terms "we," "us" and "our," we are referring to Learning Curve Brands, Inc., and when we use the terms "you" and "your" we mean the original end-user customer. Our products are guaranteed to be free from defects in material and workmanship under normal and intended use for a period of 90 days from the date of your purchase.

Repair/Replacement If our product fails to meet our limited warranty during the warranty period, we will, at our option, repair or replace the product free of charge.

What Our Limited Warranty Does Not Cover We offer this limited warranty only when the product is used by the original end-user customer. We offer no other warranty. Additionally, while our warranty is excellent, there are other limits to it. We offer NO WARRANTY in cases of damage in transit, inadequate care, abuse, abnormal use, misuse, accidents, normal wear and tear, damage due to environmental or natural elements, failure to follow product instructions, immersion in water (except for products specifically identified by us in writing as intended for water use), battery leakage or improper storage or maintenance of the products.

Disclaimer of Other Warranties: THE EXPRESS WARRANTIES IN THE PRECEDING SECTION ARE EXCLUSIVE AND IN LIEU OF ALL OTHER WARRANTIES. However, to the extent applicable law does not permit disclaimers of certain implied warranties, such warranties are limited to the warranty period identified above. Some states and countries do not allow limitations on how long an implied warranty lasts, so the above limitations may not apply to you.

Limitation on Damages: IN NO EVENT SHALL WE BE LIABLE FOR INCIDENTAL, COMPENSATORY, PUNITIVE, CONSEQUENTIAL, INDIRECT, SPECIAL OR OTHER DAMAGES. OUR AGGREGATE LIABILITY WITH RESPECT TO DEFECTIVE PRODUCTS IS LIMITED TO THE MONIES PAID TO US FOR THE DEFECTIVE GOOD. Some states and countries do not allow the exclusion or limitation of incidental, consequential or other damages, so the above limitation or exclusion may not apply to you.

State Variations: This warranty gives you specific legal rights, and you may also have other rights which vary based on state, province or country.

Contact Us: If you have a warranty claim or request, any customer care questions, please contact via our website www.learningcurve.com or call us at 1-800-704-8697.

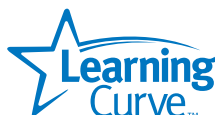

© 2010 Learning Curve Brands, Inc.
Oak Brook, IL 60523 U.S.A.
All Rights Reserved. Patent pending.
Made in China.
Y7443,Y7444. 03.18.10