



### 5-Year Limited Warranty

The Coleman Company, Inc. ("Coleman") warrants that for a period of five years from the date of original retail purchase, this product will be free from defects in material and workmanship. Coleman, at its option, will repair or replace this product or any component of the product found to be defective during the warranty period. Replacement will be made with a new or remanufactured product or component. If the product is no longer available, replacement may be made with a similar product of equal or greater value. No warranty is provided for batteries and light bulbs. This is your exclusive warranty.

This warranty is valid for the original retail purchaser from the date of initial retail purchase and is not transferable. Keep the original sales receipt. Proof of purchase is required to obtain warranty performance. Coleman dealers, service centers or retail stores selling Coleman® products do not have the right to alter, modify or in any way change the terms and conditions of this warranty.

### What This Warranty Does Not Cover

This warranty does not cover normal wear of parts, parts that are not genuine Coleman® parts, or damage resulting from any of the following: negligent use or misuse of the product; use on improper voltage or current; commercial use of the product; use contrary to the operating instructions or disassembly, repair or alteration by anyone other than Coleman or an authorized service center. Further, the warranty does not cover Acts of God, such as fire, flood, hurricanes and tornadoes. Warranty void if damage to product results from the use of a part other than a genuine Coleman® part.

**COLEMAN SHALL NOT BE LIABLE FOR DEFECTS THAT ARE CAUSED BY THE USE OF UNAUTHORIZED PARTS OR SERVICE. COLEMAN SHALL NOT BE LIABLE FOR ANY INCIDENTAL OR CONSEQUENTIAL DAMAGES CAUSED BY THE BREACH OF ANY EXPRESS OR IMPLIED WARRANTY OR CONDITIONS. EXCEPT TO THE EXTENT PROHIBITED BY APPLICABLE LAW, ANY IMPLIED WARRANTY OF MERCHANTABILITY OR FITNESS FOR A PARTICULAR PURPOSE IS LIMITED IN DURATION TO THE DURATION OF THE ABOVE WARRANTY OR CONDITIONS. SOME STATES, PROVINCES, OR JURISDICTIONS DO NOT ALLOW THE EXCLUSION OR LIMITATION OF INCIDENTAL OR CONSEQUENTIAL DAMAGES OR LIMITATIONS ON HOW LONG AN IMPLIED WARRANTY LASTS, SO THE ABOVE LIMITATIONS OR EXCLUSION MAY NOT APPLY TO YOU. THIS WARRANTY GIVES YOU SPECIFIC LEGAL RIGHTS, AND YOU MAY ALSO HAVE OTHER RIGHTS THAT VARY FROM STATE TO STATE OR PROVINCE TO PROVINCE.**

### How to Obtain Warranty Service

Take the product to an authorized Coleman service center.

You can find the nearest authorized Coleman service center by visiting [www.coleman.com](http://www.coleman.com) or calling 1-800-835-3278 or TDD 316-832-8707 in the United States or 1 800 387-6161 in Canada. If a service center is not conveniently located, attach to the product a tag that includes your name, address, daytime telephone number and description of the problem. Include a copy of the original sales receipt. Carefully package the product and send either by **courier** or **insured mail** with shipping and insurance prepaid to:

### For products purchased in the United States:

The Coleman Company, Inc.  
3600 North Hydraulic  
Wichita, KS 67219

### For products purchased in Canada:

Sunbeam Corporation (Canada) Limited  
DBA Jarden Consumer Solutions  
5975 Falbourne Street  
Mississauga, Ontario, Canada L5R 3V8

The costs of transporting the product to Coleman or an authorized service center for warranty service is the responsibility of the purchaser.

### DO NOT RETURN THIS PRODUCT TO THE PLACE OF PURCHASE.

If you have any questions regarding this warranty please call 1-800-835-3278 or TDD 316-832-8707 in the United States or 1 800 387-6161 in Canada.



©2006 The Coleman Company, Inc. All rights reserved.

Coleman®, , and are registered trademarks of The Coleman Company, Inc.

11/2006

COLEMAN® TENT LIGHTING SYSTEM / ÉCLAIRAGE DE TENTE COLEMAN®



## How to Use and Enjoy Your Coleman

# TENT LIGHTING SYSTEM

## Profitez au maximum de ce système Coleman® SYSTÈME D'ÉCLAIRAGE DE TENTE



Model 830-500 Series  
Modèle de la série 830-500

COLEMAN® TENT LIGHTING SYSTEM / ÉCLAIRAGE DE TENTE COLEMAN®

Carefully read all instructions before use and save for future reference.

### TO INSTALL OR REPLACE POWER PACK BATTERIES

Your new Coleman® Tent Lighting System operates on 8 "D" cell batteries. For longest life use alkaline batteries.

1. If Red Button on front of battery pack is glowing, push button to turn power "OFF". (Fig. 1)
2. Turn battery pack over and place coin into slot and rotate to unlock. (Fig. 2)
3. Lift up lid and install 8 batteries in the correct orientation as shown on the battery compartment. Always be careful that batteries are installed correctly. (Fig. 3)
4. Close lid, insert coin into slot and rotate to locked position.
5. Place battery pack in pocket sewn into side of tent. (Fig. 4)

**NOTE:** Never operate tent light if battery pack is not stored in upright position, with red button facing outward, in pocket.

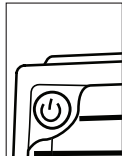

Fig. 1

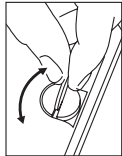

Fig. 2

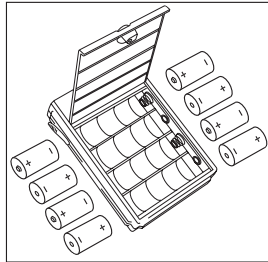

Fig. 3

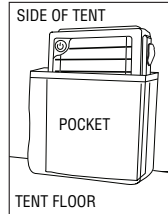

Fig. 4

### TO CHANGE FLUORESCENT TUBE

**NOTE:** This tent light uses one 15-watt fluorescent spiral tube (See Parts List for replacement part #). Fluorescent spiral tubes are very fragile. Handle with care.

1. Make sure power pack light is turned "OFF" and red button is not glowing.
2. Grasp globe on tent light and turn clockwise to remove. (Fig. 5)
3. Gently press down on fluorescent spiral tube and turn counterclockwise until both alignment tabs are visible in locating slots of housings. Remove tube. (Fig. 6)
4. Install new fluorescent spiral tube by placing alignment tabs in locating slots of reflector. Gently push down and rotate clockwise until secure.
5. Reattach globe to light housing by turning counterclockwise until tightened. Do not overtighten.

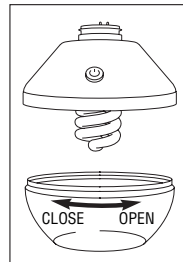

Fig. 5

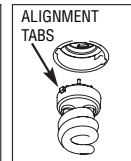

Fig. 6

### TO REPLACE REMOTE CONTROL BATTERY

**NOTE:** Remote control feature is not available on all versions of this Coleman® Tent Lighting System.

1. Remove 4 screws from back of transmitter and install one 12v, 23AE alkaline battery. (Fig. 7)
2. Reassemble transmitter.

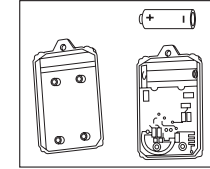

Fig. 7

This device complies with Part 15 of the FCC Rules. Operation is subject to the following two conditions: (1) This device may not cause harmful interference, and (2) This device must accept any interference received, including interference that may cause undesired operation.

**Warning:** Changes or modifications to this unit not expressly approved by the party responsible for compliance could void the user's authority to operate this equipment.

This device complies with Part 18 of the FCC Rules.

**NOTE:** This equipment has been tested and found to comply with the limits for a Class B digital device, pursuant to Part 15 of the FCC Rules. These limits are designed to provide reasonable protection against harmful interference in a residential installation. This equipment generates, uses and can radiate radio frequency energy and, if not installed and used in accordance with the instructions, may cause harmful interference to radio communications.

However, there is no guarantee that interference will not occur in a particular installation. If this equipment does cause harmful interference to radio or television reception, which can be determined by turning the equipment off and on, the user is encouraged to try to correct the interference by one or more of the following measures:

- Reorient or relocate the receiving antenna.
- Increase the separation between equipment and receiver.
- Connect the equipment into an outlet on a circuit different from that which the receiver is needed.
- Consult the dealer or an experienced radio/TV technician for help.

**Note:** This product may cause interference to radio equipment and should not be installed near maritime safety communications equipment or other critical navigation or communication equipment operating between 0.45-30 MHz.

**The Responsible Party information as below:**

• Applicant name in full: The Coleman Company, Inc.

• Address: 3600 N. Hydraulic, Wichita, KS 67219

• Contact in USA: Rex Weigand / Director of Product Safety & Compliance

• Phone: (316) 832-3056

• Fax: (316) 832-6193

• Email address: RWWeigand@coleman.com

### TO OPERATE TENT LIGHT

1. Screw tent light into socket at top of tent by turning clockwise. (Fig. 8)
2. Unsnap rubber plug from side of power pack and plug the power cord that was installed in your tent into the power pack. (Fig. 9)
3. Push the red button on the power pack to turn on main power. The button on the power pack and the tent light will glow when main power is "ON". (Fig. 9)
4. Push red button on tent light: a) once for "HIGH" light setting, twice for "LOW" light setting, a third time will turn light "OFF". (Fig. 10)

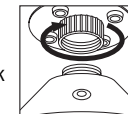

Fig. 8

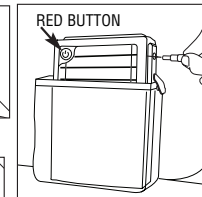

Fig. 9

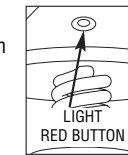

Fig. 10

### TO OPERATE TENT LIGHT WITH REMOTE CONTROL

1. Push the red button on the power pack to turn on main power. The button on the power pack and the tent light will glow when main power is "ON". (Fig. 10)
2. Push the button on the remote control transmitter: a) once for "HIGH" light setting, twice for "LOW" light setting, a third time will turn light "OFF". (Fig. 11)

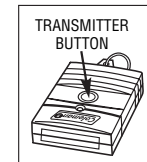

Fig. 11