

# Connections

## TFT Touch Screen

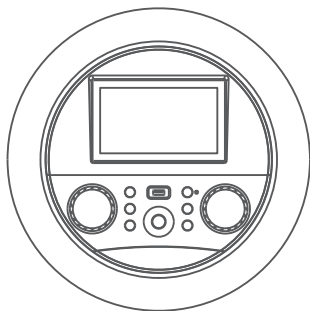

The TFT touch screen will be switched on automatically when the unit is powered on.

---

## Lights Mode

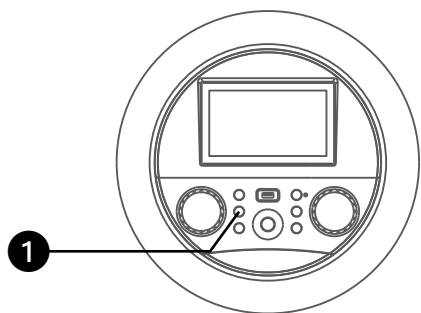

There are nine Light modes. Repeatedly press the  (**LIGHTS**) button to select a mode as follows:

**Light Mode 1~6:** The unit will synchronize to the music being played.

**Light Mode 7~8:** The unit will light up with random colors and patterns.

**Light Mode 9:** The light effects will be turned off.

---

# Energy Saving (Auto Power System-APS)

This unit will automatically turn to Screen Saver mode after 10 minutes of inactivity, and automatically turn off after 15 minutes. The unit can be powered back on by pressing the  ON/STANDBY button once. APS is for energy saving purposes.

**Note:** You can change the energy saving setting in the Wi-Fi & Setting option, see the section of **Wi-Fi & setting**.

# Operation

## WiFi & Settings

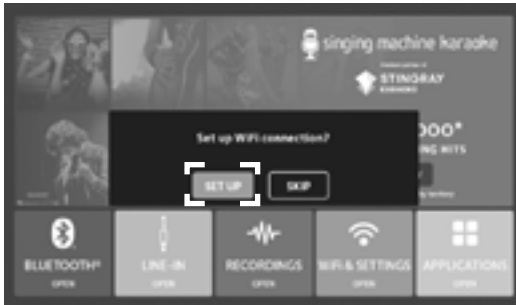

1 Connect the unit as described previously. Press the **⏻ (ON/STANDBY)** button to turn the unit on. The set up Wi-Fi connection window will pop up. Select **SET UP** icon on the touch screen or **▶|| (PLAY/PAUSE/ENTER)** button on the control panel.



2 Select your Wi-Fi network using the touch screen or **▲/▼** Navigation buttons on the control panel.

**Note:** This unit supports 2.4GHz WiFi only.

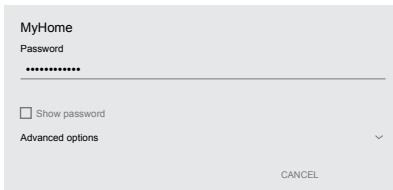

3 Use the keyboard on the touch screen to enter your WiFi password and press the **ENTER** button. **“Connected”** will appear if the connection is successful. If unsuccessful, check your password and Wi-Fi frequency and re-connect again.



4 Press the **↵ (RETURN)** button on the control panel to go back to the previous screen.

5 Press the **🏠 (HOME)** button on the control panel to go to the home screen. Press and hold the **🏠 (HOME)** button to go to menu.

# Operation

## WiFi & Settings



6 You can always change the Wi-Fi network, by selecting the **Wi-Fi & SETTINGS** icon on the touch screen or by using the ▲/▼ ►|| **(PLAY/PAUSE/ENTER)** button on the control panel to enter the WiFi settings mode.

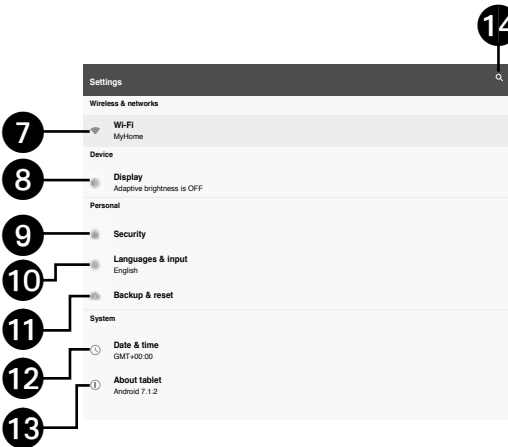

7 Select **Wi-Fi** and connect as previously described, if you want to connect another network.

8 To adjust the brightness, sleep time, font size, display size of touch screen, and HDMI, select **Display**.

9 This unit has a setting to block installing unknown apps, you can turn it on or off from **Security**.

10 Select **LANGUAGES & INPUT** to change the Languages & Input.

11 Select to reset this unit to factory settings.

12 Select to set the date and time.

13 Select to check the version of this unit.

14 Select to search the settings.

# Operation

## Accessing the Singing Machine Karaoke Catalog

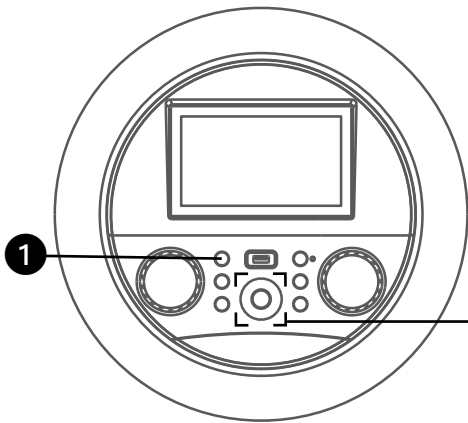

- 1 Connect the unit as described previously. Press the **⏻ (ON/STANDBY)** button to turn the unit on. The function indicator will light up.



- 2 **Singing Machine Karaoke** icon using the touch screen or **◀/▶/▲/▼** Navigation and **▶|| (PLAY/PAUSE/ENTER)** buttons to enter Singing Machine Karaoke Store page.



- 3 Select **"Sign up"** and follow the on screen instructions to register your machine.
- 4 After signing up, select "Log In" to log into your account. Select Singing Machine Karaoke icon at home screen to go to the Singing Machine Karaoke Store home screen directly.
- 5 Select your favorite songs using the touch screen to playback.

# Operation

## Accessing the Singing Machine Karaoke Catalog (Continued)

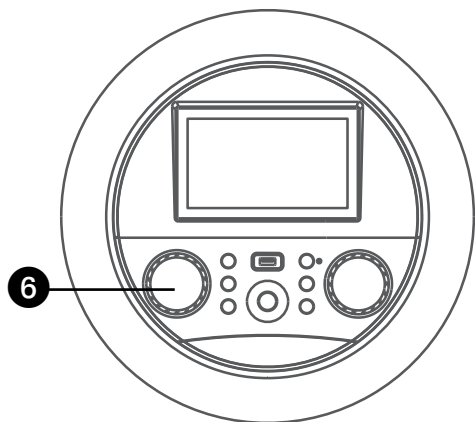

- 6 Adjust the **MUSIC VOLUME** control as desired.

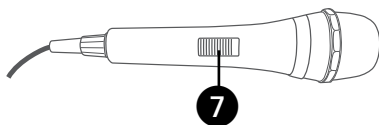

- 7 Connect the microphone(s) and slide the **ON/OFF** switch on the microphone to the ON position.

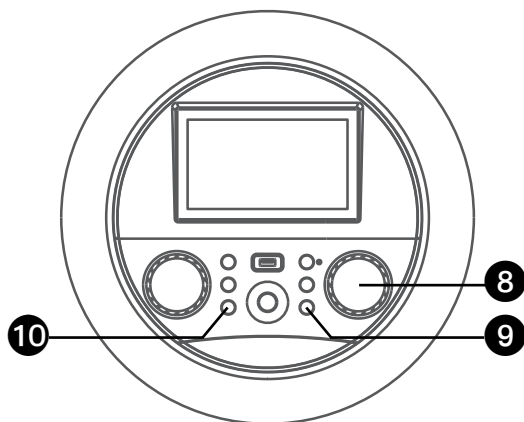

- 8 Adjust the **MIC VOLUME/ECHO** control as desired. Increasing this control will increase the volume of both microphones. Press then rotate the **MIC VOLUME/ECHO** control as desired to add an echo effect to your voice. Rotate towards **MAX** to increase the echo.

- 9 Press **↩ (RETURN)** button to go back to the previous screen.

- 10 Press **⬆ (HOME)** button to go to the home screen while in any mode or screen. Press and hold the **⬆ (HOME)** button to go to menu.

# Operation

## Accessing the Singing Machine Karaoke Catalog (Continued)

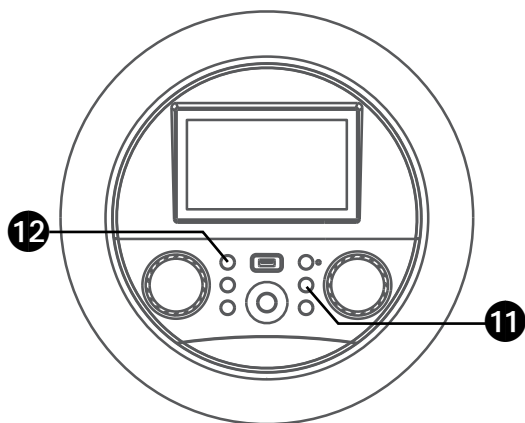

### RECORD YOUR VOCAL PERFORMANCE:

- 11** To record your singing as well as the music, press the **● (RECORD)** button. Recording will begin and the recording indicator will display on-screen and the function indicator will begin flashing red. When done recording, press the **● (RECORD)** button again; the function indicator will stop flashing.

#### Notes:

- You cannot start recording until the USB drive is inserted.
- Insert the USB flash drive into the USB slot on the unit with the face towards the top of the unit.

- 12** Press the **⏻ (ON/STANDBY)** button to turn off the unit. The function indicator will turn off.

# Operation

## Applications

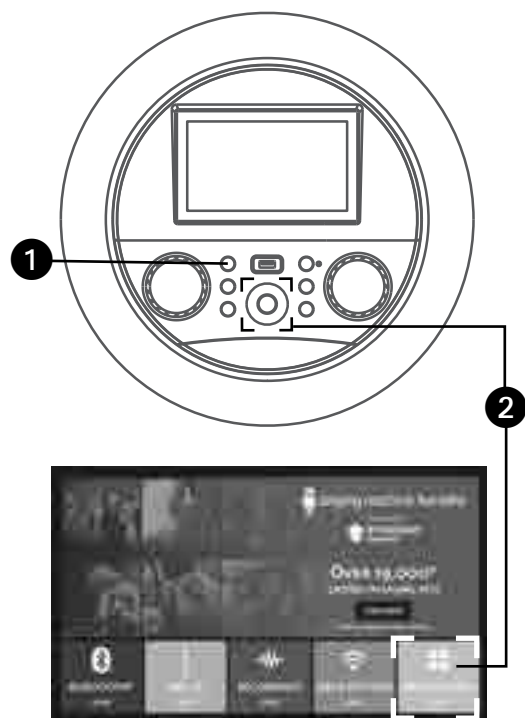

1 Connect the unit as described previously. Press the **⏻ (ON/STANDBY)** button to turn the unit on. The function indicator will light up.

2 Select **APPLICATIONS** icon using the touch screen or **◀/▶/▲/▼** navigation and **▶|| (PLAY/PAUSE/ENTER)** buttons on the control panel. All the built-in Apps will be shown.

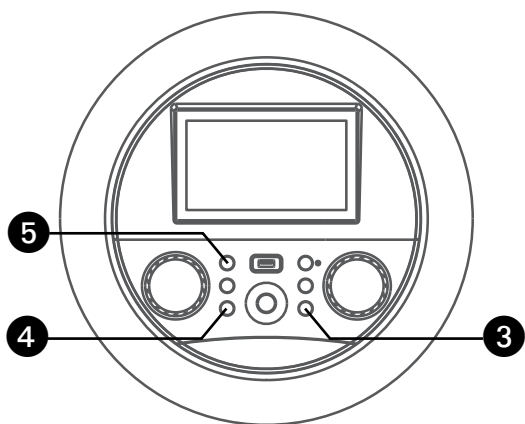

3 Press the **↶ (RETURN)** button on the panel to go back to the previous screen.

4 Press the **🏠 (HOME)** button on the panel to go to the home screen. Press and hold the **🏠 (HOME)** button to go to menu.

5 Press the **⏻ (ON/STANDBY)** button to turn off the unit. The function indicator will turn off.

# Operation

## Using a Bluetooth Device

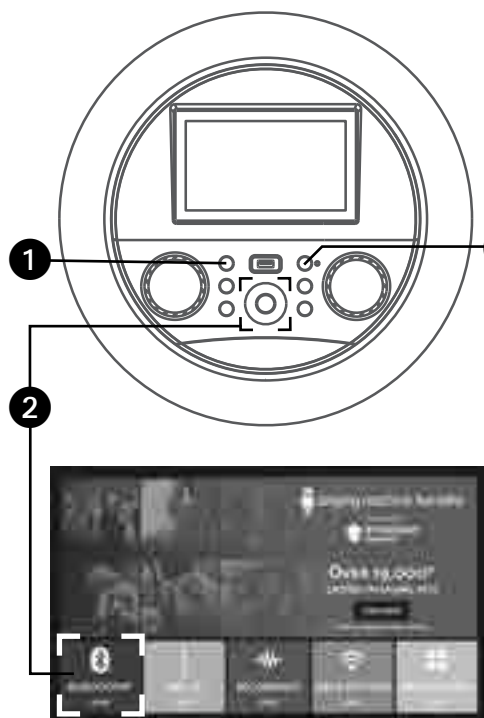

1 Connect the unit as described previously. Press the **⏻ (ON/STANDBY)** button to turn the unit on. The function indicator will light up.

2 Select **BLUETOOTH** icon using the touch screen or **◀/▶/▲/▼** navigation and **▶|| (PLAY/PAUSE/ENTER)** buttons to enter the bluetooth mode. The unit automatically searches for and pairs a previously paired Bluetooth device (if previously paired). If no previously paired devices are present and/or you want to connect a new device, press and hold the **⌘** button; the indicator will flash alternatively blue and red for 60 seconds.

**Note:** You can also press and hold the **⌘** button to disconnect any paired devices in order to pair another device.

3 Turn on your device's Bluetooth option in settings to search for a discoverable device with a Bluetooth signal. Select "**Singing Machine**" from the device results on the Bluetooth menu.

**Note:** Also refer to the user manual of your Bluetooth device for detailed instructions.



# Operation

## Using a Bluetooth Device (Continued)

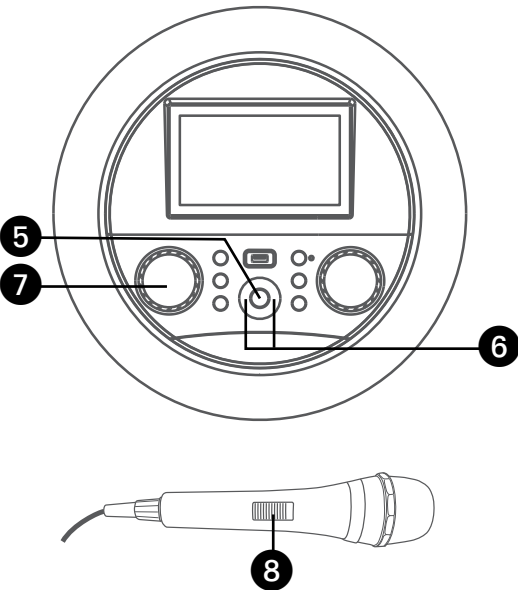
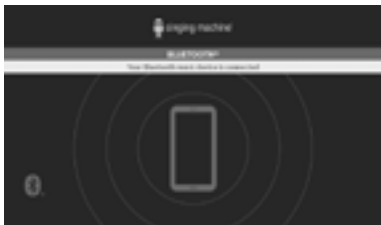
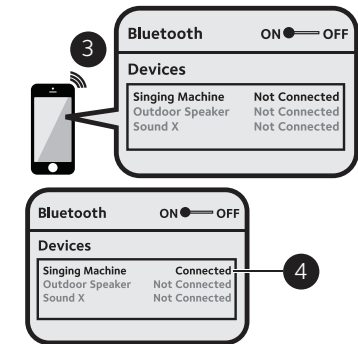

4 The screen will show that your Bluetooth device is connected successfully followed by a paired sound.

### Notes:

- If your Bluetooth prompts you for a passcode during the pairing process, please enter “0000” to connect.
- On some Bluetooth devices, once pairing is complete, select your Bluetooth device as “Use as Audio Device” or similar.
- If connection is lost after successful pairing, check to make sure the distance between speaker and Bluetooth enabled device does not exceed 30 feet/10 meters.

5 To control your Bluetooth device from this unit, press the **▶|| (PLAY/PAUSE/ENTER)** button to start playback (music app must be open). Press the **▶|| (PLAY/PAUSE/ENTER)** button during playback to pause the song.

6 **SKIP:** Advance or go back one track by pressing the **◀** or **▶** (Navigation) button.

7 Adjust the **MUSIC VOLUME** control as desired.

8 Connect microphone(s) and slide the **ON/OFF** switch on the microphone to the ON position.