



singing machine®

creating Joy through music™

SMC3093SP

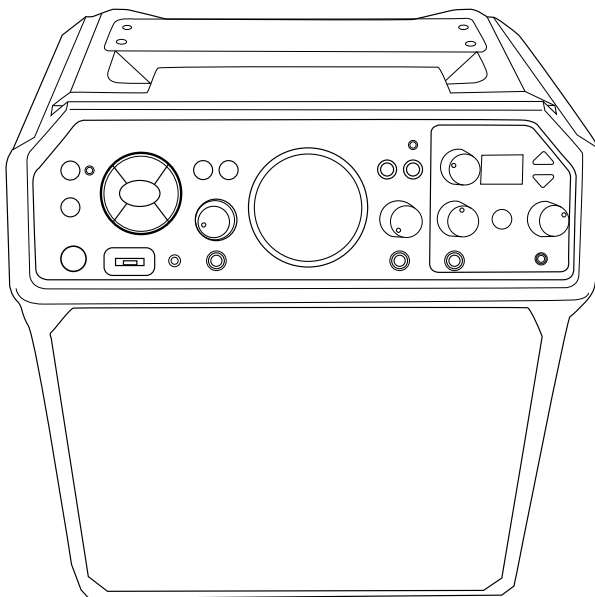

INSTRUCTION MANUAL/ MODE D'EMPLOI





www.singingmachine.com

The Singing Machine® is a registered trademark of The Singing Machine Co., Inc.
The Singing Machine® est une marque déposée de The Singing Machine Co., Inc.

Warnings

	CAUTION RISK OF ELECTRIC SHOCK DO NOT OPEN	
CAUTION: TO REDUCE THE RISK OF ELECTRIC SHOCK, DO NOT REMOVE COVER (OR BACK). NO USER-SERVICEABLE PARTS INSIDE. REFER SERVICING TO QUALIFIED SERVICE PERSONNEL.		

 **DANGEROUS VOLTAGE:** The lightning flash with arrowhead symbol within an equilateral triangle is intended to alert the user to the presence of uninsulated dangerous voltage within the product's enclosure that may be of sufficient magnitude to constitute a risk of electric shock to persons.

 **ATTENTION:** The exclamation point within an equilateral triangle is intended to alert the user to the presence of important operating and maintenance (servicing) instructions in the literature accompanying this product.

DRIPPING WARNING: This product shall not be exposed to dripping or splashing, and no objects filled with liquids, such as vases, shall be placed on the product.

VENTILATION WARNING: The normal ventilation of the product shall not be impeded for intended use.

CAUTION: TO PREVENT ELECTRIC SHOCK, MATCH WIDE BLADE OF PLUG TO WIDE SLOT AND FULLY INSERT.

WARNING: TO PREVENT FIRE OR SHOCK HAZARD, DO NOT EXPOSE THIS UNIT TO RAIN OR MOISTURE.

RF Exposure Warning Statements:

This equipment complies with FCC radiation exposure limits set forth for an uncontrolled environment. This equipment shall be installed and operated with minimum distance 20cm between the radiator & body.



This symbol on the product or in the instructions means that your electrical and electronic equipment should be disposed of at the end of its life separately from your household waste. There are separate collection systems for recycling in the EU.

For more information, please contact the local authority or your retailer where you purchased the product.

Under the influence of electrostatic phenomenon, the product may malfunction and require user to reset.

FCC WARNING: This equipment may generate or use radio frequency energy. Changes or modifications to this equipment may cause harmful interference unless the modifications are expressly approved in the instruction manual. The user could lose the authority to operate this equipment if an unauthorized change or modification is made.

This device complies with part 15 of the FCC Rules. Operation is subject to the following two conditions: (1) This device may not cause harmful interference, and (2) this device must accept any interference received, including interference that may cause undesired operation.

NOTE: This equipment has been tested and found to comply with the limits for a Class B digital device, pursuant to part 15 of the FCC Rules. These limits are designed to provide reasonable protection against harmful interference in a residential installation. This equipment generates, uses and can radiate radio frequency energy and, if not installed and used in accordance with the instructions, may cause harmful interference to radio communications. However, there is no guarantee that interference will not occur in a particular installation. If this equipment does cause harmful interference to radio or television reception, which can be determined by turning the equipment off and on, the user is encouraged to try to correct the interference by one or more of the following measures:

- Reorient or relocate the receiving antenna.
 - Increase the separation between the equipment and receiver.
 - Connect the equipment into an outlet on a circuit different from that to which the receiver is connected.
 - Consult the dealer or an experienced radio/TV technician for help.
- The rating information is located at the **rear** of the unit.

Changes or modifications not expressly approved by the party responsible for compliance could void the user's authority to operate the equipment.

Important Safety Information

1. Read these Instructions.
2. Keep these Instructions.
3. Heed all Warnings.
4. Follow all Instructions.
5. Do not use this apparatus near water.
6. Clean only with a dry cloth.
7. Do not block any of the ventilation openings. Install in accordance with the Manufacturer's instructions.
8. Do not install near any heat sources such as radiators, heat registers, stoves, or other apparatus (including amplifiers) that produce heat.
9. Do not defeat the safety purpose of the polarized or grounding-type plug. A polarized plug has two blades with one wider than the other. A grounding type plug has two blades and a third grounding prong. The wide blade or the third prong are provided for your safety. When the provided plug does not fit into your outlet, consult an electrician for replacement of the obsolete outlet. (Not applicable to UK and Europe Model)
10. Protect the power cord from being walked on or pinched particularly at plugs, convenience receptacles, and the point where they exit from the apparatus.
11. Only use attachments/accessories specified by the manufacturer.
12. Use only with a cart, stand, tripod, bracket, or table specified by the manufacturer, or sold with the apparatus. When a cart is used, use caution when moving the cart/apparatus combination to avoid injury from tip-over.
13. Unplug this apparatus during lightning storms or when unused for long periods of time.
14. Refer all servicing to qualified service personnel. Servicing is required when the apparatus has been damaged in any way, such as power-supply cord or plug is damaged, liquid has been spilled or objects have fallen into the apparatus, the apparatus has been exposed to rain or moisture, does not operate normally, or has been dropped.
15. **WARNING:** To reduce the risk of fire or electric shock, do not expose this apparatus to rain or moisture. Do not place objects filled with water, such as a vase, on the apparatus.
16. The AC mains plug is used as the power disconnect device and it should remain readily accessible and operable during intended use. In order to completely disconnect the apparatus from power, the mains plug should be completely removed from the AC outlet socket.
17. **CAUTION:** To reduce the risk of fire or explosion, do not expose batteries to excessive heat such as sunshine, fire or other heat sources.

PORTABLE CART WARNING
(symbol provided by RETAC)



Included

Please make sure the following items are included.

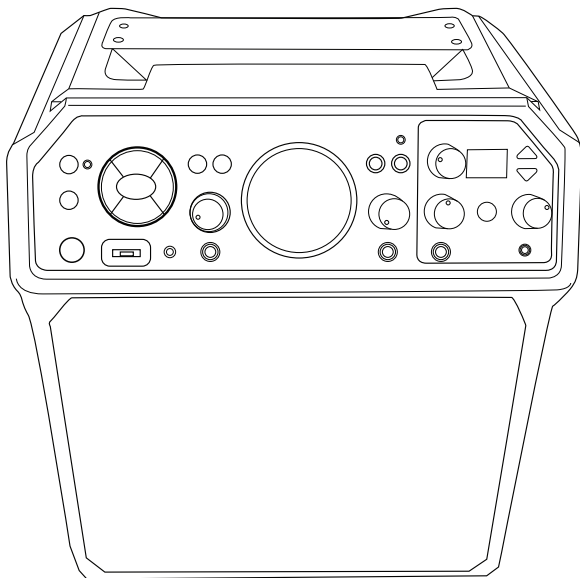

Main Unit



Wired Interactive Microphone



Wired Microphone

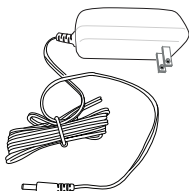

AC Adapter

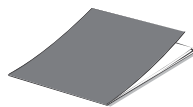

Manual

Location of Controls (Front)

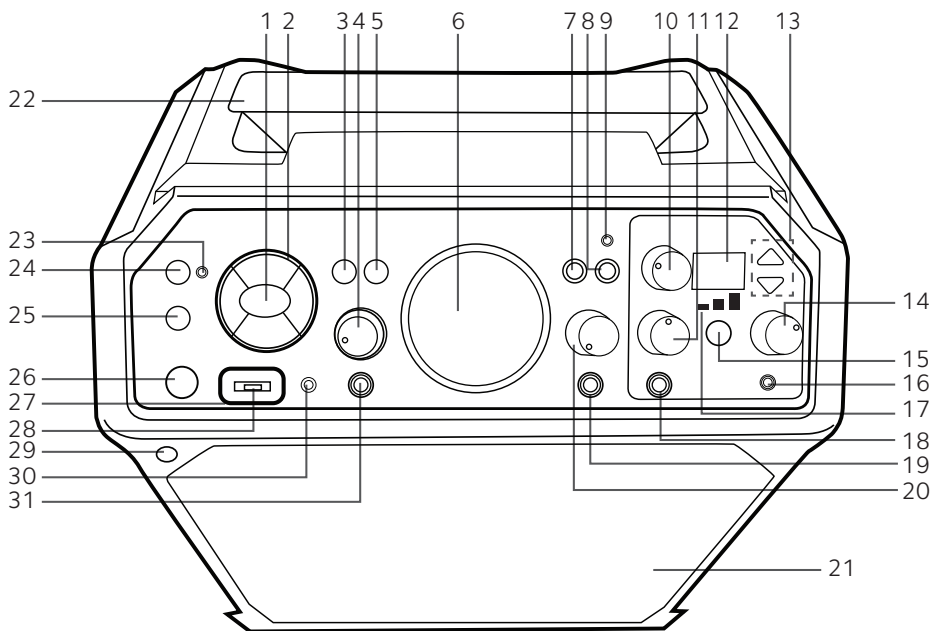

- | | | |
|---|-------------------------------|---------------------------------|
| 1. ENTER/ Button | 11. MIC 1 VOLUME Control | 22. Handle |
| 2. Navigation Buttons (Up ▲ , Right ▶▶▶ , Down ▼ , Left ◀◀◀ Button) | 12. Display | 23. Bluetooth Indicator |
| 3. ↩ BACK Button | 13. EFFECTS Up/Down Buttons | 24. Bluetooth/VOCALS OFF Button |
| 4. EXT INPUT VOLUME Control | 14. HEADPHONES VOLUME Control | 25. FUNCTION Button |
| 5. 🏠 HOME Button | 15. PITCH TUNE Button | 26. STANDBY/ON Button |
| 6. MUSIC VOLUME Control | 16. Headphones Jack | 27. Function Indicator |
| 7. LIGHT MODES Button | 17. PITCH TUNE Level | 28. USB Port |
| 8. RECORD Button | 18. MIC 1 Jack | 29. Remote Sensor |
| 9. RECORD Indicator | 19. MIC 2 Jack | 30. AUX IN Jack |
| 10. EFFECTS STRENGTH LEVEL Control | 20. MIC 2 VOLUME Control | 31. EXT INPUT Jack |
| | 21. Speaker | |

Location of Controls (Rear/Top)

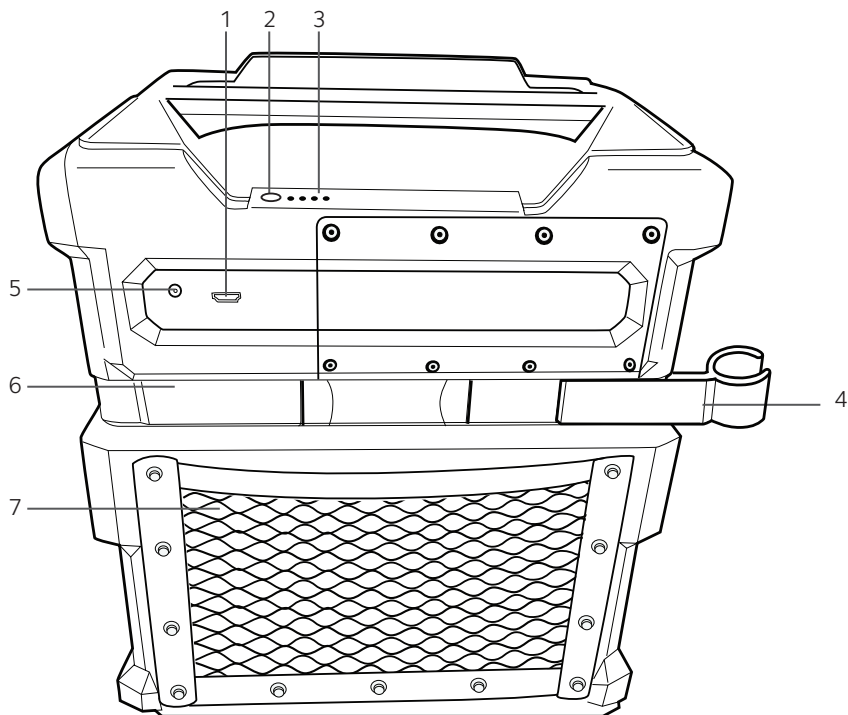

- | | |
|-----------------------------|----------------------------|
| 1. HDMI Jack | 5. DC IN Jack |
| 2. Battery Level Button | 6. Mic Holder (Slides out) |
| 3. Battery Level Indicators | 7. Accessory Storage |
| 4. Mic Holder (Slides out) | |

Location of Controls (Mic)

Interactive Microphone

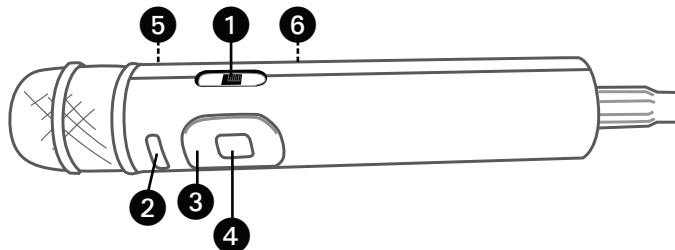

Standard Microphone

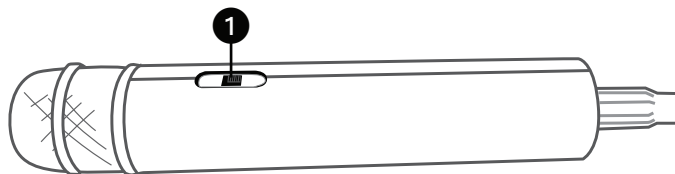

- | | |
|-----------------------|-------------------------------|
| 1. Mic ON/OFF Switch | 4. ENTER/▶■ Button |
| 2. MENU Button | 5. Remote Transmitter (Rear) |
| 3. Navigation Buttons | 6. Battery Compartment (Rear) |

Energy Saving (Auto Power System-APS)

If there is no audio playback, the unit will automatically enter standby mode after 20 minutes. To resume use of the unit press the **STANDBY/ON** button. APS is for energy saving purposes.

Connection

Connecting the Microphone(s)

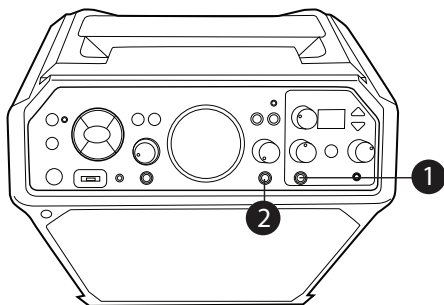

Microphones:

Connect a microphone into Mic 1 jack ① as well as Mic 2 jack ② (when desired).

NOTE:

Do not drop or tap the Mic as damage to the Mic or speakers may occur. Do not twirl the microphone by the cord as it will cause damage to the encased wiring.

Connecting the Unit to a TV

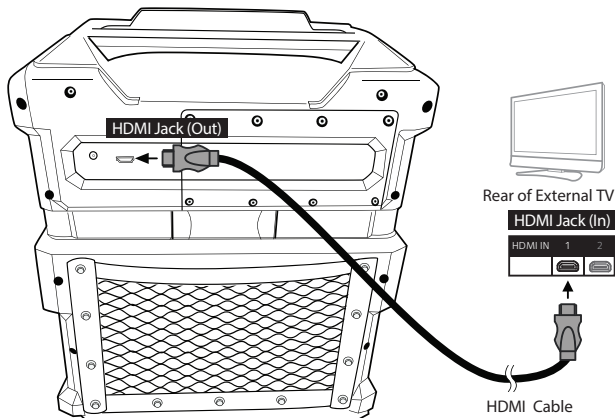

To output the video, lyrics and audio to your TV, perform the following steps:

Plug the HDMI cable (not included) into the HDMI Jack on the back of the unit. Plug the other end of the HDMI cable into the HDMI input on your TV.

NOTES:

- This unit can be used with or without a TV, but it is highly recommended to use a TV in order to utilize all the features.
- Also refer to the TV's User Guide.

Connection

Connecting to AC Power

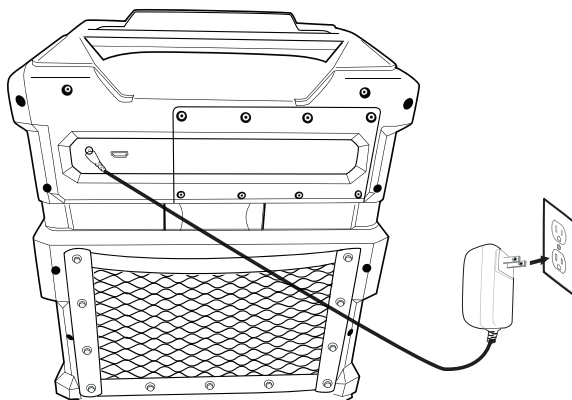

Insert the small end of the AC adapter into the DC IN jack on the rear of the unit. Insert the other end into a conveniently located AC outlet having 100-240V AC, 50/60Hz.

NOTE:

Make all connections before connecting to AC power.

Connecting Headphones

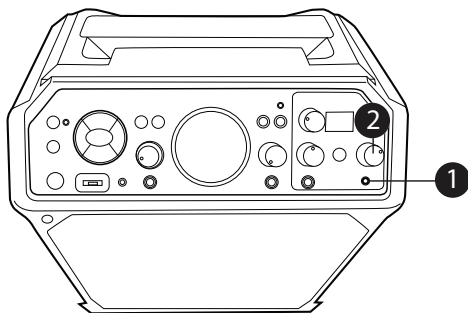

For private listening or to monitor singing, use headphones (not included). Insert headphones into the Headphones jack **1**. The headphones have a dedicated Volume control so rotate the **HEADPHONE VOLUME** control **2** as desired.

The Headphones jack can also be used as an audio out to connect to another audio system using a 3.5mm Auxiliary Audio cable (not included).

Connection

Changing the Interactive Microphone's Battery



When performance suffers, change the batteries as follows:

- 1 Unscrew the Battery Compartment screw and remove the door.
- 2 Replace battery with CR2032 button cell battery.
- 3 Replace Battery Compartment and screw.

BATTERY PRECAUTIONS:

Follow these precautions when using batteries in this device:

1. Warning – Danger of explosion if battery is incorrectly replaced. Replace only with the same or equivalent type.
2. Use only the size and type of batteries specified.
3. Be sure to follow the correct polarity when installing the batteries as indicated in the battery compartment. A reversed battery may cause damage to the device.
4. If the device is not to be used for a long period of time, remove the batteries to prevent damage or injury from possible battery leakage.
5. Do not try to recharge a battery not intended to be recharged; it can overheat and rupture. (Follow battery manufacturer's directions.)
6. Remove batteries promptly if consumed.

Rechargeable Battery

This unit comes with a built-in rechargeable battery pack that will allow the unit to be used without being connected to AC power. The Battery indicator (top of the unit) will show the battery charge remaining, indicated by the amount of bars. The rechargeable battery pack is not user-replaceable.

We recommend to charge the unit once a month so as to keep the battery in the best condition. When the battery icon turns red and flashing, recharge the unit by following below:

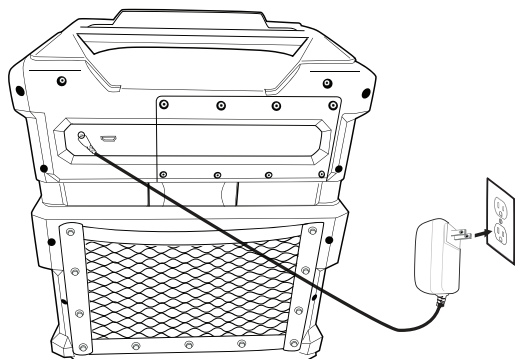

- 1 Insert the AC power cord into a conveniently located AC outlet having 100-240V AC, 50/60Hz.
- 2 Allow the unit to charge for approximately twelve hours for a full charge.
- 3 Disconnect the AC cord and the fully charged unit is now ready for use. Battery life can last up to 25 hours depending on playback operations.

Attention: The sound volume will adjust automatically when the battery is not full.

Note: If you experience battery issues, contact customer service.

Recycling and Disposal Information:

- Do not dispose of electronic devices or any of their components (especially batteries and LCD displays) in your municipal trash collection.
- Consult your local waste management authority or a recycling organization like Earth911.com to find an electronics recycling facility in your area.



CAUTION: Rechargeable batteries must be recycled or disposed of properly.

Lead Acid Battery Warning

- This equipment contains a rechargeable valve-regulated lead acid battery.
- Do not charge the battery in temperatures below 32° F (0° C) or higher than 122° F (50° C).
- Do not open or mutilate the battery.
- The rechargeable batteries contained in this equipment may explode if disposed of in a fire.
- Do not short-circuit the battery.
- Do not charge the rechargeable battery pack used in this equipment with any charger other than the one designed to charge this battery pack, as specified in the owner's manual. Using another charger may damage the battery pack or cause the battery pack to explode.

Operation

Microphone Remote Operation

The Microphone is also a remote control that can be used to control the unit. See below for instructions on using the Microphone Remote.

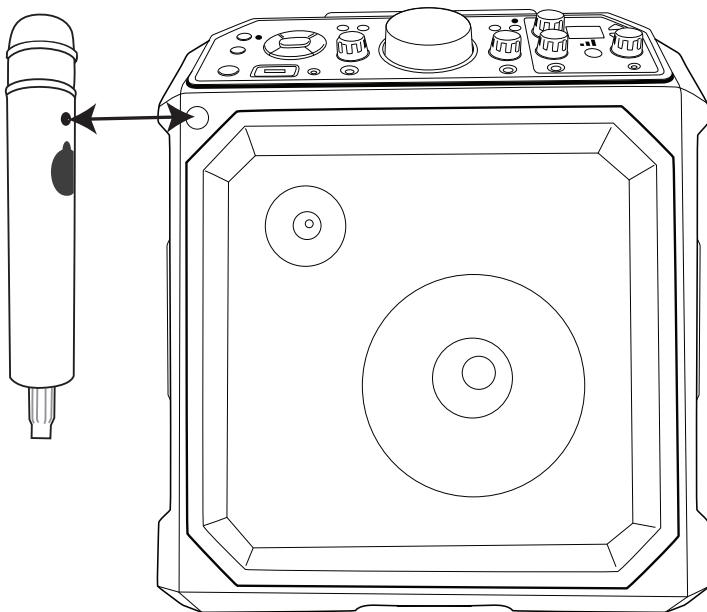

It is very important to point the remote's sensor at the unit's remote sensor (see illustration).

This Microphone Remote's buttons will operate the same way as the main unit's **ENTER**, **Navigation** and **MENU** buttons. When a step says to press one of these buttons, you can use either the unit or the Microphone Remote.

To turn the Microphone On, slide the **ON/OFF** switch ❶ to the ON position.

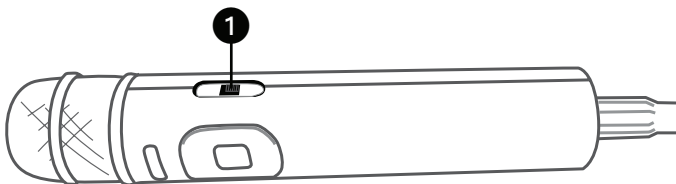

Operation

Light Mode

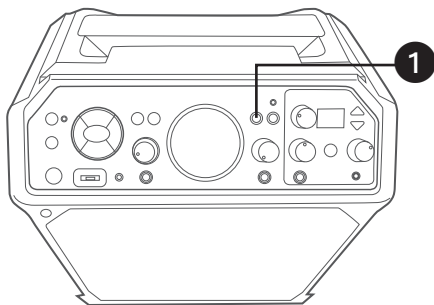

- 1 There are three Light modes. Repeatedly press the **LIGHT MODES** button to select a mode as follows:

Light Mode 1: The unit will synchronize to the music being played.

Light Mode 2: The unit will light up with random colors and patterns.

Light Mode 3: The light effects will be turned off.

Function Indicator

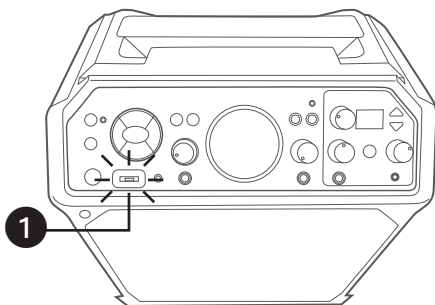

- 1 The Function indicator (around the USB port) will change colors depending on the mode selected as follows:

Blue: Bluetooth

Green: Line-In

Orange: USB

Red: Home

Purple: Casting

Cradle

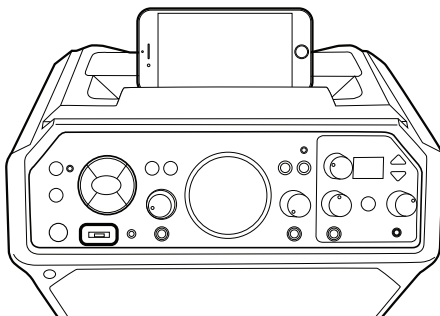

Connections

Connect to WiFi

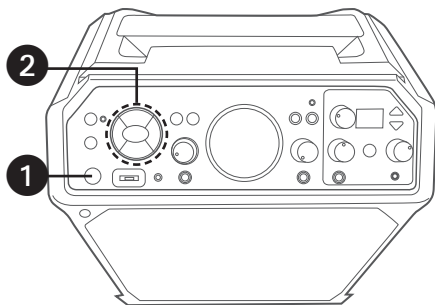

1 Connect the unit as described previously and ensure to connect it to a TV. Press the **ON/STANDBY** button to power on the unit. The power indicator will light up.

2 USE YOUR MOBILE DEVICE TO CONNECT THIS UNIT

Use the **Navigation** ►/►► Right or ◀◀/◀ Left and **ENTER/** ►|| button to select the **SINGCAST** icon on your TV screen. "CAS" will display on the screen. If this unit has not been connected to your WiFi network, a step 1 QR code will pop up on screen. Use your mobile device to scan the QR code allowing it a moment to load. Once your mobile device connects to the unit successfully, the step 2 QR code will pop up on screen.

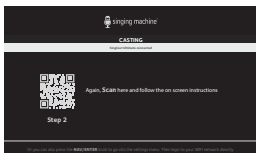

3 CONNECT THIS UNIT TO YOUR WIFI NETWORK

Use your mobile device to scan the step 2 QR code and allow it to load. The WiFi list will pop up on your mobile device. Search for and select your home WiFi and input your WiFi password to complete the login process.

If the unit does NOT connect to your home WiFi successfully, check your password and WiFi frequency and repeat above steps.

NOTES:

- Make sure the WiFi network of the mobile device and unit are using the same network.
- WPA3 security settings can cause connection issues. If you have WPA3 security, we recommend lowering to WPA2 or lower. Or contact us for further help.
- If the unit is connected to WiFi, the WiFi indicator will be light solid, otherwise the indicator will flash.

Connections

Connect to WiFi (Continued)



4

When the unit connects to your WiFi successfully, "Success! You are now connected to cast!" will display on-screen. You can download the **Singing Machine Karaoke App** to listen to your favorite karaoke music and project the HD karaoke video on your TV.

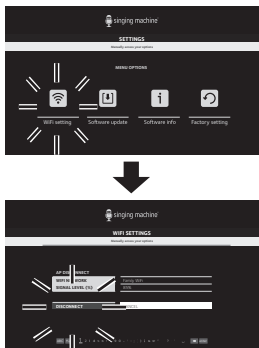

5

The unit automatically searches and pairs to a previously paired WiFi network. If you want to connect to another WiFi network, you can go to the main menu and select **SETTINGS>WiFi setting>DISCONNECT** to disconnect from the WiFi network in order to connect to another WiFi network.

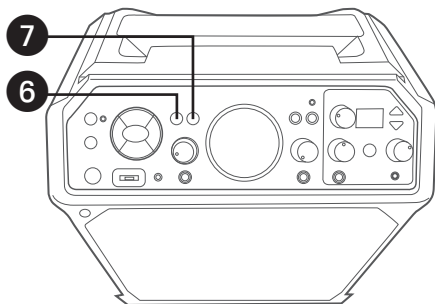

6

Press the **BACK** button to go back to the previous screen.

7

Press the **HOME** button to go to the main menu.

Connections

Settings



1

Press the **HOME** button to go to the main menu. Using the **Navigation** **▶/▶▶** Right or **◀/◀◀** Left and **ENTER/▶||** button select the **SETTINGS** icon; "SET" will appear on-screen.

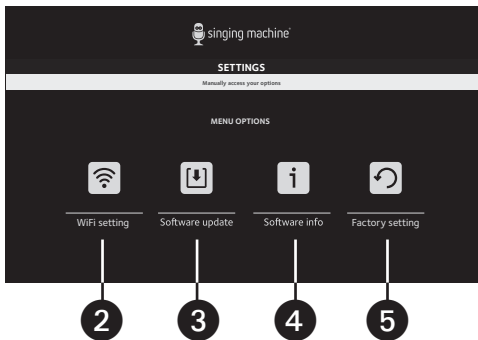

2

Select **WiFi setting** to connect or disconnect from the WiFi network and check the WiFi signal level.

3

Select **Software update** to update the software of the unit.

4

Select **Software info** to check the latest software version and serial number of this unit.

5

Select **Factory setting** to delete all data stored in the unit.

Operation

Using SingCast Casting

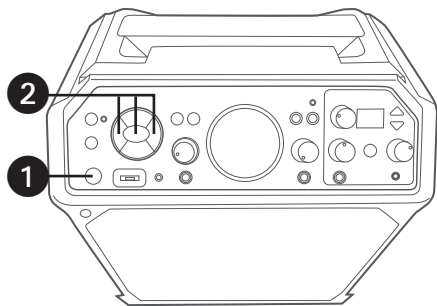

1 Connect the unit as described previously and ensure to connect it to a TV. Press the **ON/STANDBY** button to power on the unit.

2 Use the **Navigation** ►/►► Right or ◀◀/◀ Left and **ENTER**/►► button to select the **SINGCAST** icon on your TV screen; Or press the **FUNCTION** button repeatedly until "CAS" appears on the display.



3 Download the **Singing Machine Karaoke App** to choose from thousands of HD karaoke videos, project your favorite karaoke videos from your mobile device to your TV (make sure your mobile device and the unit are connected to the same WiFi network).

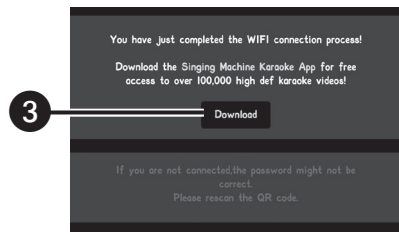

4 After registering your account, choose your favorite song. Press the icon "📺" and select "SingCast Studio" to cast to your TV.



Operation

Using SingCast Casting (Continued)

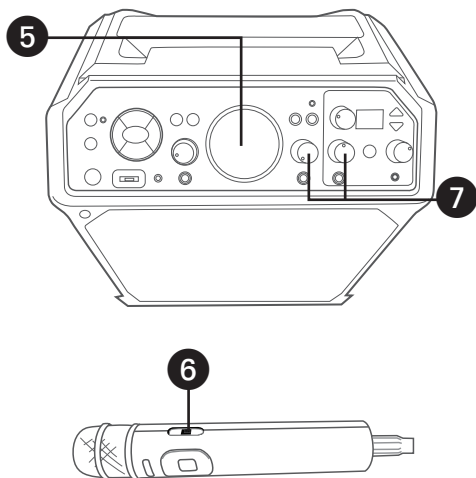

5 Adjust the volume to a comfortable level using the **MUSIC VOLUME** control.

NOTE:

- You can also control the TV's volume with the TV's volume control.

6 Connect the microphone(s). Slide the Mic's **ON/OFF** switch to the ON position.

7 Adjust the **MIC VOLUME 1 or 2** control as desired. Increasing this will increase the volume of the respective microphone.

8 **RECORDING YOUR SINGING:**

To record your singing as well as the music, press the **REC** button; recording will begin and the record indicator will light.

When done recording, press the Record button again; the Record indicator will turn off.

Notes:

- The recorded audio file will record onto the USB drive.
- The recorded audio file will be named "CAS_RECORD_X.mp3".

9 Press the **ON/STANDBY** button to turn off the unit.

Operation

Pitch Tune

The Pitch Tune feature is shown in a dedicated area at the front (top right) of the unit. This will allow you to Pitch Tune your voice like the professionals.

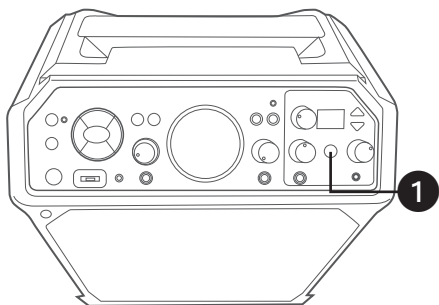

1 With the unit on, press the **PITCH TUNE** control button once to activate; the first PITCH TUNE Level indicator will light. This is the Natural PITCH TUNE setting and what is commonly used in the music industry to level out and fix a singer's voice behind the scenes. It's subtle and is meant to provide a natural fix to a singer's voice.

Press the **PITCH TUNE** control button again; the second PITCH TUNE Level indicator will light. This is a medium level, a bit stronger than natural but not full intensity of PITCH TUNE.

Press the **PITCH TUNE** control button again; the third PITCH TUNE Level indicator will light. This is the extreme level which is the iconic sound that has made PITCH TUNE famous in pop and hip-hop.

NOTE: Plug mic into mic 1 jack. PITCH TUNE feature is only available through mic 1 jack.

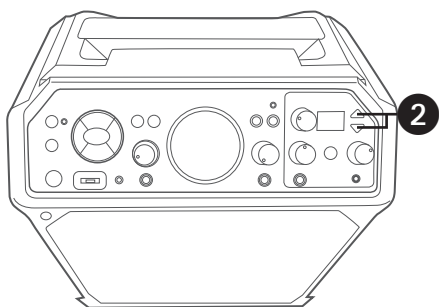

2 Press the **EFFECTS Up** or **Down** button to select a desired effect. See top of next page for Effects. Have fun experimenting with the effect to find the best results for individual songs.

Operation

Pitch Tune (Continued)

Name	Display	Effect Description
None	---	No Vocal Effects
Basic Pitch	P01	Silky smooth & balanced reverb & echo; a great all around go-to vocal enhancer
Billie Eyelash	P02	Queue up Bad Guy & let it rip with this harmonized choir effect that is perfect for Alternative and Rock singing
Phil the Air Tonight	P03	Heavy on the reverb & echo with delicate feedback & flanger effect for a lovely sound perfect for 80's hits
Grunge	P04	Unmistakably gritty, great for rock, alt, pop and just making your voice sound cool
Reggae-Tone	P05	Enhanced echo and choir makes voices shine especially while singing reggae and reggaeton
Hip-Hop	P06	Big room echo & reverb with a smooth chorus
Oldtown Rd	P07	A touch of echo with added vocal boost that's great for belting out country tunes
Diva	P08	Take your voice to new heights with this octave booster
Doo-Wop	P09	Smooth harmony adds some bass backup to your voice
Electronica	P10	Punchy and unique, perfect for pop, EDM and making heads turn
Up to Mars	P11	Big echo and chorus good for a wide range of songs from ballads to funk
Anthems	P12	Lots of echo and reverb for when your voice needs to be BIG
Nosebleed Seats	P13	Did someone say sold out stadium shows?
Voice of an Angel	P14	Have your own angelic choir singing along with this lovely chorus effect
4 of a Kind	P15	It's like having a few more singers harmonize along with your vocals
Ballad rock	P16	Crank up your favorite guilty pleasure ballad and rock it out for that special someone in the audience
Bad Trip	P17	Wild & fun chorus effect
Laser	P18	Crazy & silly vocal laser beams
Warp Speed	P19	Bouncy & echos, lots of fun
Barry Deep	P20	Oh baby, that's a deep voice

Operation

Pitch Tune (Continued)

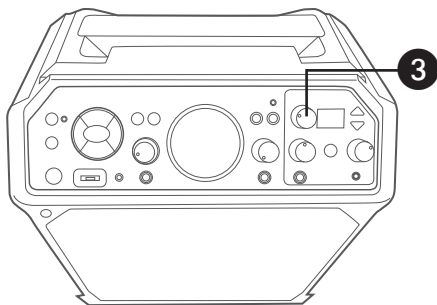

- 3 Rotate the **EFFECTS STRENGTH** control to set the desired effect level.

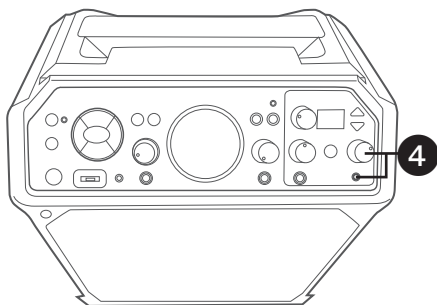

- 4 To monitor your singing, use headphones (not included). Insert headphones into the Headphone jack. The headphones have a dedicated Volume control so rotate the **HEADPHONE'S VOLUME** control as desired.

The Headphones jack can also be used as an audio out to connect to another audio system using a 3.5mm auxiliary audio cable (not included).

Operation

Playing Songs from the USB

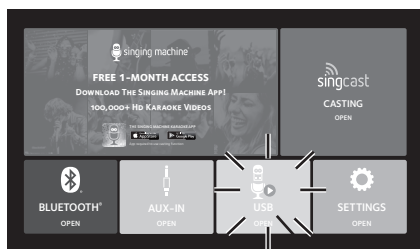
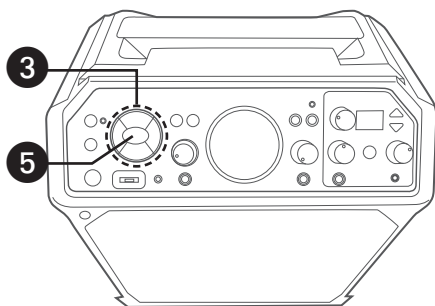
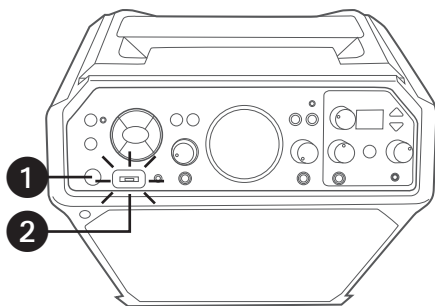

1 Connect the unit as described previously. Press the **STANDBY/ON** button to turn the unit on.

2 Insert a USB flash drive into the USB slot on the unit so it faces upward.

2 WAYS TO ENTER USB MODE

3 Press the **FUNCTION** button repeatedly until “USB” flashes on the display.

4 Use the **Navigation** ►/►► Right or ◀◀/◀ Left and **ENTER/►►►** button to select **USB OPEN** in the main menu; the unit should be connected to a TV.

5 Press the **ENTER/►►►** button to enter the USB mode; the Function indicator will light orange.

NOTES:

- A loading “Loading U Disk, Please.....” will appear on the TV when the system is loading the songs.
- Unit must be connected to a TV to access the USB song list. Songs will not display on this unit’s mini display.
- Unit can only read files in the “karaoke” folder.

Operation

Playing Songs from the USB (Continued)

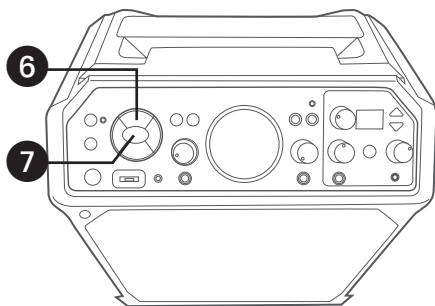

6 Use the **Navigation** ▲ Up and ▼ Down buttons to navigate through the list of songs that you have previously downloaded on your USB.

7 Press the **ENTER/▶||** button to start the playback. The HD karaoke video and MP3 will play on the TV. Press the **ENTER/▶||** button during playback to pause the song. Press the **↶ BACK** button at any time to go back to the previous screen.

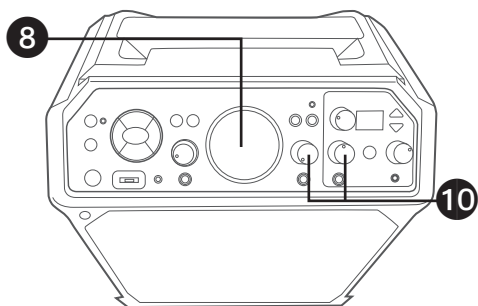

8 Adjust the volume to a comfortable level using the **MUSIC VOLUME** control.

NOTE:

- If connected to a TV, you can also control the TV's volume with the TV's volume control.

9 Connect the microphone(s). Slide the Mic's **ON/OFF** switch to the ON position.

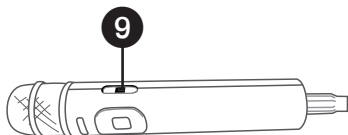

10 Adjust the **MIC VOLUME 1 or 2** control as desired. Increasing this will increase the volume of the respective microphone.

Operation

Playing Songs from the USB (Continued)

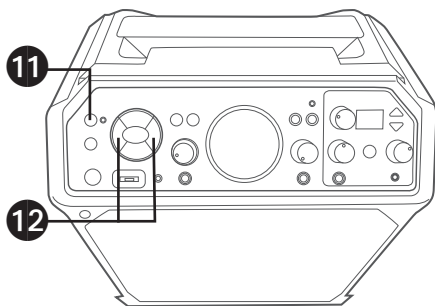

11 To sing without the lead singer on the recording, press the **VOCALS OFF** button. To resume the lead singer, press again.

NOTE: Lead vocal removal might work better on some songs than others.

12 **SKIP:** Advance or go back one track by pressing the **Navigation** **▶/▶▶** Right or **◀/◀◀** Left button.

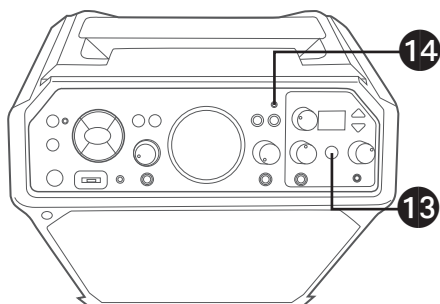

13 **PITCH TUNE :** See pages E17 to E19 for more details.

14 **RECORDING YOUR SINGING:** To record your singing as well as the music, press the **REC** button; recording will begin and the record indicator will light. When done recording, press the Record button again; the Record indicator will turn off.

Notes:

- The recorded audio file will record onto the USB drive.
- The recorded audio file will be named "USB_RECORD_X.mp3".
- Re-enter USB mode to read newly recorded audio files.

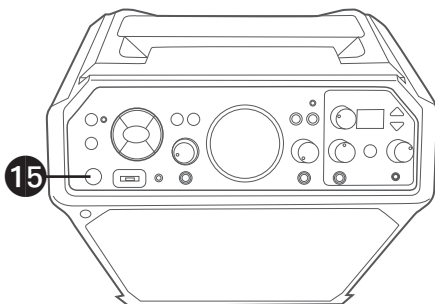

15 Press the **STANDBY/ON** button to turn the unit off.

Operation

Using a Bluetooth Device

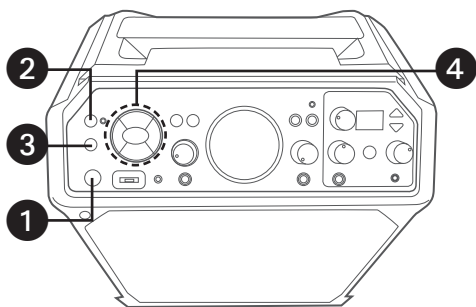

1 Connect the unit as described previously. Press the **ON/STANDBY** button to turn the unit on. The power indicator will light.

3 WAYS TO ENTER BLUETOOTH MODE

2 Press and hold the **Bluetooth/VOCALS OFF** button; “BT” will light up on the display; the indicator will flash.

3 Press the **FUNCTION** button repeatedly until “BT” will light up on the display; the indicator will flash.

4 Use the **Navigation** **▶/▶▶** Right or **◀◀/◀** Left **and ENTER/▶▶▶** button to select **BLUETOOTH OPEN** in the main menu; the unit should be connected to a TV.

5 The unit automatically searches and pairs a previously paired Bluetooth device (if previously paired). If no previously paired devices are present, connect as shown in the next step.

NOTE: You can also press and hold the **Bluetooth/VOCALS OFF** button to disconnect any paired device in order to pair another device.

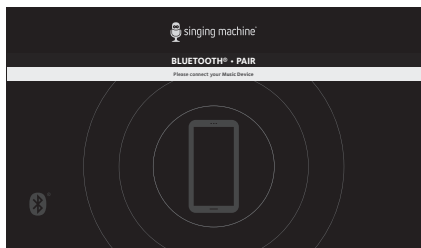
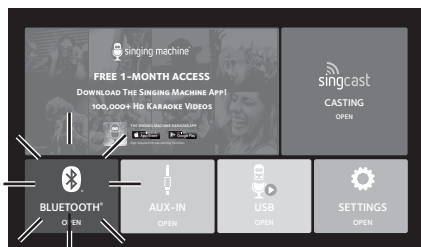

Operation

Using a Bluetooth Device (Continued)

Note: You can view the lyrics on your mobile device/tablet and get more songs by downloading the “The Singing Machine Mobile Karaoke App”; refer to the Welcome Kit for more information.

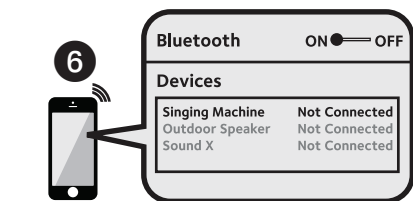

- 6 Turn on your device’s Bluetooth option in settings to search for a discoverable device with a Bluetooth signal. Select “**SINGING MACHINE**” from the device results on the Bluetooth menu.

NOTE: Also refer to the user manual of your Bluetooth device for detailed instructions.

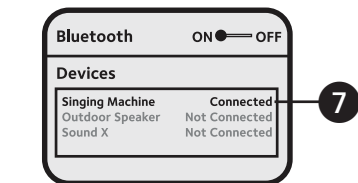

- 7 “BT” and bluetooth indicator will light solid.

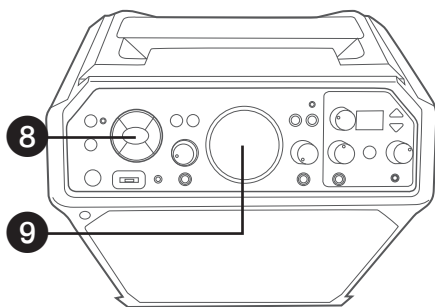

- 8 You can control your Bluetooth device to start the music playback OR press the **ENTER/▶▶** button to start playback. Press the **ENTER/▶▶** button during playback to pause the song.

- 9 Adjust the volume to a comfortable level using the **MUSIC VOLUME** control on this unit as well as the Volume on your Bluetooth device.

NOTE: If connected to a TV, you can adjust the TV’s volume as well.

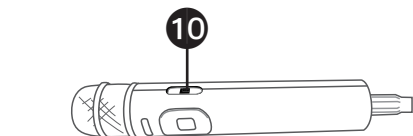

- 10 Connect the microphone(s). Slide the Mic’s **ON/OFF** switch to the ON position.

Operation

Using a Bluetooth Device (Continued)

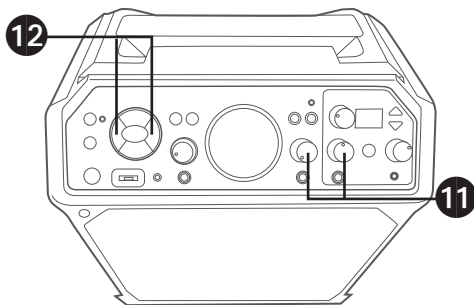

11 Adjust the **MIC VOLUME 1** or **2** control as desired. Increasing this will increase the volume of the respective microphone.

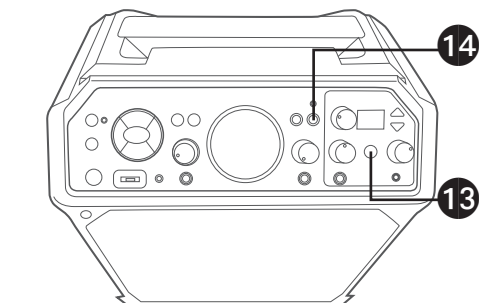

12 **SKIP:** Advance or go back one track by pressing the **Navigation** ►/►► Right or ◀◀/◀ Left button.

13 **PITCH TUNE :** See pages E17 to E19 for more details.

14 **RECORDING YOUR SINGING:**
To record your singing as well as the music, press the **REC** button; recording will begin and the Record indicator will light.
When done recording, press the Record button again; the Record indicator will turn off.

NOTES:

- The recorded audio file will record onto the USB drive.
- The recorded audio file will be named with the "BT_RECORD_X.mp3" prefix.

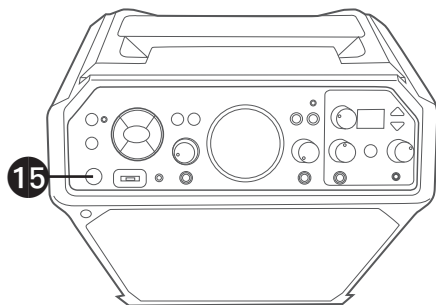

15 Press the **STANDBY/ON** button to turn the unit off.

Operation

Using the AUX IN Jack

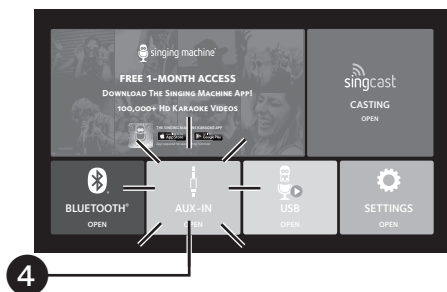
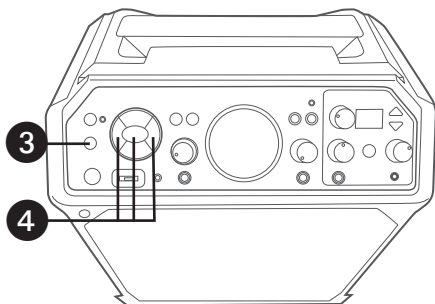
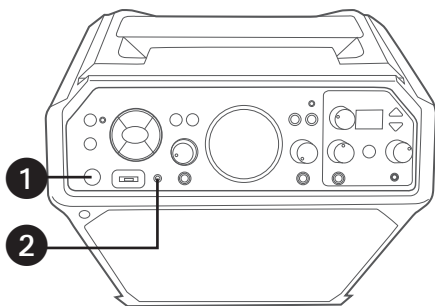

1 Connect the unit as described previously. Press the **STANDBY/ON** button to turn the unit on.

2 Connect the external unit to the AUX INPUT Jack using a 3.5mm auxiliary audio cable (not included). Connecting an external unit will allow the audio to be played through your Singing Machine.

NOTES:

- It is highly recommended to set the volume on the auxiliary unit to 1/3 or lower to avoid distortion.
- Skipping files/tracks is not possible in this unit when using an external device.

2 WAYS TO ENTER AUX IN MODE

3 Press the **FUNCTION** button repeatedly until "AUX" flashes on the display.

4 Use the **Navigation** ►/►► Right or ◀◀/◀ Left and **ENTER/** ►|| button to select **AUX IN OPEN** in the main menu; the unit should be connected to a TV. The Function indicator will light green. You can also repeatedly press the **FUNCTION** button until the Function indicator lights green to select the Line In mode. "AUX" will start to flash on the display.

Operation

Using the AUX IN Jack (Continued)

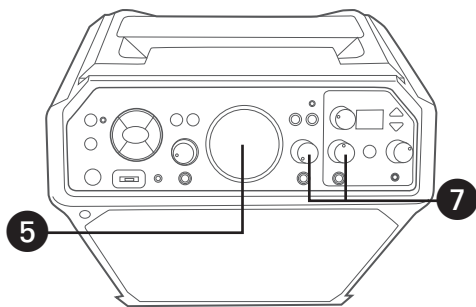

5

Adjust the volume using the **MUSIC VOLUME** control on this unit or external device.

6

Connect the microphone(s). Slide the Mic's **ON/OFF** switch to the ON position.

7

Adjust the **MIC VOLUME 1** or **2** control as desired. Increasing this will increase the volume of the respective microphone.

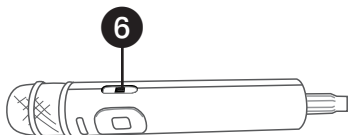

8

PITCH TUNE : See pages E13 to E16 for more details.

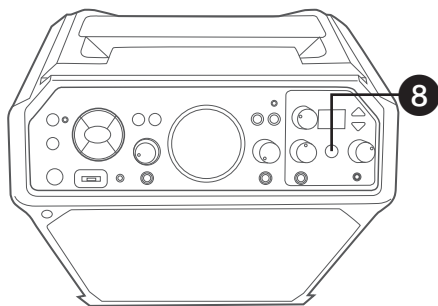

9

To record your singing as well as the music, press the **REC** button; recording will begin and the Record indicator will light. When done recording, press the **REC** button again; the Record indicator will turn off.

Notes:

- The recorded audio file will record onto the USB drive.
- The recorded audio file will be named with the "LINE_RECORD_X.mp3" prefix.

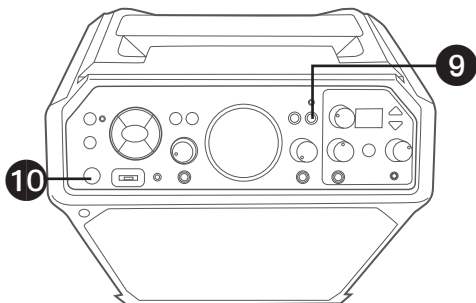

10

Press the **STANDBY/ON** button to turn the unit off.

Operation

Using the EXTERNAL INPUT Jack

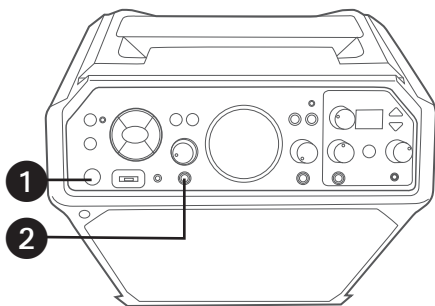

1 Connect the unit as described previously. Press the **STANDBY/ON** button to turn the unit on.

2 Connect the external unit to the **EXTERNAL INPUT** jack using a 6.3mm cable (not included). Connecting an external unit will allow the audio to be played through your Singing Machine. Adjust the external input's volume using the **EXT INPUT VOLUME** control.

Notes:

- It is highly recommended to set the volume on the auxiliary unit to 1/3 and the EXT INPUT VOLUME control on this unit to 1/3 as well to avoid distortion.
- Skipping files/tracks is not possible in this unit when using an external device.

3 Play the device connected to the **EXTERNAL INPUT** jack and it will play through this unit regardless of the function selected.

Troubleshooting Guide

Should this unit exhibit a problem, check the following before seeking service:

No Power

- Power is not on; press the **STANDBY/ON** button to turn power on.
- Make sure the unit is connected to AC power
- Confirm the AC adapter is connected securely to the back of the unit.
- Connect the unit to a different outlet.
- The normal function of the product may be disturbed by strong Electro-Magnetic Interference. If so, simply restart the product to resume normal operation by following the instruction manual. In case the function could not resume, please use the product in another location.

No Sound – General

- Music Volume is set to minimum; raise volume.
- Correct Function was not selected; select using the **Navigation** buttons or by pressing the **FUNCTION** button.

No Sound – If connected to a TV

- Volume on the TV is muted or too low.
- Correct source (usually HDMI) was not selected on the TV's menu.

Lyrics do not appear on the TV screen (if connected)

- If connected to a TV, HDMI plug is not connected properly; see page E7.
- If connected to a TV, select the correct source on the TV (usually HDMI).
- The file/track being played is not a track recorded with lyrics. These are the only files that allow you to view the lyrics on the TV screen.

No sound from the microphone

- Make sure the microphone is firmly connected to the MIC 1 or MIC 2 jack.
- Make sure the Mic's **ON/OFF** switch on the Mic is set to the ON position.
- Make sure the microphone volume is not on the lowest setting.
- **MIC VOLUME** control is set to minimum; raise volume.

File(s) on USB are not playing

- The file is corrupted; replace the file.
- The file is not in a format this unit will play.
- The connected USB device is not supported by the product.
- The file was not saved to the "karaoke" folder. Save it to the "karaoke" folder.

The Bluetooth device cannot be paired or connected with the unit

- Ensure any other Bluetooth devices are turned off to avoid accidental pairing.
- You have not activated the Bluetooth function of your device; see page E23 or refer to the Bluetooth device user's manual.
- The system is not in pairing mode; press the **PAIR** button to restart pairing.

The Music is not available on the unit after successfully connecting the Bluetooth

- Ensure your Bluetooth device can support the A2DP Bluetooth profile.
- The volume on the external Bluetooth device is set to low or muted; raise as desired.

Troubleshooting Guide

Failed to connect to the Wifi network

- The unit is not within the WiFi signal range.
- Ensure you have entered the correct password.
- Check the mobile device and unit are using the same WiFi network.
- WPA3 security settings can cause connection issues. If you have WPA3 security, we recommend lowering to WPA2 or lower. Or contact us for further help.

Need Help Casting? Start here!

Scanning QR code fail

- We recommend for you to scan the QR Code once more. If you cannot scan it successfully, you may need to try a specific QR code scanning APP to help.
- Alternatively, you can go into “SETTINGS menu/WiFi setting” to connect the SingCast unit to your WiFi network directly.

Need Help Casting? Start here!

No Internet connection

- Ensure the unit is in SingCast mode.
- Ensure the input WiFi password is correct.
- Ensure the SingCast unit is not too far from your router (recommended maximum 10 meters). If the WiFi signal level is weak, we recommend that you relocate the SingCast unit closer to the router.
- Please check out below compatible WiFi security list.
WPA, WPA-PSK, WPA2, WPA2-PSK, WPA3, WEP 64bit & 128bit, IEEE 802.11x and IEEE 802.11i.
- Depending on the brand of your router, if you still cannot connect to the router with WPA3 or lower security standard, you are recommended to factory reset your router. *Make sure you have written down your existing customized SSID name and password. This will help in reconnecting your previously connected devices and revert to your previous WiFi security settings.
- If the Singing Machines unit's WiFi is connected to the router successfully. But you still cannot connect to the internet. You might need to check for any internet connection problems on your router. Or check out the router's settings to verify if the unit is blocked from going online. You are highly recommended to refer your router's instruction manual.
- To ensure the unit's WiFi function works fine, you can connect your unit's WiFi to your mobile device's hotspot with data service to verify. Make sure you have a second mobile device providing hotspot to cast the video.

Cannot find the SingCast unit on your Karaoke app casting list / No Casting video to TV

- Ensure both the SingCast unit and your mobile device are connected to the same WiFi network.
- If SingCast does not appear as a casting option, check advanced security settings to enable DLNA.
- If you are connecting a router with Mesh function, you need to make sure "Access Intranet" function is enabled.

Specifications

AUDIO

Output Power 50 Watts (RMS)
Output Impedance 4 Ohms

BLUETOOTH

Bluetooth Version V5.0
Working Distance Up to 30 feet/10 meters measured in open space

WIFI

Wifi frequency 2.4GHz/5GHz

USB

Format FAT32
Maximum Compatibility 32GB

RECORDED FILE

MP3 Encoding 128kbps

JACK

Microphone 6.3 mm Microphone Jacks (2)

GENERAL

Power 100-240V, 50-60Hz
Output 18.0VDC  3.0A Positive Center
Dimensions - Main Unit 13.9 x 9.5 x 16.7 inches (35.4 x 24 x 42.4 cm)
Weight - Main Unit 19.8lbs/9.0Kg
Microphone -74 dB 600 Ohms impedance with 6.3 mm Dynamic Microphone

Specifications are subject to change without notice.



The terms HDMI and HDMI High-Definition Multimedia Interface, and the HDMI Logo are trademarks or registered trademarks of HDMI Licensing Administrator, Inc. in the United States and other countries.



The Bluetooth® word mark and logos are registered trademarks owned by Bluetooth SIG, Inc. and any use of such marks by The Singing Machine Company, Inc. is under license. Other trademarks and trade names are those of their respective owners.

Mises en Garde

	MISE EN GARDE RISQUE DE CHOC ÉLECTRIQUE NE PAS OUVRIR	
MISE EN GARDE: AFIN DE RÉDUIRE LE RISQUE D'ÉLECTROCUTION, NE PAS RETIRER LE COUVERCLE (OU LE DOS DU BOÎTIER). AUCUNE PIÈCE POUVANT ÊTRE RÉPARÉE PAR L'UTILISATEUR NE SE TROUVE À L'INTÉRIEUR. POUR TOUTE RÉPARATION, CONTACTER UN TECHNICIEN COMPÉTENT.		



TENSION DANGEREUSE : Le symbole de l'éclair dans un triangle équilatéral a pour but d'avertir l'utilisateur du danger présenté par des pièces non isolées à l'intérieur de l'appareil, dont la tension est suffisante pour provoquer des décharges électriques dangereuses.



ATTENTION : Le point d'exclamation à l'intérieur d'un triangle équilatéral a pour but d'avertir l'utilisateur de la présence de consignes importantes sur le fonctionnement et l'entretien (réparation) de l'appareil dans la documentation accompagnant ce produit.

AVERTISSEMENT D'ÉGOUTTEMENT : Ce produit ne doit pas être exposé à l'égouttement ni aux éclaboussures et aucun objet rempli de liquide, tel qu'un vase, ne doit être placé sur le produit.

AVERTISSEMENT D'AÉRATION : L'aération normale du produit ne doit pas être entravée pour l'usage prévu.

MISE EN GARDE : AFIN D'ÉVITER TOUT RISQUE D'ÉLECTROCUTION, JUMELER LA LARGE BROCHE DE LA FICHE À LA FENTE LA PLUS LARGE ET L'INSÉRER COMPLÈTEMENT.

AVERTISSEMENT : AFIN D'ENRAYER TOUT RISQUE D'ÉLECTROCUTION OU D'INCENDIE, NE PAS EXPOSER CET APPAREIL À LA PLUIE OU À L'HUMIDITÉ.

Énoncés d'avertissement d'exposition aux RF :

Cet équipement est conforme aux limites d'exposition aux rayonnements de la FCC définies pour un environnement non contrôlé. Cet équipement doit être installé et utilisé avec une distance minimale de 20 cm entre le radiateur et le corps.



Ce symbole sur le produit ou dans les instructions signifie que votre les équipements électriques et électroniques doivent être éliminés à la fin de leur vie séparément de vos ordures ménagères. Il y a une collecte séparée systèmes de recyclage dans l'UE.

Pour plus d'informations, veuillez contacter les autorités locales ou votre revendeur où vous avez acheté le produit.

Sous l'influence d'un phénomène électrostatique, le produit peut dysfonctionner et obliger l'utilisateur à réinitialiser.

MISE EN GARDE DE LA FCC: Cet appareil peut générer ou utiliser des fréquences radio. Les modifications ou changements peuvent causer des interférences nuisibles, à moins que ces modifications ne soient approuvées expressément dans ce mode d'emploi. L'utilisateur pourrait perdre l'autorité de faire fonctionner cet équipement en cas de modification non autorisée.

Cet appareil répond aux exigences de l'alinéa 15 des réglementations FCC. Son utilisation est soumise aux deux conditions suivantes : 1) Cet appareil ne peut pas causer d'interférence nuisible et 2), Cet appareil doit accepter toute interférence reçue, incluant les interférences qui pourraient affecter son fonctionnement.

REMARQUE : Suite aux tests effectués, il est établi que cet appareil numérique de Classe B répond aux exigences de l'alinéa 15 des réglementations FCC. Ces normes sont élaborées pour vous protéger contre toute interférence nuisible en installation résidentielle. Cet appareil génère, utilise et peut émettre des fréquences radio. Par conséquent, s'il n'est pas installé et utilisé en suivant les instructions, il peut causer des interférences nuisibles aux communications radio. Cependant, aucune garantie n'est donnée concernant la possibilité d'interférence avec une installation spécifique. Si une interférence se produisait en réception radio et/ou de télédiffusion, lors de l'activation et la désactivation de l'appareil, nous vous recommandons

- Réorientez ou déplacez l'antenne de réception.
- Éloignez l'appareil du récepteur.
- Branchez l'appareil à une prise de courant différente de celle utilisée par le récepteur.
- En cas de problème, contactez le vendeur ou un technicien spécialisé en réception radio/TV.

Le régime nominal est indiqué dans la partie inférieure de l'appareil.

Le présent appareil est conforme aux CNR d'Industrie Canada applicables aux appareils radio exempts de licence. L'exploitation est autorisée aux deux conditions suivantes:

- (1) l'appareil ne doit pas produire de brouillage, et
 - (2) l'utilisateur de l'appareil doit accepter tout brouillage radioélectrique subi, même si le brouillage est susceptible d' compromettre le fonctionnement.
- Cet équipement doit être installé et utilisé à une distance minimale de 20 cm entre le radiateur et votre corps.

Les changements ou modifications non approuvées par la partie responsable des conformités peuvent annuler les droits d'utilisation de la machine par l'utilisateur.

Renseignements Importants de Sécurité

1. Lisez ces instructions.
2. Conservez ces instructions.
3. Respectez toutes les mises en garde.
4. Suivez toutes les consignes.
5. N'utilisez pas cet appareil à proximité de l'eau.
6. Nettoyez l'appareil uniquement avec un chiffon sec.
7. Ne bloquez pas les ouvertures d'aération. Installez conformément selon les consignes du fabricant.
8. N'installez pas à proximité de sources de chaleur telles que les radiateurs, registres d'air chaud, cuisinières, ou autres appareils (notamment des amplificateurs) produisant de la chaleur.
9. Ne nuisez pas à la fonction de sécurité de la fiche polarisée ou de mise à la terre. Une fiche polarisée est dotée de deux broches dont l'une est plus large que l'autre. Une fiche de mise à la terre est dotée de deux broches et d'une troisième broche de mise à la terre. La broche la plus large ou la troisième broche est conçue pour votre sécurité. Lorsque la broche fournie ne convient pas à la prise, consultez un électricien afin de remplacer la prise défectueuse. (Pas applicable au modèle britannique et européen)
10. Protégez le cordon d'alimentation afin que personne ne marche dessus ou le pince, particulièrement au niveau des broches, de la prise et du point où ils sortent de l'appareil.
11. Utilisez seulement les accessoires spécifiés par le fabricant.
12. Utilisez seulement avec un chariot, une sellette, un trépied, un support ou une table. Lorsqu'un chariot est utilisé, prenez garde de ne pas déplacer la combinaison chariot/appareil pour éviter toute blessure causée par un renversement.
13. Débranchez cet appareil durant un orage ou lorsqu'il n'est pas utilisé pendant de longues périodes.
14. Confiez toutes les réparations à un technicien compétent. La réparation s'avère nécessaire lorsque l'appareil a été endommagé, par exemple, si le cordon d'alimentation ou la fiche a été endommagé, du liquide a été renversé ou des objets sont tombés dans l'appareil, ou si l'appareil a été exposé à la pluie ou à l'humidité, ne fonctionne pas normalement, ou a été échappé.
15. **AVERTISSEMENT :** Pour réduire le risque d'électrocution, évitez d'exposer l'appareil à la pluie ou à l'humidité. Ne déposez pas d'objets remplis d'eau, tels qu'un vase, sur l'appareil.
16. La fiche de secteur c.a. est utilisée pour débrancher l'appareil et doit être facilement accessible et utilisable durant l'usage prévu. Afin de couper complètement l'alimentation de l'appareil, la fiche de secteur doit être complètement débranchée de la prise c.a.
17. **MISE EN GARDE :** Afin de réduire le risque d'incendie ou d'explosion, n'exposez pas les piles à une source de chaleur excessive telle que le soleil, le feu ou autre.

ATTENTION CHARIOT DE
TRANSPORT
(symbole fourni par RETAC)



Visit Our Website: www.singingmachine.com
Visitez notre site Internet au: www.singingmachine.com

Copyright © 2022 - All Rights Reserved.
Droit d'auteur © 2022 - Tous Droits Réservés

Siinging Machine is distributed in the UK and Europe
by: 1994 Inc. Ltd.
Muiderstraat 9B, Amsterdam, 1011PZ Netherlands

The Singing Machine Company, Inc.
4060 E Jurupa Street, Unit B
Ontario, CA 91761-1413 USA

PRINTED IN CHINA
IMPRESO EN CHINA
IMPRIMÉ EN CHINE
3093SP-2212-EFGI01-SU