

CENTRIOS™ Instruction Manual 1419854

FM Transmitter with Memory slot and USB

Congratulations on purchasing your FM Transmitter. Follow these easy steps to get started.

Instructions for use:

- 1- Plug the FM transmitter into the DC jack of your automobile.
- 2- Adjust the channel on your FM transmitter to match the channel on your car stereo.
- 3- Plug in audio device using the 3.5 mm audio jack, SD/MMC card or USB flash drive.

Note: It is recommended to turn the volume to halfway on your music device and increase the volume on your car stereo to minimize interference. Gradually turn up the volume to the desired listening level.

For use with SD/MMC card and USB flash drive:

- 1- Insert SD/MMC card into the SD/MMC card slot of the transmitter where indicated.
Insert USB device into the USB port of the transmitter
- 2- The LCD will display the screen shown in Fig.1. Press the button once to start playing an MP3 file. Press again to pause.
- 3- Press the button once to advance to the next file.
Press and hold the button to increase the volume.
- 4- Press the button once to go to the previous file.
Press and hold the button to decrease the volume.

Fig.1 - LCD DISPLAY

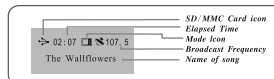

Features and Functions

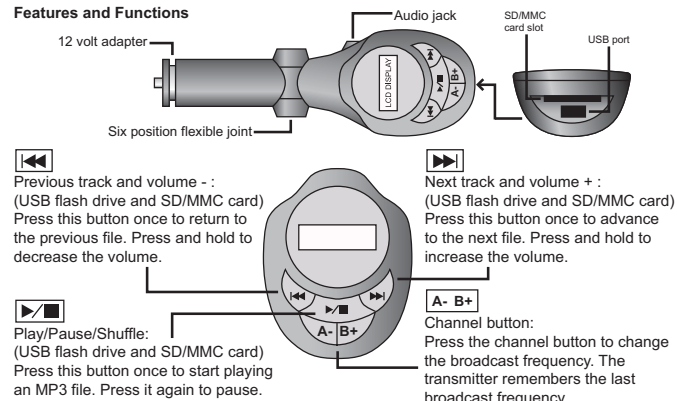

Trouble shooting:

- 1- Music is not clear or distorted: Music file may be corrupt.
- 2- Interference: Change channels on your FM transmitter and match the channel on your car stereo.
- 3- Music will not play: File type may not be supported (supports MP3, WMA files).
- 4- USB/MP3 players will not work with this FM transmitter.

FCC STATEMENT

1. This device complies with Part 15 of the FCC Rules.

Operation is subject to the following two conditions:

- (1) This device may not cause harmful interference, and
- (2) This device must accept any interference received, including interference that may cause undesired operation.

2. Changes or modifications not expressly approved by the party responsible for compliance could void the user's authority to operate the equipment.

Industry Canada Compliance

1. This device complies with Industry Canada licence-exempt RSS standard(s).

Operation is subject to the following two conditions:

- (1) This device may not cause interference, and
- (2) This device must accept any interference, including interference that may cause undesired operation of the device.

2. Changes or modifications not expressly approved by the party responsible for compliance could void the user's authority to operate the equipment.

LIMITED WARRANTY

THE SOURCE WARRANTY

The Source warrants that this product will be free from defects in materials and workmanship for a period of one (1) year from the date of purchase. Within this period, simply take the product and your proof of purchase to any The Source store or dealer and the product will be repaired without charge for parts and labour. The Source reserves the right to charge for transportation. Any product which has been subject to misuse or accidental damage is excluded from this warranty.

This warranty is only applicable to a product purchased through The Source company owned stores and dealers and to a product that is presented for repair in a country where The Source offers the product for sale. While this warranty does not confer any legal rights other than those set out above, you may have additional statutory rights which will vary under the laws of the various countries, states, province and other governmental entities in which The Source operates. This warranty is subject to all statutory rights you may have in the country of purchase.



Imported by:
The Source,
Barrie, Ontario, Canada, L4M 4W5
Manufactured in China

For product support please contact
www.thesource.ca



Please Recycle

Limited Warranty

© 2011 The Source.
All Rights Reserved.



IC Number: 255A-1419854