

RCA

2.4 Ghz Cordless Telephone and Wireless Headset with Call-Waiting/Caller ID User's Guide

Please read this manual
before operating this
product for the first time.



Model 25110

Equipment Approval Information

Your telephone equipment is approved for connection to the Public Switched Telephone Network and is in compliance with parts 15 and 68, FCC Rules and Regulations and the Technical Requirements for Telephone Terminal Equipment published by ACTA.

1 Notification to the Local Telephone Company

On the bottom of this equipment is a label indicating, among other information, the US number and Ringer Equivalence Number (REN) for the equipment. You must, upon request, provide this information to your telephone company.

The REN is useful in determining the number of devices you may connect to your telephone line and still have all of these devices ring when your telephone number is called. In most (but not all) areas, the sum of the RENs of all devices connected to one line should not exceed 5. To be certain of the number of devices you may connect to your line as determined by the REN, you should contact your local telephone company.

A plug and jack used to connect this equipment to the premises wiring and telephone network must comply with the applicable FCC Part 68 rules and requirements adopted by the ACTA. A compliant telephone cord and modular plug is provided with this product. It is designed to be connected to a compatible modular jack that is also compliant. See installation instructions for details.

Notes

- This equipment may not be used on coin service provided by the telephone company.
- Party lines are subject to state tariffs, and therefore, you may not be able to use your own telephone equipment if you are on a party line. Check with your local telephone company.
- Notice must be given to the telephone company upon permanent disconnection of your telephone from your line.
- If your home has specially wired alarm equipment connected to the telephone line, ensure the installation of this product does not disable your alarm equipment. If you have questions about what will disable alarm equipment, consult your telephone company or a qualified installer.

2 Rights of the Telephone Company

Should your equipment cause trouble on your line which may harm the telephone network, the telephone company shall, where practicable, notify you that temporary discontinuance of service may be required. Where prior notice is not practicable and the circumstances warrant such action, the telephone company may temporarily discontinue service immediately. In case of such temporary discontinuance, the telephone company must: (1) promptly notify you of such temporary discontinuance; (2) afford you the opportunity to correct the situation; and (3) inform you of your right to bring a complaint to the Commission pursuant to procedures set forth in Subpart E of Part 68, FCC Rules and Regulations.

The telephone company may make changes in its communications facilities, equipment, operations or procedures where such action is required in the operation of its business and not inconsistent with FCC Rules and Regulations. If these changes are expected to affect the use or performance of your telephone equipment, the telephone company must give you adequate notice, in writing, to allow you to maintain uninterrupted service.

Interference Information

This device complies with Part 15 of the FCC Rules. Operation is subject to the following two conditions: (1) This device may not cause harmful interference; and (2) This device must accept any interference received, including interference that may cause undesired operation.

This equipment has been tested and found to comply with the limits for a Class B digital device, pursuant to Part 15 of the FCC Rules. These limits are designed to provide reasonable protection against harmful interference in a residential installation.

This equipment generates, uses, and can radiate radio frequency energy and, if not installed and used in accordance with the instructions, may cause harmful interference to radio communications. However, there is no guarantee that interference will not occur in a particular installation.

If this equipment does cause harmful interference to radio or television reception, which can be determined by turning the equipment off and on, the user is encouraged to try to correct the interference by one or more of the following measures:

- Reorient or relocate the receiving antenna (that is, the antenna for radio or television that is "receiving" the interference).
- Reorient or relocate and increase the separation between the telecommunications equipment and receiving antenna.
- Connect the telecommunications equipment into an outlet on a circuit different from that to which the receiving antenna is connected.

If these measures do not eliminate the interference, please consult your dealer or an experienced radio/television technician for additional suggestions. Also, the Federal Communications Commission has prepared a helpful booklet, "How To Identify and Resolve Radio/TV Interference Problems." This booklet is available from the U.S. Government Printing Office, Washington, D.C. 20402. Please specify stock number 004-000-00345-4 when ordering copies.

FCC RF Radiation Exposure Statement

This equipment complies with FCC RF radiation exposure limits set forth for an uncontrolled environment. This equipment should be installed and operated with a minimum distance of 20 centimeters between the radiator and your body. This transmitter must not be co-located or operated in conjunction with any other antenna or transmitter."

For body worn operation, this phone has been tested and meets the FCC RF exposure guidelines when used with the belt clip supplied with this product. Use of other accessories may not ensure compliance with FCC RF exposure guidelines.

Licensing

Licensed under US Patent 6,427,009.

Hearing Aid Compatibility

This telephone system meets FCC standards for Hearing Aid Compatibility.

US NUMBER IS LOCATED ON THE CABINET BOTTOM
REN NUMBER IS LOCATED ON THE CABINET BOTTOM

Table of Contents

EQUIPMENT APPROVAL INFORMATION	2	HANDSET SET UP	18
INTERFERENCE INFORMATION	3	DISPLAY LANGUAGE.....	18
FCC RF RADIATION EXPOSURE STATEMENT	3	TONE/PULSE DIALING	18
LICENSING	3	AREA CODE.....	18
HEARING AID COMPATIBILITY	3	RINGER TONE	19
INTRODUCTION	6	RINGER VOLUME.....	19
PARTS CHECKLIST.....	7	DEFAULT SETTING SELECTION	19
IMPORTANT INSTALLATION INFORMATION	8	TELEPHONE OPERATION	20
SAFETY PRECAUTIONS	8	MAKING A CALL	20
INSTALLATION GUIDELINES.....	8	On the Handset	20
TELEPHONE JACK REQUIREMENTS.....	9	On the Headset.....	20
HEADSET SET UP	10	ANSWERING A CALL.....	20
HEADBAND ATTACHMENT.....	10	On the Handset	20
To switch from ear to ear.....	11	On the Headset.....	20
EAR CLIP ATTACHMENT	12	CALL TRANSFER	21
To switch from ear to ear.....	12	MUTE.....	21
PHONE INSTALLATION.....	13	REDIAL	21
CONNECTING THE AC (ELECTRICAL) POWER	13	FLASH	22
Charger unit	13	EXIT	22
Wall base unit	13	HANDSET VOLUME	22
CONNECTING THE TELEPHONE LINE.....	13	HEADSET VOLUME.....	22
INSTALLING THE BATTERIES.....	14	To Adjust Volume from Headset:	22
Installing the Handset Battery	14	To Adjust Volume from Handset:.....	22
Installing the Earpiece Battery.....	15	PAGING THE HANDSET AND HEADSET	23
HANDSET LAYOUT	16	IN USE INDICATOR LIGHT	23
HEADSET LAYOUT.....	17	On the Handset	23
		On the Headset.....	23
		CHARGER INDICATOR LIGHT	23
		CALL TIMER.....	24
		TEMPORARY TONE DIALING.....	24

CALLER ID	25	BATTERY SAFETY PRECAUTIONS	33
CALLER ID WITH CALL WAITING.....	25	DISPLAY MESSAGES	34
RECEIVING AND STORING CALLS.....	25	HANDSET SOUND SIGNALS.....	35
REVIEWING RECORDS	25	CALLER ID	35
TRANSFERRING CID RECORDS TO MEMORY.....	26	No display.....	35
DELETING RECORDS.....	26	Caller ID error message.....	36
DELETING THE CURRENT RECORD	26	TELEPHONE	36
DELETING ALL RECORDS.....	27	No dial tone.....	36
DIALING A CALLER ID NUMBER	27	TROUBLESHOOTING TIPS.....	37
CHANGING THE CID NUMBER FORMAT.....	27	GENERAL PRODUCT CARE	38
MEMORY	28	CAUSES OF POOR RECEPTION	38
STORING A NAME AND NUMBER IN MEMORY	28	INTERFERENCE INFORMATION.....	39
VIEWING A STORED NUMBER.....	29	SERVICE	40
CHANGING A STORED NUMBER.....	29	LIMITED WARRANTY	41
STORING A REDIAL NUMBER.....	29		
DIALING A STORED NUMBER	30		
INSERTING A PAUSE IN THE DIALING SEQUENCE OF A STORED NUMBER	30		
REVIEWING AND DELETING STORED NUMBERS	30		
HEADSET AND BELT CLIP OPERATION.....	31		
CONNECTING AN OPTIONAL HEADSET TO THE HANDSET	31		
ATTACHING THE BELT CLIP.....	31		
REPLACING THE BATTERIES	32		
HANDSET BATTERY	32		
HANDSET MEMORY RETENTION	32		
HEADSET BATTERY.....	33		

Important Information

Introduction



CAUTION: *When using telephone equipment, there are basic safety instructions that should always be followed. Refer to the IMPORTANT SAFETY INSTRUCTIONS provided with this product and save them for future reference.*

Your Caller ID phone stores and displays information provided by your local telephone company, to subscribers of Caller ID or similar caller identification services.

Your Caller ID phone enables you to:



- Identify callers before you answer the phone.
- View the time and date of each incoming call.
- Record up to 99 Caller ID messages sequentially.
- Know who called while you were away.

To get the most from your new phone, we suggest that you take a few minutes right now to read through this user's guide.

IMPORTANT: *In order to use all of the features of this unit, you must subscribe to either the standard Name/Number Caller ID Service or Call Waiting Caller ID Service. To know who is calling while you are on the phone, you must subscribe to Call Waiting Caller ID Service.*

IMPORTANT: *Because cordless phones operate on electricity, you should have at least one phone in your home that isn't cordless, in case the power in your home goes out.*

WARNING: TO PREVENT FIRE OR ELECTRICAL SHOCK HAZARD, DO NOT EXPOSE THIS PRODUCT TO RAIN OR MOISTURE.

 <p>THE LIGHTNING FLASH AND ARROW HEAD WITHIN THE TRIANGLE IS A WARNING SIGN ALERTING YOU OF "DANGEROUS VOLTAGE" INSIDE THE PRODUCT.</p>	<p>CAUTION: RISK OF ELECTRIC SHOCK DO NOT OPEN</p> <p>CAUTION: TO REDUCE THE RISK OF ELECTRIC SHOCK, DO NOT REMOVE COVER (OR BACK). NO USER SERVICEABLE PARTS INSIDE. REFER SERVICING TO QUALIFIED SERVICE PERSONNEL.</p>	 <p>THE EXCLAMATION POINT WITHIN THE TRIANGLE IS A WARNING SIGN ALERTING YOU OF IMPORTANT INSTRUCTIONS ACCOMPANYING THE PRODUCT.</p>
SEE MARKING ON BOTTOM / BACK OF PRODUCT		

Parts Checklist

Make sure your package includes the following items:

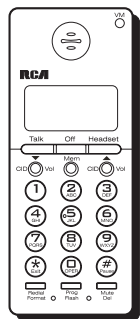

Handset

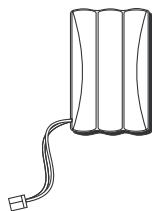

Handset battery

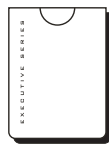

Battery compartment cover

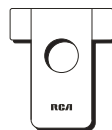

Belt clip

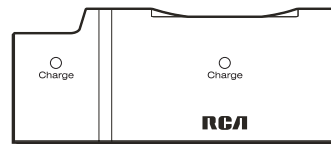

Charger

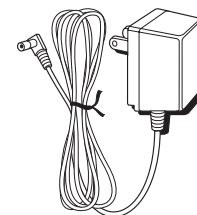

AC power adaptor

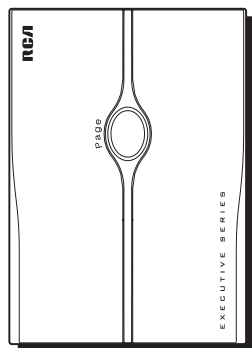

Wall base

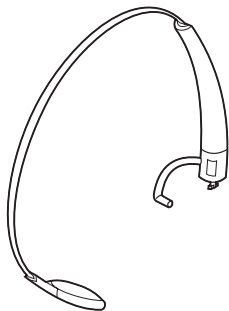

Headband



Headset

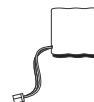

Headset battery



Ear clip



Ear clip ring



Telephone line cord

Important Installation Information

Safety Precautions

- Never install telephone wiring during a lightning storm.
- Never install telephone jacks in wet locations unless the jack is specifically designed for wet locations.
- Never touch non-insulated telephone wires or terminals, unless the telephone line is disconnected from the network.
- Use caution when installing or modifying telephone lines.
- Temporarily disconnect any equipment connected to the phone such as faxes, other phones, or modems.

Installation Guidelines

- Install the wall base unit into an electrical outlet that is near a telephone (modular) jack.
- Avoid sources of noise, such as a window by a busy street, and electrical noise, such as motors, microwave ovens, and fluorescent lighting.
- Avoid heat sources, such as heating air ducts, heating appliances, radiators, and direct sunlight.
- Avoid areas of excessive moisture or extremely low temperature.
- Avoid dusty locations.
- Avoid other cordless telephones or personal computers.



CAUTION: Always disconnect all phone cords from the base unit before battery installation or replacement.

INSTALLATION NOTE: Some cordless telephones operate at frequencies that may cause or receive interference with TVs, microwave ovens, and VCRs. To minimize or prevent such interference, the base of the cordless telephone should not be placed near or on top of a TV, microwave ovens, or VCR. If such interference continues, move the cordless telephone farther away from these appliances. Certain other communications devices may also use the 2.4GHz frequency for communication, and, if not properly set, these devices may interfere with each other and/or your new telephone. If you are concerned with interference, please refer to the owner's manual for these devices on how to properly set channels to avoid interference. Typical devices that may use the 2.4GHz frequency for communication include wireless audio/video senders, wireless computer networks, multi-handset cordless telephone systems, and some long-range cordless telephone systems.

Wall plate

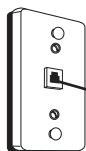

Modular telephone
line jack

Telephone Jack Requirements

To use this phone, you will need an RJ11C type modular phone jack, which might look like the one pictured here, installed in your home. If you don't have a modular jack, call your local phone company to find out how to get one installed.

Headset Set Up

Headband Attachment

1. Hold the headband and insert it into keyed slot marked with an arrow on the headset.

NOTE: *To ensure proper installation, the connector is keyed and can only be inserted one way*

2. Rotate the L-shaped band 90 degrees clockwise.
3. Align the L-shaped band into the hole on the headset.

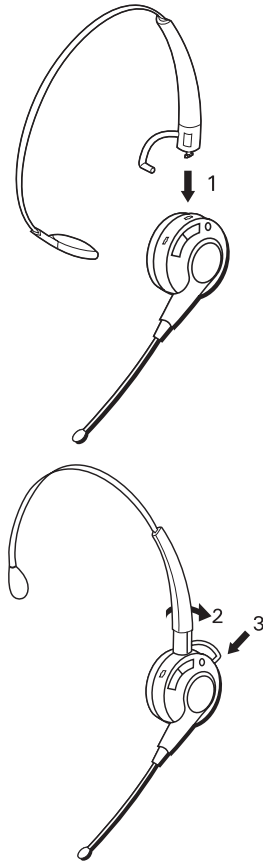



To switch from ear to ear

Rotate microphone boom to reposition nearer to mouth.

Ear Clip Attachment

1. Attach the ear clip ring to the headset and ensure all three contact points align and are engaged.

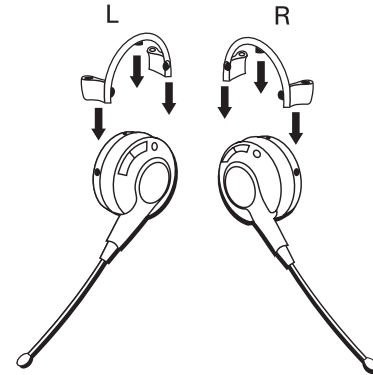

2. Insert ear clip into either side of ear clip ring, matching with the "L" or "R" marked on ear clip ring to fit either your left or right ear.

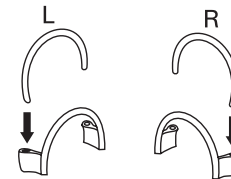

To switch from ear to ear

Unplug the ear clip from ear clip ring.

Insert the ear clip to ear clip ring with "L" mark for Left ear.

Insert the ear clip to "R" mark for Right ear.

Rotate microphone boom to reposition nearer to mouth.

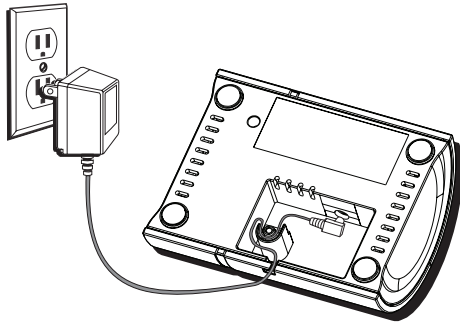

Phone Installation

Connecting the AC (Electrical) Power

Charger unit

Plug the AC power adaptor into an electrical outlet and the DC connector into the bottom of the charger.



CAUTION: Only use the ATLINKS USA, Inc. 5-2678 power converter that came with this unit. Using other power converters may damage the charger unit.

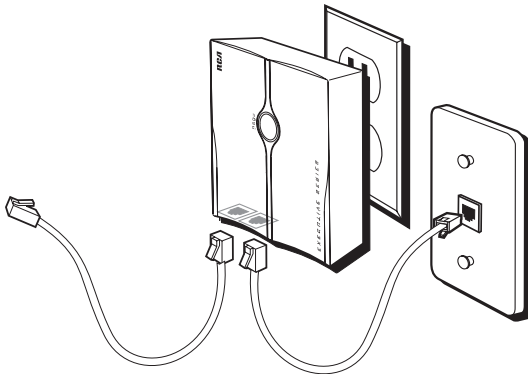

Wall base unit

To install your wall base unit, locate an electrical outlet with a phone jack nearby.

1. Plug the wall base unit into an electrical outlet.
2. Make sure that the pins are inserted fully and firmly into the outlet. If not, choose another electrical outlet.

Connecting the Telephone Line

There are two jacks on the bottom of the wall base unit.

Plug one end of the telephone line cord into the LINE jack on the bottom of the wall base unit and the other end into a modular jack.

The PHONE jack may be used to connect a parallel phone by connecting a second telephone line cord from the PHONE jack on the bottom of the wall base unit to the parallel phone.

Connections & Setup

Installing the Batteries

Installing the Handset Battery

NOTE: *You must connect the handset battery before use.*

1. Locate battery and battery door which are packaged together inside a plastic bag and are separate from the handset.
2. Locate the battery compartment on the back of the handset.
3. Plug the battery pack cord into the jack inside the compartment.

NOTE: *It is important to maintain the polarity (black and red wires) to the jack inside the compartment. To ensure proper battery installation, the connector is keyed and can be inserted only one way.*

4. Insert the battery pack.
5. Close the battery compartment by pushing the door up until it snaps into place.
6. Place the **handset** in the charging cradle.

Allow the handset to charge for 16 hours prior to first use. If you don't properly charge the **handset**, battery performance is compromised.



CAUTION: *To reduce the risk of fire or personal injury, only use the ATLINKS Ni-MH battery model 5-2683.*

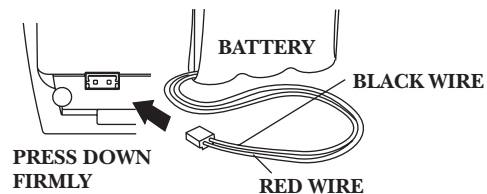

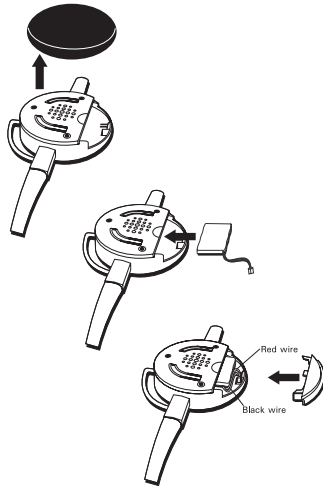

Installing the Earpiece Battery

NOTE: You must connect the earpiece battery before use.

1. Locate the battery compartment inside the headset.
2. Plug the battery pack cord into the jack inside the compartment.

NOTE: It is important to maintain the polarity (black and red wires) to the jack inside the compartment. To ensure proper battery installation, the connector is keyed and can be inserted only one way.

4. Insert the battery pack.
5. Close the battery compartment by pushing the door up until it snaps into place.
6. Place the headset in the charging cradle.

Allow the headset to charge for 16 hours prior to first use. If you don't properly charge the headset, battery performance is compromised.



CAUTION: To reduce the risk of fire or personal injury, only use ATLINKS Li-polymer battery model 5-2682.

Handset Layout

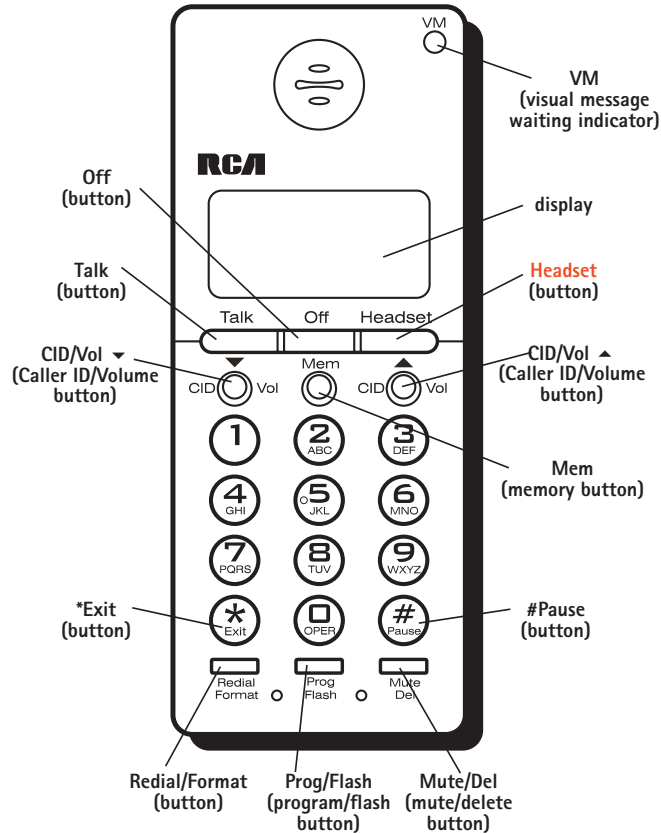

Headset Layout

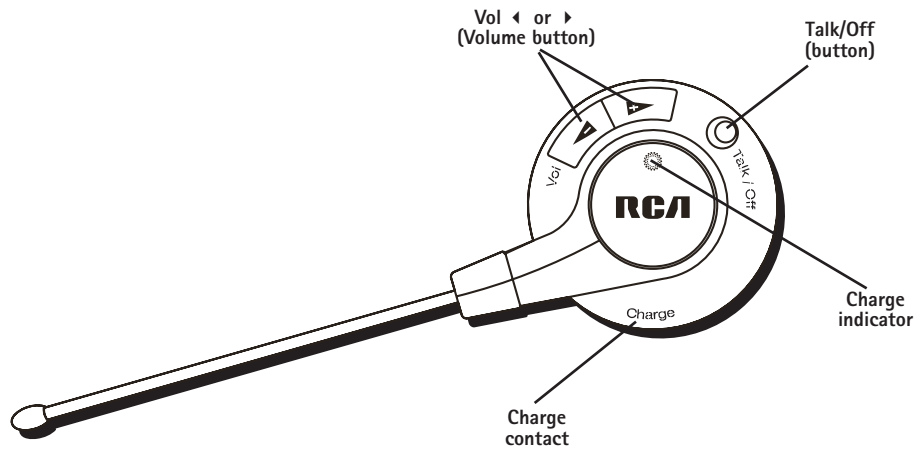

Handset Set Up

There are **six** programmable menus available: Display Language, Tone/Pulse Dialing Local Area Code, Ringer Tone, Ringer Volume and Factory Default. When you program these settings, make sure the phone is **OFF** (not in talk mode). Pressing the *Exit button will remove you from the menu selection process without changing the feature you are in.

Display Language

1. Press the **Prog/Flash** button until *1ENG 2FRA 3ESP* shows in the display.
2. Use the **CID/Vol (▲ or ▼)** buttons or the handset number pad to select 1.ENGLISH, 2.FRANCAIS, or 3.ESPANOL. The default setting is "1.ENGLISH".
3. Press the **Prog/Flash** button to confirm. You will hear a confirmation tone.



1ENG 2FRA 3ESP

Tone/Pulse Dialing

1. Press the **Prog/Flash** button until *1TONE 2PULSE* shows in the display.
2. Use the **CID/Vol (▲ or ▼)** buttons or the handset number pad to select (1) TONE or (2) PULSE. The default setting is "TONE".
3. Press the **Prog/Flash** button to confirm. You will hear a confirmation tone.



1TONE 2PULSE

Area Code

1. Press the **Prog/Flash** button until *--- SET AREA CODE* shows in the display.
2. Use the handset touch-tone pad to enter your three digit area code. "- - -" is the default setting.
4. Press the **Prog/Flash** button to confirm. You will hear a confirmation tone.



SET AREA CODE



RINGER TONE ▶ 1



RINGER VOL ▶ 1HI

Ringer Tone

1. Press the **Prog/Flash** button until *RINGER TONE 1* shows in the display.
2. Use the **CID/Vol (▲ or ▼)** buttons or the handset number pad to select **and listen** to a ringer tone. There are seven ringer tones to choose from. The default setting is "1".
3. Press the **Prog/Flash** button to confirm. You will hear a confirmation tone.

Ringer Volume

1. Press the **Prog/Flash** button until *RINGER VOL 1HI* shows in the display.
2. Use the **CID/Vol (▲ or ▼)** buttons or the handset number pad to select 1 (HI), 2 (LOW), or 3 (OFF). The default setting is "1HI".
3. Press the **Prog/Flash** button to confirm. You will hear a confirmation tone.

Default Setting Selection

1. Press the **Prog/Flash** button until *DEFAULT SETTING* shows in the display.
2. Use the **CID/Vol (▲ or ▼)** buttons or the handset number pad to select 1 (NO), or 2 (YES). The default setting is "NO". If you choose NO, the current settings remain. If you choose YES, the unit resets to the factory default.
3. Press the **Prog/Flash** button to confirm.

Telephone Operation

Making a Call

On the Handset

1. Press the Talk button on the handset to get a dial tone.
2. When finished, press the Off button on the handset to hang up.

On the Headset

1. Press the Talk/Off button on the headset OR the Headset button on the handset to get a dial tone.
2. When finished, press the Off button on the handset OR the Talk/Off button on the headset to hang up.

Answering A Call

On the Handset

1. When the phone rings, pick up the handset and press the Talk button to answer the call.
2. When finished, press Off button on the handset to hang up.

On the Headset

1. When the phone rings, pick up the headset and press the Talk/Off button OR press the Headset button on the handset to answer the call.
2. When finished, press the Talk/Off button on the headset OR the Off button on the handset to hang up.



Call Transfer

During a call this feature allows you to transfer the call back and forth from handset to headset.

1. Press the Headset button on the handset or the Talk/Off button on the headset, the call will then be transferred from handset to headset.
2. Press the Talk button on the handset, the call will then be transferred back from headset to handset.

Mute

To have a private, off-line conversation use the mute feature. The party on the telephone line will not hear you, but you can still hear them.

On the Handset or Headset

1. Press the Mute/Del button on the handset. *MUTE ON* will blink intermittently, along with the call status, in the display on the handset.
2. Press the Mute/Del button again to cancel mute and return to your phone conversation.

Redial

When the phone is on (in TALK mode), press the Redial/Format button to redial the last number you dialed (up to 32 digits). If you get a busy signal, and want to keep dialing the number, just press Redial/Format again (you do not have to turn the phone off and back on).

Operation

Flash

Use the **Prog/Flash** button to activate custom calling services such as call waiting or call transfer, which are available through your local phone company.

*TIP: Do not use the **Talk** button to activate custom calling services such as call waiting, or you will hang up the phone.*

Exit

Press the ***Exit** button to cancel any command you initiated.

Handset Volume

While talking, press the **CID/Vol (▲ or ▼)** buttons to adjust the listening level of the handset's earpiece. There are four volume levels. Press the **▲** button to increase the volume level, and press the **▼** button to decrease. VOL 1 is the lowest level and VOL 4 is the loudest.

Headset Volume

To Adjust Volume from Headset:

While talking, the headset receiver volume can be adjusted by pressing the **Vol (◀ or ▶)** buttons. The volume can be increased or decreased, step by step up to 4 levels. When maximum level or minimum level is reached, an error tone is emitted. The last setting is kept when re-cradled. The headset volume level shows on the handset LCD.

To Adjust Volume from Handset:

The headset receiver volume shall be adjusted by pressing the **CID/Vol (▲ or ▼)** buttons on handset. The volume is increased or decreased step by step up to 4 levels. The volume level shows on handset. The last setting is kept when re-cradled.

Paging the Handset and Headset

Press the Page button on the wall base. The handset and headset will beep and the in use indicators on both will flash for two minutes (or until page is terminated.)

To terminate page signal:

Press the Page button on the wall base.

OR

Press any button on the handset or headset.

NOTE: *If there is an incoming call, the handset will automatically terminate the page signal and play ring tone.*

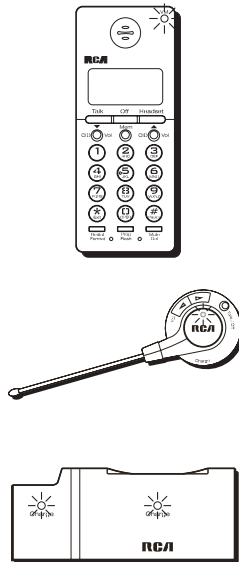

In Use Indicator Light

On the Handset

The handset in use indicator light is lit when the handset is on. It flashes when a call is received, if there is a Message Waiting (VM) or if the Page button on wall base is pressed.

On the Headset

The headset in use indicator light is lit when the headset is on. It flashes when a call is received, if the Page button on the wall base is pressed, if you have a low battery or are attempting to charge the unit without a battery.

Charger Indicator Light

The charge indicator light is lit when the handset or headset is charging in its cradle on the charger.

Call Timer

The built-in call timer shows in the display and counts the call time in minutes and seconds.

Temporary Tone Dialing

This feature is useful only if you use pulse dialing service. Temporary tone dialing enables pulse (rotary) service phone users to access touch-tone services offered by banks, credit card companies, etc. For example, when you call your bank you may need to enter your account number. Using the temporary tone feature allows you to temporarily switch to touch-tone mode so you can enter and send your number.

1. Press the **Talk** button, dial the telephone number (i.e. bank or credit card company), and wait for the line to connect.
2. When your call is answered, press the ***Exit** button on your handset number pad to temporarily change from pulse dialing to tone dialing.
3. Follow the automated instructions to get the information you need.
4. Hang up the handset and the phone automatically returns to pulse (rotary) dialing mode.

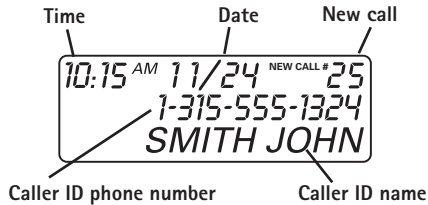

Caller ID

This unit receives and displays information transmitted by your local phone company. This information can include the phone number, date, and time; or the name, phone number, date, and time. The unit can store up to **99** calls for later review.

Caller ID with Call Waiting

Provided you subscribe to Caller ID with Call Waiting service from your phone company, you are able to see who is calling when you hear the call waiting beep. The caller identification information appears in the display after you hear the tone.

- Press the **Prog/Flash** button to put the current person on hold so that you can answer the incoming call.

IMPORTANT: *In order to use the Caller ID functions with this unit, you must subscribe to either the standard Name/Number Caller ID Service or Call Waiting Caller ID Service. To know who is calling while you are on the phone, you must subscribe to Call Waiting Caller ID Service.*

Receiving and Storing Calls

When you receive a call, the information is transmitted by the phone company to your Caller ID telephone between the first and second ring.

When the memory is full, a new call automatically replaces the oldest call in memory. **NEW** appears in the display for calls received that have not been **reviewed**.

NOTE: *Check with your local phone company regarding name service availability.*

Reviewing Records

As calls are received and stored, the display is updated to let you know how many calls have been received.

- Press the **CID/Vol** ▼ button to scroll through the call records from the most recent to the oldest.
- Press the **CID/Vol** ▲ button to scroll through the call records from the oldest to the newest.

Transferring CID Records to Memory

You may transfer a Caller ID record to your phone's memory.

NOTE: It is important that you format CID records correctly before storing in memory. It is not possible to re-format CID records stored in memory.

1. Use the **CID/Vol** (▲ or ▼) buttons to scroll to the record.
2. Press the **Mem** button.
3. Press the memory location buttons. You will hear a confirmation tone. For example, press the number 0 and 1 keys to store the record in memory location 01.

To replace a CID record stored in a memory location with a new CID record:

1. Repeat steps 1 through 3.
2. *REPLACE MEMO?* shows in the display.
3. Press the ***Exit** button to exit, or press **Mem** again and the new CID record replaces the old CID record in that memory location. You will hear a confirmation tone.

Deleting Records

Use the **Mute/Del** button to erase the record currently shown in the display or all records.

Deleting the Current Record

1. Make sure the phone is **OFF** (not in **TALK** mode).
2. Use the **CID/Vol** (▲ or ▼) buttons to scroll to the Caller ID record you want to delete.
3. Press **Mute/Del** button. The display shows *DELETE?*
4. Press **Mute/Del** again to erase the record. You will hear a confirmation tone. The display shows *DELETED*. Then the next Caller ID record shows in the display.

Deleting All Records

1. Make sure the phone is OFF (not in TALK mode).
2. Use the CID/Vol (▲ or ▼) buttons to display any Caller ID record.
3. Press and hold the Mute/Del button until the unit beeps and *DELETE ALL?* shows in the display.
4. Press Mute/Del again to erase all records. You will hear a confirmation tone, and the display shows *NO CALLS*.

Dialing a Caller ID Number

1. Make sure the phone is OFF (not in TALK mode).
2. Use the CID/Vol (▲ or ▼) buttons to display the Caller ID record you want to dial.
3. Press the Talk or Headset button on the handset. The number dials automatically.

Changing the CID Number Format

The format button lets you change the format of the displayed CID number. The available formats are as follows.

- 7-digit 7-digit telephone number.
- 10-digit 3-digit area code + 7-digit telephone number.
- 11-digit long distance code "1" + 3-digit area code + 7-digit telephone number.

1. Use the CID/Vol (▲ or ▼) buttons to scroll to the number you want to call back.
2. If the number does not dial as shown, press the format button. Repeat if necessary, until the correct number of digits show in the display.
3. Press the Talk or Headset button on the handset. The number dials automatically.

Memory

Store up to **50** 24-digit numbers in memory for quick dialing. This memory feature is in addition to the **99** Caller ID records that can be stored in the Caller ID memory log.

Storing a Name and Number in Memory

1. Make sure the phone is **OFF** (not in TALK mode).
2. Press the **Mem** button.
3. Press the memory location button (**01** through **50** records).
4. Press the **Mem** button again. The display shows *ENTER NAME* (up to 15 characters).

NOTE: *If you don't want to enter the name, skip to step 5.*

For example, to enter the name Bill Smith, press the two key twice for the letter B, press the four key three times for the letter l, and press the five key three times for the letter L. After one second, press the five key three times again for the second letter L and press the one key to insert a space between the letter L and S. Press the seven key four times for the letter S, press the six key once for the letter M, press the four key three times for the letter l, press the eight key once for the letter T, and press the four key twice for the letter H.

NOTE: *If you make a mistake, press the del button to erase a wrong letter, and re-enter the correct letter.*

5. Press the **Mem** button to save the name. The display shows *ENTER TEL NUMBR*.
6. Use the handset touch-tone pad to enter the telephone number (up to 24 digits) you want to store.
7. Press **Mem** again to store the number. You will hear a confirmation tone.

Viewing a Stored Number

When handset or headset is ON (in TALK mode), press the Mem button on the handset and key in number 01 to 50 or use the CID/Vol (▲ or ▼) buttons to scroll to the number you want to view.

Changing a Stored Number

1. Repeat steps 1 through 6 in Storing a Name and Number in Memory.
2. Press the Mem button and *REPLACE MEMO?* shows in the display.
3. Press the *Exit button to exit, or press the Mem button to store the number. You will hear a confirmation tone.

Storing a Redial Number

1. Repeat steps 1 through 5 in Storing a Name and Number in Memory.
2. Press the Redial/Format button.
3. Press the Mem button to store the number. You will hear a confirmation tone.

To replace an old redial number stored in a memory locations with a new redial number:

1. Repeat steps 1 through 5 in Storing a Name and Number in Memory.
2. Press the Redial/Format button.
3. Press the Mem button and *REPLACE MEMO?* shows in the display.
4. Press *Exit to exit, or press the mem button again and the new redial number replaces the old redial number in that memory location. You will hear a confirmation tone.

Dialing a Stored Number

1. Make sure the handset or headset is **ON** (in TALK mode) by pressing the Talk or Headset button on the handset or the Talk/Off button on the headset.
2. Press the **Mem** button.
3. Press the memory location button (01 through 50 records).
4. Press the **Talk or Headset button on the handset**. The number dials automatically.

- OR -

1. Make sure the **handset or headset** is **OFF** (not in TALK mode).
2. Press **Mem** button.
3. Use the **CID/Vol (▲ or ▼)** buttons to scroll to the number you want to dial.
4. Press the **Talk or Headset button on the handset**. The number dials automatically.

Inserting a Pause in the Dialing Sequence of a Stored Number

When a pause is needed to wait for a dial tone, press the **#Pause** button twice within one second (for example, when you must dial 9 for an outside line or to wait for a computer access tone.) A "pause" in the dialing sequence shows in the display as a "P." Each pause counts as 1 digit in the dialing sequence.

Reviewing and Deleting Stored Numbers

1. Press the **Mem** button.
2. Use the **CID/Vol (▲ or ▼)** buttons to scroll to the number.
3. To delete the number, press the **Mute/Del** button. The display shows *DELETE?*

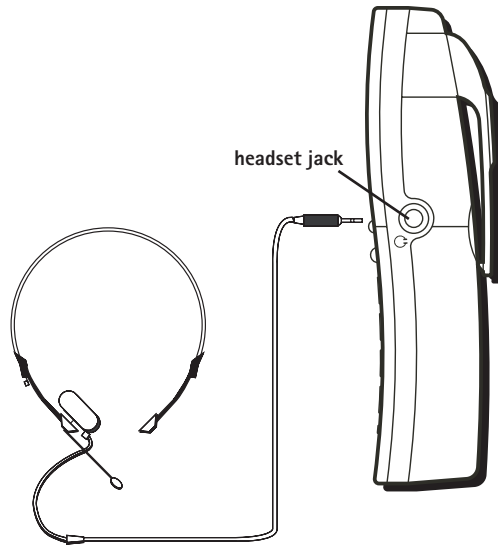

4. Press **Mute/Del** again to delete the number. *DELETED* shows in the display.

Headset and Belt Clip Operation

Connecting an Optional Headset to the Handset

1. Connect the headset (optional) to the HEADSET jack as shown. The handset receiver and microphone are disabled when the headset is connected.

TIP: To order a headset, please refer to the accessory order form at the end of this user's guide.

2. Adjust the headset to rest comfortably on top of your head and over your ear. Move the microphone to approximately 2 to 3 inches from your mouth.
3. Press the Talk button to answer or place a call.
4. To return to normal operation, unplug the headset from the jack.

Attaching the Belt Clip

1. Insert the sides of the belt clip into the slots on each side of the handset.

Other Information

2. Snap the ends of the belt clip into place.

Replacing the Batteries

Handset Battery

1. Make sure the telephone is OFF (not in TALK mode) before you replace battery.
2. Remove the battery compartment door.
3. Disconnect the cord attached to the battery pack from the jack inside the battery compartment and remove the battery pack.
4. Insert the new battery pack and connect the plug on the battery pack to the jack inside the compartment.

NOTE: It is important to maintain the polarity (black and red wires) to the jack inside the compartment. To ensure proper battery installation, the connector is keyed and can be inserted only one way.

5. Close the battery compartment by pushing the door up until it snaps into place.
6. Place the handset in the charging cradle.

Allow the handset battery to properly charge (for 16 hours) prior to first use or when you install a new battery pack. If you do not properly charge the phone, battery performance will be compromised.

CAUTION: To reduce the risk of fire or personal injury, only use ATLINKS Ni-MH-battery model 5-2683.

Handset Memory Retention

When battery is disconnected the handset has the capability to hold the user

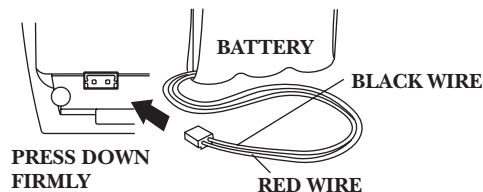

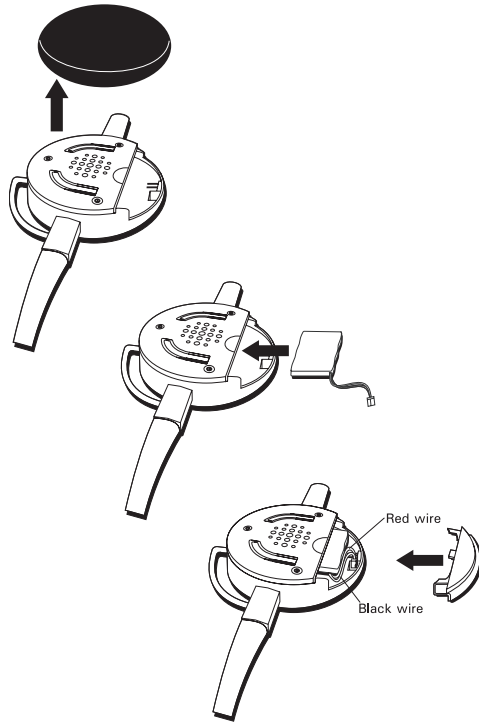

memory and Caller ID memory for up to 5 minutes.

Headset Battery

1. Make sure the telephone is OFF (not in TALK mode) before you replace battery.
2. Remove the foam cover and open the battery compartment door on the headset.
3. Disconnect the cord attached to the battery pack from the jack inside the battery compartment and remove the battery pack.
4. Insert the new battery pack and connect the plug on the battery pack to the jack inside the compartment.

NOTE: It is important to maintain the polarity (black and red wires) to the jack inside the compartment. To ensure proper battery installation, the connector is keyed and can be inserted only one way.

5. Close the battery compartment by snapping the cover into place.
6. Place the headset in the charging cradle.

Allow the headset battery to properly charge (for 16 hours) prior to first use or when you install a new battery pack. If you do not properly charge the phone, battery performance will be compromised.

CAUTION: To reduce the risk of fire or personal injury, only use ATLINKS Li-polymer battery model 5-2682.

Battery Safety Precautions

- Do not burn, disassemble, mutilate, or puncture. Like other batteries of this type, toxic materials could be released which can cause injury.
- To reduce the risk of fire or personal injury, use only the battery listed in the User's Guide.
- Keep batteries out of the reach of children.

Other Information

- Remove batteries if storing over 30 days.

Display Messages

The following indicators show the status of a message or of the unit.

BLOCKED CALL	The person is calling from a number that has been blocked from transmission.
BLOCKED NAME	The person's name is blocked from transmission.
DELETE?	Prompt asking if you want to erase Caller ID records or one of the 50 numbers stored in the phone's outgoing memory.
DELETE ALL?	Prompt asking if you want to erase all Caller ID records.
DELETED	Prompt confirming the Caller ID /Memory record is erased.
EMPTY	Indicates a memory location is vacant.
END OF LIST	Indicates there is no additional information in Caller ID memory.
ENTER NAME	Prompt telling you to enter the name for one of the 10 memory locations.
ENTER TEL NUMBR	Prompt telling you to enter the telephone number for one of the 50 memory locations.
HDST	Headset unit.
HDST 00:00 VOL1	Indicates the headset speakerphone is turned on.
INCOMPLETE DATA	Caller information has been interrupted during transmission or the phone line is excessively noisy.
MESSAGE WAITING	Indicates a message is available.
MUTE ON	Indicates you are muting a telephone conversation to speak

	to a third party .
NEW	Indicates call or calls have not been reviewed.
NO CALLS	Indicates no CID records have been stored.
NO DATA	No Caller ID information was received.
PAGING	Someone has pressed the page button on the base.
TALK 00:00 VOL1	Indicates the handset earpiece is active.
UNKNOWN NAME/ CALLER/NUMBER	The incoming call is from an area not serviced by Caller ID or the information was not sent.

Handset Sound Signals

<i>Signal</i>	<i>Meaning</i>
A long warbling tone (with ringer on)	Signals an incoming call
Two long beeps	Confirmation Tone
One short and one long beep	Page signal
One short beep every seven seconds	Low battery warning

Caller ID

No display

- Make sure the battery is properly charged for 16 hours.
- Make sure the battery is properly installed and connected.
- Replace the battery. Make sure the unit is connected to a non-switched electrical outlet.
- Disconnect the unit from the electrical outlet and plug it back in.
- Make sure you are subscribed to Caller ID service from your local telephone

Troubleshooting Tips

company.

Caller ID error message

- The unit displays this message if it detects anything other than valid Caller ID information during the silent period after the first ring. This message indicates the presence of noise on the line.

Telephone

No dial tone

- Check or repeat installation steps.
- Make sure the base power converter is connected to a working electrical outlet.
- Make sure the telephone line cord is connected to the base and the wall jack.
- Disconnect the base from the wall jack and connect another phone to the same jack. If there is no dial tone in the second phone, the problem might be your wiring or local service.
- The handset **or headset** may be out of range. Move closer to the base.
- Make sure the battery is properly charged (for **16** hours).
- Make sure the battery pack is installed correctly.
- Did the handset beep when you pressed the **Talk** button? Did the display indicator turn on? The battery may need to be charged.

Dial tone is OK, but can't dial out

- Make sure the tone/pulse setting is programmed correctly.

Handset does not ring

- Make sure the ringer switch on the handset is turned ON.
- You may have too many extension phones on your line. Try unplugging some phones.

- See solutions for “No dial tone.”

In use/charge indicator on the base flashes

- Provided your phone company offers voice messaging service and you subscribe to it, the in use/charge indicator on the base flashes when the phone is not in use to indicate there is a message waiting. It stops flashing after the message has been reviewed.

You experience static, noise, or fading in and out

- Handset or headset may be out of range. Move closer to the base.
- Relocate the base
- Charge the battery.
- Make sure the base is not plugged into an outlet with another household appliance.

Unit beeps

- See solutions for “No dial tone.”
- Replace the battery.

Memory dialing

- Make sure you have correctly programmed the memory keys.
- Make sure to follow proper dialing sequence.
- Make sure the tone/pulse setting is programmed correctly.
- If you had a power outage or replaced the battery, reprogram the numbers into

memory.

General Product Care

To keep your telephone working and looking good, follow these guidelines:

- Avoid putting the phone near heating appliances and devices that generate electrical noise (for example, motors or fluorescent lamps).
- DO NOT expose to direct sunlight or moisture.
- Avoid dropping and other rough treatment to the phone.
- Clean with a soft cloth.
- Never use a strong cleaning agent or abrasive powder because this will damage the finish.
- Retain the original packaging in case you need to ship the phone at a later date.

Causes of Poor Reception

- Aluminum siding.
- Foil backing on insulation.
- Heating ducts and other metal construction can shield radio signals.
- You're too close to appliances such as microwaves, stoves, computers, etc.
- Atmospheric conditions, such as strong storms.
- Base is installed in the basement or lower floor of the house.
- Base is plugged into an AC outlet with other electronic devices.
- Baby monitor is using the same frequency.
- Handset or headset battery is low.

- You're out of range of the base.

Interference Information

This device complies with Part 15 of the FCC Rules. Operation is subject to the following two conditions: (1) This device may not cause harmful interference; and (2) This device must accept any interference received, including interference that may cause undesired operation.

This equipment has been tested and found to comply with the limits for a Class B digital device, pursuant to Part 15 of the FCC Rules. These limits are designed to provide reasonable protection against harmful interference in a residential installation.

This equipment generates, uses, and can radiate radio frequency energy and, if not installed and used in accordance with the instructions, may cause harmful interference to radio communications. However, there is no guarantee that interference will not occur in a particular installation.

If this equipment does cause harmful interference to radio or television reception, which can be determined by turning the equipment off and on, the user is encouraged to try to correct the interference by one or more of the following measures:

- Reorient or relocate the receiving antenna (that is, the antenna for radio or television that is "receiving" the interference).
- Reorient or relocate and increase the separation between the telecommunications equipment and receiving antenna.
- Connect the telecommunications equipment into an outlet on a circuit different from that to which the receiving antenna is connected.
- Consult the dealer or an experienced radio/TV technician for help.

If these measures do not eliminate the interference, please consult your dealer or an experienced radio/television technician for additional suggestions. Also, the Federal Communications Commission has prepared a helpful booklet, "How To Identify and Resolve Radio/TV Interference Problems." This booklet is available from the U.S.

Service Information

Government Printing Office, Washington, D.C. 20402. Please specify stock number 004-000-00345-4 when ordering copies.

Service

If trouble is experienced with this equipment, for repair or warranty information, please contact customer service at **1-800-511-3180**. If the equipment is causing harm to the telephone network, the telephone company may request that you disconnect the equipment until the problem is resolved.

This product may be serviced only by the manufacturer or its authorized service agents. Changes or modifications not expressly approved by ATLINKS USA, Inc. could void the user's authority to operate this product. For instructions on how to obtain service, refer to the warranty included in this guide or call customer service at **1-800-511-3180**.

Or refer inquiries to:
ATLINKS USA, Inc.
Manager, Consumer Relations
P O Box 1976
Indianapolis, IN 46206

Attach your sales receipt to the booklet for future reference or jot down the date this product was purchased or received as a gift. This information will be valuable if service should be required during the warranty period.

Purchase date _____

Name of store _____

Limited Warranty

What your warranty covers:

- Defects in materials or workmanship.

For how long after your purchase:

- One year, from date of purchase. (The warranty period for rental units begins with the first rental or 45 days from date of shipment to the rental firm, whichever comes first.)

What we will do:

- Provide you with a new or, at our option, a refurbished unit. The exchange unit is under warranty for the remainder of the original product's warranty period.

How you get service:

- Properly pack your unit. Include any cables, etc., which were originally provided with the product. We recommend using the original carton and packing materials.
- "Proof of purchase in the form of a bill of sale or receipted invoice which is evidence that the product is within the warranty period, must be presented to obtain warranty service." For rental firms, proof of first rental is also required. Also print your name and address and a description of the defect. Send via standard UPS or its equivalent to:

**ATLINKS USA, Inc.
c/o Thomson
11721 B Alameda Ave.
Socorro, Texas 79927**

- Pay any charges billed to you by the Exchange Center for service not covered by the warranty.
- Insure your shipment for loss or damage. ATLINKS accepts no liability in case of damage or loss.
- A new or refurbished unit will be shipped to you freight prepaid.

What your warranty *does not* cover:

- Customer instruction. (Your Owner's Manual provides information regarding operating instructions and user controls. Any additional information, should be obtained from your dealer.)
- Installation and setup service adjustments.

Warranty Information

- Batteries.
- Damage from misuse or neglect.
- Products which have been modified or incorporated into other products.
- Products purchased or serviced outside the USA.
- Acts of nature, such as but not limited to lightning damage.

Product Registration:

- Please complete and mail the Product Registration Card packed with your unit. It will make it easier to contact you should it ever be necessary. The return of the card is not required for warranty coverage.

Limitation of Warranty:

- THE WARRANTY STATED ABOVE IS THE ONLY WARRANTY APPLICABLE TO THIS PRODUCT. ALL OTHER WARRANTIES, EXPRESS OR IMPLIED (INCLUDING ALL IMPLIED WARRANTIES OF MERCHANTABILITY OR FITNESS FOR A PARTICULAR PURPOSE) ARE HEREBY DISCLAIMED. NO VERBAL OR WRITTEN INFORMATION GIVEN BY ATLINKS USA, INC., ITS AGENTS, OR EMPLOYEES SHALL CREATE A WARRANTY OR IN ANY WAY INCREASE THE SCOPE OF THIS WARRANTY.
- REPAIR OR REPLACEMENT AS PROVIDED UNDER THIS WARRANTY IS THE EXCLUSIVE REMEDY OF THE CONSUMER. ATLINKS USA, INC. SHALL NOT BE LIABLE FOR INCIDENTAL OR CONSEQUENTIAL DAMAGES RESULTING FROM THE USE OF THIS PRODUCT OR ARISING OUT OF ANY BREACH OF ANY EXPRESS OR IMPLIED WARRANTY ON THIS PRODUCT. THIS DISCLAIMER OF WARRANTIES AND LIMITED WARRANTY ARE GOVERNED BY THE LAWS OF THE STATE OF INDIANA. EXCEPT TO THE EXTENT PROHIBITED BY APPLICABLE LAW, ANY IMPLIED WARRANTY OF MERCHANTABILITY OR FITNESS FOR A PARTICULAR PURPOSE ON THIS PRODUCT IS LIMITED TO THE APPLICABLE WARRANTY PERIOD SET FORTH ABOVE.

How state law relates to this warranty:

- Some states do not allow the exclusion nor limitation of incidental or consequential damages, or limitations on how long an implied warranty lasts so the above limitations or exclusions may not apply to you.
- This warranty gives you specific legal rights, and you also may have other rights that vary from state to state.

If you purchased your product outside the USA:

- This warranty does not apply. Contact your dealer for warranty information.

AC power adaptor
5-2678

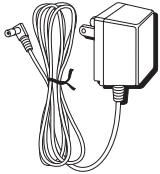

Belt clip
5-2679



Ear clip pack
5-2680



Headband pack
5-2681



Optional wired
headset
5-2588



Replacement battery
(NiMH for handset)
5-2683

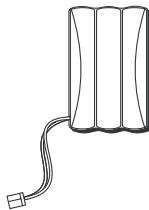

DESCRIPTION	MODEL NO.
AC power adaptor (for charger)	5-2678
Belt clip	5-2679
Ear clip pack	5-2680
Headband pack	5-2681
Optional headset (wired)	5-2588
Replacement battery (NiMH for handset)	5-2683
Replacement battery (Li-polymer for headset)	5-2682

To place order, have your Visa, MasterCard, or Discover Card ready and call toll-free 1-800-338-0376.

A shipping and handling fee will be charged upon ordering.

It is required by law to collect appropriate sales tax for each individual state, country, and locality to which the merchandise is being sent. Items are subject to availability.

Replacement battery
(Li-polymer for headset)
5-2682

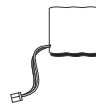

Index

A

Adjust Volume from Handset:	22
Adjust Volume from Headset:	22
Answering A Call	20
Area Code	18
Attaching the Belt Clip	31

B

Battery Safety Precautions	33
----------------------------	----

C

Call Timer	24
Call Transfer	21
Caller ID	25
Caller ID	35
Caller ID error message	36
Caller ID with Call Waiting	25
Causes of Poor Reception	38
Changing a Stored Number	29
Changing the CID Number Format	27
Charger Indicator Light	23
Charger unit	13
Connecting an Optional Headset to the Handset	31
Connecting the AC (Electrical) Power	13
Connecting the Telephone Line	13

D

Default Setting Selection	19
Deleting All Records	27
Deleting Records	26
Deleting the Current Record	26
Dialing a Caller ID Number	27

Dialing a Stored Number	30
Display Language	18
Display Messages	34

E

Ear Clip Attachment	12
Equipment Approval Information	2
Exit	22

F

FCC RF Radiation Exposure Statement	3
Flash	22

G

General Product Care	38
----------------------	----

H

Handset Battery	32
Handset Layout	16
Handset Memory Retention	32
Handset Set Up	18
Handset Sound Signals	35
Handset Volume	22
Headband Attachment	10
Headset and Belt Clip Operation	31
Headset Battery	33
Headset Layout	17
Headset Set Up	10
Headset Volume	22
Hearing Aid Compatibility	3

I

Important Installation Information	8
In Use Indicator Light	23
Inserting a Pause in the Dialing Sequence of a Stored Number	30
Installation Guidelines	8
Installing the Batteries	14
Installing the Earpiece Battery	15
Installing the Handset Battery	14
Interference Information	3
Interference Information	39
Introduction	6

L

Licensing	3
-----------	---

M

Making a Call	20
Memory	28
Mute	21

N

No dial tone	36
No display	35

P

Paging the Handset and Headset	23
Parts Checklist	7
Phone Installation	13

R

Receiving and Storing Calls	25
Redial	21
Replacing the Batteries	32
Reviewing and Deleting Stored Numbers	30
Reviewing Records	25
Ringer Tone	19
Ringer Volume	19

S

Safety Precautions	8
Service	40
Storing a Name and Number in Memory	28
Storing a Redial Number	29
Switch from ear to ear	11, 12

T

Telephone	36
Telephone Jack Requirements	9
Telephone Operation	20
Temporary Tone Dialing	24
Tone/Pulse Dialing	18
Transferring CID Records to Memory	26
Troubleshooting Tips	37

V

Viewing a Stored Number	29
-------------------------	----

W

Wall base unit	13
Warranty	41

Visit the RCA web site at www.rca.com

Please do not send any products to the Indianapolis address listed in this manual or on the carton.
This will only add delays in service for your product.

ATLINKS USA, Inc.
101 West 103rd Street
Indianapolis, IN 46290

©2005 ATLINKS USA, Inc.
Trademark(s)® Registered
Marca(s) Registrada(s)
Model 25110
00005708 (Rev. 0 DOM E)
05-33
Printed in China

