

## Warranty

**Our Limited Warranty and Warranty Period** When we use the terms "we," "us" and "our," we are referring to Learning Curve Brands, Inc., and when we use the terms "you" and "your" we mean the original end-user customer. Our products are guaranteed to be free from defects in material and workmanship under normal and intended use for a period of 90 days from the date of your purchase.

**Repair/Replacement** If our product fails to meet our limited warranty during the warranty period, we will, at our option, repair or replace the product free of charge.

**What Our Limited Warranty Does Not Cover** We offer this limited warranty only when the product is used by the original end-user customer. We offer no other warranty. Additionally, while our warranty is excellent, there are other limits to it. We offer NO WARRANTY in cases of damage in transit, inadequate care, abuse, abnormal use, misuse, accidents, normal wear and tear, damage due to environmental or natural elements, failure to follow product instructions, immersion in water (except for products specifically identified by us in writing as intended for water use), battery leakage or improper storage or maintenance of the products.

**Disclaimer of Other Warranties:** THE EXPRESS WARRANTIES IN THE PRECEDING SECTION ARE EXCLUSIVE AND IN LIEU OF ALL OTHER WARRANTIES. However, to the extent applicable law does not permit disclaimers of certain implied warranties, such warranties are limited to the warranty period identified above. Some states and countries do not allow limitations on how long an implied warranty lasts, so the above limitations may not apply to you.

**Limitation on Damages:** IN NO EVENT SHALL WE BE LIABLE FOR INCIDENTAL, COMPENSATORY, PUNITIVE, CONSEQUENTIAL, INDIRECT, SPECIAL OR OTHER DAMAGES. OUR AGGREGATE LIABILITY WITH RESPECT TO DEFECTIVE PRODUCTS IS LIMITED TO THE MONIES PAID TO US FOR THE DEFECTIVE GOOD. Some states and countries do not allow the exclusion or limitation of incidental, consequential or other damages, so the above limitation or exclusion may not apply to you.

**State Variations:** This warranty gives you specific legal rights, and you may also have other rights which vary based on state, province or country.

**Contact Us:** If you have a warranty claim or request, any customer care questions, please contact via our website [www.learningcurve.com](http://www.learningcurve.com) or call us at 1-800-704-8697.



© 2011 Learning Curve Brands, Inc.  
Oak Brook, IL 60523 U.S.A.  
All Rights Reserved.  
Made in China.  
Y3040.04.12.10

the first years™

## Two Receiver Monitor 49.83 MHz Clear Reception

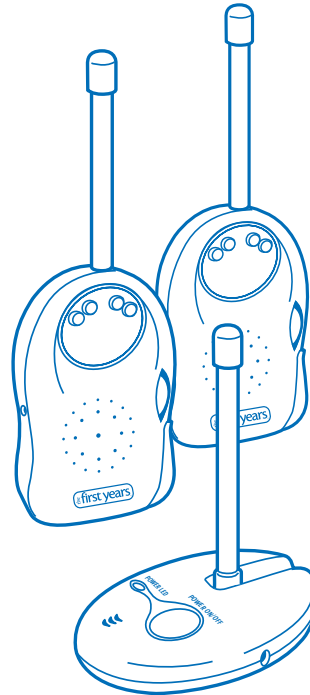

Y3040

### QUICK START INSTRUCTIONS

You'll find detailed instructions inside. Please read the safety instructions on page 2.

#### Set up the Parent's Units

- Install three AA batteries. Battery compartment is located on the side of unit. Slide button down to release cover.
- Or, plug one of the three AC adapters provided into each Parent's Unit.

#### Set up the Child's Unit

- Place the unit near your child (within 6 feet, but well beyond child's reach).
- Position the antenna straight up.
- Plug in the third AC adapter provided.
- Slide the channel switch to A or B.
- Press the ON/OFF button to turn on the unit.

#### Use the Monitor (Parent's Unit)

- Slide the channel switch to the same channel as the Child's Unit (A or B).
- Rotate the volume dial clockwise to the on position. Adjust to desired volume level.
- Keep the Parent's Unit with you, and keep it positioned upright.

### ⚠ WARNING:

- This product is a monitoring device designed to assist in the monitoring of children, not as a prevention for injury to or loss of child.
- This product is not a substitute for adult supervision. All children should be monitored at all times by responsible adults.
- This product is not a toy. Do not allow children to play with it.
- To prevent electric shock, strangling by cord, choking, or eye injury, do not place the monitor in, or attach it to, a crib or playpen.
- Never place these units within a child's reach.

Questions? Comments?  
Contact Consumer Care  
[www.learningcurve.com](http://www.learningcurve.com)  
800-704-8697

## To Set Up

### Parent's Units

#### To operate with batteries:

1. Press on the tab to release the battery compartment cover, then pull it open.
2. Insert three AA batteries. Position them so the + and - contacts are aligned with the corresponding contacts on the battery clip.
3. Close the battery compartment cover; be sure it clicks shut.
4. When it's time to change the batteries, the power indicator light will turn red. Replace batteries with three new AA batteries at that time.

#### To operate with AC adapter:

Insert the AC adapter plug into the jack on the side of the unit, then plug the adapter into an electrical outlet.

### ⚠ CAUTION:

Always use the AC adapter(s) supplied with this product. Do not use any other adapter. Monitor could become damaged, and warranty would become void.

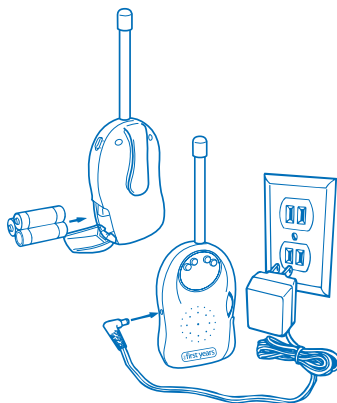

### Child's Unit

1. Position the Child's Unit within approximately 6 feet of your child, yet out of the child's reach.

### ⚠ WARNING:

Do not place Child's Unit in crib or attach to crib. (To prevent heat build-up, place on an open surface away from heat sources; do not place in an enclosed space.)

2. Position the antenna straight up, as shown.
3. Insert the AC adapter plug into the jack on the side of the unit, then plug the adapter into an electrical outlet.

#### For wall mounting (optional):

1. Securely fasten one #6 flat head wood screw on the wall. (For best results, use a 3/4-inch screw; mount in a solid wood panel, or use a screw anchor).
2. Leave the screw head protruding from the wall by at least 1/4-inch.
3. Fit the screw head slot (on the back of the unit) over the screw head and slide the unit down to seat it firmly.
4. To test that the unit is securely mounted, press on its edges.

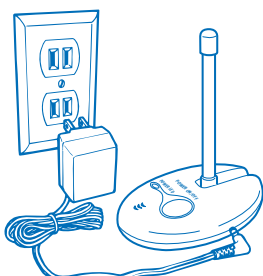

4

## To Use Monitor

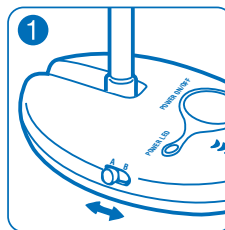

1. Slide the channel A/B switch on the Child's Unit to either A or B. Turn the unit on by pressing the ON/OFF button.
2. Slide the channel selector switch on the Parent's Units to the same channel as the Child's Unit (A or B). For the Monitor to work properly, both units must be set to the same channel.
3. Rotate the volume dial clockwise on the parent units to the on position and adjust the volume to the desired level.
4. Keep a Parent Unit with you. For best reception keep all units as near upright as possible.

#### Range:

The range of the Monitor will vary with the surroundings. You may want to test its workable range by walking through your house and yard and listening for the volume and clarity of the sounds being transmitted.

#### Using belt clip:

Slide onto your belt or waistband.

#### Changing channels:

Always keep both units set to the same channel (A or B). If you experience interference or static with one channel, switch to the other.

#### Positioning antennas:

Always be certain the antennas on both units are straight up.

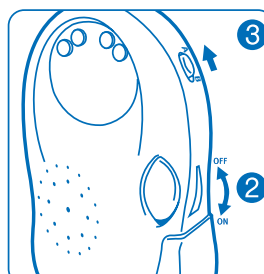

This device complies with part 15 of the FCC Rules. Operation is subject to the following two conditions: (1) This device may not cause harmful interference, and (2) This device must accept any interference received, including interference that may cause undesired operation.

**WARNING:** Changes or modifications to this unit not expressly approved by the party responsible for compliance could void the user's authority to operate the equipment.

**NOTE:** This equipment has been tested and found to comply with the limits for a Class B digital device, pursuant to Part 15 of the FCC Rules. These limits are designed to provide reasonable protection against harmful interference in a residential installation. This equipment generates, uses and can radiate radio frequency energy and, if not installed and used in accordance with the instructions, may cause harmful interference to radio communications. However, there is no guarantee that interference will not occur in a particular installation. If this equipment does cause harmful interference to radio or television reception, which can be determined by turning the equipment off and on, the user is encouraged to try to correct the interference by one or more of the following measures:

- Reorient or relocate the receiving antenna.
- Increase the separation between the equipment and receiver.
- Connect the equipment into an outlet on a circuit different from that to which the receiver is connected.
- Consult the dealer or an experienced radio/TV technician for help.

This Category II radio communication device complies with Industry Canada Standard RSS-310. Child Unit's field strength: 74.6 dBuV/m at 3 m.

Ce dispositif de radiocommunication de catégorie II respecte la norme CNR-310 d'Industrie Canada.

5

## To Use Monitor (continued)

### Lights

Here's how to interpret the lights on the Parent Units.

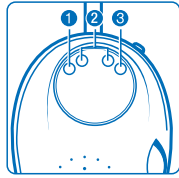

#### 1 Power Indicator

Light is Green

Light is Red

Not Lit

Both units are ON, and the Monitor is ready to transmit sound.

Batteries in Parent Unit are weak. Replace with three "AA" batteries.

Unit is not receiving power. (See "Troubleshooting," "No power.")

#### 2 Two Quiet Sound Lights

No Lights Lit

One or Two Lights Green

No sound from Child's Unit (baby is quiet).

Quiet sounds (baby may be whimpering or talking).

#### 3 One Loud Sound Light

Light is Red

Loud sounds (baby may be crying or talking loudly).

### Replacing Batteries (Parent Units):

Remove old batteries and see "To Set Up Parent Units" on page 4.



**WARNING:** Keep batteries away from children. Parents are urged to exercise care in the storage, use, and disposal of all batteries.

- Do not dispose of batteries in fire. They may explode.

Failure to follow the following instructions may cause the batteries to make "popping" sounds and leak battery acid resulting in personal injury and damage to the monitor. If battery leakage occurs, thoroughly wash the affected skin and clothes. Keep battery acid away from your eyes and mouth. Contact the battery manufacturer for further information. To avoid battery leakage:

- Be sure to insert batteries correctly following instructions. Do not put batteries in backwards (positive (+) and negative (-) ends must face the proper direction).
- Do not mix old and new, rechargeable and non-rechargeable or carbon zinc and alkaline batteries.
- Always remove exhausted batteries from the product.
- Never use a screwdriver or any other tool to pry batteries from the compartment, as the supply terminals may be short-circuited.
- Do not leave batteries in the monitor for long periods of non-use.

### To Clean Units

Wipe exterior surfaces with a clean, dry cloth.

6

## Troubleshooting

PROBLEM	POSSIBLE CAUSE	SOLUTION	
No power	<b>Parent Units:</b> Unit is not turned on.	Turn the unit on.	
	Batteries are dead.	Replace batteries or plug in adapter. (See "Care of Your Monitor.")	
	<b>Child's Unit:</b> Unit is not turned on.	Press ON/OFF button.	
	Adapter not plugged in.	Plug in adapter.	
	Adapter plugged into outlet that's turned off.	If outlet is controlled by a wall switch, be sure switch is turned on.	
	Hissing sound	Parent's Unit is turned on, but Child's Unit is off.	Leave Child's Unit plugged in and turned on at all times (or if you turn it off, turn off Parent's Unit also.)
Static or interference	Units set to different channels.	Set both units to same channel.	
	Appliances (fan, hair dryer, or mixer for example) causing interference.	Try turning off any nearby appliances or switching channels.	
	Cross talk from cordless phone or some other nearby transmitter.	Try switching channels.	
	Child's Unit not receiving power.	Make sure adapter is plugged in and outlet is receiving power.	
	Batteries are low.	Replace batteries or plug in adapter.	
Noisy feedback (high-pitched "screech")	Units too close together.	Be sure Parent's Unit is at least 3 feet from Child's Unit.	
	Volume too high.	Lower volume setting on Parent's Unit.	
No sound or very weak reception	Unit is getting little or no power.	<b>Parent's Unit:</b> Replace batteries or plug in adapter. <b>Child's Unit:</b> Make sure adapter is plugged in and outlet is receiving power.	
	Out of range.	Move Parent's Unit closer to Child's Unit (and be sure Child's Unit is turned on.)	
	Antenna is not vertical or is covered.	Be sure antenna is straight up and not obstructed.	
	Units are set to different channels.	Set both units to the same channel.	
	Weak batteries.	Replace batteries or use AC adapter.	
	Volume is set too low.	Raise volume setting.	

7

## Safety Instructions



This symbol is intended to alert the user to the presence of important operating and maintenance (servicing) instructions in the literature accompanying the product.



This symbol is intended to alert the user to the presence of uninsulated "dangerous voltage" within the product's enclosure that may be of sufficient magnitude to constitute the risk of electric shock.

### CAUTION:

**RISK OF ELECTRICAL SHOCK. DO NOT OPEN.**

**CAUTION: TO REDUCE THE RISK OF ELECTRICAL SHOCK, DO NOT REMOVE THE COVER OR BACK OF EITHER UNIT.**

**THERE ARE NO USER-SERVICEABLE PARTS INSIDE.**

**REFER ALL SERVICING TO A QUALIFIED THE FIRST YEARS TECHNICIAN (Call 1-800-704-8697 if you believe your unit needs service).**

### WARNING:

**TO REDUCE THE RISK OF FIRE OR ELECTRICAL SHOCK, DO NOT EXPOSE THIS PRODUCT TO WATER OR MOISTURE.**

- THE USER SHOULD NOT ATTEMPT TO SERVICE THIS PRODUCT. READ ALL SAFETY AND OPERATING INSTRUCTIONS BEFORE OPERATING THIS PRODUCT**
- RETAIN THESE INSTRUCTIONS FOR FUTURE REFERENCE**
- OBSERVE ALL WARNINGS**
- FOLLOW ALL OPERATING INSTRUCTIONS**
- WATER AND MOISTURE**  
This product should not be used near water, for example, near a bathtub, or sink, in a wet basement or near a swimming pool.
- VENTILATION**  
This product should be situated in such a way that it has proper ventilation. Do not place on a bed, sofa, rug, or similar surface that may block ventilation openings. Do not place in an enclosed area, such as a cabinet or book case that might impede the flow of air through the ventilation openings.
- HEAT**  
This product should be situated away from heat sources such as radiators, heat registers, stoves, or other appliances that produce heat.
- POWER SOURCE**  
This product should be connected to a power supply only of the type described in these instructions or marked on the product itself.  
**IMPORTANT:** The following applies only to UL LISTED UNITS. This product is being supplied with the required safety feature of a Polarized Plug. You will note that one prong is larger than the other so that the plug fits into the outlet only one way. **DO NOT TAMPER WITH THE PLUG** under any circumstances.
- POWER CORD PROTECTION**  
The power supply cord should be routed so that it is not likely to be walked on or pinched by items placed upon or against it. Pay particular attention to the cord at the plug, at the convenience receptacle, and at the point it exits from the appliance.
- CLEANING**  
Before cleaning, be sure to unplug. Clean only as recommended in these instructions.
- NON-USE PERIODS**  
The power cord of the product should be unplugged from the outlet when the Monitor will be unused for a long period of time.
- OBJECT AND LIQUID ENTRY**  
Care should be taken so that objects do not fall and liquids are not spilled into the enclosure through the openings.
- DAMAGE REQUIRING SERVICE**  
This product should be serviced by qualified service personnel (see below) when:
  - The power supply cord or plug has been damaged; or
  - Objects have fallen or liquid has been spilled into it; or
  - The product has been exposed to rain; or
  - The product does not appear to operate normally or exhibits marked change in its performance; or
  - The product has been dropped or the enclosure damaged.
- WALL MOUNTING**  
The monitor should be mounted to a wall only as recommended in these instructions.

2

## Contents

### Parent's Unit (receiver)

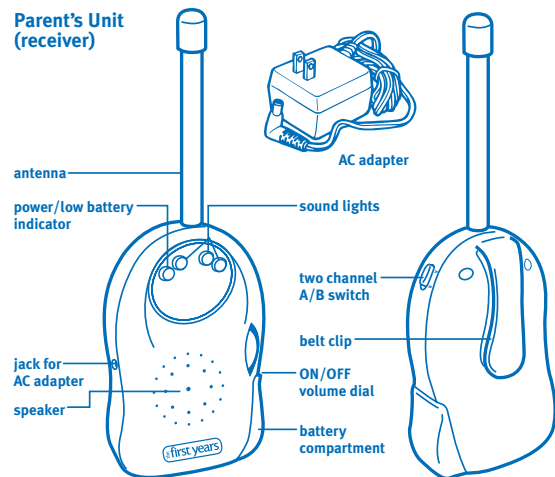

### Child's Unit (transmitter)

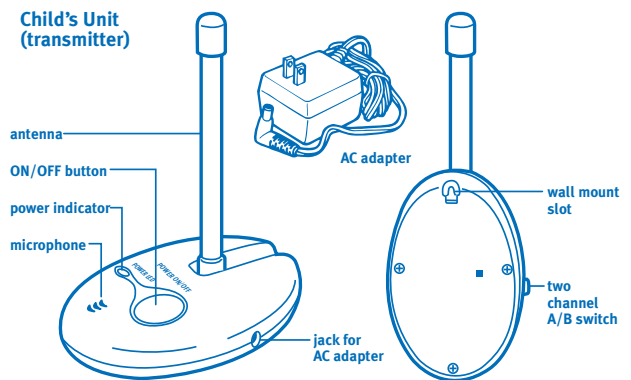

3