



Sync to PanoBike App and other Apps with *Bluetooth®* Smart (BLE 4.0) connection program.



C Cadence Sensor Sensing Point



S Speed Sensor Sensing Point

SPECIFICATION

Tech: *Bluetooth®* Smart super low energy technology

Battery Lifetime (approx): 1800 hours (5 years with 1hr/day use)

Battery: CR2032 x 1 pc (included)

Transmission Range: <10 meter (33 ft)

Waterproof: IPX 7

Weight: 21g / 0.74 oz

Operating temperature: -10° C ~ 50° C (14° F ~ 122° F)

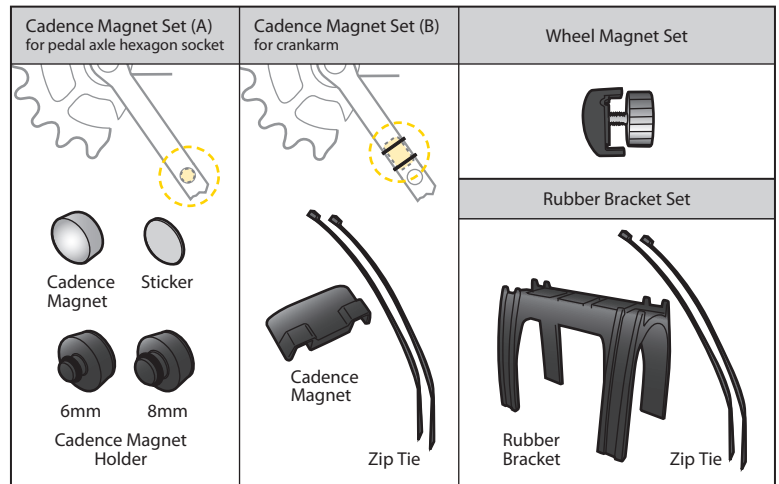

INSTALLATION

TIPS : Proper distance between Sensor and Magnet : < 30mm

1

OPTION A

Cadence Magnet Set (A)

6 mm 8 mm

(6 mm or 8 mm)
Preset suitable 6 mm or 8mm Cadence Magnet Set.

Cadence Magnet

Cadence Sensor Sensing Point

Top View

IMPORTANT NOTE

Align Cadence Magnet with Cadence Sensor Sensing Point as shown to insure magnet does not interfere with Speed Sensor.

OPTION B

Cadence Magnet Set (B)

Install Cadence Magnet on left crankarm near pedal as shown. Do not tighten zip ties completely to allow magnet placement.

Cadence Magnet

Cadence Sensor Sensing Point

Top View

IMPORTANT NOTE

Align Cadence Magnet with Cadence Sensor Sensing Point as shown to insure magnet does not interfere with Speed Sensor.

2

Pre-fit Sensor and Rubber Bracket on left rear chainstay (non-drive side) and trim excess rubber from bracket. Insure the Topeak logo is facing up. Install zip ties loosely to allow sensor placement.

3

For Round Spokes

For Bladed Spokes

Unscrew the wheel magnet to install on spoke.

Speed Sensor Sensing Point

Top View

IMPORTANT NOTE

Align Wheel Magnet with Speed Sensor Sensing Point as shown to insure magnet does not interfere with Cadence Sensor.

4

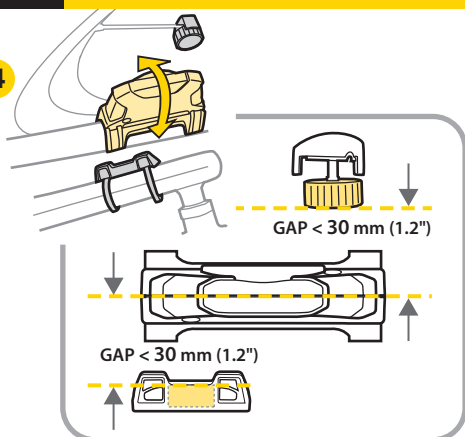

Adjust angle and position of sensor to achieve recommended magnet distances and aligning sensing points.

5 Pair with PanoBike App

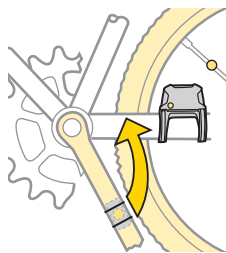
**Pair with PanoBike App.**

Turn the crankarm counterclockwise to make sure the Current Cadence (CAD) and Current Speed (SPD) data displays correctly without interfering with each other. Tighten all zip ties and wheel magnet after successful pairing. Trim zip tie excess.

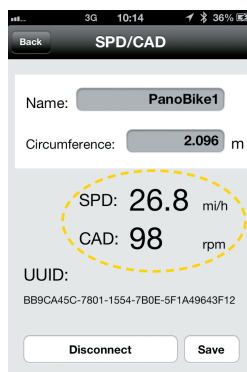
**IMPORTANT NOTE**

After pairing with PanoBike App successfully, make sure the Sensor is installed and tightened securely on left rear chainstay by using needle nose pliers before trimming excess zip tie.

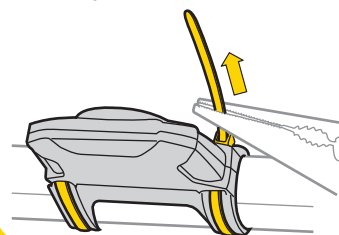
**RECHECK TO INSURE CADENCE & WHEEL MAGNETS DO NOT INTERFERE WITH EACH OTHER'S SENSOR**

1

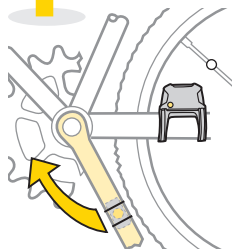

Turn the crankarm clockwise to check the Current Cadence (CAD) data displays correctly with no Current Speed (SPD) data.

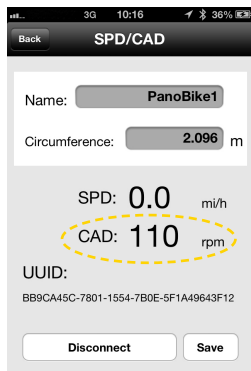

2

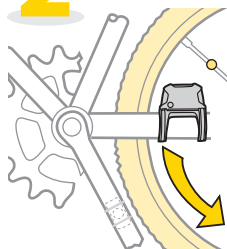

Spin the wheel counterclockwise to check the Current Speed (SPD) data displays correctly with no Current Cadence (CAD) data.

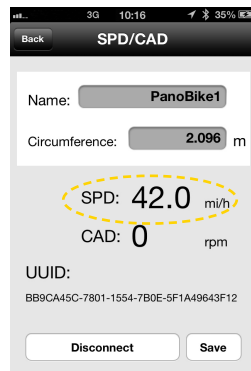
**CAUTION**

1. The Sensor and hardware can be used in the rain but should not be used underwater.
2. Do not disassemble the Sensor and hardware.
3. Check relative positions and gap between sensor and magnets periodically.
4. Do not use harsh chemicals to clean the Sensor and hardware.
5. Remember to pay attention to the road while riding.

TROUBLE SHOOTING**1. Why can't I connect the sensor with PanoBike App?**

- Make sure the Bluetooth® system in your smartphone has been open.
- Is the battery exhausted? Replace battery.

2. Display is slow?

- Is the temperature below -10°C (14°F)? The unit will return normal state when the temperature rises.

3. No current speed or incorrect data ?

- Make sure the magnets are aligned to pass by the sensor as the crankarm and wheel spin.

CHANGING BATTERY

Operation Time up to

1800 hrs. / 5 yrs.

* 5 years with 1hr/day use

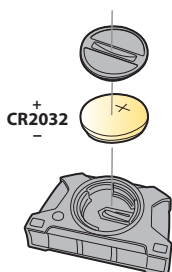

NOTE:
Install the sensor battery before first use.

RELEVANT ACCESSORIES

RideCase

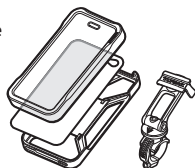

Art No. TT9832B, TT9832W
(works with iPhone 4/4S)
TT9833B, TT9833W
(works with iPhone 5)

PanoBike Heart Rate Monitor



Art No. TPB-HRM01

FCC STATEMENT

This equipment has been tested and found to comply with the limits for a Class B digital device, pursuant to Part 15 of the FCC Rules. These limits are designed to provide reasonable protection against harmful interference in a residential installation. This equipment generates, uses and can radiate radio frequency energy and, if not installed and used in accordance with the instructions, may cause harmful interference to radio communications. However, there is no guarantee that interference will not occur in a particular installation. If this equipment does cause harmful interference to radio or television reception, which can be determined by turning the equipment off and on, the user is encouraged to try to correct the interference by one of the following measures:

- Reorient or relocate the receiving antenna.
- Increase the separation between the equipment and receiver.
- Connect the equipment into an outlet on a circuit different from that to which the receiver is connected.
- Consult the dealer or an experienced radio/TV technician for help.

FCC Caution: Any changes or modifications not expressly approved by the party responsible for compliance could void the user's authority to operate this equipment.

This device complies with Part 15 of the FCC Rules. Operation is subject to the following two conditions: (1) This device may not cause harmful interference, and (2) this device must accept any interference received, including interference that may cause undesired operation.

WARRANTY

2-year Warranty: All electronic and mechanical components against manufacturer defects only. Batteries are not covered under any implied warranty.

Warranty Claim Requirements

To obtain warranty service, you must have your original sales receipt. Items returned without a sales receipt will assume that the warranty begins on the date of manufacture. All warranties will be void if the product is damaged due to user crash, abuse, system alteration, modification, or used in any way not intended as described in this manual.

* The specifications and design are subject to change without notice.

Please contact your Topeak dealer with any questions.

For USA customer service call: 1-800-250-3068
www.topeak.com

Copyright © Topeak, Inc. 2012

* Bluetooth® is a registered trademark of Bluetooth SIG, Inc.

* iPhone is a registered trademark of Apple Inc.

* App Store is a service mark of Apple Inc.

