



DUOBAND HEART RATE MONITOR

User's Guide

- Heart rate monitor will turn on automatically when attached to chest strap.
- When heart rate is sensed, LED indicator will blink 60 times. (LED will automatically turn off)
- Heart Rate Monitor will turn off automatically when removed from the chest strap.

EN

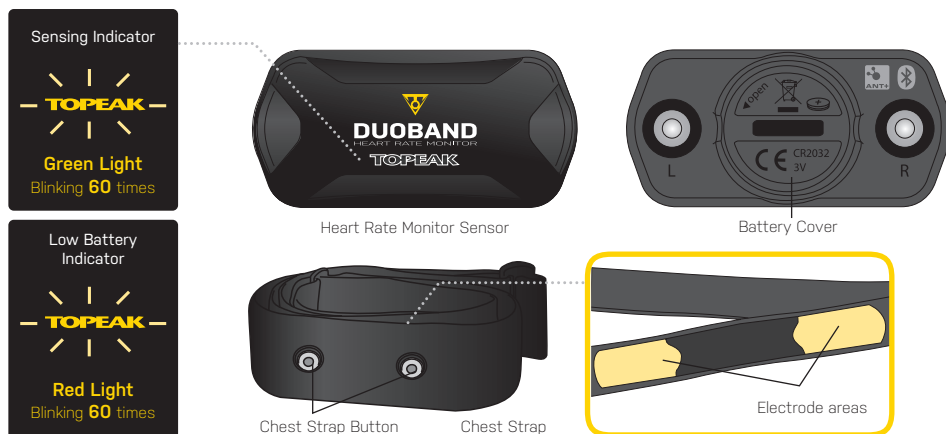

ANT+ system for Garmin or other devices.



Sync to PanoBike+ App and other Apps with Bluetooth® Smart (BLE 4.0) connection program.

SPECIFICATION

Tech: Bluetooth® Smart, ANT+ super low energy technology, Dual Band System
Fit Chest: 70-120 cm / 27.5"~47.2" | 100-150 cm / 39.4"~59" (with optional chest strap extension)
Battery Lifetime (approx): 900 hr
Battery: CR2032 x 1 pc (included)
Transmission Range: < 5 meter (16.4 ft)
Waterproof: IPX 7
Operation Temperature: -10°C ~ 50°C (14°F ~ 122°F)
Weight: 46 g / 1.62 oz (strap+monitor)

HOW TO WEAR HEART RATE MONITOR

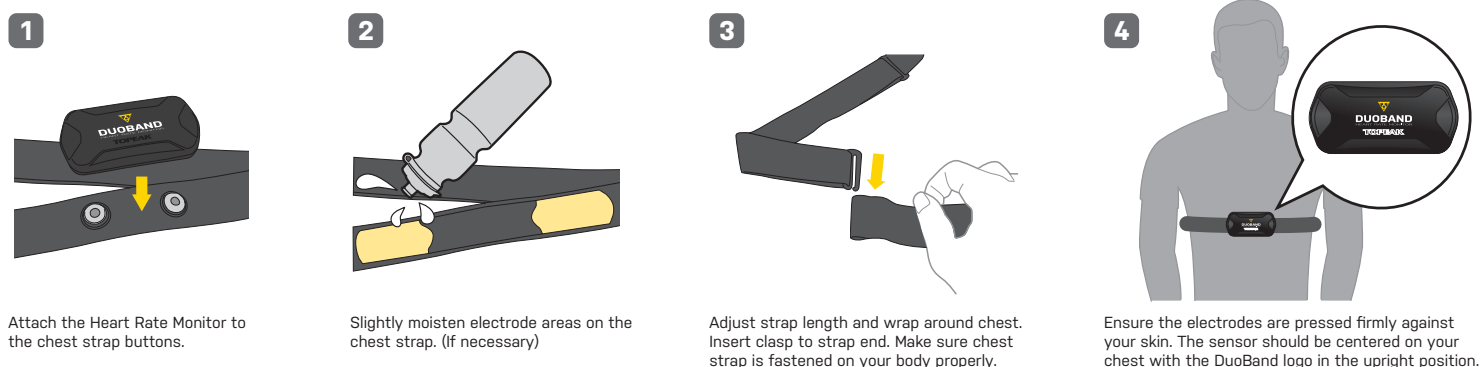

TOPEAK PANOBike+ APP



Sync to PanoBike+ App and other Apps with Bluetooth® Smart (BLE 4.0) connection program.



iOS 8 or above
(Download for Free)



Android OS 4.3 or above
(Download for Free)

MAINTENANCE OF CHEST STRAP

1. Detach the Heart Rate Monitor and rinse the chest strap under running water after each use and dry it with a soft towel. Never use alcohol or any abrasive material. Clean the chest strap with mild soap and water solution when needed.
2. Do not stretch the chest strap or bend the electrode areas sharply.
3. Do not soak, iron, dry clean or bleach the chest strap.
4. Do not twist the chest strap.
5. If you use fragrance, sunscreen, or insect repellent, you must ensure that it does not come into contact with the Heart Rate Monitor.



Care Symbols for HRM chest strap

FCC INFORMATION

This device complies with Part 15 of the FCC Rules. Operation is subject to the following two conditions:
 1. This device may not cause harmful interference. 2. This device must accept any interference received, including interference that may cause undesired operation.
Note: This equipment has been tested and found to comply with the limits for a Class B digital device, pursuant to part 15 of the FCC Rules. These limits are designed to provide reasonable protection against harmful interference in a residential installation. This equipment generates, uses and can radiate radio frequency energy and, if not installed and used in accordance with the instructions, may cause harmful interference to radio communications. However, there is no guarantee that interference will not occur in a particular installation. If this equipment does cause harmful interference to radio or television reception, which can be determined by turning the equipment off and on, the user is encouraged to try to correct the interference by one or more of the following measures:
 • Reorient or relocate the receiving antenna. • Increase the separation between the equipment and receiver.
 • Connect the equipment into an outlet on a circuit different from that to which the receiver is connected. • Consult the dealer or an experienced radio/TV technician for help.
 FCC Radiation Exposure Statement: This equipment complies with FCC radiation exposure limits set forth for an uncontrolled environment. This transmitter must not be collocated or operating in conjunction with any other antenna or transmitter.
 Caution: Any changes or modifications not expressly approved by the party responsible for compliance could void the user's authority to operate this equipment

WARNING

1. Do not store Heart Rate Monitor in damp environment or non-breathable material (such as sports bag), nor with conductive material (a wet towel).
2. Do not expose the Heart Rate Monitor to direct sunlight for extended periods.
3. Pacemaker users should never use this device.

CHANGING BATTERY

Operation Time up to
900 hr. / 2.5 yr.

TIPS:
To maximize battery life, dry and detach Heart Rate Monitor sensor from the chest strap after use.

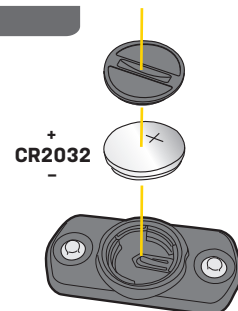

OPTIONAL AND RELEVANT ACCESSORIES

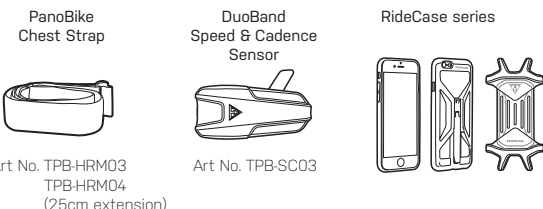

NCC INFORMATION

Administrative Regulations on Low Power Radio Waves Radiated Devices warning:
 • Without permission granted by the NCC, any company, enterprise, or user is not allowed to change frequency, enhance transmitting power or alter original characteristic as well as performance to an approved low power radio-frequency devices.
 • The low power radio-frequency devices shall not influence aircraft safety and interfere legal communications; if found, the user shall cease operating immediately until no interference is achieved.
 • The said legal communications means radio communications is operated in compliance with the Telecommunications Act.
 • The low power radio-frequency devices must be susceptible with the interference from legal communications or ISM radio wave radiated devices.

WARRANTY

2-year Warranty: All electronic and mechanical components against manufacturer defects only.
 Batteries are not covered under any implied warranty.
 1-year Warranty: The Chest Strap against manufacturer defects only.

Warranty Claim Requirements

To obtain warranty service, you must have your original sales receipt. Items returned without a sales receipt will assume that the warranty begins on the date of manufacture. All warranties will be void if the product is damaged due to user crash, abuse, system alteration, modification, or used in any way not intended as described in this manual.

* The specifications and design are subject to change without notice.

Please contact your Topeak dealer with any questions.
 For USA customer service call: 1-800-250-3088
 www.topeak.com



* Bluetooth® is a registered trademark of Bluetooth SIG, Inc. * App Store is a service mark of Apple Inc. * VIRB® is a registered trademark of Garmin Ltd. * ANT+ is a registered trademark of Dynastream Innovations Inc.

TOPEAK

Manufacture : ALATECH TECHNOLOGY

Copyright © Topeak, Inc. 2016

M-TPB-HRM05-EN 11/16
Made in Taiwan

PREPARE TO RIDE