



## PROBLEM! CAT® MACHINE RUNS SLOWLY

- There is radio interference in the area.
- Another R/C vehicle with the same frequency is close by.
- The antenna of controller is not screwed in tight.
- The antenna is not fully extended.
- Are the batteries weak or out of power?

## PROBLEM? PERFORMANCE DROP, INCONSISTENT MOVEMENT OR FAILS TO RUN

Check and replace batteries, if necessary, in CAT Machine and controller with new alkaline batteries.

Call 1-877-473-8015 for help!

**Equipped  
to  
PLAY™**



© 2011 Caterpillar  
CAT, CATERPILLAR, their respective logos,  
EQUIPPED TO PLAY, and "Caterpillar Yellow" and the  
"Power Edge" trade dress as well as corporate and  
product identity used herein, are trademarks of  
Caterpillar and may not be used without permission.  
[www.cat.com](http://www.cat.com)

Toy State, a licensee of Caterpillar Inc.

*Have Fun - Play Games @ [www.toystate.com](http://www.toystate.com)*

For questions, e-mail our Consumer Service Dept. at  
[consumerservice@toystate.com](mailto:consumerservice@toystate.com)  
Or Call 1-877-473-8015



**MADE IN SHENZHEN, CHINA**  
**TOY STATE INTERNATIONAL LIMITED**  
1 PEKING ROAD, KOWLOON, HONG KONG

IN THE INTEREST OF BETTER QUALITY AND VALUE, WE ARE CONSTANTLY  
IMPROVING AND UPDATING OUR PRODUCTS. CONSEQUENTLY, PICTURES IN THIS  
INSTRUCTION SHEET MAY SOMETIMES DIFFER FROM THE MODEL ENCLOSED.



# RADIO CONTROL HEAVY DUTY R/C

OWNER'S MANUAL

**BATTERY REQUIREMENTS:**  
3 "AAA" Batteries (for Controller)  
8 "AA" Batteries (for Machine)

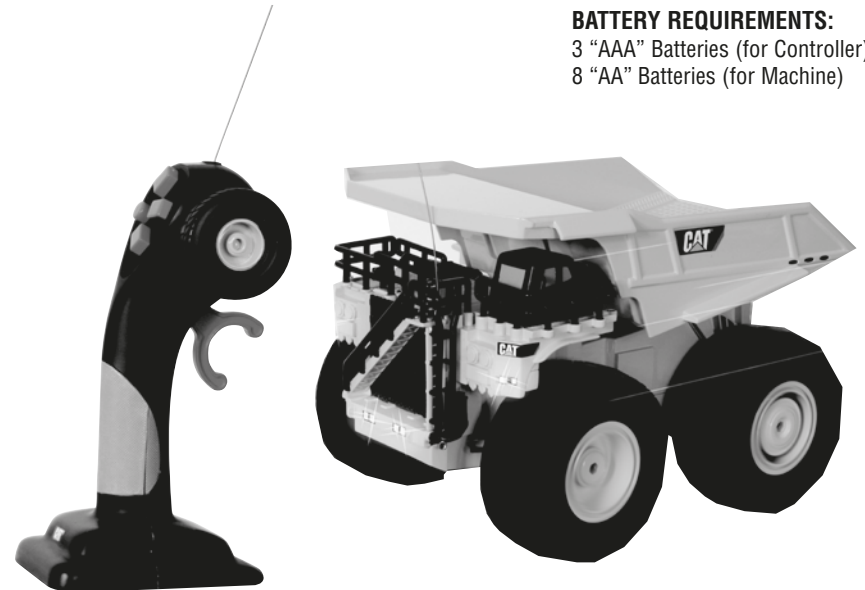

**Call for Help!**

If you have questions about this toy

Call Toll-Free: **1-877-473-8015**

Between 9:00 a.m. – 5:00 p.m. E.S.T. Monday thru Friday

Contact via e-mail: [consumerservice@toystate.com](mailto:consumerservice@toystate.com)

[www.toystate.com](http://www.toystate.com)

## MANUFACTURERS NOTE

“Modifications not authorized by the manufacturer may void users authority to operate the device.”

### CAUTION

#### Important Battery Information

- Dispose of batteries properly.
- Do not dispose of batteries in fire.
- Use only batteries of the type recommended.
- Do not mix alkaline, standard (carbon-zinc) or rechargeable (nickel-cadmium) batteries.
- Do not mix old and new batteries.
- Remove batteries from CAT® Machine and controller if vehicle will not be used for a long period.

## FEDERAL COMMUNICATIONS COMMISSION COMPLIANCE

#### NOTE:

This device complies with Part 15 of the FCC Rules. Operation is subject to the following two conditions:

- 1). This device may not cause harmful interference.
  - 2). This device must accept any interference received including interference that may cause undesired operation.
- Warning: Changes or modifications to this unit not expressly approved by the party responsible for compliance could void the user's authority to operate the equipment. Note: this equipment has been tested and found to comply with the limits for a Class B digital device, pursuant to Part 15 of the FCC Rules. These Limits are designed to provide reasonable protection against harmful interference in a residential installation. This generates, uses and can radiate radio frequency energy and if not installed and used in accordance with the instructions, may cause harmful interference to radio communications. However, there is no guarantee that interference will not occur in a particular installation. If this equipment does cause harmful interference to radio or television reception, which can be determined by turning the equipment off and on, the user is encouraged to try and correct the interference by one or more of the following measures:

- Reorient or relocate the receiving antenna
- Increase the separation between the equipment and receiver
- Connect the equipment to an outlet on a circuit different from that to which the receiver is connected
- Consult the dealer or an experienced radio/TV technician for help.

## ATTENTION PARENTS

This Toy and all Accessories need to be periodically examined for potential hazards and that any potentially hazardous parts be repaired or replaced.

## TIPS & TRICKS

#### STRONG BATTERY MEANS OPTIMUM PERFORMANCE

Save the battery by turning off vehicle when not in use.



#### LIMITED RADIO CONTROL RANGE

While CAT® Machine may be visible at a distance, full operational control may be lost. Hold controller high in the air and direct truck back.

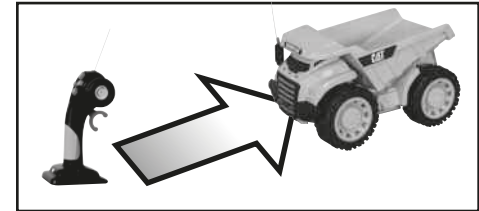

#### INTERFERENCE

Other radio signals may cause loss of control. Remove vehicle from an area of interference.

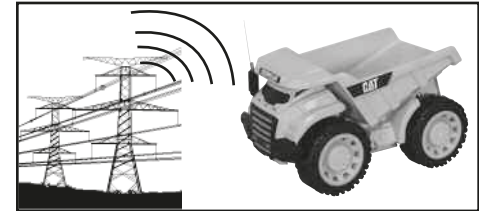

## TROUBLESHOOTING AND CARE FOR R/C TRUCKS

### PROBLEM! CAT® MACHINE DOES NOT MOVE

- Are the + and –'s contacts correctly matched in the controller?
- Are the metal contact tabs touching, rusty or dirty in controller?
- Are there batteries in the vehicle and controller?
- Is the power switch turned on?
- Are the batteries weak or out of power?

### PROBLEM! CAT® MACHINE MOVES BY ITSELF

- There is radio interference in the area.
- Another R/C vehicle with the same frequency is close by.
- The antenna of controller is not screwed in tight.
- The antenna is not fully extended.

## TREAT YOUR CAT® MACHINE WELL

Radio waves control and drive the CAT® Machine. Care for your CAT Machine and it will provide hours of fun! Avoid water, heat, sand and high impact crashes! Off road vehicles may run on grassy dry areas.

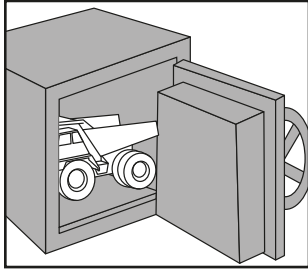

Store in safe place.

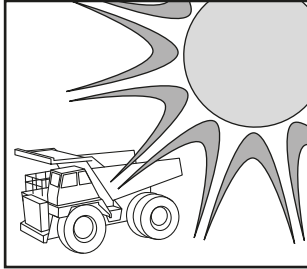

No direct sunlight.

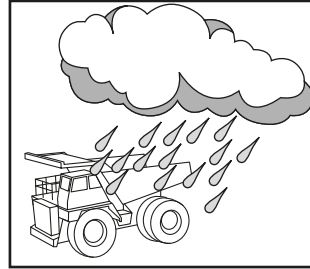

No rain or water.

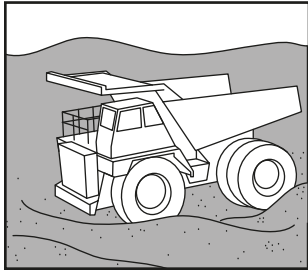

No sand or dust.

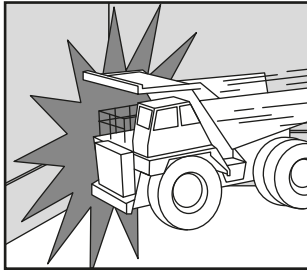

No Collisions.

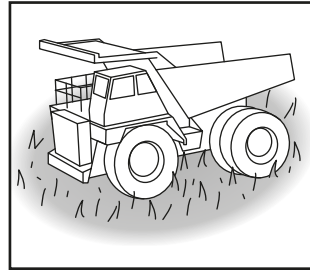

CAT Machine may get stuck on carpet or grass.

## CLEANING AND MAINTAINING



Brush areas where dirt and dust get trapped.



Wipe body off with a soft rag or tact cloth.



**Do not** clean vehicle with chemicals or water.

## GETTING STARTED

Remove the Road Rippers R/C vehicle and controller from the box. For best performance, replace the 3 “AAA” batteries in the controller with 3 new “AAA” batteries. Add 8 “AA” batteries into the R/C vehicle to begin full function play (see “Battery Installation” section for further details).

### BATTERY AND ANTENNA INSTALLATION IN CONTROLLER

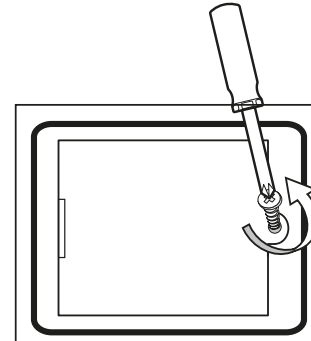

1. To remove battery cover, loosen screw to open.

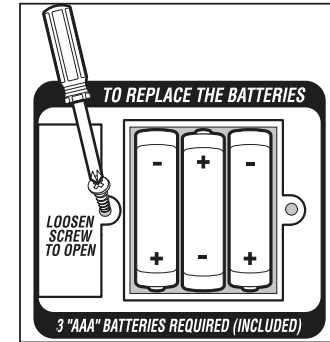

2. For best performance, replace 3 “AA” batteries with 3 new “AAA” batteries. Be sure the + and – are properly matched.

### BATTERY INSTALLATION IN ROAD RIPPERS R/C VEHICLE

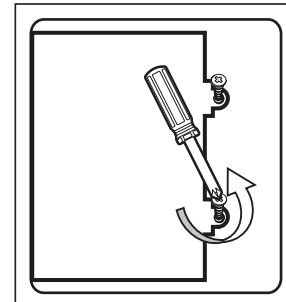

1. To remove battery cover, loosen screw to open.

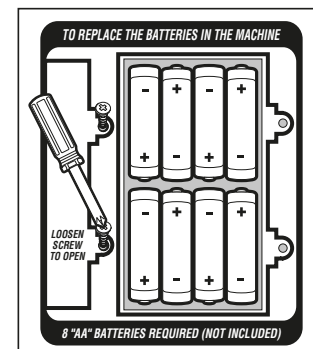

2. Insert 4 “AA” batteries into the Vehicle. Be sure the + and – are properly matched.

**NOTE:**

For best performance, always use alkaline batteries only.

## QUICK START GUIDE

- Install batteries in CAT® Machine and controller.
- Learn function of controller.
- Enjoy!

## OPERATING CAT® MACHINE



Turn ON/OFF switch (on bottom of CAT Machine) to the ON position (as shown.)



After play, always turn vehicle off. Remove batteries from controller and CAT Machine when not in use or when storing. Leakage may occur and cause damage if left for a long period of time.

## CAT® MACHINE FEATURES



Forward Action!

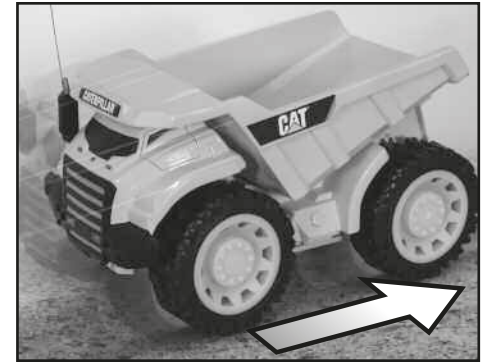

Reverse Action!

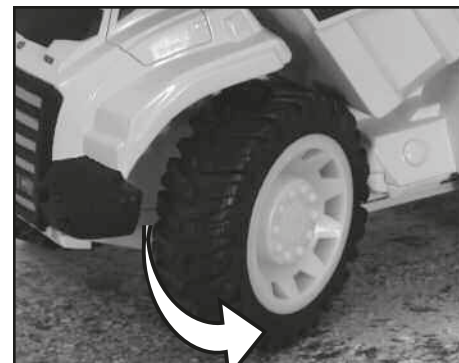

Turns Left or Right



Raise or Lower Dump Bed/Loader Bucket



Activate Sound Effects