

Quick Installation Guide

Wi-Fi Powerline Extender

Applicable to TL-WPA4220 and its multiple-pack kits
(This QIG uses the powerline adapter TL-PA4010 as an example to work with TL-WPA4220.)

7106504934 REV4.0.2

Plug and Play

Set Up a New Wireless Network

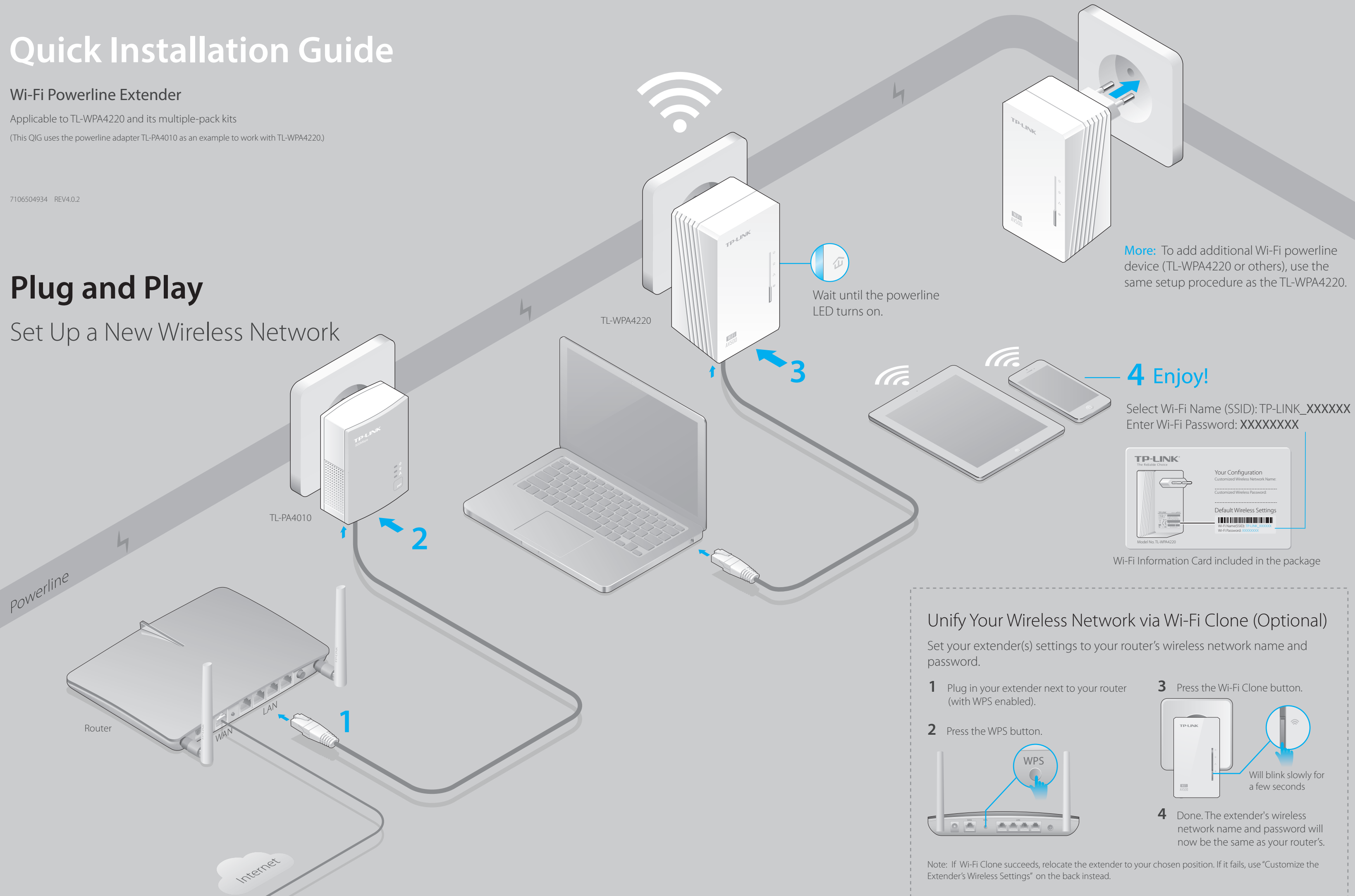

Wait until the powerline LED turns on.

More: To add additional Wi-Fi powerline device (TL-WPA4220 or others), use the same setup procedure as the TL-WPA4220.

4 Enjoy!

Select Wi-Fi Name (SSID): TP-LINK_XXXXXX
Enter Wi-Fi Password: XXXXXXXX

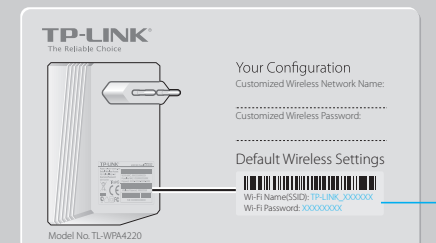

Wi-Fi Information Card included in the package

Unify Your Wireless Network via Wi-Fi Clone (Optional)

Set your extender(s) settings to your router's wireless network name and password.

- 1 Plug in your extender next to your router (with WPS enabled).
- 2 Press the WPS button.
- 3 Press the Wi-Fi Clone button.
- 4 Done. The extender's wireless network name and password will now be the same as your router's.

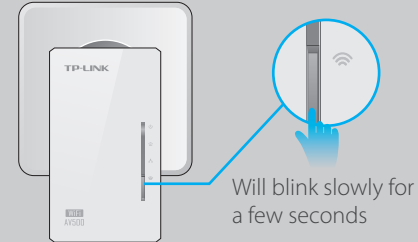
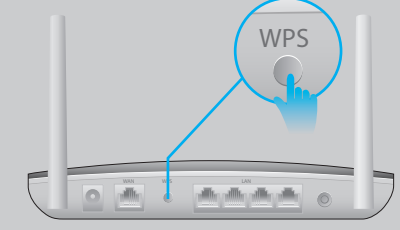

Note: If Wi-Fi Clone succeeds, relocate the extender to your chosen position. If it fails, use "Customize the Extender's Wireless Settings" on the back instead.

Set Up a Secure Powerline Network Using the Pair Button (Optional)

Pairing is used to create a secure powerline network and add additional devices to this secure network. By pairing one additional device at a time, the powerline network can allow up to 16 powerline devices.

To create a secure powerline network:

- 1 Press the Pair button on the adapter.
- 2 Press the Pair button on the extender.
- 3 Done.

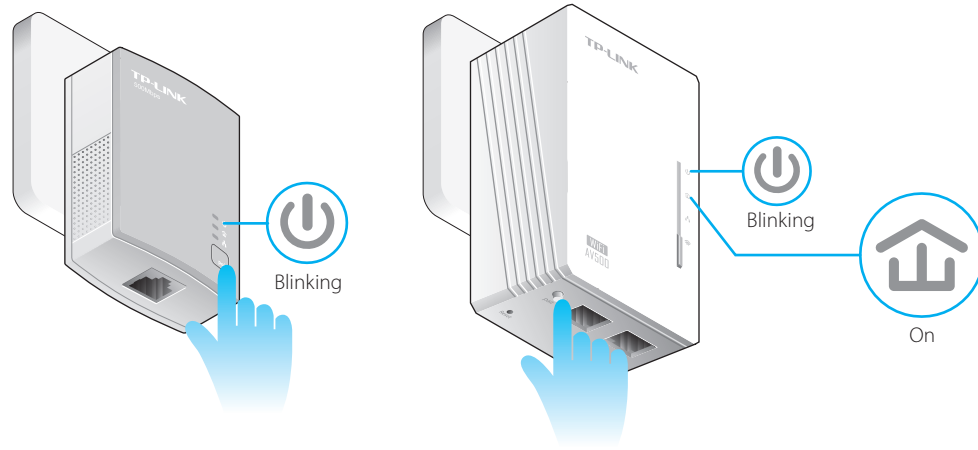

To join an existing secure powerline network:

- 1 Press the Pair button of any powerline device in the existing powerline network.
- 2 Press the Pair button on the new extender.
- 3 Done.

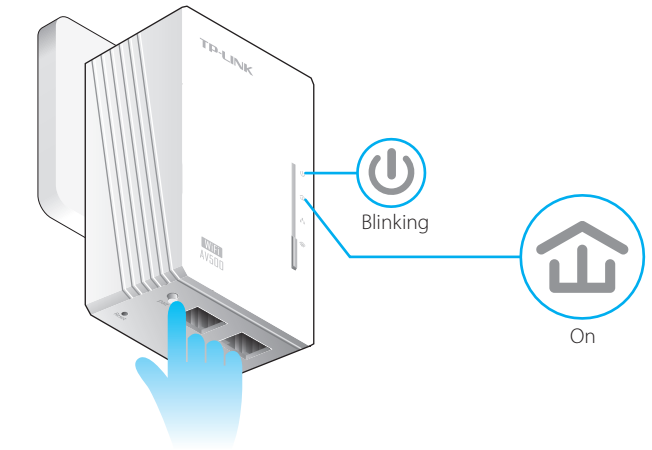
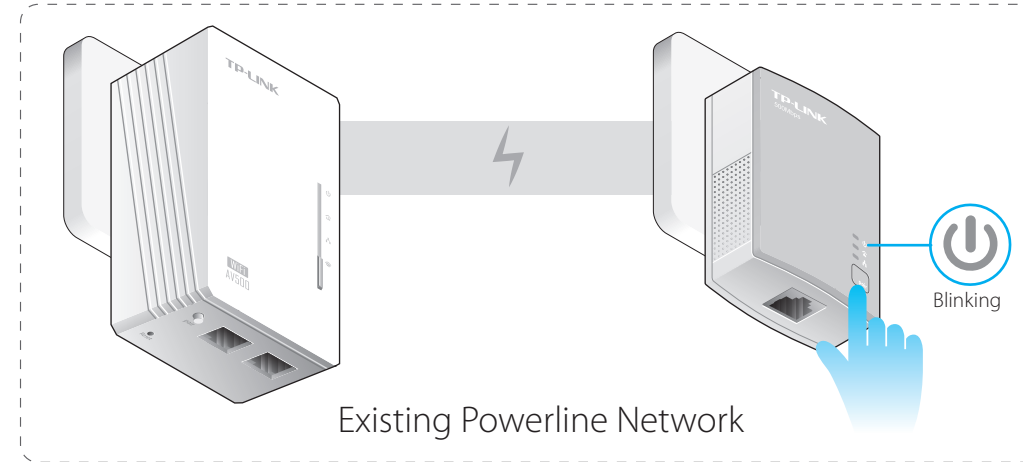

Customize the Extender's Wireless Settings (Optional)

- 1 Connect to the extender wirelessly following the instructions on the front page or via an Ethernet cable.

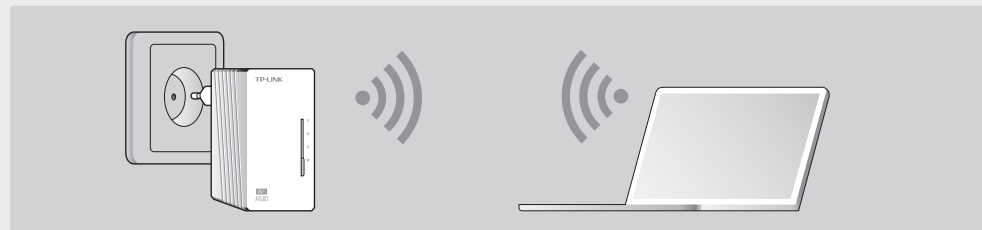

- 2 Go to the www.tp-link.com/support/download page. Click "TL-WPA4220KIT" in the Powerline section, and download the utility appropriate for your computer.
- 3 Start the utility and choose the model to be configured and click 'Connect'.

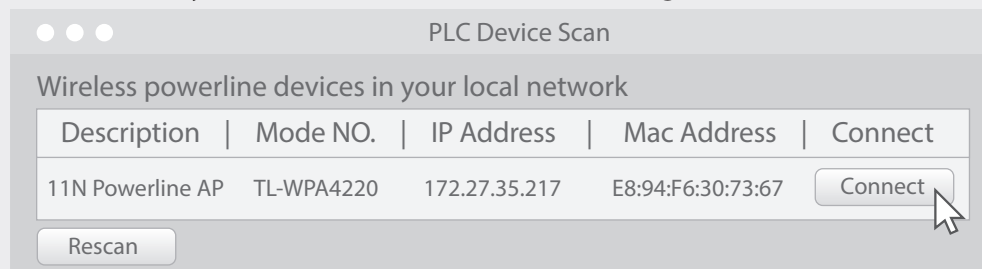

- 4 Log in with your user name and password (admin/admin by default).

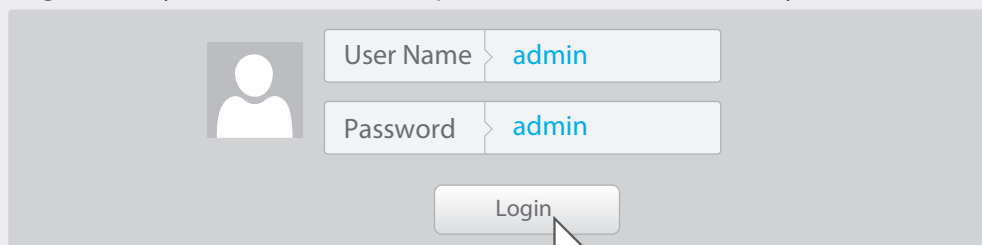

- 5 Go to "Wireless > Wireless Settings" and set the SSID. Go to "Wireless > Wireless Security" and set the wireless password. Go to "System Tools > Reboot" to restart the extender.

LED and Button Legend

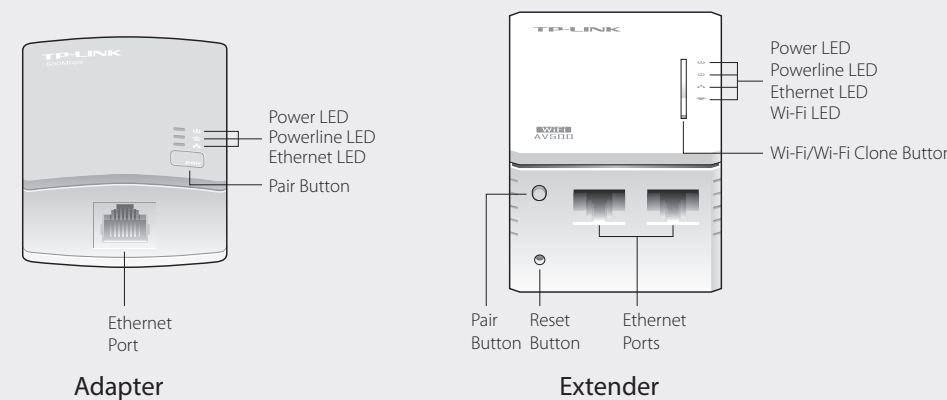

LED	STATUS	DESCRIPTION
Power	On/Off	The device is on or off.
	Blinking	Blinking every second: Pairing is in process. Blinking every 15 seconds (Powerline Adapter only): Power-Saving Mode is on.
Powerline	On	The device is connected to one or more powerline devices.
	Off	The device is not connected to any powerline devices or is in Power-Saving Mode.
Ethernet	Blinking	The device is transferring data.
	On/Off	The Ethernet port is connected or not connected.
Wi-Fi	Blinking	The Ethernet port is transferring data (Powerline Adapter only).
	Blinking rapidly	Blinking rapidly: The extender's Wi-Fi is working properly.
	Blinking every second	Blinking every second: Wi-Fi Cloning is in process.
	Off	The Wi-Fi is disabled.

BUTTON	DESCRIPTION
Wi-Fi/Wi-Fi Clone	Press and hold the button for 1 second to start Wi-Fi cloning. Press and hold the button for 5 seconds to turn the wireless function on or off.
Pair	Press and hold the button for 1 second to start the pairing process.
Reset	Press and hold the button for 5 seconds to restore the extender's settings to factory defaults.



<http://www.tp-link.com/en/support/faq>
Scan the QR code to access the Technical Support page.

FAQ (Frequently Asked Questions)

Q1. How do I reset my extender?

A. With the extender powered on, use a pin to press and hold the Reset button until all LEDs go off. When the Power LED turns on and the Wi-Fi LED starts to blink quickly, the reset process is complete.

Q2. What can I do if I don't have an Internet connection after I've completed the setup?

- Make sure the modem or router has an Internet connection. Connect a computer directly to the modem or router to check.
- Make sure the hardware connection is correct.
- Make sure the Powerline LEDs light up on all your extenders/adapters. If they do not, pair your extenders/adapters again.
- Make sure your computer's IP address is in the same segment as your router's.
- Make sure all extenders/adapters are on the same electrical circuit.

Q3. What can I do if a successfully-paired extender does not work after it has been moved to a new location?

- Make sure all devices are on the same electrical circuit.
- Try to pair them again according to "Set Up a Secure Powerline Network Using the Pair Button".
- If they still don't work, check for possible interference, such as washers, air conditioners or other household appliances that may be too close to one of the extenders/adapters.

Attention

For non-passthrough powerline device

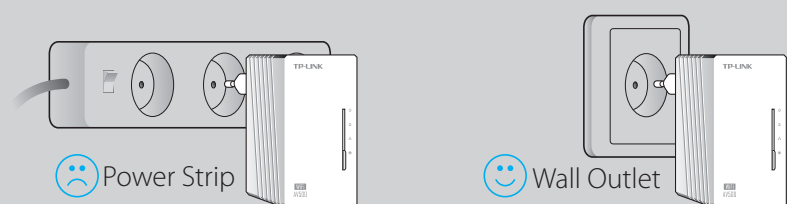

For passthrough powerline device

