



Intellipak™ II Rooftop Comfort System

Built on a legacy of comfort delivery



Intellipak™ II ready for tomorrow's building comfort needs

The Trane IntelliPak II rooftop comfort system has long been respected for its rugged design, reliable operation, flexibility of installation, and ability to deliver a comfortable environment. Trane has been providing pre-engineered packaged rooftop systems for five decades, always using advanced but proven technologies, including high-efficiency compressors and motors, the most reliable controls, and flexible designs for multiple building types.

The latest generation of our large rooftop family brings additional features to meet the demanding requirements of today's buildings and those of tomorrow. Trane has the unique advantage of being your single-source provider for complete comfort systems. In addition to our high-quality, high-performance packaged rooftop equipment, Trane provides precise air delivery management

with VariTrane™ VAV terminals and, now, second-to-none, state-of-the-art building management with our new Tracer™ SC system controller.

Controls for you

The Trane RTU/VAV system now featuring Tracer SC controls, offers a flexible, efficient and cost-effective solution for maintaining facility climate. The Tracer SC operator interface simplifies scheduling to “point and click” tasks. The intuitive “drag and drop” functions will result in an improved bottom line, through reduced operator training and improved productivity. This web-based online management tool can help reduce energy costs, installation time, and improve tenant comfort. In addition, Tracer SC controls provide the following features and benefits:

- Open, scalable, flexible building controls technology now supporting BACnet™ top-to-bottom as well as LonWorks™ controllers
- Scalable for building size to provide first-cost savings and flexibility
- Web-enabled for easy access from any location and any computer
- Proven, pre-programmed system applications that provide consistent comfort and deliver optimized indoor air quality to eliminate or reduce comfort issues
- Energy saving programs for efficient building operations

Tracer™ SC delivers open, web-based management to Trane Rooftop Systems



At the space control level, wireless zone sensors provide accurate sensing for total occupant comfort. In addition, they provide cost savings due to simplified installation, and are ideal for retrofit and remodeling projects due to their flexibility of placement.

IntelliPak II rooftop comfort system stands apart

Our tradition of total system delivery continues with IntelliPak™ II packaged rooftop systems. Available in sizes from 90 to 162 tons, this industrial/commercial rooftop unit is the most advanced Trane has ever offered. Its design takes full advantage of decades of experience in airflow, compressor technology, and microelectronic controls research. This latest platform incorporates a wide range of enhancements in a system that is designed for tomorrow and available today, including:

- Improved tenant comfort with a design focused on optimized indoor air quality (IAQ) and advanced air management control.

- Broad range of energy-saving features, including energy wheels and evaporative condensing, plus optimized system-level control strategies to minimize operating expenses and help achieve LEED® certification.
- Greater application flexibility for increased design freedom and two piece construction for improved installation in challenging locations.
- Designed to be easy to service and maintain, resulting in lower construction, installation, maintenance and operating costs.

The standard features of the IntelliPak II rooftop comfort system, developed for rugged reliability and design flexibility, are now even better with Tracer™ SC controls—the epicenter of a versatile RTU/VAV climate management system. And, with the availability of a multitude of additional features, you can customize the rooftop unit to your specific needs, saving time and money.

Tracer™ SC controller provides building operating staff with an easy interface via the web to monitor and control their building from anywhere.



Intellipak™ II rooftop comfort system

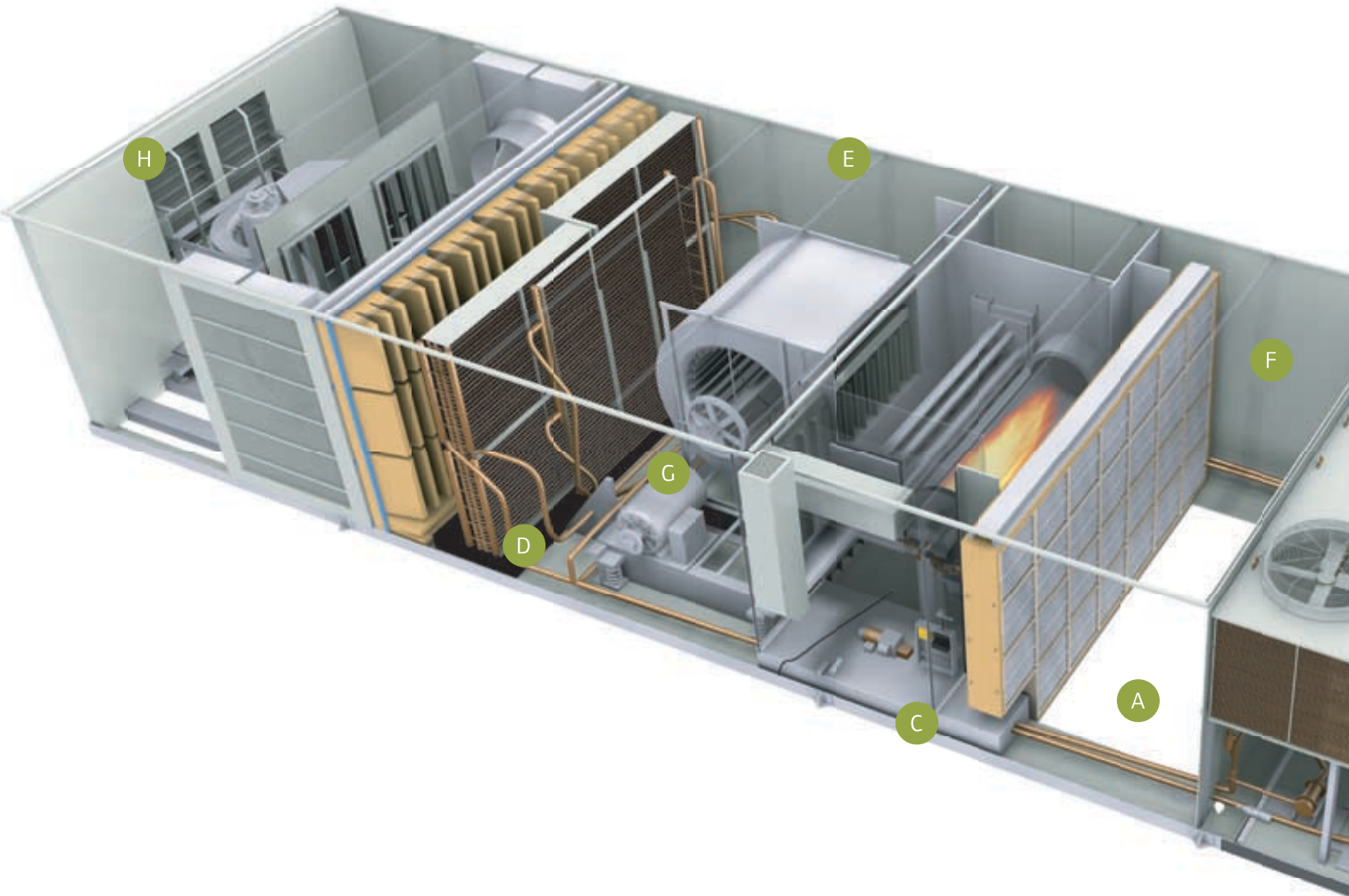

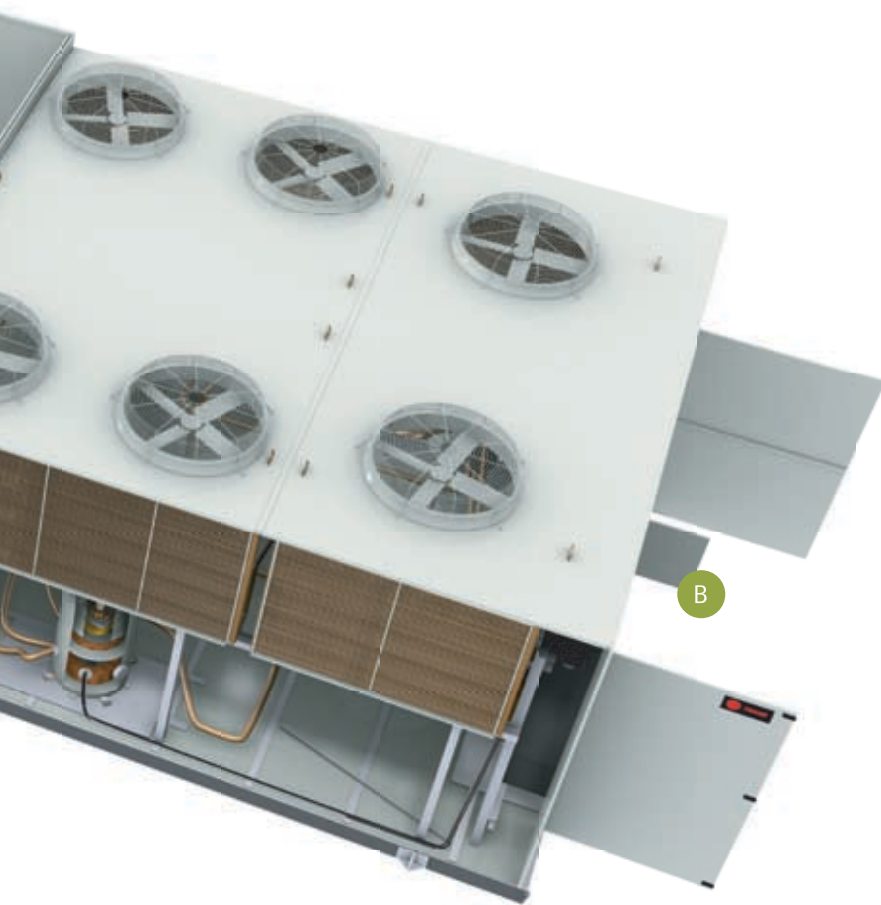

- A** *Blank section:* Provides flexibility for field customization to job needs for specific customer/building requirements such as critical humidification for healthcare or data center jobs
- B** *State-of-the-art controls platform:* Web-enabled, open, scalable, flexible building control technology supporting BACnet™ top-to-bottom or LonWorks™ controllers
- C** *Final filtration options:* Ensures proper air quality delivery for critical healthcare and industrial applications
- D** *Hot gas reheat:* Provides dehumidification of delivered air for comfort, indoor air quality control, reduced operating costs and energy savings
- E** *Double wall construction throughout air handler:* Removes insulation from air stream reducing possibility of airborne germs, improving indoor air quality and ease of airflow cleanability
- F** *Flexible airflow paths downflow and horizontal supply and return:* Provides installation flexibility
- G** *Supply fan options:* Optimizes operating efficiency
- H** *Return/exhaust fan options:* Provides flexibility for optimum air flow and lower installed costs

The right system for your building

The flexibility built into the IntelliPak™ II rooftop unit, makes it the best choice for an even wider range of installation types and applications than ever before. Tracer™ SC controls and VariTrane™ VAV terminals complete the system picture.

Architects, design-build contractors, building owners, and property managers will discover that the IntelliPak™ II rooftop system is the best choice for a wide range of building types both in new construction and retrofits. Multistory office building owners—property managers, healthcare and educational facilities professionals, as well as retail and entertainment construction professionals—helped to shape the IntelliPak II platform.

Office buildings

Building owners and property managers realize the importance and value of tenant comfort. Studies show that poorly performing comfort systems are a frequent source of tenant dissatisfaction. Whether you own and occupy your office space or lease commercial space to others, the IntelliPak II rooftop system is the answer for building comfort, efficiency, flexibility, and reliability. This advanced rooftop system is designed for application flexibility across a wide range of commercial office and mixed-use building types.



Healthcare

Healthcare facilities—medical office buildings, outpatient and surgery centers, hospitals, diagnostic centers, and extended care applications—while demanding in general, share many common requirements for flexibility, patient comfort, safety, documentation, and reporting. IntelliPak II packaged rooftop systems help meet these needs.

Indoor air quality is paramount in healthcare facilities. The IntelliPak II rooftop system offers features such as fresh air measurement to help ensure proper ventilation levels, removal of airborne particulates, and increased comfort. The IntelliPak II rooftop system also provides unit construction features like positive condensation removal and double wall construction to facilitate routine cleaning of surfaces in the unit air stream. With the Tracer™ SC controller, scheduling flexibility and simplified reporting for regulatory and government agencies is now easier than ever.

Education

Today's education professionals are interested in total building systems that will help achieve a cost-effective, high-performance learning environment, with the additional benefits that a web-based user interface and scalable system offerings can provide. The IntelliPak™ II rooftop system is designed with these needs in mind. This product can contribute to improved student performance, reduced absenteeism, operating cost containment, physical security, and an enhanced image through state-of-the-art temperature and environment control.



Retail and entertainment facilities

The last thing retail store or entertainment facility operators want is an uncomfortable indoor environment for their customers.

When customers are dissatisfied with comfort, revenues fall. In today's demanding business environment, it is critical to contain operating costs while maintaining a quality environment for customers. The IntelliPak II rooftop system is designed to meet both of these needs.



Superior product, service, and warranty support

If you've used Trane rooftop products or controls in the past, you know they are supported by the entire Trane team, before, during, and after the sale. Trane provides industry-leading sales consultation through your Trane Account Executive, and factory-authorized training for customer maintenance and operations personnel, service contracting, and facility monitoring. Factory-trained Trane service technicians can be dispatched quickly to keep your system in top-notch operating condition. Quality Trane parts and services ensure comfort and energy savings. If it's a Trane rooftop system, you expect the best and we deliver it.



Trane optimizes the performance of homes and buildings around the world. A business of Ingersoll Rand, the leader in creating and sustaining safe, comfortable and energy efficient environments, Trane offers a broad portfolio of advanced controls and HVAC systems, comprehensive building services, and parts. For more information, visit www.Trane.com.