

11081

Bluetooth music receiver

With A2DP/SBC supported



Feature

- ⊙ SBC codec support
- ⊙ A2DP Bluetooth profile supported
- ⊙ 33 feet(10M) effective range
- ⊙ Audio RL audio output
- ⊙ 8 devices ID storable

What's in the box

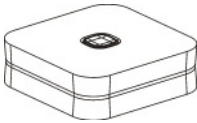

Main unit

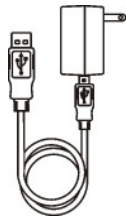

AC/DC adaptor
And USB cable



3.5mm male→
male audio cable



3.5mm female→
audio RL cable

Outlook and connectors

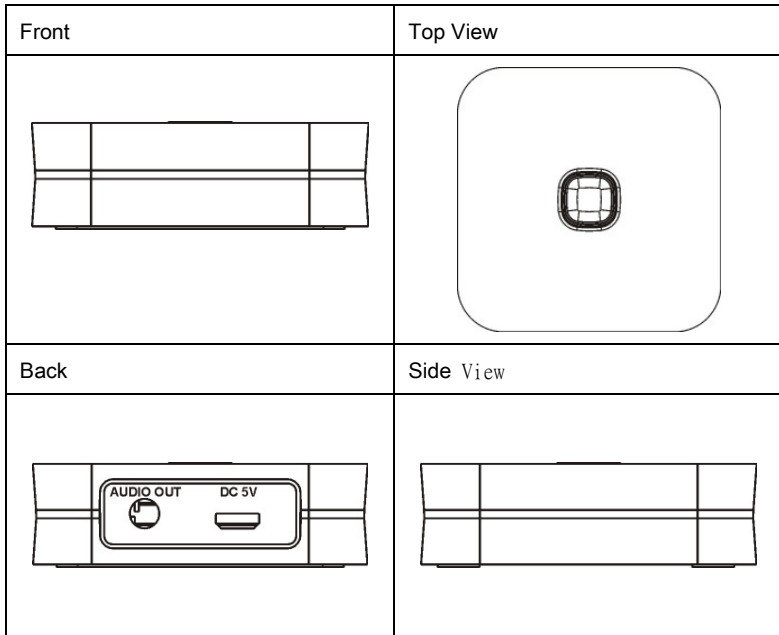

Setup your 11801

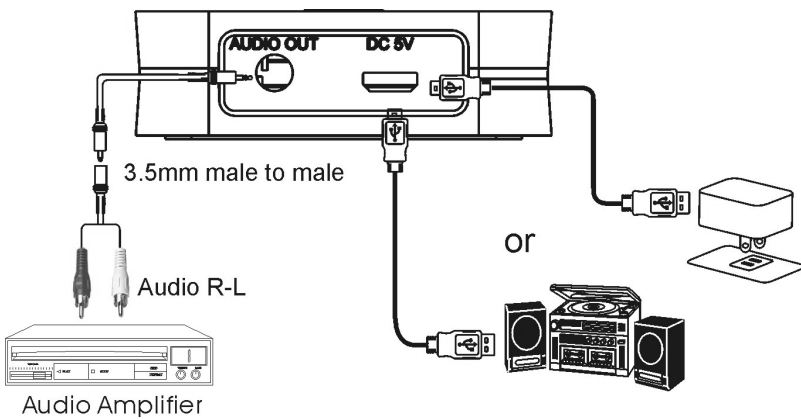

Analogue connection

1. Connect one 3.5mm end of the include audio to headphone jacket on the 11801
2. Connect the other end to an audio input on your home stereo system (3.5mm or 3.5mm + 3.5mm→2 RCA). Consult your stereo user's manual for more information on how to accomplish this.
3. Consult your stereo user's manual for more information on how to accomplish this.
4. Connect USB A to micro USB adaptor cable, the micro USB end to the micro USB jacket of 11801, USB Type A connector to the USB port of your Audio Video Device or you can connect to an AC Adaptor with USB port(option) , the AC end to any AC outlet.
5. The LED light will flash once to show the unit is powered and ready for being paired for your devices.

Pairing your 11801

iPad/iPhone/iPod touch

1. Go to Bluetooth manager of your iPad/iPhone/iPod touch by the following steps



a. From your iPad/iPhone/iPod touch home page, tap "setting"



b. Inside Settings tap on "General"



c. Inside General tap on "Bluetooth"

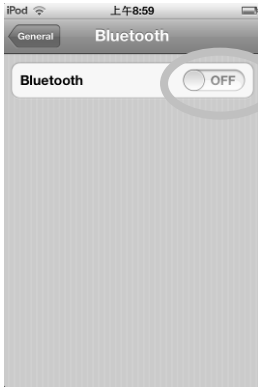

2. Turn On the Bluetooth function



3. Your iPod/iPhone/iPad will auto searching available device. You will see "Music Receiver" then Tap on it.

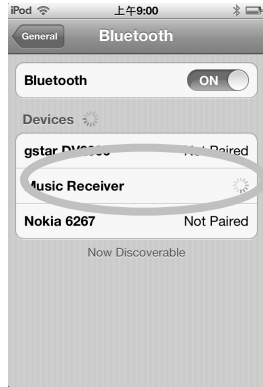

4. Enter "0000" when the player asks for PIN code (some devices have no need to input PIN). This will allow the iPad/iPhone/iPod touch to pair with "Music Receiver"



5. Your iPod/iPhone/iPad connected to 11081 Now. And You can play music from your iPod/iPhone/iPad.

Android Phone/Tablet (ver 4.0 as Example)

1. Go to Bluetooth manager of your smart phone by the following step



a. From your smart phone home page, tap on "setting"

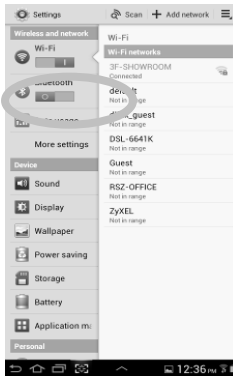

b. Inside the setting, turn on the Bluetooth

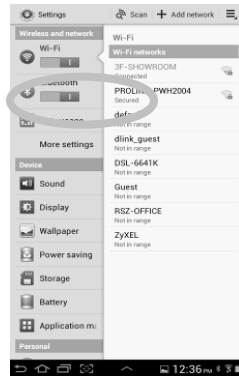

c. Bluetooth is turned on

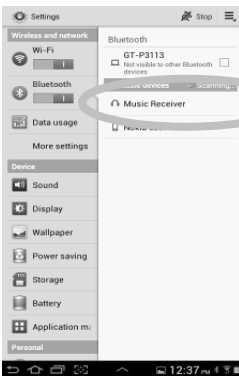

2. Searched Bluetooth Devices will show up, please tap on "Music Receiver"

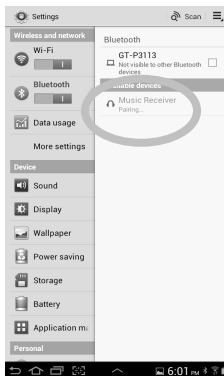

3. Enter "0000" when the player asks for PIN code (some devices have no need to input PIN).

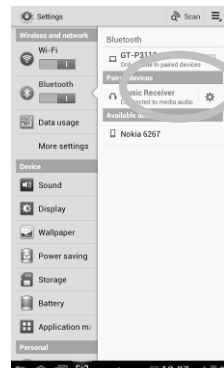

4. Once paired, the blue LED light on the 11801 will flash once. The Blue LED will keep lighted when a connection is established And In your Smartphone there is showed "connected to media audio"

Note:

Some devices, such as iPhone, will connect immediately after pairing so the LED will ON. Other devices, such as notebook, may ask you if you wish to connect and LED will go off after pairing until a connection is established.

Although the 11801 can only play music from one device at a time, it is capable of being paired to up to 8 devices. It means that you have to enter the PIN code once for each device.

You can play the music now. Just play music on your device as you normally would and the sound will come out from your stereo system.

Note: the effective range of 11801 is 33 feet(10M). (light of sight). If you hold and wear the Smartphone or tablet and cover the Bluetooth antenna, the distance will be shorter.

Disconnecting the connection via manual button

When you need to disconnect the connected Smartphone, you can push the button on the Top of 11801 then it will on the pairing Mode for new connection

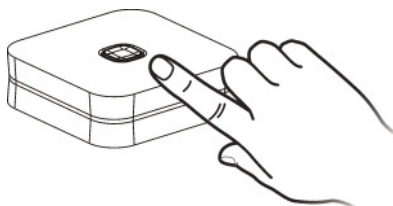

Reconnecting your device

If you move out of range or turn off the Bluetooth feature on you iPad/iPhone/iPod touch or Smartphone, 11801 will disconnected from your device. To reconnect, simply open the Bluetooth manager and tap on the “Music Receiver”, then you do not need to input PIN again, the connection will be done automatically.

Adding a new phone or tablet :

If you want to switch from one device to another, please follow these steps

1. End the existing Bluetooth connection with connected device.
2. The 11801 can now be connected with another device such as iPad/iPod/iPhone or Smartphone or tablet.
3. Follow the section “Pairing the 11801” to connect a new device.

Out of range or lost signal:

When the paired phone or device away from receiver (33 feet) or there is something blocking the Bluetooth signal. The LED light will go off, it means the connection between device and 11801 is lost. To avoid a lost connection:

1. Move the music device back into range (within 33 feet), and make sure there's a clear line of sight and there are no obstructions between 11801 and device.
2. Within 15 seconds, the connection will automatically be reestablished and LED will turn on
3. If the connection is lost for more than 15 seconds, you need to reconnect the device and 11801 again. Please follow the “Reconnect Your Device” section.

Indication of LED

Indication	Meaning	Description
Flash once 1 sec per 5 secs	Power on /Pairing	Waiting for connection
Permanent Lighted	Connected	Device and main unit are connected

Troubleshooting

You can solve your problems from this section

No music out from my stereo speaker

- ⊙ Make sure the 11801 is powered.
- ⊙ Make sure an audio cable or an Optical cable is correctly and firmly connected to 11801
- ⊙ Make sure the volume of the stereo is set to a comfortable listening level
- ⊙ Make sure you are within range.
- ⊙ Make sure the Bluetooth function is opened on your device.
- ⊙ Make sure you are playing the music from your device.

SAFETY WARNINGS

- ⊙ 11801 requires full connection and both hands to install.
- ⊙ Do not use 11801 near water(for example, a bath tub, wash bowl, kitchen sink, laundry tub, wet basement, swimming pool, or other areas located near water).
- ⊙ Clean with dry cloth.
- ⊙ Unplug the 11801 before cleaning.
- ⊙ Install 11801 far away from heat sources.
- ⊙ Use only the attached accessories.
- ⊙ Unplug the 11801 when unused for long time.

FCC Statement

Changes or modifications not expressly approved by the party responsible for compliance could void the user's authority to operate the equipment.

This device complies with part 15 of the FCC Rules. Operation is subject to the following two conditions:

- (1) This device may not cause harmful interference, and
- (2) this device must accept any interference received, including interference that may cause undesired operation

Part 15B compliance statement:

NOTE: This equipment has been tested and found to comply with the limits for a Class B digital device, pursuant to part 15 of the FCC Rules. These limits are designed to provide reasonable protection against harmful interference in a residential installation.

This equipment generates, uses and can radiate radio frequency energy and, if not installed and used in accordance with the instructions, may cause harmful interference to radio communications. However, there is no guarantee that interference will not occur in a particular installation.

If this equipment does cause harmful interference to radio or television reception, which can be determined by turning the equipment off and on, the user is encouraged to try to correct the interference by one or more of the following measures:

- ___ Reorient or relocate the receiving antenna.
- ___ Increase the separation between the equipment and receiver.
- ___ Connect the equipment into an outlet on a circuit different from that to which the receiver is connected.
- ___ Consult the dealer or an experienced radio/TV technician for help.