

**Infrared Thermometer**  
TET-380

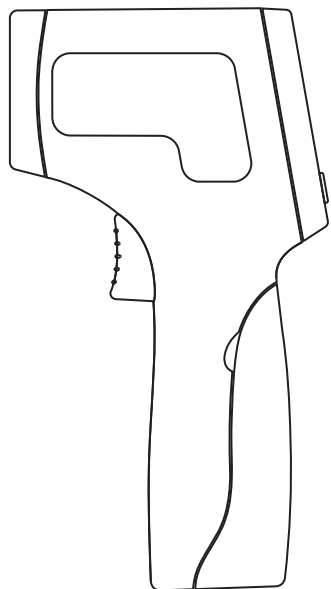

Rev.00 20131023

**Contents**

Cautions .....2  
 Special Features .....2  
 Measurement Principle .....2  
 Product scope .....3  
 The component of product .....3  
 Setting .....3  
 °C / °F unit conversion formula .....4  
 Method of measurement .....4  
 Connect iOS device via Bluetooth .....5  
 Memory Function .....5  
 Replacing the Batteries .....6  
 Cleaning and Care .....6  
 Display Message .....7  
 Product Specifications .....8

- 1 -

Thank you for purchasing the non-contact electronic thermometer, Please read through this manual before using the product.

**Cautions**

1. Do not drop or shock the unit.
2. Do not immerse the unit into water.
3. Keep the unit out of reach of children.
4. Avoid touching the lens with bare hand.
5. Do not use in areas with strong electromagnetic interference.
6. Consult your physician if the reading is out of normal body temperature range.
7. Remove the batteries from the thermometer if the unit will not be used for an extended period of time. This will prevent battery leakage causing damage to the thermometer.
8. If the unit is not working properly, please contact customer service.
9. Do not disassemble the unit, Open the battery cover only when replacing batteries.

**Special Features**

1. Measurement range: Body: 32~42.2°C / 90~108°F  
Surface: 20~60°C / 68~140°F
2. Free to set alarm temperature.
3. Non-contact measurement ,avoid cross infection.
4. Memory for 50 readings.
5. Auto power off without use it.
6. Unit of Measure: °C/°F.
7. Backlight.

**Measurement Principle**

Measuring the temperature of the body and the surface on forehead with infrared. Products the same

- 2 -

built-in infrared sensor and related hardware, software, can sense the analyte, analysis and records and environmental temperature, and once the user has to pass the instrument near certain parts of the body (forehead), and press the measure button can immediately active infrared radiation sensor.

**Product scope**

For measurement of body and surface temperature.

**The component of product**

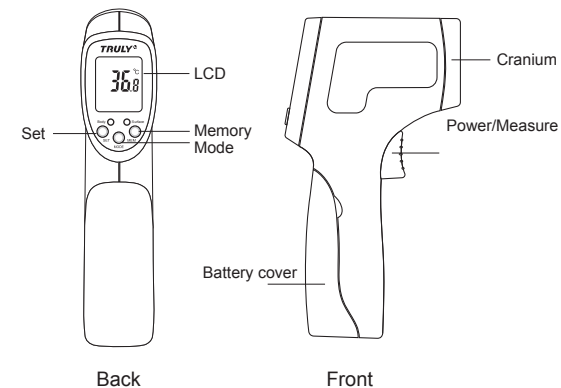

**Setting**

1. Pressing the "SET" Key for 3 seconds, The thermometer will be turn on and enter the setting mode, the LCD display F-00 and alarm temperature value.
2. Modify the setting value  
Pressing the "MODE" or "MEM" key to change

- 3 -

- the value.
3. Switch to other setting item:  
Press the "SET" key to switch to other item.  
F-01: Offset value for body mode(-2.0~+2.0).  
F-02: Offset value for surface mode(-2.0~+2.0).  
F-03: Temperature Unit (°C/°F).  
F-04: Delete records(Yes,No)

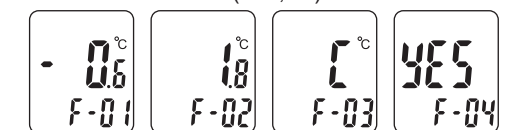

4. Save setting value.  
Pressing the "SET" key for 3 seconds to save the value and exit setting mode. If F-04 value is "YES", The thermometer will be delete all records.

**°C / °F unit conversion formula**

$$°F = 1.8 \times °C + 32$$

**Method of measurement**

1. Pressing "Power" and display.
2. Press "MODE" key to select temperature measurement mode (body or surface) :  
(1) Thermometer is straight to the forehead, and distance is 5~10cm.

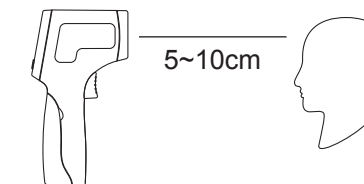

- 4 -

- (2) Pressing and holding the "Measure" key and move thermometer scanning forehead.
- (3) Release the "Measure" key to finish measurement and display the result on LCD.
- (4) Turn off: The thermometer will turn off automatically without use for 1 minute.

**Note:**  
The correct method of use is the key to test the accuracy. Please follow these instructions, so as to avoid the infrared measurement on the surrounding.

1. Testing temperature, as the showing in the figure, instrument and the distance from the forehead suggested in 5cm to 10cm.
2. Keep the body's temperature as the same as the surrounding.
3. It should be avoided cold and any disease of cool down the temperature.
4. Keep the Instrument's temperature as the same as the surrounding.
5. Forbidden to use this instrument in the strong sunshine place.
6. Measure suggestion: 3 times or so, every time when to display up to a set of data shall prevail.

**Connect iOS device via Bluetooth**

1. Installation  
Prior to first use, Download and install application to your iOS device. (Bluetooth 4.0 capabilities, e.g. iPhone 4S, iPhone 5, NewiPad and iPadMini).
2. Open application, and then press the Blood Pressure icon on Measure screen.
3. Press the "Enter" button.
4. Press the "Thermometer" button.

- 5 -

5. When the measurement is complete, the temperature will display on Thermometer monitor & save on iOS application screen.
6. This thermometer stores the last temperature readings.



**Memory Function**

1. Pressing "Power" and display and shown the last records.
2. Pressing the "MEM" key to switch record shows upper  
\* LCD display test records and record number.
3. Switch mode  
\* Pressing the "MODE" key to switch MODE.

**Replacing the Batteries**

Products use battery by 2, when a battery symbol appears and flash in the screen, and replace the battery as soon as possible.

**Note:**

1. Open the battery cover to replace batteries, and place the battery is the location of the negative electrode correctly.
2. If not use, please take out the battery so as to protect instrument.

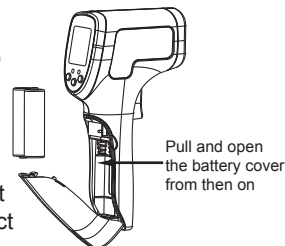

- 6 -

**Cleaning and Care**

1. Use a soft, dry cloth to clean the exterior of the thermometer.
2. Keep the thermometer away from direct sunlight, dust and contamination environment.
3. Store the thermometer in normal room temperature, or within 10-40°C.
4. Don't touch with the finger.
5. Can use less than 75% of the rubbing alcohol to clean the lens.

**Display Message**

Display message	Situation	Solution
	Ambient temperature is out of operating range (10-40°C)	Allow the thermometer remain in room temperature (10-40°C) for 30 minutes.
	Sensor error	Please contact with the customer service.
	Memory error	Please contact with the customer service.
	Temperature measured is higher than normal human temperature range (Body above 42.2°C; Surface above 60°C)	Check the measured object and take a new measure.
	Temperature measured is lower than normal human temperature range (Body below 32°C; Body below 20°C)	Check the measured object and take a new measure.
	Low battery	Replace batteries.

- 7 -

**Product specification**

Project	Content		
Measuring type	Infrared measuring		
Measuring mode	Surface/body temperature		
Measuring distance	5~10cm		
Accuracy	Measuring	Surrounding	Accuracy
	32~42.2°C	16~35°C	±0.3°C
	20~32°C 42.2~60°C	10~40°C	±0.4°C
Indicator Functions	LCD display		
Low voltage tip	< 2.2V±0.3		
Display resolution	0.1°C		
Unit	°C , °F		
Work surrounding	10°C~40°C		
Storage temperature	-20°C~+50 °C		
Automatic shutdown	1 minute after not being used		
Memory	50 Group memory		
Battery	2 x AA		
Size	158.8×86.6×37.4 mm		
Weight	About 93g (Not including batteries)		

- 8 -

This appliance conforms to the following standards:

- EN60601-1: Medical electrical equipment Part 1: General requirements for safety
- EN12470-5: Clinical thermometers Part 5: Performance of infrared ear thermometers (with maximum device)
- 93/42/EEC : Medical Device Directive
- ASTM E 1965-98: Standard Specification for Infrared Thermometers for Intermittent Determination of Patient Temperature

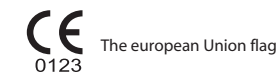
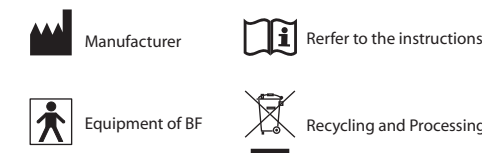

**IP22** IP is short for Ingress Protection which means that Protection's level.

## **FCC Caution.**

### **§ 15.19 Labelling requirements.**

This device complies with part 15 of the FCC Rules. Operation is subject to the following two conditions: (1) This device may not cause harmful interference, and (2) this device must accept any interference received, including interference that may cause undesired operation.

If the labelling area is considered too small and therefore it is impractical (smaller than the palm of the hand) to display the compliance statement, then the statement may be placed in the user manual or product packaging.

### **§ 15.21 Information to user.**

Any Changes or modifications not expressly approved by the party responsible for compliance could void the user's authority to operate the equipment.

### **§ 15.105 Information to the user.**

**Note:** This equipment has been tested and found to comply with the limits for a Class B digital device, pursuant to part 15 of the FCC Rules. These limits are designed to provide reasonable protection against harmful interference in a residential installation. This equipment generates uses and can radiate radio frequency energy and, if not installed and used in accordance with the instructions, may cause harmful interference to radio communications. However, there is no guarantee that interference will not occur in a particular installation. If this equipment does cause harmful interference to radio or television reception, which can be determined by turning the equipment off and on, the user is encouraged to try to correct the interference by one or more of the following measures:

- Reorient or relocate the receiving antenna.
- Increase the separation between the equipment and receiver.
- Connect the equipment into an outlet on a circuit different from that to which the receiver is connected.
- Consult the dealer or an experienced radio/TV technician for help.