

User guide



# Fall Detector™

312.00MHz

All the reassurance you need

**Tunstall**

## What is the fall detector?

Your **fall detector**™ is a battery operated device containing a microprocessor, detector and a radio transmitter. It will automatically trigger an alarm call on your personal emergency response system if it detects that you have fallen. You can also use it to manually raise an alarm call.

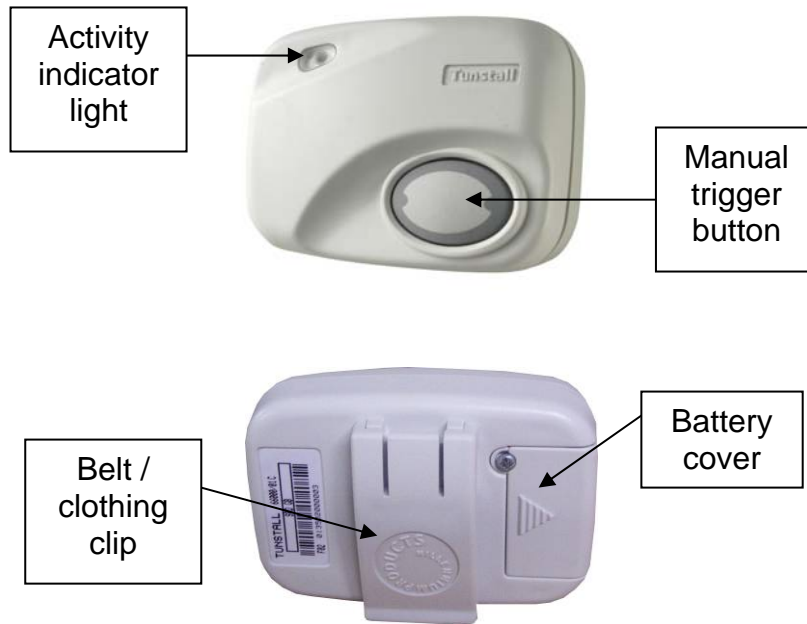

### **Wearing the *fall detector***

Clip the **fall detector** to your belt or clothing in the upright position shown in the drawing. It needs to be in the upright position to reduce the possibility of false activation.

<b>Correct upright position</b>	<b>Incorrect position</b>
	

**NOTE:** An optional Belt and Holster is available (Part Number D6609001C).



## Automatic fall detection

- Green light and two "beeps" indicate that the **fall detector** has been activated.
- The **fall detector** will then monitor for between 6 and 15 seconds to verify if there could have been a fall. The green light will flash while it does this.
- If the detector has decided that there is a fall, then a red light and four "beeps" indicates that the **fall detector** is about to trigger an alarm call (because it has detected an impact and has not been upright for between 6 and 15 seconds).
- If the detector has decided that it was activated by error then the green flashing light will stop after between 6 to 15 Seconds and the unit will revert to normal again.
- Due to the complex dynamics of falling, all falls may not be detected. In this unlikely event the manual button can still be used to call for help.

## Manual operation

- Press the button on the fall detector to raise a manual alarm call.
- The **fall detector** will "beep" and a red light indicates the **fall detector** is triggering an alarm call.
- If the red light flashes on and off, the **fall detector** is still triggering an alarm call, but is also indicating to you that the battery needs to be replaced.

Remember, the **fall detector** will only detect you falling if you are wearing it.

- The **fall detector** must be worn at or above the waist, where it will detect the maximum number of falls.
- When removing the **fall detector**, handle carefully to avoid false calls, place it on an even surface in the upright position and preferably in the stand provided.



- If the **fall detector** does wake up and beep when you know you have not fallen, you can prevent it raising an alarm by ensuring that it is returned to an upright position.
- It is not recommended that you wear the **fall detector** whilst in bed, as normal movement in bed will cause the fall detector to trigger.

## **Battery Replacement**

From time to time the battery will need replacing, you will know this because somebody from your monitoring service (if you have one) may inform you, or you may see the red light flashing rather than staying on continuously when a manual alarm call is made.

- The unit automatically tests the battery several times within each 24 hour period. It is able to automatically generate an alarm call when low battery is detected.
- If it is necessary for you to change the battery, the fall detector uses a 6 volt Duracell PX28L battery.
- After a year the battery should be replaced. Contact your provider for a replacement. In many cases your provider will change the battery for you. On the back of this user guide is a handy table to help you remember when the battery should be changed.

### To replace the battery

- 1) To access the battery, remove the battery cover screw
- 2) Then remove the battery cover by sliding it in the direction of the arrow.



- 3) Remove battery and replace it with the new battery, remember to observe the correct orientation. When the battery is first placed in the unit an automatic test call will be generated (no lights will show and no buzzer will sound).
- 4) Replace the sliding cover and the screw. Test the fall detector by making a manual call. Inform the operator that you are making a battery test call.
- 5) If the device fails to make a test call then check the orientation of the battery. If this is correct then contact your supplier.

**NOTE:** Dispose of used battery in accordance with the latest legislation. Do not dispose of in household waste.

## Care of the fall detector

- Avoid getting the **fall detector** wet (if it does then dry it quickly and make a manual test call to confirm it is working correctly).
- If required, the **fall detector** may be cleaned periodically with a damp cloth and mild detergent.
- It is recommended that you test the **fall detector** once a month:
- Make a manual test call.
- Start with the **fall detector** vertical. Place the **fall detector** horizontal and then tap within 3 seconds after placing horizontal. After 5 Seconds the **fall detector** should beep and the green light start to flash. If you put the unit quickly back upright (in its stand, for instance), the alarm call will not be raised.



## Radio Approval Notices

### Australia

The Fall Detector operates on a frequency of 312MHz and is certified approved by TRL Compliance to AS/NZS 4268:2003

### Canada

Canadian Certification Approvals Number  
IC: 1231A-66004A

### USA

#### Federal Communications Commission (FCC) notices

This equipment has been tested and found to comply with the limits for a Class B digital device, pursuant to part 15 of the FCC Rules. These limits are designed to provide reasonable protection against harmful interference in a residential installation. This equipment generates, uses and can radiate radio frequency energy and, if not installed and used in accordance with the instructions, may cause harmful interference to radio communications.

However, there is no guarantee that interference will not occur in a particular installation. If this equipment does cause harmful interference to radio or television reception, which can be determined by turning the equipment off and on, the user is encouraged to try to correct the interference by one or more of the following measures:

- Reorient or relocate the receiving antenna.
- Increase the separation between the equipment and receiver.
- Connect the equipment into an outlet on a circuit different from that to which the receiver is connected.

- Consult the dealer or an experienced radio/TV technician for help.

Fall Detector Radio Trigger  
Model Numbers  
66004/01  
66004/02  
66004/03  
66004/04

FCC ID: G2X-66004A

This Device complies with Part 15 of the FCC Rules.  
Operation is subject to the following two conditions:  
(1) This device may not cause harmful interference, and  
(2) This device must accept any interference received, including interference that may cause undesired operation.

Warning  
Changes or modifications to this unit not expressly approved by the party responsible for compliance could void the user's authority to operate the equipment.

## Battery Replacement Guide

Battery Inserted Date			Battery Replacement Date		
<i>Day</i>	<i>Month</i>	<i>Year</i>	<i>Day</i>	<i>Month</i>	<i>Year</i>

**Remember to change the battery once a year.**



**Tunstall**

[www.tunstall.co.uk](http://www.tunstall.co.uk)

Our policy of continual development means that product specification and appearance may change without notice. © 2007 Tunstall Group Ltd.  
TUNSTALL and FALL DETECTOR are trade marks.

Tunstall Group Limited, Whitley Lodge, Whitley Bridge, Yorkshire DN14 0HR  
Tel: 01977 661234 Fax: 01977 662450 Email: [enquiries@tunstall.co.uk](mailto:enquiries@tunstall.co.uk)