

Installation Instructions

PK55XX RFK55XX-433

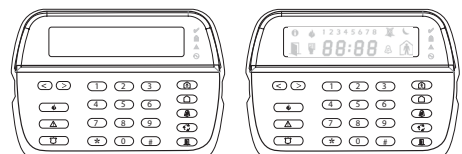

PK5500
RFK5500

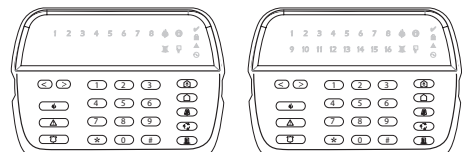

PK5501
RFK5501

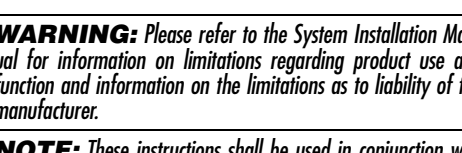

PK5508
RFK5508



PK5516
RFK5516

WARNING: Please refer to the System Installation Manual for information on limitations regarding product use and function and information on the limitations as to liability of the manufacturer.

NOTE: These instructions shall be used in conjunction with the system Installation Manual of the Control Panel with which this equipment is intended to be used.

Language Programming (PK5500/RFK5500 Only)

Hold (<>) keys for 2 seconds to enter language programming, scroll to the desired language and Press [*] to select.

Enrolling the Keypad

The keypad will need to be assigned to a partition and slot if supervision or keypad zones are being used. Keypad assignments and keypad option programming must be done at each keypad individually.

The 1st digit of keypad assignment is used to determine partition assignment (1 to 8). If partitioning is not used, enter [1]. For Global Keypads, enter [0].

NOTE: LED and ICON keypads cannot be programmed as Global Keypads

The 2nd digit of keypad assignment is used to determine slot assignment for keypad supervision. Each keypad will be assigned a different slot number from 1 to 8. PK5500 and RFK 5500 LCD keypads come defaulted in slot 8. If LCD keypads are used one LCD keypad must remain in slot 8.

NOTE: The RFK55XX enrolls as two modules:

1 = keypad section of the RFK55XX

17 = receiver section of the RFK55XX

NOTE: Deleting all wireless devices from the RFK55XX or defaulting the RFK55XX will cause a supervisory fault.

Enter the following at each keypad installed on the system:

1. Enter Installer Programming by pressing [*][8][Installer's Code]
2. Press [000] for Keypad Programming
3. Press [0] for Partition and Slot Assignment
4. Enter the 1st digit (0 to 8 for partition assignment)
5. Enter the 2nd digit (1 to 8 for slot assignment supervision)
6. Press the [#] key twice to exit programming.
7. After assigning all keypads, perform a supervisory reset by entering [*][8][Installer's Code][902] and wait for 60 seconds.
8. Press the [#] key to exit programming after 60 seconds.

Installation Instructions

The PK55XX\RFK55XX keypads can be used on security systems with up to 64 zones. These keypads are compatible with the following DSC security systems:

- PC580/PC585
- PC1555MX/PC1565
- PC1616/PC1832/PC1864
- PC5005
- PC5008
- PC5010
- PC5015
- PC5016
- PC5020

The RFK55XX keypads combine a standard PC5132 receiver with the respective PK55XX keypad.

Specifications

- Voltage rating: 12VDC nominal
- Connects to control panel via 4-wire Keypas
- 1 keypad zone input/PGM output*
- Current draw: 50mA (standby)/125mA (maximum)
- Optional tamper version
- 5 programmable function keys
- Ready (green LED), Armed (red LED), Trouble (yellow LED), AC (green LED)
- Low temperature sensor
- Frequency: 433.92MHz (RFK55XX-433 Only)
- Upto 32 wireless zones (RFK55XX Only)

NOTE: * Zone not to be programmed as Fire type or 24h type.

Unpacking

The Power keypad package includes the following parts:

- One Power keypad
- Keypad inner door labels
- Four mounting screws
- 1 tamper switch
- 2 end-of-line resistors
- 1 Installation Instructions

Mounting

You should mount the keypad where it is accessible to designated points of entry and exit. Once you have selected a dry and secure location, perform the following steps to mount the keypad.

1. Removing the keypad from the backplate for the first time.

(a) Position the keypad as indicated below, insert screwdriver and rotate.

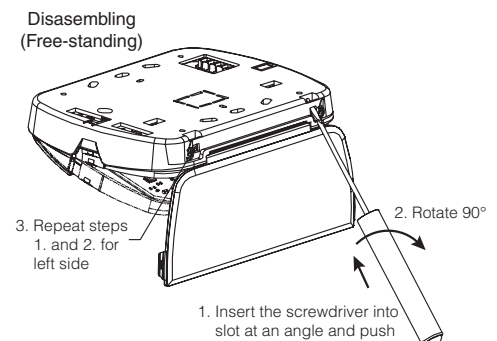

2. Removing the keypad from backplate once mounted.
 - (a) Open door, holding it 90° to the keypad, as shown below.
 - (b) Insert screwdriver into slot located under the door hinge and rotate the screwdriver.

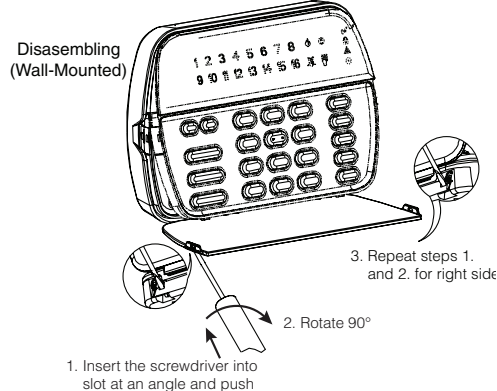

3. Repeat steps 1. and 2. for right side

Wiring

1. Before wiring the unit, ensure that all power (AC transformer and battery) is disconnected from the control panel.

2. Connect the four Keypas wires from the control panel (red, black, yellow and green) to the keypad terminals. Refer to diagram:

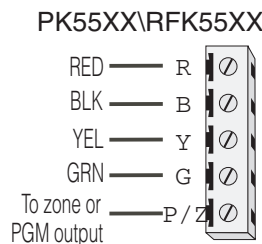

3. If programmed as an input, you can connect a device - such as a door contact - to the 'P/Z' terminal of the keypad. This eliminates the need to run wires back to the control panel for the device. To connect the zone, run one wire from the device to the 'P/Z' terminal and the other wire from the device to the B (black) terminal. For powered devices, run the red wire to the R (positive) terminal and the black wire to the B (negative) terminal. When using end of line supervision, connect the zone according to one of the configurations outlined in your system's Installation Manual.

4. If the 'P/Z' terminal is programmed as an output, the output follows the PGM programmed in Section [080]. A small relay, buzzer or other DC operated device may be connected between the positive supply voltage and the 'P/Z' terminal (maximum load is 50mA).

Applying Power

Once all wiring is complete, apply power to the control panel:

1. Connect the battery leads to the battery.
2. Connect the AC transformer.

For more information on control panel power specifications, see the control panel Installation Manual.

[065] Fire Alarm Label (28 Characters) (PK5500/RFK5500 Only)

Default: "Fire Zone"

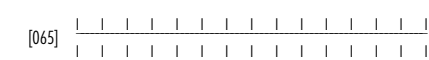

[066] Fail to Arm Event Message (PK5500/RFK5500 Only)

Default: "System Has Failed to Arm"

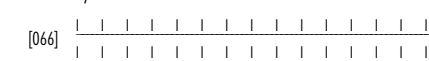

[067] Alarm When Armed Event Message (PK5500/RFK5500 Only)

Default: "Alarm Occurred While Armed <>"

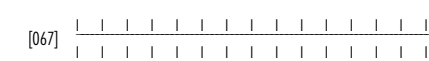

[071] First User Display Mask

Default	Option	ON	OFF
ON	[] 1	Hold [P]anic Key prompt ON	Hold [P]anic Key prompt OFF
ON	[] 2	Auto-arm Control/Time prompt ON	Auto-arm Control/Time prompt OFF
ON	[] 3	Quick Arm prompt ON	Quick Arm prompt OFF
ON	[] 4	Interior Arm prompt ON	Interior Arm prompt OFF
OFF	[] 5	Quick Exit prompt ON	Quick Exit prompt OFF
OFF	[] 6	Thermostat Control prompt ON	Thermostat Control prompt OFF
OFF	[] 7	ACK All Trouble Prompt ON	ACK All Trouble Prompt OFF
OFF	[] 8	Music Input prompt ON	Music Input prompt OFF

[072] Second User Display Mask

Default	Option	ON	OFF
ON	[] 1	User-initiated Call-up prompt ON	User-initiated Call-up prompt OFF
OFF	[] 2	For Future Use	
OFF	[] 3	Walk Test prompt ON	Walk Test prompt OFF
ON	[] 4	Command Output#1 prompt ON	Command Output#1 prompt OFF
ON	[] 5	Command Output#2 prompt ON	Command Output#2 prompt OFF
OFF	[] 6	Command Output#3 prompt ON	Command Output#3 prompt OFF
OFF	[] 7	Command Output#4 prompt ON	Command Output#4 prompt OFF
OFF	[] 8	For Future Use	

Programming the Keypad

There are several programming options available for the keypad. These are described below. Programming the keypad is similar to programming the rest of the system. When you are in the keypad programming sections, the keypad will display which options are turned on along the top of the display. To turn an option on or off, press the number corresponding to the option on the number pad. The numbers of the options that are currently turned ON will be displayed. For example, if options 1 and 4 are on, the display will look like this on the different keypad displays:

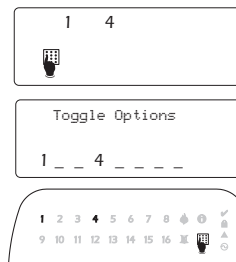

For information on programming the rest of your security system, please refer to your system's Installation Manual.

Programming LCD Labels

All LCD programming is done per keypad. If more than one LCD keypad is present on the system, labels programmed at one keypad can be broadcast to all other LCD keypads. Perform the following procedure in order to broadcast labels:

Step 1 - Program one LCD keypad completely.

Step 2 - Make sure all LCD keypads are connected to the Keypas.

Step 3 - Enter Installer's Programming, then enter section [998] at the keypad that was programmed. The keypad will now broadcast all the information programmed to all the other LCD keypads on the system.

Step 4 - When the keypad is finished press the [#] key to exit.

NOTE: Label broadcast from this keypad is only compatible with other PK5500 and RFK5500 Keypads.

[073] Download LCD Message Duration (PK5500/RFK5500 Only)

Default: 003 [] [] [] [] (Valid entries are 000-255), 000 = Unlimited Message Disp. This number represents the number of times the Downloaded message is cleared by pressing any key while the message is up after timeout).

[074] Key Options

Default	Option	ON	OFF
ON	[] 1	[F]ire Key Enabled	[F]ire Key Disabled
ON	[] 2	[A]uxiliary Key Enabled	[A]uxiliary Key Disabled
ON	[] 3	[P]anic Key Enabled	[P]anic Key Disabled
OFF	[] 4-8	For Future Use	

[076] First Keypad Options

Default	Opt.	ON	OFF
ON	[] 1	Display Code when Programming	Display "Xs" when Programming
ON	[] 2	Local Clock Display ON	Local Clock Display OFF
OFF	[] 3	Local Clock Displays 24-hr Time	Local Clock Displays AM/PM
ON	[] 4	Auto Alarm Memory Scroll Enabled	Auto Alarm Memory Scroll Disabled
OFF	[] 5	Local Display of Temperature ON	Local Display of Temperature OFF
ON	[] 6	Bypass Options prompt ON	Bypass Options prompt OFF
OFF	[] 7	For Future Use	
OFF	[] 8	Auto-Scroll Open Zones ON	Auto-Scroll Open Zones OFF

[077] Second Keypad Options

Default	Opt.	ON	OFF
ON	[] 1	Chime Enabled for Zone Openings	Chime Disabled for Zone Openings
ON	[] 2	Chime Enabled for Zone Closings	Chime Disabled for Zone Closings
OFF	[] 3	5th Terminal is Keypad PGM Output	5th Terminal is Keypad Zone Input
OFF	[] 4	For Future Use	
OFF	[] 5	Power LED Enabled	Power LED Disabled
ON	[] 6	Power LED indicates AC present	Power LED indicates AC absent
ON	[] 7	Alarms always Displayed When Armed	Alarms not Displayed When Armed
OFF	[] 8	Low Temperature Warning Enabled	Low Temperature Warning Disabled

[080] PGM Terminal 1

Default: 01 [] [] [] [] PGM Output Number

FCC Compliance Statement

Caution: Changes or modifications not expressly approved by Digital Security Controls could void your authority to use this equipment.

This equipment generates and uses radio frequency energy and if not installed and used properly, in strict accordance with the manufacturer's instructions, may cause interference to radio and television reception. It has been type tested and found to comply with the limits for Class B device in accordance with the specifications in Subpart "B" of Part 15 of FCC Rules, which are designed to provide reasonable protection against such interference in any residential installation. However, there is no guarantee that interference will not occur in a particular installation. If this equipment does cause interference to television or radio reception, which can be determined by turning the equipment off and on, the user is encouraged to try to correct the interference by one or more of the following measures:

- Re-orient the receiving antenna
- Relocate the alarm control with respect to the receiver
- Move the alarm control away from the receiver
- Connect the alarm control into a different outlet so that alarm control and receiver are on different circuits.

If necessary, the user should consult the dealer or an experienced radio/television technician for additional suggestions. The user may find the following booklet prepared by the FCC helpful: "How to Identify and Resolve Radio/Television Interference Problems". This booklet is available from the U.S. Government Printing Office, Washington, D.C. 20402, Stock # 004-000-00345-4.

This Class B digital apparatus complies with Canadian ICES-003.

Cet appareil numérique de la classe B est conforme à la norme NMB-003 du Canada.

IC:160A-RFK55XX4

The term IC before the radio certification number signifies that the Industry Canada technical specifications were met.

Operating Instructions shall be made available to the user.



©2006 Digital Security Controls, Toronto, Canada • www.dsc.com
Tech. Support: 1-800-387-3630 (Canada, US), 905-760-3036
Printed in Canada



29007261R001

[101]-[108] Partition Labels (PK5500/RFK5500 Only)

ex. For Partition 1 enter section [101], for Partition 2 enter section [102] etc.

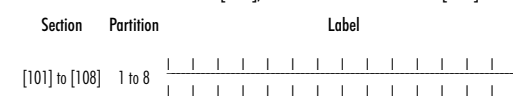

NOTE: Partition 1 Label is also used as the System Label

[120]-[151] Command Output Labels (PK5500/RFK5500 Only)

Default: "Command O/P 1" - "Command O/P 4"

For Partition 1 Command O/P 1 to 4 enter [120] to [123]

For Partition 2 Command O/P 1 to 4 enter [124] to [127]

For Partition 3 Command O/P 1 to 4 enter [128] to [131]

For Partition 4 Command O/P 1 to 4 enter [132] to [135]

For Partition 5 Command O/P 1 to 4 enter [136] to [139]

For Partition 6 Command O/P 1 to 4 enter [140] to [143]

For Partition 7 Command O/P 1 to 4 enter [144] to [147]

For Partition 8 Command O/P 1 to 4 enter [148] to [151]

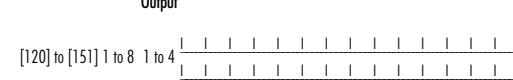

[201]-[264] Door Chime Sound Programming

You can program the keypad to make upto four different door chime sounds for individual zones.

ex. For Zone 1 enter section [201], for Zone 2 enter section [202] etc.

Default	Option	ON	OFF
ON	[] 1	6 Beeps	Disabled
OFF	[] 2	"Bing-Bing" Sound	Disabled
OFF	[] 3	"Ding-Dong" Sound	Disabled
OFF	[] 4	Alarm Tone	Disabled
OFF	[] 5-8	For Future Use	

[995] Reset Keypad Options to Factory Default

[996] Label Default (PK5500/RFK5500 Only)

[997] View Software Version (PK5500/RFK5500 Only)

[998] Initiate Global Label Broadcast (PK5500/RFK5500 Only)

[999] Reset Keypad EEPROM to Factory Defaults

