



## I9000S Handheld Payment Terminal User Guide

## Appearance and Buttons

Front View



Switch on: Hold power button until device switches on.

Switch off: Hold power button keep until the device shows the menu (as shown in figure, select " power off" ).

Switch off Display: Press the power button once or set the auto sleep option at "setting-Display-Sleep".

Sleep: manually by pressing the power button or set up the system after the sleep can trigger sleep mode.

Wake up: When the display is off, press power button once to turn on the display.

Cold-start: press "Fn", then click reset button.

Note: Please turn off the device before storage to prevent the battery to be completely drained during storage.

## Side view



## Back view



# Lithium-ion Battery Instructions And Notes

## Customer Instruction

1. Set up device (including battery) immediately upon receiving device. Do not allow the battery to be completely drained during storage.
2. Do not charge device at extreme temperature (below 5 Celsius and above 45 degree Celsius).
3. The battery should only be used by the power adaptor or cradle provided with the product.
4. To store the device, remove the battery from the device and store separately. Do not store device with battery installed.
5. Charge and discharge battery every 3 months during storage. Optimal battery charge for storage is 60%-70%.
6. Battery should be stored in a cool, dry and well-ventilated environment, Urovo recommends battery storage at 20 °C ~ 40 °C / 65±20%RH environment.

## Transport Precautions

1. Do not transport the battery at ambient temperature higher than 65 °C .
2. Please keep device and battery separately during storage
3. Pack with battery with appropriate packing materials.

## Precautions

1. Do not expose battery into a fire or heat source;
2. Do not short the battery
3. Do not intentionally drop or put battery in violent mechanical motion
4. Do not immerse battery in water or store it in humid environment.
5. Do not tampered with charger or use charger that is suspected to be tampered with
6. If battery appears to be discolored, swollen, unusually hot, remove battery from the device immediately and dispose appropriately.
7. Battery is consumable product. Battery capacity will decrease over time. Replace battery between one or two years.
8. When there is any accident and emergency pertaining battery usage, please contact Urovo on time and provide the relevant information such as photographs and operation environment.

## Disclaimer

UROVO is not responsible for users' personal and property safety under the following circumstances

1. Abusive and inappropriate usage.
2. Using unqualified logistic services to transport the battery.
3. Battery not purchased from official Urovo sales channel.

## Battery Installation

Insert the battery into the battery compartment. Battery should sit tightly in the compartment when correctly installed. Do not use excessive force to insert the battery.



Close the cover and fix the battery cover lock.

## Battery Operation



Charge the battery only with original power adaptor.  
Do not short the battery. Do not store battery in hot, humid, or corrosive environment. Do not subject battery to abusive mechanical impact.

Do not store battery when it is fully charged or completely drained. If device is not used for a long time, remove the battery from the device.

## Battery Charging



USB Data Cable



Power Adaptor

### Charge By USB Data Cable

Connect the device through the USB data cable to connect the power supply equipment such as the PC, the mobile power supply and so on. The state of the indicator lamp is consistent with the adapter charging.

### Charge By DC Power Adaptor

Plug in the power adaptor connector into the DC power port on the terminal device. Red color LED at top left corner indicates at battery is charging. Green LED indicates battery is fully charged.

## Installing the SIM/TF Card



Insert the SIM/TF Card into their corresponding slots in the battery compartment.

Installing TF Card is similar to SIM Card.



#### Note

1. Standard SIM Card is required.
2. You should gently push the SIM/TF card to the correct position without using excessive force.
3. To remove the TF card, press the exposed part of the TF Card inward, and the card will be ejected from the slot. Do not use excessive force.

## Installing Printing Paper

1. Open the paper bin cover and install the paper as below picture showing.
2. Close the paper cover with a click.
3. Tear of the exposed paper quickly to ensure the incision is smooth.



## Magnetic Stripe Card Swipe Operating Instructions

1. Hold on the device and bank card;
2. Swipe the IC card smoothly with the magnetic strip toward inside;





## Contact IC Card Instructions

Insert IC card into the device gently with metal contact upward. Please do not use excessive force so as not to damage the IC card or device.



## Non-contact IC Card Instructions

To read non-contact card, place card near the NFC antenna, as shown below:



## Computer On-line Instructions

When your personal computer installed android system drivers, you can connect device and personal computers through a USB data cable (you can obtain these software from our technical support team).

Once you have installed the required software driver, insert USB cable into the device and the computer's USB port, and you will see the device screen as shown in the figure.



Tap the top of the screen, drag downwards and the USB setting interface will appear.

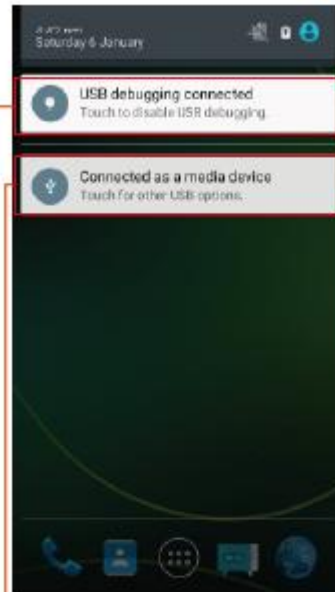

Click on this to go the next left interface

Click on this to go the next left interface

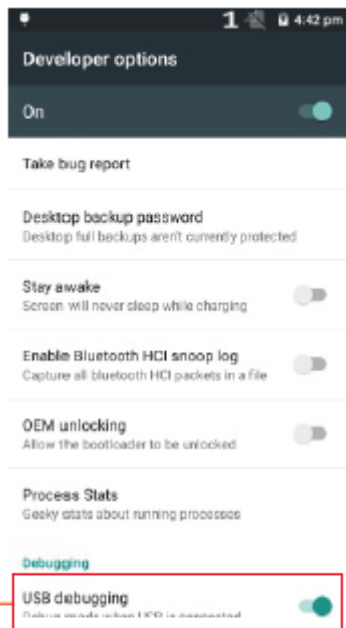

Check the USB debug if you intend to develop software and step through your code with the device.

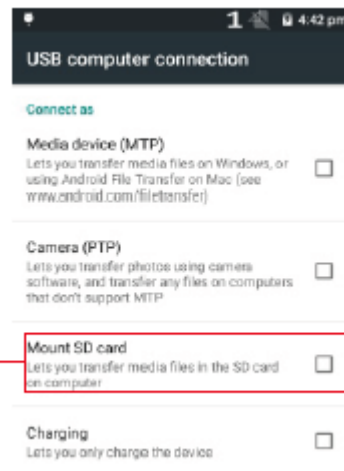

Check the SD Card option if you intend to transfer files between your PC and the device.

**Note: the contents of this manual are subject to change without prior notice.**

## **FCC Warning**

### **§ 15.19 Labeling requirements.**

This device complies with part 15 of the FCC Rules. Operation is subject to the following two conditions: (1) This device may not cause harmful interference, and (2) this device must accept any interference received, including interference that may cause undesired operation.

### **§ 15.105 Information to the user.**

**Note:** This equipment has been tested and found to comply with the limits for a Class B digital device, pursuant to part 15 of the FCC Rules. These limits are designed to provide reasonable protection against harmful interference in a residential installation. This equipment generates uses and can radiate radio frequency energy and, if not installed and used in accordance with the instructions, may cause harmful interference to radio communications. However, there is no guarantee that interference will not occur in a particular installation. If this equipment does cause harmful interference to radio or television reception, which can be determined by turning the equipment off and on, the user is encouraged to try to correct the interference by one or more of the following measures:

- Reorient or relocate the receiving antenna.
- Increase the separation between the equipment and receiver.
- Connect the equipment into an outlet on a circuit different from that to which the receiver is connected.
- Consult the dealer or an experienced radio/TV technician for help.

### **§ 15.21 Information to user.**

Any Changes or modifications not expressly approved by the party responsible for compliance could void the user's authority to operate the equipment.

### **Specific Absorption Rate (SAR) information:**

This wireless phone meets the government's requirements for exposure to radio waves. The guidelines are based on standards that were developed by independent scientific organizations through periodic and thorough evaluation of scientific studies. The standards include a substantial safety margin designed to assure the safety of all persons regardless of age or health

#### **Body-Support Operation**

This device was tested for typical body-worn operations. To comply with RF exposure requirements, a minimum separation distance of 0.5cm must be maintained between the user's body and the handset, including the antenna. Third-party belt-clips, holsters, and similar accessories used by this device should not contain any metallic components. Body-worn accessories that do not meet these requirements may not comply with RF exposure requirements and should be avoided. Use only the supplied or an approved antenna.