

DH1000
2.4GHz Digital Headphone



User Manual
Please read before using this headphone.

INTRODUCTION

This 2.4GHz Digital Wireless Headphone uses latest digital wireless technology that enables you to enjoy crystal sound stereo music and TV sound anywhere inside your home. Simply connect the transmitter to a desired audio source: DVD player, TV set, Hi-Fi system, MP3, iPod, or Smartphone. Without complicated wiring and installation, the system enables you to enjoy thrilling, lifelike sound in minutes.

FEATURES

1. 2.4GHz Digital UHF Technology
2. 31-Channel Frequency Hopping System
3. Smart Volume Memory preset
4. Electronic Volume Control
5. Low Power Indicator Alert
6. Top Charge Mechanism
7. Auto On/Off (when without signal)
8. Muting
9. Speed charging mechanism
10. Direct Audio Line-In

COMPONENT PART LIST

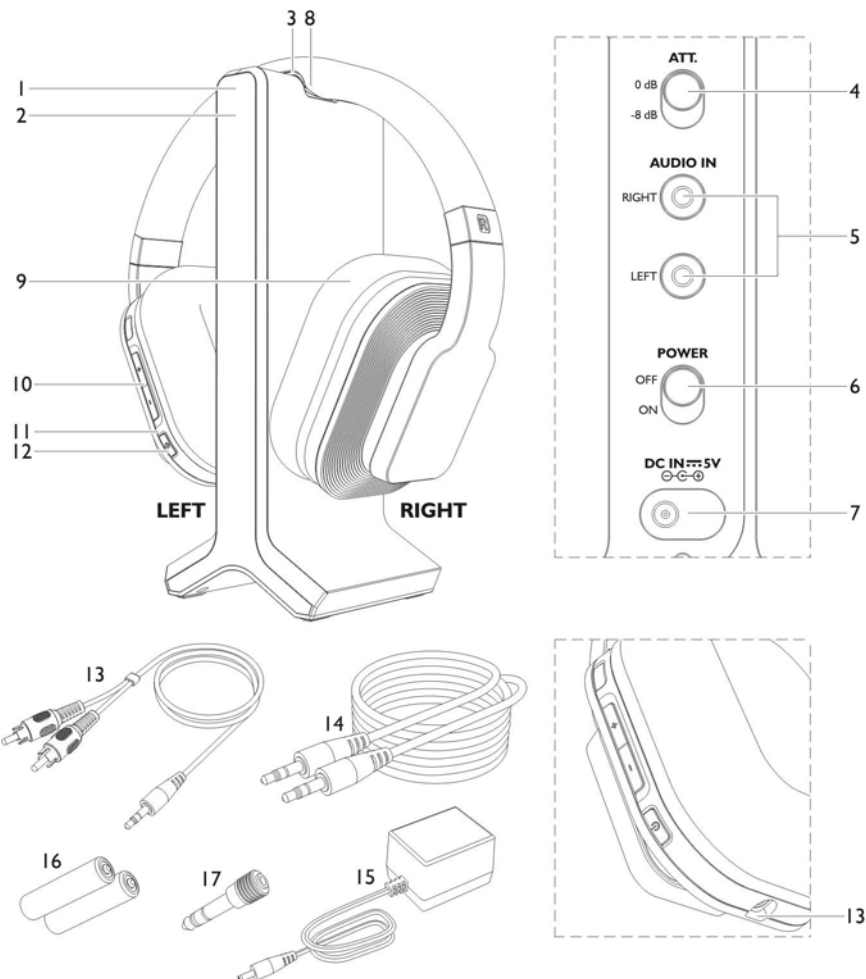

Transmitter

1. Charge LED Indicator
2. Power LED Indicator
3. Charging pins
4. Attenuation select switch
5. RCA Audio In socket
6. Power on/off switch
7. DC IN socket

Headphone Receiver

8. Charging contacts
9. Battery Compartment (inside Right Hand Side of the Ear Pad)

10. Volume Control
11. Power/Signal LED Indicator
12. Power ON/OFF
13. Direct Line-In Jack

Accessories

13. RCA cable
14. 3.5mm ~ 3.5mm Direct Line-In Cable
15. AC/DC adaptor
16. NiMH AAA size batteries for Headphone (2 pieces)
17. 3.5mm ~ 6.3mm stereo plug

INSTALLATION

TRANSMITTER

1. Plug the AC/DC power adaptor in the DC jack at the rear of the transmitter. Connect the supplied AC/DC power adaptor to an electrical wall outlet.
2. The rear of the transmitter has audio sockets with Left and Right for connecting the Audio Cable to the audio output jack of TV, DVD, iPod, MP3, or Smartphone.
- 3 For TV/DVD/Hi-Fi, switch to “-8dB”. For portable devices, like CD/MP3, and iPod, switch to “0dB”.

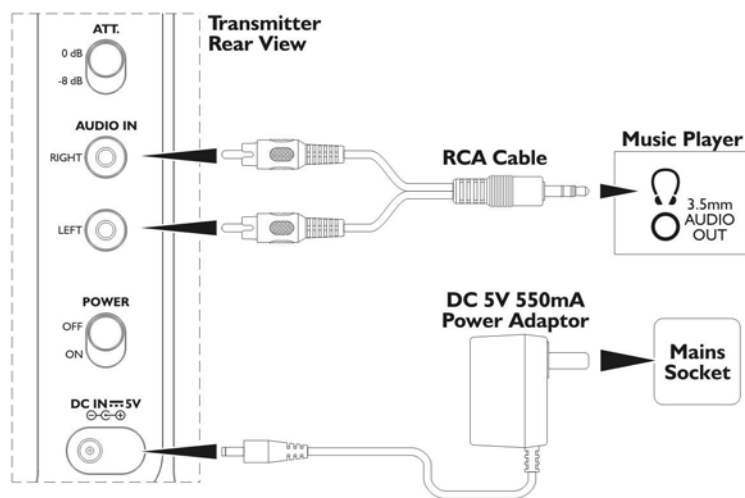

HEADPHONE RECEIVER

1. To install AAA Rechargeable Batteries or replace Ear Pad, carefully rotate the Ear Pad Holder and take it away from the Headphone Cabinet.

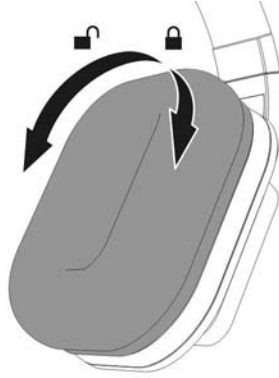

2. Insert 2 pieces of AAA size rechargeable batteries (supplied in the package) into the Battery Compartment of Headphone Cabinet (Right Hand Side **ONLY**). Make sure the batteries are placed with the right polarity.
3. Restore Ear Pad to the Headphone Cabinet after the batteries are inserted.

OPERATION

TRANSMITTER

1. Turn on the audio source (TV or audio component) to which the transmitter is connected.
2. Slide the power switch located on the rear of the Transmitter to "ON". The Power LED starts to flash in BLUE for around 8 to 9 seconds and then remains to glow steadily.

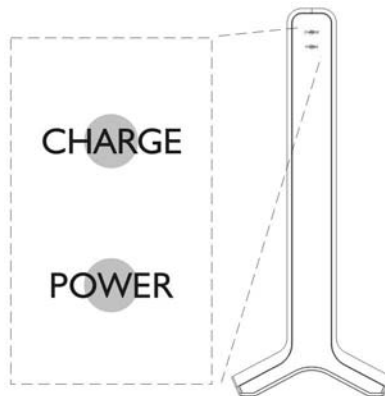

HEADPHONE RECEIVER

1. Turn on the headphone by pressing the Power button for about 2 seconds. The LED will light up in RED, and then change to GREEN when Audio Signal link between Transmitter and Headphone Receiver is established. If no Audio Signal is detected, this LED will glow in RED constantly.

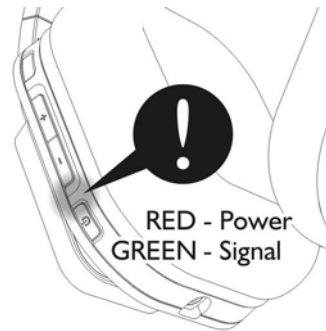

2. Adjust the size of the Headband, place the Headphone on your head. To obtain the desired sound level, adjust the Volume Control on the Headphone.
3. If interference or poor signal reception occurs, the headphone will be muted and the LED will change to RED, searching for another channel will be run automatically.
4. When the batteries of Headphone are at low level, the LED will blink in RED. There will be beeping sound from the headphone in every minute to indicate the last 5 minutes of working. A beep sound in each of the first 4 minutes, and 2 beep sound in the last minutes and then it will automatically switch off.
5. To charge the Batteries in the Headphone, turn OFF the Headphone by pressing the Power button for about 2 seconds. Place the Headphone on the Transmitter. The charging process begins automatically, and the CHARGE LED on the transmitter will light in GREEN when the charging contacts of transmitter and headphone are matched successfully. When the charging process is completed, the GREEN LED will be OFF.

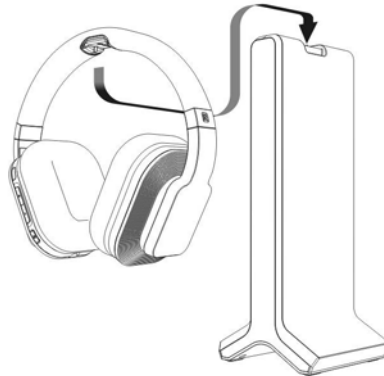

Note : For the initial use, please charge the batteries for 7 hours. If the headphone is not in use, please place it back on the transmitter.

6. This Headphone can be used as a regular Wired Headphone by connecting your Audio Source with the Line-In Cable to the Headphone Jack shown below.

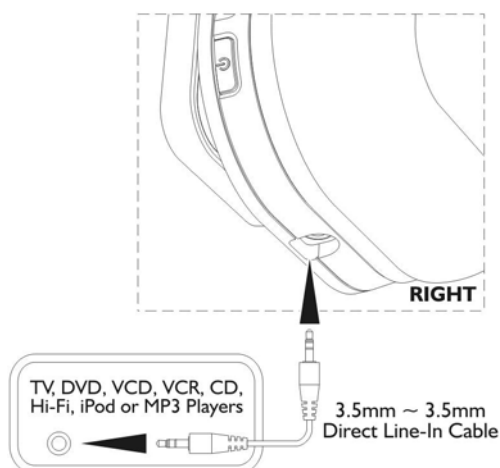

IMPORTANT

1. Switching Off
 - a) For protection of the Transmitter and power saving, the Transmitter will be switched to Stand-by Mode automatically if there is no Audio Signal for approximately 5 minutes, LED will be OFF. If the Audio Signal returns, the Transmitter will be automatically switched On with LED glows in BLUE. Switch on the Headphone again to listen the music.
 - b) The Headphone will be switched Off automatically if there is no signal from the Transmitter for about 5 minutes.
2. Make sure the Headphone is turned **OFF** when charging is in process.
3. Use only the included Rechargeable AAA Batteries. When the Headphone is not in use, turn the Headphone **OFF**.
4. To ensure a long service life, fully charge the Batteries before using the Headphone for the first time. According to the Capacity of the Rechargeable Battery included, the Battery charging process will take approximately 5 hours.

This device must be used with the AC/DC adaptor supplied in the package.

WARNING

- Never attempt to recharge conventional dry cells.
- Batteries (battery pack or batteries installed) shall not be exposed to excessive heat such as sunshine, fire or the like.
- Never use another type of battery or non-rechargeable batteries to replace the rechargeable (LR03/AAA) batteries supplied. When the headphones are not in use, switch it OFF to avoid damaging the batteries.
- Prolonged exposure to Excessive sound pressure from earphones and headphones may cause hearing loss.

TROUBLE SHOOTING

No Sound

- Ensure the AC/DC adaptor is fully inserted into the AC outlet and the power connection input on the Transmitter.
- Ensure the the Power Button at the back of Transmitter is switched to ON.
- Ensure the headphone is switched ON.
- Headphone battery charge level may be too low, recharge the batteries fully.
- Ensure the TV or the connected audio device is switched ON.
- The volume of headphone may be too low, adjust the volume to a moderate level.
- The audio signal input level is too low. Increase the volume of the audio source.

Distortion

- Ensure the volume level of headphone is set to an approximate level.
- The headphone is too far from the transmitter, move it closer.
- The audio signal input level is too low. Increase the volume of the audio source.

TECHNICAL SPECIFICATIONS

Transmission Mode	:	UHF Stereo
Carrier Frequency	:	2.4GHz Digital
Operation Voltage	:	Transmitter, DC 5V 550mA Headphone, 2 x AAA size Rechargeable NiMH batteries (included)
Frequency Response	:	30Hz~ 20KHz
Distortion	:	0.5%
S/N Ratio	:	70 dB
Operation Distance	:	Up to 30 meters

FCC INFORMATION

This device complies with Part 15 of the FCC Rules. Operation is subject to the following two conditions:

1. This device may not cause harmful interference, and 2. This device must accept any interference received, including interference that may cause undesired operation.

Note: This equipment has been tested and found to comply with the limits for a Class B digital device, pursuant to part 15 of the FCC Rules. These limits are designed to provide reasonable protection against harmful interference in a residential installation. This equipment generates, uses and can radiate radio frequency energy and, if not installed and used in accordance with the instructions, may cause harmful interference to radio communications. However, there is no guarantee that interference will not occur in a particular installation. If this equipment does cause harmful interference to radio or television reception, which can be determined by turning the equipment off and on, the user is encouraged to try to correct the interference by one or more of the following measures:

- Reorient or relocate the receiving antenna.
- Increase the separation between the equipment and receiver.
- Connect the equipment into an outlet on a circuit different from that to which the receiver is connected.
- Consult the dealer or an experienced radio/TV technician for help.

Caution: Any changes or modifications not expressly approved by the party responsible for compliance could void the user's authority to operate this equipment.

FCC Radiation Exposure Statement

This equipment complies with FCC RF radiation exposure limits set forth for an uncontrolled environment. This equipment should be installed and operated with a minimum distance of 20 centimeters between the radiator and your body.