

HP5090A

**900MHz
WIRELESS HEADPHONE SYSTEM**



User Manual

INTRODUCTION

This 900MHz compact stereo headphones takes advantage of the very latest advances in wireless transmission technology so that you can listen to music or the sound freely around your house. All you have to do is connect the transmitter to any audio source: DVD player : CD player, MP3 player, iPod, TV set, Hi-Fi system or Radio.

FEATURES

1. Auto Tuning system on Headphones Receiver
2. Phase Lock Loop (PLL) Transmission system
3. Automatic Battery Recharging
4. 900 MHz RF Technology
5. RF technology leaves you completely free to move around
6. Transmission is not restricted solely to line of sight
7. Rechargeable Headphones Receiver
8. Charger built into the Transmitter
9. High quality stereo sound that is virtually interference-free
10. Automatic Level Control (ALC) and RF Auto On/Off function

COMPONENT IDENTIFICATION

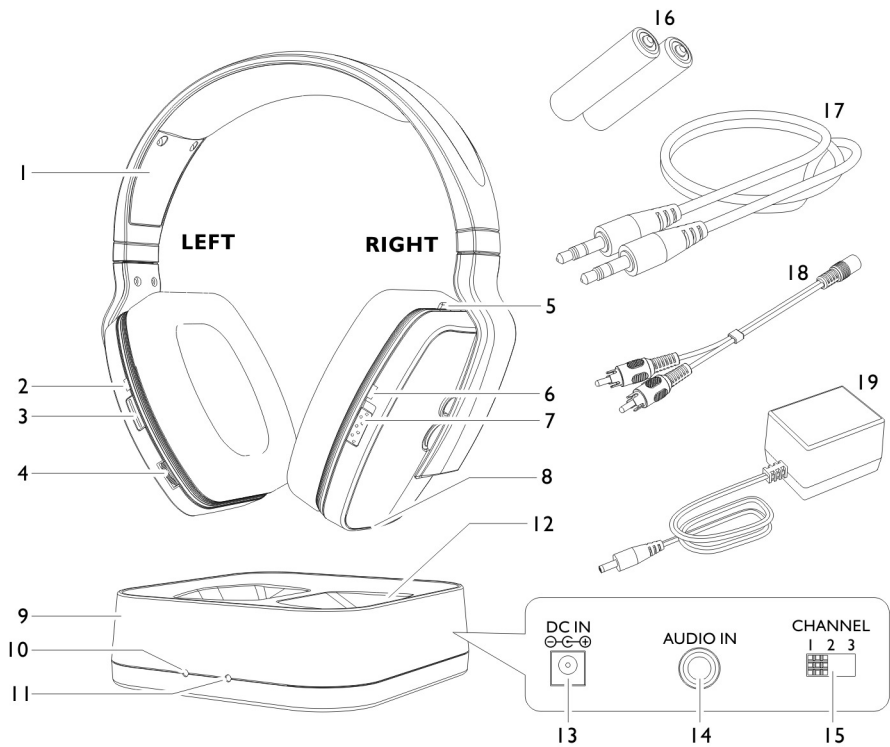

COMPONENT IDENTIFICATION

1. Wireless Headphone Receiver
2. Signal Indicator LED (Green)
3. Auto Tune Button
4. Volume Control
5. Ear Cushion Holder
6. Power Indicator LED (Red)
7. Power On/Off Switch
8. Charge Contact
9. Wireless Transmitter
10. Charge/Transmit Indicator LED (Green)
11. Power Indicator LED (Red)
12. Charge Pins
13. DC In Socket
14. 3.5mm Audio In Socket
15. Channel Switch (1/2/3)
16. Two Rechargeable AAA Size, 1.2V Batteries (550 mA)
17. Audio Connection Cable with 3.5 mm Jack Plug
18. RCA Socket Audio Adapter
19. Power Adapter

INSTALLATION

TRANSMITTER

1. Connect the Power Adapter to the DC IN input Socket located on the transmitter rear panel.
2. Connect the Power Adapter provided to an Electrical Outlet.
3. An Audio Connection Cable with 3.5 mm Jack Plug is provided, to connect the Transmitter to the Audio Devices (e.g. TV set, Hi-Fi system, DVD, MP3 or iPod).
4. When necessary, use the RCA Adapter Cable for connection to the Audio Output Right (R) and Left (L) of the Hi-Fi or TV Set.

The Red Power Indicator LED in Transmitter will light up when the Power Adapter is connected to the Electrical Outlet. Then connect Audio Device with Audio Cable to Transmitter and make sure the Audio Device is switched ON, the Green Charge/Transmit Indicator LED will turn on.

RF Transmission will automatically switch OFF in about 4 minutes if no Audio Signal is detected. However, Transmitter will be automatically switched ON once audio signal is detected.

RECEIVER HEADPHONES

1. Remove the Ear Cushion Holder on Right Hand Side (R) of Headphone Receiver. 2 Battery Compartments can be found.

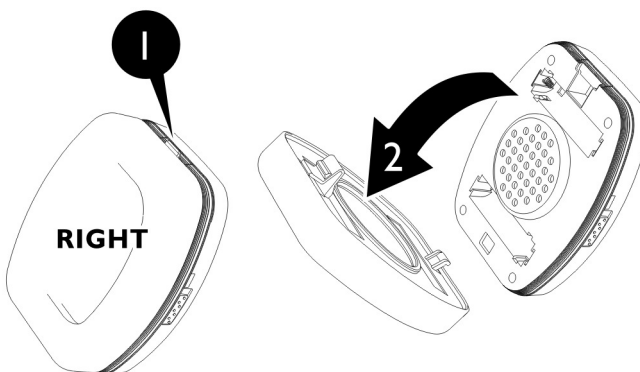

2. Insert the provided 2 pieces of Rechargeable AAA Size Batteries (provided in the packaging of the product) into the Battery Compartments with correct polarity.
3. Close the Battery Compartments by restoring the Ear Cushion Holder.

OPERATION

1. Switch on the Audio Source (TV set or audio component) that the Transmitter is connected to.
2. Select the On/Off Switch in the Headphone Receiver to ON position.
3. Adjust the Volume for desired sound level.
4. If a good reception is not obtained, press the "Auto Tune" button on the Headphone Receiver. The Signal Indicator LED will glow.

NOTE:

Make sure the batteries provided in the packing, is fully charged before first use. User should then be able to move around freely from one room to another without any interference. If interference does occur (interruptions in the signal), press the "Auto Tune" button once to obtain a better reception channel.

- A For better Stereo Reception, stay approximately seven meters away from the Transmitter when you press the "Auto Tune" button.
- B In case of difficulty in obtaining a satisfied Reception Frequency, change the Channel setting (1, 2, or 3) at the back of the Transmitter, then press the "Auto Tune" button on the Headphone Receiver to find the corresponding channel.

To protect the Transmitter and save Power, the Transmitter will automatically switch OFF in approximately 4 minutes if there is no Audio Signal, or the Signal that it receives from the Audio Source is too weak for proper reception. However, if the Signal returns to an acceptable level, the Transmitter will automatically switch ON again.

CHARGING THE BATTERIES

1. Select the On/Off Switch in the Headphone Receiver to OFF position.
2. Place the Headphone Receiver on the Transmitter, make sure the Charge Contact touches the Charge Pins on the Transmitter.
3. The Charging process starts automatically with the Charge/Transmit Indicator LED glows in Green constantly; the Transmitter will not over-charge the batteries. The Green LED will turn OFF in about 14 hours. Make sure to charge new batteries for 24 hours before using them for the first time in the Headphone Receiver.

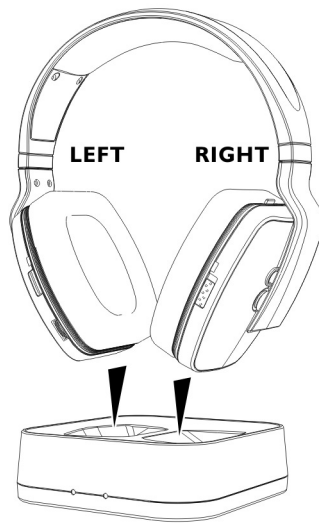

WARNING:

Never attempt to recharge conventional dry cells.

Batteries (battery pack or batteries installed) shall not be exposed to excessive heat such as sunshine, fire or the like

Never use another type of battery or non-rechargeable batteries to replace the rechargeable (LR03/AAA) batteries supplied. When the headphones are not in use, move the switch to the OFF position to avoid damaging the batteries.

The batteries must always be fully charged before first use. An initial 24 hours charge is required to guarantee an acceptable service life for the rechargeable batteries. Always ensure that the Headphone Receiver is switched to the Off position while the batteries are charging.

Excessive sound pressure from earphones and headphones can cause hearing loss.

IMPORTANT:

This unit should be operated with rechargeable batteries only. When replacing the batteries or when disposing of the unit, always comply with applicable laws relating to the disposal of batteries. Please place them in a proper disposal container to ensure that they are eliminated safely and in an environmentally friendly way.

TECHNICAL SPECIFICATIONS

Transmission mode	: UHF stereo
Carrier frequency	: Ch 1 : 912.98 – 912.02 MHz Ch 2 : 912.48 – 912.52 MHz Ch 3 : 912.98 – 913.02 MHz
Operating voltage	: Transmitter – 8V 200mA Receiver – 2.4V (two rechargeable batteries, LR03/AAA size)
Frequency response	: 40 Hz – 11 KHz
Distortion	: <2%
Signal-to-noise ratio	: >65 dB
Channel separation	: 30 dB
Range	: 150 feet (open area)

TROUBLESHOOTING

NO SOUND

- Ensure that the mains adapter is pushed fully into the power outlet and that its cable is properly connected to the DC IN connector on the transmitter.
- Ensure that the receiver headphones On/Off switch is switched to the On.
- The headphones battery charge level may be too low. Recharge the batteries or replace them with fully charged batteries.
- Ensure that your TV set, Hi-Fi system or audio component is switched ON and set to a channel that broadcasts an audio signal.
- Use the headphones volume control to increase the sound level.
- The connected audio/video equipment may not be in playback mode. Start playback on by the equipment.
- The headphones output level is set too low. Adjust the volume to a suitable level.

DISTORTION

- Ensure that the signal indicator is lit. If not, press the Auto Tune Button on the headphone receiver until it glows.
- Use the channel selector to change the transmitter's transmission frequency. Then you will need to adjust the tuning control on the headphone receiver until the indicator comes on.
- The headphones battery charge level may be too low. Recharge the batteries or replace them with fully charged batteries.
- Ensure that the volume knob setting is correct.
- The headphones may be too far away from the transmitter. Move closer to it.
- The audio signal input level is too low. Increase the volume from the audio source.