

**ATTENTION:**

The transmitter for this speaker set is designed to work with a wide variety of devices. Our tests show the default volume levels of iPods, MP3 players and other devices connected to the transmitter through the headphone jack does not have the signal strength required by the transmitter. Raising the volume of your device will increase the signal strength to the transmitter. The blue signal LED will switch from flashing to steady when the required signal strength from your device is reached. We recommend that you keep the volume set on your iPod or MP3 player at a minimum of  $\frac{3}{4}$  of full volume.

**WARNING:**

When powering by AC household current, these devices must be used with the AC/DC adapters supplied within the package. Do not attempt to power utilizing other AC or DC adapters. Power adapters are for indoor use only – do not use in wet areas or weather.

## **TECHNICAL SPECIFICATIONS**

Transmission Mode	: UHF
Carrier Frequency	: 900 MHz Digital Hybrid
Operation Voltage	: Transmitter, DC 12V 200mA Speakers, 6 X 'C' size Alkaline batteries or DC 9V 1A adaptor Remote Control Unit, 2 X 'AAA' size batteries
Frequency Response	: 40Hz – 12KHz
Distortion	: 1%
S/N Ratio	: 65dB (typical)
Operation Distance	: Up to 150 feet
Speakers	: 2-way
Output Power	: 2 x 5Watts

### **FCC STATEMENT:**

FCC Caution: Any changes or modifications not expressly approved by the party responsible for compliance could void the user's authority to operate this equipment.

This device complies with Part 15 of the FCC Rules. Operation is subject to the following two conditions: (1) This device may not cause harmful interference, and (2) this device must accept any interference received, including interference that may cause undesired operation.

Note: This equipment has been tested and found to comply with the limits for a Class B digital device, pursuant to part 15 of the FCC Rules. These limits are designed to provide reasonable protection against harmful interference in a residential installation. This equipment generates, uses and can radiate radio frequency energy and, if not installed and used in accordance with the instructions, may cause harmful interference to radio communications. However, there is no guarantee that interference will not occur in a particular installation. If this equipment does cause harmful interference to radio or television reception, which can be determined by turning the equipment off and on, the user is encouraged to try to correct interference by one or more of the following measures:

- Reorient or relocate the receiving antenna.
- Increase the separation between the equipment and receiver.
- Connect the equipment into an outlet on a circuit different from that to which the receiver is connected.
- Consult the dealer or an experienced radio/TV technician for help.

### **IC STATEMENT:**

Any changes or modifications not expressly approved by the party responsible for compliance could void the user's authority to operate this equipment.

This device complies with RSS 210 of Industry Canada.

"Operation is subject to the following two conditions: (1) this device may not cause interference, and (2) this device must accept any interference, including interference that may cause undesired operation of the device."

Le présent appareil est conforme aux CNR d'Industrie Canada applicables aux appareils radio exempts de licence. L'exploitation est autorisée aux deux conditions suivantes : (1) l'appareil ne doit pas produire de brouillage, et (2) l'utilisateur de l'appareil doit accepter tout brouillage radioélectrique subi, même si le brouillage est susceptible d'en compromettre le fonctionnement.

"This Class B digital apparatus complies with Canadian ICES-003." Cet appareil numérique de la classe B est conforme à la norme NMB-003 du Canada.

This device and its antenna(s) must not be co-located or operating in conjunction with any other antenna or transmitter.

Cet appareil et son antenne (s) ne doit pas être co-localisés ou fonctionnant en conjonction avec une autre antenne ou transmetteur.

- If unit will not be used for a long period of time, remove batteries to prevent damage or injury due to possible battery leakage.
  - Keep all batteries away from children.
7. You should now be able to place the speakers freely from room to room without disruption. Should there be any disruption (signal cuts off or carries distortion), press the speaker's "AUTO TUNE" button to maximize the best reception.

If you hear interference from other components, move the speakers to another free location, then re-adjust the tuning control by selecting different Channels of the transmitter, then press the "AUTO TUNE" button on Speakers for best reception. When transmitting / receiving over long distances, the signal from the system will become weaker.

#### 8. Switching Off

- a.) For protection of the transmitter and power saving, the transmitter will cut off automatically if there is no/weak operation input signal from the audio source for 4 minutes.

In other words, if the signal comes back, the transmitter will work again automatically.

- b.) When the speaker is turned off by pressing the Power button on the speaker all power to the speaker and remote control sensor will turn off. The speaker will not respond to any commands from the remote control. If the remote control Power button is used while the speakers are powered on they will be put into at stand-by mode for 5 minutes, the speaker power LED will change from blue to yellow. Pressing the remote control Power button during the stand-by time will restore full power to the speakers, the speaker power LED will switch from yellow to blue. If there is no signal from the remote control unit in 5 minutes, the speakers will automatically power off, the power LED will not be lit. The remote will not power up the speakers from the powered off state.

## **TROUBLE SHOOTING**

### **NO SOUND**

- Ensure the AC/DC adapter is fully inserted into the AC outlet and the power connection input on the transmitter.
- Ensure the speakers are switched ON.
- Speaker's batteries are drained or capacity is too low. Replace with new batteries or connect the AC/DC adapters to the speakers.
- Transmitter's batteries are drained or capacity is too low. Replace with new batteries or connect the AC power adapter to the transmitter.
- Ensure the TV or audio component is ON.
- The connected audio / video equipment is not playing. Start playing the equipment.
- The volume of speakers is too low. Adjust the volume to an appropriate level.
- The volume of the audio source is too low. Turn up the volume of the source equipment (iPod, radio, etc.).

### **DISTORTED**

- Press the "AUTO-TUNE" button on the speakers until you have matched the frequency of the transmitter.
- Change the position of the channel selector on the transmitter. You must then press the "AUTO TUNE" button on the speakers.
- Speaker's battery capacity is too low. Replace with new batteries or connect AC power adapter.
- Transmitter's battery capacity is too low. Replace with new batteries or connect AC power adapter.
- Ensure the volume level of speakers is adjusted properly.
- The speakers are too far away from the transmitter, move it closer.
- The input level of the audio signal is too low. Turn up the volume of the audio source equipment..
- The audio input level of the transmitter is too high, lower the volume of the audio source equipment.

## **OPERATION**

1. Turn on the audio source to which the transmitter is connected.
2. Set volume of audio source to 75% to send a strong consistent signal to the transmitter.
3. Set the POWER switch on the back of the transmitter to the ON position. The LED on the transmitter will show a steady BLUE light if the source signal is strong enough or flash if the transmitter requires a higher source device volume level.
4. Select the channel 1 or 2 of the transmitter for best performance in your location.
5. Turn on the speaker and adjust the volume to the desired listening level. Volume can be adjusted up by pressing “+” button or down by pressing the “-” button to the desired listening level, or you can press the “+” button or “-” button” on the remote control unit to adjust the volume level.
6. Press the “AUTO TUNE” button to get the best tuning reception from your speakers. When the button is pressed, frequency tuning starts automatically and it stops when a signal is detected. Tuning process can also be activated by pressing the “AUTO TUNE” button on the remote control unit.

### **NOTE :**

- a.) During initial setup keep the Speakers 21 feet (or less) away from the transmitter, and press “AUTO TUNE” button for the best reception.

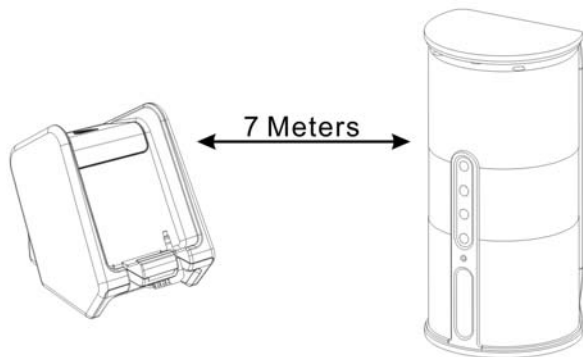

- b.) Whenever you find frequency jam, select other Channels on the transmitter, and then press the “AUTO-TUNE” button again.

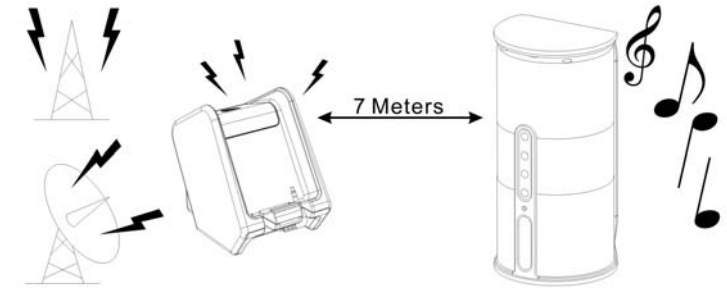

- c.) Low or distorted sound on speakers or with a transmitter powered by batteries can be caused by batteries that are discharged or have low capacity. Test by removing batteries and connecting the AC power adapter or using a fresh set of batteries.

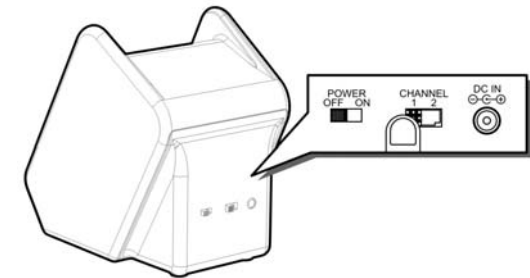

### **Battery Precautions**

If using batteries in the transmitter or speakers

- Only use AA batteries in the transmitter, C cell batteries in the speaker, and AAA batteries in the remote control.
- Batteries may leak or explode if inserted improperly, disposed of in fire, or mixed with different types.
- Alkaline batteries may leak or explode if placed in a battery charger.
- When installing batteries, observe proper +/- polarities. Batteries positioned incorrectly may leak and cause damage to the unit.
- Never attempt to recharge conventional dry cell batteries.
- Replace only with fresh, new batteries.

## INSTALLATION

### TRANSMITTER

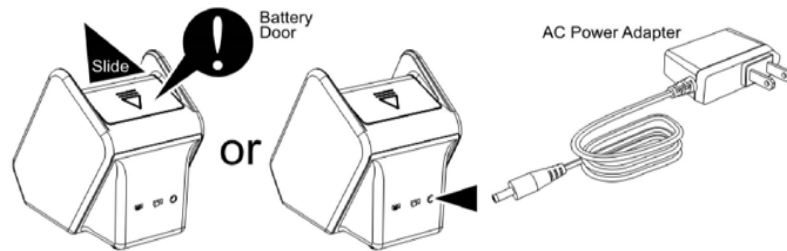

1. Connect the supplied AC power adapter to an electrical wall outlet.
2. Plug the AC power adapter (12V/200mA) in the DC jack located on the rear of the transmitter, or insert 4 fresh "AA" size ALKALINE batteries into the battery compartment of the transmitter with correct polarity. Note: **Discharged or low batteries will result in no signal to the speakers or distorted sound.**
3. Turn on the transmitter by set the POWER switch to ON position, the POWER LED (blue) on transmitter will start flashing.
4. The retractable audio cord that is located at the front of transmitter can be connected to audio output jack of any audio source such as iPod, iPhone, MP3/CD/VCD/DVD player, smart phone, computer, TV or home theater system. Home theater systems and other devices with red and white RCA audio out connections require a 3.5mm female to dual RCA male adapter cable to connect to the 3.5mm transmitter cable.

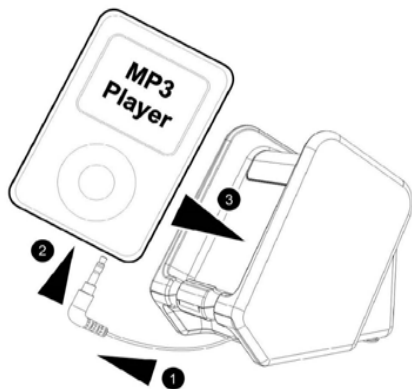

5. The transmitter for this speaker set is designed to work with a wide variety of devices. Our tests have shown the default volume levels of iPods, MP3 players and other devices connected to the transmitter through the headphone jack does not have the signal strength required by the transmitter. Raising the volume of your device increases the signal strength to the transmitter. The BLUE LED switches from flashing to steady when the required signal strength from your device is reached. We recommend that you keep the volume set on your iPod or MP3 player at a minimum of 75% of full volume.

## **PACKAGE INCLUDES**

1. Dual Power Wireless Transmitter base X 1
2. Wireless Speakers X 2 (Batteries not included)
3. Remote Control X 1 (Batteries not included)
4. 3.5MM to 1/4 Inch Adapter X 1
5. AC-DC Power Adapter X 3 (1 for transmitter; 2 for speakers)
6. 6' 3.5mm M-F cable X 1
7. 6' 3.5mm Female to RCA cable X 1

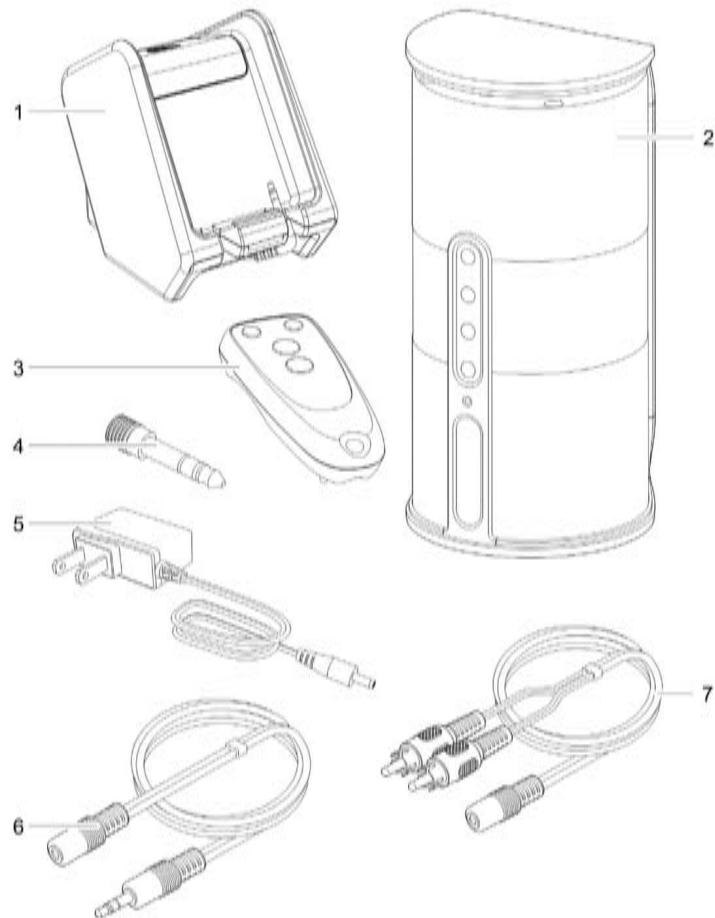

## **COMPONENT IDENTIFICATION**

### **TRANSMITTER**

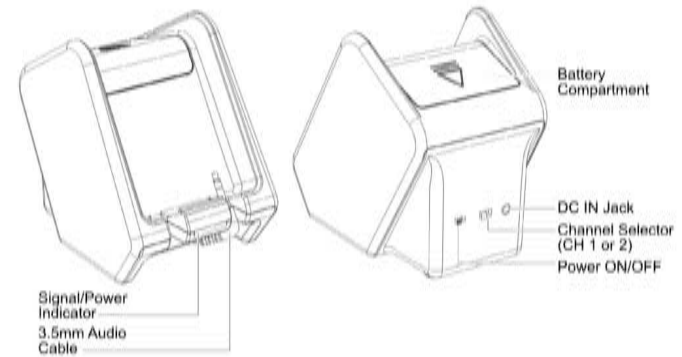

### **SPEAKER RECEIVER**

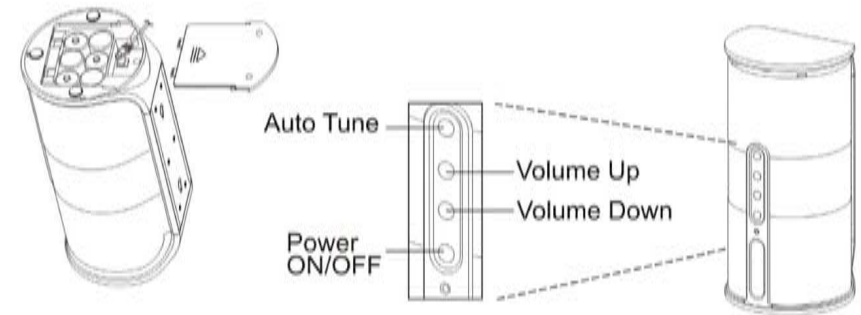

### **REMOTE CONTROL**

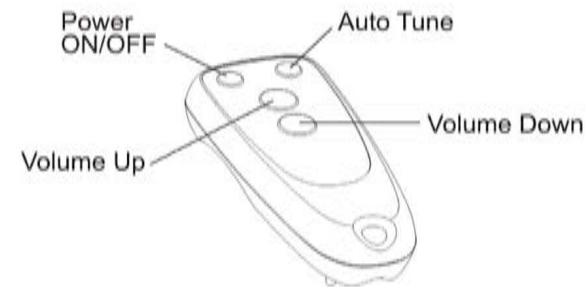



## SP1790A

**Premium 900MHz Wireless Indoor/Outdoor Speakers**

**w/Remote Control & Dual Power Transmitter, Black**

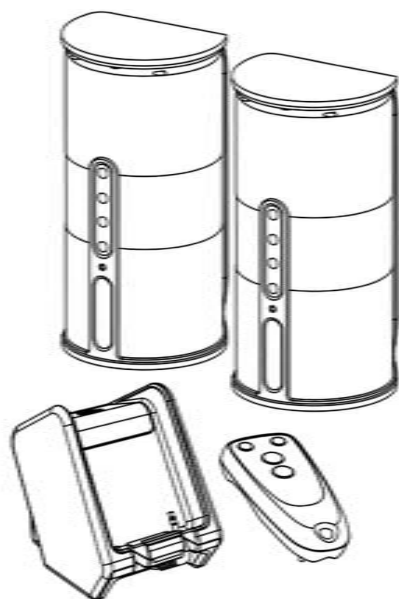

### **Owner's Manual**

(Read Instructions Carefully Before Using This System)

#### **INTRODUCTION**

This 900 MHz digital hybrid wireless speaker system uses latest wireless technology that enables you to enjoy music and TV sound anywhere inside or outside your home. You can simply connect the system to any audio source such as iPod, iPhone, MP3/CD/VCD/DVD players, smart phone, computer, TV or home theater system. Without complicated wiring and installation with your Audio/Video equipments and rear channel amplifier, the system enables you to enjoy thrilling, lifelike sound in minutes.

#### **FEATURES**

1. Weatherproof indoor and outdoor speakers.
2. Automatic Phases Lock Loop (PLL) scanning system on speaker receivers
3. Phase Lock Loop (PLL) transmission system on transmitter
4. 900 MHz Digital Hybrid RF technology speakers system
5. RF technology lets you roam freely throughout your house, garden
6. Operating distance up to 150 feet
7. No line of sight limitation
8. Virtually interference free audio quality
9. Auto ON/OFF control
10. Auto tuning function
11. Remote control unit
12. Wall-mountable
13. 2-way speakers