

JOYPAD CONTROLLER

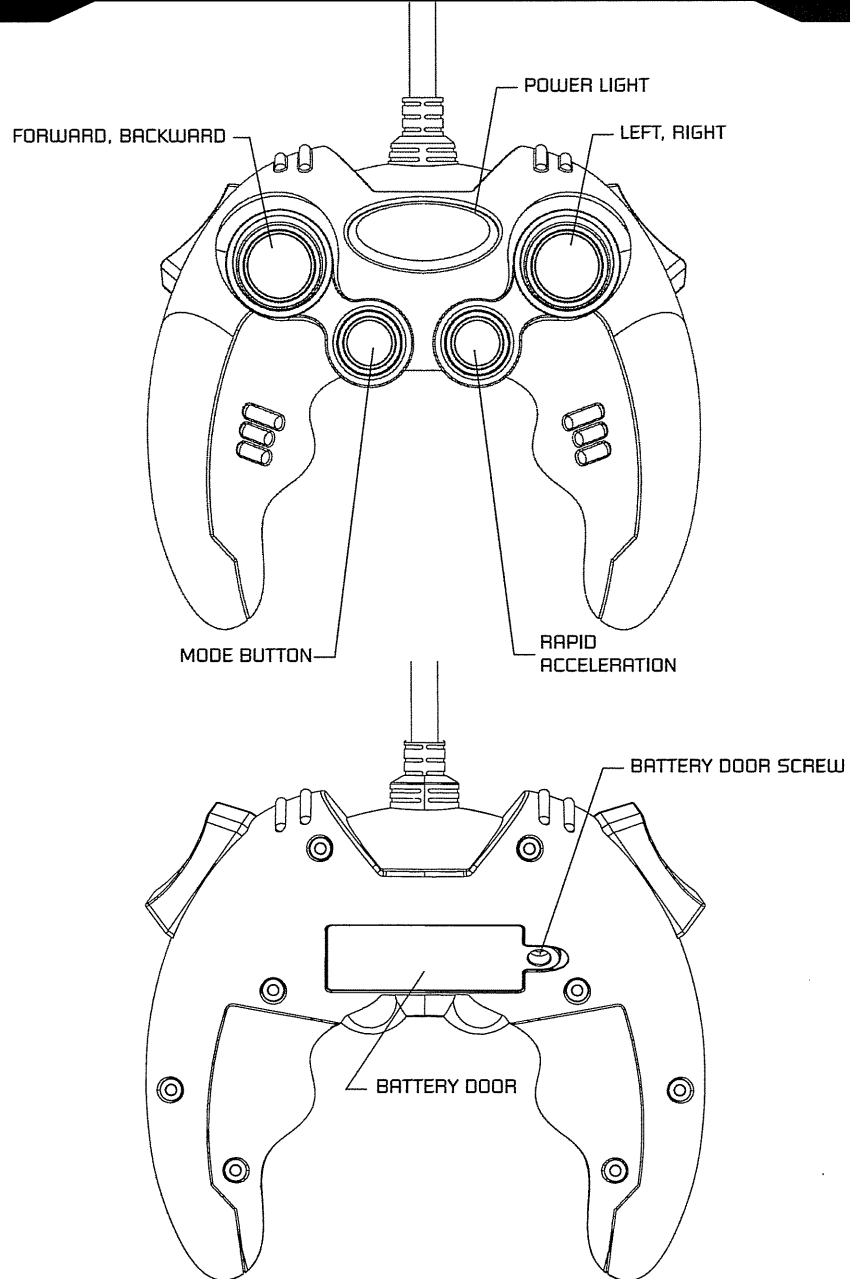

Before beginning startup, please read these instructions thoroughly.



CE 0979 ⓘ

WARNING: Always turn the transmitter on before the toy. Always turn the toy off before the transmitter. If you turn the transmitter off prior to turning off the toy (or turn the model on before the transmitter), the toy has no signal and can allow the toy to move away uncontrollably. This condition can also damage the servo output gear train because of "jitter" or excessive servo travel beyond normal limits.

■ Hereby, UNIMAX TOYS LTD, declares that this Radline RC Toy is in compliance with the essential requirements and relevant provisions of Directive 1999/5/EC. The declaration of conformity may be consulted at www.radline.com

UNIMAX®

UNIMAX TOYS LTD., 17-19 CANTON ROAD, KOWLOON, HONG KONG.

© 2007 UNIMAX TOYS LIMITED. ALL RIGHTS RESERVED.

www.unimax.com.hk www.radline.com

MADE IN CHINA

PLEASE KEEP DETAILS FOR FUTURE REFERENCE

TREK TILE™

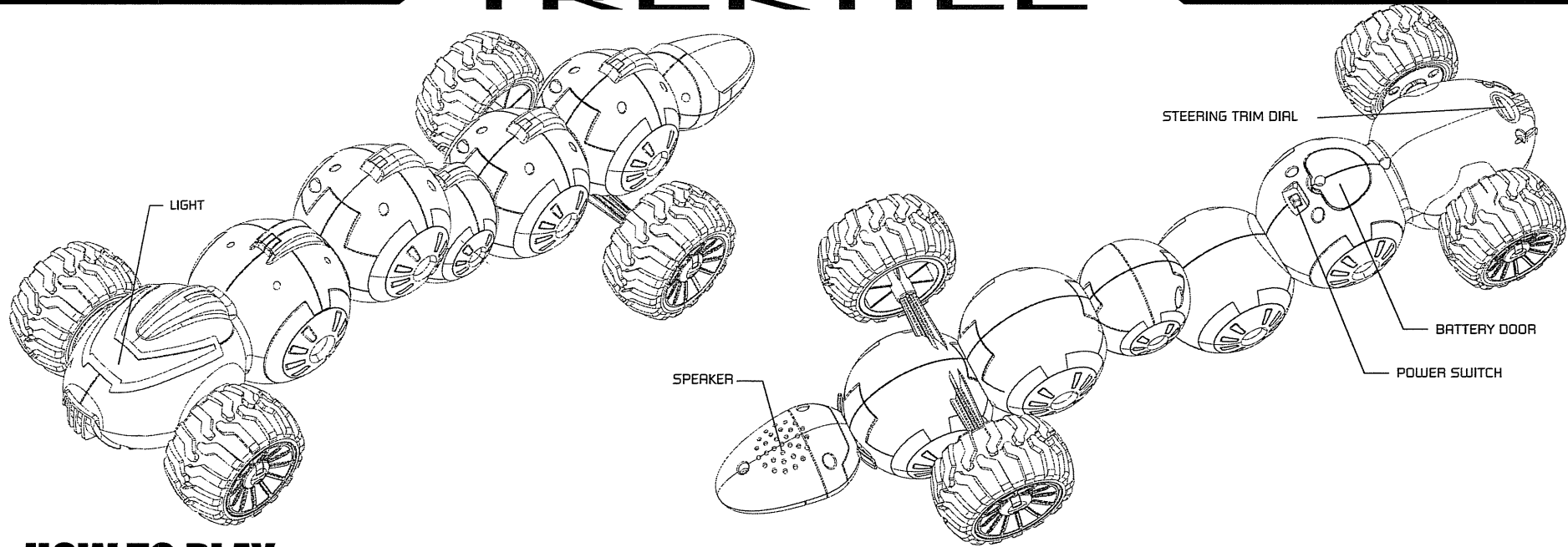

HOW TO PLAY

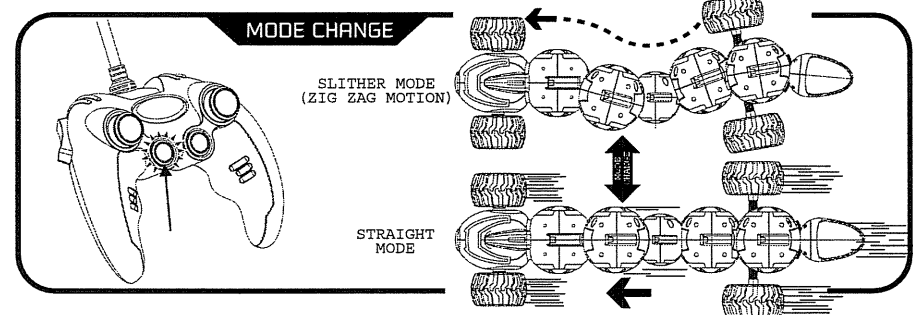
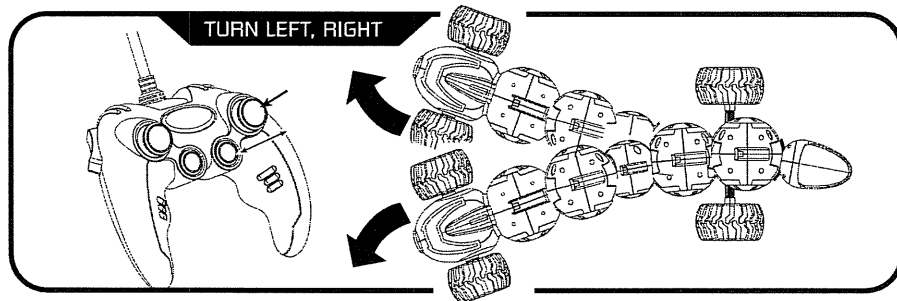
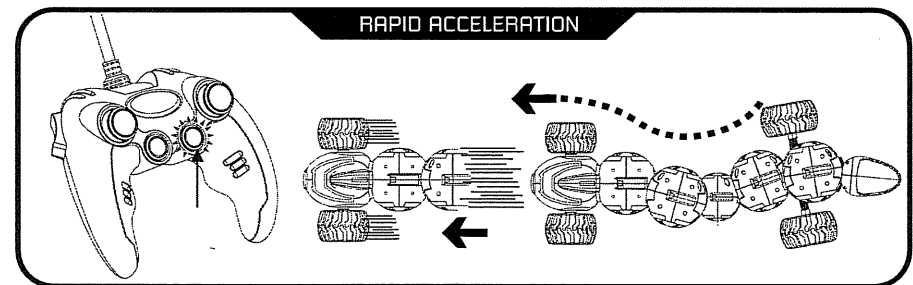
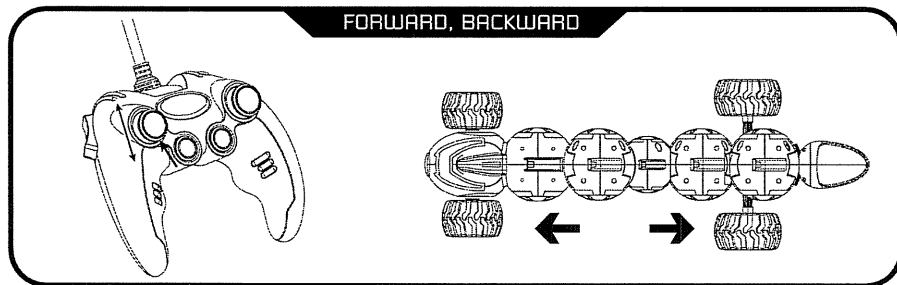

TREKTILE™ BATTERY INSTALLATION

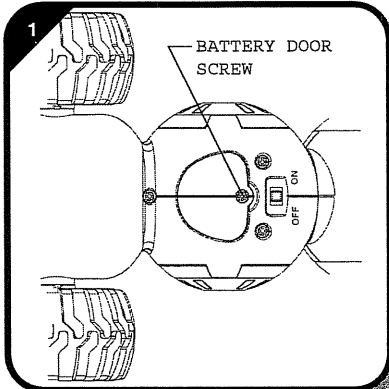

1
TURN OFF THE POWER AND REMOVE BATTERY DOOR WITH SCREWDRIVER

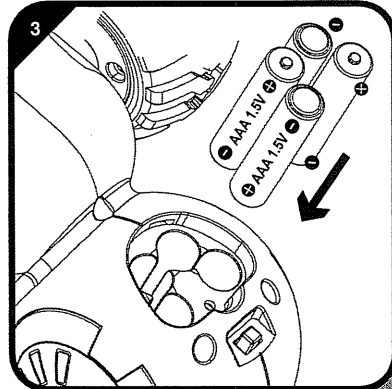

3
INSERT 4 AAA BATTERIES

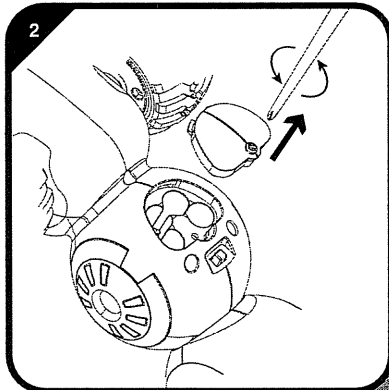

2
REMOVE BATTERY DOOR

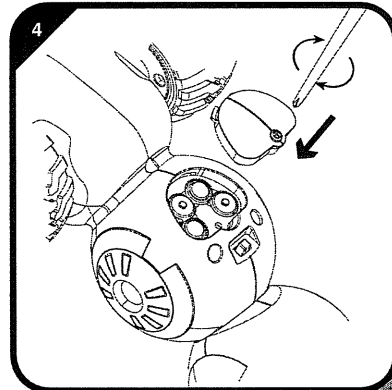

4
ATTACH BATTERY DOOR

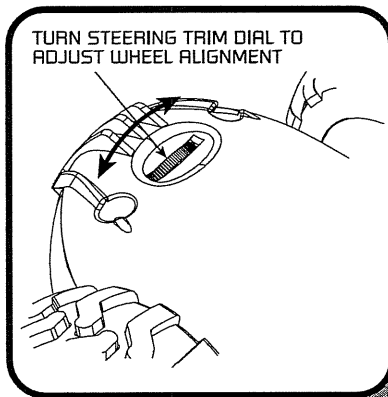

TURN STEERING TRIM DIAL TO ADJUST WHEEL ALIGNMENT

FOR BEST PERFORMANCE USE RECHARGEABLE BATTERIES. NOT RECOMMEND TO USE ZINC CARBON BATTERIES

REQUIRED FOR OPERATION
TREKTILE:
AAA-SIZE BATTERIES X 4
TRANSMITTER:
AAA-SIZE BATTERIES X 2
APPROX. PLAYTIME 25 MINS.

JOYPAD CONTROLLER BATTERY INSTALLATION

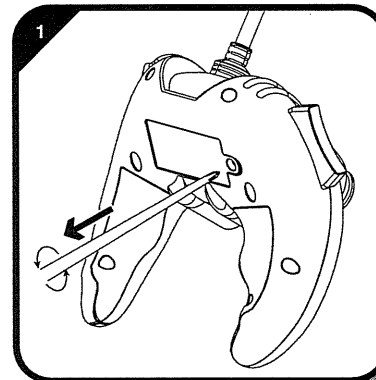

1
OPEN THE BATTERY DOOR

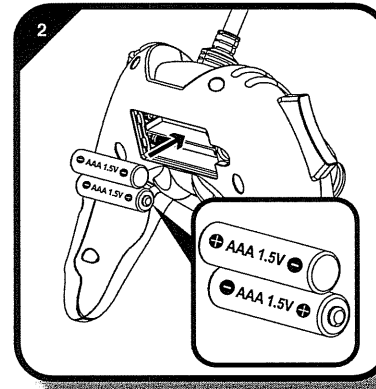

2
INSTALL 2 AAA BATTERIES

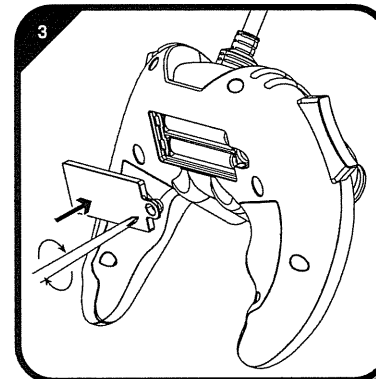

3
ATTACH THE BATTERY DOOR

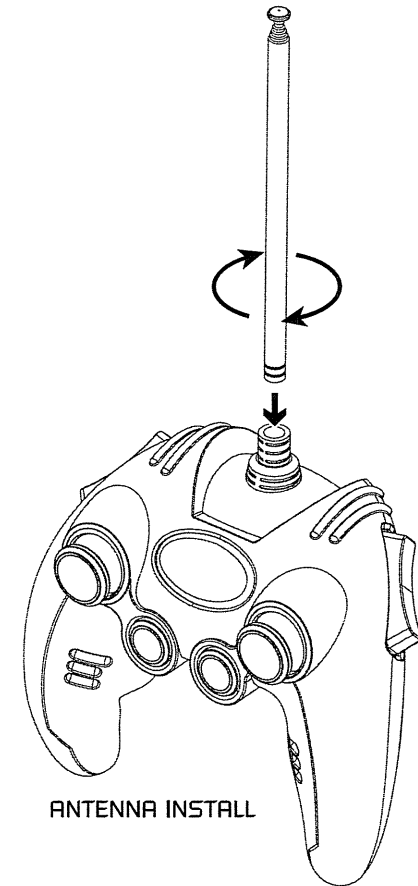

ANTENNA INSTALL

Battery Notes:

- Turn on the transmitter using the buttons. Confirm the Power Light is on.
- If the power light is not illuminated, check the polarity (+ and -) of the battery.
- If you are confident you have properly positioned the battery and the power light is not on, then try a new battery.

⚠ WARNING:

- Use only fresh batteries of the required size and type.
- Do not mix old and new batteries or different types of batteries (standard, alkaline or rechargeable) or rechargeable batteries of different types (NiCd or NiMH).
- If you are not planning to use your toys for several days, remove the batteries. Batteries can leak and damage your toy.
- Dispose of batteries properly. Do not burn or bury batteries.

! WARNING

- DO NOT RUN YOUR VEHICLE ON PUBLIC ROADS OR ANY AREA WHERE YOU MAY INTERRUPT PEDESTRIAN OR VEHICLE TRAFFIC.
- DO NOT OPERATE IN A CONGESTED AREA OR IN CROWDS. YOUR VEHICLE CAN CAUSE HARM IF IT COLLIDES WITH ANY OTHER PERSON.
- DO NOT OPERATE YOUR VEHICLE WITH OBSTRUCTED LINE OF SIGHT, AT NIGHT, OR NEAR WATER.
- THE MOTOR AND BATTERIES CAN BECOME HOT DURING USE. DO NOT HANDLE EITHER AFTER USE TO AVOID INJURY.
- YOUR VEHICLE IS CONTROLLED BY RADIO. RADIO WAVES ARE SUBJECT TO INTERFERENCE FROM OUTSIDE SOURCES. RADIO INTERFERENCE CAN CAUSE LOSS OF CONTROL OF YOUR VEHICLE.
- ALWAYS ALLOW A MARGIN OF SAFETY IN ALL DIRECTIONS.
- TOOLS AND SCREWDRIVERS NEED CAREFUL HANDLING.
- DO NOT TOUCH THE MOVING GEARS.
- ALWAYS TURN OFF THE POWER WHEN REMOVING BATTERIES.
- DO NOT USE DAMAGED BATTERIES.
- NEVER TRY TO CHARGE NON-RECHARGEABLE BATTERIES.
- RECHARGEABLE BATTERIES SHOULD ONLY BE CHARGED UNDER ADULT SUPERVISION.
- DO NOT USE DIFFERENT TYPES AND/OR NEW AND USED BATTERIES TOGETHER.
- ALWAYS USE BATTERIES OF THE SAME AND/OR EQUIVALENT TYPE.
- BATTERIES MUST BE INSERTED PROPERLY WITH THE CORRECT POLARITY.
- EXHAUSTED BATTERIES SHOULD BE REMOVED FROM THE VEHICLE.
- DO NOT DISPOSE THE BATTERY IN FIRE OR HEAT.
- DO NOT USE OR LEAVE THE BATTERY NEAR A HEAT SOURCE SUCH AS FIRE OR HEATER.
- DO NOT STRIKE OR THROW THE BATTERY AGAINST HARD SURFACE.
- DO NOT IMMERSE THE BATTERY IN WATER, AND KEEP THE BATTERY IN A COOL DRY ENVIRONMENT.
- WHEN RECHARGING, ONLY USE THE BATTERY CHARGER SPECIFICALLY FOR THAT PURPOSE.
- DO NOT OVER-DISCHARGE THE BATTERY.
- DO NOT CONNECT THE BATTERY TO AN ELECTRICAL OUTLET.
- DO NOT DIRECTLY SOLDER THE BATTERY AND PIERCE THE BATTERY WITH A NAIL OR OTHER SHARP OBJECT.
- DO NOT TRANSPORT OR STORE THE BATTERY TOGETHER WITH METAL OBJECTS SUCH AS NECKLACES, HAIRPINS ETC.
- DO NOT DISASSEMBLE OR ALTER THE BATTERY.
- DO NOT RUN YOUR VEHICLE IN SANDY, DUSTY, OR WET CONDITIONS, OR ON THICK/SOFT CARPET.

MAINTENANCE

- ALWAYS REMOVE BATTERIES FROM THE TOY WHEN IT IS NOT BEING USED FOR A LONG PERIOD OF TIME.
- WIPE THE TOY GENTLY WITH A CLEAN DAMP CLOTH.
- KEEP THE TOY AWAY FROM DIRECT HEAT.
- DO NOT SUBMERGE THE TOY INTO WATER THAT CAN DAMAGE THE ELECTRONIC ASSEMBLIES.

RESET MAY OCCUR IF BATTERIES GO LOW. PLEASE REPLACE NEW BATTERIES.

THE FCC WANTS YOU TO KNOW

Modifying or tampering with your RadlineRC toy or transmitter's internal components can cause a malfunction and could void your FCC authorization to operate the equipment.

This equipment has been tested and found to comply with Part 15 of the FCC Rules.

Operation is subject to the following two conditions:

This device may not cause harmful interference

This device must accept any interference received, including interference that may cause undesired operation

Warning: Changes or modifications to this unit not expressly approved by the party responsible for compliance could void the user's authority to operate the equipment.

About FCC compliance

This device complies with Part 15 of the FCC Rules. Operation is subject to the following two conditions:

- 1) This device may not cause harmful interference, and
- 2) This device must accept any interference received, including interference that may cause undesired operation. This equipment has been tested and found to comply with the limits for a Class B digital device, pursuant to Part 15 of the FCC Rules. These limits are designed to provide reasonable protection against harmful interference in a residential installation. This equipment generates, uses and can radiate radio frequency energy and, if not installed and used in accordance with the instructions, may cause harmful interference to radio communications.

However, there is no guarantee that interference will not occur in a particular installation.

If this equipment does cause harmful interference to radio or television reception, which can be determined by turning the equipment off and on, the user is encouraged to try to correct the interference by one or more of the following measures:

- Reorient or relocate the receiving antenna.
- Increase the separation between the equipment and receiver.
- Connect the equipment into an outlet on a circuit different from that to which the receiver is connected.

Consult the dealer or an experienced radio/TV technician for help.

BEHAVIOR

TREKTILE... RC VEHICLE OR ROBOTIC PET? IT'S BOTH!

TREKTILE can sense your touch--- how will it respond to you?

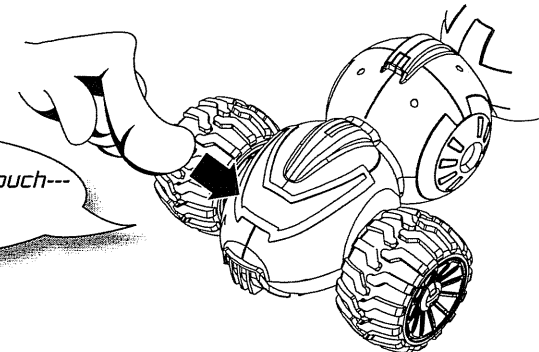

➔ Equipped to communicate with other life forms, TREKTILE can and will express its moods to you when you pet it---be they happy, sad or MAD!

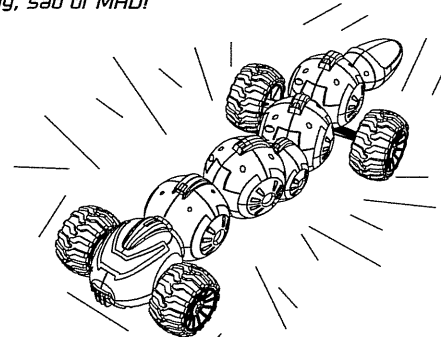
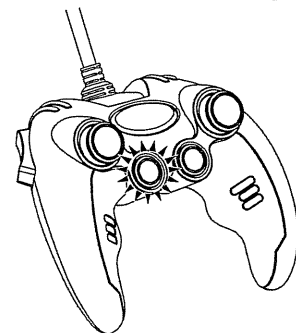

➔ By pressing the joypad controls in "INTELLIGENT" mode, your TREKTILE will react with dramatic displays of light and sound!

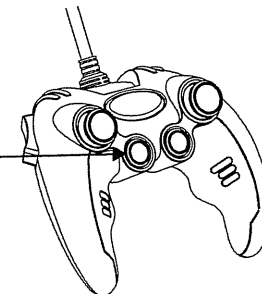
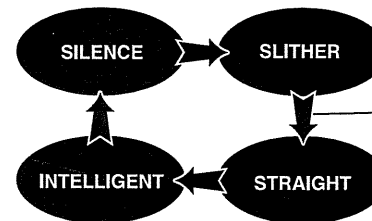

Drive your TREKTILE on any hard surface using its joypad controller, either in "STRAIGHT" or "SLITHER" driving modes. Its hypnotic, serpentine motion and rapid acceleration button make TREKTILE fun to drive and watch!

This is one side-winding "cyber snake" that will get plenty of attention and capture the imagination---wherever it goes! As with any radio controlled toy, please operate your TREKTILE safely and responsibly---and have fun!