



| Smart Control
Guide

Table of Contents

| | |
|--|----|
| Your Smart Control | 1 |
| Practical Solutions to Everyday Problems | 2 |
| Using the Smart Control Guide | 3 |
| Turning Your Smart Control On and Off | 4 |
| Replacing the Battery | 5 |
| Operating Instructions | 7 |
| Adjusting Your Hearing Instruments with Smart Control | 8 |
| Accessories | 11 |
| Caring for Your Smart Control | 12 |
| Cleaning Your Smart Control | 12 |
| Warnings | 13 |
| Troubleshooting Guide | 16 |
| Declaration of Conformity | 17 |

Your Smart Control

Hearing Healthcare Professional: _____

Telephone: _____

Model: _____

Serial Number: _____

Replacement Batteries: One AAA (1.5 Volt),
Standard or Rechargeable

Warranty: _____

Date of Purchase: _____

Practical Solutions to Everyday Problems

Congratulations on purchasing your new Smart Control handheld device and choosing a Unitron Hearing digital system. For over 40 years, Unitron Hearing has been committed to making life better for people with hearing loss. This means a commitment to developing high-quality hearing solutions that incorporate special features to solve the everyday problems and concerns you have with hearing loss and hearing devices.

Smart Control is a small and user-friendly remote control which allows you to manage your hearing instruments' volume levels, switch between listening programs and adjust the comfort and clarity of sound, all in the palm of your hand.

Using the Smart Control Guide

Refer to the table of contents for a complete listing of the topics covered in this guide.

The diagrams below identify some of the components on your Smart Control.

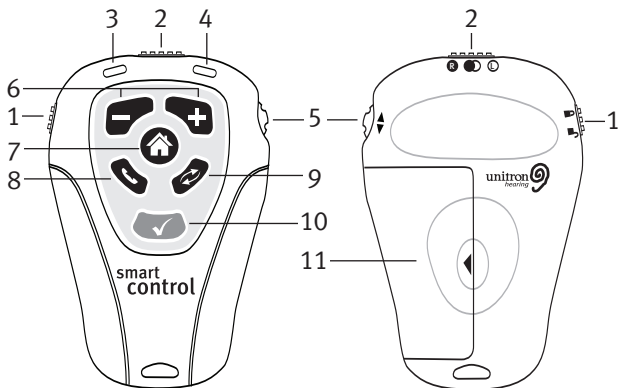



Legend

- | | |
|-------------------------------|-------------------------|
| 1 Off-On Switch | 7 Home Button |
| 2 Left-Both-Right Switch | 8 Telephone Button |
| 3 Left (Blue) Indicator Light | 9 Program Change Button |
| 4 Right (Red) Indicator Light | 10 LearnNow Button |
| 5 Comfort-Clarity Control | 11 Battery Compartment |
| 6 Volume Control Buttons | |

Turning Your Smart Control On and Off

Your Smart Control has an Off-On switch on the left side of the device.

- To turn the remote control on, slide the switch into the On position .
- To turn the remote control off, slide the switch into the Off position . Sliding the switch to the Off position will avoid sending unintentional commands to your hearing instruments (while the device is in your handbag or pocket, for example).

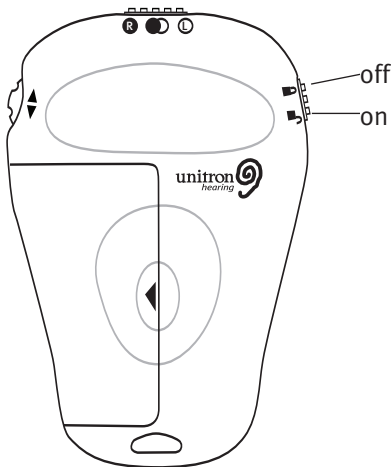

Replacing the Battery

The battery compartment is located on the back of the Smart Control.

1. Slide the battery cover in the direction of the arrow.
2. Grasp the old battery with your thumb and index finger and remove.
3. Insert the new battery into the battery compartment in the correct +/- position, placing the battery's minus (-) end into the compartment first.
4. Slide the battery cover in the opposite direction of the arrow.

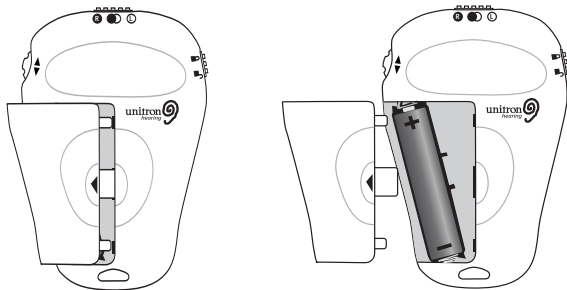

Low Battery Warning

When you see the left and right indicator lights flash rapidly for two seconds, your Smart Control is warning you that the battery in your handheld device is low. You will see the warning every time you turn on your Smart Control or send a command to your hearing instruments until you change the battery or the battery dies.

Caring for Batteries

- Always discard batteries in a safe and environmentally friendly way.
- To prolong battery life, remember to turn the remote control off when not in use.

Battery Warnings

- Never leave your remote control or batteries where small children and pets can reach them.
- Never put your remote control or batteries in your mouth. If a battery is swallowed, call a physician immediately.

Operating Instructions

Before using your Smart Control, turn on your hearing instruments to ensure they are able to receive the Smart Control commands.

Smart Control is designed to be used comfortably in your hand at a maximum distance of one arm's length. You do not have to point the remote at your hearing instruments. Placing the remote control directly next to or too close to your hearing instruments may decrease the remote's effectiveness.

Selecting Which Hearing Instrument to Adjust

At the top of the handheld device, there is a Left-Both-Right switch. This switch allows you to select the hearing instruments you want to adjust.

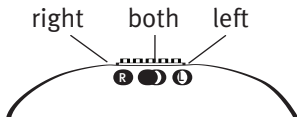

- The left (blue) indicator light will flash to indicate your left hearing instrument is being adjusted.
- The right (red) indicator light will flash to indicate your right hearing instrument is being adjusted.
- Both indicator lights will flash to indicate your left and right hearing instruments are being adjusted at once.

Adjusting Your Hearing Instruments with Smart Control

Your Smart Control provides backlighting each time a button is pressed, allowing you to see the remote buttons in dimly lit environments.

Comfort-Clarity Control



The Comfort-Clarity Control can improve listening comfort in noisy situations and assist with sound clarity and ease of listening.

- Turn the scroll wheel up to improve sound clarity.
- Turn the scroll wheel down to improve listening comfort.

As the comfort-clarity settings are adjusted, your hearing instruments may beep. Please refer to your hearing instrument guide for more information on the comfort-clarity beeps.

Note that the Comfort-Clarity Control on your hearing instruments may be deactivated by your hearing healthcare professional and, therefore, could be inactive. Talk to your hearing healthcare professional to find out if you are able to adjust your hearing instruments' comfort-clarity settings.

Volume Control Buttons



- To increase the volume on your hearing instruments, press the + button on your Smart Control.
- To decrease the volume on your hearing instruments, press the – button on your Smart Control.

As the volume is adjusted, your hearing instrument may beep. Please refer to your hearing instrument guide for more information on your hearing instruments' volume beeps.

Note that the volume control on your hearing instruments may be deactivated by your hearing healthcare professional and, therefore, could be inactive. Talk to your hearing healthcare professional to find out if you are able to adjust your hearing instruments' volume settings.

Home Button



To return to the listening program that is initiated when you first turn on your hearing instruments (i.e., your start-up program) press the **Home** button. Regardless of the position of the Left-Both-Right switch, pressing the Home button sends a command to both of your hearing instruments to

return to the start-up program. Please refer to your hearing instrument guide to determine which program is your start-up program.

Telephone Button



To switch to the telephone program, press the **Telephone** button.

To exit the telephone program, press the **Home** or **Program Change** button.

Program Change Button



To change the currently set listening program on your hearing instruments, press the **Program Change** button. The hearing instrument will advance to the next listening program. Please refer to your own hearing instrument guide to determine which programs are available to you and their program beep notifications.

LearnNow Button



The **LearnNow** button allows you to tell your hearing instruments that you like the current volume and comfort-clarity settings. When you press the LearnNow button, Smart Control sends a message to your hearing instruments to remember and use these settings when you are in a similar listening environment in the future. In this way, LearnNow allows

you to personalize the volume and comfort-clarity settings in your hearing instruments such that fewer manual adjustments are required by you in the future.

Note: The LearnNow button will only work when your hearing instruments are set to the automatic program. After pressing the LearnNow button, your hearing instruments will give you a short three beep melody, if the LearnNow command was successfully received. Please refer to your hearing instrument guide to learn more about the automatic program.

Accessories

Your Smart Control can be used with a lanyard so that you can carry the device around your neck or wrist. Attach the lanyard to the device, as illustrated below.

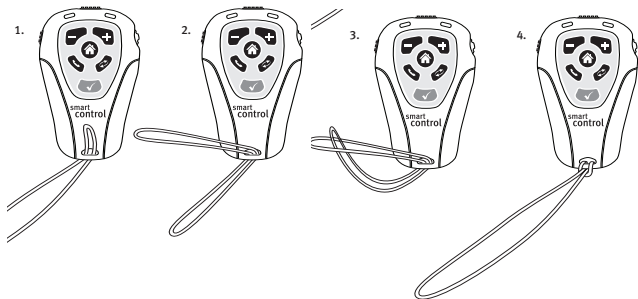

Caring for Your Smart Control

- Open the battery compartment and remove the battery if the remote control will not be used for long periods of time.
- Do not use your Smart Control in the bath or shower or immerse it in water.
- If your remote device does become wet, do not attempt to dry it in an oven or microwave. Do not adjust any controls. Open the battery compartment and allow your remote device to dry naturally for 24 hours.
- Protect your remote device from excessive heat (hair dryer, vehicle glove box or dashboard).
- Do not drop your remote device or knock it against hard surfaces.

Cleaning Your Smart Control

Do not use alcohol to clean your remote control. Use a damp cloth to clean the outside of the remote.

Warnings

- Smart Control should only be used as directed by your hearing healthcare professional.
- Smart Control uses a low-power, digitally coded inductive transmission to communicate to your hearing instruments. Although unlikely, interference with medical devices such as pacemakers is possible. Interference should not occur with normal use, holding the remote comfortably in the hand, 4 inches (10 centimeters) or more from the body. Therefore, it is recommended that pacemaker users do not keep the remote device in a breast pocket.
- Do not use Smart Control in explosion hazard areas.
- Do not use Smart Control in locations forbidden to use electronic devices, such as an airplane.
- Store your Smart Control in a safe location for CT and MRI scans or for other electromagnetic procedures.
- Changes or modifications made to the Smart Control not expressly approved by Unitron Hearing may void the user's authority to operate the equipment.

Precautions

- If your Smart Control fails to operate after you have correctly inserted a new battery, contact your hearing healthcare professional. Always bring both your Smart Control and your hearing instruments for service questions.
- Your Smart Control and your hearing instruments are given a unique communication code. Because of this code, your Smart Control will not affect hearing instruments worn by others.
- Your Smart Control uses the most modern components to provide an extremely reliable experience with virtually no interference from other devices. However, when operating the Smart Control near a computer terminal, communication device such as a digital cell phone, or other strong electromagnetic field, it may be necessary to be at least 24 inches (60 centimeters) away to ensure proper operation. If your hearing instruments do not respond to the Smart Control because of an unusual field disturbance, move away from the disturbing field.

Labeling

The serial number and year of manufacture are located inside the battery compartment.

Please fill out the contact information sticker provided with your new Smart Control and place inside the battery compartment.

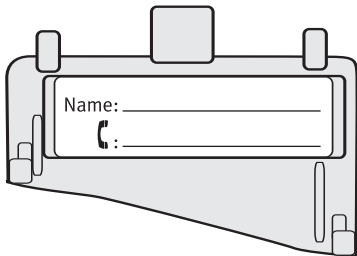

Troubleshooting Guide

You can refer to the troubleshooting table below if you are experiencing problems with your Smart Control. Please consult your hearing aid guide to troubleshoot problems with your hearing instruments.

| CAUSE | POSSIBLE REMEDY |
|---|---|
| Indicator lights not flashing | |
| <ul style="list-style-type: none">• Not turned on• Low/dead battery• Poor battery contact• Battery upside down | <ul style="list-style-type: none">• Turn on• Replace battery• Consult your hearing healthcare professional• Insert battery minus (-) side down |
| Indicator lights flashing rapidly | |
| <ul style="list-style-type: none">• Low battery | <ul style="list-style-type: none">• Replace battery |
| Hearing instruments not responding to Smart Control commands | |
| <ul style="list-style-type: none">• Holding the remote device too far away | <ul style="list-style-type: none">• Move the remote device closer to you |

For any problems not listed in the guide, contact your hearing healthcare professional. If you do not have a hearing healthcare professional, please contact the nearest office listed on the back page of this booklet.

Declaration of Conformity

Hereby, Unitron Hearing declares that Smart Control is in compliance with the essential requirements and other relevant provisions of Directive 93/42/EEC. To obtain a copy of the Declaration of Conformity, please contact your local representative from the list of Unitron Hearing Distributors.

This device complies with part 15 of the FCC rules and with RSS 210 of Industry Canada. Operation is subject to the following two conditions: (1) This device does not cause harmful interference, and (2) this device must accept any interference received, including interference that may cause undesired operation.

UNITRON HEARING DISTRIBUTORS

CORPORATE OFFICE/INTERNATIONAL

20 Beasley Drive, P.O. Box 9017, Kitchener, ON N2G 4X1 Canada

AUSTRALIA

Level 2, Norwest Quay, 21 Solent Circuit, Baulkham Hills, NSW, NSW 2153

BELGIUM

Baron de Vironlaan, 60 b-1700 Dilbeek

CANADA

5 Cherry Blossom Road, Unit 2, Cambridge, ON N3H 4R7

CHINA

No. 200 Suhong Road, Export Processing Zone 4D, Suzhou Industrial Park 215021

EUROPEAN REPRESENTATIVE

Daimlerstrasse 22, 70736 Fellbach-Oeffingen, Germany

FRANCE

5, rue Maryse Bastié - BP 15 69671 Bron Cedex, France

NETHERLANDS

Archimedesbaan 19, P.O. Box 1214, 3430 BE Nieuwegein

NEW ZEALAND

10/215 Rosedale Rd., M277 Private Bag, 300987, Albany, Auckland

NORWAY

Brugata 14 0186 Oslo, Norway

SOUTH AFRICA

First Floor – East Block, Pineslopes Office Park, Cnr The Straight & Witkoppen Roads, Fourways, Johannesburg 2194

UNITED KINGDOM

St. George House, Cygnet Court, Centre Park, Warrington, Cheshire WA1 1PD

U.S.A.

Suite A, 2300 Berkshire Lane North, Plymouth, MN 55441

MANUFACTURER

UNITRON HEARING LTD.

20 Beasley Drive, P.O. Box 9017, Kitchener, ON N2G 4X1 Canada





www.unitronhearing.com

DISTRIBUTOR