

# **DETACHABLE 2.1 Channel Bluetooth Soundbar**



## **Owner's Manual**

## PROSCAN DETACHABLE 2.1 Channel Bluetooth Soundbar

Immerse yourself with the PROSCAN Bluetooth soundbar and feel your audio come alive in your home. The PROSCAN Bluetooth soundbar will provide you with a powerful and satisfying sound from an ultra stylish design.

Front



Rear



### Bluetooth pairing instructions:

To pair your audio device to the PROSCAN sound bar via Bluetooth, ensure you are close by the PROSCAN sound bar then go into your audio device (mobile phone, Tablet etc.) settings and enable Bluetooth. Bluetooth connection name: PROSCAN

This should automatically pick up all the Bluetooth devices in your vicinity, from the list you should see PROSCAN Soundbar, please select this and your device should pair successfully.

### OPERATION AND LED DISPLAY

- You can connect several external devices simultaneously to the soundbar and select the required device every time using the source selection function
- Press repeatedly the  button at the (4) at the soundbar or the INPUT button on the remote control to select the desired audio source
- The selected audio source, Sound effect and volume control is displayed on the LED display of the soundbar
- Digital LED display on the front of the soundbar
- Red LED indicates standby after show bye
- All other LED digital letter is white display

Mode	Message on the LED display
OPTICAL	OPT(default)
AUX	LINE
BLUETOOTH	BLUE
COAXIAL	COX
MUSIC	E1
TV	E2
Movie	E3
SUB	S -10/+10,00(Bass default)
Volume	01/20

### Description of terminals on the rear of the unit:

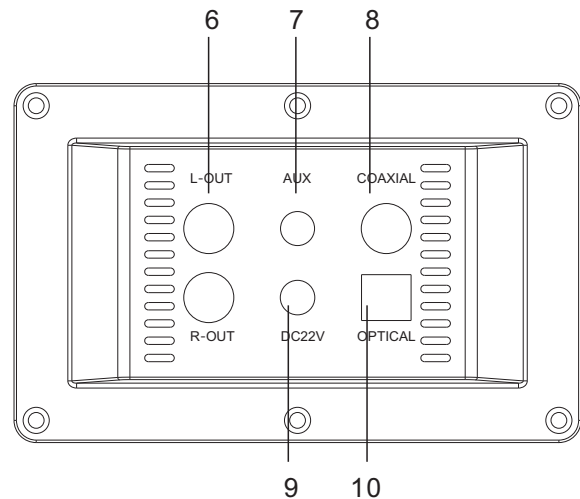
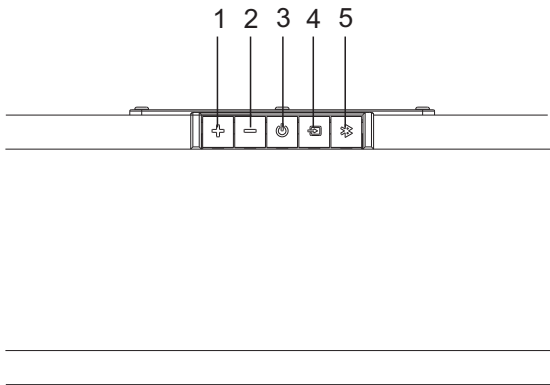

### Description of front button on soundbar

- 1.increase the volume of the soundbar
- 2.decrease the volume of the soundbar
- 3.Power switch
- 4.Press to change the input source (AUX,OPTICAL,COAXIAL ,BT)
- 5.Pairing bluetooth

### Description of rear panel on sound bar

- 6.Connect with two both of satellite speaker
- 7.Input AUX
- 8.Input Coaxial
- 9.DC22V
- 10.Input Optical

### Remote Control Description

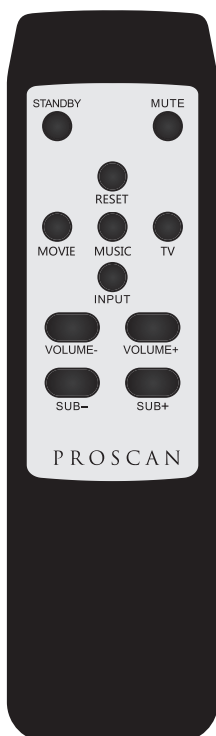

**STANDBY:** Switch to standby mode of the soundbar

**MUTE:** Mute audio

**RESET:** Volume reset

**MOVIE/MUSIC/TV:**Sound effect switchover

**INPUT:** Toggle among different input sources (AUX/OPT/COX/BT)

**VOLUME-:**Decrease the volume of the soundbar

**VOLUME+:** Increase the volume of the soundbar

**SUB-/+:** volume for bass

## Installation Instructions:

- Step 1 : Plug the power adapter into the PROSCAN soundbar
- Step 2: Switch the power button ON
- Step 3: Pair the soundbar (see above pairing instructions) if you want to use it in Bluetooth mode
- Step 4: Attach an audio source to the AUX to connect the sound bar to an external input
- Step 5: Press INPUT on the remote to change between AUX and Bluetooth modes

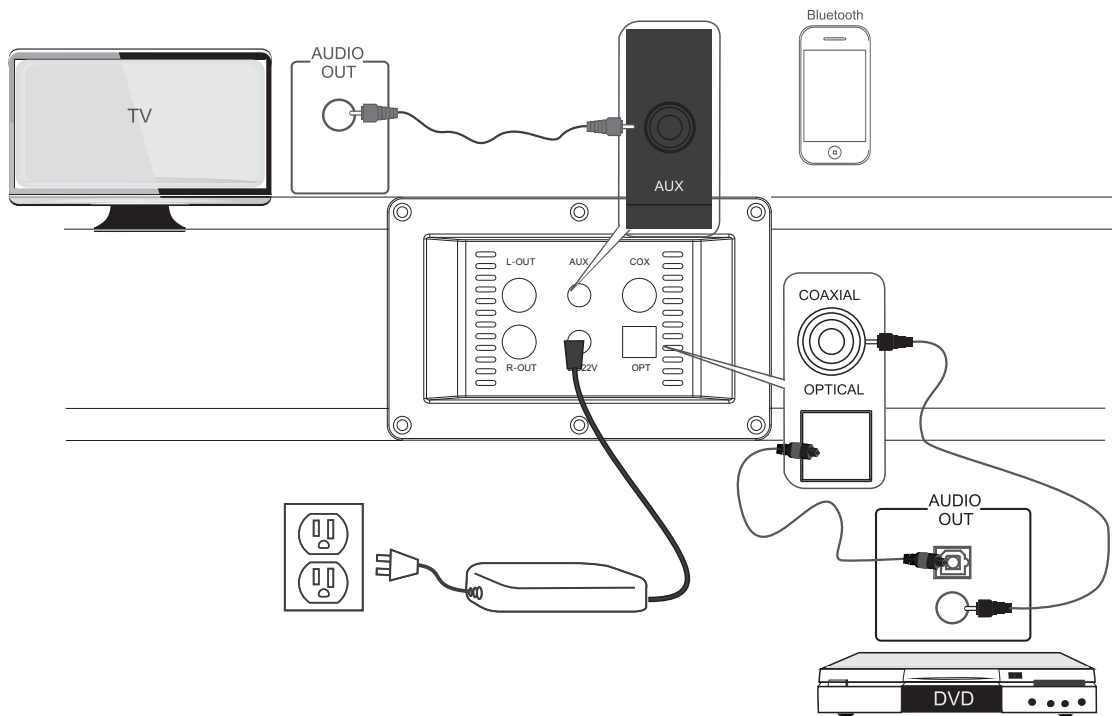

It is detachable 2.1CH bluetooth soundbar , take both end of satellite speaker apart , put on the table independently ;if you want to be one whole set ,mount both end of stellite speaker back to soundbar by snap joint (see picture )

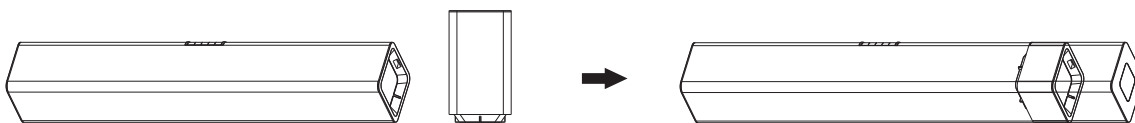

## Connecting to external devices

### L-OUT&R-OUT connect with two both of satellite speaker

#### With a 3.5mm to Cinch audio cable(supplied)

- Use the Cinch to 3.5mm audio cable provided to connect the soundbar to a television set, a DVD player , a game console or other suitable device
- Connect one end of the Cinch to 3.5mm audio cable provided to the output sockets of your external device
- Attach the other end of the Cinch to 3.5mm audio cable provided to the AUX Input sockets of the soundbar

**With a digital Coaxial cable (not supplied)**

Connection with better sound quality

- Use a digital coaxial cable (not supplied) to create a digital connection to a TV, DVD, Blu-Ray player or other suitable devices
- Connect one end of the digital coaxial cable (not supplied) to the COAXIAL input socket at the back of the sound bar

**With a digital Optical cable (not supplied)**

Connection with better sound quality

- Use a digital optical cable (not supplied) to create a digital connection to a TV, DVD, Blu-Ray player or other suitable devices
- Connect one end of the digital optical cable (not supplied) to the digital optical output socket of your source device
- Connect the other end of the digital optical cable (not supplied) to the OPTICAL input socket at the back of the soundbar.

**FCC STATEMENT :**

This device complies with Part 15 of the FCC Rules. Operation is subject to the following two conditions:

(1) This device may not cause harmful interference, and (2) This device must accept any interference received, including interference that may cause undesired operation.

**Warning:** Changes or modifications not expressly approved by the party responsible for compliance could void the user's authority to operate the equipment.

NOTE: This equipment has been tested and found to comply with the limits for a Class B digital device, pursuant to Part 15 of the FCC Rules. These limits are designed to provide reasonable protection against harmful interference in a residential installation. This equipment generates uses and can radiate radio frequency energy and, if not installed and used in accordance with the instructions, may cause harmful interference to radio communications. However, there is no guarantee that interference will not occur in a particular installation. If this equipment does cause harmful interference to radio or television reception, which can be determined by turning the equipment off and on, the user is encouraged to try to correct the interference by one or more of the following measures:

Reorient or relocate the receiving antenna.

Increase the separation between the equipment and receiver.

Connect the equipment into an outlet on a circuit different from that to which the receiver is connected.

Consult the dealer or an experienced radio/TV technician for help.

**RF warning statement:**

The device has been evaluated to meet general RF exposure requirement. The device can be used in portable exposure condition without restriction.

## Troubleshooting guide:

### No power

Check the connection of the AC/DC adaptor between the unit and wall outlet

### No sound

Check that the volume control is not at minimum  
Check that mute is not set on the remote control

### The Remote control is not working

Replace the batteries

Make sure there are no obstacle obscuring the front of the PROSCAN soundbar

### The power light is on when power on, but no sound

Press the power button on the remote to ensure the soundbar is not in standby mode  
Press the input button on the remote to switch between AUX and Bluetooth in case you're in the wrong mode

### Intermittent Bluetooth

For the best signal transmission please ensure your PROSCAN soundbar is located 4 meters away from microwave ovens & Wi-Fi routers as this can interfere with the signal

<b>Specifications:</b>	
<b>Speakers:</b>	SUB Speaker 3"x2 4Ω 20W+passive speaker 3"x2 two end of speaker 3"x2 4Ω10W
Output sound press:	88dB
Frequency response:	80-20KHz
Remote control system:	infrared
Adapter input:	AC100V-AC240V 50Hz/60Hz 0.6A Max
Power output:	22V 1.63A
Standby power:	<0.5W
Mid speaker :	L670xW102xH102mm
One satellite speaker:	L183xW102x102mm
Gift box:	L1170xW149x153mm
Master carton:	L1180xW309x167mm