



1

Download The Free App



Search on the Apple Store or Google play for VR Real Feel Racing



2

Install Batteries

Unscrew the battery door on the back of the steering wheel

Install 3 x AAA batteries (not included)
Replace the battery door

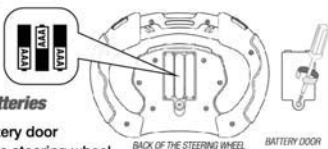

ALKALINE BATTERIES RECOMMENDED. USES 3 AAA BATTERIES (NOT INCLUDED)

BATTERY WARNINGS:
DO NOT MIX OLD AND NEW BATTERIES.
DO NOT MIX ALKALINE, STANDARD (CARBON-ZINC), OR RECHARGEABLE (NICKEL-CADMIUM) BATTERIES.
BATTERIES ARE TO BE INSERTED WITH THE CORRECT POLARITY.

3

Setting Up Smart Phone

Make sure the volume level on your phone is set to maximum and that the phone is not set to "silent" mode.

NOTE: You will be able to adjust the volume levels of the sound effects and music in the App before you start to play the game.

Turn OFF your WIFI and Cellular data. This will keep you from being disturbed while playing.

You can also put your phone in "airplane mode" but be sure your Bluetooth® connectivity is still enabled.

IMPORTANT: Bluetooth®
Bluetooth® connectivity must be working for you to play with VR Real Feel Racing.

4

Launch the VR REAL FEEL™ app

Click & launch the VR Real Feel APP on your device.



Turn the ON/OFF switch on the back of the steering wheel to ON.



Press SCAN in the app to connect your steering wheel by Bluetooth® technology. The word GO! will turn bright.



Press the GO! button to start the program.

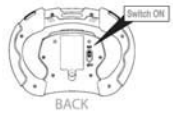

RED LED on the steering wheel should be lit
This tells you that the Bluetooth® connection was successful

NOTE:
• You must have the steering wheel connected by Bluetooth® technology for the App to open.

NOTE: The red LED on the front of the steering wheel will flash on and off two times to tell you that the batteries are working.

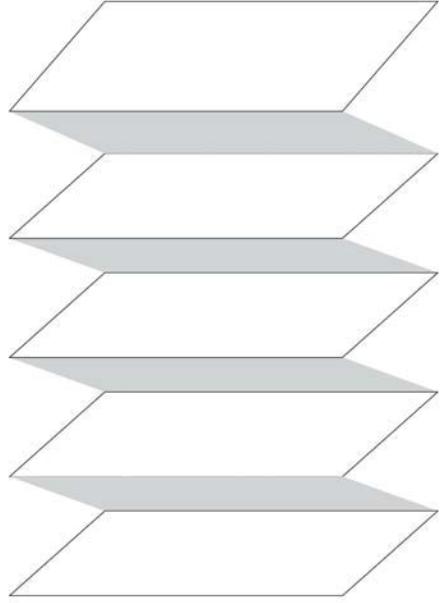

This fold pattern allows foreign language version to be printed on the back side with the same unfolding action. Just flip. If you must add pages make sure you end with odd number pages

MOUNTAIN FOLD

VALLEY FOLD

MOUNTAIN FOLD

VALLEY FOLD

5

Insert Your Phone

Open the front panel of the headset by pressing on the button on the top.



VR HEADSET

Slide the self adjusting frame wide enough to insert your phone. Release the frame and make sure that it holds your phone by the clasp.



VR HEADSET OPENED

6

Center your phone

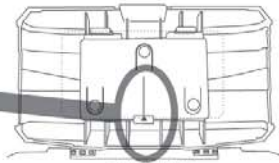
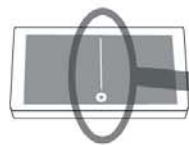

CENTER LINE

Align the white line on the APP screen with the marker on the frame to center your phone properly for optimum viewing. Close the VR headset carefully; make sure the button on top is locked.

For some phone models the frame "clips" may align with control buttons such as power or volume. Attach the included foam pad to the frame clips to minimize pressure on those buttons.

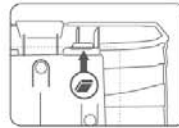

MOUNTAIN FOLD

VALLEY FOLD

7

Put On the Headset

Place the headset on your head. Make sure the center strap is centered over the top of your head.

Adjust the straps so the headset fits snugly and comfortably

TIP: If the headset is putting too much weight on your nose, make the center strap shorter



8

Let's Race!

Hold the steering wheel and follow the instructions in the app to start the race.

The drawing on the right explains the controls.

Press (+) button to continue.

Go to settings menu to adjust your settings.

When you are finished, select the race you want to play and press (+) button.

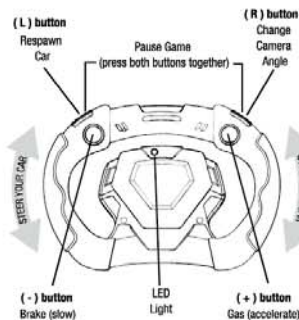

MOUNTAIN FOLD

TIPS AND TROUBLESHOOTING

Don't drive too fast at first or you will crash a lot. Get used to the feel of your car and the track first and build up your driving skills. Start slowly and build your way up.

Look for special icons on the track. They may hold some fun surprises.

Hold down the (+) button to go faster and the (-) button to go slower

If you see yourself "fishtailing", try to hit to the (-) button to gain control of your car.

Because the game is generating stereo high-definition graphics, your phone's battery life may be shorter than with other games. Make sure your phone is well charged before playing.

While playing VR Real Feel Racing, you may notice that the phone is warm to the touch. This is normal. If it gets too warm stop the app and let the device cool down.

If the Red LED on the Steering Wheel does not flash 2 times when you turn on the switch to ON, Replace the batteries and try again.

If the RED LED does not come on after you press SCAN on the app, check to make sure your Bluetooth® connectivity setting is in the ON position. You must be running Bluetooth® connectivity for the App to open.

If you want to play silently, plug in your ear buds (not included) through the slot on the side of the headset to your phone

Bluetooth® headphones are not available for this app because mobile devices cannot connect Bluetooth® headphone and steering wheel at the same time.

This device complies with Part 15 of the FCC Rules.

Operation is subject to the following two conditions:

- (1) this device may not cause harmful interference, and
- (2) this device must accept any interference received, including interference that may cause undesired operation.

Warning: Changes or modifications to this unit not expressly approved by the party responsible for compliance could void the user's authority to operate the equipment.

NOTE: This equipment has been tested and found to comply with the limits for a Class B digital device, pursuant to Part 15 of the FCC Rules. These limits are designed to provide reasonable protection against harmful interference in a residential installation. This equipment generates, uses and can radiate radio frequency energy and, if not installed and used in accordance with the instructions, may cause harmful interference to radio communications.

However, there is no guarantee that interference will not occur in a particular installation. If this equipment does cause harmful interference to radio or television reception, which can be determined by turning the equipment off and on, the user is encouraged to try to correct the interference by one or more of the following measures:

- Reorient or relocate the receiving antenna.
- Increase the separation between the equipment and receiver.
- Connect the equipment into an outlet on a circuit different from that to which the receiver is connected.
- Consult the dealer or an experienced radio/TV technician for help.

VR ENTERTAINMENT LTD.
CHANGHANG ROAD,
CHANGPING, DONGGUAN, CHINA
MADE IN CHINA



Android, Google Play and the Google Play logo are trademarks of Google Inc.

Apple, Apple logo, iPod touch and iPhone are trademarks of Apple Inc., registered in the U.S. and other countries. App Store is a service mark of Apple Inc.



The Bluetooth® word mark and logos are registered trademarks owned by the Bluetooth SIG, Inc. and any use of such marks by VR-ENTERTAINMENT LTD. is under license. Other trademarks and trade names are those of their respective owners.

www.vr-entertain.com

49400-US

VALLEY FOLD

VALLEY FOLD