

Go to [www.vtechphones.com](http://www.vtechphones.com) to register your product for enhanced warranty support and the latest VTech product news.

## VM351 VM351-2 Full Color Video Monitor with Wide-Angle Lens



## vtech User's manual

### Congratulations

on purchasing your new VTech product. Before using this product, please read **Important safety instructions**.

This manual has all the feature operations and troubleshooting necessary to install and operate your new VTech product. Please review this manual thoroughly to ensure proper installation and operation of this innovative and feature rich VTech product.

For support, shopping, and everything new at VTech, visit our website at [www.vtechphones.com](http://www.vtechphones.com).

### What's in the box



### Install the battery

The parent unit runs on rechargeable battery or AC power. To continuously monitor your baby, make sure you use both battery and AC power at the same time. With the battery alone, the parent unit can cordlessly run for a short time only.

#### NOTES

- Use only the battery supplied with this product.
- The operating time for using the rechargeable battery is short. If you want to monitor your baby for a long time, we recommend you connect the parent unit to AC power.
- If the parent unit will not be used for a long time, disconnect and remove the battery to prevent possible leakage.

Install the battery as shown below.

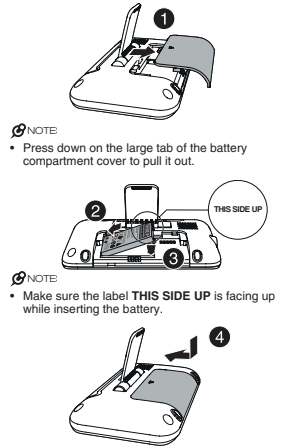

### Replace the battery

To replace the battery, press down on the large tab of the battery compartment cover and pull it out, then follow the steps above to install the battery.

### Connect and charge the battery

#### NOTES

- Use only the battery supplied with this product.
- Use only the power adapters supplied with this product.
- Make sure the electrical outlets are not controlled by wall switches.
- The power adapters are intended to be correctly oriented in a vertical or floor mount position. The prongs are not designed to hold the plug in place if they are plugged into a ceiling, under-the-table or cabinet outlet.
- Make sure the parent unit, the baby unit and the power adapter cords are out of reach of children.

### Connect the baby monitor

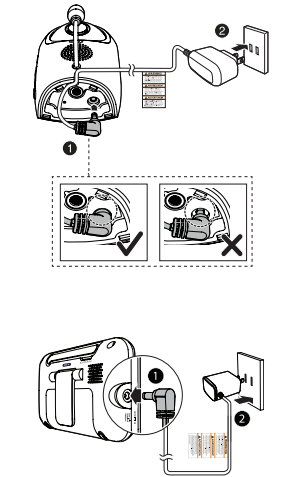

### Charge the parent unit battery

When you have connected the parent unit and installed its battery for the first time or after power outage, the parent unit powers on automatically. The battery icon indicates the battery status (see the following table).

#### NOTES

- The parent unit battery is fully charged after 3 hours of continuous charging.
- It takes longer to charge the battery when the parent unit is turned on. To shorten the charging time, turn the parent unit off while charging.
- The standby time varies depending on the sensitivity level you set, your actual use and the age of the battery.

Battery indicators	Battery status	Action
The battery icon is off and displays.	No battery is installed but operates using AC power, or the battery has been installed incorrectly.	Install the parent unit battery. Charge without interruption (at least 30 minutes).
The screen displays <b>Battery low at Parent Unit</b> and the light flashes.	The battery has very little charge and may be used for only a short time.	Charge without interruption (about 30 minutes).
The battery icon becomes solid.	The battery is fully charged.	To keep the battery charged, connect it to AC power when not in use.

### Before use

#### NOTE

- This baby monitor is intended as an aid. It is not a substitute for proper adult supervision, and should not be used as such.

### Test your baby monitor

You may test the baby monitor before initial use, and at regular times thereafter.

#### CAUTION

- For hearing protection, make sure the parent unit is more than 1 meter (3 feet) away from the baby unit. If you hear any high-pitched noise, move the parent unit further until the noise stops. You can also press **VOL** on the parent unit to lower or mute the noise.

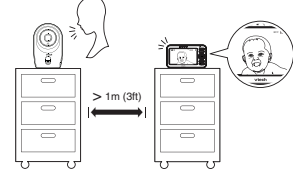

- Make sure your baby units and parent unit are on.
- The parent unit displays images from the baby unit.
  - Speak towards the baby unit microphone. You will hear the sound at the parent unit.
- If you have two baby units, press **VIEW** on your parent unit. The screen switches to the other baby units. Then, repeat step 2.

#### NOTE

- When the parent unit displays **No link to CAM #** (# represents the selected baby unit number), and the **LINK** LED light flashes, move the parent unit closer to the baby unit (observe the minimum distance of 1 meter/3 feet). You can also check if the baby monitor is connected to a live power socket and switched on.

#### TIP

- Increase the parent unit speaker volume if you cannot hear the sounds transmitted from the baby unit.

### Positioning the baby monitor

#### CAUTION

- Keep the baby units out of the reach of your baby. Never place or mount the baby units inside the baby's crib or playpen.

#### NOTE

- To avoid interference from other electronic devices, place your baby monitor far away from devices such as wireless routers, microwaves, cell phones and computers.

- Place the baby units more than 1 meter (3 feet) away from your baby.

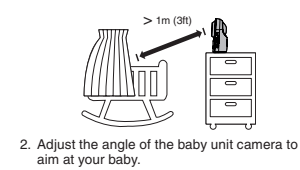

- Adjust the angle of the baby unit camera to aim at your baby.

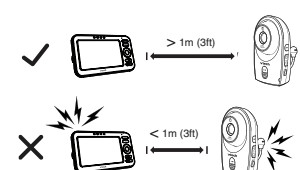

#### CAUTION

- The default volume of your parent unit is level 4. If you experience high-pitched screeching noise from your baby monitor while positioning:
  - Make sure your baby units and parent unit are more than 1 meter (3 feet) apart. OR
  - Turn down the volume of your parent unit.

### Operating range

The operating range of the baby monitor is up to 300 meters (1,000 feet) outdoors or 50 meters (160 feet) indoors. The actual operating range may vary depending on the environmental conditions and other interferences such as walls, doors and other obstructions.

### Install the lens (optional)

The wide-angle lens (VM101) provided allows you to view more of your baby's room from the parent unit screen. Install the wide-angle lens onto the baby unit camera as shown below.

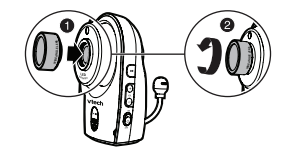

### Remove the lens

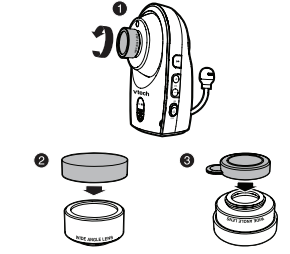

#### NOTES

- When the lens is not in use, cover both sides of the lens with the lens covers provided to avoid scratches.
- You can purchase and install an extra new wide-angle lens (VM101) onto your baby unit if necessary.

### Overview

#### Baby unit overview

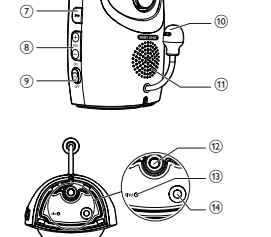
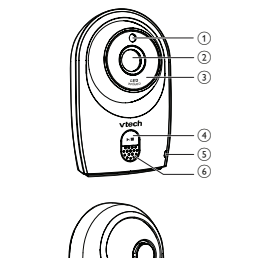

1	<b>Light sensor</b>
2	<b>Camera</b>
3	<b>Infrared LEDs</b>
4	<b>Play/Stop</b> Press to play or stop lullaby on the baby unit.
5	<b>ON/OFF light</b> On when the baby unit is turned on. Flashes when the baby unit is not being viewed, or when the link to the parent unit is lost.
6	<b>Microphone</b>

7	<b>Skip</b> Press to play the next lullaby.
8	<b>+VOL/-VOL</b> Press to adjust the speaker volume. It determines the lullaby volume and talkback volume transmitted from parent unit.
9	<b>ON/OFF switch</b> Slide to turn on or off the baby unit.
10	<b>Temperature sensor</b>
11	<b>Speaker</b>
12	<b>Threaded socket</b> For wall mount installation use.
13	<b>PAIR</b> Your baby units and parent unit provided are already paired.
14	<b>Power jack</b>

#### Parent unit overview

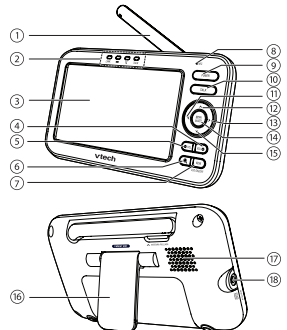

1	<b>Antenna</b>
2	<b>LED lights</b> Indicate the different statuses of the parent unit. For details, refer to <b>Parent unit lights</b> .

3	<b>LCD Display</b>
4	<b>VOL</b> Press to increase the parent unit speaker volume.
5	<b>VOL</b> Press to decrease the parent unit speaker volume.
6	<b>Q</b> Press to zoom in or out while viewing image in <b>Single CAM</b> or <b>Patrol mode</b> .
7	<b>VIEW / LCD ON/OFF</b> Press and hold to turn off the parent unit screen. Press to view the image of the next baby unit in <b>Single CAM</b> or <b>Patrol mode</b> .
8	<b>Microphone</b>
9	<b>POWER</b> Press and hold to power on. Press and hold again to power off.
10	<b>TALK</b> Press and hold to talk to the selected baby unit in <b>Single CAM</b> or <b>Patrol mode</b> .
11	<b>Left Arrow</b> While in a menu, press to return to the main menu or idle screen. While viewing zoomed image, press and hold to move the zoomed image leftward. While in <b>Split mode</b> , press to move the selection box leftward.
12	<b>Up Arrow</b> While in a menu, press to scroll up. While viewing zoomed image, press and hold to move the zoomed image upward. While in <b>Split mode</b> , press to move the selection box upward.

13	<b>Right Arrow</b> While in a menu, press to choose an item. While viewing zoomed image, press and hold to move the zoomed image rightward. While in <b>Split mode</b> , press to move the selection box rightward.
14	<b>MENU/SELECT</b> Press to enter the menu. While in a menu, press to choose an item, or save a setting.
15	<b>Down Arrow</b> While in a menu, press to scroll down. While viewing zoomed image, press and hold to move the zoomed image downward. While in <b>Split mode</b> , press to move the selection box downward.
16	<b>Stand</b>
17	<b>Speaker</b>
18	<b>Power jack</b>

#### Parent unit lights

<b>LINK</b>	On when the parent unit is linked to the baby unit. Flashes when the link to the baby unit being viewed in <b>Single CAM</b> or <b>Patrol mode</b> is lost; or when the link to both baby units being viewed in <b>Split mode</b> is lost.
<b>Charging</b>	On when the parent unit is connected to AC power, or the battery is charging. Flashes when the parent unit battery is low and needs charging. Off when the parent unit is disconnected from AC power.
<b>Speaker</b>	On when the speaker volume of the parent unit is turned off.
<b>TALK</b>	On when the parent unit is talking to the baby unit.

#### Parent unit display icons

<b>Connection status</b>	<b>Full Signal</b> displays when strong signal strength is detected between the baby unit and the parent unit. <b>Partial Signal</b> or <b>Low Signal</b> displays when moderate or low signal strength is detected between the baby unit and the parent unit. <b>Y</b> displays when the link between the baby unit and the parent unit is lost.
<b>Lullaby</b>	Displays when the baby unit being viewed is playing lullaby.
<b>Current view status</b>	Displays the number of the baby unit that is being viewed when in <b>Single CAM</b> and <b>Patrol mode</b> . Displays the number of the highlighted baby unit when in <b>Split mode</b> .
<b>Patrol mode</b>	Displays when the parent unit is in <b>Patrol mode</b> .
<b>Split mode</b>	Displays when the parent unit is in <b>Split mode</b> .
<b>Night vision</b>	Displays when the baby unit being viewed has activated the night vision feature.
<b>Zoom</b>	Displays when the baby unit camera has zoomed in.
<b>Temperature alert tone</b>	Displays when the temperature alert tone is set on.
<b>Real-time temperature</b>	Displays the real-time temperature detected by the baby unit in Fahrenheit (°F) or Celsius (°C) (e.g. 57 °F or 14 °C).

<b>Mute alert</b>	Displays when the parent unit speaker volume is set to off. Displays when <b>Split mode</b> is turned on.
<b>9-level sound indicator</b>	(1 to 3 bars) indicates low sound level detected by the baby unit. (4 to 6 bars) indicates moderate sound level detected by the baby unit. (7 to 9 bars) indicates high sound level detected by the baby unit (e.g. baby crying loudly).
<b>Speaker volume</b>	Displays the parent unit speaker volume level while adjusting.
<b>Battery status</b>	<b>Charging</b> animates when the battery is charging. <b>Full</b> displays solid when the battery is fully charged. <b>Low</b> displays when the battery is low and needs charging.
<b>AC power without battery</b>	Displays when the parent unit is connected to AC power without the battery.

#### Parent unit main menu icons

<b>Monitoring Mode</b>	You can select a monitoring mode ( <b>Single CAM</b> , <b>Patrol</b> or <b>Split</b> ).
<b>Alert Tone</b>	You can set the parent unit to beep when: the parent unit operates in low battery condition; the link between the parent unit and the baby unit is lost; or the baby unit detects sounds while in <b>Split mode</b> .
<b>Language</b>	You can select a language (English, French or Spanish) to be used in all screen displays.

<b>LCD</b>	You can change the brightness of the parent unit screen, or turn on the <b>Dim Mode</b> to save power.
<b>Rename</b>	You can choose a specific name for the baby unit from a pre-defined name list.
<b>VOX sensitivity</b>	With this feature, you can choose to hear sounds from the baby unit all the time, or to hear sounds that exceed a certain level. You can use the parent unit to adjust the microphone sensitivity of your baby unit. The higher the sensitivity level, the more sensitive the baby unit is in detecting sounds for transmitting to the parent unit.
<b>Sound-activated Screen</b>	Automatically turns on the parent unit screen when a baby unit detects a sound after the screen is turned off. When no sound is detected, the screen is automatically off to save power.
<b>Temperature alert tone</b>	You can turn on the <b>Temperature alert tone</b> so that the parent unit beeps whenever the room temperature detected by the baby unit falls outside of the desired temperature range.
<b>Lullaby on CAM</b>	You can choose a lullaby or soothing sound to comfort your baby.
<b>Volume on CAM</b>	You can adjust the volume of baby units which determines the lullaby volume and talkback volume transmitted from parent unit.
<b>Vibration</b>	You can turn on the vibration alert so that the parent unit vibrates when it receives <b>No link alert</b> , <b>Sound alert in split-view</b> or <b>Temperature alert tone</b> after turning on the respective alert tones.

#### Parent unit display messages

<b>No link to CAM #</b>	The selected baby unit is out of range or is turned off.
<b>Battery low at Parent Unit</b>	The battery level of the parent unit is very low and needs to be recharged.
<b>Battery empty. Powering off ...</b>	The battery is empty and needs to be recharged.
<b>Sound detected at CAM #</b>	The sound level exceeds the threshold at CAM # in <b>Split mode</b> .
<b>Temperature too high at CAM #</b> or <b>Temperature too low at CAM #</b>	The temperature detected by the baby unit is higher/lower than the desired temperature alert range.
<b>Powering on...</b>	The parent unit is turning on.
<b>Auto Timer of lullaby is reset</b>	The auto timer for playing lullaby is reset.

# represents the selected baby unit number.

#### Using the baby monitor

##### Power on or off the baby unit

- Slide **ON/OFF** LED light turns on.
- Slide **ON/OFF** LED light turns off.

##### Power on or off the parent unit

- Press **POWER** to turn on the parent unit. The screen turns on.
- Press and hold **POWER** again to turn off the parent unit. The screen turns off.

#### Turn on or off the parent unit screen

You can turn on or off the parent unit screen without powering off the parent unit. You can still hear sound from the baby units.

- Press and hold **LCD ON/OFF** on the parent unit to turn off the screen.
- Press any key on the parent unit to turn on the screen again.

#### Adjust speaker volume

**For parent unit:**  
Press **VOL** or **VOL** on the parent unit at any time when viewing images.

**For baby unit:**  
The baby unit speaker volume determines the lullaby volume and talkback volume transmitted from parent unit.

- Press **-VOL +** on the baby unit to adjust the speaker volume.

The volume can also be adjusted in the parent unit. Level 1 is the softest while Level 5 is the loudest.

- Press **MENU** when the parent unit is idle.
- Press **V** or **A** to choose **Volume on CAM**, then press **SELECT**.
- Press **V** or **A** to choose the desired volume level, then press **SELECT** to confirm your selection.

#### Lullaby

The baby monitor has five lullabies and four soothing sounds for you to comfort your baby.

#### To play lullaby or soothing sound on the baby unit:

- Press **Play/Stop** on the baby unit to play lullaby.
- Press **Play/Stop** on the baby unit to switch to the other lullabies.

#### Adjust speaker volume

- Press **V** or **A** again to stop the lullaby.
- Press **-VOL +** to adjust the volume level of the lullaby on the baby unit.

#### To play lullaby using the parent unit:

- Press **MENU** when the parent unit is idle.
- Press **V** or **A** to choose **Lullaby on CAM**, then press **SELECT**.
- Press **V** or **A** to choose **Play Melodies**, then press **SELECT**.
- Press **V** or **A** to choose a lullaby, or choose **Play All**, then press **SELECT**.  
If **Play All** is selected, the five lullabies will be played one after the other, until all of them are played.

- When the desired lullaby is selected, press **V** or **A** to choose **Play**, then press **SELECT**.

#### To play soothing sound using the parent unit:

- You can play soothing sound on the baby unit by controlling remotely with the parent unit.
- Press **MENU** when the parent unit is idle.
- Press **V** or **A** to choose **Lullaby on CAM**, then press **SELECT**.
- Press **V** or **A** to choose **Play Soothing Sounds**, then press **SELECT**.
- Press **V** or **A** to choose a soothing sound, then press **SELECT**.
- Press **V** or **A** to choose **Play**, then press **SELECT**.

#### To play soothing sound on the baby unit:

- You can play soothing sound on the baby unit by controlling remotely with the parent unit.
- Press **MENU** when the parent unit is idle.
- Press **V** or **A** to choose **Lullaby on CAM**, then press **SELECT**.
- Press **V** or **A** to choose a soothing sound, then press **SELECT**.
- Press **V** or **A** to choose **Play**, then press **SELECT**.

#### To set auto timer for lullaby:

- While the baby unit is playing lullaby or soothing sound, the auto timer feature helps you automatically stop the lullaby or soothing sound after playing for 15/30/45/60 minutes. You can set auto timer for lullaby with the parent unit.
- Press **MENU** when the parent unit is idle.
- Press **V** or **A** to choose **Lullaby on CAM**, then press **SELECT**.



- Press **V** or **A** to choose **Auto Timer**, then press **SELECT**.
- Press **V** or **A** to choose the desired lullabies duration, then press **SELECT** to confirm your selection.

After 15/30/45/60 minutes, the lullaby or soothing sound will stop automatically.

### Set the language

You can select a language (English, French or Spanish) to be used in all screen displays.

- Press **MENU** when the parent unit is idle.
- Press **V** or **A** to choose **Language**, then press **SELECT**.
- Press **V** or **A** to choose **English, Français or Español**, then press **SELECT** to confirm your selection.

### Adjust LCD brightness

You can change the brightness of the parent unit screen from **Level 1** to **Level 5**. The LCD brightness is preset to **Level 3**.

- Press **MENU** when the parent unit is idle.
- Press **V** or **A** to choose **LCD**, then press **SELECT**.
- Press **SELECT** again to choose **Brightness**.
- Press **V** or **A** to choose the desired level of brightness, then press **SELECT** to confirm your selection.

### Turn on or off the dim mode

The dim mode is preset to on to help you save the parent unit power. Whenever the parent unit has been left idle for 10 minutes while the screen is still on, the screen will be dimmed automatically to save power.

- Press **MENU** when the parent unit is idle.
- Press **V** or **A** to choose **LCD**, then press **SELECT**.
- Press **V** or **A** to choose **Dim Mode**, then press **SELECT**.
- Press **V** or **A** to choose **On** or **Off**, then press **SELECT** to confirm your selection.

⚠NOTES

- While the screen is dimmed, any keypad or alert message will trigger the screen to return to the preset brightness level. After 10 minutes of idle, it will be dimmed again.

- Do not allow anything to rest on the power cords. Do not install this product where the cords may be walked on or crimped.
- This product should be operated only from the type of power source indicated on the marking label. If you are not sure of the type of power supply in your home, consult your dealer or local power company.
- Do not overload wall outlets or use an extension cord.
- Do not place this product on an unstable table, shelf, stand or other unstable surfaces. This product should not be placed in any area where proper ventilation is not provided. Slots and openings in the back or bottom of this product are provided for ventilation. To protect them from overheating, these openings must not be blocked by placing the product on a soft surface such as a bed, sofa or rug. This product should never be placed near or over a radiator or heat register.
- Never push objects of any kind into this product through the slots because they may touch dangerous voltage points or create a short circuit. Never spill liquid of any kind on the product.
- To reduce the risk of electric shock, do not disassemble this product, but take it to an authorized service facility. Opening or removing parts of the product other than specified accessories may expose you to dangerous voltages or other risks. Incorrect reassembling can cause electric shock when the product is subsequently used.
- You should test the sound reception every time you turn on the units or move one of the components.
- Periodically examine all components for damage. Be aware of possible loss of privacy while using product airwaves. Conversations may be picked up by other nursery monitors, cordless phones, scanners, etc.
- Children should be supervised to ensure that they do not play with the product.
- The product is not intended for use by persons (including children) with reduced physical, sensory or mental capabilities, or lack of experience and knowledge, unless they have been given supervision or instruction concerning use of the appliance by a person responsible for their safety.

### SAVE THESE INSTRUCTIONS

- Use and store the product at a temperature between 32°F and 104°F.
- Do not expose the product to extreme cold, heat or direct sunlight. Do not put the product close to a heating source.
- Batteries should not be exposed to excessive heat such as bright sunshine or fire.
- Make sure the baby unit(s) and the adapter cord(s) are always out of reach of the baby, at least 3 feet away from the baby or crib, to avoid a possible strangulation hazard.

### Adjust the sound sensitivity of the baby unit

You can choose to hear sounds from the baby unit all the time, or to hear sounds that exceed a certain level. You can use the parent unit to adjust the microphone sensitivity of your baby unit. The higher the VOX sensitivity level, the more sensitive the baby unit is in detecting sounds for transmitting to the parent unit. The VOX sensitivity level is preset to **HIGHEST**.

Sensitivity Level		Description
<b>Highest</b>	High sensitivity	<b>Highest VOX sensitivity level</b> <p>The parent unit speaker is constantly on, and you will hear all sounds (including background noises) from your baby's room.</p>
<b>High</b>		<b>High VOX sensitivity level</b> <p>The parent unit speaker turns on for soft babbling and louder sounds from your baby. It remains quiet when your baby sleeps soundly.</p>
<b>Medium</b>		<b>Medium VOX sensitivity level</b> <p>The parent unit speaker turns on for loud babbling and louder sounds from your baby. It remains quiet when your baby makes soft sounds.</p>
<b>Low</b>		<b>Low VOX sensitivity level</b> <p>The parent unit speaker turns on for crying and louder sounds from your baby. It remains quiet when your baby makes soft sounds.</p>
<b>Lowest</b>	Low sensitivity	<b>Lowest VOX sensitivity level</b> <p>The parent unit speaker turns on for loud crying or screaming sounds from your baby. It remains quiet when your baby makes soft sounds.</p>

- Press **MENU** when the parent unit is idle.
- Press **V** or **A** to choose **VOX sensitivity**, then press **SELECT**.
  - If you have two baby units, the system prompts you to choose the desired baby unit or both baby units, press **V** or **A** to choose **ALL CAM** or **CAM #**, then press **SELECT**.
- Press **V** or **A** to choose **Dim Mode**, then press **SELECT**.
- Press **V** or **A** to choose **On** or **Off**, then press **SELECT** to confirm your selection.

⚠NOTES

- While the screen is dimmed, any keypad or alert message will trigger the screen to return to the preset brightness level. After 10 minutes of idle, it will be dimmed again.

- Never place the baby unit(s) inside the baby's crib or playpen. Never cover the baby unit(s) or parent unit with anything such as a towel or a blanket.
- Other electronic products may cause interference with your baby monitor. Try installing your baby monitor as far away from these electronic devices as possible: wireless routers, radios, cellular telephones, intercoms, room monitors, televisions, personal computers, kitchen appliances and cordless telephones.

#### Precautions for users of implanted cardiac pacemakers

- Cardiac pacemakers (apples only to digital cordless devices):
- Wireless Technology Research, LLC (WTR), an independent research entity, led a multidisciplinary evaluation of the interference between portable wireless devices and implanted cardiac pacemakers. Supported by the U.S. Food and Drug Administration, WTR recommends to physicians that:
- Pacemaker patients**
- Should keep wireless devices at least six inches from the pacemaker.
  - Should NOT place wireless devices directly over the pacemaker, such as in a breast pocket, when it is turned ON.

WTR's evaluation did not identify any risk to bystanders with pacemakers from other persons using wireless devices.

#### Electromagnetic fields (EMF)

This Vtech product complies with all standards regarding electromagnetic fields (EMF). If handled properly and according to the instructions in this user's manual, the product is safe to be used based on scientific evidence available today.

## The RBRC® seal

The RBRC® seal on the lithium-ion battery indicates that VTech Communications, Inc. is voluntarily participating in an industry program to collect and recycle these batteries at the end of their useful lives, when taken out of service within the United States and Canada.

The RBRC® program provides a convenient alternative to placing used lithium-ion batteries into the trash or municipal waste, which may be illegal in your area.

VTech's participation in RBRC® makes it easy for you to drop off the spent battery at local retailers participating in the RBRC® program or at authorized VTech product service centers. Please call **1 (800) 8 BATTERY®** for information on Li-Ion battery recycling and disposal bans/restrictions in your area. VTech's involvement in this program is part of its commitment to protecting our environment and conserving natural resources.

- Press **V** or **A** to choose the desired VOX sensitivity level, then press **SELECT** to confirm your selection.

⚠TIP

- You can adjust the baby unit placement to improve the sound detection.

### Turn on or off the sound activation

When sound activation is on, as long as no sound is detected within 50 seconds, the parent unit screen will turn off automatically to save power.

When your baby unit detects a sound, the sound activation triggers the parent unit screen to turn on automatically. When no sound is detected within 50 seconds, the screen will be off again.



- Press **MENU** when the parent unit is idle.
- Press **V** or **A** to choose **Sound-activated Screen**, then press **SELECT**.
- Press **V** or **A** to choose **On** or **Off**, then press **SELECT** to confirm your selection. The screen returns to main menu.

⚠NOTES

- Sound activation is available in **Single CAM** and **Patrol** mode only.
- If the sound sensitivity is set to **Highest**, the parent unit screen may remain on continuously even though sound activation is on.

### Monitoring mode

Every time the parent unit is turned on, it displays a baby unit in **Single CAM** mode. If there are two baby units in your system, you can also monitor your baby in **Patrol** or **Split** mode.

<b>Single CAM</b>	The screen displays a single baby unit in full screen.
<b>Patrol</b> 	A single cam view that transmits to a different baby unit every 10 seconds.
<b>Split</b> 	The screen displays all baby units.

You can choose the desired monitoring mode.

- Press **MENU** when the parent unit is idle.
- Press **V** or **A** to choose **Monitoring Mode**, then press **SELECT**.

- Press **V** or **A** to choose **Single CAM, Patrol** or **Split**, then press **SELECT**.

In **Single CAM** or **Patrol** mode:

- Press **VIEW** to view the next baby unit.



**No link alert**
You can set the parent unit to beep when the link between the parent unit and the baby unit is lost.

- Press **MENU** when the parent unit is idle.
- Press **V** or **A** to choose **Alert Tone**, then press **SELECT**.
- Press **V** or **A** to choose **No Link Alert**, then press **SELECT**.
- Press **V** or **A** to choose **On** or **Off**, then press **SELECT** to confirm your selection. It returns to **Split** mode after 10 seconds.

In **Split** mode:

- Press **A**, **V**, **<** or **>** to select a baby unit.
- Press **Q** or **VIEW** key to view the selected baby unit temporarily in **Single CAM** mode. It returns to **Split** mode after 10 seconds.

⚠NOTE

- The parent unit is muted while in **Split** mode.

### Zoom

You can zoom in or out while viewing image from baby unit in **Single CAM** and **Patrol** mode.

- Press **Q** to zoom in.
- Press **and hold A**, **V**, **<** or **>** to move the zoomed image upward, downward, leftward or rightward correspondingly.
- Press **Q** again to zoom out.

### Talk

You can use the **TALK** function of the parent unit to comfort your baby in **Single CAM** and **Patrol** mode.

- Press and hold TALK** on the parent unit. The **TALK** light turns on.
- Speak towards the microphone on the parent unit. Your voice is broadcast to the baby unit.
- Release the **TALK** key to stop the broadcast. The **TALK** light goes off.

**Set temperature range**
You can set the desired room temperature alert range. The minimum temperature can be set between **52 °F (11 °C)** and **69 °F (20 °C)**.

### Set alert tone

#### Low battery tone

You can set the parent unit to beep when the parent unit operates in low battery condition.

- Press **MENU** when the parent unit is idle.
- Press **V** or **A** to choose **Alert Tone**, then press **SELECT**.
- Press **SELECT** again to choose **Low Battery Tone**.
- Press **V** or **A** to choose **On** or **Off**, then press **SELECT** to confirm your selection.

#### No link alert

You can set the parent unit to beep when the link between the parent unit and the baby unit is lost.

- Press **MENU** when the parent unit is idle.
- Press **V** or **A** to choose **Alert Tone**, then press **SELECT**.
- Press **V** or **A** to choose **No Link Alert**, then press **SELECT**.
- Press **V** or **A** to choose **On** or **Off**, then press **SELECT** to confirm your selection.

#### Sound alert in split-view

You can turn on the sound alert feature so that, while in **Split** mode, the parent unit beeps and displays **Sound detected at CAM #** whenever the baby unit detects sounds.

- Press **MENU** when the parent unit is idle.
- Press **V** or **A** to choose **Alert Tone**, then press **SELECT** to select.
- Press **V** or **A** to choose **Sound Alert in Split-View**, then press **SELECT**.
- Press **V** or **A** to choose **On** or **Off**, then press **SELECT** to confirm your selection.

⚠NOTE

- The sound alert feature is only available in **Split** mode.

### Monitor the temperature

Your baby unit monitors the temperature of your baby's room with its built-in temperature sensor. If the detected temperature is outside of the preset temperature range, the parent unit will display alert message.

**Set temperature range**
You can set the desired room temperature alert range. The minimum temperature can be set between **52 °F (11 °C)** and **69 °F (20 °C)**.

The maximum temperature can be set between **70 °F (21 °C)** and **86 °F (30 °C)**.

- Press **MENU** when the parent unit is idle.
- Press **V** or **A** to choose **Temperature**, then press **SELECT**.
- Press **V** or **A** to choose **Minimum** or **Maximum**, then press **SELECT**.
  - If you have two baby units, the system prompts you to choose the desired baby unit or both baby units, press **V** or **A** to choose **ALL CAM** or **CAM #**, then press **SELECT**.
- Press **V** or **A** to choose the desired minimum or maximum temperature, then press **SELECT** to confirm your selection.

#### Temperature alert tone

You can turn on the temperature alert tone so that the parent unit will emit an alert tone if the detected temperature is out of range.

- Press **MENU** when the parent unit is idle.
- Press **V** or **A** to choose **Temperature**, then press **SELECT**.
- Press **V** or **A** to choose **Alert Tone**, then press **SELECT**.
  - If you have two baby units, the system prompts you to choose the desired baby unit or both baby units, press **V** or **A** to choose **ALL CAM** or **CAM #**, then press **SELECT**.
- Press **V** or **A** to choose **On** or **Off**, then press **SELECT** to confirm your selection.

**Temperature format**
You can choose to display the temperature in Fahrenheit (°F) or Celsius (°C).

- Press **MENU** when the parent unit is idle.
- Press **V** or **A** to choose **Temperature**, then press **SELECT**.
- Press **V** or **A** to choose **Format**, then press **SELECT**.
- Press **V** or **A** to choose **°F** or **°C**, then press **SELECT** to confirm your selection.

**Turn on or off the vibration**
You can turn on the vibration feature so that the parent unit vibrates when it receives any of the following alerts: **Sound alert in split-view** or **Temperature alert tone** after turning on the respective alert tones.

- Press **MENU** when the parent unit is idle.

- Press **V** or **A** to choose **Vibration**, then press **SELECT**.
- Press **V** or **A** to choose **On** or **Off**.
- Press **SELECT** to confirm your selection.

### Rename the baby units

You can rename each baby unit. Once the baby unit is renamed, its new name together with the baby unit number will appear in the sub-menu of below options:

- VOX sensitivity
- Rename
- Temperature

- Press **MENU** when the parent unit is idle.
- Press **V** or **A** to choose **Rename**, then press **SELECT**.
- Press **V** or **A** to choose the desired baby unit, then press **SELECT**.
- Press **V** or **A** to choose the desired name for the baby unit, then press **SELECT** to confirm your selection.

### Night vision

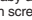
The baby unit has infrared LEDs that allow you to see your baby clearly at night or in a dark room. When the baby unit is viewed detects low light levels, the infrared LEDs are switched on automatically. The image from this baby unit is in black and white, and  appears on screen.

⚠NOTES

- It is normal if you see a short white glare on your parent unit screen as the baby unit is adapting to the dark environment.

- When the infrared LEDs are on, the image is in black and white. This is normal due to external light sources.

- ⚠TIP
  - Depending on the surroundings and other interfering factors like lights, objects, colors and backgrounds, the display resolution may vary. Adjust the baby unit's angle or place the baby unit at a higher level to prevent glare and blurry display.

## General product care

To keep this product working well and looking good, follow these guidelines:

- Avoid putting it near heating appliances and devices that generate electrical noise (for example, motors or fluorescent lamps).
- DO NOT expose it to direct sunlight or moisture.
- Avoid dropping the product or treating it roughly.
- Clean with a soft cloth.

- DO NOT immerse the parent unit and the baby unit in water and do not clean them under the tap.
- DO NOT use cleaning spray or liquid cleaners.
- Make sure the baby unit and parent unit are dry before you connect them to the mains again.

## Storage

When you are not going to use the baby monitor for some time, remove the rechargeable battery from the parent unit. Store the parent unit, the baby unit and the adapters in a cool and dry place.

## Frequently asked questions

Below are the questions most frequently asked about the baby monitor. If you cannot find the answer to your question, visit our website at [www.vtechphones.com](http://www.vtechphones.com), or contact **1 (800) 595-9511** for customer service.

Why does the baby monitor not respond normally?	Try the following (in the order listed) for common cure: <ol style="list-style-type: none"><li>Disconnect the power to the baby units and the parent unit.</li> <li>Remove the batteries in the parent unit. Then install the batteries again.</li> <li>Wait a few seconds before connecting power back to the baby units and the parent unit.</li> <li>Turn on the baby units and the parent unit.</li> <li>Wait for the parent unit to synchronize with the baby units. Allow up to one minute for this to take place.</li></ol>
Why don't the power-on light of the baby unit and parent unit go on when I switch on the units?	Perhaps the parent unit is not connected to the mains. Insert the appliance plug into the parent unit and put the adapter in a wall socket. Then press and hold <b>POWER</b> to switch on the parent unit and to establish connection with the baby unit. <p>Perhaps the baby unit is not connected to the mains. Connect the baby unit to the mains. Then set the <b>ON/OFF</b> switch to <b>ON</b> to establish connection with the parent unit.</p>
Why doesn't my parent unit charge while on AC power?	Make sure the power is not controlled by a wall switch. <p>Make sure the battery is correctly installed in your parent unit.</p> <p>You may have used the battery for a long time. Replace a new battery.</p>

Why is my screen in black and white?	The screen is in black and white during nighttime or in a dark room. This is normal due to external light sources.
Why do I get glare or blurry display on my screen when viewing my baby at night?	During nighttime or in a dark room, the surroundings and other interfering factors, like lightings, objects, colors and backgrounds, may affect the image quality on your parent unit screen. Adjust the baby unit's angle or place the baby unit at a higher level to prevent glare and blurry display.
Why does the baby monitor produce a high-pitched noise?	The parent unit and baby units may be too close to each other. <ul style="list-style-type: none"><li>Move the parent unit away from the baby units until the noise stops; OR</li> <li>Turn down the volume of your parent unit.</li></ul>
Why does the parent unit beep?	The baby units may be out of range. Move the parent unit closer to the baby units (but not less than 3 feet).
Why does the parent unit beep/vibrate frequently in Split mode?	If the parent unit is powered by the provided battery, it may not have enough charge for the parent unit to perform normal operation. Charge the battery in the parent unit for up to 3 hours.
Why does the parent unit beep/vibrate feature are turned on.	If your parent unit is in <b>Split</b> mode, some of your baby units may detect sounds.
Why does the parent unit beep/vibrate feature are turned on.	The temperature of your baby's room may be too high or too low.
Why does the parent unit hear a sound/ Why can't I hear my baby cry?	You may have set the sound sensitivity level to <b>Highest</b> when the sound alert (and vibration) feature are turned on. The parent unit notifies you of all sounds including background noise with beeps (and vibrations). Adjust the sound sensitivity to a lower level.
Why does the parent unit hear a sound/ Why can't I hear my baby cry?	The baby unit also picks up other sounds than those of your baby. Adjust the sensitivity level to a lower level or lower the parent unit speaker volume.
Why don't I hear a sound/ Why can't I hear my baby cry?	The parent unit speaker volume may be too low or off. Press <b>VOL</b>  to increase the volume.
Why doesn't my parent unit charge while on AC power?	You may have set a low sound sensitivity level. Adjust the <b>sound sensitivity of the baby unit</b> to set it to a higher level.

www.vtechcanada.com or call 1 (800) 267-7377.
NOTE: Before calling for service, please review the user's manual - a check of the Product's controls and features may save you a service call.

Except as provided by applicable law, you assume the risk of loss or damage during transit and transportation and are responsible for delivery or handling charges incurred in the transport of the Product(s) to the service location. VTech will return repaired or replaced Product under this limited warranty. Transportation, delivery or handling charges are prepaid. VTech assumes no risk for damage or loss of the Product in transit. If the Product failure is not covered by this limited warra nty, or proof of purchase does not meet the terms of this limited warranty, VTech will notify you and will request that you authorize the cost of repair prior to any further repair activity. You must pay for the cost of repair and return shipping costs for the repair of Products that are not covered by this limited warranty.

#### What must you return with the Product to get warranty service?

- Return the entire original package and contents including the Product to the VTech service location along with a description of the malfunction or difficulty; and
- Include a "valid proof of purchase" (sales receipt) identifying the Product purchased (Product model) and the date of purchase or receipt; and
- Provide your name, complete and correct mailing address, and telephone number.

**Credits:**
The *Background Noise* sound file was created by Caroline Ford, and is used under the Creative Commons license.
The *Stream Noise* sound file was created by Caroline Ford, and is used under the Creative Commons license.
The *Crickets At Night* sound file was created by Mike Koenig, and is used under the Creative Commons license.
The *Heart Beat* sound file was created by Zarabadeu, and is used under the Creative Commons license.

**Other limitations**
This warranty is the complete and exclusive agreement between you and VTech. It supersedes all other written or oral communications related to this Product. VTech provides no other warranties for this Product. The warranty exclusively describes all of VTech's responsibilities regarding the Product. There are no other express warranties. No one is authorized to make modifications to this limited warranty and you should not rely on any such modification.

State/Provincial Law Rights: This warranty gives you specific legal rights, and you may also have other rights, which vary from state to state or province to province.
Limitations: Implied warranties, including those of fitness for a particular purpose and merchantability (an unwritten warranty that the Product is fit for ordinary use) are limited to one year from the date of purchase. Some states/provinces do not allow limitations on how long an implied warranty lasts, so the above limitation may not apply to you. In no event shall VTech be liable for any indirect, special, incidental, consequential, or similar damages (including, but not limited to lost profits or revenue, inability to use the Product or other associated equipment, the cost of substitute equipment, and claims by third parties) resulting from the use of this Product. Some states/provinces do not allow the exclusion or limitation of incidental or consequential damages, so the above limitation or exclusion may not apply to you.

**Please retain your original sales receipt as proof of purchase.**

Why can't I establish a connection? Why is the connection lost every now and then? Why are there sound interruptions?	The baby units may be out of range. Move the parent unit closer to the baby units (observe the minimum distance of 1 meter/ 3 feet). <p>Other electronic products may cause interference with your baby monitor. Try installing your baby monitor as far away from these electronic devices as possible.</p>
---	--

## Important safety instructions

When using your equipment, basic safety precautions should always be followed to reduce the risk of fire, electric shock and injury, including the following:

- Follow all warnings and instructions marked on the product.
- Adult setup is required.
- This product is intended as an aid. It is not a substitute for responsible and proper adult supervision and should not be used as such.
- This product is not intended for use as a medical monitor.
- Do not use this product near water. For example, do not use it next to a bath tub, wash bowl, kitchen sink, laundry tub or swimming pool, or in a wet basement or shower.
- CAUTION:** Use only the batteries indicated in this manual. There may be a risk of explosion if a wrong type of battery is used for the parent unit. Use only the supplied rechargeable battery or replacement battery pack (BT198555/BT288555) for the parent unit. Do not dispose of batteries in a