

Installation options

3. To attach the mounting bracket for wall mounting, insert the tabs of the bracket into slots ⑤ and ⑥ on the telephone base, then press the other bracket tabs into slots ⑧ and ⑨ as shown on the right.
4. Plug the power adapter into an electrical outlet not controlled by a wall switch. Plug the telephone line cord into a telephone wall jack. To mount the telephone on the wall, position the mounting holes ⑩ and ⑪ over the telephone outlet mounting studs. Press and slide the bracket down firmly so the telephone is held securely on the telephone outlet mounting studs.

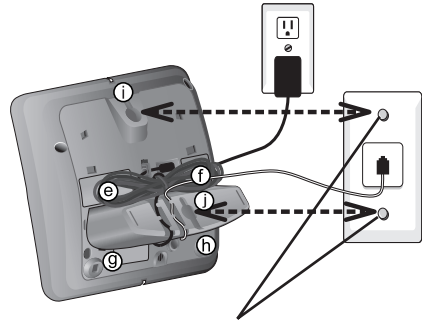

Telephone outlet mounting studs

Tabletop mounting

To change back from the wall mounting to tabletop mounting position, follow the directions below.

1. Remove the telephone base from the wall. Unplug the cords from the wall jacks. Remove the mounting bracket from the telephone base.
2. Insert the bracket tabs into slots ③ and ④ on the telephone base, then press the other bracket tabs into the slots ① and ②.

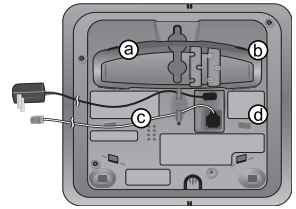
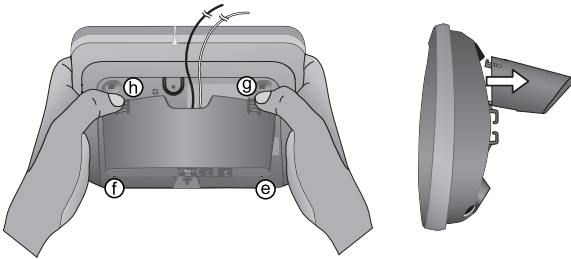

3. Route cords through slots. Plug the other end of the telephone line cord into a telephone wall jack. Plug the large end of the power adapter into an electrical outlet not controlled by a wall switch.

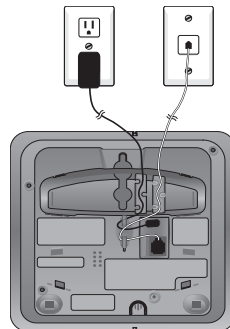

Belt clip & optional headset

Install belt clip as shown below if desired.

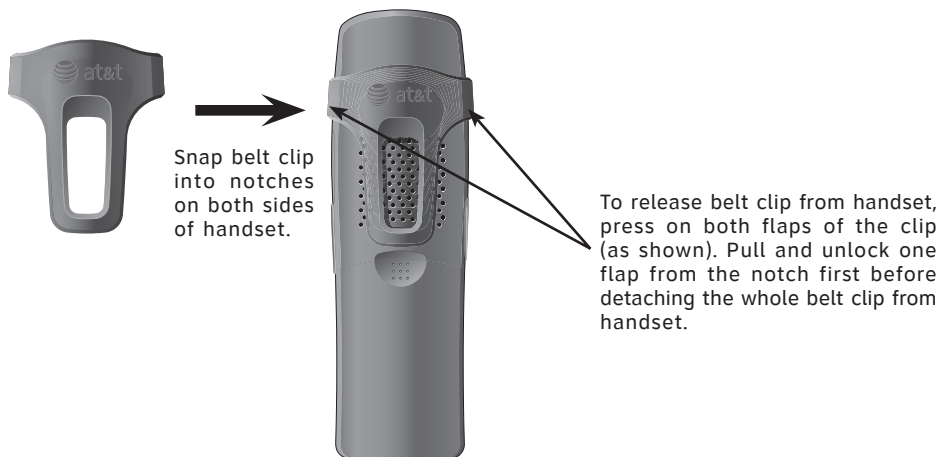

For handsfree telephone conversations, use any industry standard 2.5 mm headset (purchased separately). For best results, use an AT&T 2.5 mm headset. To purchase a headset, visit our website at www.telephones.att.com or contact our customer service representatives at 1 (800) 222-3111. In Canada, dial 1 (866) 288-4268.

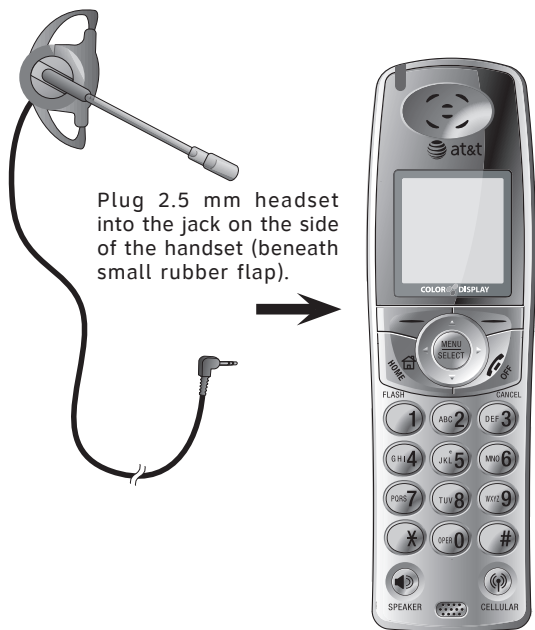



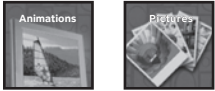
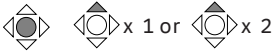

Handset screen images





Press the **SET** softkey or the center NavKey  to select the desired image.

The Pictures and Animations settings allow you to select an image or design as wallpaper for the background of the handset screen.

These images can also be programmed for individual callers in the directory so that different images will show when there are incoming calls from different callers (see page 31).



Press the center NavKey  to display the menu. Use the up or down NavKey  or  to highlight Animations or Pictures, then press the center NavKey  again to select this option.

Browse through the options using the up or down NavKey  or , then press the softkey set or center NavKey  to select an image.

To change the wallpaper display, repeat the above steps.

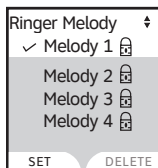
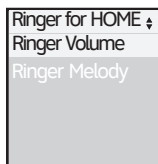
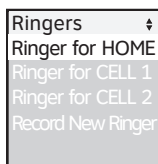
Handset ringers



Press the center NavKey  to enter the main menu, and press the up NavKey  three times to enter the Ringers menu, then press the center NavKey  to activate the menu.





Select the desired originating telephone line (**HOME**, **CELL 1**, **CELL 2**) by pressing the up or down NavKey  or  to highlight it.

When the desired originating telephone line (**HOME**, **CELL 1**, **CELL 2**) is highlighted, press the center NavKey  to confirm selection.



After selecting any option, press the center NavKey  or the softkey **SET** to confirm.

Ringer volume

At this menu, the ringer volume can be set between levels 1 and 6, or set the ringer off by pressing the **OFF** softkey so the telephone does not ring at all with incoming calls. When the ringer on the handset is turned off, the flashing icon  is shown on the screen of the handset.

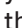

Press the left or down NavKey  or  to lower the ringer volume. Press the right or up NavKey  or  to increase the ringer volume. Press the **SET** softkey or the center NavKey to confirm your choice.

Ringer melody

This feature allows you to customize the ringers. The menu includes options for 8 ringer styles and 13 preloaded musical melodies. A sample of each ringer melody will be played when scrolling through the choices. Press the up or down NavKey  or  to change the ringer melody. Press the **SET** softkey or the center NavKey  to confirm.

- From the **Settings** menu, Press  three times to enter the **Ringer Melody** menu. Press the **SELECT** softkey to confirm.
- The system will start by showing the name and a sample of the current ringer melody.

Handset ringers

- Use  or  keys to scroll through the 8 ringer styles and musical melodies.
- Press the **SELECT** softkey to confirm. A confirmation tone will sound and **Choice saved** will be displayed briefly.



 **NOTE:** The microphone used when recording a ringer is located at the bottom front of the handset. If recording a tune, place the microphone about twelve inches from the music source. If recording a message, speak clearly from about twelve inches.



Record ringer

You can also customize the ringer by recording tunes or messages up to 15 seconds.

Press the **RECORD** softkey to start recording. The screen will show **Record ringer after tone**.

Start recording the new ringer after the tone. When finished recording, press the **STOP** softkey. Press the **PLAY** softkey to listen to the recorded ringer. Then press the **SAVE** softkey to enter the name of this recording using the table on page 30.

Enter up to ten characters for the name of this recording (See table on page 30). Press the **SAVE** softkey to save this ringer. The recording with the programmed name will then be added to the list of ringer melodies.

If neither the **SAVE** nor **PLAY** softkey is pressed, the new recording will be discarded.

More than one ringer can be recorded as long as there is recording time remaining. The total recording time can be extended if some of the preset musical ringers are deleted.

If there is not enough time left to record a new ringer, **Ringer memory full** will be displayed after pressing the **RECORD** softkey.

Messages



NOTES:



1. All incoming telephone messages are played in chronological order so the earliest new message is played first.



2. Unreviewed messages will not be deleted.

This menu enables you to listen to messages on the answering system using the cordless handset.

When there are new messages on the answering system, **New Message** will be displayed on the handset screen, the message icon  will flash alternately with the current time at the top left corner of the screen, the status light at the top left corner of the handset will flash and the **PLAY/STOP** light of the telephone base will also flash.

- Press the center NavKey  to enter the main menu.
- Press the down NavKey  twice to bring out the Messages menu.
- Press the center NavKey  to confirm.
- The screen will show the number of new messages and old messages.
- Press the **PLAY** softkey to play the new messages and memos.

The date and time the message is recorded will be announced by the voice prompt. The screen on the handset will show the date and time the memo and incoming messages are recorded, the length of the message, and a diagram of the NavKey illustrating how to repeat or skip a message. If it is a memo recorded on the answering machine, the word **Memo** will be shown on the screen.



Pressing the **STOP** softkey will exit to the **Messages** screen. Pressing the **DELETE** softkey when a message is playing will delete that particular message and advance to the next one.

When no message is being played, pressing the **DELETE** softkey will bring out the question whether you wish to delete old messages. Press the **NO** softkey if you prefer to keep all messages. Press the **YES** softkey if you wish to all delete old messages, keeping those which have not been reviewed.

You can also access the **Messages** menu by pressing the right  Navkey on the handset when it is idle.

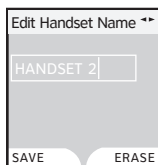
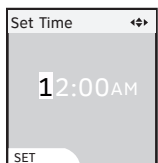
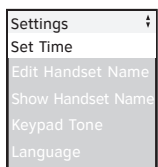
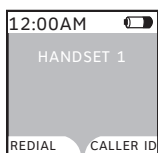





Handset settings



Press the center NavKey  to enter the main menu, then press the up NavKey  four times to reach the **Settings** menu. Press the center NavKey  to start the menu.

After selecting the desired option, press the center NavKey  to confirm.

Set time



Select this menu to set the time displayed on screen. You must enter four digits to input the time (e.g. 09:23). Using the dial pad, set the current time using the 12-hour clock format, or use the up or down NavKey  or  to enter the time, then use the left or right NavKey  or  to move to the next digit. Use the up or down NavKey  or  or the **2** or **7** on the dial pad to change the AM/PM entry. Press the center NavKey  or the **SET** softkey to confirm the setting and the correct time will be displayed on the screen.



NOTES:

1. The time is automatically set and updated with incoming caller ID information if you have this service (see page 6).
2. The date information is set on the telephone base only and cannot be set on the handsets.

Edit handset name

In the **Settings** menu, press the down NavKey  once to select this menu to set the handset name displayed on screen. Enter up to fifteen characters including spaces for the name of this handset. Use the right NavKey  to insert a space (see page 30). Press the **ERASE** softkey to delete the highlighted character. After entering the name of the handset, press the **SAVE** softkey or the center NavKey . A confirmation tone will sound.

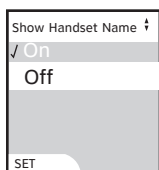
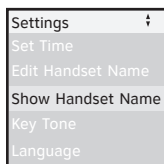

Handset settings







Show handset name

This menu allows you to decide whether the handset name should be shown on the screen of the handset.

From the idle mode, press the center NavKey  to enter the main menu.

Press the down NavKey  four times to reach the **Settings** menu. Press the center NavKey  to confirm selection.





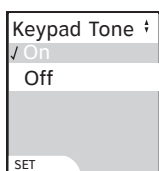

When the **Settings** menu is displayed, press the down NavKey  twice to reach **Show Handset Name**. Press the center NavKey  to confirm.

Use the up or down NavKey  or  to alternate between **On** and **Off**. Press the **SET** softkey or the center NavKey  to confirm selection. The screen will show **Choice saved** and return to the **Settings** menu.



Keypad tone

The handset is preset to beep with the pressing of each key. The keypad tones can be turned on or off in this menu.









- Press the center NavKey to enter the main menu. Press  four times to reach the **Settings** menu and press the center NavKey  to confirm.
- Press  three times to highlight **Keypad Tone** and press the center NavKey  to confirm.
- Use the  or  NavKey to select whether you prefer the keypad tone to be on or off.
- Press the **SET** softkey or the center  Navkey to confirm.
- The screen will show **Choice saved** to confirm the new setting and a confirmation tone will sound.

Handset settings

Language

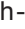



In this menu, you can select the language used in all menus and screen displays. The choices are English, Español and Français.



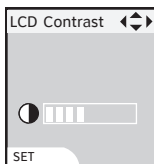

From the idle mode, press the center NavKey  to enter the main menu. Press the down NavKey  four times to reach the **Settings** menu and press the center NavKey  to confirm. Press the down NavKey  three times to highlight Language. Press the center NavKey  to confirm and the three languages (**English, Español and Français**) are displayed. Use the up or down NavKey  or  to highlight the desired language setting. Press the **SET** softkey or the center NavKey  to confirm and the screen will show **Choice saved**.

LCD Contrast



In this menu, you can adjust the screen contrast to suit different lighting conditions. Press the center NavKey  to activate the menu from the idle screen.

Press the up NavKey  four times to reach the **Settings** screen menu and press the center NavKey  to activate it.

Press the down NavKey  four times to reach **LCD Contrast** and press the center NavKey  to activate **Contrast setting**. Press the left or right NavKey  or  to adjust the level of screen contrast from 1 to 8. Press the **SET** softkey or the center NavKey  to confirm.

Handset settings

Clear Voice Mail

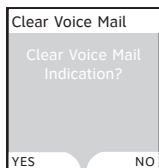

NOTES:

1. This procedure only turns off the displayed message, and it does not delete your voicemail message(s). This feature allows you to correct a voicemail indication which is out of sync with the local telephone company. If there actually is a new voice message, the local telephone company will continue to send the message which will then turn the display message back on.
2. Clearing the voicemail indication on the handset also turns off the voicemail indicator light on the telephone base.

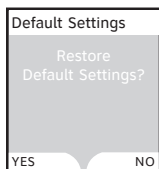

If you subscribe to voicemail services provided by the local telephone company, you will receive a text message on the handset when there is a new voicemail. After you have listened to these messages, the text message on the display should disappear automatically. In the event that the indication remains after you have listened to your local telephone company's voicemail messages, you can remove the indication according to the following steps.

- Press the center NavKey to enter the main menu.
- Press the down NavKey four times to enter the **Settings** menu. Press the center NavKey to confirm.
- Press the up NavKey three times to select **Clear Voice Mail**. Press the center NavKey to confirm.
- Press the **YES** softkey to delete voicemail indication.

Default settings

This menu allows you to restore the default settings for all menu settings on the handset. It will not clear the directory, call log, handset name, redial log, or messages.





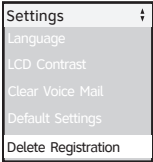

- Enter the main menu by pressing the center NavKey .
- Reach the **Settings** menu by pressing the down NavKey four times. Press the center NavKey to confirm.
- Press the up NavKey twice to go to **Default Settings**. Press the center NavKey to confirm.
- You will be prompted to **Restore Default Settings**. Select by pressing the **YES** or **NO** softkeys.
- If you press **YES**, **Default settings restored** will be restored and appeared on the screen.

Handset settings

Delete registration

A handset must be de-registered first before it can be registered to another telephone base.



- Press the center NavKey  on the handset.
- Press the up or down NavKey  or  four times for Settings.
- Press the center NavKey  to enter into the Settings menu.
- Press the up NavKey  once to select Delete Registration.
- Press the center NavKey  and you will be prompted to select **YES/NO** for handset de-registration.
- Press the **YES** softkey to proceed with de-registration or **NO** to cancel.
- After pressing the **YES** softkey, the screen will show **Handset Registration Deleted**, and then darkens and will remain blank.
- When the screen shows **Not Registered**, the de-registration process is complete.
- If you have to de-register more than one handset, but not all at one time, please repeat the above steps for each handset to be de-registered.

Base settings

Setting the date

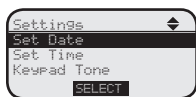







NOTE: This procedure also sets the time and date on the answering system. The incoming caller ID also updates the day and time on the telephone base.

- Press the **MENU** softkey.
- Press the down NavKey  four times to scroll to **Settings**.
- Press the **SELECT** softkey.
- When **Set Date** is displayed, press the **SELECT** softkey.
- Use the keypad to enter the year. The cursor will automatically advance to the next space for you to then enter the month and date. The system uses the YYYY/MM/DD format.
- Press the **SET** softkey to save the settings and a confirmation tone will sound. The correct date will be displayed briefly on the screen.

Setting the time



- Press the **MENU** softkey.
- Press the down NavKey  four times to scroll to **Settings**.
- Press the **SELECT** softkey.
- Press the down NavKey  once to set the time. Press the **SELECT** softkey to confirm. The system uses a 12-hour clock format.
- Use the keypad to enter the digits for the current hour. The cursor will automatically advance to the next space for entering the minutes. Press  or  to select AM and PM, or press 2 for AM and press 7 for PM.
- Press the left or right NavKey  or  to move the cursor to the left or right to correct any mistakes.
- Press the **SET** softkey to save the setting. A confirmation tone will sound and the correct time will be displayed briefly on the screen.