

**SPARX**  <sup>TM</sup>

**OPERATING MANUAL**

**CONTENTS**

---

**SAFETY**

**INTRODUCTION**

**SETUP**

**OPERATION**

**TROUBLESHOOTING**

**MAINTENANCE**

**WARRANTY**

# SAFETY PRECAUTIONS

- Before operating the Sparx™ Skate Sharpener you should familiarize yourself with the product and read and understand all applicable instructions and warnings in this manual.
- For emergencies: press the  **Cancel** button two times. This will stop the grinding ring in its place. Do not stop the grinding ring unless it is an emergency, as this may damage the skate blade.
- We do not recommend that children less than 13 years old be permitted to use the Sparx™ Skate Sharpener. Anyone who is less than 18 years old should be supervised by a qualified adult when using the Skate Sharpener.
- The Sparx™ Skate Sharpener may only be used for sharpening skates.
- Only Sparx™ grinding rings may be used with this machine.
- Set up the product securely on a stable surface and in a protected location. It must be placed where no one can step on or trip over the **Power Cord** and where the **Power Cord** cannot be damaged.
- Always use the Sparx™ Skate Sharpener in a dry, well lit, and non-condensing environment. To avoid the risk of electric shock, do not use the Sparx™ Skate Sharpener in wet or damp conditions.
- To avoid injury, always use caution when operating the Sparx™ Skate Sharpener, or when changing the grinding ring.
- Do not attempt to touch the grinding wheel, carriage, or **Skate Clamp** while the grinding wheel is moving. Wait for the carriage and grinding wheel to come to a complete stop before attempting any adjustments or **Grinding Ring** replacement.
- Make sure that the **Thumb Nut** is tightened down onto the grinding ring before starting any grinding operation
- Do not leave the Sparx™ Skate Sharpener running unattended.
- Never disconnect the **Power Cord** by pulling the wire to disconnect it from the socket.
- Store the Sparx™ Skate Sharpener in a dry place, out of the reach of children.
- Maintain the sharpener according to the Maintenance section of this manual.
- If at any time, the product does not operate normally, see the Troubleshooting section of this manual.
- There are no user serviceable parts on the sharpener. The sharpener should only be repaired by a professional Sparx™ Hockey technician, using only original spare parts. Unauthorized repairs could lead to hazardous conditions for the user and/or void of warranty.
- For any further questions about the sharpener, please contact Sparx™ Hockey Support at 855-SPARXHQ (855-772-7947) or by email at help@sparxhockey.com.

# PRÉCAUTIONS DE SÉCURITÉ

- Avant d'utiliser le Sparx ™ Skate Sharpener vous devez vous familiariser avec le produit et lire et comprendre toutes les instructions et les avertissements applicables dans ce manuel.
- En cas d'urgence: appuyez sur le bouton Annuler c deux fois. Ceci empêchera l'anneau de broyage à sa place. Ne pas arrêter l'anneau de broyage sauf en cas d'urgence, car cela pourrait endommager la lame du patin.
- Nous ne recommandons pas que les enfants âgés de moins de 13 ans sont autorisés à utiliser le Sparx ™ Skate Taille-crayon. Toute personne âgée de moins de 18 ans doivent être supervisés par un adulte qualifié lors de l'utilisation du Skate Taille-crayon.
- Le Sparx ™ Skate Taille-crayon ne peut être utilisé pour l'affûtage des patins.
- Seuls Sparx ™ anneaux de broyage peuvent être utilisés avec cette machine.
- Mettre en place le produit en toute sécurité sur une surface stable et dans un endroit protégé. Il doit être placé là où personne ne puisse marcher ou trébucher sur le cordon d'alimentation et où le cordon d'alimentation ne peut pas être endommagé.
- Utilisez toujours le Sparx ™ Skate Taille-crayon dans un environnement sec, bien éclairé, et sans condensation. Pour éviter tout risque de choc électrique, ne pas utiliser le Sparx ™ Skate Taille-crayon dans des conditions humides ou mouillées.
- Pour éviter les blessures, utilisez toujours la prudence lors de l'utilisation du Sparx ™ Skate Taille-crayon, ou lors du changement de l'anneau de broyage.
- Ne pas essayer de toucher la meule, le transport, ou Skate Clamp tandis que la meule est en mouvement. Cela se produit généralement lorsque les utilisateurs tentent de régler la hauteur de la meule ou de commencer à retirer la meule immédiatement après la porte est ouverte. Attendez que le chariot et la meule à venir à un arrêt complet avant d'essayer des réglages ou de meulage de remplacement de la roue.
- Assurez-vous que l'écrou de pouce est serré vers le bas sur l'anneau de broyage avant de commencer toute opération de broyage
- Ne laissez pas le Sparx ™ Skate Taille-crayon en marche sans surveillance.
- Ne jamais débrancher le cordon d'alimentation en tirant sur le fil pour le débrancher de la prise.
- Rangez la Sparx ™ Skate Taille-crayon dans un endroit sec, hors de la portée des enfants.
- Maintenir le taille-crayon selon la section Entretien de ce manuel.
- Si, à tout moment, le produit ne fonctionne pas normalement, consultez la section Dépannage de ce manuel.
- Il n'y a aucune pièce réparable par l'utilisateur sur le taille-crayon. Le taille-crayon ne doit être réparé par un technicien professionnel de hockey Sparx ™, utilisant uniquement des pièces de rechange d'origine. Les réparations non autorisées pourraient conduire à des conditions dangereuses pour l'utilisateur et / ou annulation de la garantie.
- Pour toute question au sujet de la taille-crayon, s'il vous plaît contacter le support Hockey ™ Sparx au 855-SPARXHQ (855-772-7947) ou par courriel à help@sparxhockey.com.



1

# SAFETY

## SAFETY INFORMATION



Warning: Please see the manual for operating instructions.



Caution: Pinch point hazard. Keep hands, hair, and other body parts clear of the skate clamp area.

FCC Notice (for U.S. Customers):

This device complies with Part 15 of the FCC Rules:

Operation is subject to the following conditions:

1. This device many not cause harmful interference, and
2. This device must accept any interference received, Including interference that may cause undesired operation

Changes and Modifications not expressly approved by Velasa Sports, Inc. can void your authority to operate this equipment under Federal Communications Commissions rules.

This device complies with Industry Canada license-exempt RSS standard(s). Operation is subject to the following two conditions: (1) this device may not cause interference, and (2) this device must accept any interference, including interference that may cause undesired operation of the device.

Le présent appareil est conforme aux CNR d'Industrie Canada applicables aux appareils radio exempts de licence. L'exploitation est autorisée aux deux conditions suivantes : (1) l'appareil ne doit pas produire de brouillage, et (2) l'utilisateur de l'appareil doit accepter tout brouillage radioélectrique subi, même si le brouillage est susceptible d'en compromettre le fonctionnement.

## INFORMATION SÉCURITAIRE



Attention: S'il vous plaît voir le manuel pour les instructions d'utilisation.



Attention: Risque de pincement. Garder les mains, les cheveux et autres parties du corps d'avance sur la zone de patin de serrage.

# INTRODUCTION

## TECHNICAL SPECIFICATIONS

### SKATE COMPATIBILITY

- Hockey Skates
- Goalie Skates
- Figure Skates\*

*\*Requires an additional adapter, which is sold separately.*

### DIMENSIONS AND WEIGHT

- Width: 26.8 Inches / 680mm
- Height: 7.6 Inches / 194mm
- Depth: 15.5 Inches / 390mm
- Weight: 33 Pounds / 10.4kg

### ELECTRICAL

- Line Voltage: 100 – 240 Volts AC (50 – 60Hz single phase)
- Maximum Power Consumption: 200W

WHAT’S IN THE BOX

- Sharpener
- 1 - Clamp Lever
- 2 - Travel Guard
- 3 - Alignment Ring
- 4 - Grinding Ring
- 5 - Goalie Risers
- 6 - Power Cord
- 7 - Optical Alignment Tool
- 8- Honing Stone
- 9 - Leather Strop
- 10 - Youth Skate Adapters

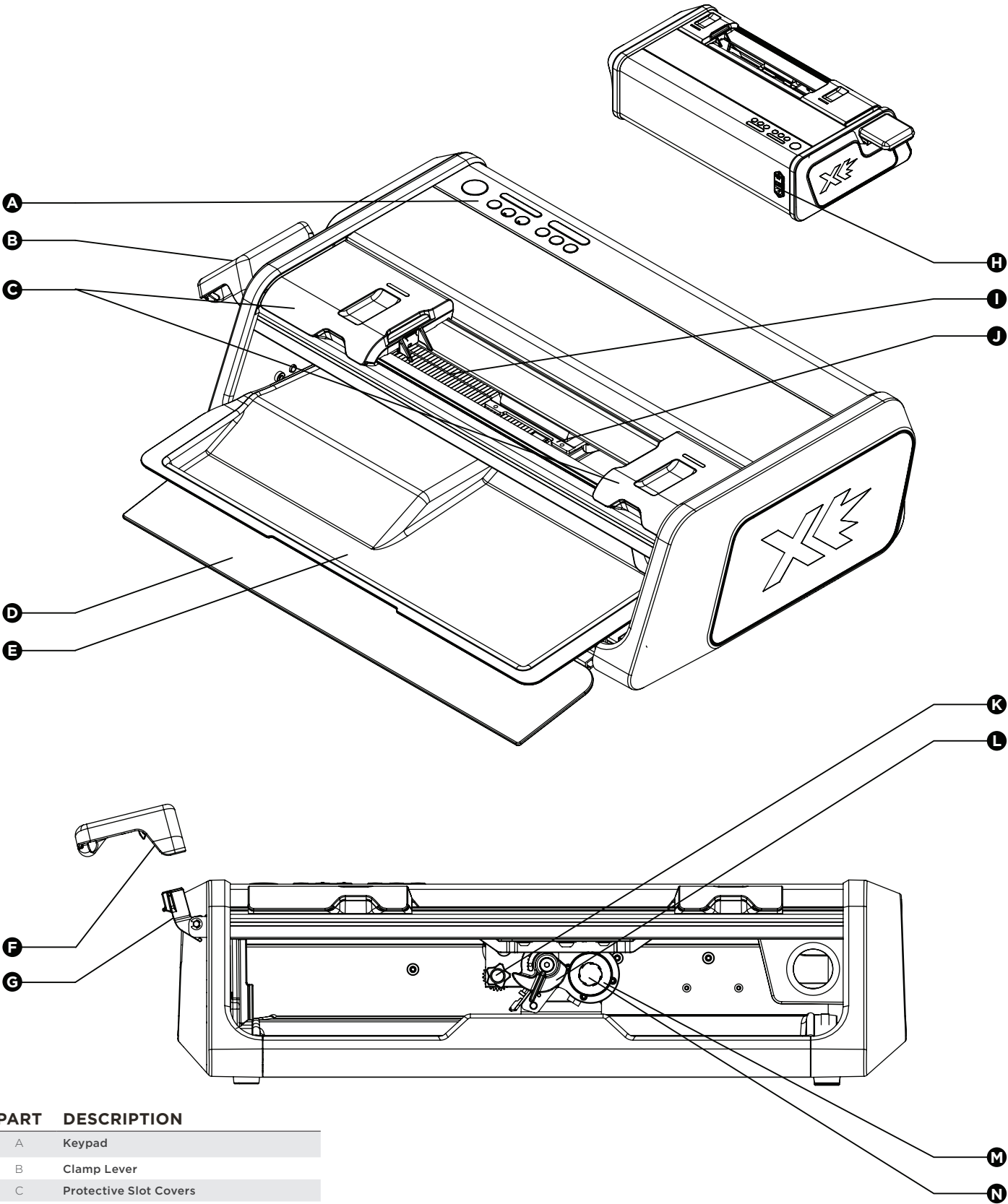
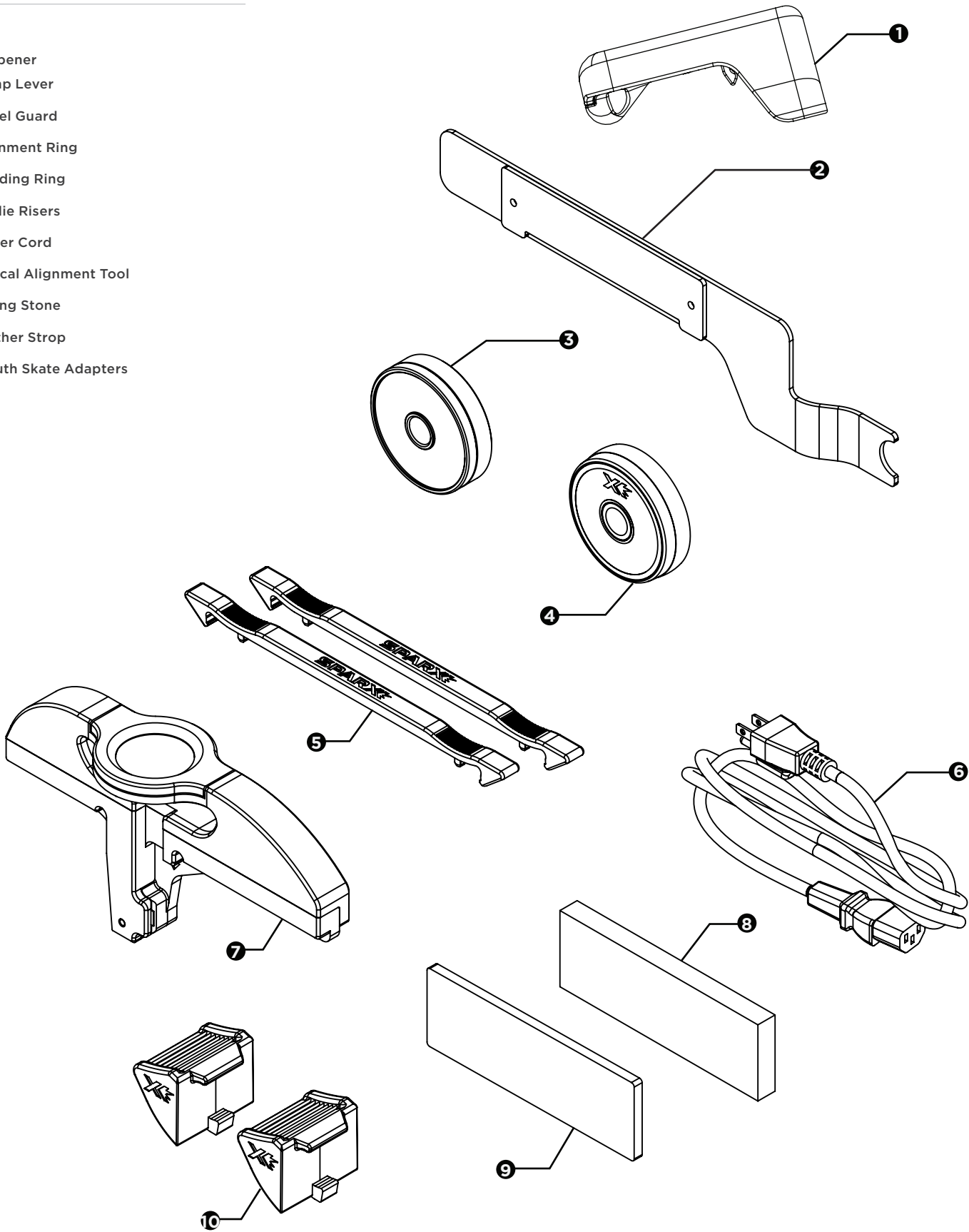

PART	DESCRIPTION
A	Keypad
B	Clamp Lever
C	Protective Slot Covers
D	Glass Door
E	Dust Tray
F	Clamp Lever
G	Lever Dock
H	Power Input Port - On/Off Switch
I	Filter
J	Skate Clamp
K	Alignment Adjustment Knob
L	Height Adjust Knob
M	Grinding Ring Shaft
N	Thumb Nut

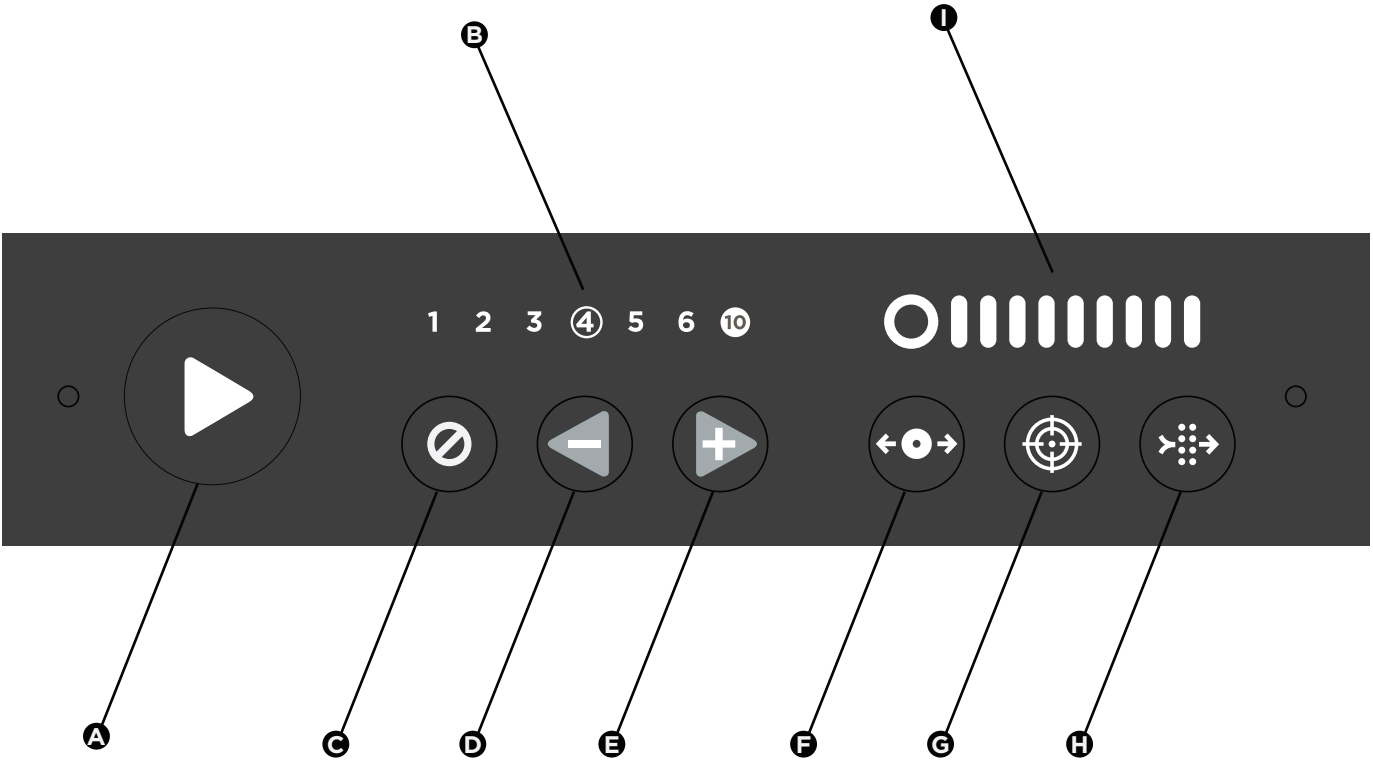

PART	NAME	DESCRIPTION
A	Play Button	Begins the sharpening cycle
B	Cycle Counter	Displays the current number of cycles selected / displays error codes
C	Cancel/Error Button	-Push one time to stop the carriage at conclusion of the current pass -Push two times for an emergency stop; the motor will stop immediately -When illuminated, the sharpener is in an error state. See Troubleshooting -When illuminated in an error state, reset the sharpener by pressing one time -Hold the button down for 2 seconds to recall a previous error code
D	Minus Cycles/Move Left Button	Subtracts cycles from the Cycle Counter/If in Move Mode, it moves the carriage left
E	Add Cycles/Move Right Button	Adds cycles to the Cycle Counter/If in Move Mode, it moves the carriage right
F	Move Button	Press once to enter Move Mode to move the carriage
G	Calibrate Button	Press once to enter Calibration Mode
H	Air Filter Button	Indicates the filter needs to be replaced
I	Ring Life Indicator	Indicates the grinding ring's life status

# 3 SETUP

Plug the **Power Cord** into the **Power Input Port** on the back of the sharpener. Plug the other end into a wall outlet. Using the switch on the **Power Input Port**, turn the sharpener on.

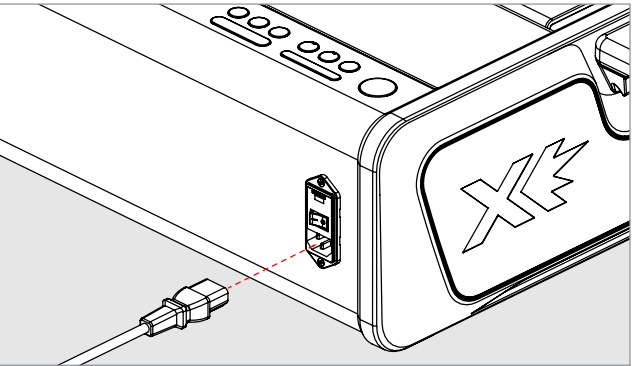

## SHARPENER ASSEMBLY



To watch the video online, visit [sparxhockey.com/assembly](https://sparxhockey.com/assembly)

### 1 INSTALL THE CLAMP LEVER

Slide the **Clamp Lever** (A) onto the **Lever Dock** (B). Press the lever down until it clicks into place. When engaged, the lever will lie at a slight angle.

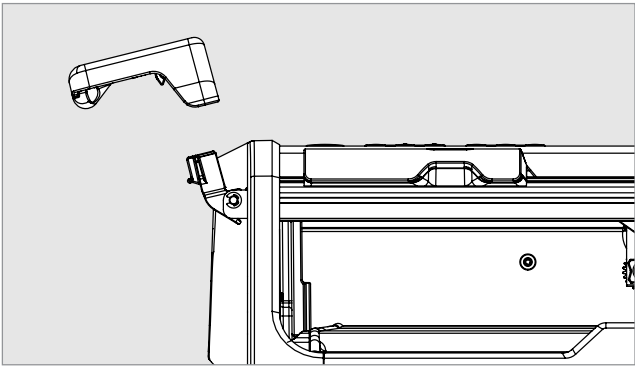

### 2 PLUG IN THE POWER CORD

### 3 REMOVE THE TRAVEL GUARD

Open the **Skate Clamp** by pressing and holding down the **Clamp Lever**. Remove the **Travel Guard**. Release the **Clamp Lever** to close the **Skate Clamps** after removal.

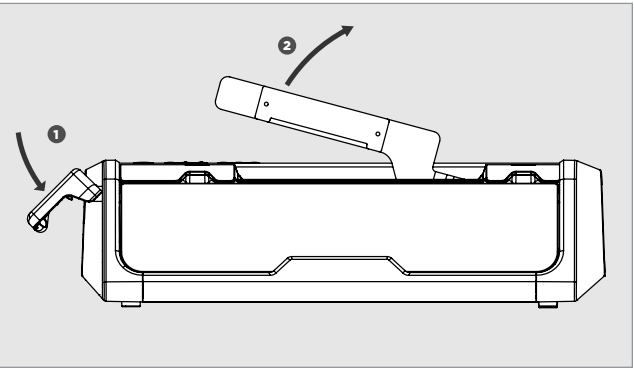

Do not discard the **Travel Guard**. This guard is used to help keep the components of the sharpener safe during travel. Damage resulting from transport without the **Travel Guard** installed is not covered by warranty.

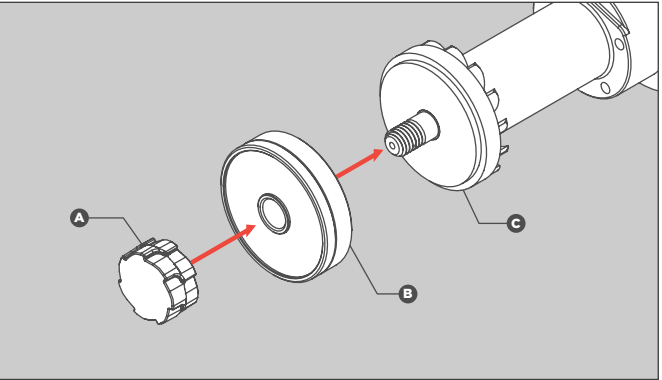

1. Open the **Glass Door**. The carriage will automatically move into the install position.

2. While holding the **Grinding Ring Shaft** (C), unscrew the **Thumb Nut** (A). Slide the **Alignment Ring** (B) onto the **Grinding Ring Shaft** (C), with the label facing out, and replace and tighten the **Thumb Nut** until hand-tight. Close the **Glass Door**.

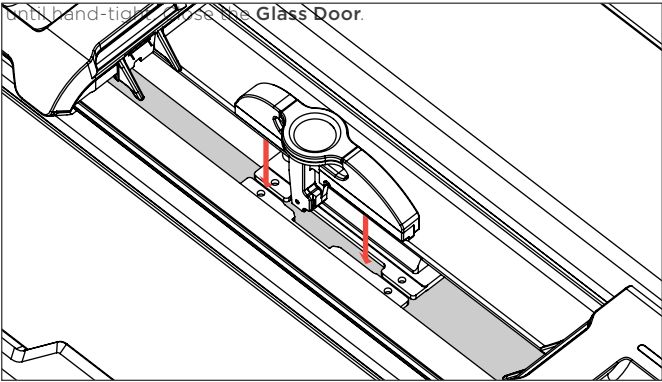

3. Press down on the **Clamp Lever** to open the **Skate Clamp**. Place the **Optical Alignment Tool** (Sparx™ logo facing forward) into the **Skate Clamp**. Place the **Optical Alignment Tool** into the slot and let it fall into place. Release the **Clamp Lever**.

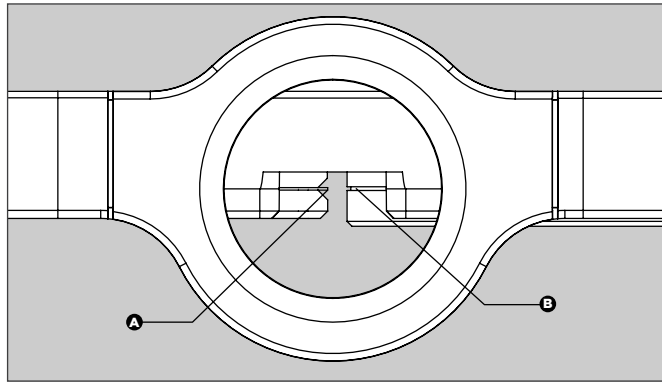

4. Press the **Calibrate Button** to send the carriage to its alignment position. When the carriage is in place, a tone will play and the case will illuminate with blue LEDs.

5. Looking through the eyepiece of the **Optical Alignment Tool**, find the indicator tab of the **Alignment Tool** (A). Ensure it aligns with the notch on the **Alignment Ring** (B) as shown below.

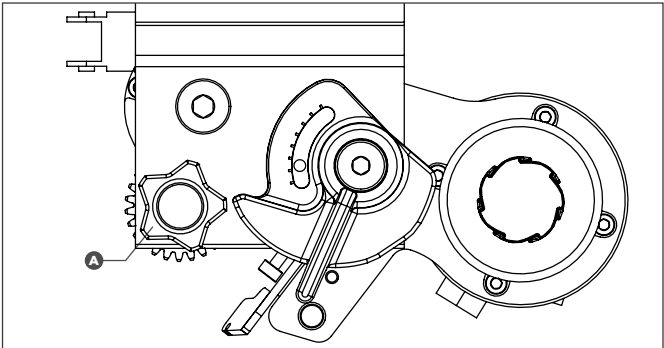

If not aligned, follow step 6. If the indicator tab of the **Alignment Tool** is in aligned with the notch on the **Alignment Ring**, move to step 7.

6. Open the **Glass Door** and locate the gray **Alignment Adjustment Knob** (A) inside of the sharpener. While looking through the **Optical Alignment Tool**, turn the **Alignment Adjustment Knob** until the notch on the **Alignment Ring** (right) lines up with the indicator tab of the **Alignment Tool** (left), as shown below. Close the **Glass Door** when aligned.

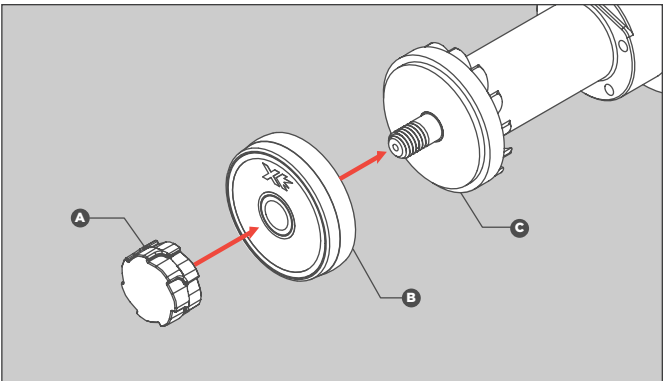

the **Clamp Lever**.

9. Open the **Glass Door**. The **Carriage** automatically moves into the install position. Once the **Carriage** stops, unscrew the **Thumb Nut** and remove the **Alignment Ring**.

10. Slide the **Grinding Ring** (B) (label facing forward) on the **Grinding Ring Shaft** (C), label facing out, and replace and tighten the **Thumb Nut** (A) until hand-tight. Close the **Glass Door**.

# 4

## OPERATION

### LOADING A SKATE

*\*For Goalie Skates, Youth Skates, and Sharpening New Steel, see the end of this section.*

1. Open the **Skate Clamp** by pressing and holding down the **Clamp Lever**. With the skate toe facing left and the laces tucked into the skate, set the skate into the **Skate Clamp** slot letting the plastic blade holder rest on top of the clamps. Center the skate blade in the **Skate Clamps**. Release the **Clamp Lever**.

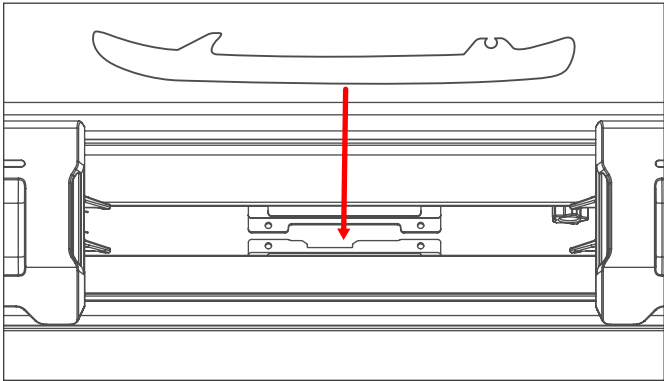

2. With the skate clamped, move each **Protective Slot Cover (A)** in towards the skate until they touch the blade holder and the **Safety Lights (B)** extinguish.

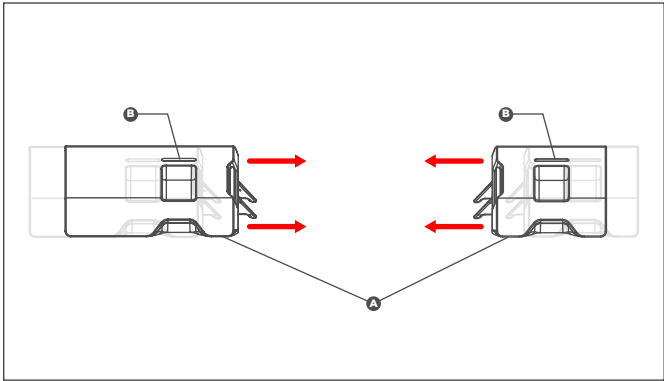

### ADJUSTING THE GRINDING RING HEIGHT

For every skate sharpened, we must adjust the grinding ring's height. We'll first introduce a few new concepts and then move into the actual adjustment. As a reminder, this adjustment will be performed for every new pair of skates sharpened.

We want to first define an intersection zone where the vertical face of the blade "B" meets the nearly horizontal face of the blade "C". This zone can be a curved section of blade like that shown in this figure or in some cases can be a point where surfaces "B" and "C" meet.

When the intersection zone is a curved surface the grinding ring can safely initially contact the blade anywhere in this region. We typically recommend contacting in this zone at a 45 degree angle (see Step X or Figure Y for more details). When the intersection zone is a point, the first contact between the grinding ring and the blade should be just below this point.

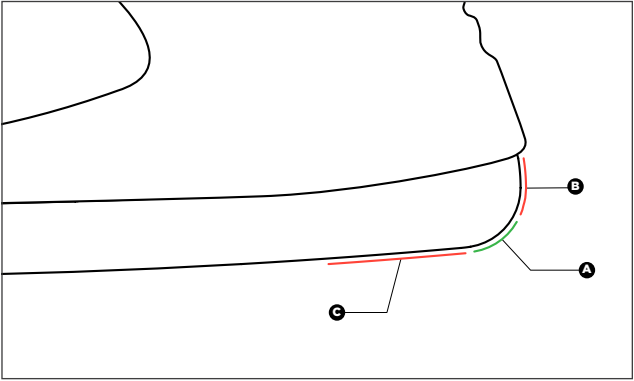

To check the Grinding Ring Height, we will enter Move Mode and bring the Griding Ring left until we are about 1/4” from the blade (A). This will allow us to see approximately where the first contact point between ring and steel would be.

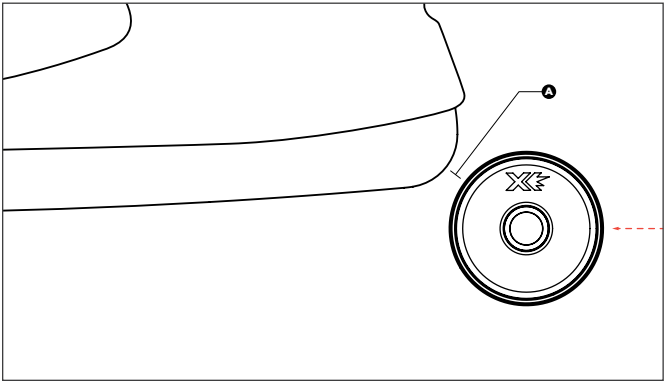

Below is an example of an intersection point (A) on a brand new blade. We want our first contact point to be just below intersection point (A). Point (B) is too high and point (C) is too low. For new blades, we recommend starting at a height setting of 4 and moving up until you hit the intersection point.

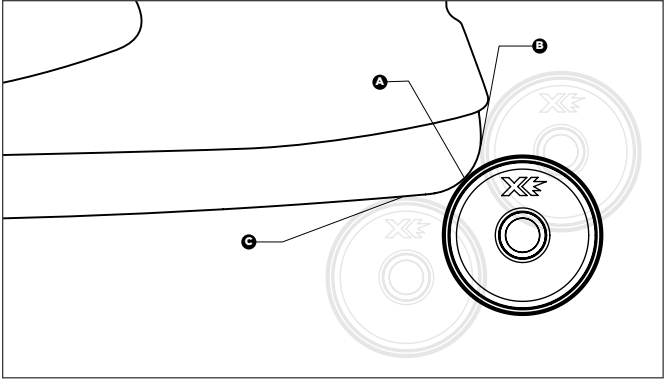

Below is an example of an intersection point (A) on a worn down blade. We want our first contact point to be just below intersection point (A). Point (C) is too low. For worn down blades, try starting with a setting of 6 and moving up to hit your desired contact point.

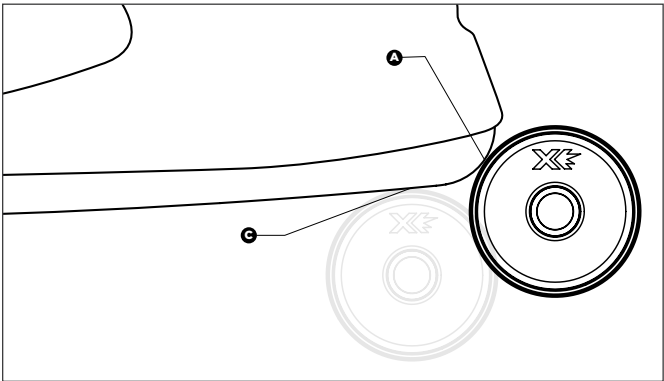

1. Press the **Move Button** on the keypad. This will set the **Grinding Ring** into Move Mode and allow you to control its movement.

2. Using the **Left** and **Right** buttons on the keypad, move the carriage to the left until it almost touches the heel of the skate blade.

4. Open the **Glass Door**. Using the red **Height Adjustment Knob**, turn left or right until the **Grinding Ring** is at a desired height. The knob is labeled 1-8, with 8 being the highest setting for the **Grinding Ring** and 1 being the lowest setting.

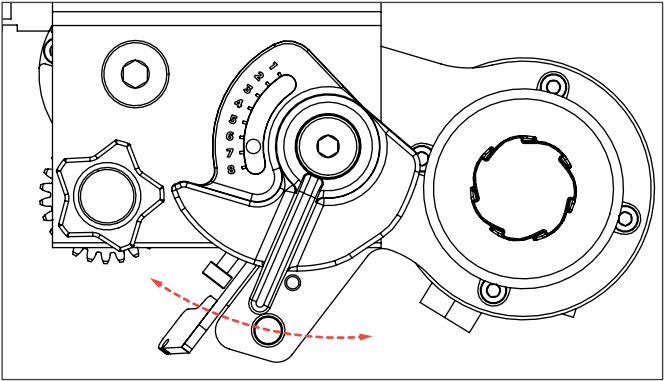

5. Close the **Glass Door**. Once the **Glass Door** has been closed, using the **Left** and **Right Buttons**, touch the **Grinding Ring** to the skate blade. Inspect it's contact point and be sure its in its desired position.

6. Press the **Move Button** again to send the **Grinding Ring** back to its home position.

## SELECTING CYCLE AMOUNT

When the sharpener moves the **Grinding Ring** out and back over the skate blade once it is called a cycle.

Your Sparx™ Sharpener comes set to a standard four cycles with all standard Radius Ring™ and FIRE Ring™ grinding rings automatically. We recommend trying four cycles to start and moving higher or lower as needed. Typically, we have found that four cycles will handle normal wear and tear (and even small nicks) from one-five hours of skating in-between sharpenings.

If choosing to adjust the cycle amount, use the **Left** and **Right** buttons on the keypad to adjust the number of passes desired. The number of passes selected will be illuminated on the **Cycle Counter Bar (A)**.

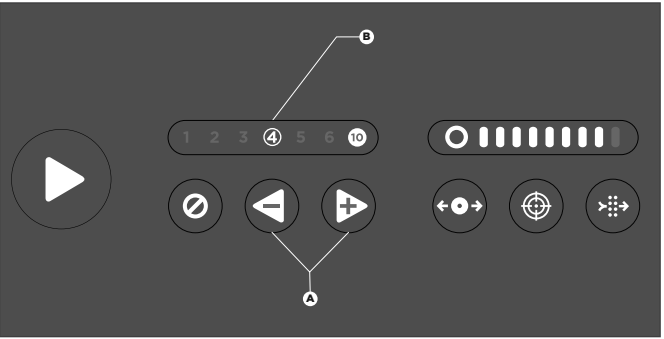

## SHARPENING SKATES

Once you have loaded the skate properly, closed the safety guards, and adjust the height of the **Grinding Ring**, you are ready to sharpen.

To cancel the cycles at any point during the sharpening, press the **Cancel** button once. This will send the **Carriage** back to its home position at the end of its current pass.

1. Press the Play Button. Once the **Play** button has been pressed, it will change from white to blue and the sharpening process will begin.

Upon pressing play, the air filter fan and grinding motor will turn on. The **Cycle Counter** will flash with the current cycle number until that pass (out and in) is competed.

The sharpener will continue to run until all cycles have been performed. At the completion of the final cycle, the end of sharpening is marked by a 'cycle complete' tone and the case LEDs will turn green. The fan will continue to run for an additional 30 seconds after the final cycle completes.

### ADDITIONAL CYCLES

If additional cycles are required, you can re-set the cycle count and press the **Play** button again.

## UNLOADING SKATE

1. Move both **Protective Slot Covers** away from the skate. The safety light on each cover will illuminate.

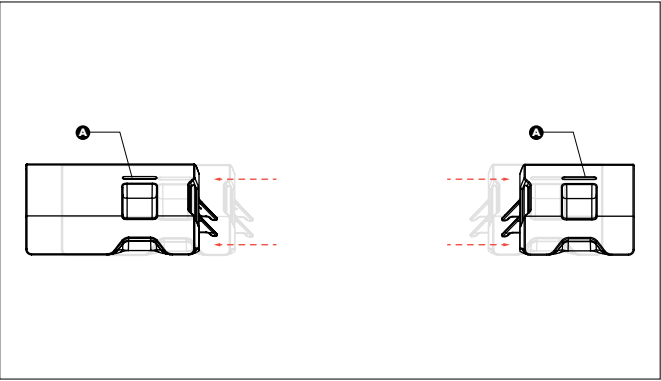

2. To open the **Skate Clamp**, press down the **Clamp Lever**. Remove the skate from the **Skate Clamp** and release the **Clamp Lever**.

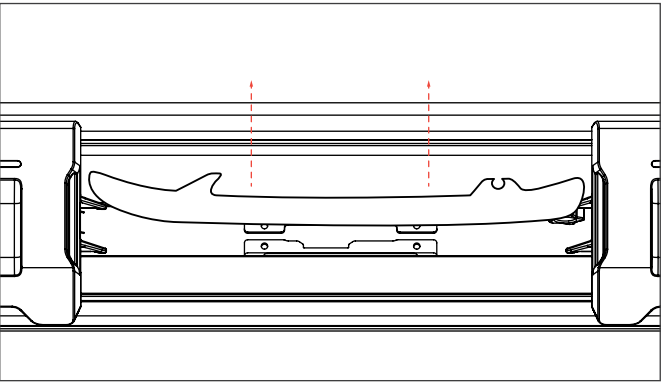

## EDGE DEBURRING WITH THE SPARX HONING STONE

1. Press the **Sparx™ Honing Stone (B)** against the top side (closer to the plastic blade holder) of the skate blade (A). Do not to put pressure on the bottom of the stone closest to the blade edge. With light pressure, press down on the lower side of the stone (C) and slowly run the stone back and forth the length of the blade for four full passes.

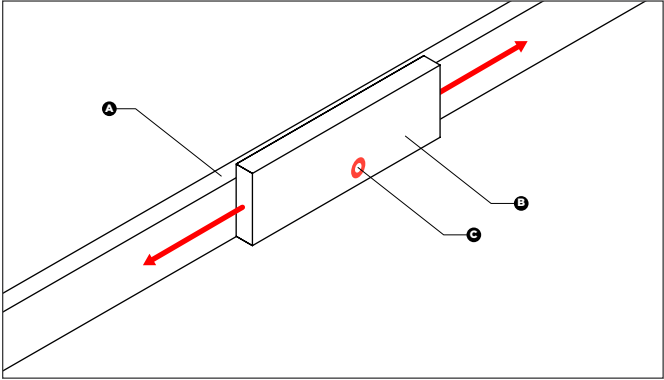

2. Turn the skate over and repeat Step 1.

## EDGE DEBURRING WITH THE SPARX LEATHER STROP

1. Hold the skate, upside-down in one hand.

2. Press the **Sparx Leather Strop** against the edge of the blade at a 45 degree angle. Slowly run the strop up and down the length of the blade for four full passes on each side of the edge.

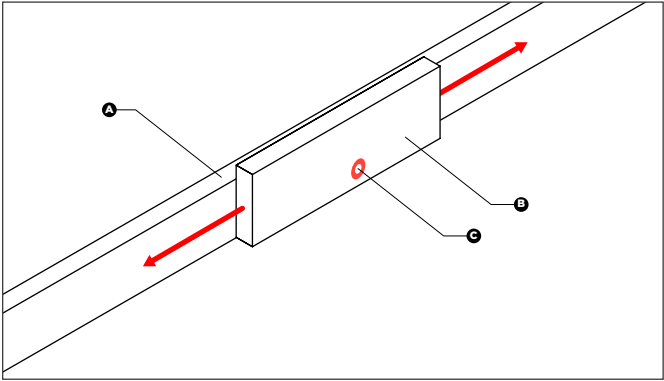

2. Turn the skate over and repeat Step 1.

## POWERING OFF

### LOCATE THE POWER SWITCH

On the back of the sharpener, locate the **Power Input Port** and switch to the off position.

## LOADING GOALIE SKATES

Before loading a goalie skate, you must first install the **Goalie Risers** onto the **Skate Clamp** (one **Goalie Riser** on each side of the **Skate Clamp**). To do this, locate the **Anchor Slots** on the **Skate Clamp** and align the **Anchor Pins** to the slots. Once aligned, press down firmly until you feel **Goalie Risers** snap into place.

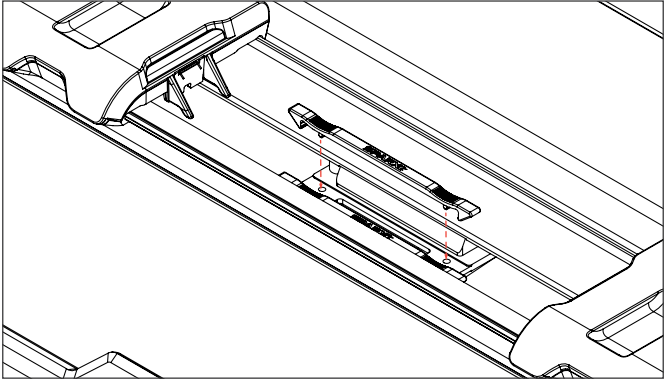

Below is an example of an intersection point (A) on a goalie skate blade. We want our first contact point to be just below intersection point (A). Point (B) is too high and point (C) is too low.

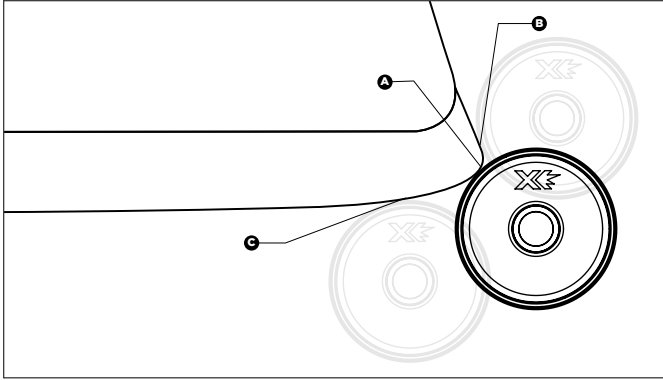

## LOADING YOUTH SKATES

Before loading a youth skate of size 12 and below, **Youth Skate Adapters** must be installed onto each **Protective Slot Cover**. On the adapter, locate the **Anchor Tab** (A) on the top of the adapter and then the lower **Anchor Tab** (B) on the bottom.

Below is a cross-sectioned **Protective Slot Cover**. Locate the recessed slot (C) and the Tab Cut Out (D) on the **Protective Slot Cover Switch**.

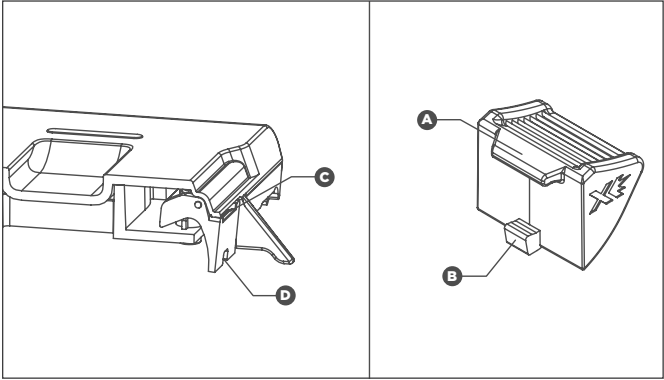

1. Press the top **Anchor Tab** (A in figure above) into the recessed slot (C). Once in, press down firmly on the top of the **Youth Skate Adapter** until the bottom **Anchor Tab** clicks in place.

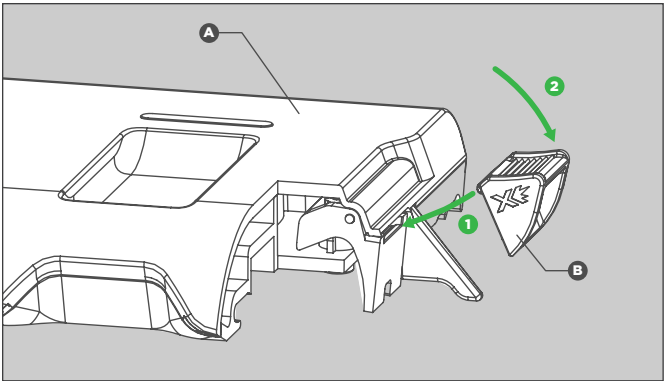

Below is an installed **Youth Skate Adapter**.

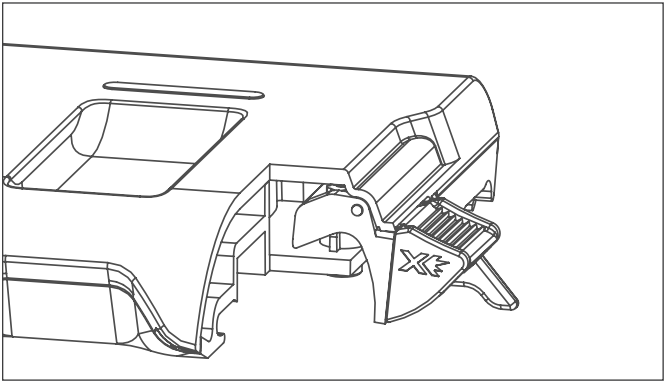

## SHARPENING NEW STEEL

### 1. LOAD SKATE

Follow the instructions for Loading a Skate in the Operations section of the manual.

### 2. ADJUST GRINDING RING HEIGHT

Follow the instructions for Adjust Grinding Ring Height in the Operations section of in the manual.

### 3. SELECT 10 CYCLES

Using the **Left** and **Right** buttons on the keypad, select **10** on the **Cycle Counter**.

### 3. PERFORM MARKER TEST

# 7

## TROUBLESHOOTING

### ERROR MESSAGES

There are three types of errors encountered by the Sparx Sharpener which can interrupt operation. These error Types are: Startup, Function Entry, and System Stop errors. Each error type is described in the table below along with information about how the user is informed of the error.

For some error types, an Error Code is displayed on the Keypad's Cycle Counter. The Troubleshooting Table below suggests possible corrective actions to resolve the error.



If the Error Code was only temporarily displayed or the user wishes to cycle through previous Error Codes, hold down the Cancel/Error button for 2 seconds until a beep is heard (button initially emits error buzz when pressed). Once the beep is heard, the most recent Error Code is displayed and pressing the Move Left and Move Right buttons will cycle through previous Error Codes

ERROR TYPE	DESCRIPTION	DISPLAY METHOD
I: Startup	Errors encountered by the system during startup.	Displayed through the User Interface (e.g. flashing LEDs at the area of concern, for example the <b>Protective Slot Cover</b> LEDs)  No Error Code is displayed for this type.
II: Function Entry	Errors that prevent the user from entering into a function (e.g. sharpening or calibration).	Displayed through the User Interface (e.g. flashing LEDs at the area of concern, for example the Slot Cover LEDs)  &  Error Code temporarily displayed on the keypad's <b>Cycle Counter</b> . See below.
III: System Stop	Errors that cause the machine to exit out of a function because of safety concerns or to prevent machine damage.	Error Code that caused the machine to be stopped is displayed on the keypad's <b>Cycle Counter</b> . See below.  All functionality is disabled until the user acknowledges the error by pressing the  <b>Cancel</b> button.

ERROR CODE	POSSIBLE CAUSE	CORRECTIVE ACTION
1 - 2 - 4	<b>Glass Door</b> open.	Close <b>Glass Door</b> .
1 - 2 - 5	Excessive <b>Glass Door</b> opening during calibration.	Attempt calibration again while leaving <b>Glass Door</b> closed until <b>Carriage</b> stops at calibration location.
1 - 2 - 6	<b>Dust Tray</b> missing.	Confirm that <b>Dust Tray</b> is correctly installed.
1 - 2 - 10	<b>Air Filter</b> missing.	<b>Air Filter</b> Missing.
1 - 3 - 10	Attempted to start calibration routine with skate or <b>Grinding Ring</b> installed.	Adjust skate and protective slot covers until contact is made between Protective Slot Covers and both ends of the installed skate. LEDs on Protective Slot Covers should be extinguished. Use Youth Skate Adapters if skate is too small to make contact with both Protective Slot Covers.
1 - 4 - 5	Pressed the  <b>Play</b> button in Calibration Mode.	Exit <b>Calibration Mode</b> prior to pressing the  <b>Play</b> button.
1 - 4 - 6	Pressed the  <b>Play</b> button in Move Mode.	Exit <b>Move Mode</b> prior to pressing the  <b>Play</b> button.
1 - 5 - 10	Left <b>Protective Slot Cover</b> Disengaged.	Adjust skate and protective slot covers until contact is made between <b>Protective Slot Covers</b> and both ends of the installed skate. LEDs on <b>Protective Slot Covers</b> should be extinguished.  Use <b>Youth Skate Adapters</b> if skate is too small to make contact with both <b>Protective Slot Covers</b> .
1 - 6 - 10	Right <b>Protective Slot Cover</b> Disengaged.	Adjust skate and protective slot covers until contact is made between <b>Protective Slot Covers</b> and both ends of the installed skate. LEDs on <b>Protective Slot Covers</b> should be extinguished.  Use <b>Youth Skate Adapters</b> if skate is too small to make contact with both <b>Protective Slot Covers</b> .
2 - 3 - 6	Sharpener failed to detect skate.	Ensure that skate is installed in <b>Skate Clamp</b> correctly and that <b>Grinding Ring</b> height is adjusted properly.
2 - 4 - 10	<b>Grinding Ring</b> empty.	Install a valid <b>Grinding Ring</b> .
2 - 5 - 6	<b>Grinding Ring</b> not found.	Install a valid <b>Grinding Ring</b> .
2 - 5 - 10	<b>Grinding Ring</b> read incomplete.	Repeat process and allow extra time between steps. If this doesn't resolve problem, replace <b>Grinding Ring</b> .
2 - 6 - 10	<b>Grinding Ring</b> read error.	Install a valid <b>Grinding Ring</b> .
3 - 5 - 10	Grinding Motor over-current.	Confirm that <b>Grinding Ring</b> height is adjusted properly and nothing is obstructing the <b>Grinding Ring</b> .
3 - 6 - 10	Translation Error - Limit undetected.	Confirm that the <b>Carriage</b> is not obstructed.

In the event that a error cannot be resolved, please contact customer support at Sparx Hockey.

### SPARX HOCKEY CUSTOMER SUPPORT

help@sparxhockey.com (fastest response)  
1-800-SPARX HQ

# 8

# MAINTENANCE

## EMPTYING DUST TRAY

When the **Dust Tray** is full and before moving or traveling with the Sparx™ Sharpener, empty the **Dust Tray**.

1. Open the **Glass Door**. Slide out the **Dust Tray** and dispose of the steel shavings.

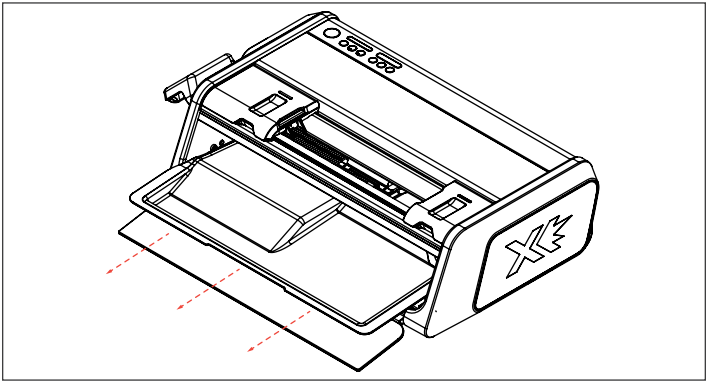

2. Slide the **Dust Tray** back into the machine. Close **Glass Door**.

2. Push up on the two tab locks on the filter housing. Open the top lid of the housing until it clicks into the open position. Remove the filter.

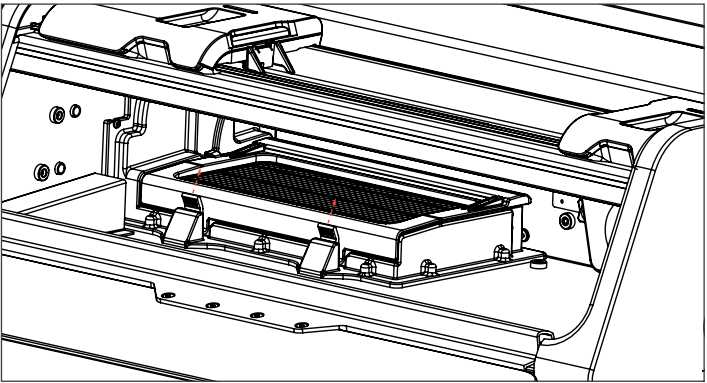

3. Push up on the two tab locks on the filter housing. Open the top lid of the housing until it clicks into the open position. Remove filter.

Once your filter has been replaced, hold down the **Air Filter** button for two second to reset the system.

## CHANGE AIR FILTER

The **Air Filter** will last 200 sharpenings. After that, we can no longer ensure that your filtering quality will remain at our high standards. The **Air Filter** button will light up reminding you to order a replacement filter.

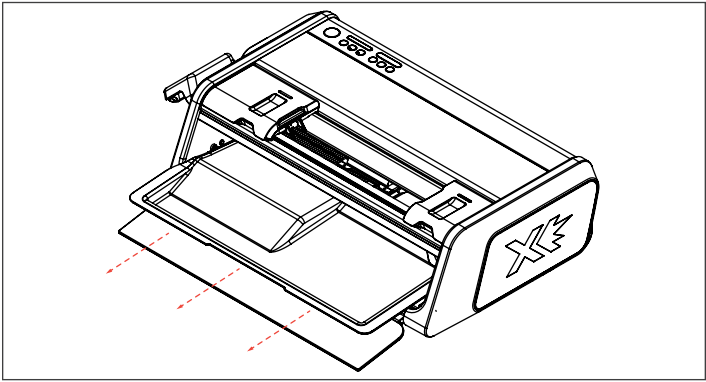

1. Open the Glass Door. Slide out the **Dust Tray**.

# 9

# WARRANTY

## LIMITED ONE YEAR PRODUCT WARRANTY

Velasa Sports, Inc. ("Velasa Sports") warrants that, under normal use and provided that you have followed our reasonable care instructions, your Sparx™ Product will be free from defects in materials and workmanship for a period of one (1) year from the date of purchase from Velasa Sports or an authorized Velasa Sports reseller or partner. Your exclusive remedy and our sole obligation is to repair or replace any Product that Velasa Sports reasonably determines does not comply with this warranty or, at our sole discretion, to accept return of such Product and refund to you the price paid therefor.

Products that have been repaired or replaced hereunder shall be covered by this warranty for the longer of thirty (30) days after being shipped back to you or the remainder of the original 1-year warranty period. Any Product or component that is replaced becomes the sole property Velasa Sports.

## HOW TO MAKE A WARRANTY CLAIM

If you experience any problems with your Sparx™ Product, please contact Customer Service at [help@sparxhockey.com](mailto:help@sparxhockey.com). Upon confirmation and approval of your warranty claim, we will assign a return material authorization number ("RMA"). At your risk and expense, you must deliver the nonconforming Product (with prominent indication of the RMA) to Velasa Sports or its designated repair center. Products returned without an RMA shall not be afforded warranty service, and you shall be liable for all costs and expenses incurred by us in connection with servicing the unauthorized return.

## EXCLUSIONS

All claims under this limited warranty must be made during the applicable warranty period.

This limited warranty shall be void and not apply as to any Product that was (a) used, handled, operated, maintained or stored improperly, or in any manner not in accord with our documentation, instructions or recommendations, (b) repaired, altered or modified by anyone other than Velasa Sports or its authorized agents or (c) used with parts or accessories not supplied by Velasa Sports.

SPARX™ PRODUCTS ARE NOT WARRANTED FOR COMMERCIAL OR RENTAL USE. Velasa Sports' limited warranty does not include coverage or liability for the loss of or damage to any Ice Skates with respect to which the Sparx™ Product was used.

## DISCLAIMERS

EXCEPT AS EXPRESSLY SPECIFIED HEREIN, ALL SPARX™ PRODUCTS ARE PROVIDED "AS IS" WITHOUT REPRESENTATION OR WARRANTY OF ANY KIND. VELASA SPORTS DOES NOT WARRANT THAT THE SPARX™ PRODUCTS WILL MEET YOUR REQUIREMENTS, OR THAT THEIR OPERATION WILL BE ERROR-FREE. FOR ITSELF AND ITS LICENSORS, VELASA SPORTS HEREBY DISCLAIMS ALL OTHER REPRESENTATIONS AND WARRANTIES, EXPRESS OR IMPLIED, ORAL OR WRITTEN, INCLUDING WITHOUT LIMITATION, ALL IMPLIED WARRANTIES OF TITLE, NON-INFRINGEMENT, INTEGRATION, MERCHANTABILITY OR FITNESS FOR ANY PARTICULAR PURPOSE.

## OTHER TERMS

This warranty gives you specific legal rights, and you may also have other rights which vary from state to state.

Your use of this Site and the Services (including your purchase of Sparx™ Products) are governed by our Terms of Service, which are available at <https://www.sparxhockey.com/pages/terms-services>. Capitalized terms used herein without definition will have the same meanings as defined in the Terms of Service.

