

USER MANUAL

PARTS & FUNCTION

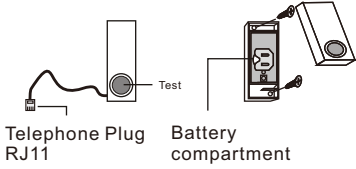

BATTERY INSTALLATION

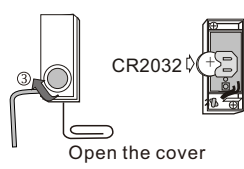

CODE MATCHING & MELODY SELECTION

The telephone signaller works with the receiver (chime),

and must be paired prior to use.
Step 1: Insert battery to the telephone transmitter.

Step 2: Insert batteries to the receiver (chime).

Step 3: Enter pairing mode for receiver (chime unit).

Press and hold the ● zone selector button 3 seconds. The LED #1 will flash.

Step 4: Press the ● button again to move to the zone you want to pair with.

Press 🎵 melody selector to scroll through the melodies. Once you hear the telephone sound, do not press again as it is now selected.

Step 5: Once you have selected the zone and sound, press the test button on the telephone signaller once. If successful, the receiver will generate a short tone. Press the ● button to exit pairing mode it is now ready to use.

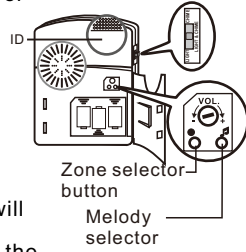

CODE CONFLICT

If the telephone signaller coding is the same as another sensor you must change the code. After you have changed the code re-matching the telephone signaller.

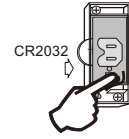
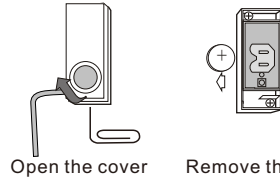

Press and hold the test button, insert the battery whilst holding the button for 5 seconds. The LED will flash 5 times when a new code is generated

FCC Statement:

This equipment has been tested and found to comply with the limits for a Class B digital device, pursuant to part 15 of the FCC Rules. These limits are designed to provide reasonable protection against harmful interference in a residential installation. This equipment generates, uses and can radiate radio frequency energy and, if not installed and used in accordance with the instructions, may cause harmful interference to radio communications. However, there is no guarantee that interference will not occur in a particular installation. If this equipment does cause harmful interference to radio or television reception, which can be determined by turning the equipment off and on, the user is encouraged to try to correct the interference by one or more of the following measures:

- * Reorient or relocate the receiving antenna.
- * Increase the separation between the equipment and receiver.
- * Connect the equipment to an outlet on a circuit different from that to which the receiver is connected.

This device complies with part 15 of the FCC rules. Operation is subject to the following two conditions: (1) This device may not cause harmful interference, and (2) this device must accept any interference received, including interference that may cause undesired operation.

Note: Modifications to this product will void the user's authority to operate this equipment.

OPERATION

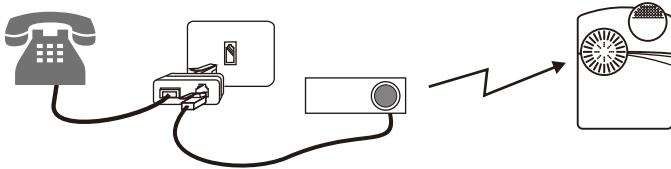

Plug the telephone line into the telephone socket as the diagram. The system is ready to use.