

# **Mobil Indoor Speedpass**

---

## **Installation Guide**

P/N: 55225

Revision A



## **Mobil Indoor Speedpass Installation Guide**

September 11, 1998

### **VeriFone® , Inc.**

4988 Great America Parkway

Santa Clara, CA 95054-1200

Telephone: 408-496-0444

<http://www.verifone.com>

Printed in the United States of America.

© 1998 by VeriFone, Inc. All rights reserved.

No part of this publication covered by the copyrights herein may be reproduced or copied in any form or by any means — graphic, electronic, or mechanical, including photocopying, taping, or information storage and retrieval systems — without written permission of the publisher.

The content of this document is subject to change without notice. The information contained herein does not represent a commitment on the part of VeriFone, Inc.

Publications are not stocked at the address given above. Requests for VeriFone publications should be made to your VeriFone representative.

VeriFone is a registered trademark of VeriFone, Inc. Speedpass is a trademark of Mobil Oil Corporation. All other products mentioned in this manual are trademarks or registered trademarks of their respective owners.

## **Mobil Indoor Speedpass Installation Guide Revision History**

<b>Revision</b>	<b>Date</b>	<b>Comments</b>
A	September 11, 1998	Initial release of software and documentation.

## FCC Compliance

This equipment complies with the requirements in Part 15 of FCC rules for a Class A computing device. Operation of this equipment in a residential area may cause unacceptable interference for radio and TV reception requiring the operator to take whatever steps necessary to correct the interference.

## Safety Instructions

- Read all instructions contained in this guide before making any equipment connections.
- Save these instructions for later use.
- Unplug the unit before servicing or cleaning. Do not use liquid or aerosol cleaners. Use only a damp cloth for cleaning.
- Do not use any attachments not specifically recommended by VeriFone as they may result in the risk of fire, electric shock, or injury to persons.
- Do not use the unit near water.
- Do not place the unit on an unstable cart, stand, or table. The unit may fall, causing serious personal injury and/or damage to the equipment.



# Contents

<b>1. Introduction</b> .....	<b>1</b>
<b>2. Unpacking</b> .....	<b>3</b>
<b>3. Installation</b> .....	<b>5</b>
Installation Procedures .....	5
Equipment Power Up .....	6
<b>4. Specifications</b> .....	<b>9</b>
Power Requirements .....	9
Operating Environment .....	9
Service and Repair .....	9
Cleaning .....	10



# 1

## Introduction

This document provides the information necessary to install your Mobil Indoor Speedpass System.

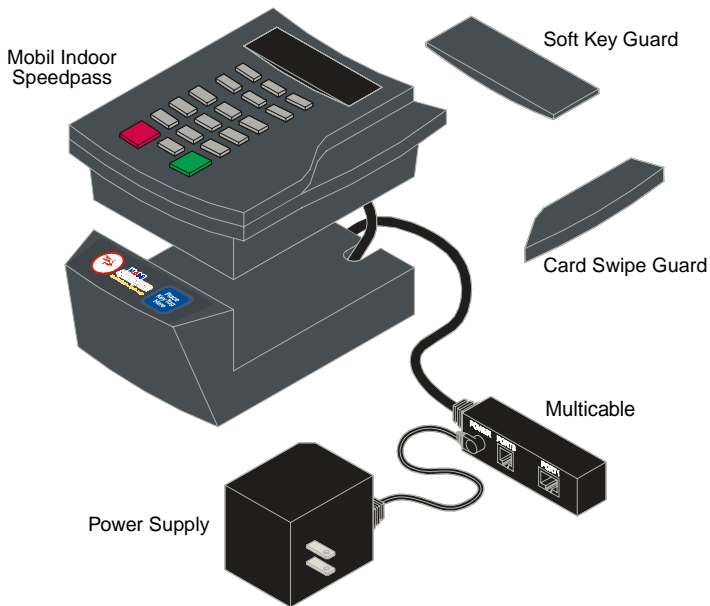

The Mobil Indoor Speedpass System is a self-contained device, when properly installed, becomes an integral part of the POS equipment. It has the ability of reading a retail customer's *tag* when placed near an antenna mounted on the face of the equipment.

Information from the tag is processed and transferred to POS equipment.



# 2

## Unpacking

Carefully inspect the shipping carton and its contents for any damage that may have occurred during shipment. If anything appears damaged, immediately file a claim with the shipping company or carrier and notify the Point of Sales equipment manufacturer.

**Warning:** *Never use damaged equipment. A shock or fire hazard may exist if equipment is energized in a damaged condition.*

Remove the following items from the shipping carton:

- Mobil Indoor Speedpass Unit with attached Multicable
- Power Supply
- Soft Key Guard
- Card Swipe Guard

Remove any protective plastic wrapping from the components and place them on a table or countertop.

Retain the shipping carton and any packing material in case it is necessary to move components from one location to another or to return the equipment for service.



# 3

## Installation

Unpack equipment in accordance with instructions listed in Chapter 2.

**Warning:** *To reduce the risk of fire, do not place this unit near any heat producing source.*

When selecting a location for your Mobil Indoor Speedpass equipment, avoid areas having:

- Direct sunlight or objects that produce heat.
- Excessive dust.
- Electrical “noise” or devices that cause excessive voltage variations such as air conditioners, fans, or high frequency security systems.

## Installation Procedures

Use the following procedures to install and power up the Mobil Indoor Speedpass.

1. Place the unit close to the POS equipment.
2. Uncoil the Multicable and ensure that it does not kink or is not placed under heavy equipment.
3. Uncoil the Power Supply cable.
4. Mount the unit on a custom stand, if applicable.

5. Locate the RS232 and RS485 cabling from the POS equipment.
6. Insert the RS232 cable connector into the Multicable jack labeled PORT 1.
7. Insert the RS485 cable connector into the Multicable jack labeled PORT 3.

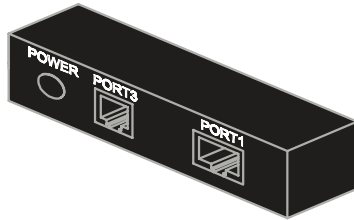

## Equipment Power Up

Before installing your Mobil Indoor Speedpass equipment, a quality surge protector should be purchased to protect the equipment from voltage surges. Ideally, the Mobil Indoor Speedpass equipment and the POS equipment should have its own dedicated AC power outlet. The surge protector is plugged into the AC power outlet first. The Mobil Indoor Speedpass Power Supply should then be plugged into the surge protector.

Use the following procedures to power up the Mobil Indoor Speedpass unit:

1. Insert the Power Cable connector into the Multicable jack labeled POWER.

**Warning:** *When the Power Supply is plugged into the AC power outlet, voltage is immediately available to the Mobil*

*Indoor Speedpass. Avoid handling the exposed power cable connector.*

**Note:** *The AC power outlet should be easily accessible should the user desire quick power disconnect.*

2. Connect the Power Supply to the AC power outlet or appropriately configured power connector.
3. Verify that the display is activated.

**Warning:** *To turn off your Mobil Indoor Speedpass, always unplug the power supply from the AC power outlet first. This eliminates the presence of voltage at the Multicable power receptacle and the potential shock hazard.*



# 4

## Specifications

### Power Requirements

- Input Voltage : 120VAC 60Hz 18 W
- Output Voltage: 12VDC 1000mA

### Operating Environment

- Temperature: 0 to 40 degrees C (32 to 104 degrees F)
- Humidity: 20% to 90%, noncondensing

### Service and Repair

Do not, under any circumstances, attempt to repair, service, or adjust your Mobil Indoor Speedpass equipment. If you have any problems with your unit, contact the manufacturer of your POS equipment.



## Cleaning

Routine cleaning can be accomplished by removing dust or dirt with a clean, damp cloth and mild soap or detergent. Use a cloth dampened with alcohol for more stubborn stains.

**Warning:** *Never use thinner, trichloroethylene, or ketone based solvents to clean this equipment or cabling as they may deteriorate plastic parts.*