

Description

The Vigil Wireless Mini-Pendant is typically used by residents to alert staff that they are in need of assistance. The Mini-Pendant can be worn by the resident using a key fob attachment for easy carrying in pocket or purse or can be worn with a lanyard or breakaway necklace. The Mini-Pendant is water-resistant and has replaceable batteries.

Operating Instructions

*****Pendants must be added to the Vigil software and tested prior to giving it to a resident. Refer to the Vigil Software User's Manual for instructions. *****

How to Create a Pendant Call:

- Simply push the call area (textured area on the front of the pendant)
- The LED light will flash blue 10 times (quicker at the beginning and then gradually slower) to indicate the call has been received by Vigil wireless system. It can take up to 2 seconds for your resident to see the blue flash.
- A message will be sent to phones or pagers and the Vigil software and show as: W Pendant Call, Room #, Resident Name, Location

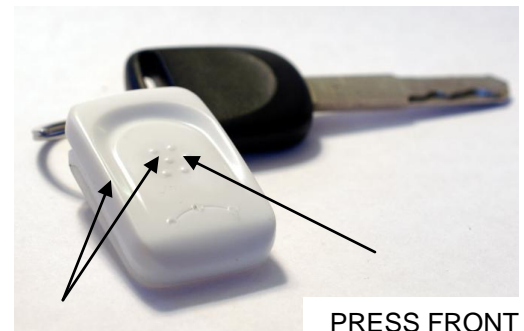

PRESS FRONT AND
SIDE TO RESET

PRESS FRONT TO
CREATE A CALL

How to Respond to a Pendant Call:

- Read the message on your pager, phone or the Active Calls screen and look at the closest receiver location given.
- On your pager/phone the last message will be the strongest
- On your Active Call screen the first message will be the strongest.
- When responding to Pendant calls consider your resident's behavior pattern first and use the messages as one of your tools when locating them.
- The call must be cancelled from the pendant.

How to Cancel a Pendant Call:

- You can only cancel a pendant call from the actual pendant that created the call
- Push and hold the left side of the pendant with one hand and then press and release the call button on the front.
- The LED light will flash green once to indicate you've canceled the call
- If you do not see the green light or if you see a blue light, you have not canceled the call. Repeat the steps above.

NOTE: If you see the LED light flash red on the pendant when the call area is pressed or when canceling an active call, it means the signal did not go through. Try canceling the call again.

How to Change the Battery:

1. Remove the battery cover on the back of the pendant
2. Pull the battery holder tab away from the battery to release the battery
3. Place the new battery in the battery holder tab with the word Sanyo facing you and press down to snap the new battery into place.
4. Replace battery cover as per diagram on the right*. Ensure the entire battery cover is in place to keep the pendant water resistant.
5. Check to make sure you cancel a call if one has been raised during the battery change

Always use the recommended battery: **Sanyo CR2025 3volts**

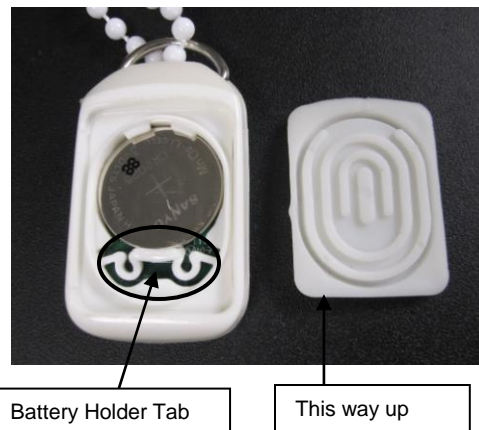

System Requirements

The Vitality Care System operates on the Vigil Integrated Care Management System™ platform offering you all of the functionality and reporting of the Vigil system. The Vitality Care System can be added to your existing Vigil system or can be installed as a stand-alone system. The Vitality Care System requires:

- Software version 3.3 or higher
- 2.4GHz wireless receivers (ZRX)
- CAT5 cabling between to the receivers
- Repeaters or power supplies as required

Technical

The Vitality Care System is based on the IEEE 802.15-4-2003 wireless standard and communicates on the widely used Controller Area Network (CAN) data protocol. The wireless devices communicate on a 2.4GHz frequency and use transceiver technology to ensure that each signal is received and acknowledged by the network.

Pendant Specifications

PHYSICAL		ELECTRICAL	
Height	45mm (1.77")	Operating Voltage	3V
Width	27mm (1.06")	Wireless	2.4GHz DSSS Transceiver
Depth	11mm (0.43")		
Weight	11g (0.4 oz)	Physical	Resistant to temporary immersion in water
Enclosure	Polypropylene	Battery Type	Coin cell
Accessories	Decorative break away neck chain, lanyard or key ring	Battery Life	1 yr average use, two calls per day, in wireless coverage area
Temperature Ratings			
Operating:	-0°C to 50°C (32°F to 122°F)		
Storage/Transport	-55°C to 85°C (-67°F to 185°F)		

FCC/IC Statements

FCC ID UI6-ZPTX

- This device complies with Part 15 of the FCC Rules. Operation is subject to the following two conditions: (1) this device may not cause harmful interference, and (2) this device must accept any interference received, including interference that may cause undesired operation.

- Changes or modifications not expressly approved by the party responsible for compliance could void the user's authority to operate the equipment.
- This portable transmitter with its antenna complies with FCC/IC RF exposure limits for general population/uncontrolled exposure.

IC: 6706A-ZPTX

- This Device complies with Industry Canada License-exempt RSS standard(s). Operation is subject to the following two conditions: (1) this device may not cause interference, and (2) this device must accept any interference, including interference that may cause undesired operation of the device.
- Cet appareil est conforme avec les norme(s) exemption de licences RSS d'Industrie Canada. Opération est sujet au deux conditions suivantes. (1) Cet appareil ne peut causer d'interférences, et (2) cet appareil doit accepter toute interférence, y compris les interférences qui peuvent causer un mauvais fonctionnement de l'appareil.