

WAFERLOCK®
Security ∞ Simplicity

**C-700-S04
C-700M-S04
C-700N-S04**

**Standard / Half / Double
Digital Locking**

Standalone Cylinder

User Manual

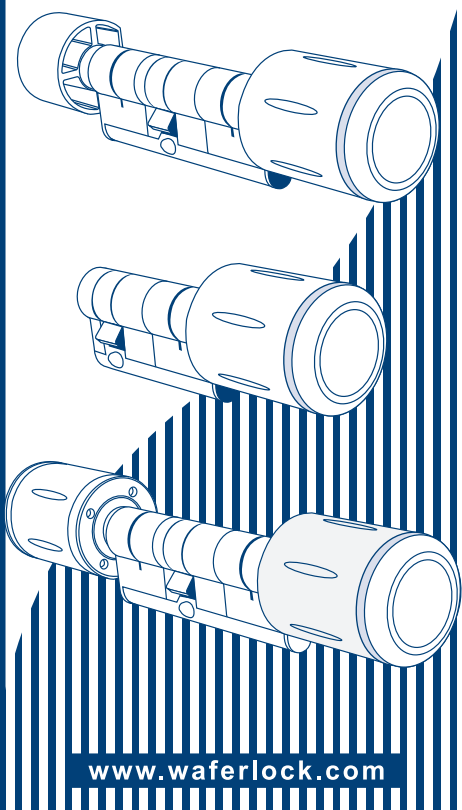

www.waferlock.com

CE Marking

This device has been tested to and conforms to the regulatory requirements of the European Union and has attained CE Marking. The CE Mark is a conformity marking consisting of the letters "CE". The CE Mark applies to products regulated by certain European health, safety and environmental protection legislation. The CE Mark is obligatory for products it applies to: the manufacturer affixes the marking in order to be allowed to sell his product in the European market.

This product conforms to the essential requirements of the R&TTE directive 1999/5/EC in order to attain CE Marking.

The CE Marking is not a quality mark. Foremost, it refers to the safety rather than to the quality of a product. Secondly, CE Marking is mandatory for the product it applies to, whereas most quality markings are voluntary.

WFE TECHNOLOGY CORPORATION

Tel: 886-4-22300362 Fax: 886-4-22377995

No. 16 Ke Yuan 2nd Rd., Central Taiwan Science Park
Taichung city 407, Taiwan.

E-mail: info@waferlock.com

www.waferlock.com

Construction Mode:

If the cylinder(s) is installed on a door, installer can use the following way to access the cylinder(s).

- 1 Take any card (transponder) to approach the reader of the cylinder.

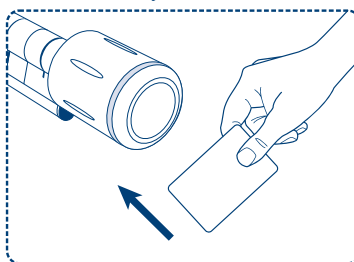

- 2 Green & Red LED will flash 3 times, and motor triggered.

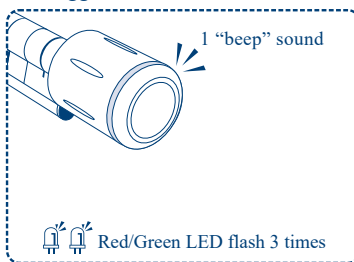

Note 1. Construction Mode can be used during installation of the cylinder if the Programming Card is not programmed yet.

2. Any Mifare card (transponder) will be able to access/open the cylinder before Programming card is learned.

Federal Communication Commission Interference Statement

This equipment has been tested and found to comply with the limits for a Class B digital device, pursuant to Part 15 of the FCC Rules. These limits are designed to provide reasonable protection against harmful interference in a residential installation.

This equipment generates, uses and can radiate radio frequency energy and, if not installed and used in accordance with the instructions, may cause harmful interference to radio communications. However, there is no guarantee that interference will not occur in a particular installation. If this equipment does cause harmful interference to radio or television reception, which can be determined by turning the equipment off and on, the user is encouraged to try to correct the interference by one of the following measures:

- Reorient or relocate the receiving antenna.
- Increase the separation between the equipment and receiver.
- Connect the equipment into an outlet on a circuit different from that to which the receiver is connected.
- Consult the dealer or an experienced radio/TV technician for help.

FCC Caution: To assure continued compliance, any changes or modifications not expressly approved by the party responsible for compliance could void the user's authority to operate this equipment. (Example - use only shielded interface cables when connecting to computer or peripheral devices).

This device complies with Part 15 of the FCC Rules. Operation is subject to the following two conditions:

- (1) This device may not cause harmful interference, and
- (2) This device must accept any interference received, including interference that may cause undesired operation.

Set up the Programming Card:

- 1 Have any Programming Card ready then place it 1~3cm in front of the reader of the cylinder for 10 seconds.

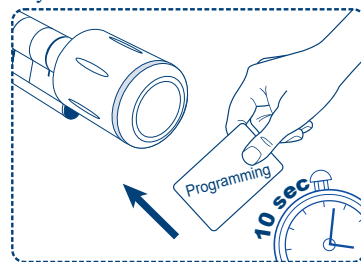

- 2 1 "beep" sound will be heard and Red LED will flash periodically for 10 seconds.

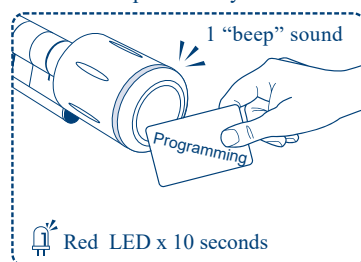

- 3 Within these 10 seconds, do not remove the Programming Card away from the reader.

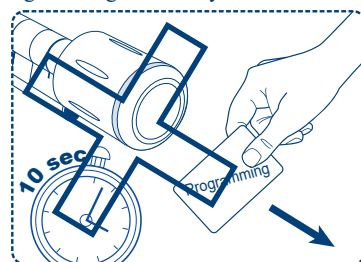

- 4 If the Programming card is learned successfully, 3 "beep" sounds will be heard, and Green LED will flash 3 times.

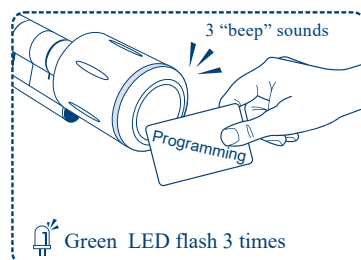

- 5 If you remove the Programming card within 10 seconds, then set up of the Programming card will be failed.

- 6 If failed, repeat from Step 1~4 to try again.

Shadow Programming Card:

Please contact and present this card to your local supplier for assistance in case the Programming Card is lost.

- Note**
1. There is only ONE Programming card per cylinder, please do not lose it.
 2. Programming Card is meant to Add/Delete Users, it can not be used to access/open the cylinders.
 3. Multi locks with One Programming Card: You can use one Programming card for the multiple cylinders. The way to setup the Programming card for each cylinder is the same as above steps.

⦿ Programming Card:

- 1 To add a new user or new Passage Card
Programming Card x 1 time, User Card x 1
time or Passage Card x 1 time.

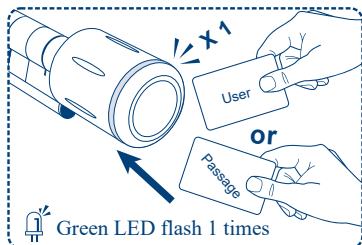
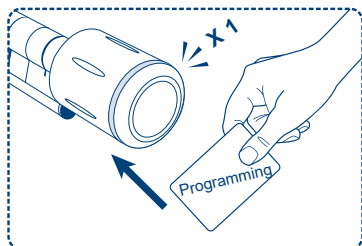

- 2 To delete all users:
Programming Card x 3 times.

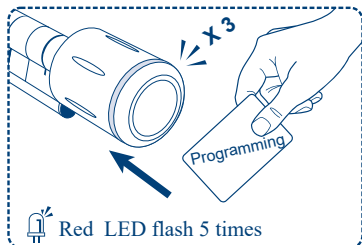

⦿ User Card:

- 1 To open:
User Card x 1 time.

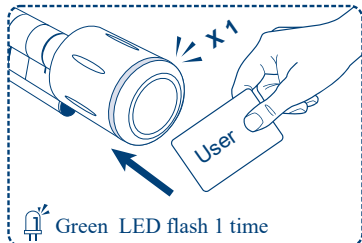

- 2 To activate Passage Mode:
User Card x 1 time for 5 seconds.

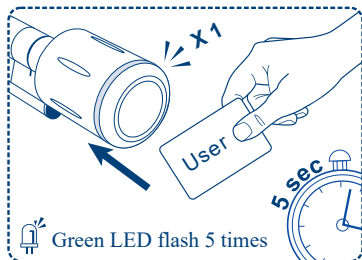

- 3 To deactivate Passage Mode:
User Card x 1 time for 5 seconds.

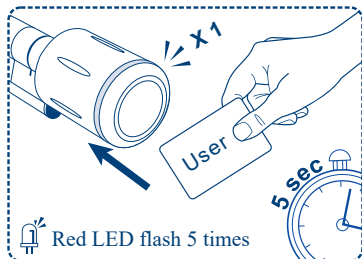

- Note**
1. The maximum user for each cylinder is 1000.
 2. You will hear 10 short beep sounds and Red/Green light flashed 3 times in between when the cylinder is fully programming with 1000 users.

⦿ Enrollment Card:

- 1 To add a batch of User Card
(20, 50 or 75 users)
Programming Card x 1 time,
Enrollment Card x 1 time.

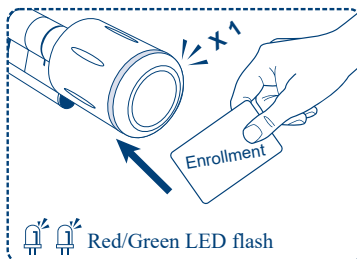
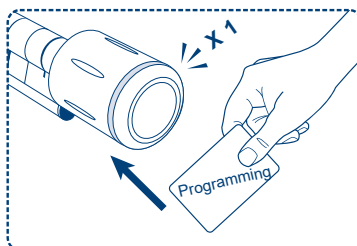

⦿ Shadow Card:

- 1 To delete lost user card:
Programming Card x 1 time, Shadow Card x
1 time for 5 seconds.

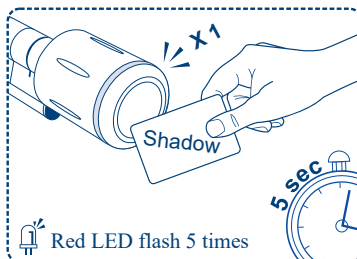
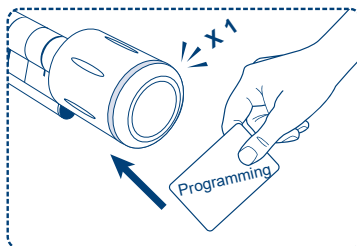

- 2 To delete existing user card:
Programming Card x 1 time, existing
user card x 1 time for 5 seconds.

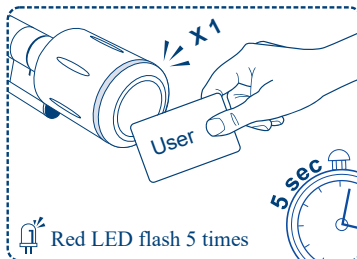
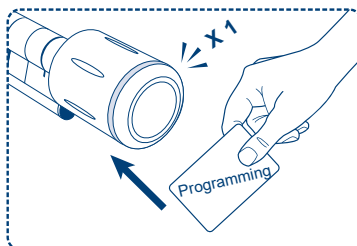

⦿ Passage Card:

- 1 To activate an user card with passage
mode function:
Passage Card x 1 time, User Card x 1 time.

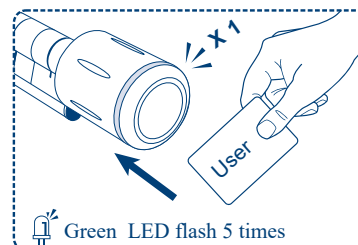
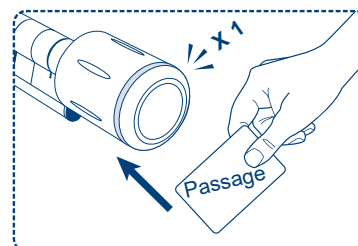

- 2 To deactivate an user card with passage
mode function:
Passage Card x 1 time, User Card x 1 time.

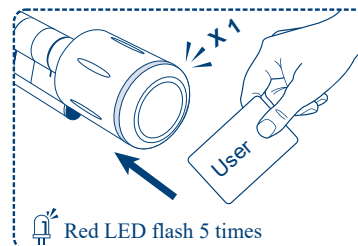
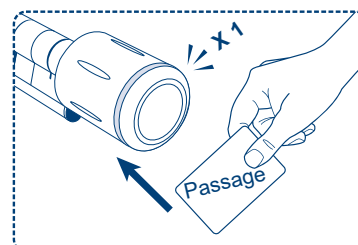

- 3 If Passage Card is lost, please contact
your local supplier to purchase new
Passage Card.

Note Passage Card can only be re-programmed, it can not be deleted.

⦿ Your Warranty

Your Warranty covers all manufacturers' defects in workmanship and material. It does not cover any unit that is damaged beyond normal usage, by improper installations, by contacts to chemicals, or any other acts or omissions unsanctioned within the user manual.

All components are covered for one (1) year after the date of purchase or installation from supplier.

The user is required to provide dated proof of purchase. Waferlock or its authorized distributor will determine if there is a warrantable condition associated with material and/or manufacturing workmanship. If the lock conforms to the warranty conditions, the lock will be repaired free of charge. The shipping freights would be at owner's expense.

The warranty does not include any further obligation whatsoever, including but not limited to the installation of the replacement unit to the customer's lock.

All other warranties, express or implied, are disclaimed. All collateral agreements, which purport to modify this limited warranty, are of no effect.