

Outside

BATTERY INSTALLATION: VEHICLE

1. Turn your vehicle over. Rotate the battery latch to release the battery holder.
2. Slide the battery holder toward the latch.
3. Lift the battery holder out of the vehicle.

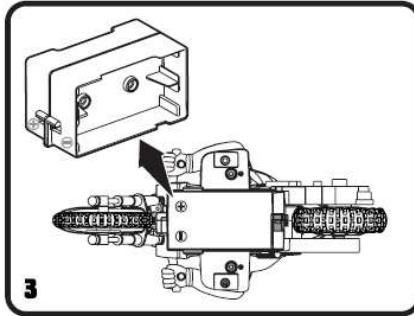

BATTERY INSTALLATION: VEHICLE

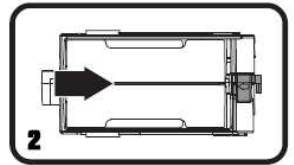
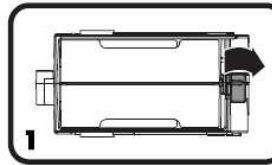

4. Insert 4 AA alkaline batteries into the battery holder, with polarity (+/-) as shown on the battery holder.
5. Replace the battery holder in the vehicle and rotate the latch until it clicks shut, locking the battery holder in place.

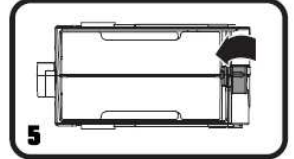
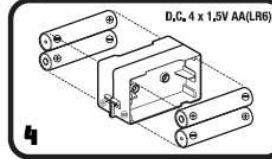

BATTERY INSTALLATION: CONTROLLER

Requires 2 AA type batteries (not included). Use a Phillips screwdriver to unscrew cover, note polarity of batteries, remove and replace with new ones as shown. Attach the cover and fasten screw. Never let a child use this product unless battery door is secure. Batteries are small objects and could be ingested. Keep all batteries away from small children.

Requiert 2 piles AA (non incluses). Dévisser le couvercle en utilisant un tournevis cruciforme, noter la polarité des piles, enlever les piles usées et les remplacer par des piles neuves. Attacher le couvercle et serrer la vis. Ne jamais laisser un enfant utiliser ce produit si le compartiment des piles n'est pas fermé. Les piles sont de petits objets qui risquent d'être avalés. Tenir toutes les piles à l'écart des enfants en bas âge.

BATTERY INSTALLATION: CONTROLLER

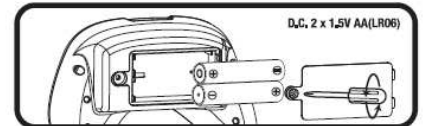

SAFETY INFORMATION

SAFETY INFORMATION

NOTE TO ADULTS NOTE TO ADULTS

Adults, this toy is recommended for children 8 years of age and older. To ensure that the child's play is both safe and fun, please review the operating instructions and these general safety rules with your child. Adults, this toy is recommended for children 8 years of age and older. To ensure that the child's play is both safe and fun, please review the operating instructions and these general safety rules with your child.

SAFETY TIPS SAFETY TIPS

- DO NOT pick up vehicle while in motion.
- Keep fingers, hair and loose clothing away from tires and wheels while the vehicle is switched ON.
- Adult supervision is recommended when this vehicle is being operated.
- To avoid accidental operation, remove all batteries when not in use.
- DO NOT pick up vehicle while in motion.
- Keep fingers, hair and loose clothing away from tires and wheels while the vehicle is switched ON.
- Adult supervision is recommended when this vehicle is being operated.
- To avoid accidental operation, remove all batteries when not in use.

CAUTION: Do not operate vehicle through water or snow. Electronic components can overheat or be damaged as a result of contact with water.

CAUTION: Do not operate vehicle through water or snow. Electronic components can overheat or be damaged as a result of contact with water.

IMPORTANT BATTERY INFORMATION

IMPORTANT BATTERY INFORMATION

- Do not use rechargeable batteries.
- Do not mix new and used batteries.
- Do not mix alkaline, standard or rechargeable batteries.
- Alkaline batteries are recommended.
- Non-rechargeable batteries are not to be recharged.
- Only batteries of the same or equivalent type as recommended are to be used.
- Batteries are to be inserted with the correct polarity.
- Exhausted batteries are to be removed from the toy.
- The supply terminals are not to be short-circuited.
- Do not dispose of batteries in fire, batteries may explode or leak.
- Replace with new batteries at the first sign of erratic operation.

- Ne pas utiliser de piles rechargeables.
- Il ne faut pas mélanger des piles neuves et usées.
- Ne pas mélanger des piles alcalines, standard ou rechargeables.
- Les piles alcalines sont recommandées.
- Les piles non rechargeables ne doivent pas être rechargées.
- Il ne faut utiliser que des piles du type recommandé ou d'un type équivalent.
- Les piles doivent être introduites selon la polarité correcte.
- Les piles usées doivent être retirées du jouet.
- Il ne faut pas court-circuiter les bornes d'alimentation.
- Ne pas jeter les piles au feu car cela présente un risque d'explosion ou de fuite des piles.
- Remplacer les piles par des piles neuves dès que le fonctionnement devient irrégulier.

TROUBLESHOOTING

TROUBLESHOOTING

Symptom Symptom	Probable Cause Probable Cause	Correction Correction
<ul style="list-style-type: none">• Vehicle runs slowly or will not run.• Vehicle runs slowly or will not run.	<ul style="list-style-type: none">• Loose battery connection or vehicle switch not ON.• Weak vehicle or transmitter batteries.• Loose battery connection or vehicle switch not ON.• Weak vehicle or transmitter batteries.	<ul style="list-style-type: none">• Check battery connector and vehicle switch.• Replace with fresh alkaline batteries.• Check battery connector and vehicle switch.• Replace with fresh alkaline batteries.
<ul style="list-style-type: none">• Erratic operation or only short range possible.• Erratic operation or only short range possible.	<ul style="list-style-type: none">• Radio interference likely.• Radio interference likely.	<ul style="list-style-type: none">• Change location (see point 2 - Quick Tips).• Change location (see point 2 - Quick Tips).
<ul style="list-style-type: none">• Vehicle doesn't work after going through water or snow.• Vehicle doesn't work after going through water or snow.	<ul style="list-style-type: none">• Water in the electronics area.• Water in the electronics area.	<ul style="list-style-type: none">• Vehicle will take several hours to dry. Allow to dry thoroughly overnight before trying again.• Operate your vehicle in a dry area. Avoid driving in water and snow.• Vehicle will take several hours to dry. Allow to dry thoroughly overnight before trying again.• Operate your vehicle in a dry area. Avoid driving in water and snow.

WARNING: Not suitable for children under 3 years.

Illustrations may vary from actual products.

Please keep this instruction sheet as well as the packaging for future reference as it contains important information.

ATTENTION: Ne convient pas aux enfants de moins de 3 ans.

Les illustrations peuvent être différentes du produit réel.

Veuillez conserver ce mode d'emploi et l'emballage pour toute référence ultérieure aux informations importantes qu'ils contiennent.

Wicked Cool Toys

10 Canal Street, Suite 327, Bristol, PA 19007

Questions or comments? www.wickedcooltoys.com,
info@wickedcooltoys.com, or 1.888.518.392 in North America.

XTREME CYCLE MOTO-RC

GET STARTED!

Your vehicle has an amazing Gyro Stabilizer that makes it easy to drive - and lets it perform amazing stunts! The stabilizer safely spins at high speed inside the rear wheel, and it works like a gyroscope to help keep your vehicle upright.

Your vehicle has an amazing Gyro Stabilizer that makes it easy to drive - and lets it perform amazing stunts! The stabilizer safely spins at high speed inside the rear wheel, and it works like a gyroscope to help keep your vehicle upright.

1. GET SET! 1. GET SET!

Energize the gyro stabilizer! Hold the vehicle off the ground and push the left control stick all the way forward. Once the stabilizer spins up to full speed, you'll be able to hear it - and if you twist the vehicle from side to side you'll really feel it working!

Energize the gyro stabilizer! Hold the vehicle off the ground and push the left control stick all the way forward. Once the stabilizer spins up to full speed, you'll be able to hear it - and if you twist the vehicle from side to side you'll really feel it working!



Be sure to hold the vehicle by the drive figure, keeping your fingers clear of the wheels.

2. LAUNCH IT! 2. LAUNCH IT!

Now gently hand-launch your vehicle. Set it on the ground and give it a gentle push while pushing the left stick forward. Now you're ready for the coolest stunt driving!

Now gently hand-launch your vehicle. Set it on the ground and give it a gentle push while pushing the left stick forward. Now you're ready for the coolest stunt driving!



CAUTION: Surfaces may become hot and cause burns if electronics get wet. Do not operate vehicle through water or snow.



CAUTION: Surfaces may become hot and cause burns if electronics get wet. Do not operate vehicle through water or snow.

8+

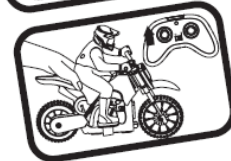
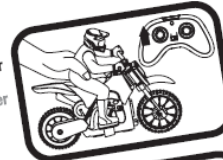

CONTENTS

VEHICLE VEHICLE



CONTENTS

CONTROLLER CONTROLLER

Left Stick - Controls Forward & Braking
Left Stick - Controls Forward & Braking

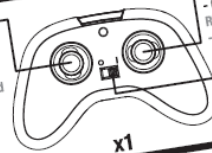

Right Stick - Controls Turning
Right Stick - Controls Turning
ON/OFF Switch
ON/OFF Switch

NOTE: Turn on both your vehicle and controller, LED light flashes indicating pairing in progress. When they are paired, the LED light on the vehicle is on. Then push either controller stick and you will be able to run and control your vehicle.

NOTE: Turn on both your vehicle and controller, LED light flashes indicating pairing in progress. When they are paired, the LED light on the vehicle is on. Then push either controller stick and you will be able to run and control your vehicle.

FEATURES FEATURES

- Full function Full function
- 2.4 GHz radio control 2.4 GHz radio control
- Range up to 65' Range up to 198.1m

TOP VIEW TOP VIEW

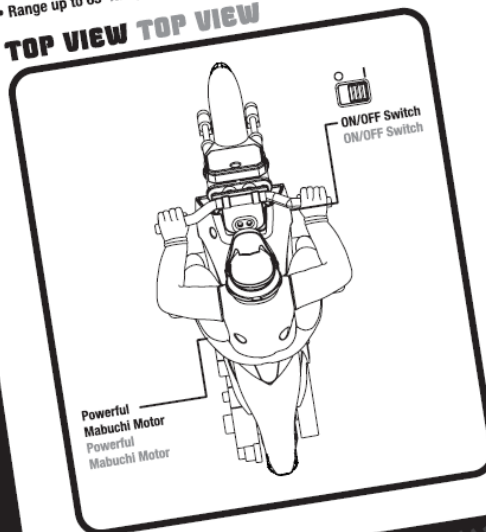

BOTTOM VIEW BOTTOM VIEW

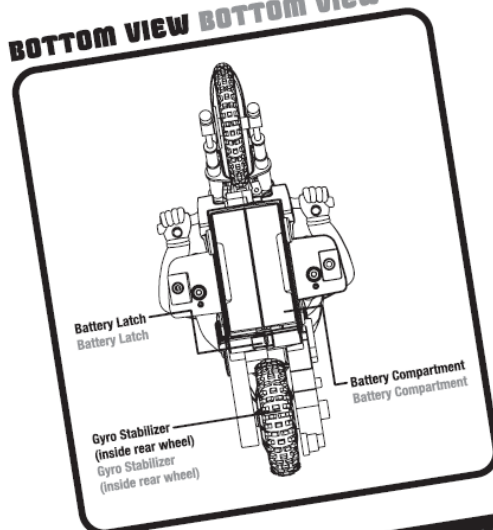

If you have questions about this vehicle, DO NOT RETURN IT TO THE STORE!
Call 1.888.519.1392 for technical help and parts and service assistance.

If you have questions about this vehicle, DO NOT RETURN IT TO THE STORE!
Call 1.888.519.1392 for technical help and parts and service assistance.

QUICK START

QUICK START

Please read this Owner's Manual thoroughly. Please read this Owner's Manual thoroughly.

1. Start with a fresh set of batteries. 1. Start with a fresh set of batteries.
2. Turn vehicle switch ON. Press transmitter controls to run and control your vehicle. 2. Turn vehicle switch ON. Press transmitter controls to run and control your vehicle.
3. When you're done driving, turn vehicle switch OFF. Remove all batteries for storage. 3. When you're done driving, turn vehicle switch OFF. Remove all batteries for storage.

OPERATING YOUR VEHICLE

OPERATING YOUR VEHICLE

FORWARD FORWARD

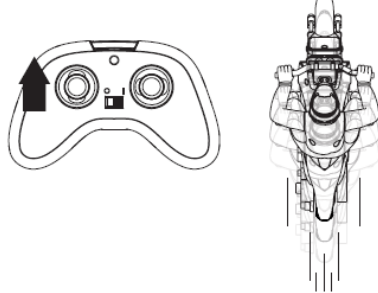

BRAKING BRAKING

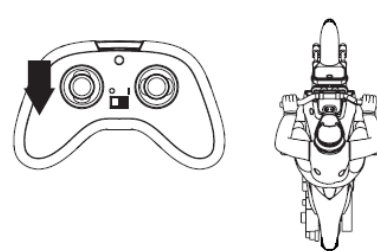

LEFT TURN LEFT TURN

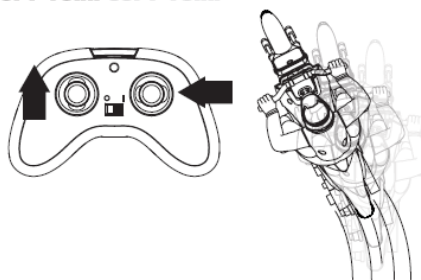

RIGHT TURN RIGHT TURN

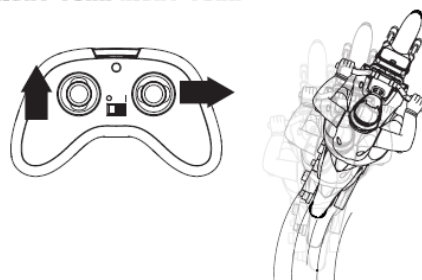

QUICK TIPS

QUICK TIPS

1. When your vehicle starts to lose power, it may lose functions or performance. It's time for fresh batteries. Your vehicle's running time may change depending on your driving style.
2. Radio interference can make your vehicle run badly. Interference can be caused by other R/C vehicles running on the same frequency; electrical wires; large buildings; or CB radios. Try to stay away from these!
3. If your vehicle gets too far away, it won't work properly. Your maximum range should be about 65'.
4. Don't drive your vehicle in sand or through water or snow. If your vehicle does get wet, wipe with a towel and allow to dry completely overnight.
5. Don't store your vehicle near heat or in direct sunlight. Always turn switch OFF and remove all batteries for storage.
1. When your vehicle starts to lose power, it may lose functions or performance. It's time for fresh batteries. Your vehicle's running time may change depending on your driving style.
2. Radio interference can make your vehicle run badly. Interference can be caused by other R/C vehicles running on the same frequency; electrical wires; large buildings; or CB radios. Try to stay away from these!
3. If your vehicle gets too far away, it won't work properly. Your maximum range should be about 19.8m.
4. Don't drive your vehicle in sand or through water or snow. If your vehicle does get wet, wipe with a towel and allow to dry completely overnight.
5. Don't store your vehicle near heat or in direct sunlight. Always turn switch OFF and remove all batteries for storage.

DRIVING TIPS

DRIVING TIPS

1. You can also start with your vehicle resting on its side skid plate: push the left stick forward and steer with the right stick (into and then out of the turn). Your vehicle will get up and go! But remember: if you start this way, it'll take the stabilizer a little while to come up to full speed. And you'll get different results on different driving surfaces.
2. Your vehicle will run really well on hard packed dirt, asphalt and other similar surfaces.
3. When you want to stop, it's best to turn into a skid while braking, instead of hitting the brakes suddenly while going straight.
1. You can also start with your vehicle resting on its side skid plate: push the left stick forward and steer with the right stick (into and then out of the turn). Your vehicle will get up and go! But remember: if you start this way, it'll take the stabilizer a little while to come up to full speed. And you'll get different results on different driving surfaces.
2. Your vehicle will run really well on hard packed dirt, asphalt and other similar surfaces.
3. When you want to stop, it's best to turn into a skid while braking, instead of hitting the brakes suddenly while going straight.

V x 297mmH)

Inside

OPERATING YOUR VEHICLE

OPERATING YOUR VEHICLE

DIRT-DIGGIN' DONUTS! DIRT-DIGGIN' DONUTS!

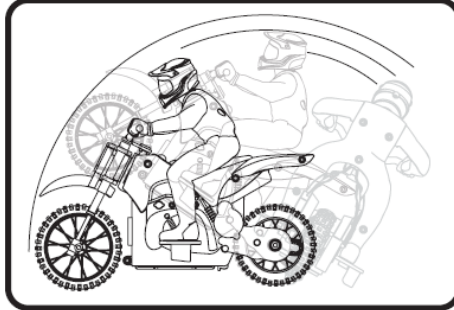

Push the left stick forward to drive straight. Now use the right stick to steer hard (either right or left) into a leaning turn. Now let go of the sticks; your vehicle will glide to a stop on its side skid plate. Quickly, while the Gyro Stabilizer is still spinning, push the left stick all the way forward, and use the right stick to steer "into" the donut. As your vehicle picks up speed, use the right stick to steer "out" of the donut and bring the vehicle upright.

Push the left stick forward to drive straight. Now use the right stick to steer hard (either right or left) into a leaning turn. Now let go of the sticks; your vehicle will glide to a stop on its side skid plate. Quickly, while the Gyro Stabilizer is still spinning, push the left stick all the way forward, and use the right stick to steer "into" the donut. As your vehicle picks up speed, use the right stick to steer "out" of the donut and bring the vehicle upright.



This stunt works best on pavement or hard packed dirt.
This stunt works best on pavement or hard packed dirt.



SIZZLIN' SOMERSAULTS! SIZZLIN' SOMERSAULTS!

For amazing somersault stunts, try driving your vehicle downhill, aiming at a small ramp or bump. When you drive over it, your vehicle may flip into a fearsome forward somersault!

For amazing somersault stunts, try driving your vehicle downhill, aiming at a small ramp or bump. When you drive over it, your vehicle may flip into a fearsome forward somersault!

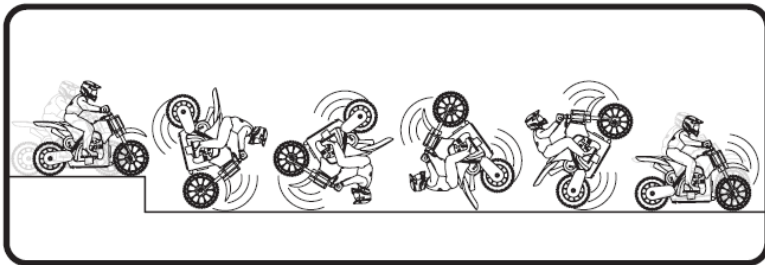

JAMMIN' JUMPS! JAMMIN' JUMPS!

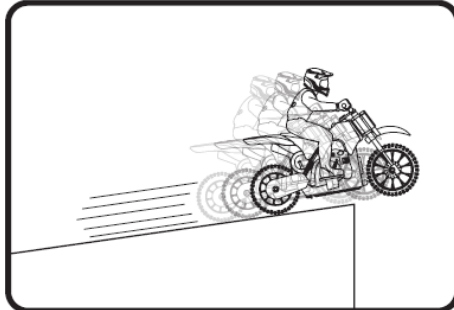

Push the left stick all the way forward to accelerate. Drive your vehicle off a ramp or curb and watch it catch some "big air." For the smoothest jumps, keep the stick pushed forward during the jump. Depending on speed and ramp angle, your vehicle may land on both wheels - or in a full wheelie! Push the left stick all the way forward to accelerate. Drive your vehicle off a ramp or curb and watch it catch some "big air." For the smoothest jumps, keep the stick pushed forward during the jump. Depending on speed and ramp angle, your vehicle may land on both wheels - or in a full wheelie!



You can change the position of your vehicle in mid-air by using the left control stick. Push the stick forward to keep the nose up. Pull back to point the nose down.

You can change the position of your vehicle in mid-air by using the left control stick. Push the stick forward to keep the nose up. Pull back to point the nose down.



STOP & START! STOP & START!

Push the left stick all the way forward to accelerate. Now use the right stick to steer into a skid (either right or left), while reducing speed. When your vehicle's die skid just touches the pavement, quickly jam the left stick forward again and steer out of the turn. Your vehicle will right itself and keep driving to the next exciting stunt!

Push the left stick all the way forward to accelerate. Now use the right stick to steer into a skid (either right or left), while reducing speed. When your vehicle's die skid just touches the pavement, quickly jam the left stick forward again and steer out of the turn. Your vehicle will right itself and keep driving to the next exciting stunt!



FCC Warning

Warning: Changes or modifications to this unit not expressly approved by the party responsible for compliance could void the user's authority to operate the equipment.

NOTE: This equipment has been tested and found to comply with the limits for a Class B digital device, pursuant to Part 15 of the FCC Rules. These limits are designed to provide reasonable protection against harmful interference in a residential installation. This equipment generates, uses and can radiate radio frequency energy and, if not installed and used in accordance with the instructions, may cause harmful interference to radio communications.

However, there is no guarantee that interference will not occur in a particular installation. If this equipment does cause harmful interference to radio or television reception, which can be determined by turning the equipment off and on, the user is encouraged to try to correct the interference by one or more of the following measures:

- Reorient or relocate the receiving antenna.
- Increase the separation between the equipment and receiver.
- Connect the equipment into an outlet on a circuit different from that to which the receiver is connected.
- Consult the dealer or an experienced radio/TV technician for help.