

DAEWOO

PLASMA TELEVISION

USER MANUAL

DPA-5034LDS

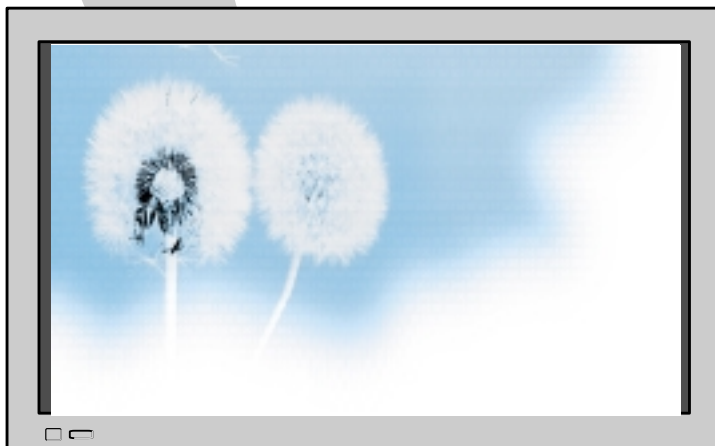

**Proper use guarantees
product life.**

Before using the product, be advised
that you read this user manual well and
try to operate it.

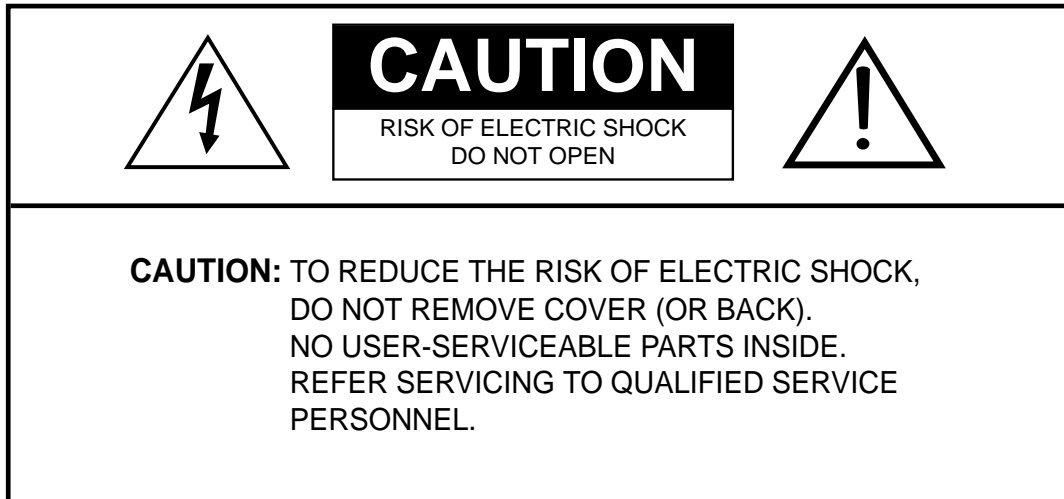

This symbol is intended to alert the user to the presence of uninsulated “dangerous voltage” within the product’s enclosure that may be of sufficient magnitude to constitute a risk of electric shock to persons.



The symbol is intended to alert the user to the presence of important operating and maintenance(servicing) instructions in the literature accompanying the appliance.

WARNING:

TO REDUCE THE RISK OF FIRE OR ELECTRIC SHOCK, DO NOT EXPOSE THIS PRODUCT TO RAIN OR MOISTURE.

CAUTION:

- TO PREVENT ELECTRIC SHOCK, MATCH WIDE BLADE OF PLUG TO WIDE SLOT, FULLY INSERT.
- THE STAND INTENDED FOR USE ONLY WITH THIS PDP TV. USE WITH OTHER APPARATUS IS CAPABLE OF RESULTING IN INSTABILITY CAUSING POSSIBLE INJURY.

Important Safety Instructions

1. Read these instructions.
2. Keep these instructions.
3. Heed all warnings.
4. Follow all instructions.
5. Do not use this apparatus near water.
6. Clean only with a damp cloth.
7. Do not block any of the ventilation openings. Install in accordance with the manufacturer's instructions.
8. Do not install near any heat sources such as radiators, heat registers, stoves, or other apparatus(including amplifiers) that produce heat.
9. Do not defeat the safety purpose of the polarized or grounding type plug. A polarized plug has two blades with one wider than the other. A grounding type plug has two blades and a third grounding prong. The wide blade or the third prong is provided for your safety. When the provided plug does not fit into your outlet, consult an electrician for replacement of the obsolete outlet.
10. Protect the power cord from being walked on or pinched particularly at plugs, convenience receptacles, and the point where they exit from the apparatus.
11. Only use the attachments/accessories specified by the manufacturer.
12. Use only with a cart, stand, tripod, bracket, or table specified by the manufacturer, or sold with the apparatus. When a cart is used, use caution when moving the cart/apparatus combination to avoid injury from tip-over.



13. Unplug this apparatus during lightning storms or when unused for long periods of time.
14. Refer all servicing to qualified service personnel. Servicing is required when the apparatus has been damaged in any way, such as power supply cord or plug is damaged, liquid has been spilled or objects have fallen into the apparatus, the apparatus has been exposed to rain or moisture, does not operate normally, or has been dropped.

Features

- **50" Wide XGA Plasma Panel Television**

- **Built in Analog and Digital Tuner**

PDP has the analog and digital tuner inside for watching terrestrial broadcasting without the need to purchase a separate broadcasting receiver.

- **DVD Direct Connection / Outstanding Picture Quality via a Digital Broadcast Receiver**

A DVD can be directly connected to the unit so that you can view clear digital images. You can enjoy even higher quality images by connecting a digital broadcasting receiver with which digital broadcasts can be viewed.

- **A PC Direct Connection**

PC can be connected to the PDP without a separate device and can be used as a TV making it ideal for presentation, various events and exhibitions.

- **160° Wide-Angle Viewing Area**

- **Flat Panel with No Distortion and Color Blurring**

Since Plasma TV has no problems such as distortion, blurring, flickering unlike existing CRT type displays you can enjoy Home Cinema picture quality and sound.

- **Various Control Functions**

- 4 Languages OSD, 20 Step screen zoom function, Full-screen still function, Various aspect ratio, Keypad lock function, Sleep timer, and so forth.

- **Free Volt (100-240V~, 50/60Hz)**

- **DVI (Digital Visual Interface) Connection**

When connected to a PC, you can receive DVI digital signals as well as the former analog signals by using DVI input and D-Sub input. Furthermore, using the DVI Input, you can receive directly a digital signal from the computer. Consequently, pictures on the screen are much more clear and fresh.

- **CCF(Capsulated Color Filter) Technology for natural color**

CCF Technology makes the picture clearer by controlling of the brightness among three different color filters.

- **MGDI (Meta Genuine Digital Image) Engine**

MGDI is the image enhancement technology of Daewoo Electronics, which provides more clear, splendid, and delicat images.

- **BBE(Bass Boost Effect) Sound Effect**

HDTV
HIGH DEFINITION

MGDI
META GENUINE DIGITAL IMAGE

BBE
DIGITAL

DOLBY
DIGITAL

**This User Manual presents safety precautions and how to use the product.
After reading it thoroughly, use the product safely.
Keep this manual where the user can see it easily.**

Failure to comply with warnings and cautions for the safe use of electric appliances may cause fire or human injury.

FCC RF INTERFERENCE STATEMENT

NOTE :

This equipment has been tested and found to comply with the limits for a Class B digital device, pursuant to Part 15 of the FCC Rules. These limits are designed to provide reasonable protection against harmful interference in a residential installation.

This equipment generates, uses and can radiate radio frequency energy and, if not installed and used in accordance with the instructions, may cause interference to radio communications. However, there is no guarantee that interference will not occur in a particular installation.

If this equipment does cause interference to radio or television reception which can be determined by turning the equipment off and on, the user is encouraged to try to correct the interference by one or more of the following measures.

- Reorient or relocate the receiving antenna.
- Increase the separation between the equipment and receiver.
- Connect the equipment into an outlet on a circuit different from that to which the receiver is connected.
- Consult authorized service centers for help.
- Only shielded interface cable should be used.

Finally, any changes or modifications to the equipment by the user not expressly approved by the grantee or manufacturer could void the users authority to operate such equipment,

Safety Precautions

Power

Always obey all safety messages.

- All the safety and operating instructions should be read before the product is operated. If anything strange happens, unplug this product from the wall outlet.
- Do not disassemble or replace any parts of the TV. Refer to a qualified service personnel for repair.

WARNING

You can be dead or seriously injured if you do not follow instructions.

During a lightning storm, or when it is left unattended and unused for a long period of time, unplug it from the wall outlet.

It can result in fire.

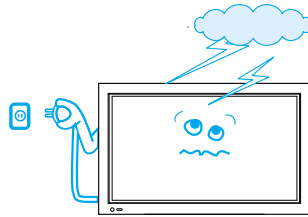

When unplugging your TV, always grip plug firmly and pull straight out from the receptacle.

It can result in fire or electric shock due to damaged power cord.



This product must be properly grounded.

- Improper grounding may cause malfunction or electric shock.
- When proper grounding is not possible, install circuit breaker.
- Do not ground to gas pipe, water pipe, lightning rod, or telephone line.

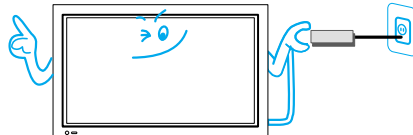

During a lightning storm, unplug the TV from the wall outlet, and do not touch the antenna.

It can cause fire or electric shock.

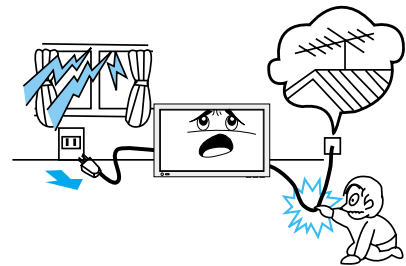

Installation

Do not use this product in the neighborhood of a bath or shower.

It can result in electric shock or fire.

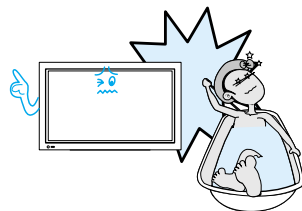

Do not place this TV on an unstable cart, stand, or table

It may cause the product and cart to overturn, damaging equipment or causing possible injury.

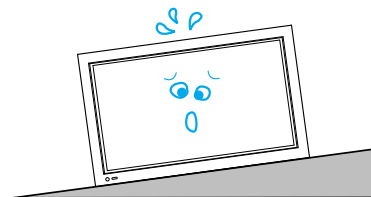

During Use

Do not open the cover (or back) because high voltage is present within the TV enclosure.

It may cause electric shock.

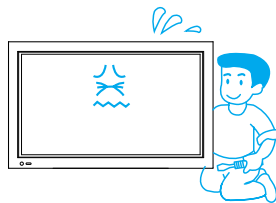

Never push any kind of objects into this product through openings at the back of TV.

It may cause fire or electric shock.

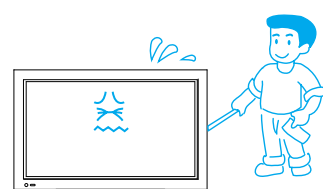

The apparatus shall not be exposed to dripping or splashing and that no objects filled with liquids, such as vases, shall be placed on the apparatus.

Spilled liquids may cause electric shock or fire.

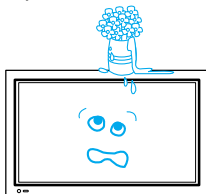

Do not allow children to play or hang on the TV.

These actions may tip it over, causing personal injury.

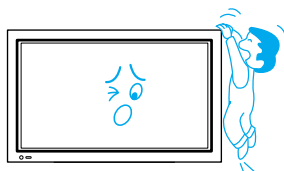

Do not place a candle or lighted cigarette on the TV.

If these fall into the inside of the TV, it may cause a fire or explosion.

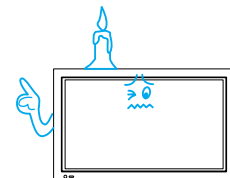

Do not disassemble batteries, and do not leave around in case children swallow them.

Heavy metal may contaminate environment, and can be harmful or detrimental to human health. (If children swallow the batteries, go to hospital and consult with a doctor.) Batteries could explode if Fitted incorrectly. Align the batteries according to the (+) and (-) indication inside the case.

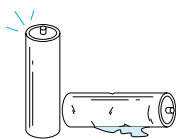

Do not spray water onto the TV or wipe with damp cloth.

It may cause an electric shock or fire.

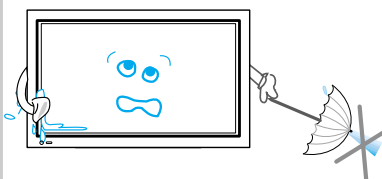

Unplug the TV from the wall outlet when smoke or a strange smell occurs, then refer to a service personnel.

Leaving the TV on in this condition, may cause fire or electric shock.

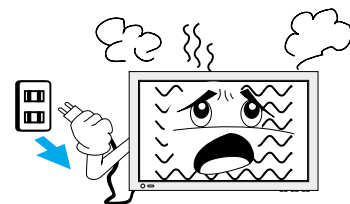

Safety Precautions

Always obey all safety messages.

- All the safety and operating instructions should be read before the product is operated.

CAUTION

You can be injured, or this product or any other of your property can be damaged if you don't follow instructions.

Power

When moving your TV, remove the power plug, antenna, and cables, and be sure to move it by using two people..

Failure to follow this instruction can result in electric shock or personal injury.

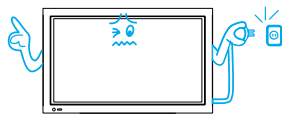

Do not touch the power plug with wet hands when plugging or unplugging it into the wall socket.

It can result in a risk of electric shock.



Installation

Do not install the product where there is oil, smog, moist, or dust

It may cause malfunction.

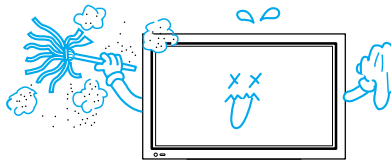

Do not install the product where it will be exposed to the direct sunlight, and the product should not be near heat sources such as radiators, stoves, etc.

It may cause malfunction.

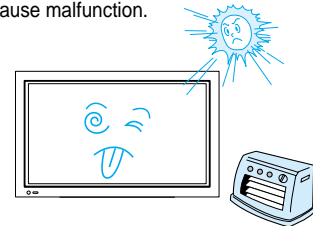

For proper ventilation, separate the product from the wall, and keep a distance of more than 10cm (4").

Due to the increase of temperature inside the TV, it may cause fire.

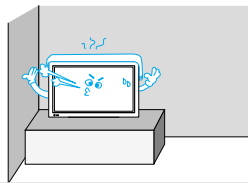

Minimum distances around the apparatus for sufficient ventilation.

Due to the increase of temperature inside the TV, it may cause fire.

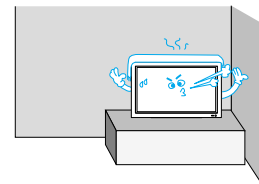

If you wish to install this product on the wall or ceiling, refer to a professional.

Failure to do so may cause damage to product and injury to human.



When using an outside antenna system, do not install it in the vicinity of overhead power lines.

If the antenna touches such power lines, it may cause electric shock.

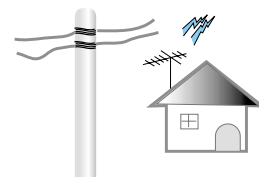

During Use

The plasma television panel consists of fine cells. Although the panels are produced with more than 99.9 percent active cells, there may be some cells that do not produce light or remain lit.

Do not allow a still picture to be displayed for an extended period, as this can cause a permanent ghost image to remain on the Wide Plasma Television.

Examples of still pictures include logos, video games, computer images, teletext and images displayed in 4:3 mode.

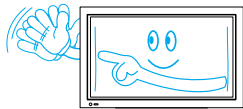

Warranty does not cover any damage caused by image retention.

Do not wipe the TV using a cloth damped with chemicals (benzene, thinner, etc.).

TV appearance may be marred. (Unplug the power plug and wipe with soft cloth.)

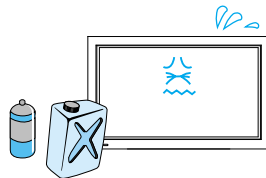

Do not place heavy objects or heat sources on the power cord.

It may damage the power cord, causing fire or electric shock.

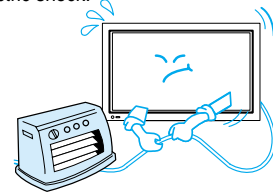

Do not place any object or cover on the TV.

In an event of improper ventilation, the TV will be overheated causing fire.



When watching the TV, the distance between the TV screen and your eye should be as 5-7 times as the diagonal distance of the TV.

Watching the TV for a long time may hurt your eye sight.

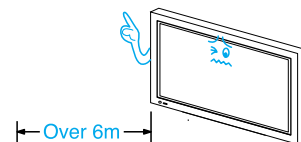

When cleaning of the inside of the TV is required, consult to the qualified service personnel.

When the TV is not cleaned for a long period of time, dust in it may cause fire or malfunction.



When the TV is placed on a cart or table, the front side of the TV should not project outward.

Unbalance may cause the TV to drop, resulting in personal injury or equipment malfunction and damage.

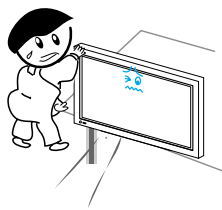

Do not grip speakers when moving the TV attached with speakers.

When moving the TV while gripping speakers, speakers may be fallen away from the TV due to its weight, causing personal injury.

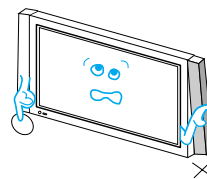

Checking Accessories



Note

Check to be sure that the following items are packed with your Plasma panel.

Supplied Accessories

Remote Control

1 UNIT

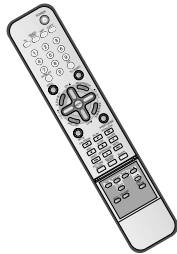

Component Cable (Option) 1 UNIT

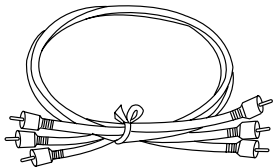

A/V Cable (Option)

2 UNITS

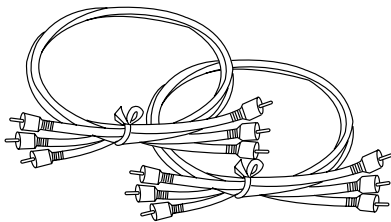

Ferrite Core

2 UNITS



Place the small ferrite cores in the speaker cables close to the speaker terminals of the PDP unit.

Speaker(2 units)

Coaxial Cable (Option)

1 UNIT

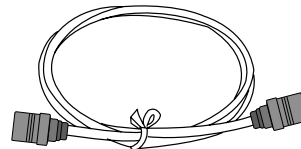

AC Cable 1 UNIT



Note

The following items are optional accessories.
Refer purchasing optional accessories from
Daewoo Electronics Local retailer or the retailer
from where you purchased the unit.

Optional Accessories

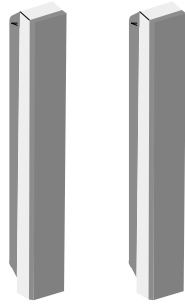

Speakers

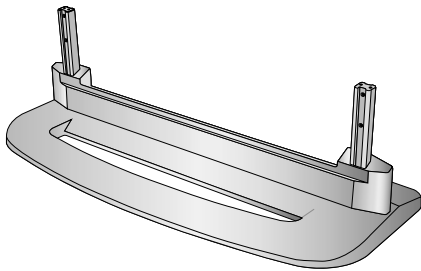
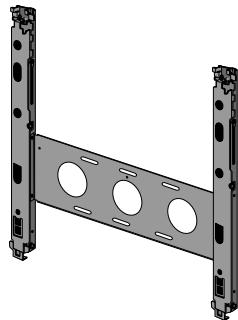

Table Top Stand



Wall Mounting Unit



CONTENTS

PREPARATION

- 6 • Safety Precautions
- 10 • Checking Accessories
- 14 • Panel Controls
- 15 • Remote control
- 16 • Remote Control Setup

CONNECTION

- 17 • Antenna Connection
- 20 • To Watch TV
- 22 • Channel Setup
- 28 • Watching Digital Broadcasts
- 30 • Watching Cable Broadcasts
- 32 • Watching Satellite Broadcasts
- 34 • Watching a DVD Image
- 36 • Watching a VCR Image
- 38 • Watching a Camcorder/Game Console Image
- 40 • Connecting PC(15Pin D-Sub)
- 42 • Connecting PC(DVI)

APPLICATION

- 45 • Selecting Picture Mode
- 46 • Customizing Picture
- 48 • Adjusting Screen Size
- 50 • Adjusting Screen Size(PC, DVI)
- 52 • Enlarging Screen Size
- 54 • Watching a Still Image
- 55 • Adjusting Auto Sound Mode
- 56 • Customizing Sound Mode
- 58 • Selecting INPUT SIGNAL
- 60 • Checking the Current Input Signal
- 61 • MENU Background, Languages and Keypad Lock Settings
- 63 • MGDI (Meta Genuine Digital Image)
- 65 • Closed Caption Setting
- 67 • Time Setting
- 69 • Image Sticking Minimization(ISM)
- 71 • Parental Lock Setting
- 75 • Initialize Setting
- 77 • Setting Sleep Timer

MISC.

- 78 • Before Requesting Service
- 79 • SPECIFICATIONS

Antenna Connection

Outdoor Antenna Connection

- when watching both analog and digital broadcasts through outdoor antenna connection

1 Connect a antenna coaxial cable to the input terminal

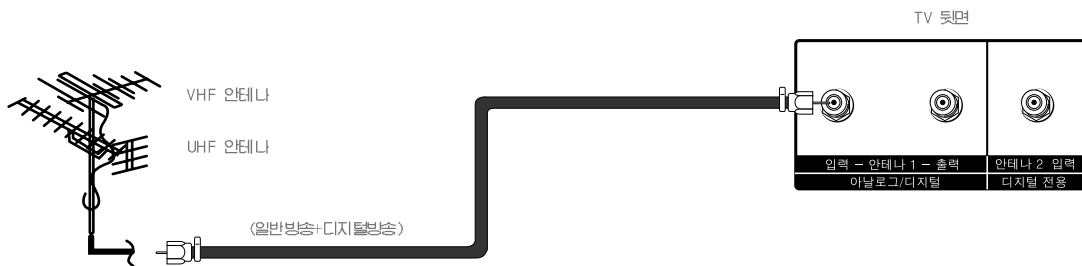

2 Select Input

- 메뉴 → 채널

아날로그 : "일반"
디지털 : "일반"
안테나2 : "사용안함"

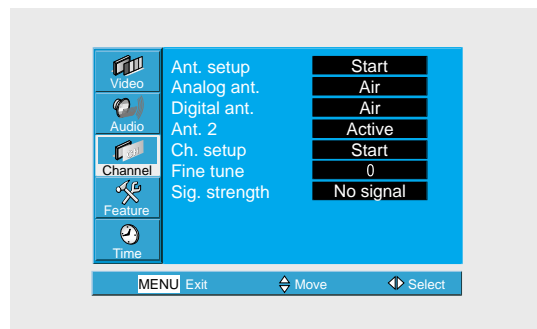
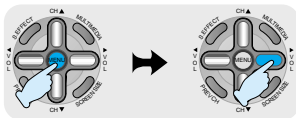

- Different items will be displayed depending on whether to receive digital broadcast or analog broadcast.
- Choosing "Ant. setup" will automatically set following items : Analog, Digital and Antenna 2.

3 Execute automatic channel setting. Refer to 42

Shared Antenna Connection

- when watching both analog and digital broadcasts through antenna connection in your apartment.
- Please contact your apartment office for terrestrial digital broadcast.

1 Connect the TV's antenna 1 to the antenna socket as shown figure



2 Select Input

• 메뉴 → 채널 → 안테나 설정

아날로그 : "일반"
디지털 : "일반"
안테나2 : "사용안함"

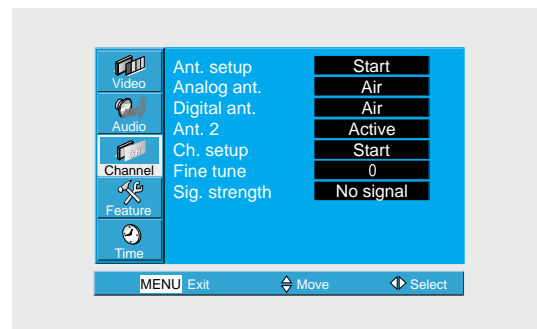
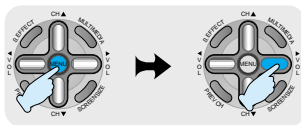

3 Execute automatic channel setting. Refer to 42



Watching Cable Broadcasts with cable broadcast receiver

- When receiving digital broadcasts from a cable broadcast.
- Please contact your local cable TV company for terrestrial digital broadcast.

1 Connect signal divider and coaxial cables as shown figure

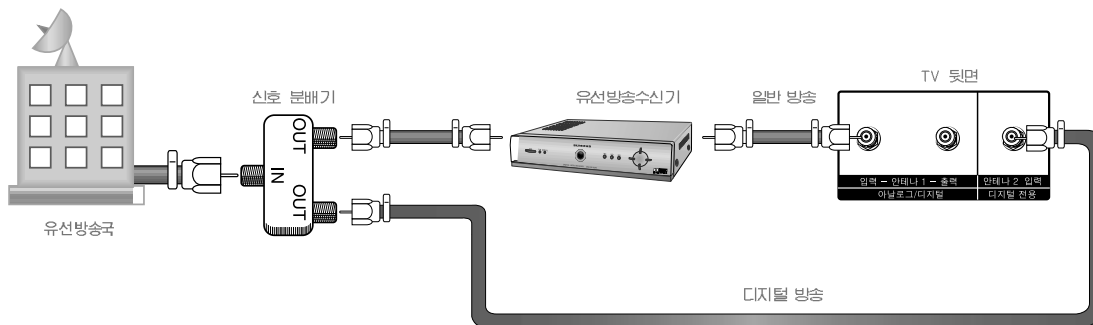

2 Select Input

· 메뉴 → 채널 → 입력신호 선택

아날로그 : "유선"
 디지털 : "유선"
 안테나2 : "사용"

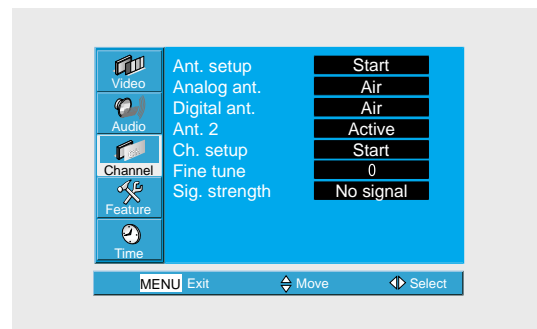
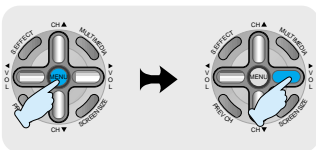

3 Execute automatic channel setting. Refer to 42

Watching Cable Broadcasts without cable broadcast receiver

- When receiving digital broadcasts from a cable broadcast.
- Please contact your local cable TV company for terrestrial digital broadcast.

1 Connect the TV's antenna 1 to the antenna socket as shown figure.

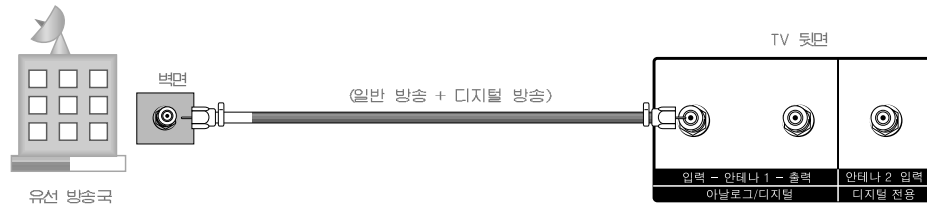

연
결
편

2 Select Input

· 메뉴 → 채널 → 입력신호 선택

아날로그 : "유선"
디지털 : "유선"
안테나2 : "사용안함"

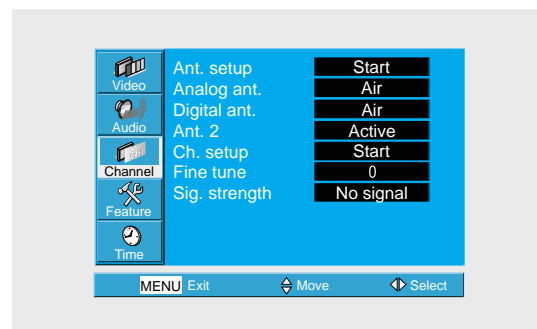
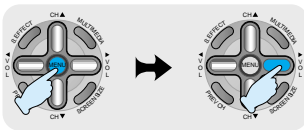

3 Execute automatic channel setting. Refer to 42



Watching Digital Broadcasts Through Digital Antenna

- Use digital(only) antenna when your local cable broadcast company does not transmit digital broadcasts or unable to receive digital broadcasts over the existing antenna.
- Use UHF antenna for digital(only) antenna.
- Install the antenna where there aren't any obstacles.
- It may be difficult to receive for areas with many signal obstacles.
- If receive many identical digital channel, it is possible to select identical channel several times. It is convenient to erase unnecessary channels using "Memorize/Eraser" button.

1 Connect the TV's antenna 2 to the antenna socket as shown figure

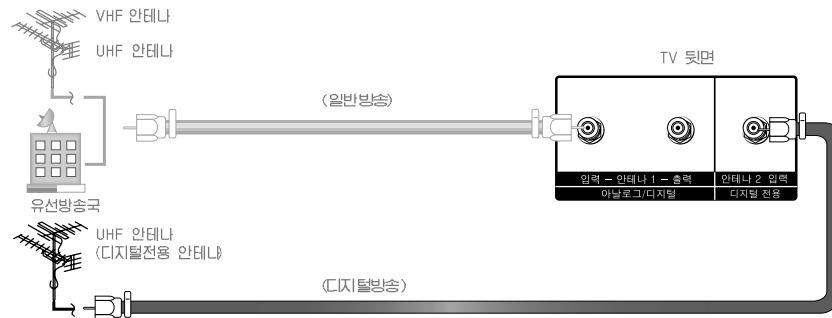

2 Select Input

• 메뉴 → 채널 → 안테나 설정

아날로그	: "일반" 혹은 "유선"
디지털	: "일반"
안테나2	: "사용"

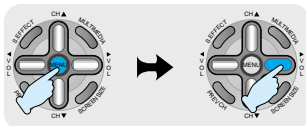

3 Execute automatic channel setting. Refer to 42

Connecting Antenna Output Terminal(Recording etc.)

- Use this feature when record TV broadcast to external recording devices.

1 Connect signal divider and coaxial cables as shown figure.



2 Turn on the TV and the device.

3 From the menu select channel. then choose "Antenna 2" from analog antenna/digital antenna "Air" or "Cable".

4 REcord programs received through TV's Antenna 1 input (Digital Broadcast are NOT recordable).

Watching Cable Broadcasts

Watching Cable Broadcasts

- To watch cable broadcasts, subscribe to your local Cable TV Broadcasting, and then connect a cable Broadcasting Receiver TV to the PDP as shown right.

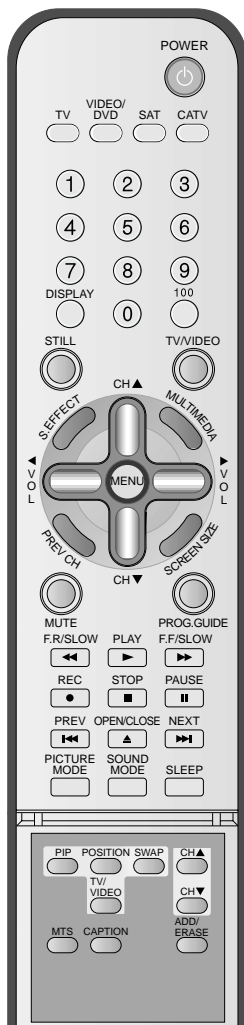

1 Connect a Cable Broadcasting Receiver to the PDP.

- Prepare the AV cable.
- Connect the receiver(Output) to PDP(Video Input) as shown below.
- When connecting to an external AV source, be sure to match the colors.

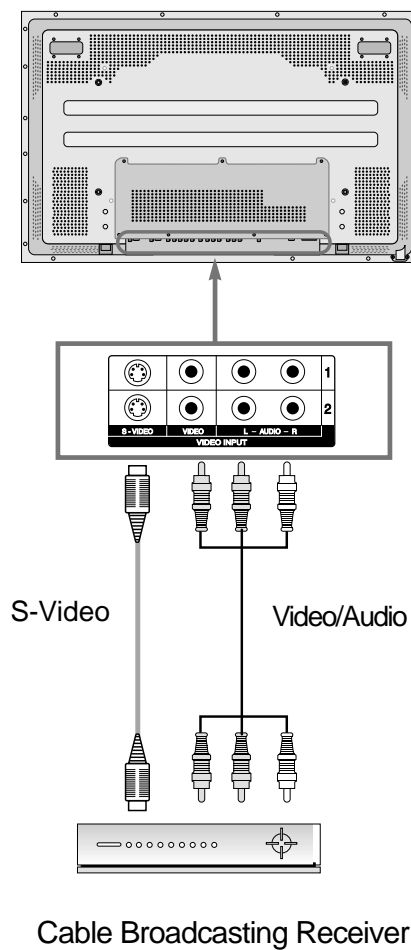

2 Press the Power Buttons

POWER



- Turn the PDP and the Receiver ON.

3 Input Select



- Select [Video 1 or Video 2] by pressing the TV/VIDEO button of the Remote Control or the "INPUT SELECT" Key in KeyPad of the pdp set.
- Each time you press the "TV/VIDEO" button, different input modes appear. The sequence is as follows:

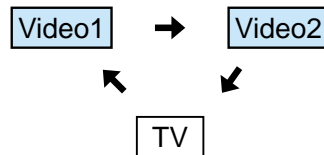

4 Select a Desired Channel and Function

- Select a desired channel and function by using the Remote Control of the Cable Broadcasting Receiver.



NOTES:

- 1) If your local cable company re-transmits digital broadcasts, you may watch normal broadcasts or digital broadcasts simultaneously. For detailed information, refer to your local cable company.

Watching Digital Broadcasts

Watching Digital Broadcasts

- To watch digital broadcasts:
 - Purchase a separate digital Broadcasting Receiver (SET-TOP BOX)
 - Connect the PDP to a Digital Broadcasting Receiver as shown right.

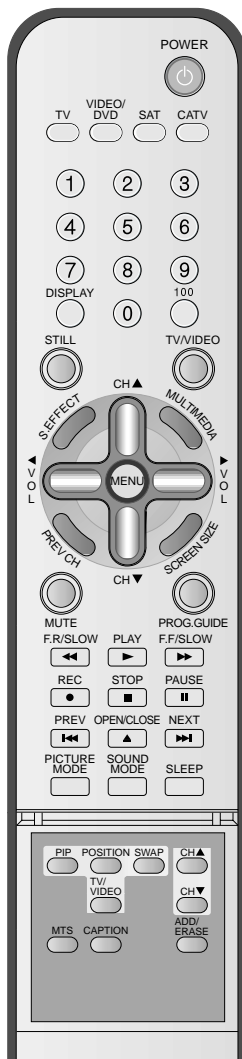

1 Connect a Digital Broadcasting Receiver to the PDP

- Prepare supplied A/V cables.
- Connect the cables from the Digital TV Receiver output terminal to the PDP (Component 1, 2) input terminal.
- When connecting the cables, be sure to match the cable colors.

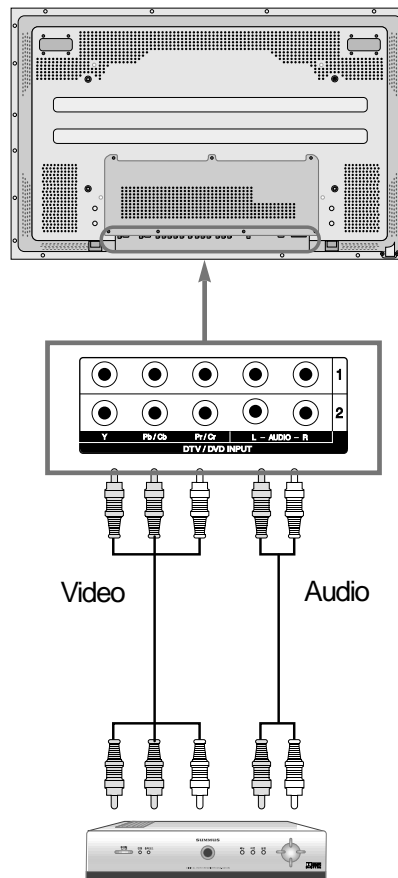

Digital Broadcasting Receiver (Set-Top Box)

2 Press the Power Buttons

POWER



- Turn the PDP and the Receiver ON.

3 Input Select



- Select [Component 1 or Component 2] by pressing the "Multimedia" button of the Remote Control or the "INPUT SELECT" Key in KeyPad of the pdp set.
- Each time you press the "Multimedia" button, different input modes appear. The sequence is as follows:

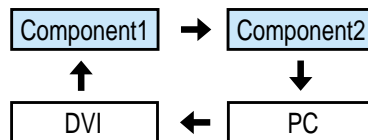

4 Select a Desired Channel and Function

- Select a desired channel and function by using the Remote Control of Digital Broadcasting Receiver.



NOTES:

- 1) You can select input using [INPUT SELECT] button in the keypad of the pdp set. The used sequence is as follows:
TV -> PC -> DVI -> Component1 -> Component2 -> Video1 -> Video2
- 2) Possible Digital Broadcasting signals: 1080i, 720p, 480p.
- 3) Antenna Connection:
Apartment : Check if community antenna receives digital broadcasts.
Private Houses: Set the indoor/outdoor UHF antenna to the direction of the digital broadcasting transmitting company.
- 4) For detailed connection method, refer to the Owner's Manual of Digital Broadcasting Receiver.
- 5) What is a component? : Signals with which brightness and color are separated, producing a sharp picture.
- 6) If the Digital Broadcasting Receiver has PC Output terminal or DVI Output terminal, connect to 'PC INPUT' or 'DVI INPUT' at the back panel of the PDP.
When watching the PDP by PC or DVI Input, some undesired signals may be seen at the top and bottom area of the screen. In this case, select [Menu] -> [Screen] -> [V. Size] to adjust.

Watching Cable Broadcasts

Watching Cable Broadcasts

- To watch cable broadcasts, subscribe to your local Cable TV Broadcasting, and then connect a cable Broadcasting Receiver TV to the PDP as shown right.

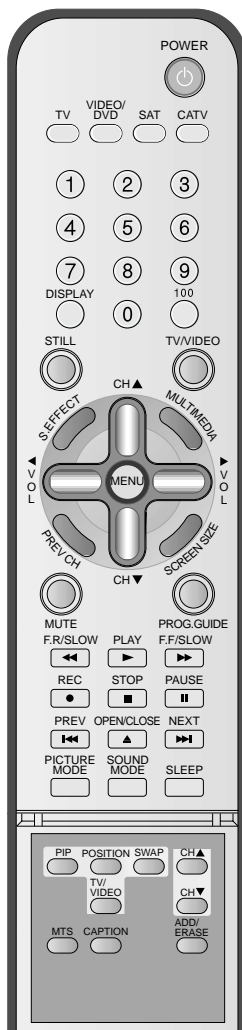

1 Connect a Cable Broadcasting Receiver to the PDP.

- Prepare the AV cable.
- Connect the receiver(Output) to PDP(Video Input) as shown below.
- When connecting to an external AV source, be sure to match the colors.

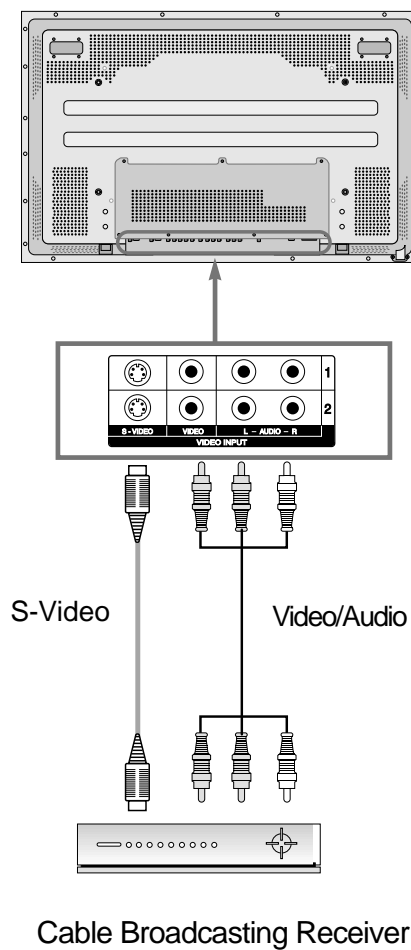

2 Press the Power Buttons

POWER



- Turn the PDP and the Receiver ON.

3 Input Select

TV/VIDEO



- Select [Video 1 or Video 2] by pressing the TV/VIDEO button of the Remote Control or the "INPUT SELECT" Key in KeyPad of the pdp set.
- Each time you press the "TV/VIDEO" button, different input modes appear. The sequence is as follows:

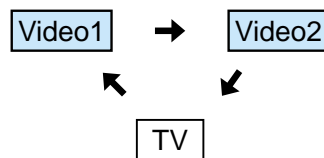

4 Select a Desired Channel and Function

- Select a desired channel and function by using the Remote Control of the Cable Broadcasting Receiver.



NOTES:

- 1) If your local cable company re-transmits digital broadcasts, you may watch normal broadcasts or digital broadcasts simultaneously. For detailed information, refer to your local cable company.

Watching Satellite Broadcasts

Watching Satellite Broadcasts

- To watch satellite broadcasting, subscribe to Digital Satellite Broadcasting, then connect satellite Broadcasting Receiver to the PDP as shown right.

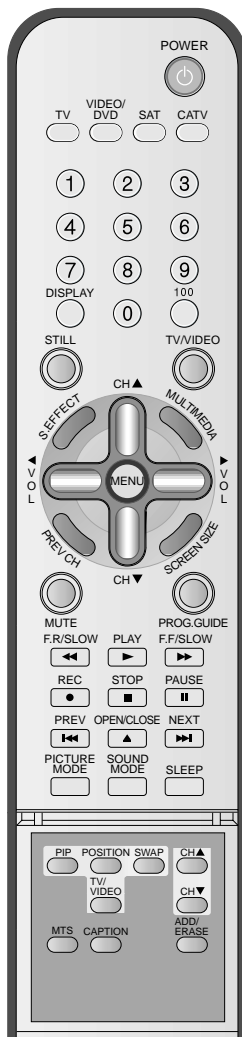

1 Connect a Satellite Broadcasting Receiver to the PDP.

- Prepare the AV cable.
- Connect the receiver(Output) to PDP(Video Input) as shown below.
- When connecting to an external AV source, be sure to match the colors.

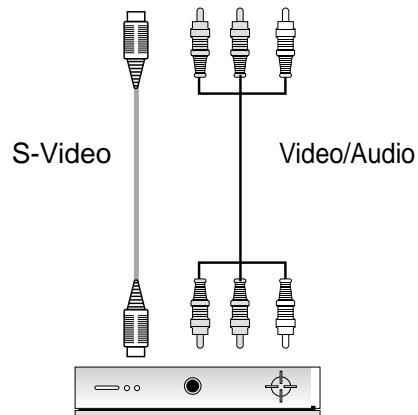
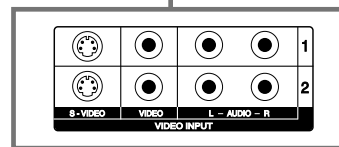
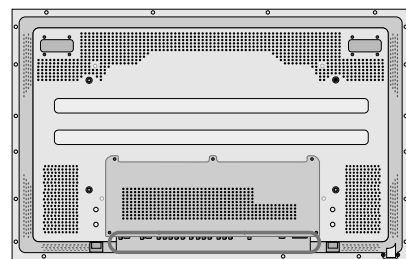

Satellite Broadcasting Receiver

2 Press the Power Buttons

POWER



- Turn the PDP and the Receiver ON.

3 Input Select

TV/VIDEO



- Select [Video 1 or Video 2] by pressing the TV/VIDEO button of the Remote Control or the "INPUT SELECT" Key in KeyPad of the pdp set.
- Each time you press "TV/VIDEO" button, a different input mode appears. The sequence is as follows:

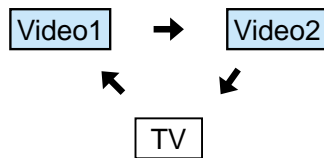

4 Select a Desired Channel and Function

- Select a desired channel and function by using the Remote Control of the Satellite Broadcasting Receiver.

Watching a DVD Image

Watching a DVD Image

- Component Input is set to 480i and 480p mode.
- Connect the cable from the DVD Video Output (Y, Pb/Cb, Pr/Cr) to the Component Input at the back of PDP, and connect the cable from DVD Audio output (Left, Right) to the Audio Input at the back of PDP.

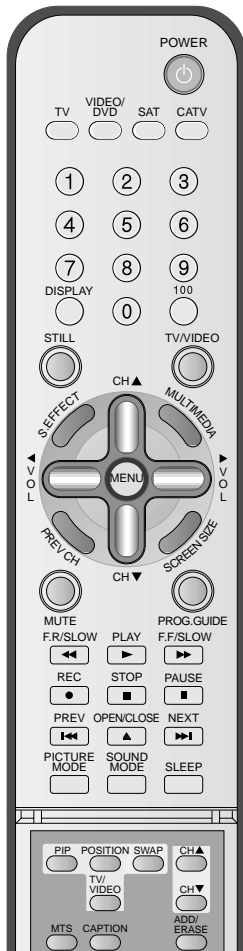

1 Connect a DVD Player to the PDP.

- Prepare the AV cable.
- Connect the DVD(Output) to the PDP(Component or Video Input) as shown below.
- When connecting to an external AV source, be sure to match the colors.

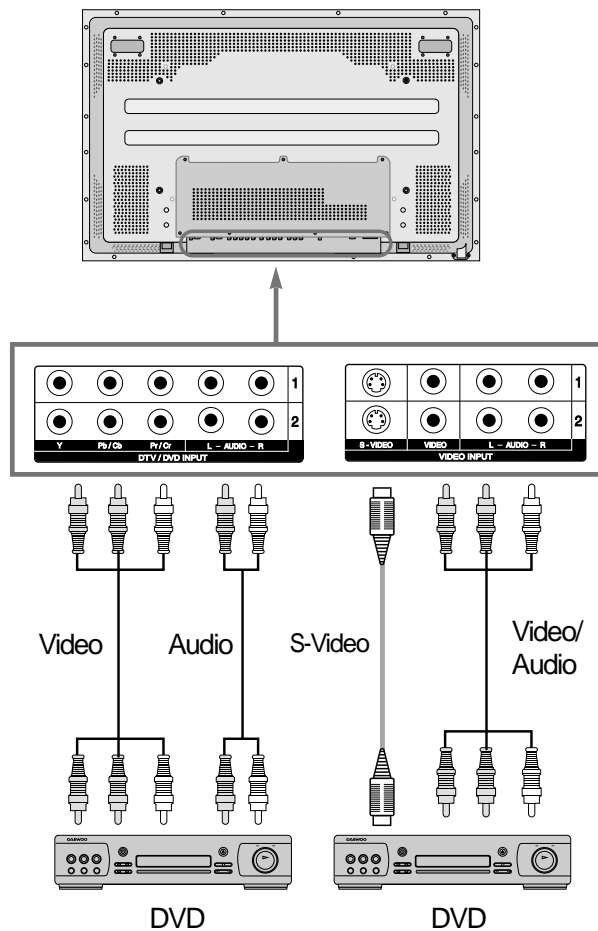

2 Press the Power Buttons

POWER



- Turn the PDP and the DVD ON.

3 Input Select



- Select [Component 1 or Component 2, Video1, Video2] by pressing the "MULTIMEDIA" or "TV/VIDEO" button of the Remote Control or the "INPUT SELECT" Key in KeyPad of the PDP set.
- Each time you press the "MULTIMEDIA" or "TV/VIDEO" button, a different input mode appears. The sequence is as follows:

- **"MULTIMEDIA" button**

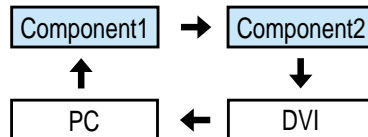

- **"TV/VIDEO" button**

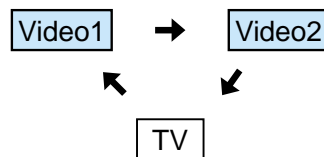

4 Select a Desired Title and Function

- Select a desired title and function by using the Remote Control of the DVD.



NOTES:

- 1) Y/Cb/Cr, which stands for DVD Player's Output Terminal, can also be written as Y/B-Y/R-Y, Y/Pb/Pr depending on the kinds of DVD devices.
- 2) The way of connecting the DVD to the PDP is as follows:
Y ↔ Y Cb ↔ Pb, B-Y, Cr ↔ Pr, R-Y
- 3) The DVD output can be Video, S-Video and/or Component Video depending on the DVD devices. There are various output modes, so be sure to check when you purchase it.
- 4) When connecting S-Video and Video simultaneously, only S-Video will be displayed on the screen.

Watching a VCR Image

Watching a VCR Image

- Video can use either the video terminal or the S-video terminal.

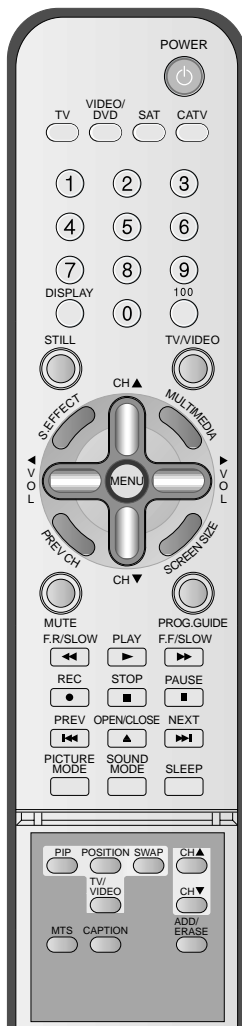

1 Connect a VCR to the PDP.

- Prepare the AV cable.
- Connect the Video(Output) to PDP(Video Input) as shown below.

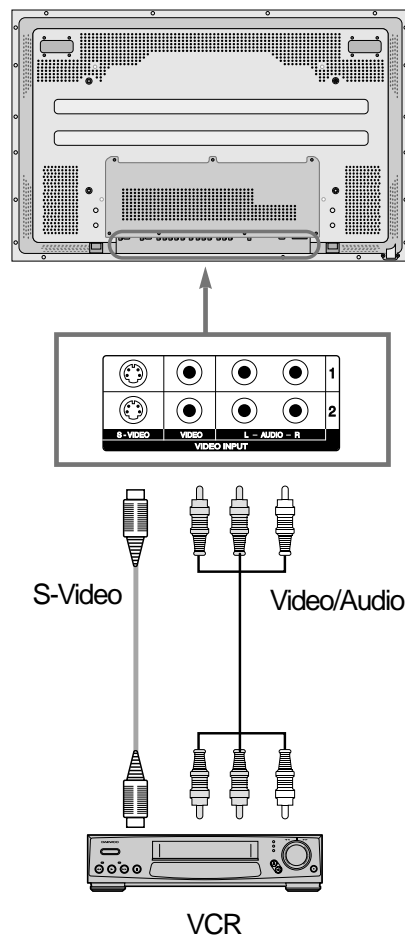

2 Press the Power Buttons

POWER



- Turn the PDP and the VCR ON.

3 Input Select



- Select [Video 1 or Video 2] by pressing the "TV/VIDEO" button of Remote Control or the "INPUT SELECT" Key in Keypad of the pdp set.
- Each time you press the "TV/VIDEO" button, a different input mode appears. The sequence is as follows:

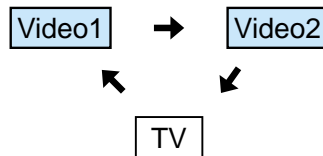

4 Select a Desired Title and Function

- Select a desired title and function by using the Remote Control of the VCR.



NOTES:

- 1) When connecting a Video, the S-Video terminal provides a better image than the Video terminal.
- 2) When connecting to the Video terminal, connect 3 color AV cables (video, left audio, right audio) to the PDP; for the S-Video terminal, connect the Audio terminal (Left, Right) in the same way, and connect the S-Video cable (sold separately).
- 3) When connecting the Video terminal and the S-Video simultaneously, the S-Video terminal is selected. This can be checked by the "DISPLAY" button of the Remote Control.

Watching a Camcorder/Game Console Image

Watching a Camcorder/Game Console Image

- Enjoy images recorded by camcorder or the game console after connecting to the PDP.

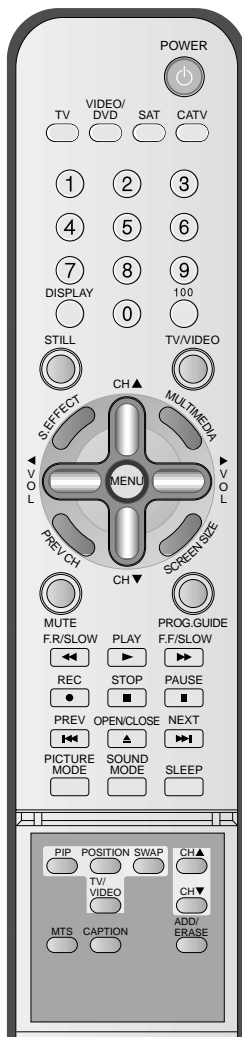

1 Connect a Camcorder/Game Console to the PDP.

- Prepare the AV cable.
- Connect the Video(Output) to the PDP(Video Input) as shown below.
- When connecting to an external AV source, be sure to match the colors.

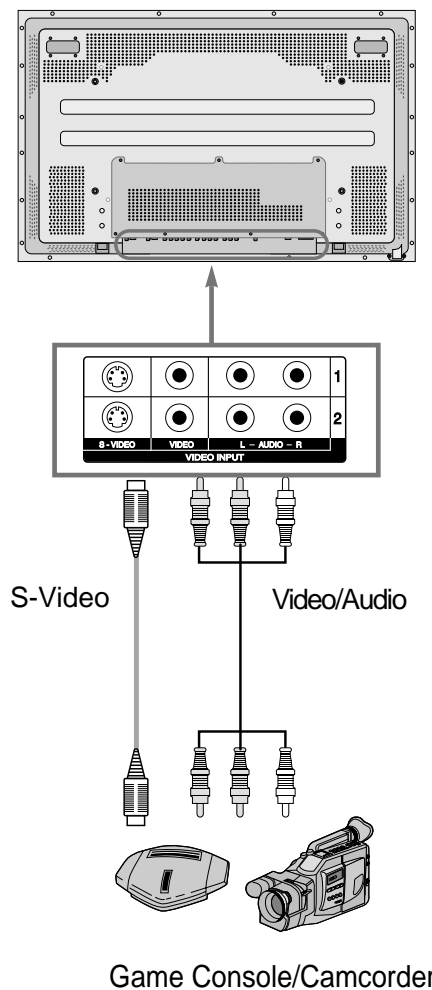

2 Press the Power Buttons

POWER



- Turn the PDP and the Camcorder/Game Console ON.

3 Input Select

TV/VIDEO



- Select [Video 1 or Video 2] by pressing the "TV/VIDEO" button of the Remote Control or the "INPUT SELECT" Key in KeyPad of the pdp set.
- Each time you press the "TV/VIDEO" button, a different input mode appears. The sequence is as follows:

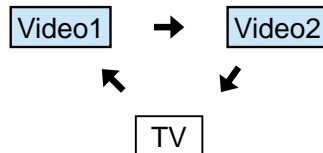

4 Select Function

- Select the Function by using the Remote Control of Camcorder or Game Console.



NOTES:

- 1) When connecting a Video, the S-Video terminal provides a better image than the Video terminal.
- 2) When connecting to the Video terminal, connect 3 color AV cables (video, left audio, right audio) to the PDP; for the S-Video terminal, connect the Audio terminal (Left, Right) in the same way, and connect the S-Video cable(sold separately).
- 3) When connecting a component, refer to "Watching a DVD Image" on page 34-35.

Connecting PC(15pin D-sub)

Connecting PC

- This product supports resolution of VGA, SVGA, XGA, and SXGA.
- Before connecting a PC to the PDP, be sure to adjust the resolution of PC.

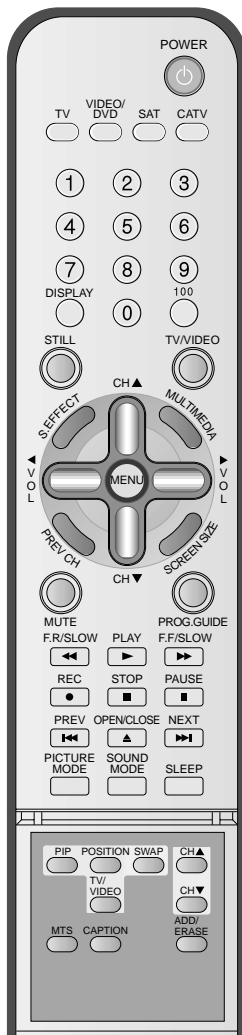

1 Before connecting to the PDP, set the resolution of the PC.

- Go to SETUP-CONTROL PANEL-DISPLAY PROPERTIES in Window Screen of the PC.
- Choose the SETTINGS tab in the DISPLAY Menu.
- In the SETTINGS Menu, select 640 x 480 or 800 x 600.

2 Connect the PC to the PDP.

- Prepare the PC cable (D-sub 15pin) and the PC audio cable(Sold separately).
- Connect the PC(Output) to the PDP(Input) as shown below.

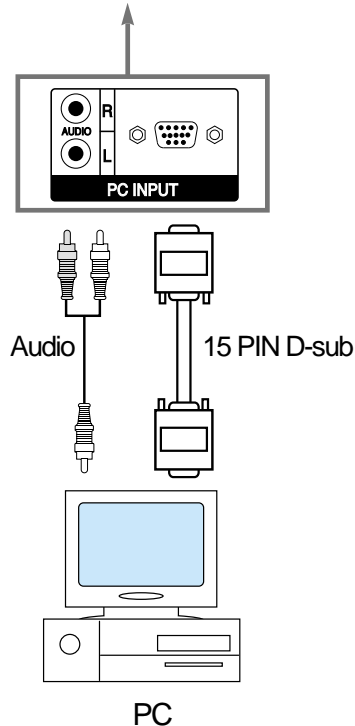
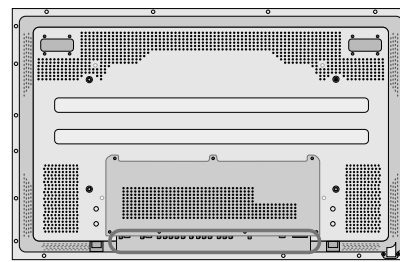

3 Press the Power Buttons.

POWER



- Turn on the PDP and the PC.

4 Input Select



- Select [PC] by pressing the "MULTIMEDIA" button of the Remote Control or PDP unit.
- Each time you press the "MULTIMEDIA" button, a different input mode appears. The sequence is as follows:

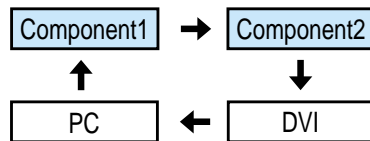

5 Enjoy Dynamic Ultra Screen TV by Using PC's Keyboard or Mouse.



NOTES:

- 1) The resolution of the PC TV is best at 1024 x 768 (XGA).
- 2) If there is a [Vertical Frequency] setting menu in the [Display] Menu of the PC, adjust the frequency to 60Hz.
- 3) If the PC resolution is too high, it may be hard to read letters. Select a suitable resolution.

Connecting PC(DVI)

Connecting PC

- This product supports resolution of VGA, SVGA, XGA, SXGA.
- Before connecting a PC to the PDP, be sure to adjust the resolution of PC.
- This product is supported by Plug and Play only at DVI.

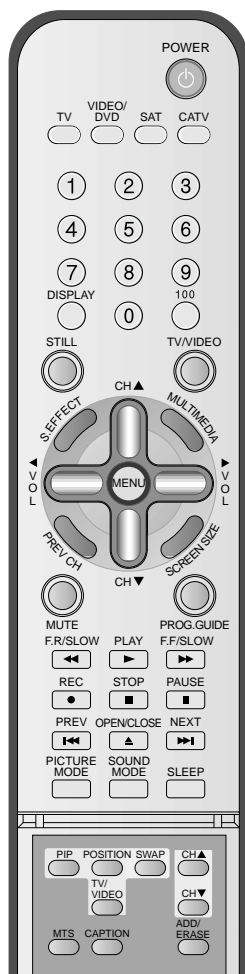

1 Before connecting to the PDP, set the resolution of the PC.

- Go to SETUP-CONTROL PANEL-DISPLAY PROPERTIES in Window Screen of the PC.
- Choose the SETTINGS tab in the DISPLAY Menu.
- In the SETTINGS Menu, select 640 x 480 or 800 x 600.

2 Connect the PC to the PDP.

- Prepare the DVI cable and the PC audio cable(Sold separately).
- Connect the PC(Output) to the PDP(Input) as shown below.

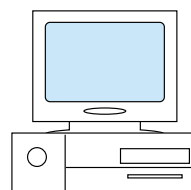
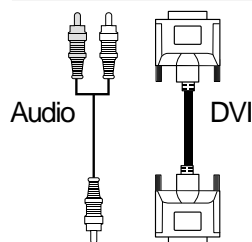
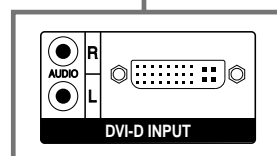
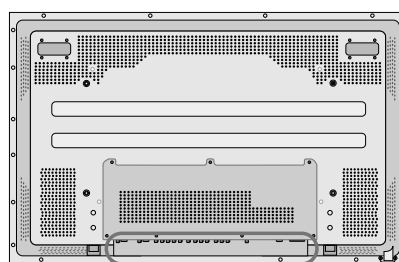

PC

3 Press the Power Buttons.

POWER



- Turn on the PDP and the PC.

4 Input Select



- Select [DVI] by pressing the "MULTIMEDIA" button of the Remote Control or PDP unit.
- Each time you press the "MULTIMEDIA" button, a different input mode appears. The sequence is as follows:

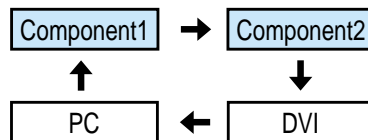

5 Enjoy Dynamic Ultra Screen TV by Using PC's Keyboard or Mouse.



NOTES:

- 1) The resolution of the PC monitor is best at 1024 x 768 (XGA).
- 2) If there is a [Vertical Frequency] setting menu in the [Display] Menu of the PC, adjust the frequency to 60Hz.
- 3) If the PC resolution is too high, it may be hard to read letters. Select a suitable resolution.
- 4) DVI input port receives only Digital Signal.
- 5) Depending on the graphic card when plug & unplug the DVI connection the screen may not display correctly. Restart the computer if this happens.

PC and DVI Input Resolution Available in PDP

- Depending on graphic card, problems like no signal detected or line noises can happen. If these problems happen, contact the graphic card company for help.

Resolution	H Freq. (KHz)	V Freq. (Hz)	Remark	DVI	PC
640x480	31.469	59.940	DOS	O	O
800x600	37.879	60.317	VESA	O	O
1024x768	48.363	60.004	VESA	O	O

Connecting Dolby digital Amp.

- Connecting coaxial digital audio output to dolby digital Amp. enables you yo hear enhanced sound.(Dolby digital sound is output only when it is receiving digital broadcasts)
- When both Optical/Coaxial are connected Coaxial has priority.

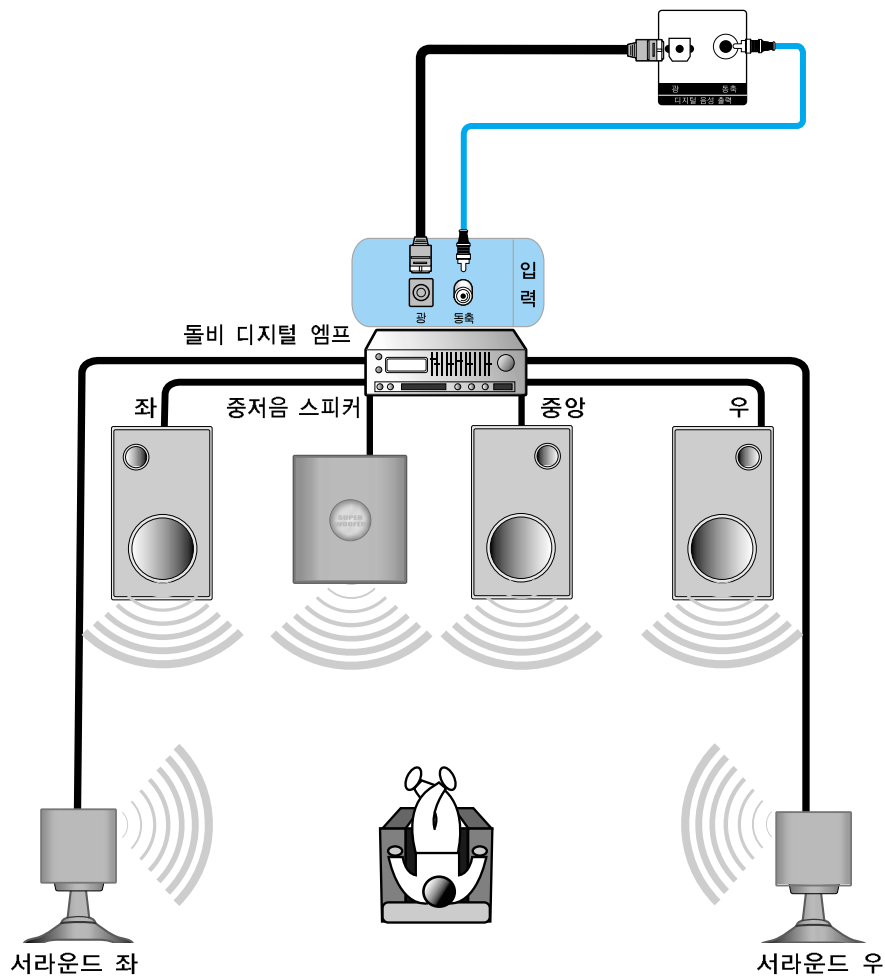

Note.

- For digital sound, dolby digital or PCM is possible



이 제품은 Dolby Laboratories의 허가를 받아 제조되었습니다.
 돌비, "Dolby" 및 이중 D 기호는 Dolby Laboratories의 상표입니다.

Panel Controls

Front Panel, Back Panel, Remote Control

* Items having same names on Plasma television and the remote control would function in exactly the same way.

Front

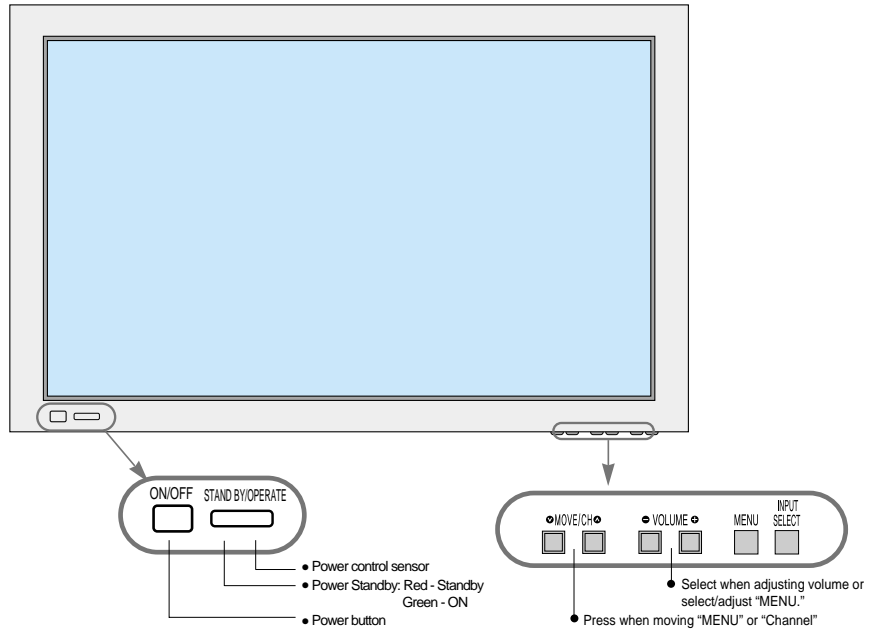

Rear

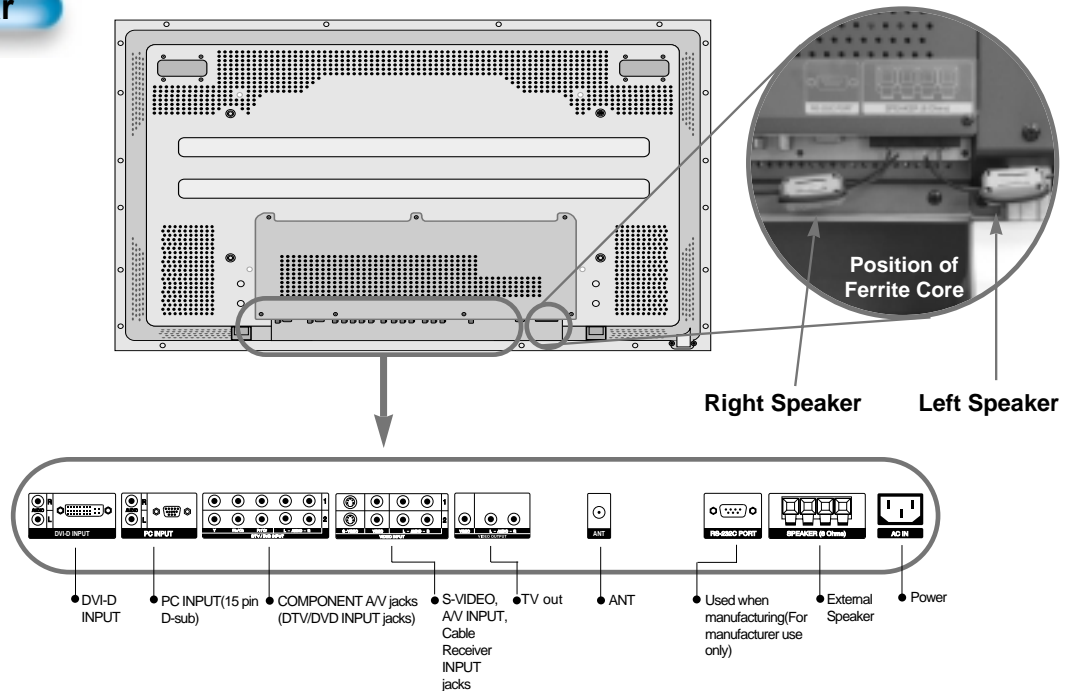

Remote Control

Note

- Use two "AAA" batteries.
- Be sure to use replacement batteries of the same type as the original ones.
- The life of a battery depends on how much it has been used.

● The number in () indicates the page in the function of each button is explained in detail.

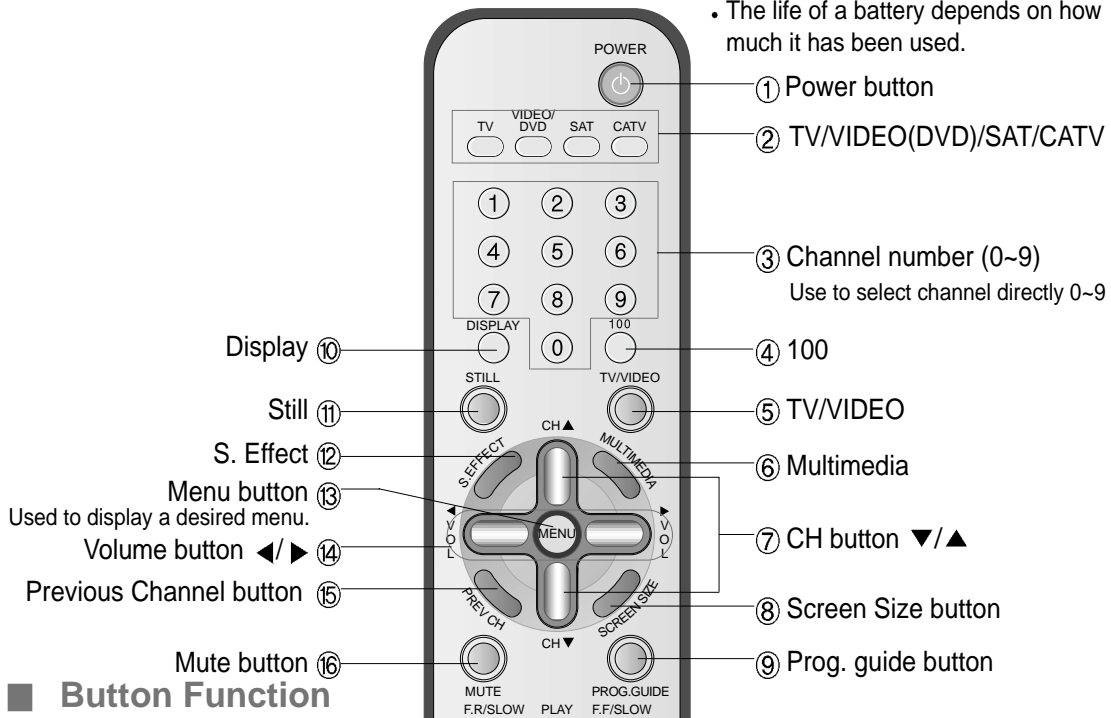

Button Function

- ① **Power Button** : Pressing the Power button of the Monitor allows the Display to be standby. (Red light is shown in the Remote Control Sensor.) At this time, if you press the Power button of the Remote Control, the Display is turned ON (Green light in the Sensor).
- ② **TV/VIDEO(DVD)/SAT/CATV Select Button**
 - ▶ TV Button : Control the PDP TV
 - ▶ Video(DVD) Button : Control the VCR or DVD Player
 - ▶ SAT Button : Control the satellite receiver
 - ▶ CATV Button : Control the cable TV receiver
- ③ **Channel Number 0~9** : Use to select channel directly 0~9
- ④ **100 Button** : Use it when selecting a channel number of over 100
- ⑤ **TV/Video Button** : Use this function to make video input selection. It changes in the following sequence (TV -> Video1 -> Video2 -> TV)
- ⑥ **Multimedia** : Use this function to make video input selection. It changes in the following sequence (TV -> Component 1-> Component 2 -> DVI -> PC -> TV)
- ⑦ **CH button** : Adjusts the channel.
- ⑧ **Screen Size Button** : Adjusts the size of the screen (Normal, 16:9, etc.)
- ⑨ **Prog. guide** : Display EPG
- ⑩ **Display Button** : Indicates the current state and resolution.
- ⑪ **Still Button** : Used to view a still picture during watching moving images.(Sound can be heard.)
- ⑫ **S.Effect Button** : Choose the BBE or M.Voice
- ⑬ **Menu Button** : Used to display a desired menu.
- ⑮ **Previous Channel Button** : It returns to previous channel.
- ⑯ **Mute Button** : Mute Sound

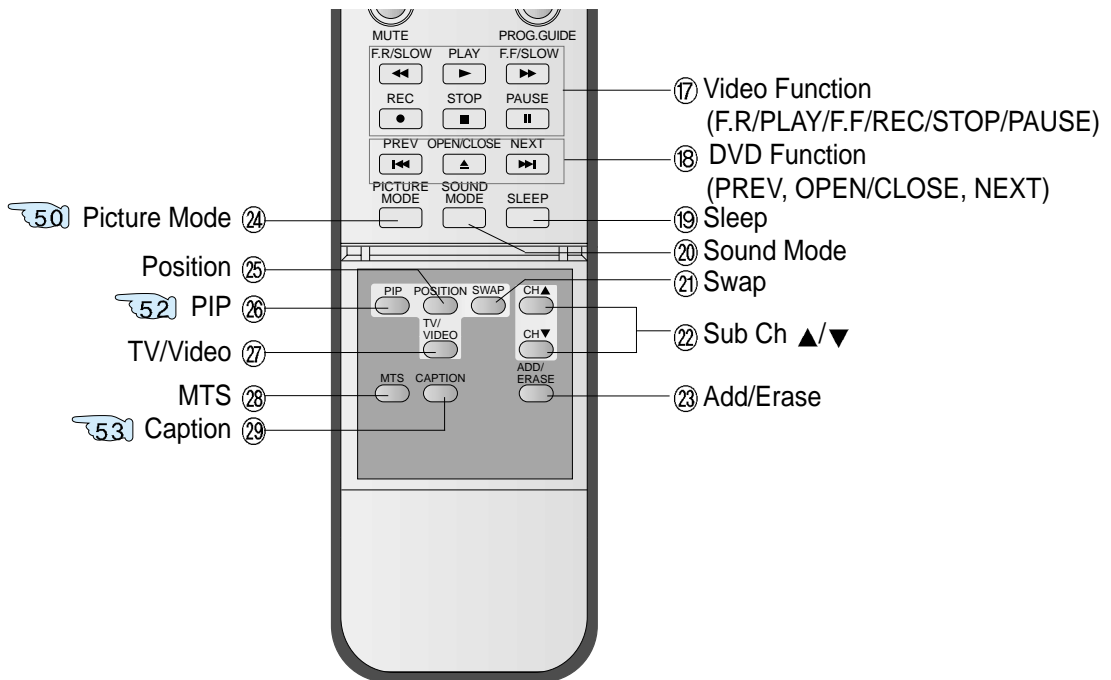

■ Button Function

- 17 **Video Function** : These buttons are used for controlling of video player such as play, record, and so on.
- 18 **DVD Function** : These buttons are used for controlling of DVD player such as open/close, previous, and next
- 19 **Sleep Timer button** : Each time you press this button, a different input mode appears. The sequence is as follows: 15Min. -> 30Min. -> 60Min. -> 90Min. -> 120Min. -> OFF. After the time is selected, it automatically becomes standby state.
- 20 **Sound Mode button** : Every press of the button cycles through the five different modes: Normal -> Movie -> Music -> News -> User.
- 21 **Swap button** : swap the main picture and sub-picture.
- 22 **Sub-channel up/down button** : used for changing the channel of sub-picture at PIP mode.
- 23 **Channel Add/Erase** : The feature either memorizes the current channel or erases a channel that has previously memorized
- 24 **Picture Mode button** : Every press of the button cycles through the four different. Normal -> Movie -> Music -> News -> User.
- 25 **Position** : move the position of sub-picture
- 26 **PIP button** : used for switching the normal mode to PIP mode, or for controlling the size of sub-picture
- 27 **TV/VIDEO button** : Use this function to make video input selection. It changes in the following sequence. (TV -> Video1 -> Video2 -> TV)
- 28 **MTS button** : This feature allows you to select the language and stereo sound while broadcasting
- 29 **Caption button** : Toggle the language

How to insert the battery

- 1 Push to open the cover of the remote controller.
- 2 Set the buttons in the battery cell after checking the electrode.
- 3 Then shut the cover.

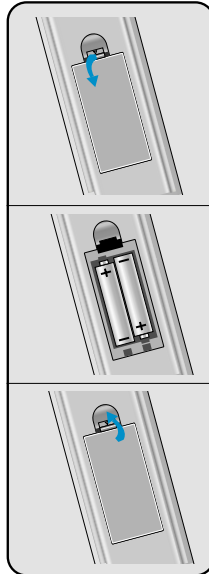

- When the battery is changed, previously set code will be deleted. Please set again after changing battery.
- We recommend you to use Alkaline Battery for better controlling.

The remote control setup

- 1 Plug in the power cord of external device (cable converter, VCR, DVD, etc) while the main power of the device is turned off.
- 2 Press the device selection button of remote control until red color is on.
- 3 Press the assigned three digits code of the device using number key button of the remote control toward the IR receiver of the device.
- 4 If the code is set properly, use the device after power on.
 - Contact to Daewoo Electronics Service Center to get the Remote Control Setup Code.

