

User's Manual

Product Overview



1. Built-in MEMS microphone, real-time acquisition of music and environmental sound intensity
2. LED Strip Light sync to music , contains a variety of musical rhythm modes
3. Infrared Remote Controller Control(Optional)
4. Press key to switch color and mode
5. Control by SmartLife APP
6. Works with Amazon alexa and Google home and so on

Product Parameter

Model Number	WD300
Category	LED Controller
Domination Principle	WiFi
APP	SmartLife
Language	Chinese、 English
Operation Platform	Android4.0 or IOS9.0orhigher
Sound Sensor	MEMS MIC
LED Drive Type	Constant voltage: MOSFET
Channels	3
Input Voltage	DC 5V
Max Output Power	144W
Work For	LED Strip or other constant voltage lights
Connect Method	Common Anode
IP Rating	IP20
Control Distance	Visible distance 30M

Software Manual

Download and Install App

Use your phone to scan the QR code below or search “Smart Life” in application marker to Download and install the App



Register/Login/Forget password

Register: Register your account to the following tips before using at the first time. If you have an account, please enter the password to login directly.

Login: Input the correct account number and password to login.

Forgert your password: You can enter the login page to retrieve your password.

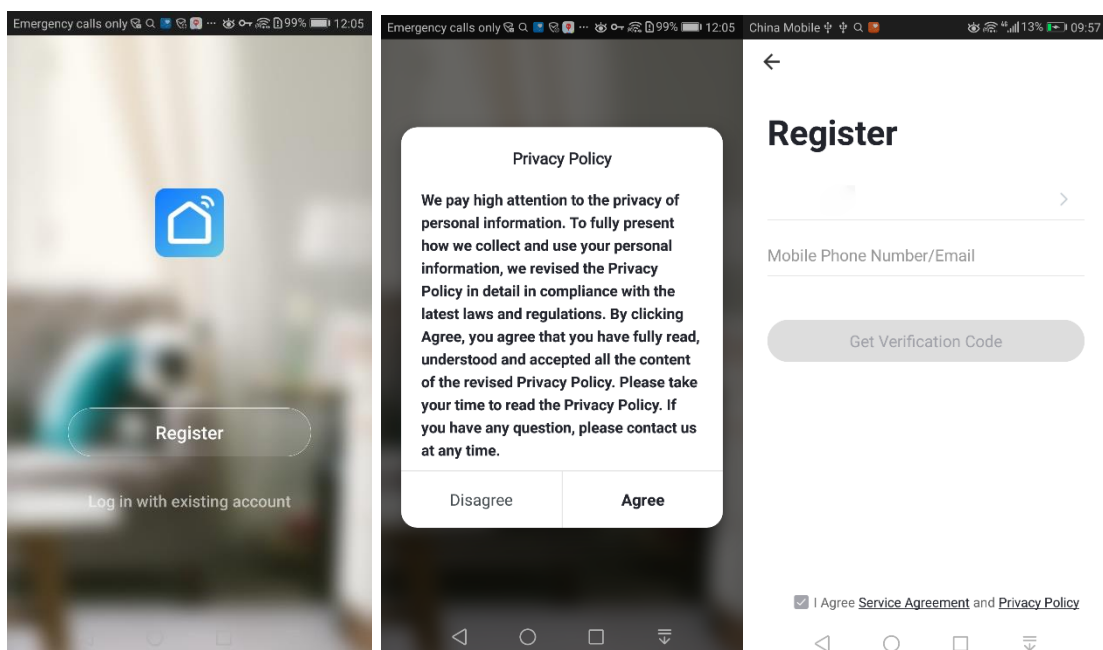

Add Device-Normal mode

In the main application page,click on the top right corner "+" to next window page and then choose Lighting,as shown below.

In normal mode,please confirm that the device red light is quickly blink and then into the next step.

Note:

If the light is not flash,press the "mode" key of the controller with 5-10 seconds to keep the red light in the quickly blink for searching & connecting network.

If add the device in Normal mode fails many times,please go to [Add Device-AP mode](#)

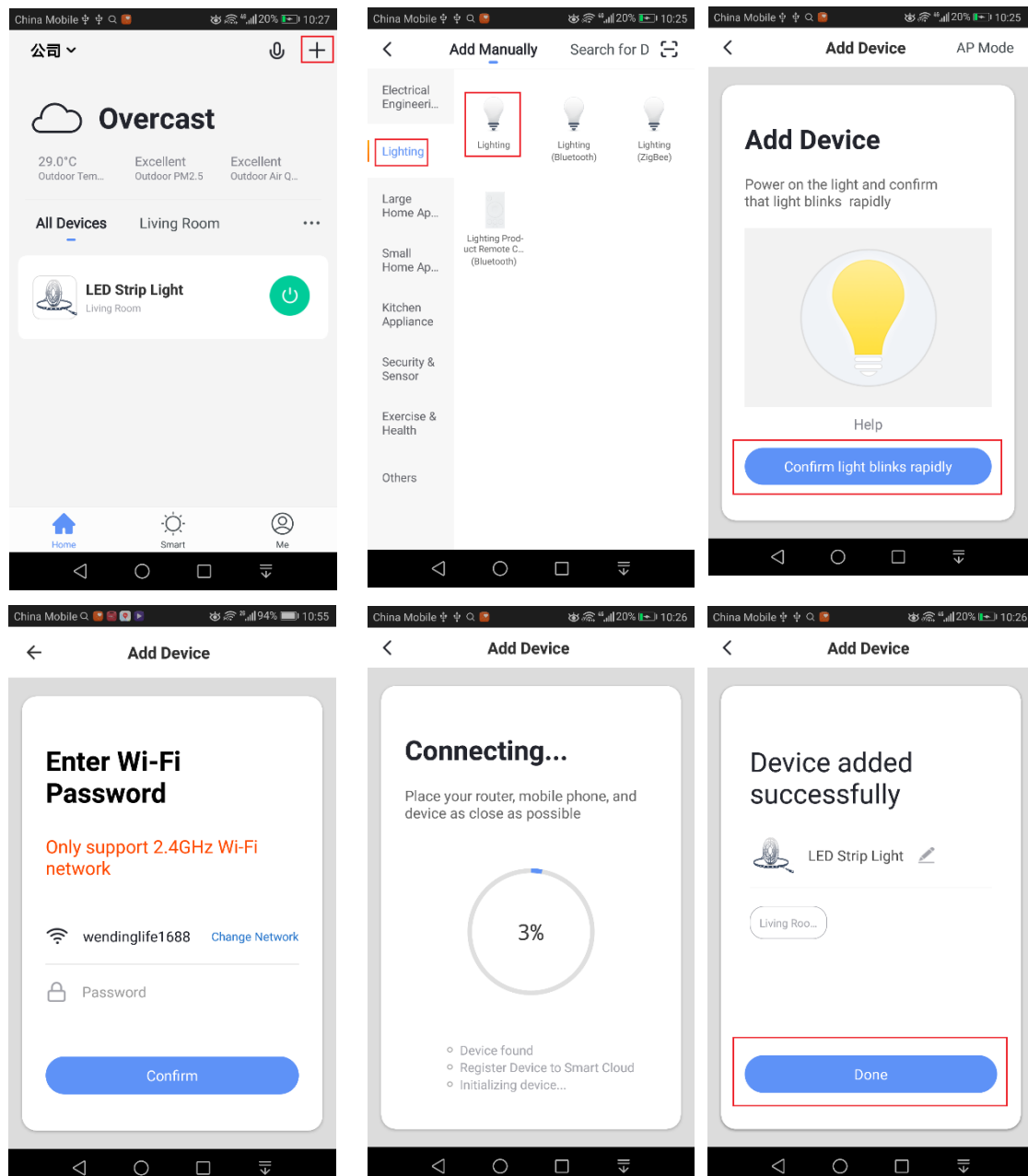

Add Device-AP mode

In the main application page,click on the top right corner "+" to next window page and then choose Lighting,as shown below.

In normal mode, click on the top right corner "AP Mode" to AP Mode window page.

In AP Mode,please confirm that the device red light is slowly blink and then into the next step.

Note:

If the light in quickly blink,just press the controller with 5-10 seconds again,and the red light will slowly blink.

If the light neither slowly blink nor quickly blink.First press the "mode" key of the controller with 5-10 seconds to keep the red light in the quickly blink ,Second release the button and then press the controller with 5-10 seconds again,the red light will slowly blink.

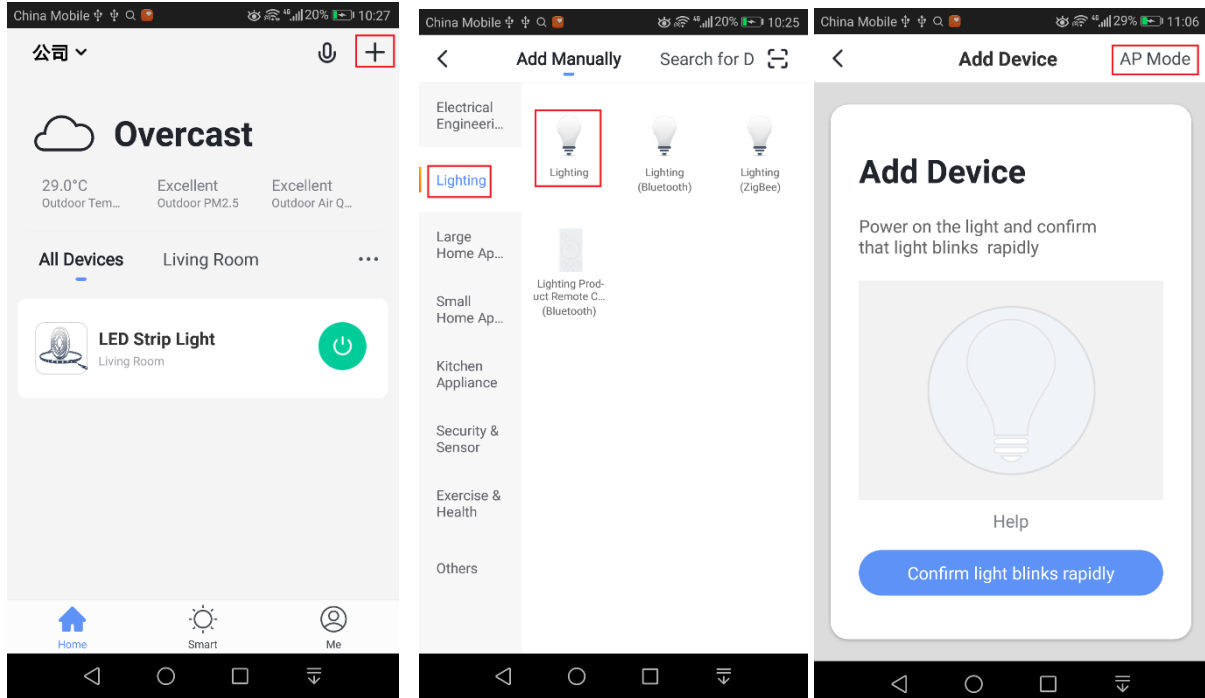

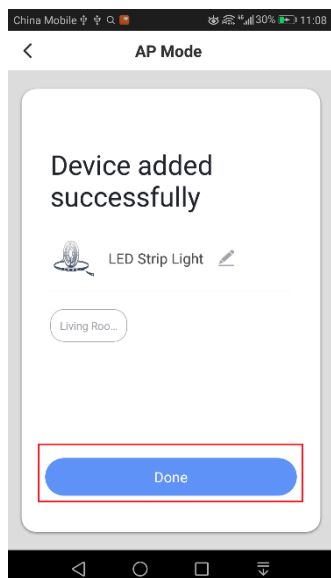
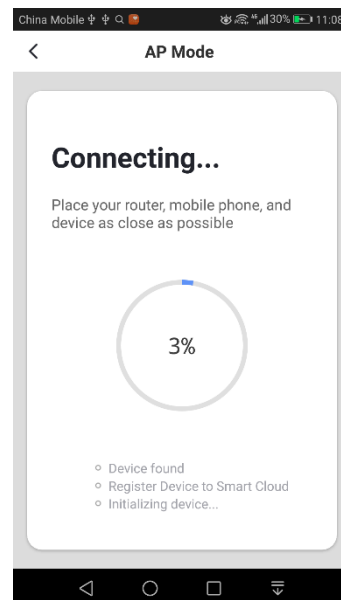
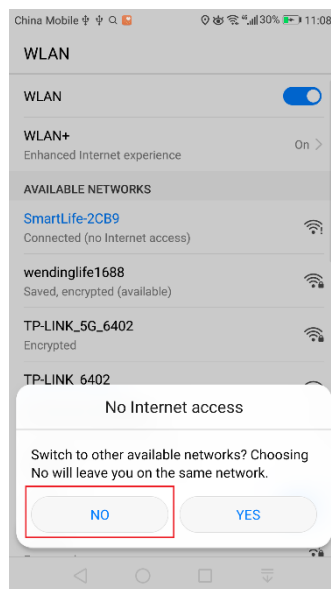
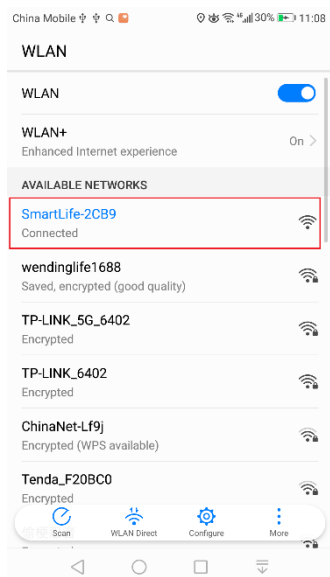
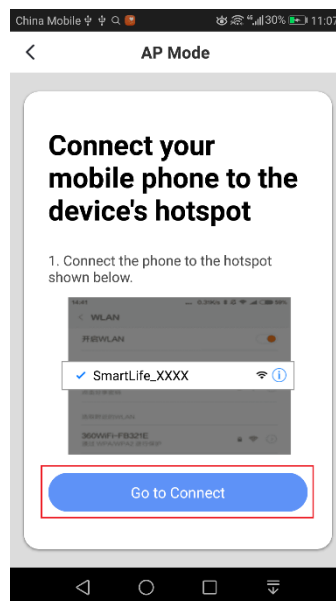
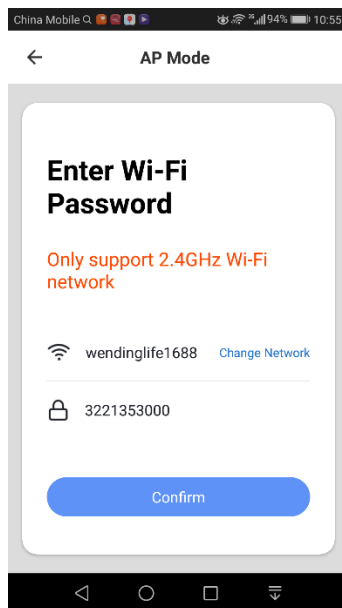
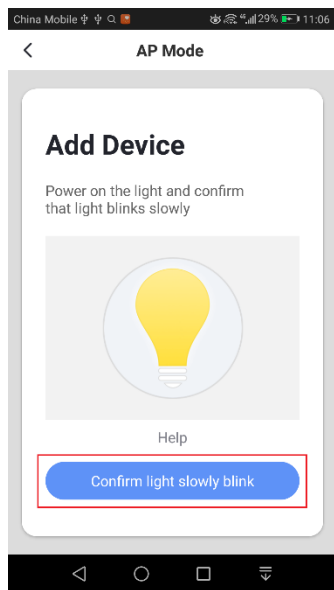

Control device

After successfully connecting the devices, the related smart device will be shown on the home page. Tap to enter its control page

Note:

1. when device is online, it supports quick operations
2. when device is offline, it displays "Offline". and can not be controlled.

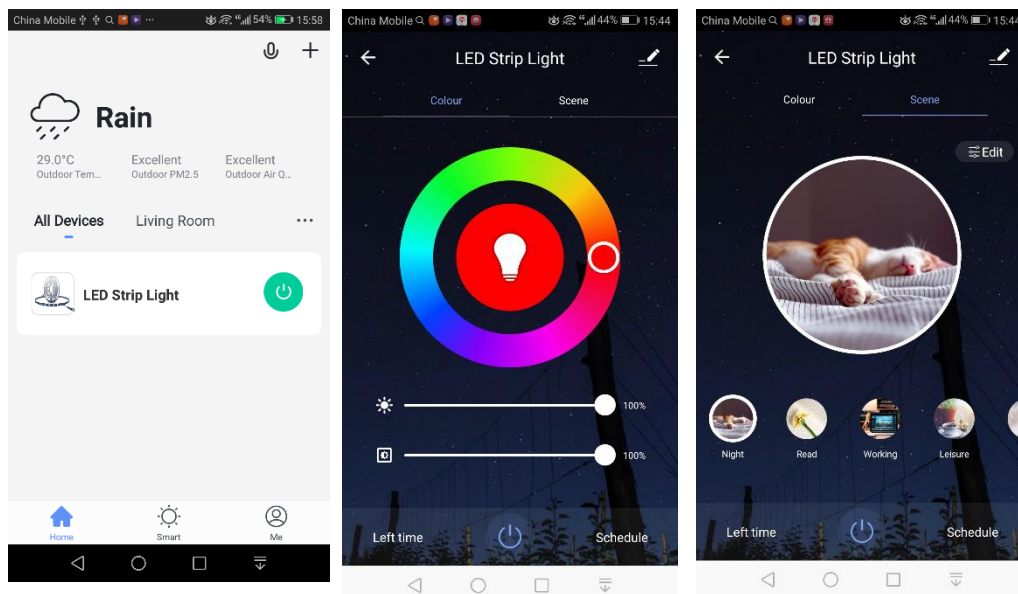

LED Strip Light Sync to Music Function

Enter music mode and play music with any device, and the led strip light will sync to music

Note:

The volume of mobile phone is relatively small, it's better to use Bluetooth audio

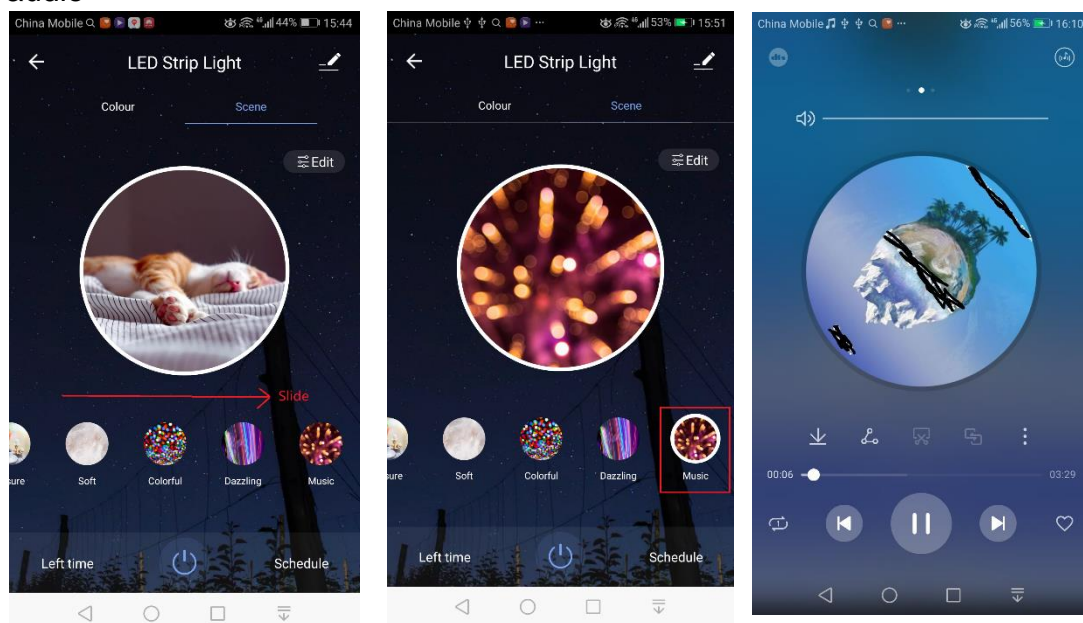

1. Click Edit in the top right corner to enter custom scene
2. Breath and Static music mode is suitable for light music
3. Flash music mode is suitable for fast rhythm music
4. You can add/delete/modify the color displayed and change the speed of color switching
5. If you are not satisfied, you can reset the settings

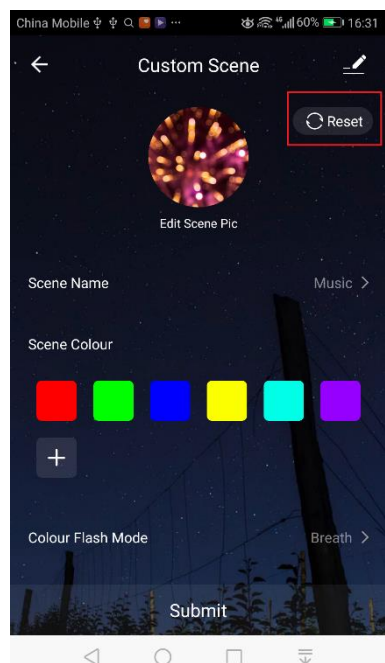
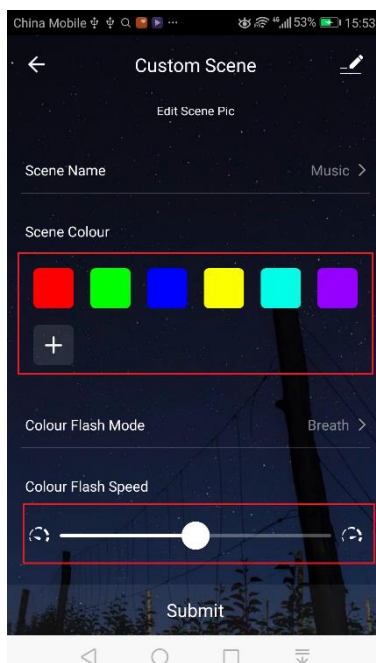
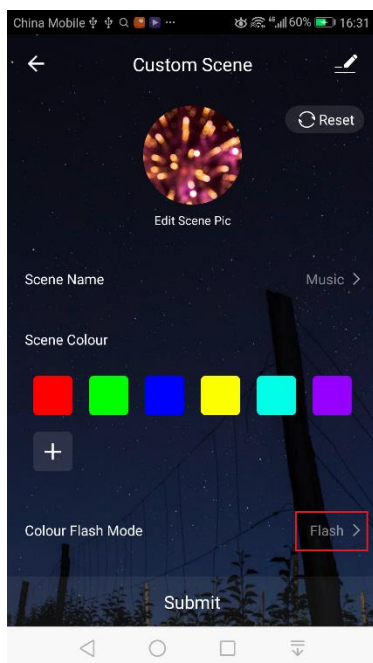
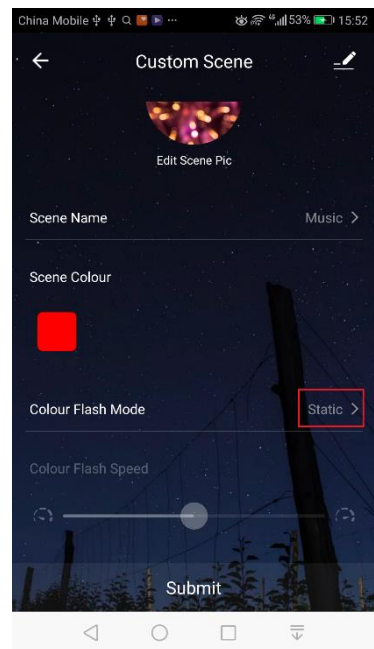
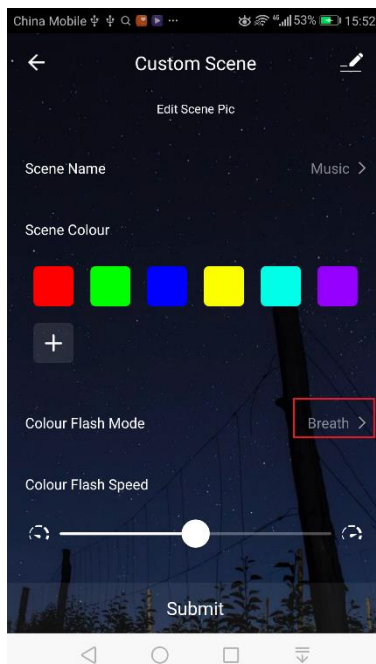
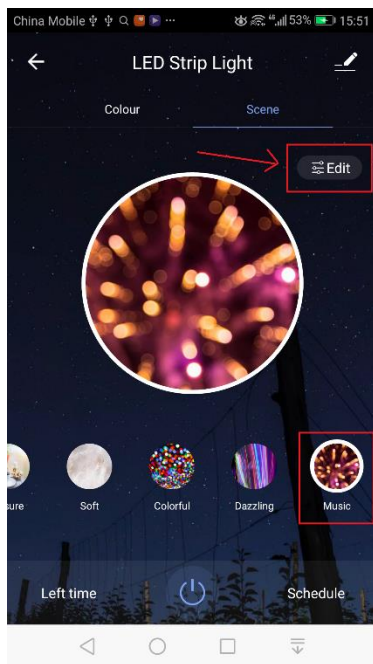

Works with Amazon Alexa

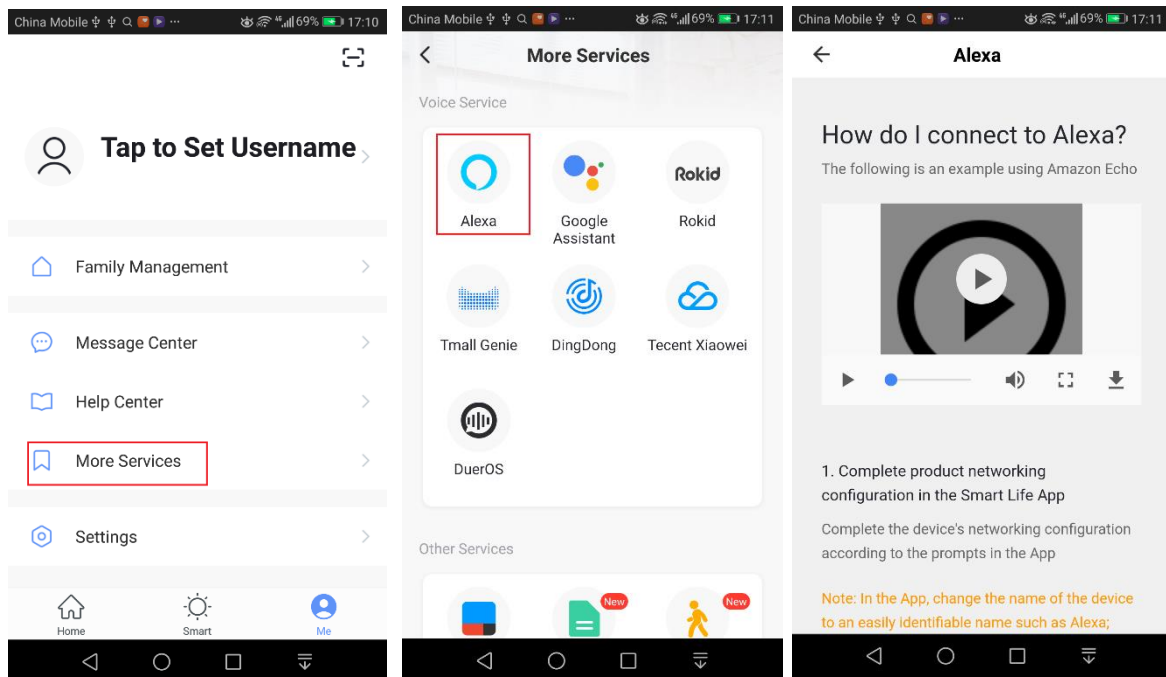

Works with Google Assistant

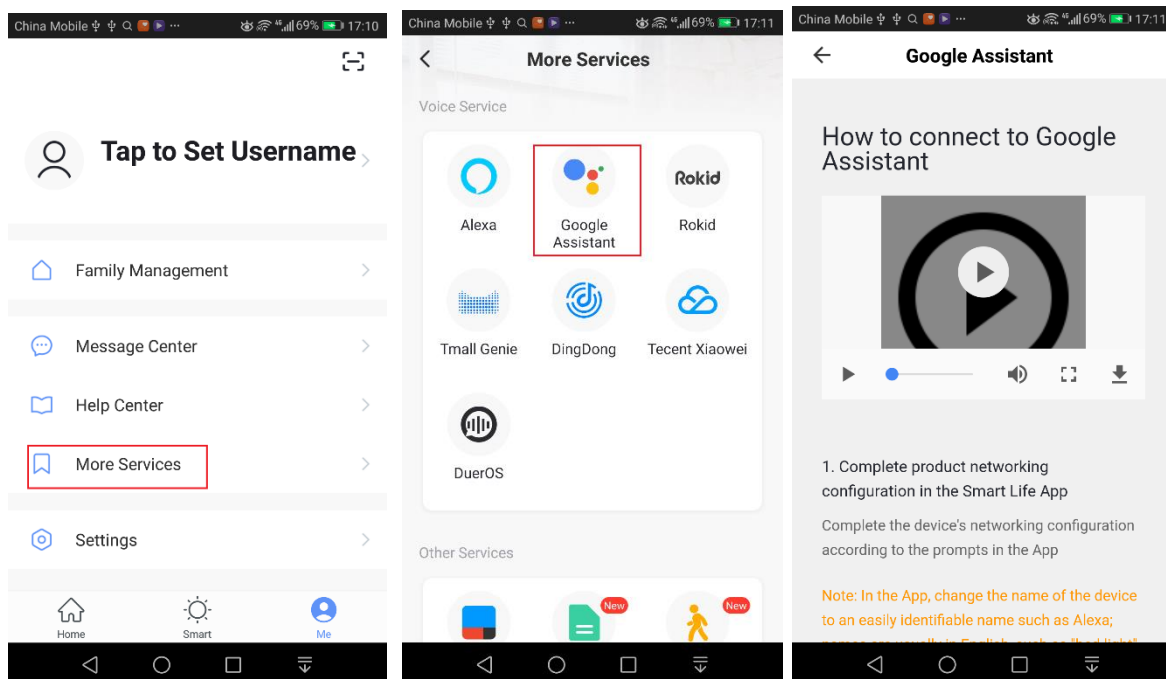

FAQ

1.How to reset the controller?

Press the “mode” key of the controller with 5-10 seconds

2.How to get more help?

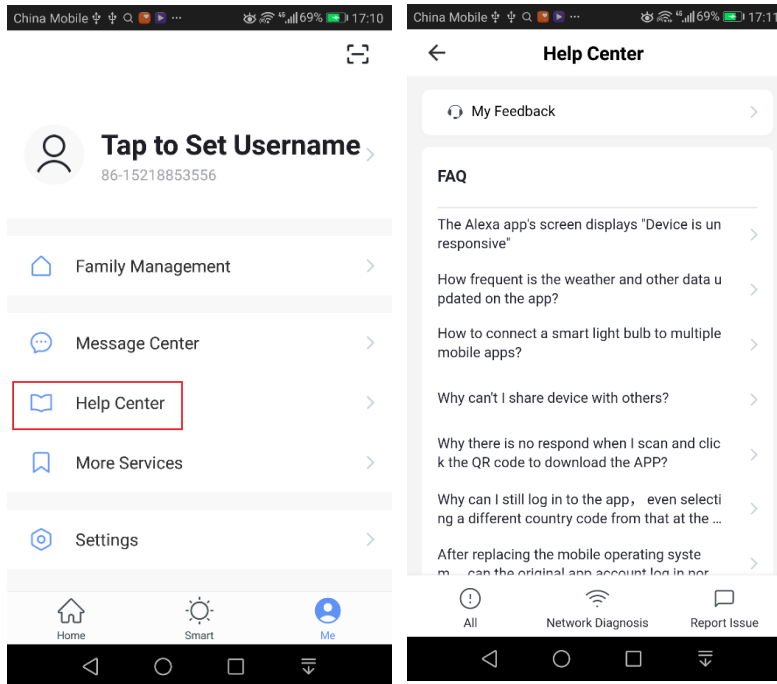

Attentions

1. Please use the product in a dry environment.
2. Please use the input voltage at 5V DC voltage, must not connect into 220V AC directly.
3. The product is requested common anode connection. The wrong connection will cause a malfunction.
4. In the process of the product and software upgrade, the data and software interface listed in the text are only for description and reference. No further notify will given if there is any change.

This device complies with Part 15 of the FCC Rules. Operation is subject to the following two conditions: (1) this device may not cause harmful interference, and (2) this device must accept any interference received, including interference that may cause undesired operation

NOTE: This equipment has been tested and found to comply with the limits for a Class B digital device, pursuant to Part 15 of the FCC Rules. These limits are designed to provide reasonable protection against harmful interference in a residential installation. This equipment generates, uses and can radiate radio frequency energy and, if not installed and used in accordance with the instructions, may cause harmful interference to radio communications. However, there is no guarantee that interference will not occur in a particular installation. If this equipment does cause harmful interference to radio or television reception, which can be determined by turning the equipment off and on, the user is encouraged to try to correct the interference by one or more of the following measures:

- Reorient or relocate the receiving antenna.
- Increase the separation between the equipment and receiver.
- Connect the equipment into an outlet on a circuit different from that to which the receiver is connected.
- Consult the dealer or an experienced radio/TV technician for help.

Warning: changes or modifications not expressly approved by the party responsible for compliance could void the user's authority to operate the equipment

This equipment complies with FCC radiation exposure limits set forth for an uncontrolled environment. This equipment should be installed and operated with minimum distance 20cm between the radiator & your body