

Desktop & Mobile App



WD My Cloud™



<http://wd.com/wdmycloud/apps>

- * WD My Cloud EX4100 und das Wireless-Gerät müssen über Wi-Fi mit demselben Netzwerk verbunden sein.
- * Le WD My Cloud EX4100 et le périphérique sans fil doivent être connectés en Wi-Fi au même réseau.
- * WD My Cloud EX4100 e il dispositivo wireless devono essere connessi via Wi-Fi alla stessa rete.
- * WD My Cloud EX4100 y el dispositivo inalámbrico deben tener una conexión Wi-Fi a la misma red.
- * WD My Cloud EX4100 en het draadloze apparaat moeten via Wi-Fi verbonden zijn met hetzelfde netwerk.
- * WD My Cloud EX4100 oraz urządzenie bezprzewodowe muszą być połączone z siecią za pomocą Wi-Fi.
- * O WD My Cloud EX4100 e o dispositivo sem fio devem estar conectados por Wi-Fi à mesma rede.
- * WD My Cloud EX4100 og trådløs enhed skal have oprettet Wi-Fi-forbindelse til det samme netværk.
- * WD My Cloud EX4100 ja langattoman laitteen on oltava Wi-Fi-yhteydessä samaan verkkoon.
- * WD My Cloud EX4100 og den trådløse enheten må være trådløst koblet til det samme lokalnettverket.
- * WD My Cloud EX4100 och trådlös enhet måste vara Wi-Fi-anslutna till samma nätverk.
- * A WD My Cloud EX4100 meghajtónak és a vezeték nélküli eszköznek ugyanarra a hálózatra kell csatlakoznia Wi-Fi kapcsolatok keresztül.
- * WD My Cloud EX4100 ve kablosuz aygıtın, Wi-Fi üzerinden aynı ağına bağlı olması gerekir.
- * WD My Cloud EX4100 a bezdrátové zařízení musí být připojeny ke stejné síti pomocí připojení Wi-Fi.
- * WD My Cloud EX4100 a bezdrátové zariadenie musia byť pripojené do rovnakej siete pomocou pripojenia Wi-Fi.
- * WD My Cloud EX4100 dengan perangkat wireless harus terhubung didalam satu network Wi-Fi yang sama.
- * Η μονάδα WD My Cloud EX4100 και η ασύρματη συσκευή πρέπει να είναι συνδεδεμένες μέσω Wi-Fi στο ίδιο δίκτυο.
- * WD My Cloud EX4100 およびワイヤレス端末は、同一ネットワークにWi-Fi接続してください。
- * WD My Cloud EX4100 및 무선 장치는 같은 네트워크에 Wi-Fi로 연결되어 있어야 합니다.
- * WD My Cloud EX4100 și dispozitivul fără fir trebuie să fie conectate prin Wi-Fi la aceeași rețea.
- * WD My Cloud EX4100 и беспроводное устройство должны быть подключены по Wi-Fi к одной и той же сети.
- * WD My Cloud EX4100 和无线设备必须通过 Wi-Fi 连接到同一网络。
- * WD My Cloud EX4100 和無線裝置必須透過 Wi-Fi 連線至相同的網路。
- * يجب توصيل WD My Cloud EX4100 والجهاز اللاسلكي بشبكة Wi-Fi ذاتها.

Technical Support Services

<http://support.wd.com>
<http://www.wd.com>

If you encounter problems with this product, please contact WD Technical Support.

United States/North America	
English	800.ASK.4WDC (800.275.4932)
Spanish	800.832.4778
Asia Pacific (all countries)	
http://support.wd.com/contact	
Asia Pacific (non toll free)	+86.21.2603.7560
Australia & New Zealand	+800.2275.4932
India	1800 200 5789 / 1800 419 5591
Singapore	1800.608.6008
Taiwan	0800.225 593
Thailand	1800.852.5913
Europe (toll free*)	
0800.27549338	
<small>* Austria, Belgium, Czech Republic, Denmark, France, Germany, Ireland, Italy, Netherlands, Norway, Poland, Slovakia, Spain, Sweden, Switzerland, United Kingdom</small>	
Europe (non toll free)	+31.880062100
Russia	8 10 8002 335 5011
Middle East/Africa	
+31.880062100	



Western Digital, WD, the WD logo, My Cloud, and WD My Cloud are registered trademarks of Western Digital Technologies, Inc. in the U.S. and other countries. Other marks may be mentioned here in that belong to other companies. Specifications subject to change without notice.

© 2015 Western Digital Technologies, Inc. All rights reserved.

Western Digital
3355 Michelson Drive, Suite 100
Irvine, California, U.S.A. 92612

4079-705149-801 Jan 2015



My Cloud™ EX4100 Pre-Configured NAS



Quick Installation Guide

1

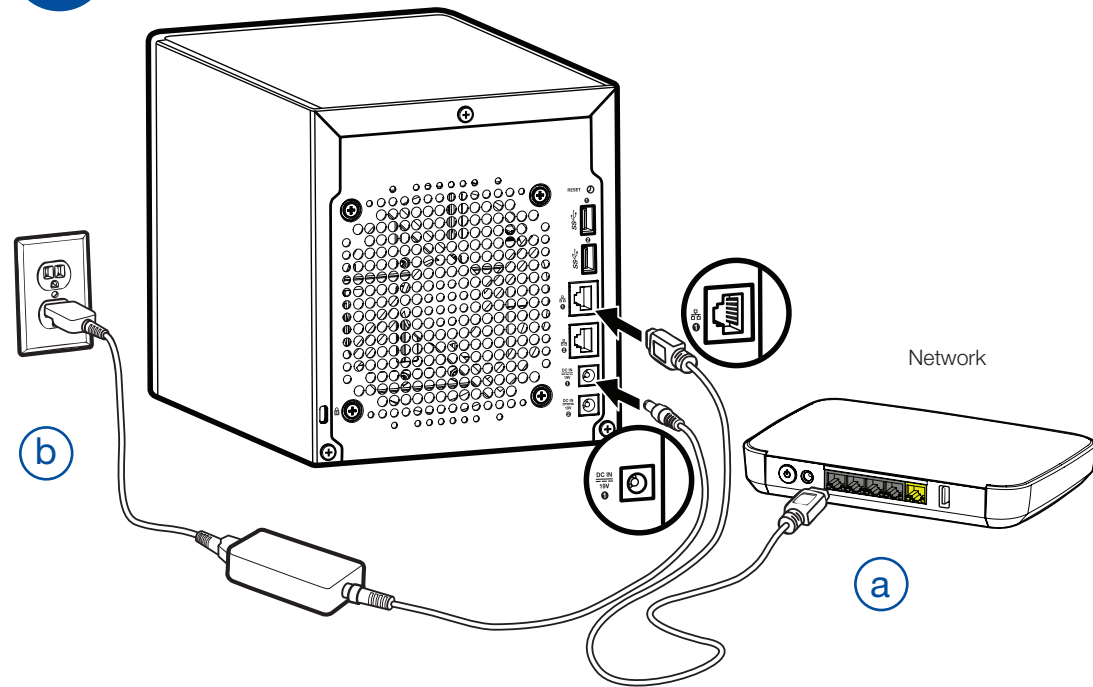

2



Wireless Devices

* WD My Cloud EX4100 and wireless device must be Wi-Fi® connected to the same network.

3



4

