

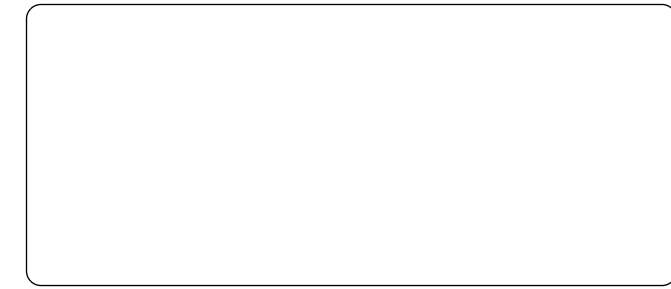

WIDEX PRO LINK™

USER INSTRUCTIONS PRO LINK

GB
DE
FR
ES
PT
IT
NL
DK
NO
SE
FI
KR
CN
JP
TH
TR
PL
TW
US



 **WIDEX A/S** Nymoellevej 6, DK-3540 Lyngby, Denmark
global.widex.com

Manual no.: 9 514 0414 099 #03
Issue: 2018-01



9 514 0414 099 03



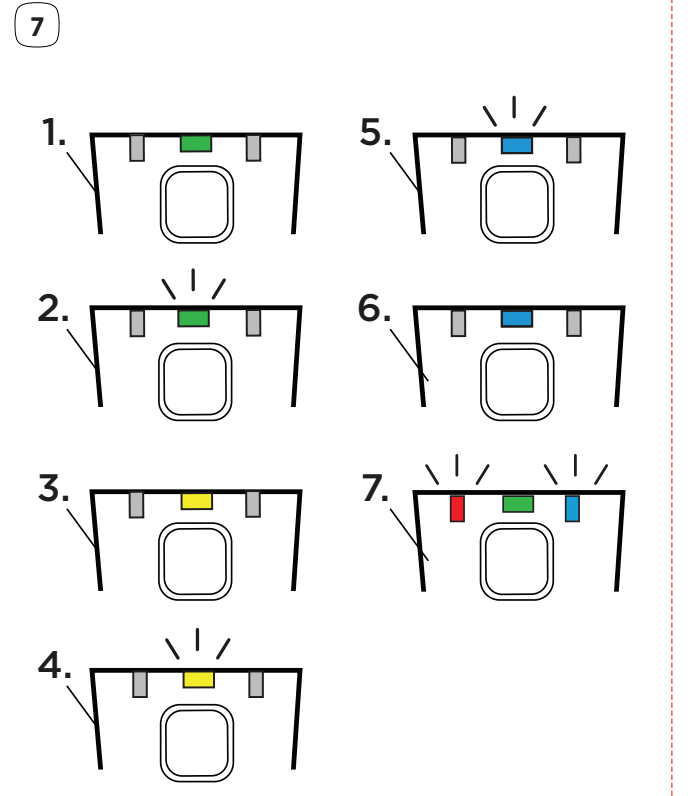
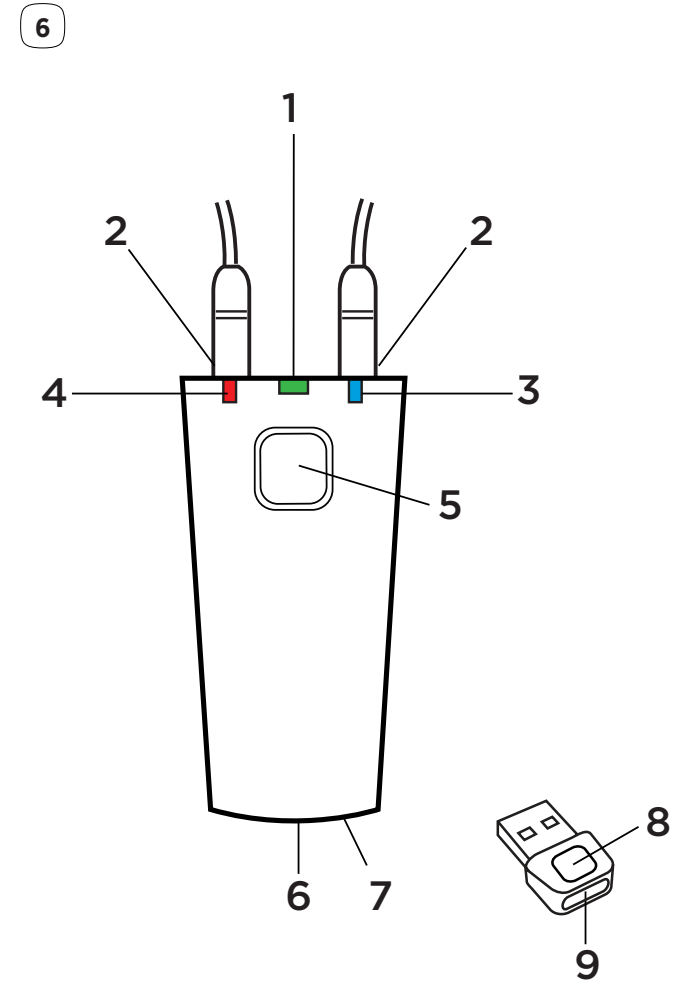
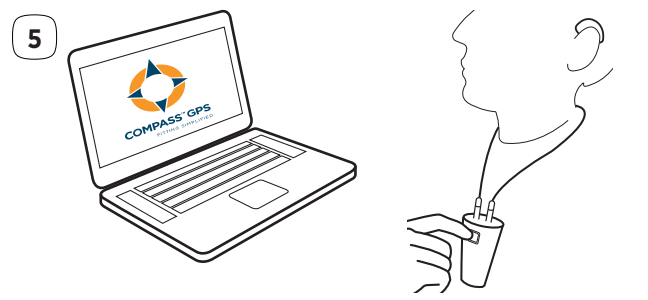
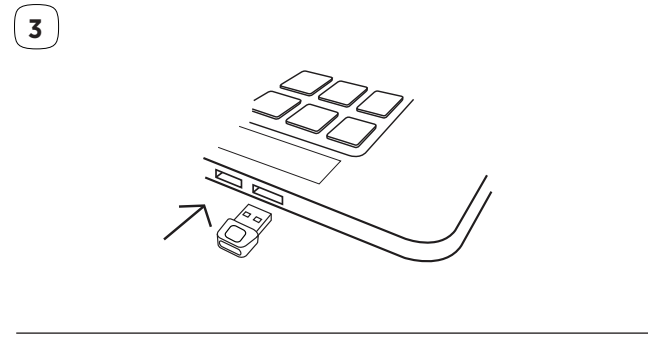
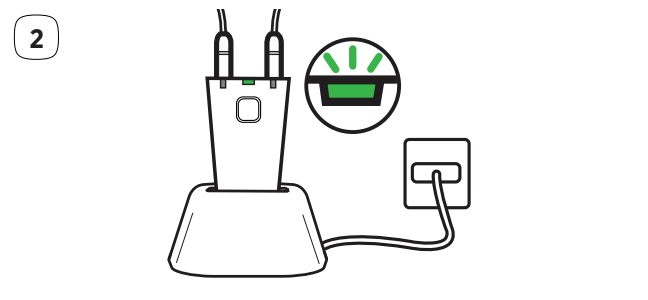
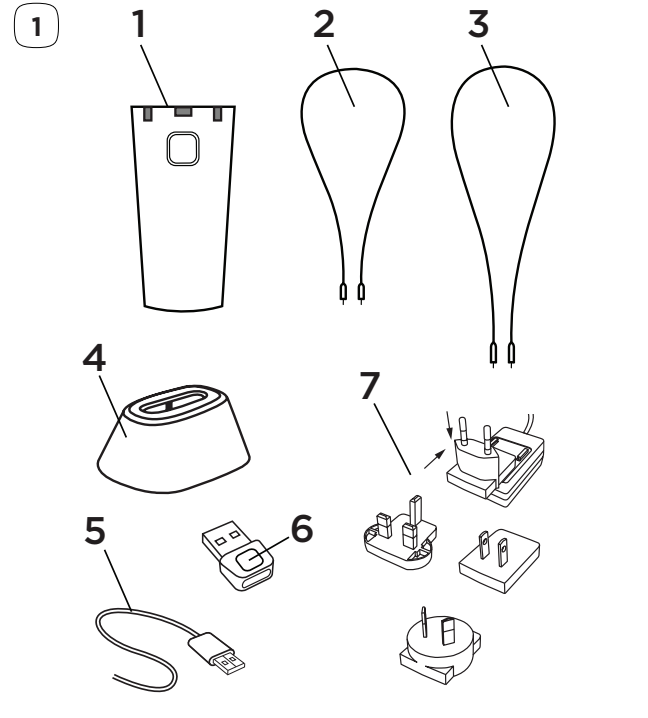

PACKAGE CONTENTS AND DESCRIPTION OF DEVICE

Package contents - see illustration 1:

- 1.1 Fitting device
- 1.2 Regular neckloop (75 cm)
- 1.3 Long neckloop (85 cm)
- 1.4 Docking station
- 1.5 Micro USB cable
- 1.6 Bluetooth® adaptor (model: BT adaptor)
- 1.7 Plugs for the charger

The device - see illustration 6:

- 6.1 Center LED
- 6.2 Neckloop connectors
- 6.3 LED for the left hearing aid
- 6.4 LED for the right hearing aid
- 6.5 Push button (on/off switch/pairing)
- 6.6 Micro USB port for charging
- 6.7 Reset pinhole button
- 6.8 Bluetooth adaptor - LED
- 6.9 Pairing button

IMPORTANT SAFETY INFORMATION

Warnings

Read this page carefully before you start using this device.



Do not use the device in mines or other areas with explosive gases.



Do not expose to extreme temperatures or high humidity.



When the device is connected via micro USB cable to external mains-operated equipment such as a charger, PC, audio source or similar, this equipment must comply with IEC 60065, IEC 60950-1, IEC 60601-1 or equivalent safety standards.



Any change or modification to the device that has not been expressly approved by the manufacturer could void the user's authority to operate the device.



Do not use the product at altitudes above 2000 meters, as extremely low air pressure may result in an explosion or the leakage of flammable liquid or gas.



Do not dispose of the product with battery into fire or a hot oven.

Your device should be stored and transported within the temperature and humidity ranges of -10°C to +50°C (14°F to 122°F) and < 90% rH.

Your device is designed to operate from 5°C (41°F) to 40°C (122°F).

For more information about your device, visit: widex.pro.

Intended use

The device is intended to connect the COMPASS GPS fitting software with a wireless WidexLink hearing aid for fitting purposes.

SETTING UP THE DEVICE

Charging the device - see illustration 2

Connect the docking station to a power outlet and place the fitting device on the docking station. Alternatively, you can connect the docking station to your computer using the micro USB cable.

NOTE

Let the battery charge up to 100% before using the device for the first time.

Connecting the device to a computer - see illustrations 3,4 and 5

To connect your fitting device to your computer using the Bluetooth adaptor, do as follows:

3. Plug the Bluetooth adaptor into an USB port on your computer.
4. Turn on the computer.
5. Turn on the device. The system is now ready for use.

NOTE

Note that the device only connects to the Bluetooth adaptor provided. You can also use the micro USB cable provided with your fitting device to connect it to your computer.

USING THE DEVICE

Place the hearing aids and the neckloop on your client.

Press the push button on the device to turn it on and establish connection to the fitting software via Bluetooth.

Follow the fitting flow as indicated on your computer.

Visual indicators

The following table shows the available LEDs and what they mean:

Power, battery status, charging and Bluetooth pairing (see illustration 7):

LED	Meaning
7.1	The device is on and the battery charged
7.2	The device is charging
7.3	The battery is running low
7.4	The battery is very low
7.5	The device is in pairing mode
7.6	The device is connected via Bluetooth (only shown shortly after the device has been connected)

Communication between hearing aids and the device (see illustration 7):

LED	Meaning
7.7	The device is communicating with the hearing aids

MAINTENANCE

It is important that you keep your device clean and disinfected before use.

- Wipe the device and neckloop with a damp cloth. Do not use any chemicals.
- Do not immerse the device or neckloop in water or any other liquid.
- Clean the power supply, docking station, Bluetooth adapter and micro USB cable using a dry cloth.
- While the device is not in use, keep it in a dry location out of reach of children and pets.
- Never try to open or repair the device yourself. This may only be done by authorised technicians.

TROUBLESHOOTING

Problem	Possible cause	Solution
The device does not work	a: The device is not correctly connected to your computer b: The battery is low c: Out of operating range	a: Make sure the device is correctly connected and that the Bluetooth adaptor is plugged into your PC. b: Recharge the battery c: Move within operating range

If you still experience problems with connecting, pairing or using the device, contact your supplier for help.

REGULATORY INFORMATION

EU Directives

Directive 2014/53/EU

Hereby, Widex A/S declares that these PRO LINK and BT adaptor are in compliance with the essential requirements and other relevant provisions of Directive 2014/53/EU.

The PRO LINK contains radio transmitters operating at: 10.6 MHz, -54 dB μ A/m @10 m 2.4 GHz, 2.2 mW EIRP.

The BT adaptor contains a radio transmitter operating at: 2.4 GHz, 2.1 mW EIRP.

A copy of the Declaration of Conformity according to 2014/53/EU can be found at:

<http://global.widex.com/doc>



N26346









Information regarding disposal

Do not dispose of hearing aids, hearing aid accessories and batteries with ordinary household waste.

Hearing aids, batteries and hearing aid accessories should be disposed of at sites intended for waste electrical and electronic equipment, or given to your hearing care professional for safe disposal.

SYMBOLS

Symbols commonly used by Name in medical device labelling (labels/IFU/etc.)

Symbol	Title/Description
	Manufacturer The product is produced by the manufacturer whose name and address are stated next to the symbol. If appropriate, the date of manufacture may also be stated.
	Catalogue number The product's catalogue (item) number.
	Consult instructions for use The user instructions contain important cautionary information (warnings/precautions) and must be read before using the product.
	Warning Text marked with a warning symbol must be read before using the product.
	WEEE mark "Not for general waste". When a product is to be discarded, it must be sent to a designated collection point for recycling and recovering to prevent the risk of harm to the environment or human health as a result of the presence of hazardous substances.
	CE mark The product is in conformity with the requirements set out in European CE marking directives.
	RCM mark The product complies with electrical safety, EMC and radio spectrum regulatory requirements for products supplied to the Australian or New Zealand market.
	Interference Electromagnetic interference may occur in the vicinity of the product.

FCC AND IC STATEMENTS

FCC ID: TTY-PRLI

FCC ID: TTY-BA

IC: 5676B-PRLI

IC: 5676B-BA

CAN ICES-3(B)/NMB-3 (B)

Federal Communications Commission Statement

This device complies with part 15 of the FCC Rules. Operation is subject to the following two conditions:

- (1) This device may not cause harmful interference, and
- (2) this device must accept any interference received, including interference that may cause undesired operation.

NOTE:

This equipment has been tested and found to comply with the limits for a Class B digital device, pursuant to part 15 of the FCC Rules. These limits are designed to provide reasonable protection against harmful interference in a residential installation. This equipment generates, uses and can radiate radio frequency energy and, if not installed and used in accordance with the instructions, may cause harmful interference to radio communications. However, there is no guarantee that interference will not occur in a particular installation. If this equipment does cause harmful interference to radio or television reception, which can be determined by turning the equipment off and on, the user is encouraged to try to correct the interference by one or more of the following measures:

- Reorient or relocate the receiving antenna.
- Increase the separation between the equipment and receiver.
- Connect the equipment into an outlet on a circuit different from that to which the receiver is connected.
- Consult the dealer or an experienced radio/TV technician for help.

NOTE:

This equipment complies with FCC radiation exposure limits set forth for an uncontrolled environment. This transmitter must not be co-located or operating in conjunction with any other antenna or transmitter.

Changes or modifications to the equipment not expressly approved by Widex could void the user's authority to operate the equipment.

Industry Canada Statement / Déclaration d'industrie Canada

Under Industry Canada regulations, this radio transmitter may only operate using an antenna of a type and maximum (or lesser) gain approved for the transmitter by Industry Canada.

To reduce potential radio interference to other users, the antenna type and its gain should be so chosen that the equivalent isotropically radiated power (e.i.r.p.) is not more than that necessary for successful communication.

This device complies with Industry Canada licence-exempt RSS standard(s). Operation is subject to the following two conditions:

- (1) this device may not cause interference, and
- (2) this device must accept any interference, including interference that may cause undesired operation of the device.

Conformément à la réglementation d'Industrie Canada, le présent émetteur radio peut fonctionner avec une antenne d'un type et d'un gain maximal (ou inférieur) approuvé pour l'émetteur par Industrie Canada.

Dans le but de réduire les risques de brouillage radioélectrique à l'intention des autres utilisateurs, il faut choisir le type d'antenne et son gain de sorte que la puissance isotrope rayonnée équivalente (p.i.r.e.) ne dépasse pas l'intensité nécessaire à l'établissement d'une communication satisfaisante.

Le présent appareil est conforme aux CNR d'Industrie Canada applicables aux appareils radio exempts de licence. L'exploitation est autorisée aux deux conditions suivantes :

- (1) l'appareil ne doit pas produire de brouillage, et
- (2) l'utilisateur de l'appareil doit accepter tout brouillage radioélectrique subi, même si le brouillage est susceptible d'en compromettre le fonctionnement.

LICENSE AGREEMENT

Apache License (mbed TLS)

Version 2.0, January 2004

<http://apache.org/licenses/>

TERMS AND CONDITIONS FOR USE, REPRODUCTION, AND DISTRIBUTION

1. Definitions.

"License" shall mean the terms and conditions for use, reproduction, and distribution as defined by Sections 1 through 9 of this document.

"Licensor" shall mean the copyright owner or entity authorized by the copyright owner that is granting the License.

"Legal Entity" shall mean the union of the acting entity and all other entities that control, are controlled by, or are under common control with that entity. For the purposes of this definition, "control" means (i) the power, direct or indirect, to cause the direction or management of such entity, whether by contract or otherwise, or (ii) ownership of fifty percent (50%) or more of the outstanding shares, or (iii) beneficial ownership of such entity.

"You" (or "Your") shall mean an individual or Legal Entity exercising permissions granted by this License.

"Source" form shall mean the preferred form for making modifications, including but not limited to software source code, documentation source, and configuration files.

"Object" form shall mean any form resulting from mechanical transformation or translation of a Source form, including but not limited to compiled object code, generated documentation, and conversions to other media types.

"Work" shall mean the work of authorship, whether in Source or Object form, made available under the License, as indicated by a copyright notice that is included in or attached to the work (an example is provided in the Appendix below).

"Derivative Works" shall mean any work, whether in Source or Object form, that is based on (or derived from) the Work and for which the editorial revisions, annotations, elaborations, or other modifications represent, as a whole, an original work of authorship. For the purposes of this License, Derivative Works shall not include works that remain separable from, or merely link (or bind by name) to the interfaces of, the Work and Derivative Works thereof.

"Contribution" shall mean any work of authorship, including the original version of the Work and any modifications or additions to that Work or Derivative Works thereof, that is intentionally submitted to Licensor for inclusion in the Work by the copyright owner or by an individual or Legal Entity authorized to submit on behalf of the copyright owner. For the purposes of this definition, "submitted" means any form of electronic, verbal, or written communication sent to the Licensor or its representatives, including but not limited to communication on electronic mailing lists, source code control systems, and issue tracking systems that are managed by, or on behalf of, the

Licensors for the purpose of discussing and improving the Work, but excluding communication that is conspicuously marked or otherwise designated in writing by the copyright owner as "Not a Contribution."

"Contributor" shall mean Licensor and any individual or Legal Entity on behalf of whom a Contribution has been received by Licensor and subsequently incorporated within the Work.

2. Grant of Copyright License.

Subject to the terms and conditions of this License, each Contributor hereby grants to You a perpetual, worldwide, non-exclusive, no-charge, royalty-free, irrevocable copyright license to reproduce, prepare Derivative Works of, publicly display, publicly perform, sublicense, and distribute the Work and such Derivative Works in Source or Object form.

3. Grant of Patent License.

Subject to the terms and conditions of this License, each Contributor hereby grants to You a perpetual, worldwide, non-exclusive, no-charge, royalty-free, irrevocable (except as stated in this section) patent license to make, have made, use, offer to sell, sell, import, and otherwise transfer the Work, where such license applies only to those patent claims licensable by such Contributor that are necessarily infringed by their Contribution(s) alone or by combination of their Contribution(s) with the Work to which such Contribution(s) was submitted. If You institute patent litigation against any entity (including a cross-claim or counterclaim in a lawsuit) alleging that the Work or a Contribution incorporated within the Work constitutes direct or contributory patent infringement, then any patent licenses granted to You under this License for that Work shall terminate as of the date such litigation is filed.

4. Redistribution.

You may reproduce and distribute copies of the Work or Derivative Works thereof in any medium, with or without modifications, and in Source or Object form, provided that You meet the following conditions:

1. You must give any other recipients of the Work or Derivative Works a copy of this License; and
2. You must cause any modified files to carry prominent notices stating that You changed the files; and
3. You must retain, in the Source form of any Derivative Works that You distribute, all copyright, patent, trademark, and attribution notices from the Source form of the Work, excluding those notices that do not pertain to any part of the Derivative Works; and
4. If the Work includes a "NOTICE" text file as part of its distribution, then any Derivative Works that You distribute must include a readable copy of the attribution notices contained within such NOTICE file, excluding those notices that do not pertain to any part of the Derivative Works, in at least one of the following places: within a NOTICE text file distributed as part of the Derivative Works; within the Source form or documentation, if provided along with the Derivative Works; or, within a display generated by the Derivative Works, if and wherever such third-party notices normally appear. The contents of the NOTICE file are for informational purposes only and do not modify the License. You may add Your own attri-

tribution notices within Derivative Works that You distribute, alongside or as an addendum to the NOTICE text from the Work, provided that such additional attribution notices cannot be construed as modifying the License.

You may add Your own copyright statement to Your modifications and may provide additional or different license terms and conditions for use, reproduction, or distribution of Your modifications, or for any such Derivative Works as a whole, provided Your use, reproduction, and distribution of the Work otherwise complies with the conditions stated in this License.

5. Submission of Contributions.

Unless You explicitly state otherwise, any Contribution intentionally submitted for inclusion in the Work by You to the Licensor shall be under the terms and conditions of this License, without any additional terms or conditions. Notwithstanding the above, nothing herein shall supersede or modify the terms of any separate license agreement you may have executed with Licensor regarding such Contributions.

6. Trademarks.

This License does not grant permission to use the trade names, trademarks, service marks, or product names of the Licensor, except as required for reasonable and customary use in describing the origin of the Work and reproducing the content of the NOTICE file.

7. Disclaimer of Warranty.

Unless required by applicable law or agreed to in writing, Licensor provides the Work (and each Contributor provides its Contributions) on an "AS IS" BASIS, WITHOUT WARRANTIES OR CONDITIONS OF ANY KIND, either express or implied, including, without limitation, any warranties or conditions of TITLE, NON-INFRINGEMENT, MERCHANTABILITY, or FITNESS FOR A PARTICULAR PURPOSE. You are solely responsible for determining the appropriateness of using or redistributing the Work and assume any risks associated with Your exercise of permissions under this License.

8. Limitation of Liability.

In no event and under no legal theory, whether in tort (including negligence), contract, or otherwise, unless required by applicable law (such as deliberate and grossly negligent acts) or agreed to in writing, shall any Contributor be liable to You for damages, including any direct, indirect, special, incidental, or consequential damages of any character arising as a result of this License or out of the use or inability to use the Work (including but not limited to damages for loss of goodwill, work stoppage, computer failure or malfunction, or any and all other commercial damages or losses), even if such Contributor has been advised of the possibility of such damages.

9. Accepting Warranty or Additional Liability.

While redistributing the Work or Derivative Works thereof, You may choose to offer, and charge a fee for, acceptance of support, warranty, indemnity, or other liability obligations and/or rights consistent with this License. However, in accepting such obligations, You may act only on Your own behalf and on Your sole responsi-

bility, not on behalf of any other Contributor, and only if You agree to indemnify, defend, and hold each Contributor harmless for any liability incurred by, or claims asserted against, such Contributor by reason of your accepting any such warranty or additional liability.

END OF TERMS AND CONDITIONS

Appendix: How to apply the Apache License to your work

To apply the Apache License to your work, attach the following boilerplate notice, with the fields enclosed by brackets "[]" replaced with your own identifying information. (Don't include the brackets!) The text should be enclosed in the appropriate comment syntax for the file format. We also recommend that a file or class name and description of purpose be included on the same "printed page" as the copyright notice for easier identification within third-party archives.

Copyright [yyyy] [name of copyright owner]

Licensed under the Apache License, Version 2.0 (the "License"); you may not use this file except in compliance with the License. You may obtain a copy of the License at <http://www.apache.org/licenses/LICENSE-2.0>

Unless required by applicable law or agreed to in writing, software distributed under the License is distributed on an "AS IS" BASIS, WITHOUT WARRANTIES OR CONDITIONS OF ANY KIND, either express or implied. See the License for the specific language governing permissions and limitations under the License.

Copyright © Widex A/S, 2017 - 2018. All rights reserved. Any unauthorized redistribution or use of the software in source or binary form is prohibited and will be prosecuted when discovered.