

**OWNER'S MANUAL
(T-2101)**

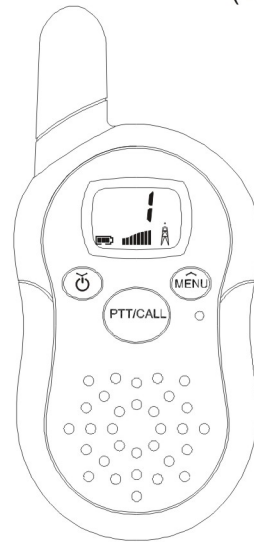

PLEASE READ THIS OWNER'S MANUAL CAREFULLY BEFORE USE. KEEP FOR YOUR REFERENCE.

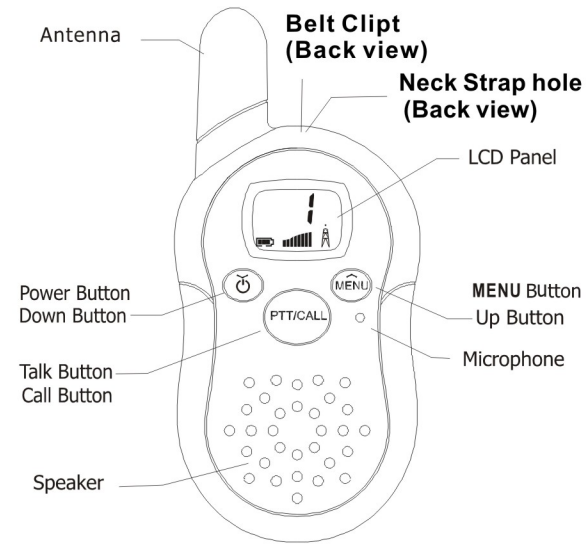

Function description

1. Batteries: Use 3 "AAA" size batteries.
2. Belt clip: The belt clip is attached for easy use.
3. LCD display: Displays current channel selection and other radio status symbols.
4. **Power/Down** \odot button:
Press and hold the \odot button to turn your unit on/off.
Press the \odot button to decrease the speaker volume.
5. **MENU/UP** \hat{M} button:
Press and hold the **MENU** button to Channel and function selector.
Press the \hat{M} button to increase the speaker volume.
6. **TALK/CALL** button:
Press **TALK/CALL** button to transmit.
Press **TALK/CALL** button double times to **CALL**

	- Receiving icon, displayed when receiving a signal.
	- Transmitting icon, displayed when transmitting a signal.
	- Display of current volume.
SCAN	- Displayed during the Channel Scan mode.
	- Keyboard is locked.
	- Display of the current battery level.
	- Channel number.

Getting started

BATTERY INSTALLATION:

- Remove the belt clip by pulling the tab and sliding it up.
- Pull the battery door lock tab down to release the battery cover. Insert 3 "AAA" batteries.
- Replace battery cover. Snap the lock tab and belt clip back into place.
- To use the radio, you must install 3 "AAA" size batteries.

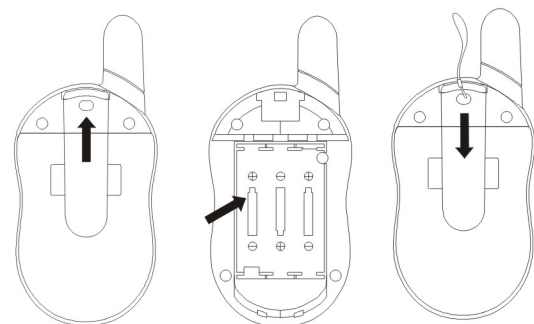

Figure 1

Figure 2

Figure 3

Operation

Turning the unit ON

Press and hold the \odot button. The unit will beep and the LCD display will display the current channel.

Turning the unit OFF

Press and hold the \odot button. The unit will beep and the LCD display will turn blank.

Adjusting the speaker volume

- Press the \hat{M} button to increase the speaker volume.
- Press the \odot button to decrease the speaker volume.
- The speaker volume level is indicated by the number of bars displayed in the lower left corner of the LCD display.

RECEIVING COMMUNICATIONS:

- When the FRS is switched on and not being used for speech or paging, it is always in the receiving mode.
- Pressing the **TALK** or **Call** buttons automatically overrides and turns off the receiving mode.

Calling another radio

- Turn the volume up to an audible level.
- Set both units to the same channel.
- Press **TALK/CALL** button double times to **CALL**. The other unit will make a 2 second call tone. They can then respond to your call by either:
- pressing the **TALK/CALL** button and speaking into the radio, or
- Press **TALK/CALL** button double times to **CALL**, which activates a 2 second call tone on your radio.

Operation

Changing channels

The COMMUNICATOR has multi-channels. To change channels:

1. Press and hold the \hat{M} button until the current channel number and [ch] icon flash on the LCD display.
2. While the channel number is flashing:
- Press the \hat{M} button to move to a higher channel.
- Press the \odot button to move to a lower channel.
3. Press and hold the \hat{M} button to choose the desired channel and return to normal mode, or press the **TALK/CALL** button to confirm the channel and go to the **MONITOR** melody option.

AUTOMATIC SQUELCH:

The FRS is equipped with an automatic squelch circuitry filtering out weak transmission and unwanted noise, usually caused by terrain conditions.

MONITOR:

- This feature turns off the automatic squelch feature, either momentarily or continuously. It helps in receiving signals to its maximum range, but may pick up static signals, too.

Continuous monitor:

- Press and hold the \hat{M} button until the current channel number and [oF] icon flash on the LCD display.
- Press the **TALK/CALL** button to the **MONITOR** melody option.
- Press the \odot button to ON. The monitor symbol will appear.
- Press the **TALK/CALL** button to restore the automatic squelch.

Operation

CHANNEL SCAN:

- Your radio can scan across 8 channels allowing it to search other radios without changing channels. To scan:
- Press and hold the \hat{M} button until the current channel number and [ch] icon flash on the LCD display.
- Press the **TALK/CALL** button to the **SCAN** melody option.
- Press the \hat{M} button to ON to activate the channel scan. The channel number will run rapidly on the display. When a signal is detected, the channel scan pauses keeping the active signal broadcasted.
- Press the **TALK/CALL** button to communicate (the Channel Scan is deactivated). When the active signal is detected and another channel is desired, press the \odot button to search for another active channel.
- To stop the scanning operation, press the **TALK/CALL** button again.

Low battery indicator

When the batteries need to be changed, the battery level icon will flash. To ensure uninterrupted communication, recharge or replace the batteries as soon as possible.

Automatic battery save

Your FRS has a special circuitry designed to extend the life of your batteries. When the radio is not used for 4 seconds, it will switch itself into a low power mode. The battery save mode does not affect the radio's ability to receive transmissions. When a signal is detected, it automatically returns to full power.



operation on GMRS frequencies requires an FCC license, and such operation is subject to additional rules specified in Part 95 including prohibited communications in Section 95.183.

For hand held operation, the radio device should be held at least 2.5cm from the user's face. To maintain compliance with FCC RF exposure requirements, body worn operations are restricted to supply belt clip. The use of accessories that do not satisfy these requirements may not comply with FCC RF exposure requirements and should be avoided.

FRS Authorized Bandwidth 12.5kHz

2.1033(c)(5) FRS Frequency Range:

95.627

- | | |
|-------------|------------------|
| 1. 462.5625 | 8. 467.5625 |
| 2. 462.5875 | 9. 467.5875 |
| 3. 462.6125 | 10. 467.6125 |
| 4. 462.6375 | 11. 467.6375 |
| 5. 462.6625 | 12. 467.6625 |
| 6. 462.6875 | 13. 467.6875 |
| 7. 462.7125 | 14. 467.7125 MHz |

GMRS Authorized Bandwidth 20.0kHz

2.1033(c)(5) GMRS Frequency Range:

95.621

- 15. 462.5500
- 16. 462.5750
- 17. 462.6000
- 18. 462.6250
- 19. 462.6500
- 20. 462.6750
- 21. 462.7000
- 22. 462.7250 MHz

FCC ID: N3E74047

IMPORTANT REGULATORY INFORMATION

This device complies with Part 15 of the FCC Rules: Operation is subject to the

following two conditions:

1. This device may not cause harmful interference and
2. This device must accept any interference that is received, including any interference that may cause undesired operation.

WARNING:

Changes or modifications to this unit not expressly approved by the party responsible for compliance could void the user's authority to operate the equipment.