



MINI SPY LISTENER CAR™

Ages 8 and Up
70210
Requires 2 9V (6LR61)
batteries, not included.

Important: Please save this instruction sheet. It contains valuable product information.

ADULTS: INSTALLING BATTERIES

1. Using a small Phillips screwdriver, loosen screw and remove **BATTERY DOOR** on each unit. (Figs. 2 and 4)
2. Remove both old batteries.
3. Snap a fresh, new battery onto each **BATTERY CLIP**. (Fig. 3)
IMPORTANT: Observe battery polarity (direction, + and -)
4. Place each battery into battery compartment, making sure wires and clip are tucked neatly inside.
5. Replace battery covers and tighten screws.

OPERATING MINI SPY LISTENER VEHICLE

1. Slide **SWITCH** on **VEHICLE** to **ON** position. **RED LED** will light.
 2. Place vehicle in the room you would like to listen in, **OR** send it in to spy.
 3. To send vehicle in to spy, place it on the floor, making sure both rear wheels are contacting the floor.
 4. Pull back the vehicle to wind the motor, point vehicle in the direction you want to go, then let go. For maximum distance, pull the vehicle back until you hear the clicking "ratchet" sound, indicating the motor is fully wound.
- **Tip:** Vehicle will travel farther on hard floors than on carpet.
 - Always turn power off when not in use to preserve battery life.

OPERATING LISTENING RECEIVER

1. Move up to 75 feet (23 meters) from the vehicle.
 2. Rotate the **POWER/VOLUME CONTROL** to turn on the power. **RED LED** will light. *Set volume to a low level to start.*
 3. Unsnap **EAR BUD**, unwrap **CORD**, and place ear bud in your ear.
 4. **SLOWLY** turn volume up until you can hear.
- Always turn power off when not in use to preserve battery life.

CONNECTING/CARRYING ON BELT CLIP

1. Turn off the power on both units.
2. Wrap cord around **CORD SPOOL**, snap ear bud into **HOLDER**.
3. Push **CONNECTOR** on receiver into **SLOT** on vehicle.
4. Secure **ANTENNA** under **CLIP** on either side of cord spool. (Fig. 1)
5. Hang connected units on your belt using **BELT CLIP**.

BATTERY SAFETY

1. Only adults should install and replace batteries.
2. Do not recharge non-rechargeable batteries.
3. Remove dead or exhausted batteries.
4. Insert batteries correctly. Match positive and negative signs.
5. The supply terminals are not to be short circuited.
6. Do not use rechargeable batteries.
7. Do not mix alkaline, standard (carbon-zinc), or rechargeable (nickel-cadmium) batteries.
8. Do not mix old and new batteries.
9. Only the batteries of the same or equivalent type recommended to be used.
10. Do not dispose of batteries in a fire; they may explode.
11. Dispose of batteries safely.

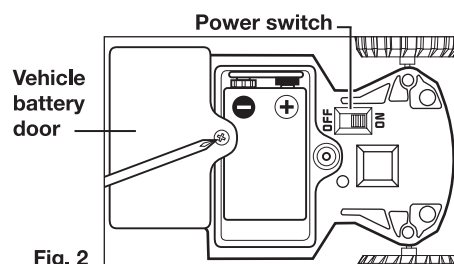
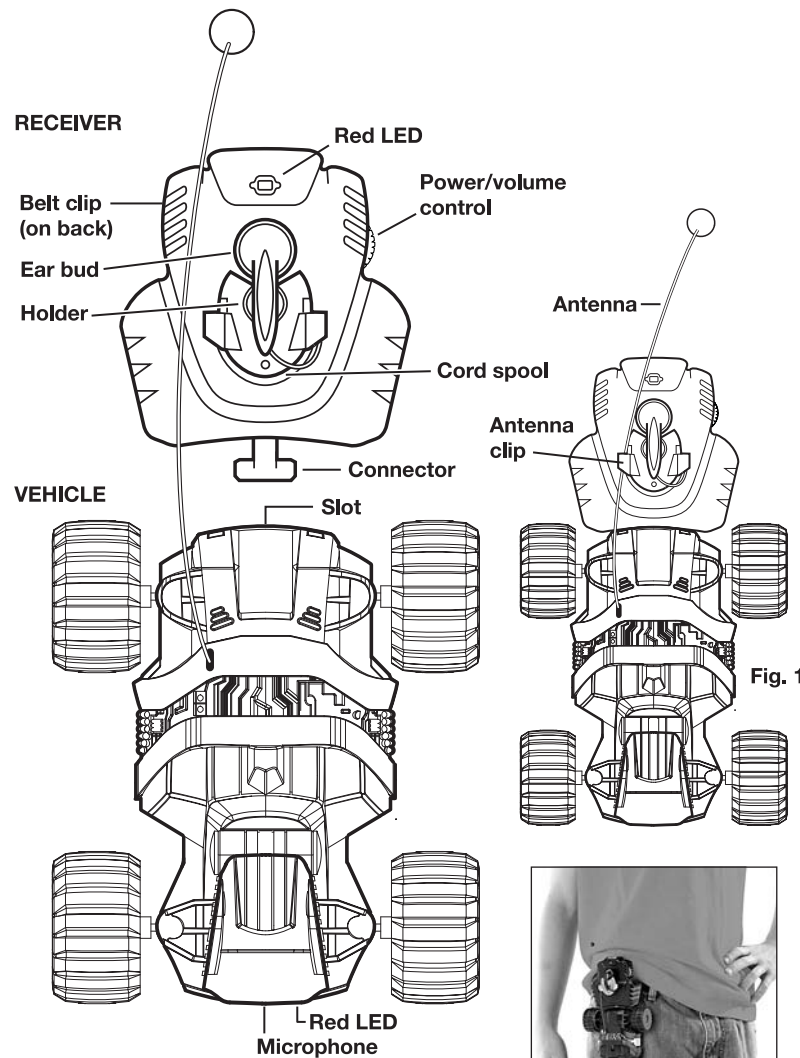

Fig. 2

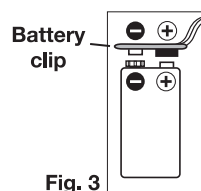

Fig. 3

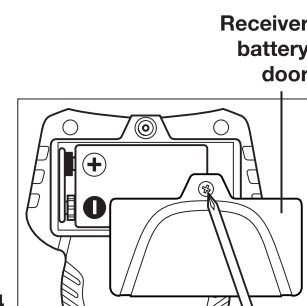

Fig. 4

WARNING: Changes or modifications to this equipment not expressly approved by the party responsible for compliance could void the user's authority to operate the equipment.

FCC ID: N3EMINSPYLISCAR1

This device complies with Part 15 of the FCC Rules. Operation is subject to the following two conditions: (1) This device may not cause harmful interference, and (2) This device must accept any interference received, including interference that may cause undesired operation.

NOTE: This equipment has been tested and found to comply with the limits for a Class B digital device, pursuant to Part 15 of the FCC Rules. These limits are designed to provide reasonable protection against harmful interference in a residential installation. This equipment generates, uses, and can radiate radio frequency energy and, if not installed and used in accordance with the instructions, may cause harmful interference to radio communications. However, there is no guarantee that interference will not occur in a particular installation. If this equipment does cause harmful interference to radio or television reception, which can be determined by turning the equipment off and on, the user is encouraged to try to correct the interference by one or more of the following measures:

- Reorient or relocate the receiving antenna.
- Increase the separation between the equipment and receiver.
- Connect the equipment into an outlet on a circuit different from that to which the receiver is connected.
- Consult the dealer or an experienced radio/TV technician for help.



70210-4000-TRU PR 9/07
IF YOU HAVE ANY QUESTIONS, PLEASE CONTACT US AT
1-800-247-6570
WWW.WILDPLANET.COM/HELP
Wild Planet Entertainment, Inc., P.O. Box 194087
San Francisco, CA 94119-4087

© 2006 Wild Planet Entertainment, Inc., San Francisco, CA 94104, USA. All rights reserved. **PRINTED IN CHINA.**
Product specifications subject to change.