

SIZE:165 x125(mm)

K:80

Pantone 158C

Red&Green(With Remote) #785860

User Manual

#785860



Garden Laser Projector
Red&Green (With Remote)
Instruction Menu

Model : AL69-RX



www.ishowtree.com

PACKAGE CONTENTS

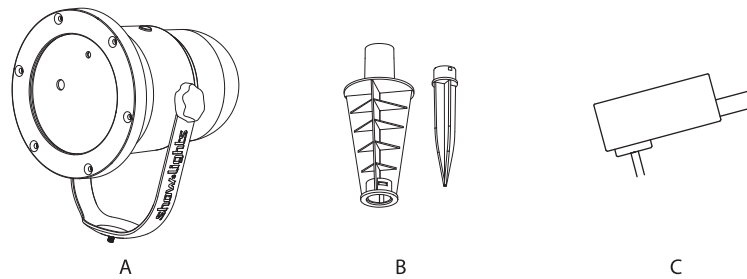

| PART | DESCRIPTION | QUANTITY |
|------|------------------------------------|----------|
| A | Laser Light Projector+Laser holder | 1 |
| B | Ground Stake | 1 |
| C | Adapter | 1 |

PRODUCT DESCRIPTION

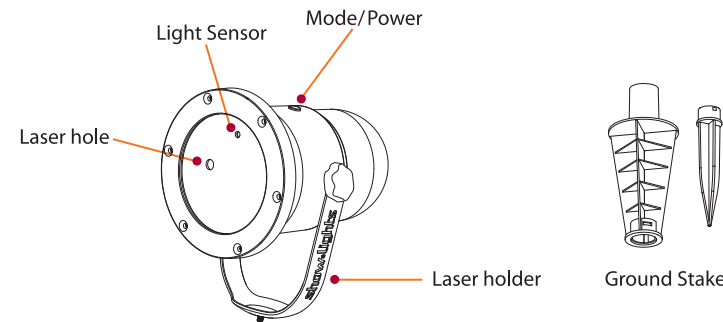

REMOTE CONTROL

Remote Control Instructions

1. Pull the plastic sheet located below the remote before using.
This remote is infrared which only allow receiving a distance is of 8 meters.

2. Turn on /off.

3. Flash on/off.

4. is the buttons to change the color.

Control red lighting ON /OFF

Control green lighting ON/OFF

Is for moving light, here are three options: Slow, Fast, Static.

Control Slow and Static mode

Control fast mode

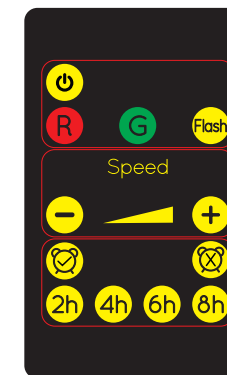

7. Timer: Press the and Show Light laser projector will flash thrice, This indicate timer is set for 2 hour. If you need to change from 2hrs to another time Press the hour below.

To cancel the timer, Press show lights laser projector will flash thrice to cancel the timer.

Product Instructions

1 Assemble the ground stake

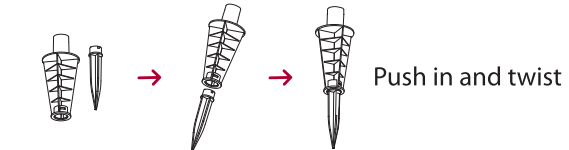

2 Adapter: Plug in directly, reverse prevented



3 Connect projector to stake (Twist screw to secure the holder)

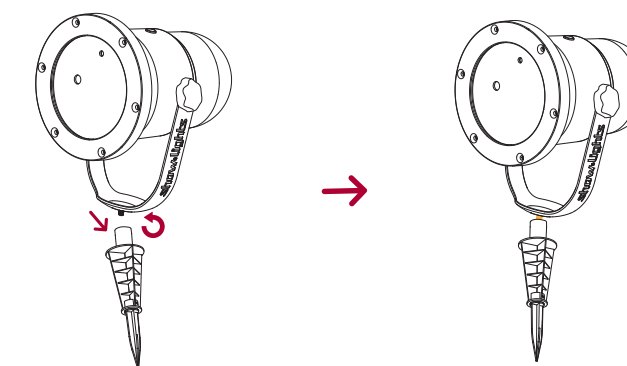

1. Connect the power adapter to the laser light.

The adapter input voltage is AC120V.

2. Press the button to switch mode.

3. Press and hold to turn on/off.

4. Show light laser will only work at night

SAFETY INSTRUCTIONS

Safety Attention

1. Better to work 6 hours then cool it down with 30 minutes, it will save the lifetime of lighting source.

2. This product is mainly used for outdoor with waterproof Ip65. It has excellent radiating ease put it far way from the flammable objects or liquids.

3. Please use show light laser projector power adaptor to support the light. If you need to change a new adaptor please check the parameter of our adaptor and before you buy a new one.

CAUTION

1. Danger-laser eadiation when open.
2. Avod direct exposure to beam.
3. Avoid direct eye exposure
4. Laser radition-do not stare into beam or view directly withoptical instruments



IMPORTANT!

- * Show light laser projector only work during the night.
- * Once the light sensor on the lens sence light, show light laser projector will not turn on.
- * Do not point the show light laser projector to the airplane or up in the sky.

SIZE:165 x125(mm)

K:80

Pantone 158C

Green #785858



www.ishowtree.com



#785858

PACKAGE CONTENTS

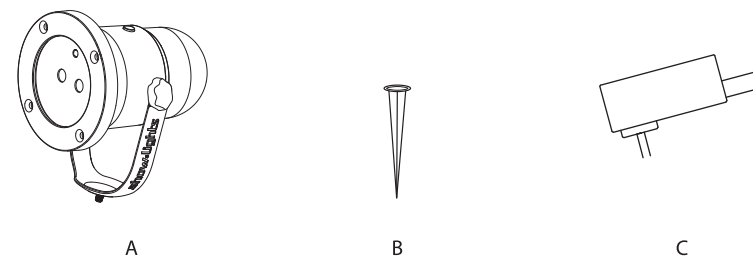

| PART | DESCRIPTION | QUANTITY |
|------|------------------------------------|----------|
| A | Laser Light Projector+Laser holder | 1 |
| B | Ground Stake | 1 |
| C | Adapter | 1 |

PRODUCT DESCRIPTION

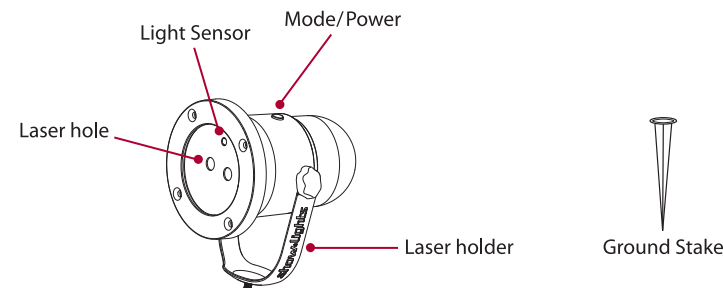

Product Instructions

1 Adapter: Plug in directly, reverse prevented



2 Connect projector to stake (Twist screw to secure the holder)

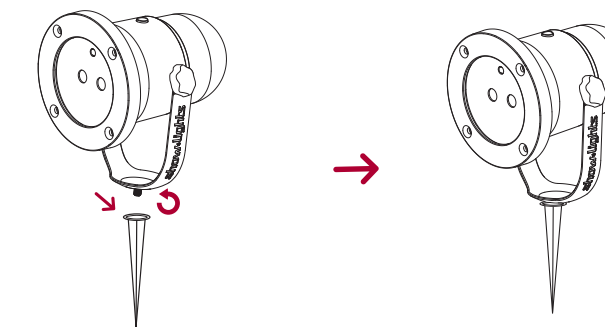

1. Connect the power adapter to the laser light.
The adapter input voltage is AC120V.

2. Press the button to switch mode.

3. Press and hold to turn on/off.

4. Show light laser will only work at night

SAFETY INSTRUCTIONS

Safety Attention

- Better to work 6 hours then cool it down with 30 minutes, it will save the lifetime of lighting source.
- This product is mainly used for outdoor with waterproof Ip65. It has excellent radiating ease put it far way from the flammable objects or liquids.
- Please use show light laser projector power adaptor to support the light. If you need to change a new adaptor please check the parameter of our adaptor and before you buy a new one.

CAUTION

- Danger-laser eadiation when open.
- Avod direct exposure to beam.
- Avoid direct eye exposure
- Laser radition-do not stare into beam or view directly withoptical instruments



IMPORTANT!

- * Show light laser projector only work during the night.
- * Once the light sensor on the lens sence light, show light laser projector will not turn on.
- * Do not point the show light laser projector to the airplane or up in the sky.

FCC NOTE :

This device complies with Part 15 of the FCC Rules. Operation is subject to the following two conditions: (1) this device may not cause harmful interference, and (2) this device must accept any interference received, including interference that may cause undesired operation.

THE MANUFACTURER IS NOT RESPONSIBLE FOR ANY RADIO OR TV INTERFERENCE CAUSED BY UNAUTHORIZED MODIFICATIONS OR CHANGE TO THIS EQUIPMENT. SUCH MODIFICATIONS OR CHANGE COULD VOID THE USER'S AUTHORITY TO OPERATE THE EQUIPMENT.

This equipment has been tested and found to comply with the limits for a Class B digital device, pursuant to part 15 of the FCC Rules. These limits are designed to provide reasonable protection against harmful interference in a residential installation. This equipment generates, uses and can radiate radio frequency energy and, if not installed and used in accordance with the instructions, may cause harmful interference to radio communications. However, there is no guarantee that interference will not occur in a particular installation. If this equipment does cause harmful interference to radio or television reception, which can be determined by turning the equipment off and on, the user is encouraged to try to correct the interference by one or more of the following measures: -- Reorient or relocate the receiving antenna.

-- Increase the separation between the equipment and receiver.

-- Connect the equipment into an outlet on a circuit different from that to which the receiver is connected.

-- Consult the dealer or an experienced radio/TV technician for help.

-- Reorient or relocate the receiving antenna.

-- Increase the separation between the equipment and receiver.

-- Connect the equipment into an outlet on a circuit different from that to which the receiver is connected.

-- Consult the dealer or an experienced radio/TV technician for help.

SIZE:165 x125(mm)

K:80

Pantone 158C Red&Green #785859



www.ishowtree.com



#785859

PACKAGE CONTENTS

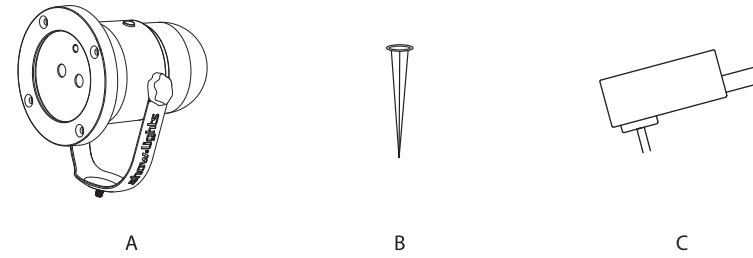

| PART | DESCRIPTION | QUANTITY |
|------|------------------------------------|----------|
| A | Laser Light Projector+Laser holder | 1 |
| B | Ground Stake | 1 |
| C | Adapter | 1 |

PRODUCT DESCRIPTION

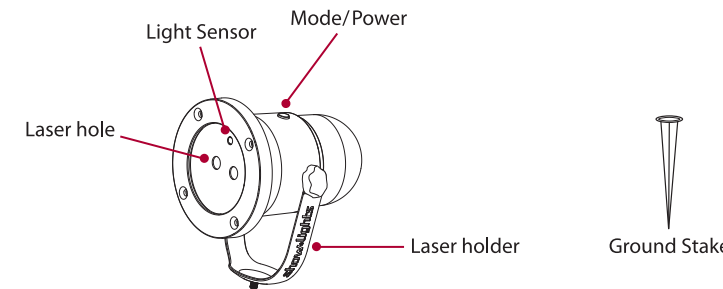

Product Instructions

1 Adapter: Plug in directly, reverse prevented



2 Connect projector to stake(Twist screw to secure the holder)

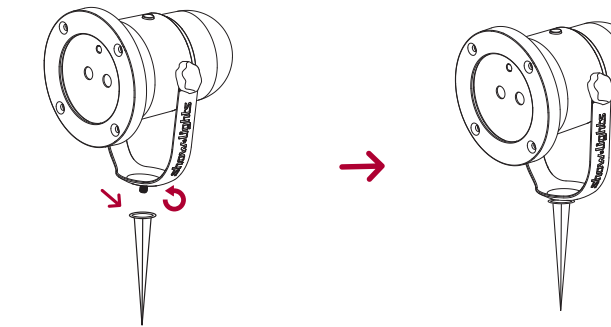

1. Connect the power adapter to the laser light.
The adapter input voltage is AC120V.

2. Press the button to switch mode.

3. Press and hold to turn on/off.

4. Show light laser will only work at night

SAFETY INSTRUCTIONS

Safety Attention

- Better to work 6 hours then cool it down with 30 minutes, it will save the lifetime of lighting source.
- This product is mainly used for outdoor with waterproof Ip65. It has excellent radiating ease put it far way from the flammable obejects or liquids.
- Please use show light laser projector power adaptor to support the light. If you need to change a new adaptor please check the parameter of our adaptor and before you buy a new one.

CAUTION

- Danger-laser eadiation when open.
- Avod direct exposure to beam.
- Avoid direct eye exposure
- Laser radition-do not stare into beam or view directly withoptical instruments



IMPORTANT!

- * Show light laser projector only work during the night.
- * Once the light sensor on the lens sence light, show light laser projector will not turn on.
- * Do not point the show light laser projector to the airplane or up in the sky.