



Instruction

Name : Dimple KeyFob (Bluetooth)

Type : W0101BLE02

Technology : Bluetooth V4.0 (Single mode)

Operating Frequency : ISM2.4GHz

Use Range : Open Space Up to 30M

Detection Range : Open Space Up to 120M

Battery Type : CR2025 3V, 165mAh(included)

Electric Quantity: Used for about 1 year on standby condition
(on testing 30 minutes per day)

Operating ambient temperature : -20° C+70° C RH<=90%

Place the ambient temperature : -40° C+85° C

Dimension : Housing - Silicone-35.8mm x 29 mm

Parts Shell's - ABS resin-28mm x 7.2mm

Made in Taiwan

www.dimple.com.tw

WARNING & SAFTY

This product is not a toy, included something small like battery, in order to avoid dangerousness and suffocation, please prevent the children from swallowing . If you replace this battery explosion hazard incorrect, please dispose of used according to the manufacturer's instructions for battery.

Warning! Under the following conditions will not provide free warranty:

- 1.No in accordance with the instruction manual operation, damage by improper use.
- 2.This product serial number stickers, warranty stickers forged or destroyed, making it impossible to identify the warranty period.
- 3.break caused by human use, flooding, erosion, foreign invasion, loss and damage to those parts.
- 4.due to natural disasters or force majeure outside damage or malfunction.
- 5.disassemble repair, modification and improper non-factory maintenance processing.
- 6.Use of non-original parts or supplies.
- 7.outside of the machine body due to the failure of other products (equipment) are induced.
- 8.product has exceeded the warranty period provided by the Company.

NCC 警語

第十二條

經型式認證合格之低功率射頻電機，非經許可，公司、商號或使用者均不得擅自變更頻率、加大功率或變更原設計之特性及功能。

第十四條

低功率射頻電機之使用不得影響飛航安全及干擾合法通信；經發現有干擾現象時，應立即停用，並改善至無干擾時方得繼續使用。前項合法通信，指依電信法規定作業之無線電通信。低功率射頻電機須忍受合法通信或工業、科學及醫療用電波輻射性電機設備之干擾。

FCC

Federal Communication Commission Interference Statement

This device complies with Part 15 of the FCC Rules. Operation is subject to the following two conditions: (1) This device may not cause harmful interference, and (2) this device must accept any interference received, including interference that may cause undesired operation.

This equipment has been tested and found to comply with the limits for a Class B digital device, pursuant to Part 15 of the FCC Rules. These limits are designed to provide reasonable protection against harmful interference in a residential installation. This equipment generates, uses and can radiate radio frequency energy and, if not installed and used in accordance with the instructions, may cause harmful interference to radio communications. However, there is no guarantee that interference will not occur in a particular installation. If this equipment does cause harmful interference to radio or television reception, which can be determined by turning the equipment off and on, the user is encouraged to try to correct the interference by one of the following measures:

- Reorient or relocate the receiving antenna.
- Increase the separation between the equipment and receiver.
- Connect the equipment into an outlet on a circuit different from that to which the receiver is connected.
- Consult the dealer or an experienced radio/TV technician for help.

FCC Caution: Any changes or modifications not expressly approved by the party responsible for compliance could void the user's authority to operate this equipment.

This transmitter must not be co-located or operating in conjunction with any other antenna or transmitter.

Radiation Exposure Statement:

This equipment complies with FCC radiation exposure limits set forth for an uncontrolled environment. This equipment should be installed and operated with minimum distance 20cm between the radiator & your body.

1 Start using Dimple www.dimple.com.tw

- a.Open the box.
- b.Take out the Dimple and battery.
- c. Remove the battery spacer.
- d. Insert the battery into the Dimple.

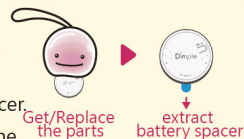

2 Install the Dimple APP

- a. iOS and Android device with Bluetooth 4.0.
- b. Go to the App store or Play store , search **Dimple** by your device and the Dimple App is for free.



3 Start using Dimple App

- a.Pair : Press **+** show a dialog box and display Dimple's pairing code, please press OK. **+** turn into **X** ,and the pairing is completed.
 - b.Take the Dimple to hanging on the articles.
- ⚠ Press **X** remove the pairing



4 Dimple condition www.dimple.com.tw

- a. **Power Display** Full means Dimple with fully charged. None means Dimple with no power, please change the battery.
- b. **Signal Display** Full means Dimple with strongly signal. None means Dimple with no signal, please check the place whether provides signal or not.

5 Find articles with Dimple

- a. **Find articles with Dimple**
After pressing **Q** ,Dimple will sound and light, it is very easy to look for the articles.
- b. **Find your device by Dimple**
Press the Dimple's button , the device will sound a ring and you can find out your device easily.

