

QUICK REFERENCE

KB-604
Touch Pad Wireless Keyboard

1.Introduction

Thank you for choosing the wireless keyboard for smart TV and PC

2.Product description

The wireless keyboard is a keyboard with touchpad mouse function on the same keyboard.

Includes 87 standard keys and 12 multimedia functions. Perfect to easily control all smart TV devices or use as a wireless keyboard for PC.

With stylish and compact design and low profile keys, perfect for storage anywhere in the home.

Forget wires with its nano receiver connected to a USB port and increase the potential of your smart TV.

3.Package Contents

Keyboard and nano receiver

Quick Install Guide

4.Note:

Make sure your package contains the items described above. If you find any items are missing or damaged, please contact your dealer.

5 System Requirements

USB2.0 port Smart TV or PC

6.Installation and configuration

Installation Procedure for keyboard battery

Step 1: Open the battery compartment cover on the bottom of the keyboard

Step 2: Insert two AAA batteries into the battery compartment as shown in the picture.

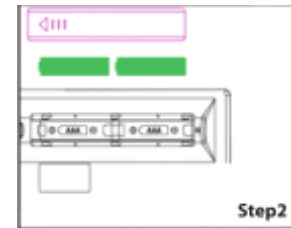

Step 3: Close the battery cover.
Step 4: Change the Switch to ON.

7.Installing the nano reciver
Place the nano receiver into a free port on your PC or Smart TV



8.Hotkeys keyboard

Valid only for Windows PC

FN+F1=Media Player	FN+F8=Stop
FN+F2=Volume down	FN+F9=Internet explorer
FN+F3= Volume UP	FN+F10=Email
FN+F4=mute	FN+F11=My PC
FN+F5=previous track	FN+F12=Favorites
FN+F6= Next track	
FN+F7=Play/pause	

Touch pad function

By default the feature is enabled keypad, press the Num lock key to activate or deactivate.

9.List of functions in mouse mode.

Flick of the finger on the touch pad : Move the mouse pointer

Clicking the finger on the touch panel: Left mouse button

Double Click with your finger on the touch pad: Middle mouse button

Make Click with three fingers at once on the touch pad: right mouse button

Double Click with your fingers and push the left: Page up

Double Click with your fingers and push the right: Page down

Double Click with your fingers and thumb up/down: Scroll up/down

Single finger slider as
Mouse cursor movement



Three finger click as
Mouse right key function



Two finger slider to
right side as next page



Zoom In
Zoom out



Single finger slide from right
side as right Charm Bar
opening of Win8



10. Technical support

For more information about installing and configuring this product, please visit our website or send an email to us, thanks.

Single finger click as
Mouse left key function



Two finger slider to left side
as previous page



Two finger slider to up and down
as scroll wheel up and down



Single finger slide from upper
side as function of application
opening



Single finger slide from left
side as windows switching



FCC STATEMENT :

This device complies with Part 15 of the FCC Rules. Operation is subject to the following two conditions:
(1) This device may not cause harmful interference, and
(2) This device must accept any interference received, including interference that may cause undesired operation.
Warning: Changes or modifications not expressly approved by the party responsible for compliance could void the user's authority to operate the equipment.

NOTE: This equipment has been tested and found to comply with the limits for a Class B digital device, pursuant to Part 15 of the FCC Rules. These limits are designed to provide reasonable protection against harmful interference in a residential installation. This equipment generates uses and can radiate radio frequency energy and, if not installed and used in accordance with the instructions, may cause harmful interference to radio communications. However, there is no guarantee that interference will not occur in a particular installation. If this equipment does cause harmful interference to radio or television reception, which can be determined by turning the equipment off and on, the user is encouraged to try to correct the interference by one or more of the following measures:
Reorient or relocate the receiving antenna.
Increase the separation between the equipment and receiver.
Connect the equipment into an outlet on a circuit different from that to which the receiver is connected.
Consult the dealer or an experienced radio/TV technician for help.