



W1

PORTABLE WI-FI SPEAKER

INSTRUCTION MANUAL

TABLE OF CONTENTS

Introduction	2
Features	
Inside the box	
Product overview	4
Functions	
Powering on	
Charging the Speaker	
Villo App	5
App download	
Setup your speaker	
Dashboard	6
Add speakers	
Group speakers (Multi-room music)	
Speaker settings	
More App Controls	8
Bluetooth/Wi-Fi Connection	9
Troubleshooting	10
Warranty	12

INTRODUCTION

Thank you for purchasing the Villo W1. This speaker is designed to fill your space with hi-fidelity music over your Wi-Fi network. Please read this instruction manual and your Quick Start Guide carefully and keep for future reference.

Features

- Built in Wi-Fi and Bluetooth connectivity for multi-room streaming
- Wireless setup using smartphone or tablet
- Control speaker(s) using the Villo app
- Incredible sound, multi-speaker connectivity
- Portable, take with you on the go
- Compatible with internet music streaming services

Inside the box

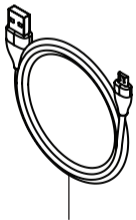
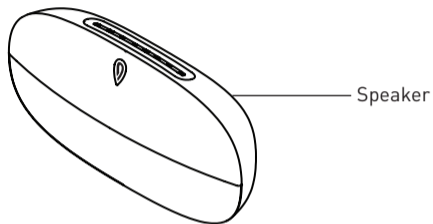

USB Charging cable

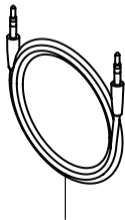

AUX-in cable

PRODUCT OVERVIEW

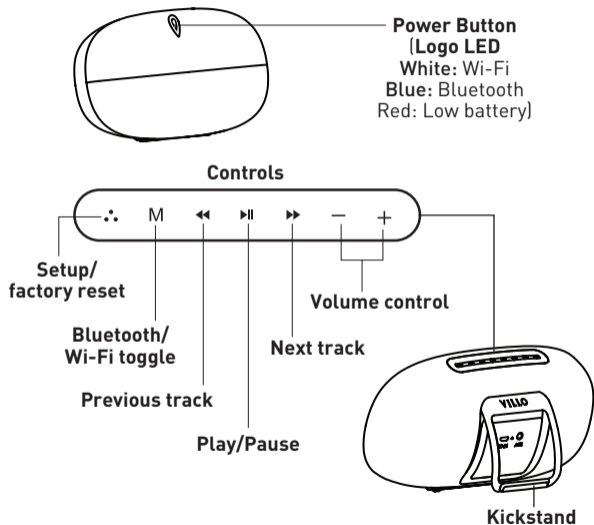

Powering On

To turn the speaker on (or off), press and hold the  on the front for 3 seconds. The Logo LED will turn white when the device is on.

Charging the Speaker

The speaker comes pre-charged and ready to use. When the battery is low, the Logo LED will glow red. Charge the speaker using the included USB charging cable from a laptop or any USB wall-adaptor. The charge indicator is located on the back of the speaker next to the DC-IN port and will glow green when fully charged.

VILLO APP

App Download

Download the Villo app for your device by searching for the Villo App through the Apple App Store™ or Google Play Store™. The Villo App is designed for iOS and Android devices only such as smartphones or Wi-Fi enabled tablets, it is not available for use on regular desktop or laptop computers.

Setup Your Speaker

Make sure your device is connected to a Wi-Fi network via a 2.4Ghz wireless router. Power-on your speaker and launch

the Villo app on your device. The App will take you through step-by-step to setup your Villo speaker in minutes. If you are unable to setup your speaker, refer to the trouble-shooting section of this manual.

DASHBOARD

After setting up your speaker you will be taken to the dashboard. The dashboard lets you control all Villo speakers that are connected to your Wi-Fi network. Here you can:

1. Setup new speakers

- Tap the **+** button on the top right and follow the on screen prompts to connect a new Villo speaker to your Wi-Fi network.

2. Multi-room Music

If you have multiple Villo speakers on your network, you can group them together for a rich, synchronized playback experience.

· Grouping Speakers

After connecting 2 or more Villo speakers to your network, tap the **Group** button on the top right corner of any speaker and select speakers to add/remove from the group. Speakers in the same group will play

synchronously until you remove them from the group.

· Left/Right/Stereo Channel

Speakers are set to stereo mode by default (left + right channel). When speakers are grouped, you can assign left or right channel for each speaker within the group to simulate surround sound. Tap the button to the right of the volume slider under the speaker name to change between L (left), R (right), or LR (stereo).

3. Speaker Settings

- Tap the  button next to the volume adjuster. You can rename your speaker or restore it to factory settings.

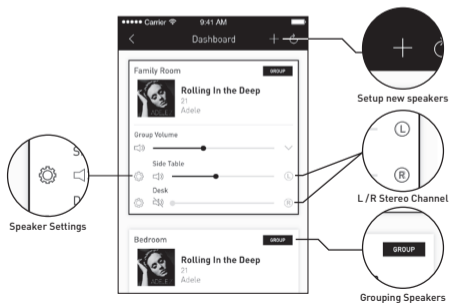

MORE APP CONTROLS

From the dashboard, swipe left to navigate to additional screens to see what's playing, edit your favorites, and access streaming services and or music stored on your device.

Streaming Music Services

Your Villo speaker supports TuneIn, iHeartRadio, Spotify, Tidal and other third party streaming platforms. If you already have accounts with any of these services, you can sign in through the Villo app to access any songs or stations you may already have saved with that service.

If you do not have an account with one of these services, the app will guide you through the setup process, however, you may need to download and install the internet music services first before it can be played. Follow the on screen prompts to add services and setup an account. Follow the on screen prompts to add services and setup an account.



BLUETOOTH CONNECTION

1. Press the **M** button to enable Bluetooth on speaker, the logo LED will blink blue. Enable Bluetooth on your device and search for your Villo speaker.
 2. Find and select the Villo speaker in your device list. When connected, the logo LED will turn solid blue.
- To reset the Bluetooth connection, hold the  button for 3 seconds while in Bluetooth mode.

WI-FI CONNECTION

- To toggle between Bluetooth and Wi-Fi, press the **M** button.
- The Logo LED will be solid white to indicate that Wi-Fi mode is on.

TROUBLESHOOTING

Cannot connect to Wi-Fi Network	<p>Make sure speaker is powered on.</p> <p>Make sure your device is connected to a Wi-Fi network via a 2.4Ghz router.</p> <p>Make sure your Wi-Fi password is correct.</p> <p>Test internet connection.</p> <p>Power speaker off and on, restart setup.</p> <p>Uninstall and reinstall app.</p> <p>Restore speaker to factory settings.</p>
Cannot connect to Bluetooth	<p>Make sure speaker is powered on.</p> <p>Make sure Bluetooth is enabled.</p> <p>Make sure device's Bluetooth is enabled.</p> <p>Power speaker off and on, restart setup.</p> <p>Uninstall and reinstall app.</p> <p>Restore speaker to factory settings.</p>

Audio doesn't play	<p>Make sure volume isn't too low on speaker.</p> <p>Other electronic household items can interfere with signal, move speaker to another location.</p> <p>Restore speaker to factory settings.</p>
---------------------------	--

Restore Speaker to Factory Settings

- Press and hold the  button for 6 seconds.
- The speaker will acknowledge the reset and the logo LED will slow blink white.

You can also factory reset your speaker through the Villo app by tapping speaker settings in the app dashboard and selecting factory reset.

IC Statement:

This device complies with Industry Canada's licence - exempt RSSs. Operation is subject to the following two conditions:

- (1) This device may not cause interference; and
- (2) This device must accept any interference, including interference that may cause undesired operation of the device.

Le présent appareil est conforme aux CNR d'Industrie Canada applicables aux appareils radio exempts de licence. L'exploitation est autorisée aux deux conditions suivantes : (1) l'appareil ne doit pas produire de brouillage, et (2) l'utilisateur de l'appareil doit accepter tout brouillage radio électrique subi, même si le brouillage est susceptible d'en compromettre le fonctionnement.

FCC Statement:

This equipment has been tested and found to comply with the limits for a Class B digital device, pursuant to Part 15 of the FCC Rules. These limits are designed to provide reasonable protection against harmful interference in a residential installation. This equipment generates uses and can radiate radio frequency energy and, if not installed and used in accordance with the instructions, may cause harmful interference to radio communications. However, there is no guarantee that interference will not occur in a particular installation. If this equipment does cause harmful interference to radio or television reception, which can be determined by turning the equipment off and on, the user is encouraged to try to correct the interference by one or more of the following measures:

- Reorient or relocate the receiving antenna.
- Increase the separation between the equipment and receiver.
- Connect the equipment into an outlet on a circuit different from that to which the receiver is connected.
- Consult the dealer or an experienced radio/TV technician for help.

This device complies with part 15 of the FCC Rules. Operation is subject to the following two conditions:

- (1) This device may not cause harmful interference, and (2) this device must accept any interference received, including interference that may cause undesired operation.

Changes or modifications not expressly approved by the party responsible for compliance could void the user's authority to operate the equipment.

RF exposure warning:

This equipment complies with radiation exposure limits set forth for an uncontrolled environment. This equipment should be installed and operated with Minimum distance 20cm between the radiator and your body.

L'équipement du millipascal incontrôlé, leurs conditions normales d'utilisation de maintenir, au moins 20cm avec les utilisateurs.



© 2018 Villo-audio. Any unauthorized copying, duplicating, or other reproduction of the contents hereof is prohibited without written consent from Villo-audio. All rights reserved.