

YOXIMO

innovation
on the move



Legal disclaimer and copyrights

The information in this document is subject to change without notice and shall not be construed as a commitment by Worldline S.A./N.V. ("Worldline")

The content of this document, including but not limited to trademarks, designs, logos, text, images, is the property of Worldline and is protected by the Belgian Act of 30.06.1994 related to authors' rights and by the other applicable Acts.

Linux is a registered trademark of Linus Torvalds, Java is a registered trademark of Sun Microsystems Inc. and ARM is a registered trademark of ARM Limited.

The contents of this document can be reproduced by or on behalf of third parties with the prior written consent of Worldline and following its instructions. Worldline accepts no responsibility for errors and omissions introduced when translating or reworking this document.

Except with respect to the limited licence to download and print certain material from this document for non-commercial and personal use only, nothing contained in this document shall grant any licence or right to use any of Worldline's proprietary material.

While Worldline has made every attempt to ensure that the information contained in this document is correct, Worldline does not provide any legal or commercial warranty on the document that is described in this specification. The technology is thus provided "as is" without warranties of any kind, expressed or implied, included those of merchantability and fitness for a particular purpose. Worldline does not warrant or assume any legal liability or responsibility for the accuracy, completeness, or usefulness of any information, product or processes disclosed.

To the fullest extent permitted under applicable law, neither Worldline nor its affiliates, directors, employees and agents shall be liable to any party for any damages that might result from the use of the technology as described in this document (including without limitation direct, indirect, incidental, special, consequential and punitive damages, lost profits).

These terms shall be governed by and construed in accordance with the laws of Belgium. You irrevocably consent to the jurisdiction of the courts located in Brussels for any action arising from or related to the use of this document.

Document information

document title	YOXIMO owner manual
security	unrestricted
last modified	September 2015
owner	Philippe Lesire
author	Niels Grundtvig Nielsen
document release	1.1

© Worldline 2013 - 2015

Contents

Introduction	1
About this manual.....	1
About the YOXIMO	3
Terminal – top view	3
Terminal – side view.....	4
Terminal – bottom view	4
Installing the YOXIMO.....	5
Unpacking the terminal.....	5
Preparing the terminal for operation.....	6
Where to use the YOXIMO.....	6
Installing SIM and/or SAM – optional	7
Fitting the battery.....	8
Removing the battery	10
Loading printer paper	11
Powering up the YOXIMO for the first time	13
Using the YOXIMO	15
Reading a chip card	15
Reading a magstripe card	15
Reading a contactless card/device.....	16
PIN privacy shield.....	16
Printer.....	17
Resetting the YOXIMO.....	17
Powering down the YOXIMO	17
Connecting a USB peripheral.....	18
Power supply and power consumption	19
Charging the battery.....	19
Caring for batteries.....	19
Power consumption.....	20
Using the YOXIMO with a power adaptor – indoors.....	20
Using the YOXIMO with a power adaptor – in a vehicle	22
Carrying case and cradle	23
Carrying case	23
Clipping the terminal into the case	24

Taking the terminal out of the case	25
Shoulder-strap and belt-clip	26
Cradle.....	27
Unpacking the cradle.....	28
Selecting a location for the cradle	28
Fixing the cradle on a countertop or other horizontal surface	29
Fixing the cradle on a wall or other vertical surface	30
Placing the terminal on the cradle	31
Removing the terminal from the cradle	32
Powering the cradle.....	32
Indoors	33
In a vehicle	33
Maintaining the YOXIMO	35
Cleaning the terminal	35
Cleaning the card reader.....	35
Cleaning the cradle	35
Cleaning the carrying case.....	35
Safety information.....	37
Certification	37
Safety recommendations.....	37
Electrical installations	37
Operating the YOXIMO	37
Opening the terminal	39
Servicing.....	39
Disposing of the terminal and battery	39
Technical specifications.....	41

Figures

<i>Figure 1.</i> Terminal (PIN privacy shield closed)	3
<i>Figure 2.</i> Side view, with detail of USB port	4
<i>Figure 3.</i> Terminal (rear view) and SIM/SAM slots	4
<i>Figure 4.</i> SIM / SAM holders	7
<i>Figure 5.</i> Sliding a SIM/SAM card into its holder	7
<i>Figure 6.</i> Closing a SIM / SAM holder	8
<i>Figure 7.</i> Opening the battery cover	8
<i>Figure 8.</i> Positioning the battery	9
<i>Figure 9.</i> Clicking the battery into place	9
<i>Figure 10.</i> Closing the battery cover	10
<i>Figure 11.</i> Removing the battery	10
<i>Figure 12.</i> Opening the printer cover	11
<i>Figure 13.</i> Inserting printer paper	12
<i>Figure 14.</i> Plugging the power cable into the terminal	13
<i>Figure 15.</i> Inserting a chip card in the terminal	15
<i>Figure 16.</i> Swiping a magstripe card through the card reader	15
<i>Figure 17.</i> Reading a contactless card/device	16
<i>Figure 18.</i> PIN privacy shield – closed (left) and open (right)	16
<i>Figure 19.</i> Tearing off a ticket	17
<i>Figure 20.</i> Connecting a USB peripheral to the YOXIMO terminal	18
<i>Figure 21.</i> Power adaptors for connection to the YOXIMO – European / universal	21
<i>Figure 22.</i> Vehicle power cable	22
<i>Figure 23.</i> YOXIMO in carrying case	23
<i>Figure 24.</i> Clipping the terminal into carrying case	24
<i>Figure 25.</i> Removing YOXIMO from carrying case	25
<i>Figure 26.</i> Security stud and belt-clip	26
<i>Figure 27.</i> Opening the belt-clip	26
<i>Figure 28.</i> Cradle	27
<i>Figure 29.</i> Mounting the drop protection on to the cradle	30
<i>Figure 30.</i> Placing YOXIMO on its cradle	31
<i>Figure 31.</i> Removing YOXIMO from its cradle	32
<i>Figure 32.</i> Power inputs on the cradle	32
<i>Figure 33.</i> Vehicle power cable socket	33

Introduction

The YOXIMO is a mobile payment terminal offering the ideal solution for a variety of situations: on-the-road transactions, in-store promotion sales, the hospitality sector, and so on.

The main features of the terminal are the following:

- compact, lightweight and truly portable
- backlit ergonomic keypad, bright large display, card interfaces with easy access
- fast silent printer
- rechargeable, long-life lithium-ion battery
- revolving PIN privacy shield incorporated into the design of the terminal
- standard WiFi/Bluetooth and optional GSM/GPRS communication interfaces

A full-featured YOXIMO kit consists of two main pieces of equipment:

- YOXIMO terminal for performing payment transactions
- optional YOXIMO cradle, combining safe storage and easy battery-charging

You can use it indoors on a countertop or a wall mount, but also in a vehicle.



We care for our environment: the package is as small as possible, contains no toxic materials and is recyclable. The terminal and all accessories follow the RoHS2 directives, meaning that no hazardous substances are used.

About this manual

This manual contains the following information for YOXIMO owners:

- the terminal and its accessories
- installing the terminal
- using the terminal
- maintaining the terminal
- troubleshooting
- safety information
- technical specifications

About the YOXIMO

This chapter gives an overview of the terminal.

- for information on the power supply options, see [Power supply and power consumption](#), on page 19, and [Powering the cradle](#), on page 32.
- for information about accessories, see [Carrying case and cradle](#), on page 23

Terminal – top view

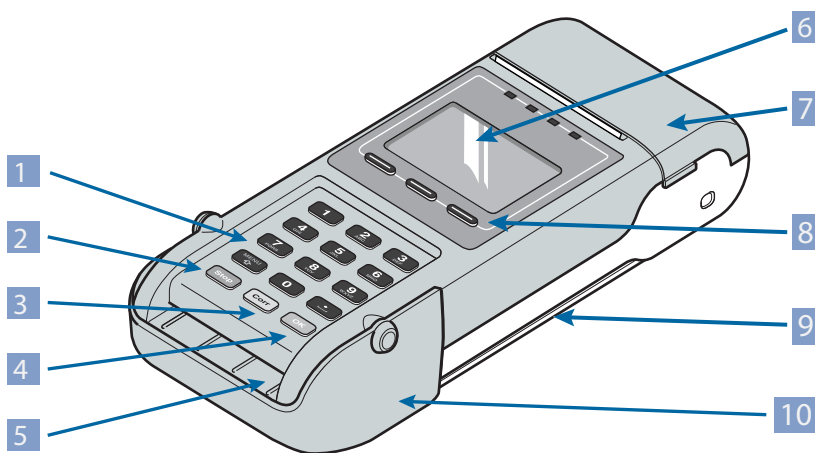

Figure 1. Terminal (PIN privacy shield closed)

1	keypad	6	display
2	Corr / On / reset button	7	printer cover
3	Stop / power-down button	8	function keys
4	OK button	9	magstripe-card reader
5	chip-card reader	10	PIN privacy shield

Terminal – side view

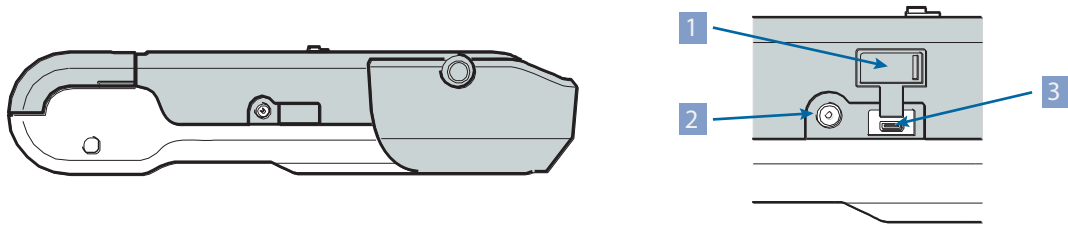

Figure 2. Side view, with detail of USB port

1	USB protection cap	3	USB device port
2	external power socket		

Terminal – bottom view

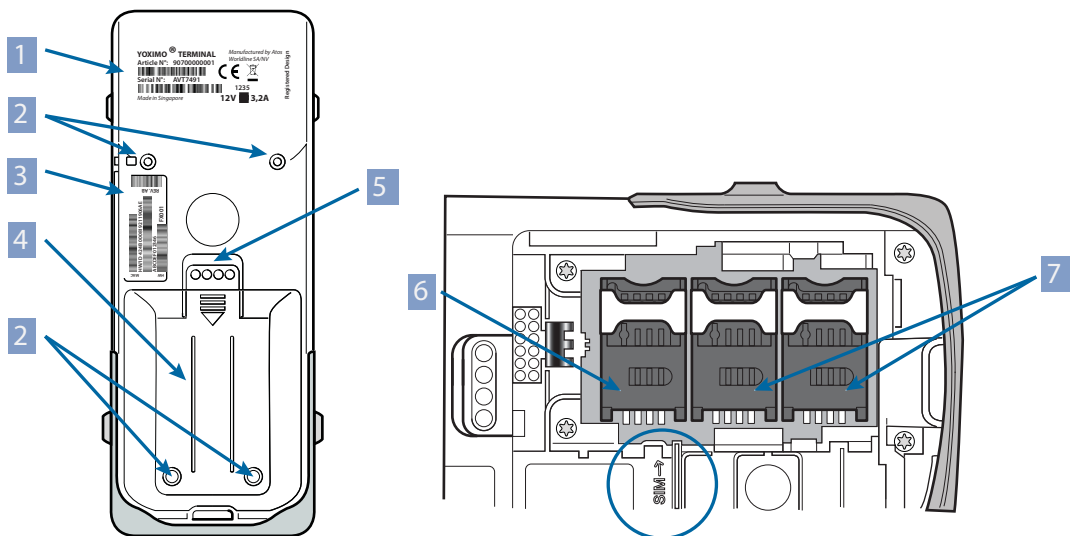

Figure 3. Terminal (rear view) and SIM/SAM slots

1	product label	5	charging contacts
2	rubber feet	6	SIM slot
3	MAC label	7	SAM slots
4	battery cover		

Installing the YOXIMO

You can call upon a technician or a field engineer to help you install your terminal or you can do it yourself. If you decide to install the terminal yourself, remember the guidelines below.



- if you decide to install the YOXIMO yourself, Worldline nor its vendor will bear any responsibility or cost for malfunctioning, breakdowns or any anomaly that may result from incorrect manipulation of the terminal
- read the safety recommendations on page 48 before starting to install your YOXIMO.
- if you notice that any part of the YOXIMO does not fit, blocks or shows any other malfunction, contact your vendor – do not try yourself to repair or alter it in any way.
- use only accessories (battery, power adaptor, cables and so on) provided by your vendor or by an approved source

Unpacking the terminal

1. Open the package and check the contents.
The package should contain a YOXIMO terminal, a battery, a mains adaptor and a roll of paper for the printer. If any of these is missing, contact your vendor immediately.
Your vendor may also have included documentation.
2. Inspect the package and its contents for damage.
If anything is missing or damaged, contact your shipping company immediately and notify your vendor.



Save the box for repacking or moving your equipment in the future.

Preparing the terminal for operation

Before you start, make sure the operating conditions are suitable. If you need to install the SIM and/or SAMs, do this first; then fit the battery. Finally, put a roll of paper in the printer.

Where to use the YOXIMO

YOXIMO is a mobile payment terminal, designed for easy payment on the go. The terminal can be used in the following environmental conditions:

- operating temperature between -10°C and +50°C

Remember that the temperature of the battery has an influence on the autonomy of the terminal. When the operating temperature drops below freezing point, the battery will need charging more frequently.

- operating humidity between 20 % and 95 % RH, non-condensing

Avoid environments where the humidity may fluctuate.

Avoid exposing the YOXIMO to:

- shocks and vibrations
- excessive heat and dust
- explosive environments
- oil, water, moisture or condensation
- devices that cause excessive voltage fluctuations and/or electromagnetic fields such as electric motors or high-frequency devices
- direct sunlight or objects that radiate heat

Installing SIM and/or SAM – optional

To communicate via GSM/GPRS-EDGE-3G, you need a SIM installed in the YOXIMO terminal. Some applications also require one or more SAMs to be installed. The SIM and SAM slots are located inside the terminal underneath the battery.



- Make sure that the mains power adaptor is not connected to the YOXIMO.
 - Avoid electrostatic discharge as it can severely damage the equipment. For guidelines on minimising the risk of electrostatic discharge, see [Safety recommendations](#), on page 37.
1. If you have already installed the battery, start by removing the battery cover and battery. See [Removing the battery](#), on page 10, for more information.

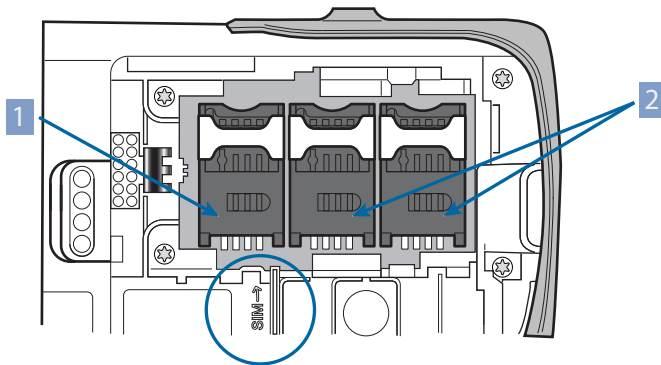

Figure 4. SIM / SAM holders

1	SIM holder	2	SAM holders
---	------------	---	-------------

2. Open the correct holder for inserting the SIM or SAM.
 - the SIM holder is the holder to the left, marked **SIM**
 - the SAM slots are the two remaining holders
 Shift the appropriate latch upwards, until you hear a click, then hinge the holder open.
3. Insert the SIM or SAM with the bevel in the direction as shown in the next figure. Make sure the card is completely inserted.

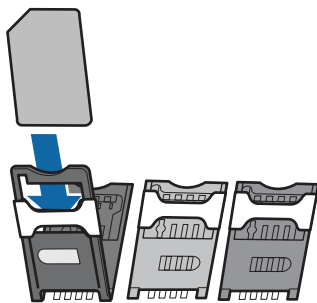

Figure 5. Sliding a SIM/SAM card into its holder

4. Close the holder.
Make sure the bevel fits behind the corner, then shift the latch up until you hear a click.
5. Make sure that all holders (SIM and SAM) are closed.

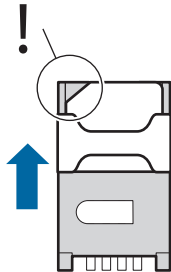

Figure 6. Closing a SIM / SAM holder

6. Put the battery back in its recess and close the battery cover again.

Fitting the battery



- never operate the YOXIMO terminal without a battery
Trying to operate the terminal without a battery will damage the terminal.
- only use the battery that is supplied with your YOXIMO
- to get the best performance from the battery, make sure it is at room temperature (20°C) when operating YOXIMO
- do not touch the terminal battery contacts

To install the battery:

1. Put the PIN privacy shield in the upright position.
2. Remove the battery cover at the rear side of the terminal.
Press with your thumb on the top of the battery cover to release it, then slide the cover backwards.

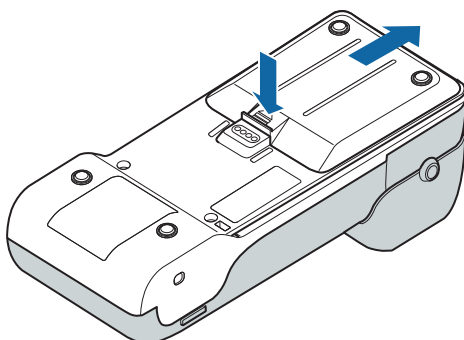

Figure 7. Opening the battery cover

3. Lower the battery into its recess.

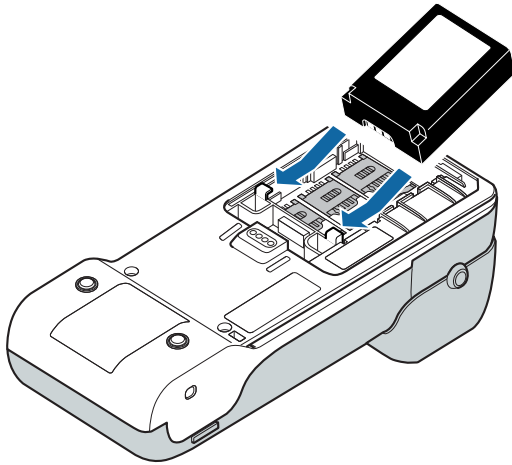

Figure 8. Positioning the battery

Position the battery with the label facing upwards and the battery contacts facing forwards.

4. Make sure that the battery contacts touch the ones in the terminal, then press the battery down until you hear a click.

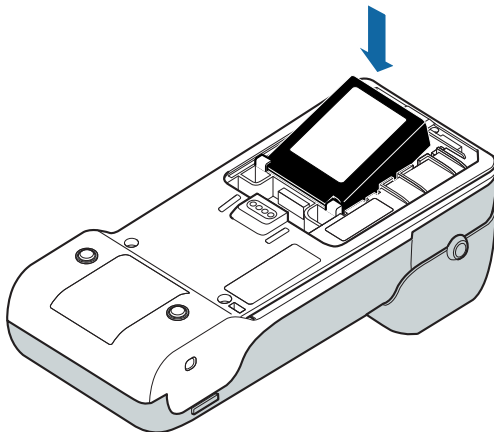

Figure 9. Clicking the battery into place

5. Position the battery cover on the terminal, then slide it forwards until you hear a click.

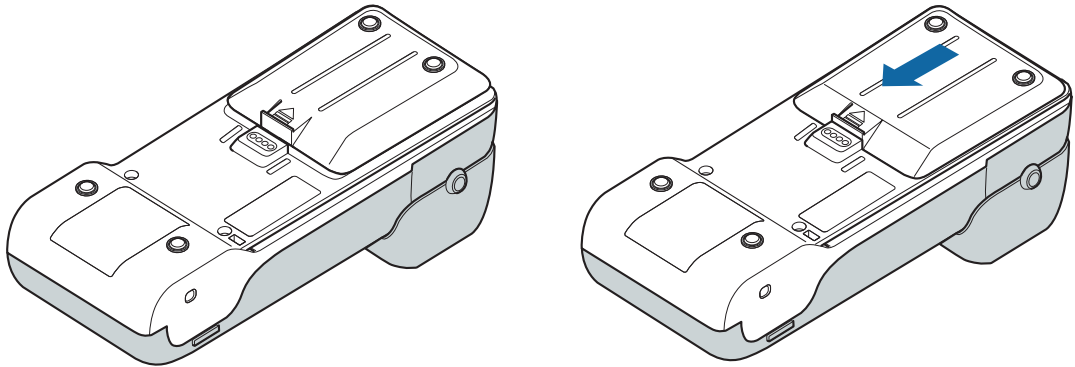

Figure 10. Closing the battery cover

Removing the battery



1. Always unplug the power adaptor before removing the battery
2. Put the PIN privacy shield in the upright position.
3. Remove the YOXIMO battery cover at the rear side of the terminal.
4. Lift the battery out of the terminal.

Never use a sharp or pointed object when removing the battery, because this may damage the terminal

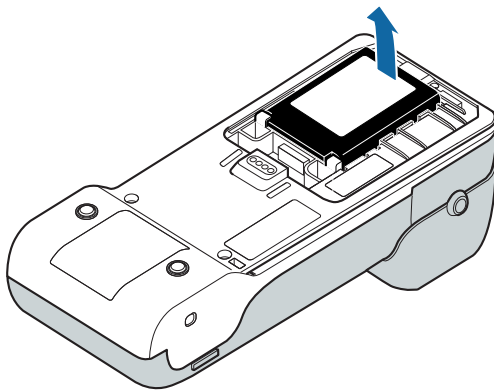

Figure 11. Removing the battery

5. Close the battery cover again.

Loading printer paper



- only use Worldline-approved paper, which you can recognise by the Worldline approval seal printed on the back of the paper.
To order paper from your local paper supplier, contact your vendor.
 - do not remove the roller on the inside of the printer cover.
1. Open the printer cover.
Put your fingers on the notches at the left- and right-hand side of the printer cover, then pull the cover open.

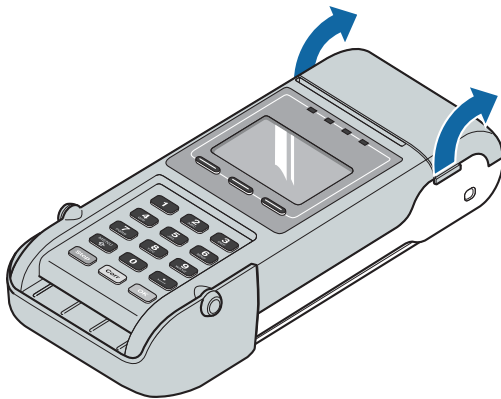

Figure 12. Opening the printer cover

2. Take a paper roll and unroll about 5 centimetres of it.
3. Insert the paper as shown on the sticker inside the printer compartment.
When inserting a paper roll, make sure that:
 - the paper-holder is empty
 - the paper is not cracked, wrinkled or sealed
 - the paper comes out straight

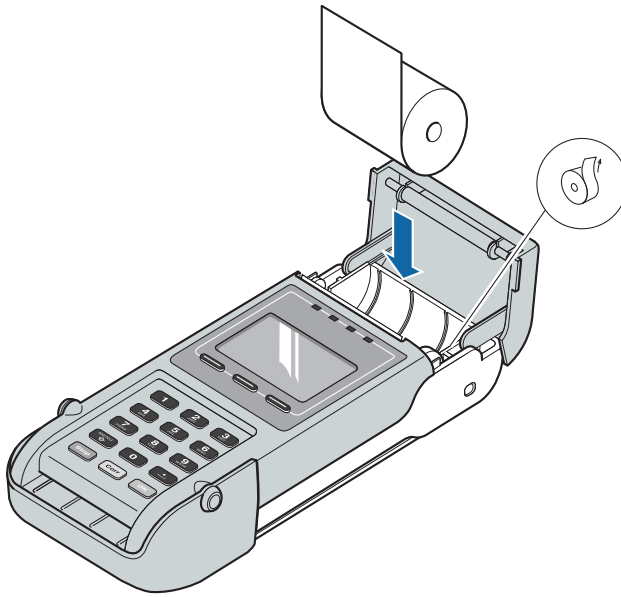

Figure 13. Inserting printer paper

4. Close the printer cover. Press firmly until you hear a click.

Powering up the YOXIMO for the first time



- the first time you power up your YOXIMO, make sure it is connected to the power adaptor
- make sure the battery has been fitted, and that there is a roll of paper in the printer

To power up your YOXIMO for the first time:

1. Plug the power cable from the mains adaptor into the socket on the left-hand side of the YOXIMO terminal.

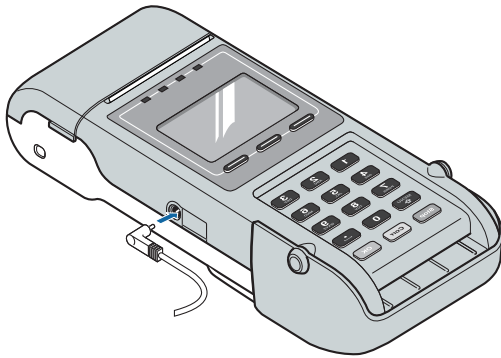

Figure 14. Plugging the power cable into the terminal

2. Connect the mains adaptor to a wall socket and wait for the YOXIMO keypad backlight and display to light up.

This takes five minutes at most, depending on the state of the battery.



The battery that is delivered with your terminal is not fully charged. Charge the battery completely before switching to battery-only operation. A complete charging cycle takes approximately 2.5 hours. The display indicates when the battery is fully charged.

Using the YOXIMO

Reading a chip card

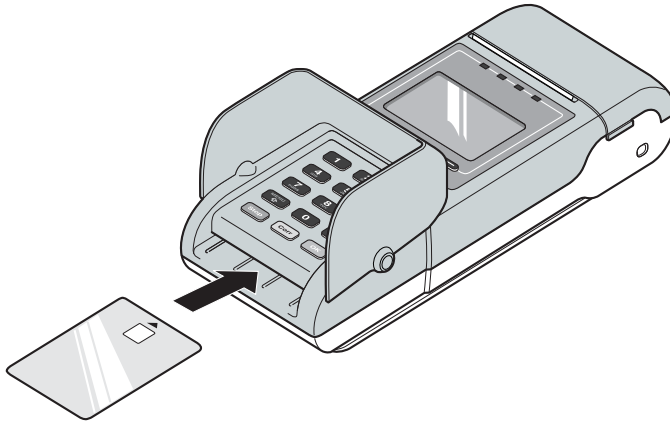

Figure 15. Inserting a chip card in the terminal

To read a chip card:

1. Put the privacy shield in the upright position.
2. Insert the chip card face-up in the slot at the front side of the terminal, as shown by the pictogram

Reading a magstripe card

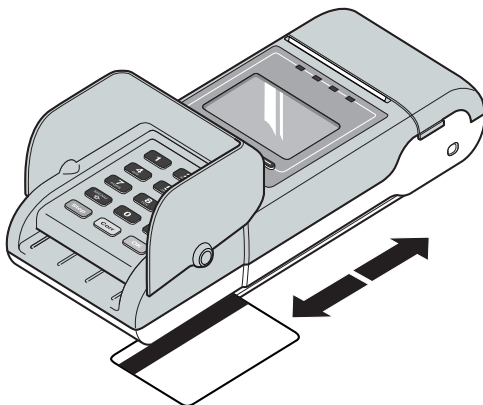

Figure 16. Swiping a magstripe card through the card reader

To swipe a magstripe card:

1. Put the privacy shield in the upright position.
2. Swipe the card through the reader located at the righthand side of the terminal.
Hold the card with the stripe upward, as indicated on the pictogram on the terminal

housing. You can slide the card in either direction. For reliable card reading, swipe the card in one smooth movement.

Reading a contactless card/device

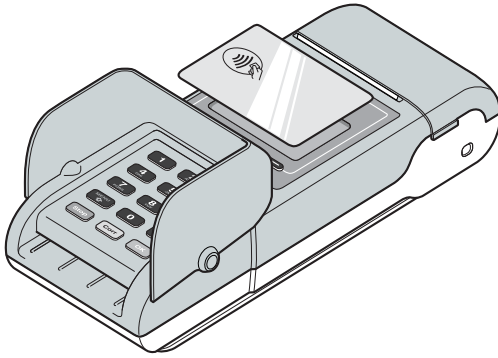

Figure 17. Reading a contactless card/device

To reading a contactless card/device:

1. Hold the card above the display, centred on the landing point.



When the payment application supports contactless cards/devices, the landing-point symbol appears on the display.

PIN privacy shield

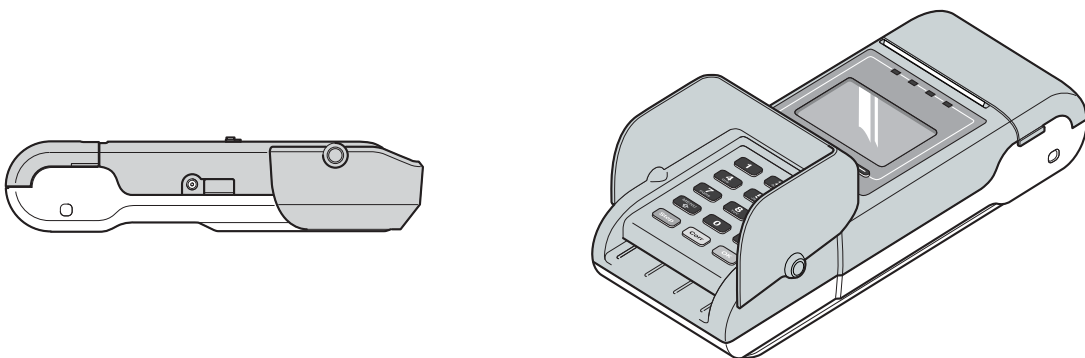

Figure 18. PIN privacy shield – closed (left) and open (right)

The integrated YOXIMO privacy shield is to prevent shoulder surfing when entering a PIN. Raising the privacy shield uncovers both the chip-card interface and the magnetic stripe reader so you can operate the terminal.

When you are not using the terminal, fold in the privacy shield in. This makes the terminal flat and easy to carry.

Printer

How to insert a paper roll is described in [Loading printer paper](#), on page 11.

To tear off a ticket, hold the top of the ticket and tear the ticket off along the cutting edge. To avoid damage, do not pull paper out of the printer.

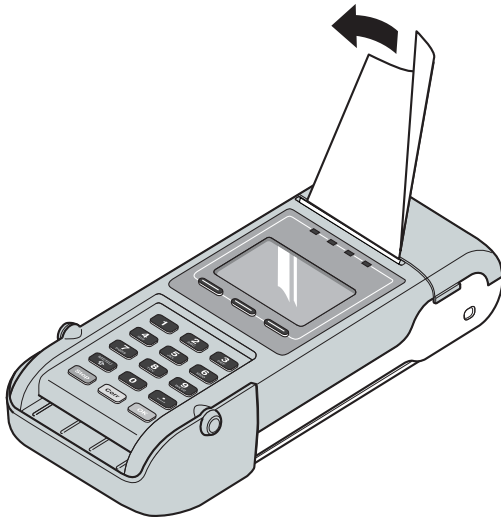

Figure 19. Tearing off a ticket

Resetting the YOXIMO



To reset the YOXIMO, press the yellow Corr button for at least 5 seconds and wait for the terminal to reboot.

If the Power down function is not supported by your application, you have to remove the battery, wait for 10 seconds and insert the battery again.

Powering down the YOXIMO



To power down the YOXIMO, press the red Stop button for at least 5 seconds. In this mode the battery consumes almost no energy. This function is useful when, for example, entering health care facilities or when boarding an aircraft.

To power up the terminal, press the yellow On button again. It takes longer to power up a terminal than it does to wake the terminal from sleep mode.

If the Power down function is not supported by your application, you have to remove the battery.

Connecting a USB peripheral

The YOXIMO terminal is equipped with a USB socket, for communication with external equipment such as an ePOS terminal or a PC. The appropriate cable is available as an option. To find out what equipment is supported, contact your vendor.

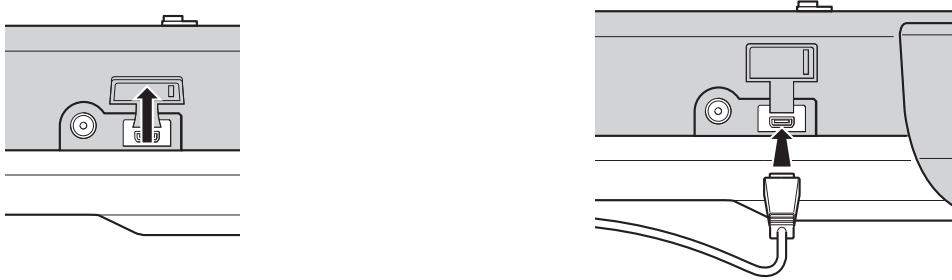

Figure 20. Connecting a USB peripheral to the YOXIMO terminal

To access the socket, open the small rubber cap with your fingers. Leave the cap connected to the terminal so that the connector can be protected when not used.



- do not use a sharp object to remove the rubber cap

Power supply and power consumption

For portability, the YOXIMO is powered by a rechargeable, high-energy Lithium-Ion battery with a capacity of 1200 mAh at a nominal voltage of 7.6 VDC. The battery management system features a fuel gauge, so the user always has accurate information on battery status. The user can replace the battery when necessary.

Charging the battery

The battery can be charged:

- by connecting the power adaptor to the YOXIMO
- by placing the YOXIMO on its cradle (for indoor or in-vehicle use)

The YOXIMO terminal uses a high-energy Lithium-Ion battery. To get the best performance and the longest life from the battery:



- always disconnect the power adaptor from the terminal before removing the battery
- always operate the YOXIMO terminal with the battery in place to avoid damage to the terminal
- only charge the battery when it is in the YOXIMO terminal
- charge the battery regularly – do not wait for it go flat

You can charge the battery by connecting the power adaptor to the YOXIMO or by placing the YOXIMO on its cradle. As Lithium-Ion batteries do not suffer from being continuously charged, you can do so without affecting the battery performance. When the low battery message appears on the display, the terminal needs to be charged.



- a new battery achieves full performance only after two or three complete charge-discharge cycles
- for quick and efficient results, charge the battery at room temperature

When the terminal is connected to the power adaptor or placed on its cradle, charging is software-controlled depending on the battery charge status.

When you will not be using the terminal for more than a week, charge the battery to around 40% before removing it from the terminal and storing it. Do not leave the battery inside the terminal. Another option is to keep the battery powered (directly or via the cradle) all the time.

Caring for batteries

Lithium-Ion batteries can be left charging all the time, because they do not suffer from the “memory effect”. Recharging an empty battery takes about 2.5 hours. A separate battery charger is not available for this type of battery.

A Li-Ion battery normally delivers peak performance for around three years after it is built or until it has been recharged 500 times. After this, it may need charging more frequently. Depending on how intensively the battery is used, and on how often it is charged, it can continue to deliver acceptable performance for another three years. Operating at extremely high or low temperatures may also have an adverse impact on performance and battery life.

Worldline specifies a double-cell Lithium-Ion battery for the YOXIMO because this type of battery:

- offers at least 30% more capacity than their NiMH counterparts
- weigh at least 30% less than NiMH
- has a long life cycle
- provides excellent discharge performance
- is more environmentally-friendly

In stock, YOXIMO terminals are stored without a battery. This is because Li-Ion batteries discharge slowly inside the terminal, even when the terminal is switched off.

Power consumption

The current consumption of the YOXIMO Terminal depends on the mode:

- working: ~160mA drawn from Li-ion battery (backlights on, CPUs at 264MHz)
- idle: ~70mA drawn from Li-ion battery (backlights off, CPUs at 24MHz)
- stand by: around 7 days with either WiFi or GSM/GPRS module in sleep-mode

To have YOXIMO ready whenever needed, power-management is crucial at every implementation level. Tests show that reducing the intensity of the display backlight to 50% for half the transaction time offers a 20% extra operational time. In normal operating conditions, a fully charged battery allows:

- around 300 transactions a day, with one ticket printed per transaction
- an average of 40 transactions a day over a period of 4 days
- around 7 days on stand-by, with GSM/GPRS active

Using the YOXIMO with a power adaptor – indoors



Do not remove the battery when using the YOXIMO with a power adaptor.

- in all European countries except the United Kingdom and Ireland, YOXIMO comes with a small plug-in adaptor (for indoor use) with a Euro plug.

Adaptor input is 220 – 240 VAC, 50 Hz. The built-in cable is 2 m long.

- elsewhere, YOXIMO comes with a universal adaptor (for indoor use) in combination with different country-specific mains power cables

Adaptor input is 100 – 240 VAC, 50 – 60 Hz. The standard adaptor cables are 2 m long.

The adaptor output is 12 VDC at 1.0 A. Leaving the adaptor cable plugged in when the YOXIMO is connected but not in use makes sure the battery is always charged and the terminal is always ready to use.

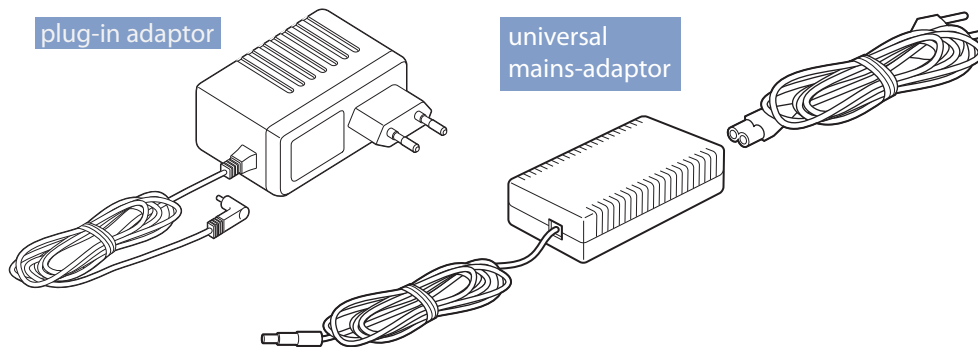

Figure 21. Power adaptors for connection to the YOXIMO – European / universal

The power adaptor can be connected either to the YOXIMO or to the cradle, using the socket on the side of the terminal or the side of the cradle.

Using the YOXIMO with a power adaptor – in a vehicle



Do not remove the battery when using the YOXIMO with a power adaptor.

There are three options for using the YOXIMO with a power adaptor in a vehicle:

- power the terminal from the cigarette-lighter
- put the terminal in the cradle, and use the co-ax or the flat-pin connector to power the cradle from the cigarette-lighter
- put the terminal in the cradle, and use the flat-pin connector to power the cradle from a built-in connection to the vehicle's electrical system

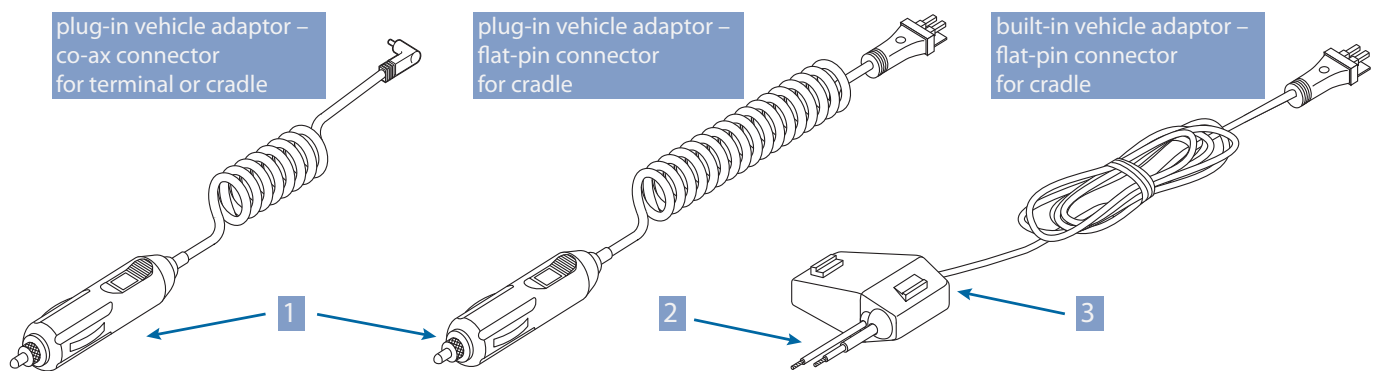

Figure 22. Vehicle power cable

1	cigarette lighter plug
2	connection to vehicle electrical system
3	fuse box

The cradle transforms the car or truck voltage to the 12 VDC needed to charge the battery in the YOXIMO terminal.



Cables/adaptors for these options have to be purchased separately, as accessories.

Carrying case and cradle

For user comfort and to protect the terminal, a carrying case and a cradle are available. Both these items help keep your YOXIMO safe in daily use. The cradle also includes a charger.

Carrying case

The case protects the YOXIMO against shocks and bumps, and has both a shoulder strap and an optional belt clip. All interfaces – chip card, magstripe card, contactless and USB – remain fully accessible when the YOXIMO is in the open case.

The carrying-case includes a clip to hold the YOXIMO securely in place.

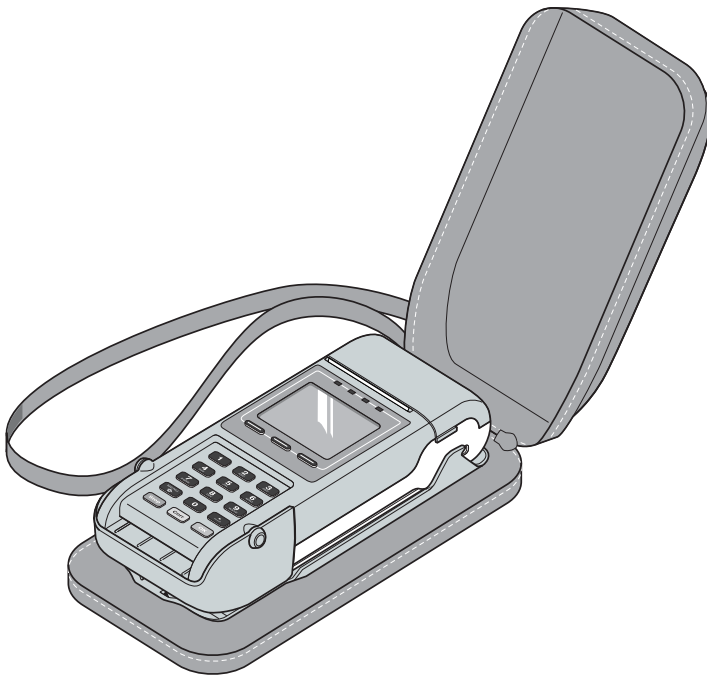

Figure 23. YOXIMO in carrying case

Clipping the terminal into the case

1. slip the recess at the front of the terminal over the tab at the front of the clip
2. line up the terminal between the two tabs (one either side of the terminal) at the back of the clip
3. press the terminal down until it clicks into place

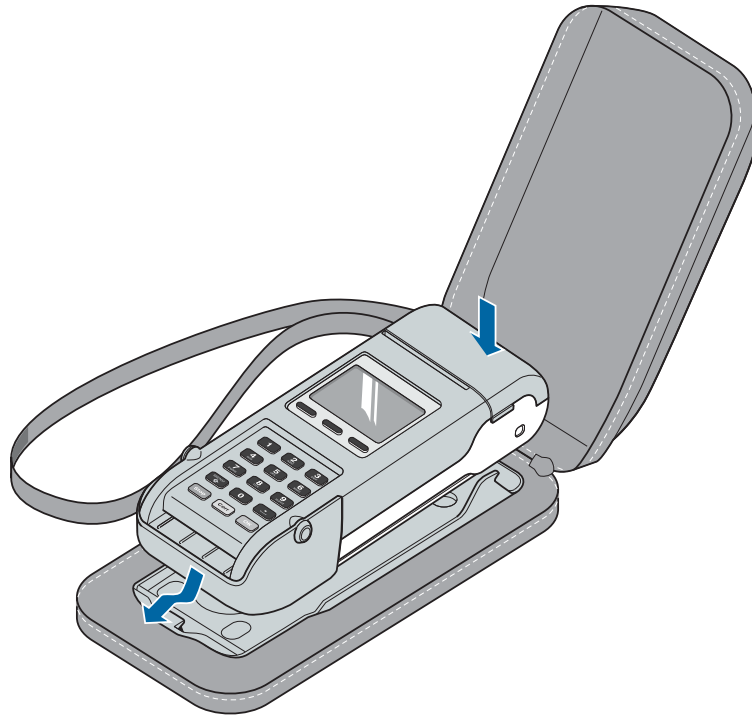

Figure 24. Clipping the terminal into carrying case

Taking the terminal out of the case

1. push open the right-hand tab at the back of the clip with your thumb
2. lift the terminal out of the clip with your other hand

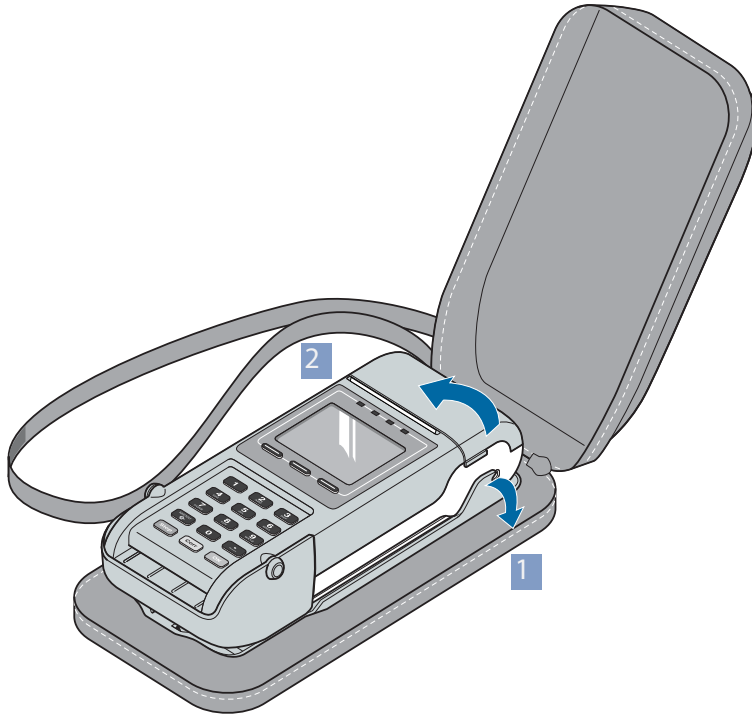

Figure 25. Removing YOXIMO from carrying case

Shoulder-strap and belt-clip

The carrying case comes with both a shoulder-strap and a belt-clip. To use the belt-clip

1. screw the security stud on to the carrying case
2. slip the belt-clip over your belt: it includes a spring to keep it securely in place
3. slip the security stud into the belt-clip and wait for it to click into place

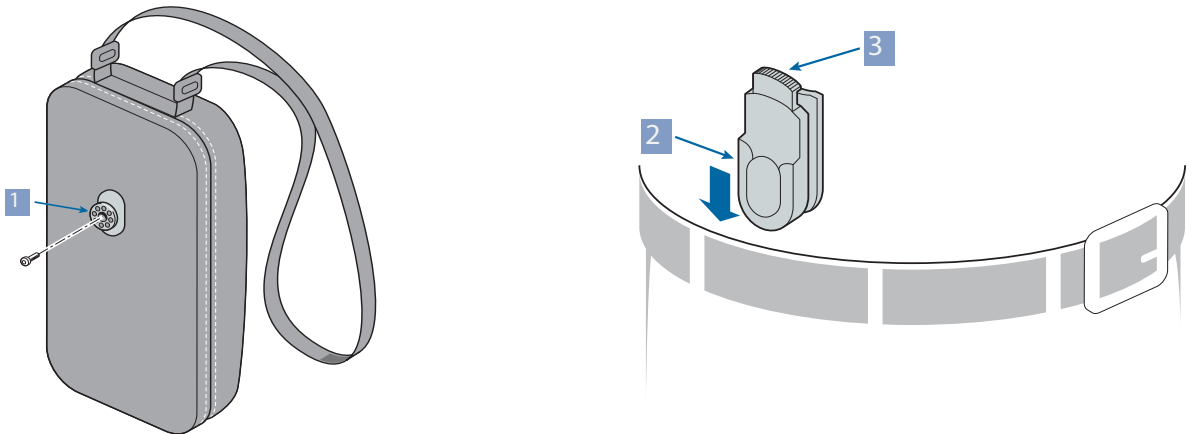

Figure 26. Security stud and belt-clip

1	security stud
2	belt-clip
3	release button – press to take carrying-case off belt-clip

Pinch the belt-clip open before pulling it off your belt.

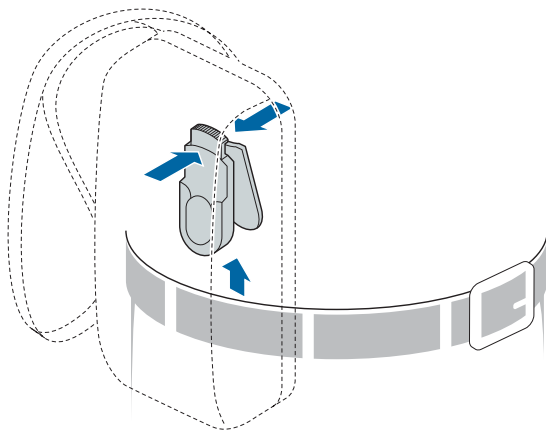

Figure 27. Opening the belt-clip

Cradle

The optional cradle gives you a safe place to put the YOXIMO when you are not using it immediately. It is ideal for use in vehicles and busy environments indoors. The cradle can also be used to charge the YOXIMO.

The cradle can be:

- screwed to a wall or other vertical surface
- fixed to a horizontal surface using ruggedised Velcro tape

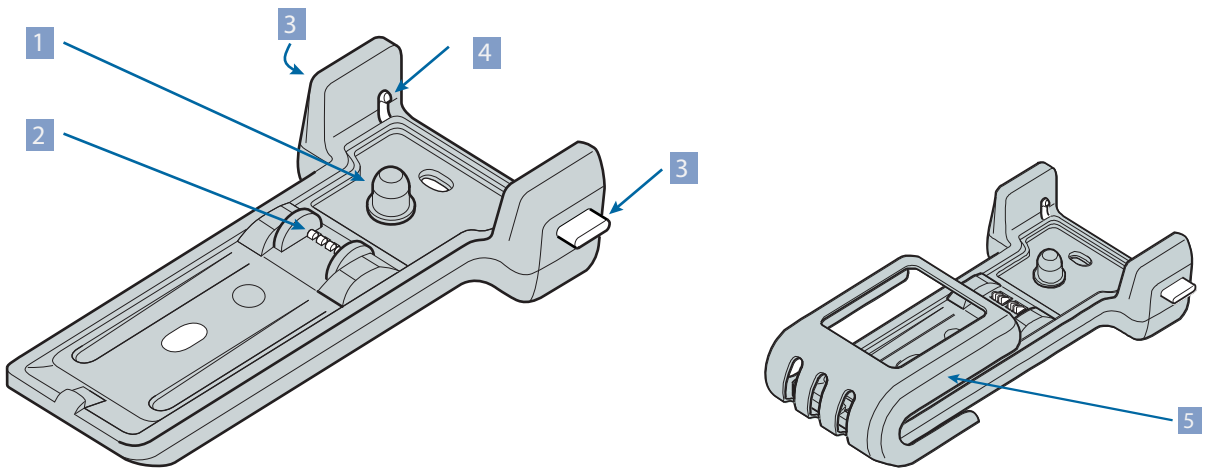

Figure 28. Cradle

1	release spring	4	retaining clip
2	power contacts	5	drop protection
3	release buttons		

Without the drop protection attached, the cradle measures 178 mm long x 120 mm wide x 47 mm high and weighs 120 g.

Without the drop protection attached, the cradle measures 180 mm long x 120 mm wide x 70 mm high, and weighs 145 g.

The YOXIMO cradle is available in dark grey (colour code ncs s6000-n). The drop protection has the same colour.

Unpacking the cradle

1. Open the YOXIMO cradle package and check the contents.
The package should contain at least a YOXIMO cradle, a drop protection and two mounting screws
If any of these is missing, contact your vendor immediately.
2. Inspect the package and its contents for damage.
If anything appears damaged, contact your shipping company immediately and notify your vendor.



Save the box for repacking or moving your equipment in the future.

Selecting a location for the cradle

Select a convenient location for the YOXIMO cradle, where you can comfortably put the terminal aside temporarily, charge the battery and possibly operate the terminal. You can install the cradle on a countertop (horizontal) or on a wall or other vertical surface.



- avoid direct light sources as they can interfere with the readability of the display or the keypad
- make sure that the cables are not hindering you or your customer. always guide cables through a strain relief
- circulation of air around the YOXIMO is not obstructed. if the YOXIMO terminal is not freestanding, provide adequate ventilation.
- for quick and efficient results, charging should be performed between 0°C and 40°C

The cradle can also be installed in a vehicle.



- only qualified personnel should install the YOXIMO in a vehicle – faulty installation may invalidate any warranty that applies to the unit
- do not attach the cradle to the floor of the vehicle, as vibrations and dust may disrupt its operation

Fixing the cradle on a countertop or other horizontal surface

You can use the cradle simply by resting it on its four rubber feet. For stability, you can also screw it to a flat surface.

Before fixing the cradle, make sure there will be enough space to:

- fold the privacy shield in and out
- insert a chip card in the chip-card reader
- slide a magstripe card through the magstripe-card reader
- open the printer cover and replace the paper

To fix the cradle to a flat surface:

1. make sure that the surface is stable
2. put the fixing screws through the oval holes

Fixing screws are not supplied with the cradle. Use screws appropriate for the surface, and with a maximum diameter of 4.5 mm



Always use **two** screws to attach the cradle firmly. We recommend screws with a domed or pan head, as shown.

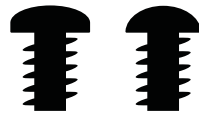

When you are ready to use the cradle, attach the power cable as described under [Powering the cradle](#), on page 32

Fixing the cradle on a wall or other vertical surface

For convenience, you can also mount the cradle vertically. If you do this, you are advised to fit the drop protection before you screw the cradle to the wall. Note that the card interfaces are not accessible when the terminal is in a cradle with drop protection fitted.



Always fit the drop protection when the cradle is mounted vertically. This will prevent the terminal from falling if it is not positioned correctly on the cradle. The drop protection is supplied as standard, and can easily be screwed on to the cradle.

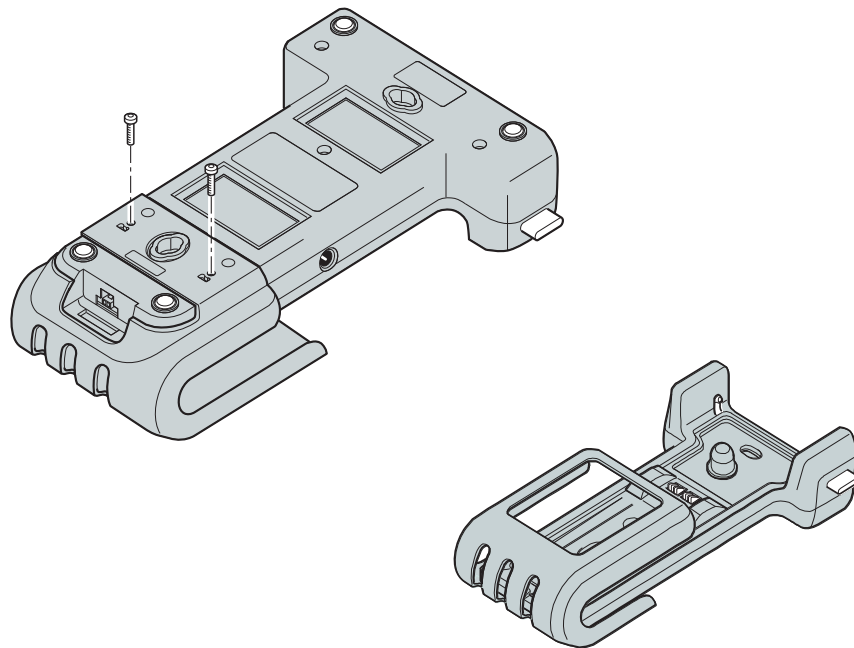

Figure 29. Mounting the drop protection on to the cradle

1. Fit the cradle in the drop protection, using the two screws supplied.
Use a torx T8 screwdriver to screw the drop protection on to the cradle.
2. After fitting the drop protection to the cradle, fix the cradle to the flat surface as described under [Fixing the cradle on a countertop or other horizontal surface](#), on page 29.

Placing the terminal on the cradle

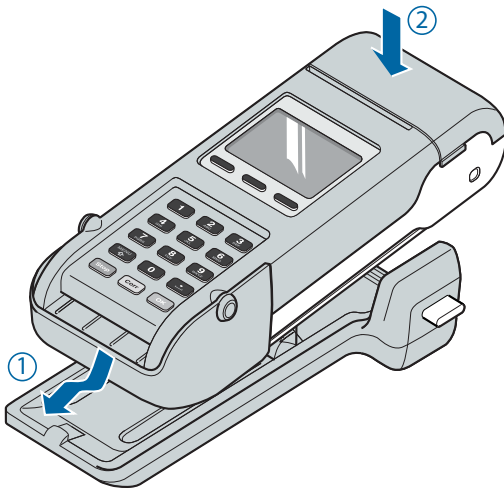

Figure 30. Placing YOXIMO on its cradle

To place the YOXIMO on its cradle:

1. Position the lower end of the YOXIMO on its cradle and make sure it engages with the catch.
2. Press the YOXIMO down, until you hear a click.

When the cradle is powered and the YOXIMO is correctly connected, the YOXIMO display lights up.

Removing the terminal from the cradle

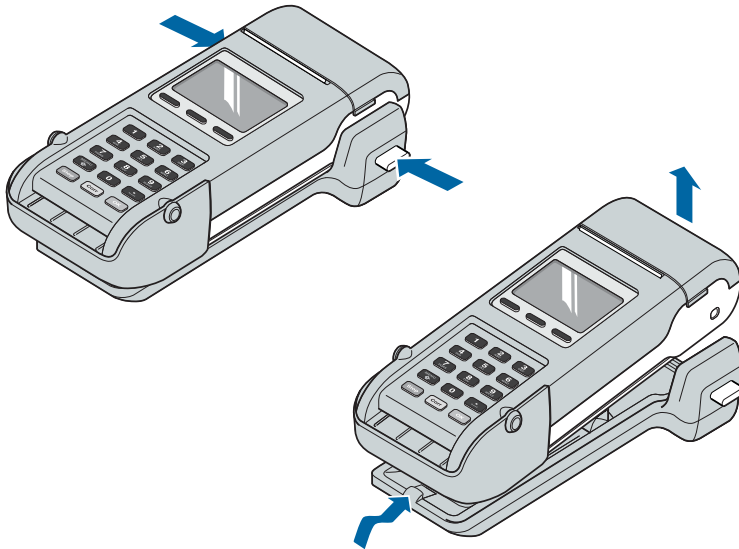

Figure 31. Removing YOXIMO from its cradle

To remove the YOXIMO from its cradle, put your hand over the YOXIMO and press the two release buttons on the cradle. A spring on the cradle makes sure that the YOXIMO is released.

Powering the cradle

There are different sockets for the power cable from a mains adaptor and the power cable (hard-wired or from the cigarette lighter) in a vehicle.

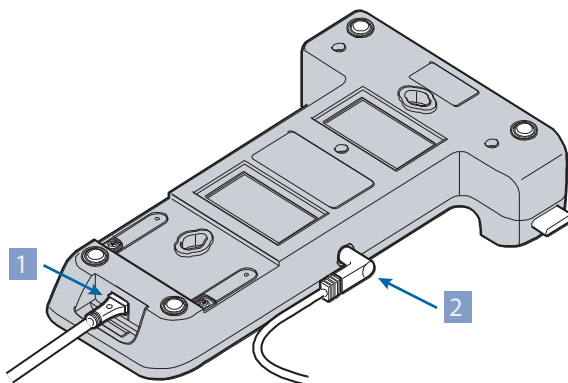

Figure 32. Power inputs on the cradle

1	vehicle power ((hard-wired or from the cigarette lighter)
2	external power cable from mains adaptor

Indoors



Only use the power adaptor that is supplied with your YOXIMO terminal.

1. Plug the power cable from the mains adaptor into the socket on the side of the cradle.
2. Connect the mains adaptor to a wall socket.
3. Put the YOXIMO on its cradle as described in [Placing the terminal on the cradle](#), on page 31, and wait for the YOXIMO keypad backlight and display to light up.

In a vehicle



- Only qualified personnel should install the YOXIMO in a vehicle. Faulty installation may invalidate any warranty that applies to the unit.
- Only use the vehicle power cable that is supplied by your vendor.

In a vehicle, a power cable for direct wiring or with cigarette lighter plug is connected to the cradle. The cradle transforms the car or truck voltage to the 12 VDC needed to charge the battery in the YOXIMO terminal.



For more information, see [Vehicle power cable](#), on page 22.

The straight car power cable for direct wiring has a length of 2 m. The coiled cable with a cigarette lighter plug has a length of 0.60 m, and can be extended to 2.35 m. Worldline can supply these cables.

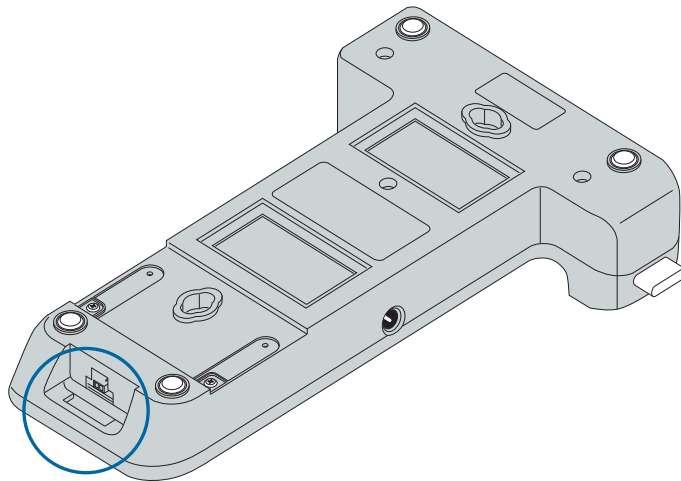

Figure 33. Vehicle power cable socket

1. Take the appropriate vehicle power cable.
2. Plug it into the connector underneath the front of the YOXIMO cradle.
3. Connect the power cable to the vehicle's electrical system (12 or 24 VDC) directly, or use the cigarette lighter plug.
4. Put the YOXIMO on its cradle as described in [Placing the terminal on the cradle](#), on page 31, and wait for the YOXIMO keypad backlight and display to light up.

Disconnecting the vehicle power cable

To unplug the vehicle power cable from the cradle, push the release clip on the connector down firmly and pull the cable.

Maintaining the YOXIMO

For optimal functioning of the YOXIMO terminal and cradle, clean them regularly.



- do not immerse the products in water, or use a lot of water while cleaning
 - do not let dirt enter the card readers
 - do not use detergents, solvents, alcohol or abrasive products
- These products may damage surfaces and make transparent parts opaque

Cleaning the terminal

1. Disconnect the power adaptor from your YOXIMO terminal or remove the terminal from its cradle.
2. Remove the battery.
3. Clean the display, the keypad and the terminal housing with a soft damp cloth.

Cleaning the card reader

Clean the card readers for chip cards and magstripe cards with a cleaning card, following the instructions in the cleaning-card kit.



We suggest cleaning the card readers every two weeks. Contact your vendor for additional information about cleaning cards.

Cleaning the cradle

1. Disconnect the power adaptor from the cradle.
2. Clean the cradle with a soft damp cloth.

Cleaning the carrying case

Clean the carrying case with a soft damp cloth.

Safety information



Worldline declines any liability if the instructions and precautions contained in this manual are not observed.

Certification

CE

Worldline declares that the YOXIMO mobile payment terminal complies with relevant EU directives.

The declaration of conformity (DoC) can be consulted on the Worldline website.

FCC

This equipment has been tested and found to comply with the limits for a Class A digital device, pursuant to Part 15 of the FCC Rules.

Other regions

Contact your vendor for safety information on regions outside the EU and the US.

Safety recommendations

Electrical installations

The YOXIMO operates safely when used according to its marked electrical ratings and product usage instructions. To ensure the safe operation of the YOXIMO, use it only in premises that have electrical installations in compliance with local and regional office and residential electrical wiring codes.

Operating the YOXIMO

- The YOXIMO is a payment terminal and is not to be used for any other purposes. Keep the YOXIMO and its cradle away from heat, fire, cold, moisture or oil, electricity, radiation, water, humidity, shocks, vibrations, chemicals or any other product that may affect electronic devices. The YOXIMO terminal and the cradle should not be kept in refrigerators, defrosting systems, microwaves, or treated with a hairdryer or any high pressure cleaning equipment.
- Do not drop the YOXIMO terminal or cradle, throw it or slam it; do not put any heavy equipment on top of it or squeeze it. Do not store it with food or any consumable goods. Do not store it with explosive substances such as lighter fuel, petrol, ether or the like.

- Do not operate the YOXIMO while driving a vehicle. Always secure the terminal in its cradle; do not place it on the passenger seat or anywhere it can come loose in a collision or sudden stop. Do not place it in the area over the air bag or in the air bag deployment area.
- Before using the YOXIMO in a vehicle powered by liquefied petroleum gas (LPG), ensure that the vehicle complies with the relevant fire and safety regulations.
- Handle your YOXIMO with care: there is no warranty against breakage.
- Your YOXIMO is equipped with a WiFi/Bluetooth interface operating in the 2.4 GHz spectrum. Various other electronic devices in a home, such as cordless phones, garage door openers, baby intercoms, and microwave ovens, may use the same frequency range. Any such device can interfere with a WiFi home network, slowing down its performance or breaking network connections.
- Your YOXIMO may be equipped with a GSM/GPRS interface that uses low power radio frequencies (RF) for its communication. Most electronic equipment, for example in hospitals and motor vehicles, are shielded from radio frequencies. Beware, however, that radio frequencies might affect damaged or improperly shielded equipment. Always switch your YOXIMO off in areas that instruct you to, for example when entering health care facilities or when boarding an aircraft.
- YOXIMO is a battery-operated device; only use the battery that is supplied with your YOXIMO.
- Use the battery only for its intended purpose. Keep the battery out of reach of children. The battery may explode if damaged or exposed to fire or high temperatures.

Do not dismantle or short-circuit the battery. Accidental short-circuiting can occur when a metallic object causes direct connection between battery contacts. This might happen when carrying a spare battery in your pocket together with for example a coin, a clip, a necklace, a hairpin.

Do not pierce the battery with nails, strike it with a hammer, step on it or otherwise subject it to strong impacts or shocks. Do not solder directly onto the battery. Do not place the battery in microwave ovens, high-pressure containers or on induction cooking plates.

Do not expose the battery to water or salt water, or allow the battery to get wet. Immediately discontinue use of the battery if, while using, charging or storing, it emits an unusual smell, feels hot, changes colour or shape, or appears abnormal in any way.

- Leaving the battery in cold or hot places, such as in a closed car in winter or summer conditions, will reduce the capacity and lifetime of the battery. The best temperature for the battery is between 15°C and 25°C.
- Only use the power adaptor that is supplied with your YOXIMO to charge the battery. Check regularly that there is no overheating of the power adaptor.
- Disconnect the power adaptor when you want to clean the terminal housing or the display and when the YOXIMO needs servicing or repair.
- Never use extension cables for the DC outlet of the power adaptor.

- Impact, friction, temperature, humidity, light, and oil affect the coloring and storage characteristic of thermal printer paper. Only load paper rolls that do not have folds, wrinkles, tears, or holes. Do not pull paper out of the printer; this could damage the feed mechanism. Only use Worldline-approved paper.

Opening the terminal

- Only open the YOXIMO terminal for adjustments that are described in this manual. Never remove or open any part that is not described in this manual.
- When opening the YOXIMO terminal take the necessary precautions to avoid electrostatic discharge (ESD). An electrostatic charge can build up on the human body and then be discharged when you touch a circuit board. ESD can damage equipment and impair electrical circuitry. To minimize the risk, always follow these guidelines when removing and replacing SAM or SIM cards:
 - Ground yourself while holding the YOXIMO and touching a metal surface on the ground.
For example, if your computer has a metal case and is plugged into a standard grounded outlet, then touching the case should discharge the ESD on your body
 - Make sure not to wear any clothing that conducts a lot of electrical charge, such as a woollen sweater
 - Unless absolutely necessary, try not to work on the YOXIMO during a thunderstorm
 - Remove all jewellery



Never open the cradle.

Servicing

All servicing other than the actions described in this manual must be performed by Worldline or an approved service centre.

Disposing of the terminal and battery

When your YOXIMO is at the end of its life, return it to your vendor for disposal. The terminal contains materials that have to be disposed of professionally.

Do not throw batteries away with the household waste: use an appropriate recycling channel or return them to your vendor.

Technical specifications

For part numbers, refer to your vendor's catalogue

item	specification
product name	YOXIMO
type	mobile payment terminal
keypad	backlit ergonomic keypad
display	backlit 64k colour display, 44.64mm wide x 33.48mm high (2.2" diagonal), 320 pixels wide x 240 pixels high
card readers	chip-card reader conforms to EMV 4.3 Level 1 triple-track magstripe-card reader conforms to ISO 1/2/3 NFC (contactless) reader conforms to EMV 4.3 Level 1
printer	integrated thermal graphic printer, easy-paper-load mechanism, paper 58 mm width and 10 m length
wireless communication	WiFi, IEEE 802.11 (standard) b/g/n 3G/GSM/GPRS worldwide (850-900-1800-1900-2100 MHz)
interface	USB for connection to an ePOS (point of sales) terminal, a PC or as a peripheral
chip security modules	2 SAM slots type ID 0 1 SIM slot (for GSM/GPRS/Edge/3G)
processing capabilities	2 x 32 bit ARM™ processor cores 128 Mbytes RAM 128 Mbytes Flash memory hardware cryptographic accelerators
power supply	rechargeable Lithium-Ion battery, 1200 mAh @7.6 V direct battery charging via power adaptor 220-240 VAC, 50 Hz or 100-120 VAC, 60 Hz
dimensions	190 mm long x 84 mm wide x 46 mm high
weight	380 g (including printer, paper roll and battery)
operating conditions	operating temperature -10°C to +50°C operating humidity 20 % to 95 % RH non-condensing
environmental compliance	RoHS2 directive 2011/65/EU WEEE directive 2002/96/EC European directive 1907/2006/EC on Registration, Evaluation, Authorisation and Restriction of Chemicals (REACH)
software	full-featured Linux® operating system Linux-based development kit (C and Java™) secured remote download of software

item	specification
approvals	EMV 4.3 level 2 approved kernel for payment application development PCI PED, CE and other country-specific standards (see vendor)
optional accessories	carrying case cradle and drop protection vehicle power cables USB cable for connection to ePOS terminal