

HOW TO CALIBRATE THE GYRO

1. Place the quadcopter on a flat, level surface.
2. Quickly shift the left stick up and down to bind the quadcopter to the transmitter as usual.
3. Pull both the left and right sticks down to the bottoms left until the LED lights of the drone start flashing and then turn solid. (see the picture below)
4. The gyro should now be reset.

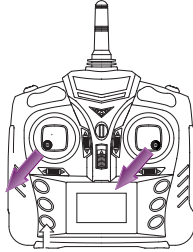

3D FLIPS

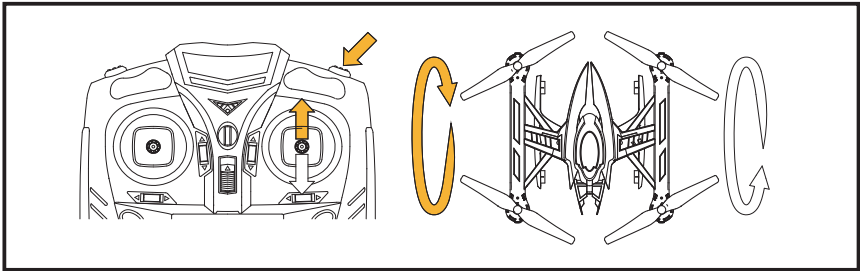

Once you have become familiar with the basic flight capabilities of your quadcopter you can move on to some more acrobatic maneuvers. The quadcopter must be at a height of more than 5m for this to function. However once above this height, you can press the 3D flip button at the upper right of the transmitter, the remote control will sound beeps, move the right stick forward or backward, the drone will flip forward or backward.

Note:

1. We suggest beginners fly the quadcopter in an area with soft ground and free of obstacles.
2. The quadcopter will perform better flips when the battery is fully charged.
3. The quadcopter can only flip forward or backward.

ONE KEY RETURN

Press the One Key Return button, the quadcopter will fly back to the direction where the tail of the drone points to when the drone is being paired.

Please do not use this function when the quadcopter is close to the flyer, otherwise it may cause the injury. Move the right stick to any direction to operate the quadcopter and it will exit the One Key Return function.

WIFI FPV INSTRUCTION FOR USE

This model uses WIFI in combination with HD cameras to display real time images on smartphones. All that is needed is a suitable Android or IOS smartphone with the App installed.

ASSEMBLING THE PHONE HOLDER

A phone holder is included in the box for the FPV function, the assembling is shown as below.

Put the phone holder in the correct position.

Install the holding part with the phone holder.

Fix the phone holder on the remote control by clockwise locking screws.



Please note that the plugs of the camera should be inserted into the correct positions.

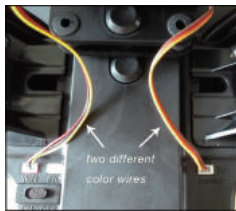
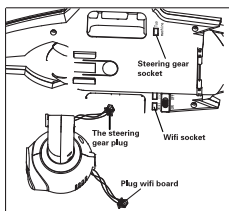

APP INSTALLATION

Scan the relevant QR code below with your smart phone and install the 'Exploration UFO' App



Android



IOS

OPERATING THE APP

Turn on your quadcopter, then go into your phone settings, select WIFI, and then connect to “WiFiUFO_***”, which is the camera connection. Once you have successfully connected, exit the settings menu on your phone and open the ‘EXPLORATION UFO’ App. To see real time images from the quadcopter, simply press the START button in the app.



Open the App
“Exploration UFO”



Click the “start” icon



Real-time image or video will
be shown on the mobile screen

1. To **take a photo**, simply tap the Take Photo button
2. To **take a video**, simply tap the Take Video button.

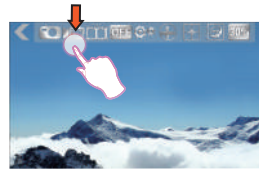

3. All images and videos will be saved to the camera’s micro SD card, so make sure you have inserted that before flight. Once you have finished flying, simply push the card gently to remove it from the camera, and insert it into a card reader and connect to your computer to access your files. All data is saved to a folder in the App.

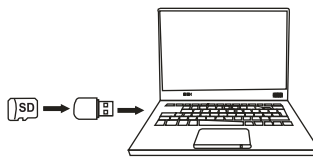

MOBLIE PHONE CONTROL

You can control the quadcopter directly from within the app without using the transmitter. Hold the mobile phone horizontally when using the Gravity Sensor Mode.

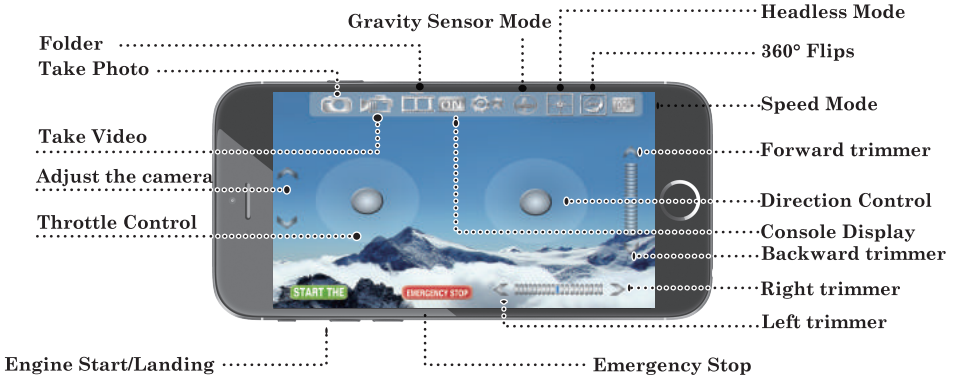

Tips: Turn off the transmitter before you control the drone via the phone.

SPARE PARTS

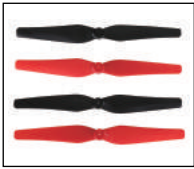

Blades



Camera

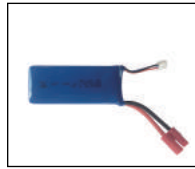

Lithium Battery



USB Cable



Landing Gears

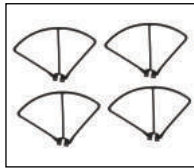

Propeller Guards



Remote Controller



Phone Holder



Shock Absorber



Screwdriver

ABOUT US

Holy Stone is committed to providing the tools that enrich the lives of young adults and children alike. Holy Stone Toys places the quality of our products and services at the heart of everything we do, and our goal is to provide the joy of entertainment and fun to all by providing the best products and support possible to all of you.

We value every customer and appreciate your suggestions and opinions, so please feel free to contact us:



USA@HOLYSTONE.COM (America)

CA@HOLYSTONE.COM (Canada)



+1 (626) 465-7134



WWW.HOLYSTONE.COM



<https://www.facebook.com/HolyStoneToy>

Share our Facebook page to **win extra parts**.
For more info., contact us: fb@holystone.com



Scan to visit our stores



Subscribe us on YouTube

MANUFACTURER INFORMATION

HS400 is manufactured by: Holy Stone
Xiamen Huoshiquan Import & Export CO., LTD.
Room 703, No. 813-2 Xiahe Road, Siming District,
XIAMEN,
China
+1 (626) 465-7134

FCC ID: 2AJ55HOLYSTONEJ01

FCC ID: 2AJ5513358327006



Made in China

FCC Information

This device complies with Part 15 of the FCC Rules. Operation is subject to the following two conditions:

- (1) This device may not cause harmful interference.
- (2) This device must accept any interference received, including interference that may cause undesired operation.

NOTE: This equipment has been tested and found to comply with the limits for a Class B digital device, pursuant to Part 15 of the FCC Rules. These limits are designed to provide reasonable protection against harmful interference in a residential installation. This equipment generates uses and can radiate radio frequency energy and, if not installed and used in accordance with the instructions, may cause harmful interference to radio communications. However, there is no guarantee that interference will not occur in a particular installation. If this equipment does cause harmful interference to radio or television reception, which can be determined by turning the equipment off and on, the user is encouraged to try to correct the interference by one or more of the following measures:

- Reorient or relocate the receiving antenna.
- Increase the separation between the equipment and receiver.
- Connect the equipment into an outlet on a circuit different from that to which the receiver is connected.
- Consult the dealer or an experienced radio/TV technician for help.

FCC WARNING:

The equipment may generate or use radio frequency energy. Changes or modifications to this equipment may cause harmful interference unless the modifications are expressly approved in the instruction manual. Modifications not authorized by the manufacturer may void user's authority to operate this device.

RF Exposure

The equipment complies with FCC radiation exposure limits set forth for an uncontrolled environment. This device should be installed and operated with minimum distance 20cm between the radiator & your body.

LiPo Battery Care Instructions

Temperature

- Heat is a known factor. If a battery is pushed beyond 60°C during discharging or charging, problems could occur due to metallic lithium generation, which damages the cell.

- After a flight, you may find your batteries are warm to touch. Cool down the battery a little bit before recharging.

Storage

- Please store batteries at normal room temperature and avoid direct exposure to sunlight or heat. When storing LiPo battery for any length of time, they should ideally be stored at a temperature of between 5°C and 7°C.
- If you have a battery pack sitting on the shelf, fully charged, never try topping it up till it has been partially or fully discharged!

Usage

- There should be a time interval between charging and using battery.
- Please make sure you time your flights to leave about 20% power remaining in the batteries (instead of completely draining them down) as that would prolong battery life and you can enjoy more cycles!
- If the battery is pushed beyond its limits, the battery could get hot and the performance will drop.
- When using the battery for a long time, the quantity of heat of your battery will increase. If it is sealed, the air inside will inflate rapidly causing heating.

Charging

- DO NOT overcharge the battery. It may cause overheating and in turn this overheating could damage the unit.
- Never try charging a pack that has been crashed or is damaged, you run the risk of fire! Cells that are obviously swollen or have physical damage should never be used and careful disposal is required, especially if the cells are swollen.
- If the battery or the charger is defective, you should discard it immediately and process a warranty from our support team(usa@holystone.com). We can arrange to ship you a replacement charger or battery.
- After crashing the quadcopter, please check the battery connector and battery properly.
- Please use genuine factory spare parts replacements from Holy Stone only.



Li-Po Battery Disposal & Recycling
Wasted Lithium-Polymer batteries must not be placed with household trash. Please contact local environmental or waste agency or the supplier of your model of your nearest Li-Po battery recycling center.

