



QUICK START GUIDE

VS330



1. Packing List



2. Hardware Introduction

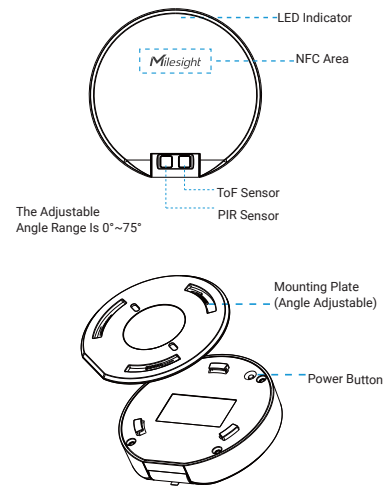

3. Hardware Introduction

Function	Action	LED Indicator
Power On/Off	Press and hold the power button for more than 3 seconds.	Power On: Off → On Power Off: On → Off
Check On/Off Status	Quick press the power button.	Light On: Device is on Light Off: Device is off
Reset	Press and hold the power button for more than 10 seconds.	Blinks quickly
Enable Test Mode	Quick press the power button.	Off → On
Test Mode	Face the sensor to object.	Occupied → Vacant: Blinks twice Vacant → Occupied: Blinks twice

4. Configuration Guide

1. Press and hold the power button on the back of device to power on the device.
2. Download "Milesight ToolBox" App on an NFC-supported smartphone.



Android



iOS

3. Open "Milesight ToolBox" App and attach the smartphone with NFC area to read/write the device until App shows a successful prompt. It's suggested to configure a device password for security. (Default password: 123456)

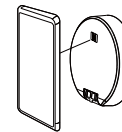

Cloud App



Quick Start Guide

Better Inside, More in Sight

Milesight IoT Co., Ltd. | www.milesight-iot.com

5. Installation

Ceiling Mount:

1. Take off the mounting plate on the back of the device, drill 2 holes on the ceiling according to the mounting plate, then fix the wall plugs into the ceiling and fix the mounting plate to the wall plugs with screws. The mounting plate can also be fixed by 3M tapes.

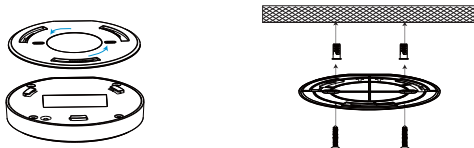

2. Turn the device clockwise to lock it to the mounting plate. The angle of rotation can be adjusted according to your requirements (at maximum of 15°).

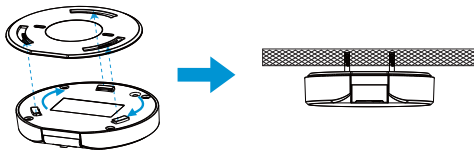

Installation Location:

- The installation height should be 2.5 to 3m.
- The sensor part should face the front of toilet and the sensor should be installed horizontally to the ceiling, sensor angle is set to 0°.
- Keep the center of device 10 to 20 cm away from the center of toilet.
- It is suggested to enable test mode to check if opening and closing door will affect the detection results and adjust the location.

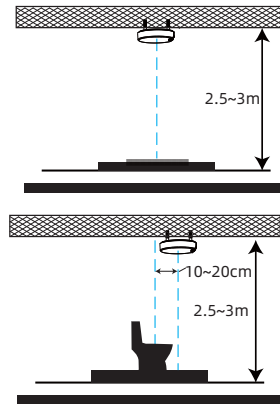

Wall Mount:

1. Take off the mounting plate on the back of the device, drill 2 holes on the wall according to the mounting plate, then fix the wall plugs into the wall and fix the mounting plate to the wall plugs with screws. The mounting plate can also be fixed by 3M tapes.

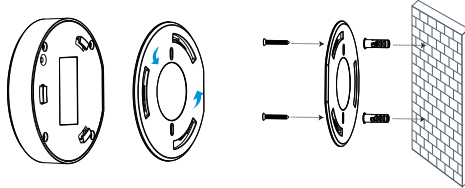

2. Turn the device clockwise to lock it to the mounting plate. The angle of rotation can be adjusted according to your requirements (at maximum of 15°).

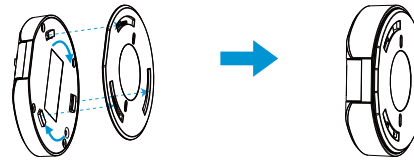

Installation Location:

- Locate the device exactly on the wall and at the back of the flush toilet, and the sensor part should face downwards the flush toilet.
- Do not make the sensor face to door directly or cover the detection area of door when adjusting the sensor angle.
- The installation height should be higher than the height of standing toilet lid so as to avoid affecting the detection.
- It is suggested to enable test mode to check if opening and closing door will affect the detection results and adjust the location.

6. Installation Note

- Avoid strong light, like direct sunlight or IR LED, in the detection area.
- Do not install the device close to glass or mirror.
- After installation and adjustment, please remove the protective film.
- Do not touch the lens of sensors directly to avoid leaving the fingerprint on it.
- The detecting performance will be affected if there's dust on the lens. Please use the mirror cleaning cloth to clean the lens regularly.
- Keep the device away from the water or other liquids to prevent damage to the device.
- Do not modify, disassemble, strike or crush the device.
- Keep the device out of childrens' reach.

7. FCC Statement

Any Changes or modifications not expressly approved by the party responsible for compliance could void the user's authority to operate the equipment. This device complies with part 15 of the FCC Rules. Operation is subject to the following two conditions:

- (1) This device may not cause harmful interference, and
- (2) This device must accept any interference received, including interference that may cause undesired operation.

Note: This equipment has been tested and found to comply with the limits for a Class B digital device, pursuant to part 15 of the FCC Rules. These limits are designed to provide reasonable protection against harmful interference in a residential installation. This equipment generates, uses and can radiate radio frequency energy and, if not installed and used in accordance with the instructions, may cause harmful interference to radio communications. However, there is no guarantee that interference will not occur in a particular installation. If this equipment does cause harmful interference to radio or television reception, which can be determined by turning the equipment off and on, the user is encouraged to try to correct the interference by one or more of the following measures:

- Reorient or relocate the receiving antenna.
- Increase the separation between the equipment and receiver.
- Connect the equipment into an outlet on a circuit different from that to which the receiver is connected.
- Consult the dealer or an experienced radio/TV technician for help.

FCC Radiation Exposure Statement:

This equipment complies with FCC radiation exposure limits set forth for an uncontrolled environment. This equipment should be installed and operated with minimum distance 20cm between the radiator & your body. This transmitter must not be co-located or operating in conjunction with any other antenna or transmitter.